

District I
1625 N. French Dr., Hobbs, NM 88240
District II
1301 W. Grand Avenue, Artesia, NM 88210
District III
1000 Rio Brazos Road, Aztec, NM 87410
District IV
1220 S. St. Francis Dr., Santa Fe, NM 87505

State of New Mexico
Energy Minerals and Natural Resources

Form C-144
June 1, 2004

Oil Conservation Division
1220 South St. Francis Dr.
Santa Fe, NM 87505

For drilling and production facilities, submit to appropriate NMOCD District Office.
For downstream facilities, submit to Santa Fe office

Pit or Below-Grade Tank Registration or Closure

Is pit or below-grade tank covered by a "general plan"? Yes ☒ No ☐

Type of action: Registration of a pit or below-grade tank ☐ Closure of a pit or below-grade tank ☒

Operator: <u>Capataz Op. Inc</u> Telephone: <u>432.420.8820</u> e-mail address: <u>sean.04@leaco.net</u>		
Address: <u>P.O. Box 10549</u> <u>Midland Tx 79702</u>		
Facility or well name: <u>Salem #1</u> API #: <u>30.025.37316</u> U/L or Qtr/Qtr <u>A</u> Sec <u>3</u> T <u>20</u> R <u>38</u>		
County: <u>Lea</u> Latitude _____ Longitude _____ NAD: 1927 <input type="checkbox"/> 1983 <input type="checkbox"/>		
Surface Owner: Federal <input type="checkbox"/> State <input type="checkbox"/> Private <input type="checkbox"/> Indian <input type="checkbox"/>		
Pit Type: Drilling <input checked="" type="checkbox"/> Production <input type="checkbox"/> Disposal <input type="checkbox"/> Workover <input type="checkbox"/> Emergency <input type="checkbox"/> Lined <input checked="" type="checkbox"/> Unlined <input type="checkbox"/> Liner type: Synthetic <input checked="" type="checkbox"/> Thickness <u>12</u> mil Clay <input type="checkbox"/> Pit Volume <u>1200</u> bbl		
Below-grade tank Volume: _____ bbl Type of fluid: _____ Construction material: _____ Double-walled, with leak detection? Yes <input type="checkbox"/> If not, explain why not. _____		
Depth to ground water (vertical distance from bottom of pit to seasonal high water elevation of ground water.) <u>25 ft</u>	<u>Less than 50 feet</u> 50 feet or more, but less than 100 feet 100 feet or more	<u>(20 points)</u> (10 points) (0 points)
Wellhead protection area: (Less than 200 feet from a private domestic water source, or less than 1000 feet from all other water sources.)	Yes <u>No</u>	(20 points) (0 points)
Distance to surface water: (horizontal distance to all wetlands, playas, irrigation canals, ditches, and perennial and ephemeral watercourses.)	Less than 200 feet 200 feet or more, but less than 1000 feet <u>1000 feet or more</u>	(20 points) (10 points) (0 points)
Ranking Score (Total Points)		<u>20</u>

If this is a pit closure: (1) Attach a diagram of the facility showing the pit's relationship to other equipment and tanks. (2) Indicate disposal location: (check the onsite box if you are burying in place) onsite ☐ offsite ☒ If offsite, name of facility _____. (3) Attach a general description of remedial action taken including remediation start date and end date. (4) Groundwater encountered: No ☐ Yes ☐ If yes, show depth below ground surface _____ ft. and attach sample results. (5) Attach soil sample results and a diagram of sample locations and excavations.

Additional Comments: Plan to excavate and haul all contents of the drilling pit to a OCD approved facility. After excavating and hauling the bottom of the pit will be sampled & tested, the results will be given to OCD for approval to backfill & level.
Will notify OCD before starting & file sundry notice after closing
Will begin soon after approval

I hereby certify that the information above is true and complete to the best of my knowledge and belief. I further certify that the above-described pit or below-grade tank has been/will be constructed or closed according to NMOCD guidelines ☒, a general permit ☐, or an (attached) alternative OCD-approved plan ☒.

Date: 2/16/06

Printed Name/Title Eddie W. Sean Agent Signature Eddie W. Sean

Your certification and NMOCD approval of this application/closure does not relieve the operator of liability should the contents of the pit or tank contaminate ground water or otherwise endanger public health or the environment. Nor does it relieve the operator of its responsibility for compliance with any other federal, state, or local laws and/or regulations.

Approval:

Printed Name/Title GARY W. WINK / STAFF MGR Signature Gary W. Wink

Date: 2/15/06

CAPATAZ OPERATING, INC.

DRILLING PIT DIAGRAM

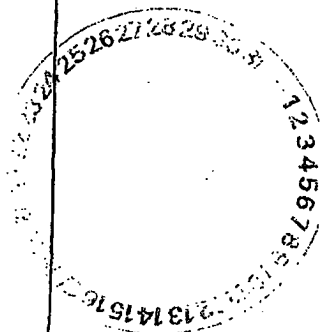
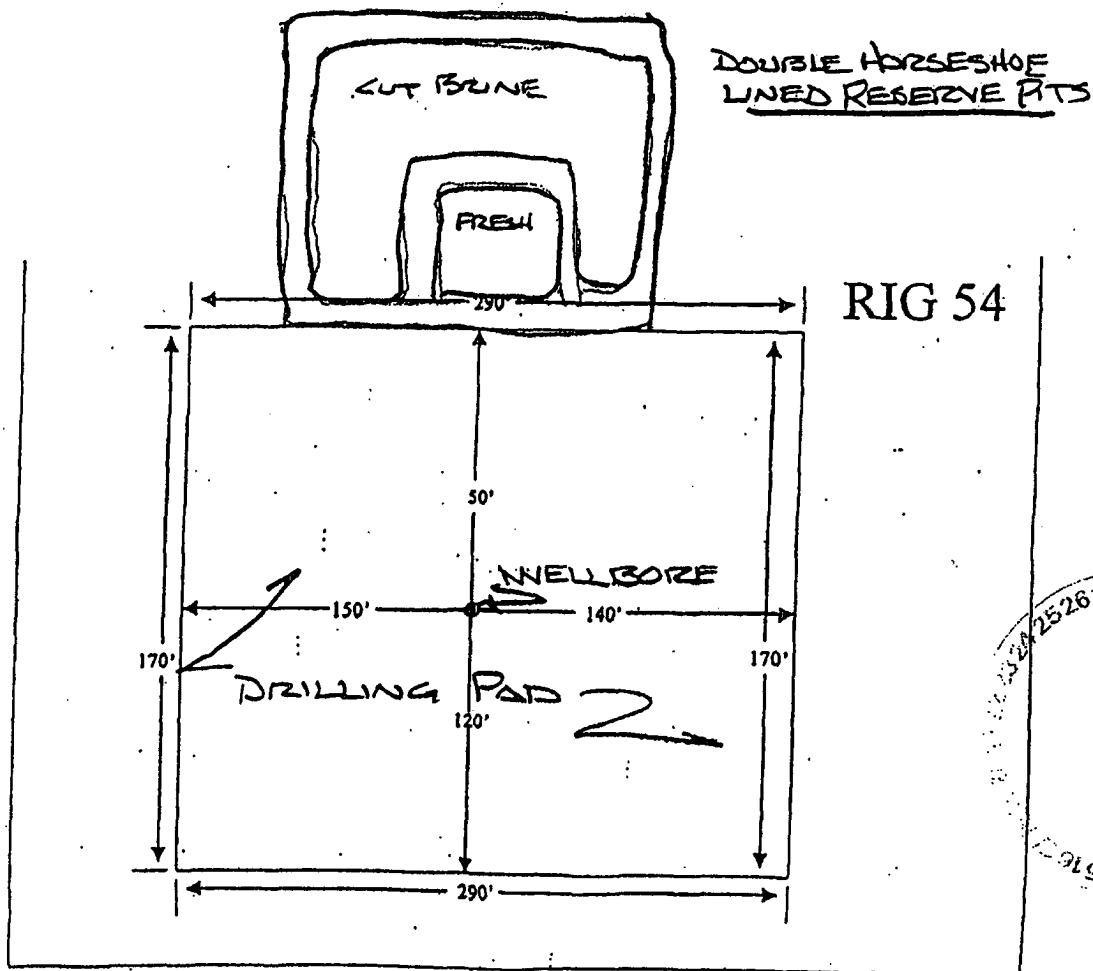

New Mexico Office of the State Engineer
POD Reports and DownloadsTownship: **20S** Range: **38E** Sections: NAD27 X: Y: Zone: Search Radius: County: Basin: Number: Suffix: Owner Name: (First) (Last) ☐ Non-Domestic ☐ Domestic ☒ All

POD / Surface Data Report

Avg Depth to Water Report

Water Column Report

Clear Form

iWATERS Menu

Help

AVERAGE DEPTH OF WATER REPORT 02/15/2006

Bsn	Tws	Rng	Sec	Zone	X	Y	Wells	(Depth Water in Feet)		
								Min	Max	Avg
CP	20S	38E	33				1	35	35	35
L	20S	38E	02				16	38	65	45
L	20S	38E	03				4	25	45	35
L	20S	38E	04				1	30	30	30
L	20S	38E	05				4	24	54	39
L	20S	38E	06				6	53	67	63
L	20S	38E	07				2	80	80	80
L	20S	38E	08				2	60	60	60
L	20S	38E	10				4	30	52	45
L	20S	38E	11				8	31	90	47
L	20S	38E	12				4	46	65	57
L	20S	38E	13				1	42	42	42
L	20S	38E	14				2	38	38	38
L	20S	38E	18				2	50	50	50
L	20S	38E	24				1	30	30	30
L	20S	38E	26				1	65	65	65

Record Count: 59