

District I
1625 N. French Dr., Hobbs, NM 88240
District II
1301 W. Grand Avenue, Artesia, NM 88210
District III
1000 Rio Brazos Road, Aztec, NM 87410
District IV
1220 S. St. Francis Dr., Santa Fe, NM 87505

State of New Mexico
Energy Minerals and Natural Resources

Form C-101
Revised March 17, 1999

Oil Conservation Division
1220 South St. Francis Dr.
Santa Fe, NM 87505

Submit to appropriate District Office
State Lease - 6 Copies
Fee Lease - 5 Copies

☐ AMENDED REPORT

APPLICATION FOR PERMIT TO DRILL, RE-ENTER, DEEPEN, PLUGBACK, OR ADD A ZONE

¹ Operator Name and Address Chesapeake Operating, Inc. P. O. Box 18496 Oklahoma City, OK 73154-0496		² OGRID Number 147179
		³ API Number 30-025-36332
³ Property Code 32560	⁵ Property Name Berry 1	⁶ Well No. 1

⁷ Surface Location

UL or lot no.	Section	Township	Range	Lot Idn	Feet from the	North/South line	Feet from the	East/West line	County
M	1	17-S	37-E		680'	South	195	West	Lea

⁸ Proposed Bottom Hole Location If Different From Surface

UL or lot no.	Section	Township	Range	Lot Idn	Feet from the	North/South line	Feet from the	East/West line	County
M	1	17S	37E		560	South	560	West	Lea

⁹ Proposed Pool 1

¹⁰ Proposed Pool 2

Shipp Strawn	
--------------	--

¹¹ Work Type Code N	¹² Well Type Code G	¹³ Cable/Rotary R	¹⁴ Lease Type Code P	¹⁵ Ground Level Elevation 3746'
¹⁶ Multiple N	¹⁷ Proposed Depth 11,850'	¹⁸ Formation Strawn	¹⁹ Contractor Patterson #504	²⁰ Spud Date 08/15/03

²¹ Proposed Casing and Cement Program

Hole Size	Casing Size	Casing weight/foot	Setting Depth	Sacks of Cement	Estimated TOC
17-1/2"	13-3/8"	48# H-40	0-440'	400	Surf
12-1/4	8-5/8"	32# J-55	0-4600'	1200	Surf
7-7/8	5-1/2"	17# L-80	0-11,850'	1300	4600'

²² Describe the proposed program. If this application is to DEEPEN or PLUG BACK, give the data on the present productive zone and proposed new productive zone.

Describe the blowout prevention program, if any. Use additional sheets if necessary.

Chesapeake Operating, Inc. proposes to drill to a T.D. of 11850' in the Strawn formation with Patterson #504 rig as the drilling contractor.

The BOP consists of 13-5/8" 10M blind & pipe rams & 13-5/8" 5M annular (see schematic)

Permit Expires 1 Year From Approval
Date Unless Drilling Underway

²³ I hereby certify that the information given above is true and complete to the best of my knowledge and belief.

Signature:

Printed name: Barbara J. Bale

Title: Regulatory Analyst

Date: 07/10/03

Phone: (405) 848-8000

OIL CONSERVATION DIVISION

Approved by:

Title: PETROLEUM ENGINEER

Approval Date: JUL 16 2008 Expiration Date:

Conditions of Approval:

Attached ☐

State of New Mexico

DISTRICT I

P.O. Box 1980, Hobbs, NM 88241-1980

Energy, Minerals and Natural Resources Department

Form C-102

Revised February 10, 1994

Submit to Appropriate District Office

State Lease - 4 Copies

Fee Lease - 3 Copies

DISTRICT II

P.O. Drawer DD, Artesia, NM 88211-0719

OIL CONSERVATION DIVISION

P.O. Box 2088

Santa Fe, New Mexico 87504-2088

DISTRICT III

1000 Rio Brazos Rd., Aztec, NM 87410

DISTRICT IV

P.O. Box 2088, Santa Fe, N.M. 87504-2088

WELL LOCATION AND ACREAGE DEDICATION PLAT

☐ AMENDED REPORT

API Number 30-025-36332	Pool Code 55695	Pool Name Shipp Strawn
Property Code 32560	Property Name BERRY 1	Well Number 1
OGRID No. 147179	Operator Name CHESAPEAKE OPERATING, INC.	Elevation 3746'

Surface Location

UL or lot No.	Section	Township	Range	Lot Idn	Feet from the	North/South line	Feet from the	East/West line	County
M	1	17-S	37-E		680'	SOUTH	195'	WEST	LEA

Bottom Hole Location If Different From Surface

UL or lot No.	Section	Township	Range	Lot Idn	Feet from the	North/South line	Feet from the	East/West line	County
M	1	17-S	37-E		560'	SOUTH	560'	WEST	LEA
Dedicated Acres 80		Joint or Infill		Consolidation Code		Order No.			

NO ALLOWABLE WILL BE ASSIGNED TO THIS COMPLETION UNTIL ALL INTERESTS HAVE BEEN CONSOLIDATED
OR A NON-STANDARD UNIT HAS BEEN APPROVED BY THE DIVISION

LOT 4	LOT 3	LOT 2	LOT 1
41.19 AC	41.17 AC	41.15 AC	41.13 AC
<p>GEODETIC COORDINATE</p> <p>NAD 27 NME SURFACE LOCATION Y.= 677774.7 N X.= 844206.9 E LAT.= 32°51'29.75"N LONG.= 103°12'44.76"W</p>			
<p>B.H. LOCATION</p> <p>Y.= 677658.4 X.= 844573.3</p>			
<p>OPERATOR CERTIFICATION</p> <p>I hereby certify the the information contained herein is true and complete to the best of my knowledge and belief.</p> <p><i>Barbara J Bale</i> Signature Barbara J. Bale Printed Name Regulatory Analyst Title 07/10/03 Date</p>			
<p>SURVEYOR CERTIFICATION</p> <p>I hereby certify that the well location shown on this plat was plotted from field notes of actual surveys made by me or under my supervision, and that the same is true and correct to the best of my belief.</p> <p>July 01, 2003</p> <p>Date Surveyed Signature & Seal of Professional Surveyor <i>GARY EIDSON</i> 03.13.0672 Certification No. RONALD J. EIDSON 3239 GARY EIDSON 12841</p>			

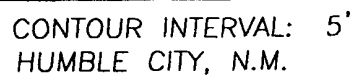

U.S.G.S. TOPOGRAPHIC MAP
HUMBLE CITY, N.M.

JOHN WEST SURVEYING
HOBBS, NEW MEXICO
(505) 393-3117

VICINITY MAP

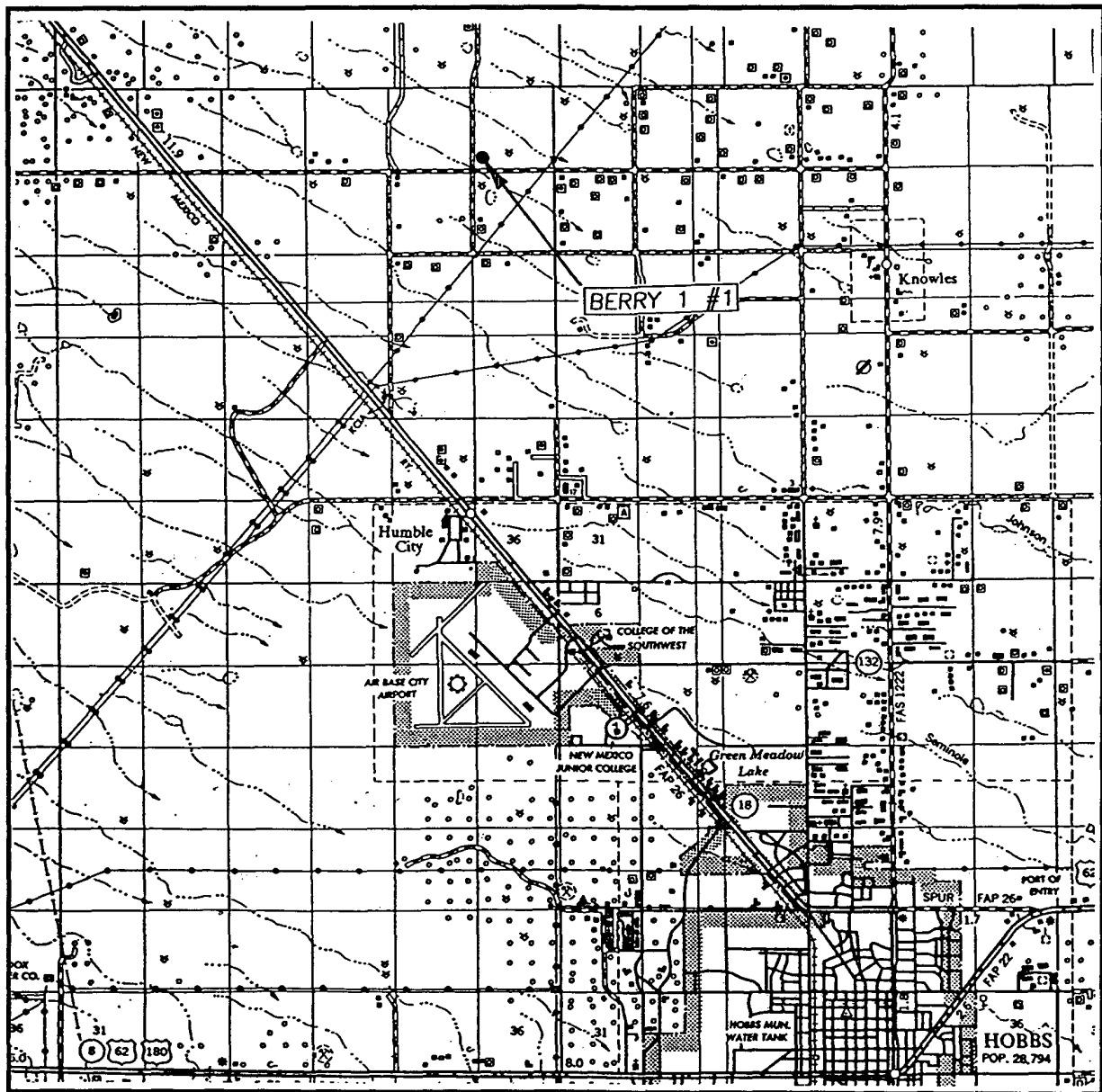

SCALE: 1" = 2 MILES

SEC. 1 TWP. 17-S. RGE. 37-E

SURVEY N.M.P.M.

COUNTY LEA

DESCRIPTION 680' FSL & 195' FWL

ELEVATION 3746'

OPERATOR CHESAPEAKE OPERATING, INC.

LEASE BERRY 1

JOHN WEST SURVEYING
HOBBS, NEW MEXICO
(505) 393-3117

Well Name Berry 1-1
County Lea, NM (1-17S-37E))

Rig
Survey Co.

Target #1 0.00 KBTVD 0.00 Dip(- Up) 108.2 Section Plane
Target #2 0.00 KBTVD 0.00 Dip(- Up) 0 Section Plane
Target #3 0.00 KBTVD 0.00 Dip(- Up) 0 Section Plane

Survey	Measured Depth	Inclination	Azimuth	Course Length	TVD	North (+) South (-)	East (+) West (-)	VS	BUR	DLS	Relation to	Relation to	Relation to
Tie In	-	0.00	0.00	0	0.0	0	0.0	0.0			-	-	-
KOP	6,944	0.00	0.00	6944	6944.1	0.0	0.0	0.0	0.00	0.00	-8944.1	-8944.1	-8944.1
EOB	7,277	5.00	108.20	333	7277.0	-4.5	13.8	14.5	1.50	1.50	-7277.0	-7277.0	-7277.0
Tgt Cntr	11,517	5.00	108.20	4239	11500.0	-119.9	384.8	384.0	0.00	0.00	-11500.0	-11500.0	-11500.0
TD	11,868	5.00	108.20	351	11850.0	-129.5	393.9	414.6	0.00	0.00	-11850.0	-11850.0	-11850.0

BLOWOUT PREVENTOR SCHEMATIC
CHESAPEAKE OPERATING INC

WELL : Berry 1-1
RIG : Patterson 504
COUNTY : Lea STATE: New Mexico
OPERATION Drill out below 13-5/8" Casing

	SIZE	PRESSURE	DESCRIPTION
A	13-5/8"	5,000#	Annular
D	13-5/8"	5,000#	Mud Cross
Spool		13-5/8" 3M x 13-5/8" 5M	
A-Sec		13-5/8" SOW x 13-5/8" 3M	

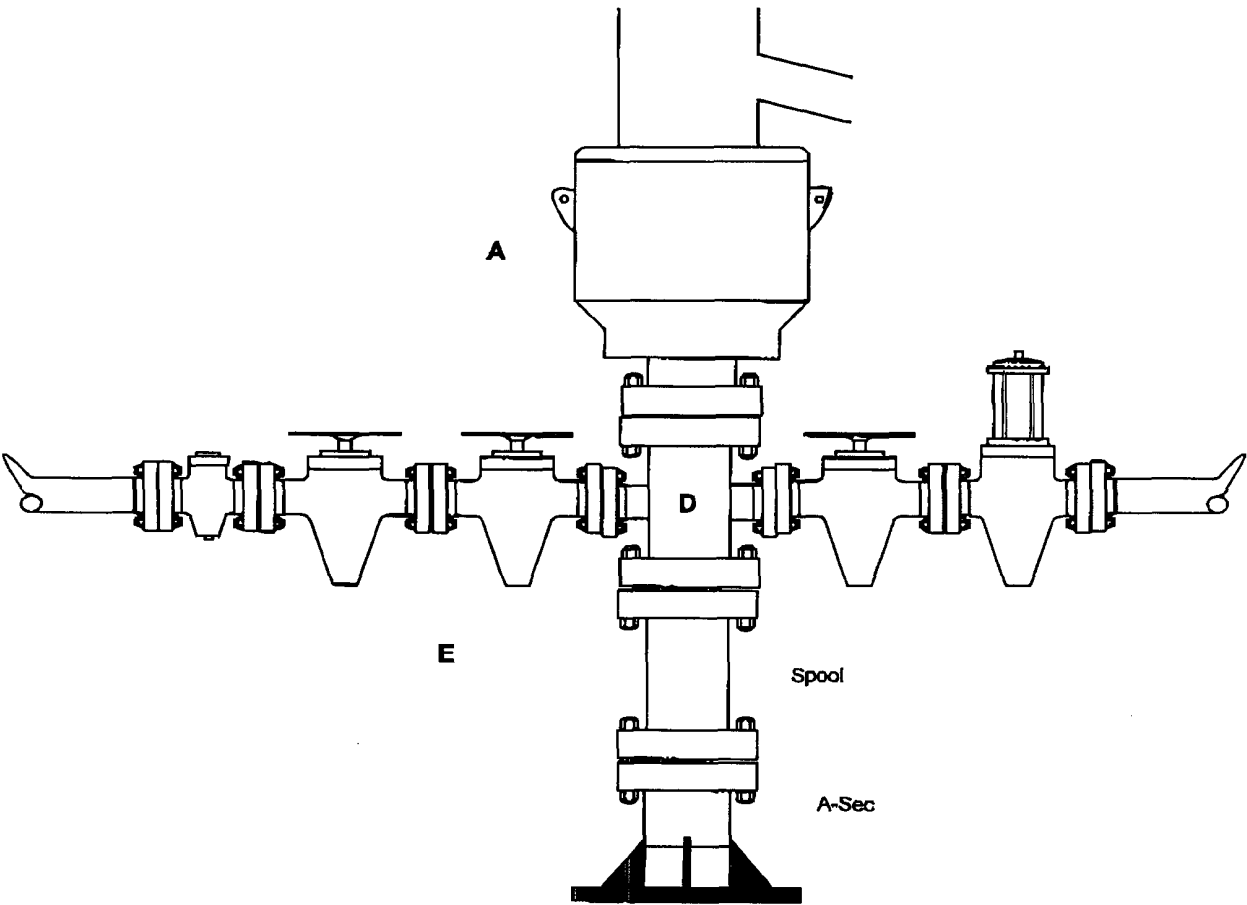

Kill Line

SIZE	PRESSURE	DESCRIPTION
2"	10,000#	Check Valve
2"	10,000#	Gate Valve
2"	10,000#	Gate Valve

Choke Line

SIZE	PRESSURE	DESCRIPTION
4"	10,000#	Gate Valve
4"	10,000#	HCR Valve

BLOWOUT PREVENTOR SCHEMATIC

CHESAPEAKE OPERATING INC

WELL : Berry 1-1

RIG : Patterson 504

COUNTY : Lea

STATE: New Mexico

OPERATION: Drill out below 8-5/8" Casing

	SIZE	PRESSURE	DESCRIPTION
A	13-5/8"	500#	Rot Head
B	13-5/8"	5,000#	Annular
C	13-5/8"	5,000#	Pipe Rams
D	13-5/8"	5,000#	Blind Rams
E	13-5/8"	5,000#	Mud Cross
DSA	11" 5M x 13-5/8" 5M		
B-sec	13-5/8" 3M x 11" 5M		
A-Sec	13-5/8" SOW x 13-5/8" 3M		

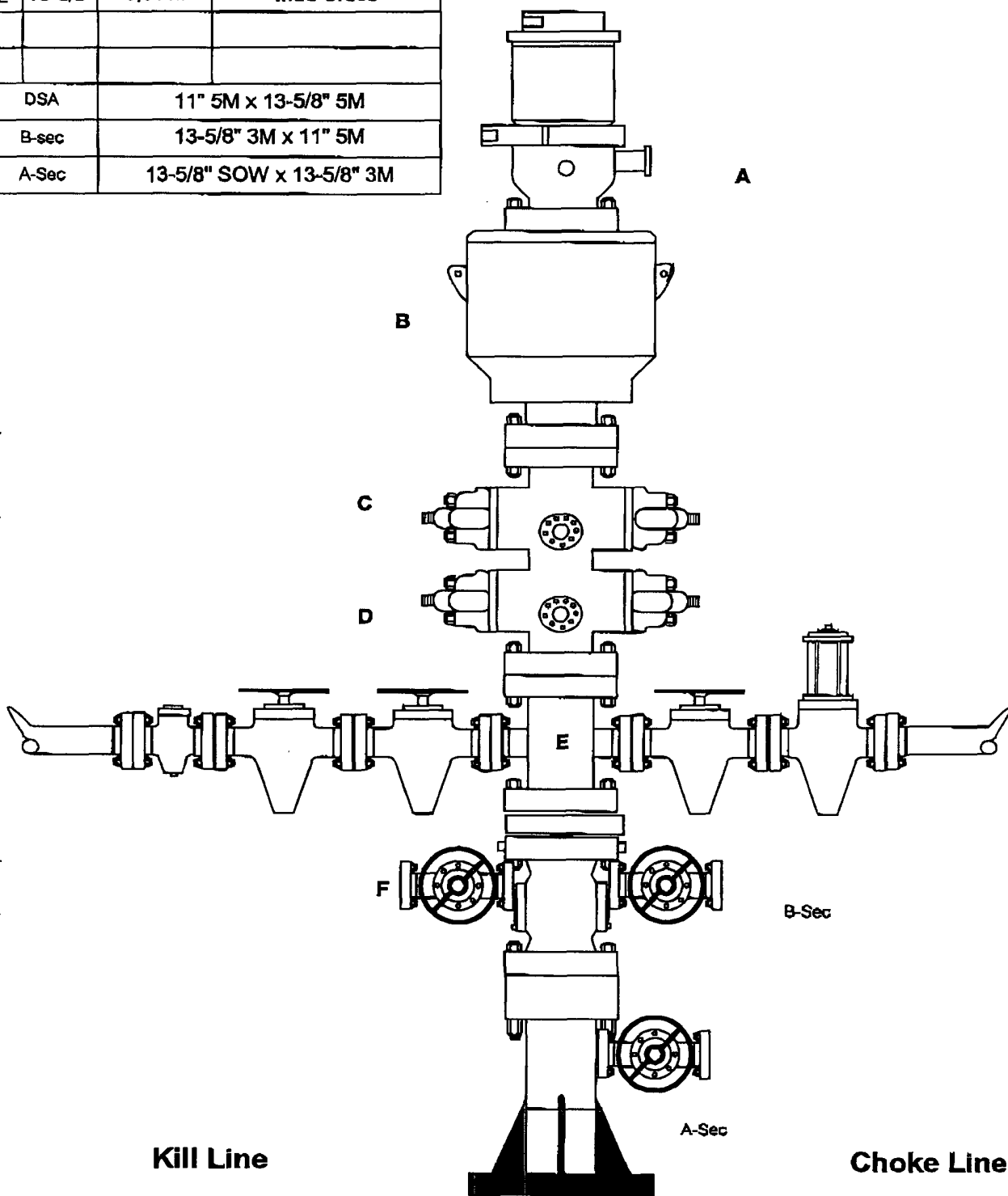

	SIZE	PRESSURE	DESCRIPTION
	2"	10,000#	Check Valve
	2"	10,000#	Gate Valve
	2"	10,000#	Gate Valve

	SIZE	PRESSURE	DESCRIPTION
	4"	10,000#	Gate Valve
	4"	10,000#	HCR Valve

sc. Well: Pennzoil Co. Viersen #1-1 4-17-37 Top Perf. 11,138 Disc. Allow. 55,595 bbls.76 BOPD
 Top Allow. 445 BOPD
 80 Acre Spacing-either way
 Well to be located within
 150' of center of either 4
 R-8062-A

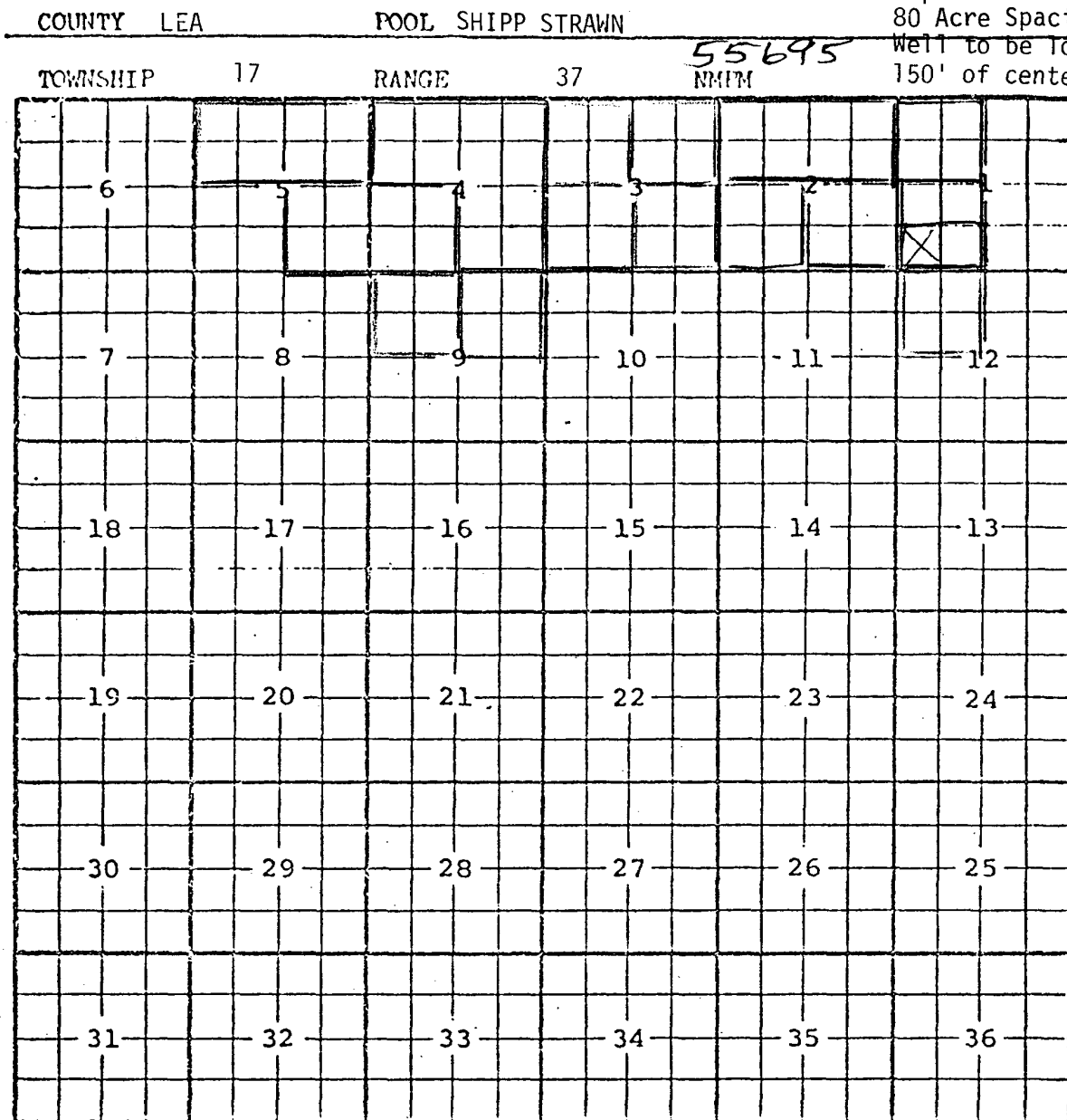

Created R-8062 & revised by R-8062-A effec. 1/21/86 Vertical Limits (R-8062) Strawn from
 R-8062-A N/2 & SE/4 Sec. 4 11,138' to 11,255' on log
 of discovery well. (Signature) PK

5/1/86	Ext R-8214 Sec. 9: NE/4	
11/1/86	Ext R-8340 Sec. 9: NW/4	4/1/91 Ext R9472 Sec.4 SW/4 & Sec5 SE/4
12/18/86	R-8062-B special rules continued in full force	
4/1/87	Ext R-8409 Sec. 3: NW/4	
6/1/87	Ext R-8451 Sec. 3: NE/4	
11/1/87	Ext R-8533 Sec. 3: SE/4	
3/1/88	Ext R-8603 Sec. 5: N/2	
4/1/88	Ext R-8626 Sec. 2: N/2 & Sec. 3: SW/4	
11/1/88	Ext R-8772 Sec. 1: NW/4	
2/1/89	Ext R-8856 Sec.2: SW/4	
4/1/89	Ext R-8901 Sec. 1: SW/4	
9/1/89	Ext. R-8981 Sec.2: SE/4 & Sec 12: NW/4	