



Occidental Permian Limited Partnership

February 21, 2006

New Mexico Oil Conservation Division
District I
1625 N. French Drive
Hobbs, New Mexico 88240

Attn: Environmental Engineering

RE: Drilling Pit Closure Plan
North Hobbs Unit 29-711 Drilling Pit
UL 'C', Sec. 29, T-18-S, R-38-E

This letter is being sent as a notification of pit closure for the drilling pit at the above mentioned location. This pit will be closed as follows:

1. All drill cuttings and liner will be removed from pit area.
2. All cuttings will be disposed of at Sundance Services, Parabo Facility near Eunice, New Mexico.
3. Native soils, stored on site, will be used for backfill of the area.
4. NMOCD Pit and Below-Grade Tank Guidelines, dated 11-01-2004, will be used for pit closure compliance.
5. Start date on drill cutting removal March 01, 2006.
6. Work should be completed by March 30, 2006.
7. A final form C-144 is attached.

If you have any questions, or if I can be of further assistance, please contact me at (505) 397-8251.

Steven M. Bishop
HES Technician/Hobbs RMT
Steven_Bishop@oxy.com
(505) 397-8251

Attachments: Form C-144
Diagram of pit and well location

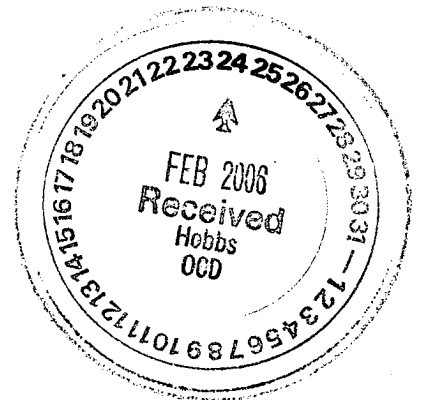

District I
1625 N. French Dr., Hobbs, NM 88240
District II
1301 W. Grand Avenue, Artesia, NM 88210
District III
1000 Rio Brazos Road, Aztec, NM 87410
District IV
1220 S. St. Francis Dr., Santa Fe, NM 87505

State of New Mexico
Energy Minerals and Natural Resources

Form C-144
March 12, 2004

Oil Conservation Division
1220 South St. Francis Dr.
Santa Fe, NM 87505

For drilling and production facilities, submit to appropriate NMOCD District Office.
For downstream facilities, submit to Santa Fe office

Pit or Below-Grade Tank Registration or Closure

Is pit or below-grade tank covered by a "general plan"? Yes No

Type of action: Registration of a pit or below-grade tank Closure of a pit or below-grade tank

Operator: Occidental Permian, LTD Telephone: 505.39738251 e-mail address: Steven_Bishop@oxy.com

Address: 1017 W. Stanolind Road, Hobbs, New Mexico 88240

Facility or well name: NHU 29-711 API #: 30-025-37451 U/L_C__ Sec 29 T 18-S R 38-E

County: Lea Latitude 32°43'29.19"N Longitude 103°10'24.31"W NAD: 1927 1983 Surface Owner Federal State Private Indian

<p>Pit Type: Drilling <input checked="" type="checkbox"/> Production <input type="checkbox"/> Disposal <input type="checkbox"/> Workover <input type="checkbox"/> Emergency <input type="checkbox"/> Lined <input checked="" type="checkbox"/> Unlined <input type="checkbox"/> Liner type: Synthetic <input checked="" type="checkbox"/> Thickness 12 mil Clay <input type="checkbox"/> Volume 5,000 bbl</p>	<p>Below-grade tank Volume: ___ bbl Type of fluid: _____ Construction material: _____ Double-walled, with leak detection? Yes <input type="checkbox"/> If not, explain why not. _____</p>	
<p>Depth to ground water (vertical distance from bottom of pit to seasonal high water elevation of ground water.)</p>	<p>Less than 50 feet 50 feet or more, but less than 100 feet 100 feet or more</p>	<p>(20 points) (10 points) 10 (0 points)</p>
<p>Wellhead protection area: (Less than 200 feet from a private domestic water source, or less than 1000 feet from all other water sources.)</p>	<p>Yes No</p>	<p>(20 points) 20 (0 points)</p>
<p>Distance to surface water: (horizontal distance to all wetlands, playas, irrigation canals, ditches, and perennial and ephemeral watercourses.)</p>	<p>Less than 200 feet 200 feet or more, but less than 1000 feet 1000 feet or more</p>	<p>(20 points) (10 points) (0 points) 0</p>
<p>Ranking Score (Total Points)</p>		<p>30</p>

If this is a pit closure: (1) attach a diagram of the facility showing the pit's relationship to other equipment and tanks. (2) Indicate disposal location: onsite offsite If offsite, name of facility Sundance Services, Parabo Facility. (3) Attach a general description of remedial action taken including remediation start date and end date. (4) Groundwater encountered: No Yes If yes, show depth below ground surface _____ ft. and attach sample results. (5) Attach soil sample results and a diagram of sample locations and excavations.

I hereby certify that the information above is true and complete to the best of my knowledge and belief. I further certify that the above-described pit or below-grade tank has been/will be constructed or closed according to NMOCD guidelines , a general permit , or an (attached) alternative OCD-approved plan .

Date: 02/21/2006

Printed Name/Title Steven M. Bishop / HES Spec. Signature *Steven M. Bishop*

Your certification and NMOCD approval of this application/closure does not relieve the operator of liability should the contents of the pit or tank contaminate ground water or otherwise endanger public health or the environment. Nor does it relieve the operator of its responsibility for compliance with any other federal, state, or local laws and/or regulations

Approval:
Date: 2/27/06

Printed Name/Title GARY W. WINK / STAFF MGR Signature *Gary W. Wink*

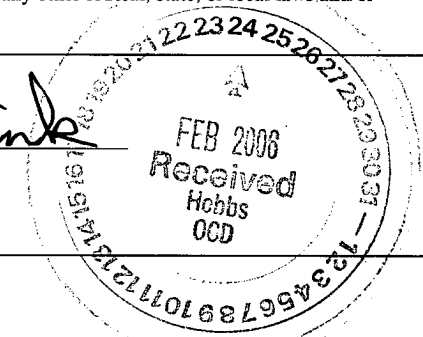

North Hobbs Unit 29-711

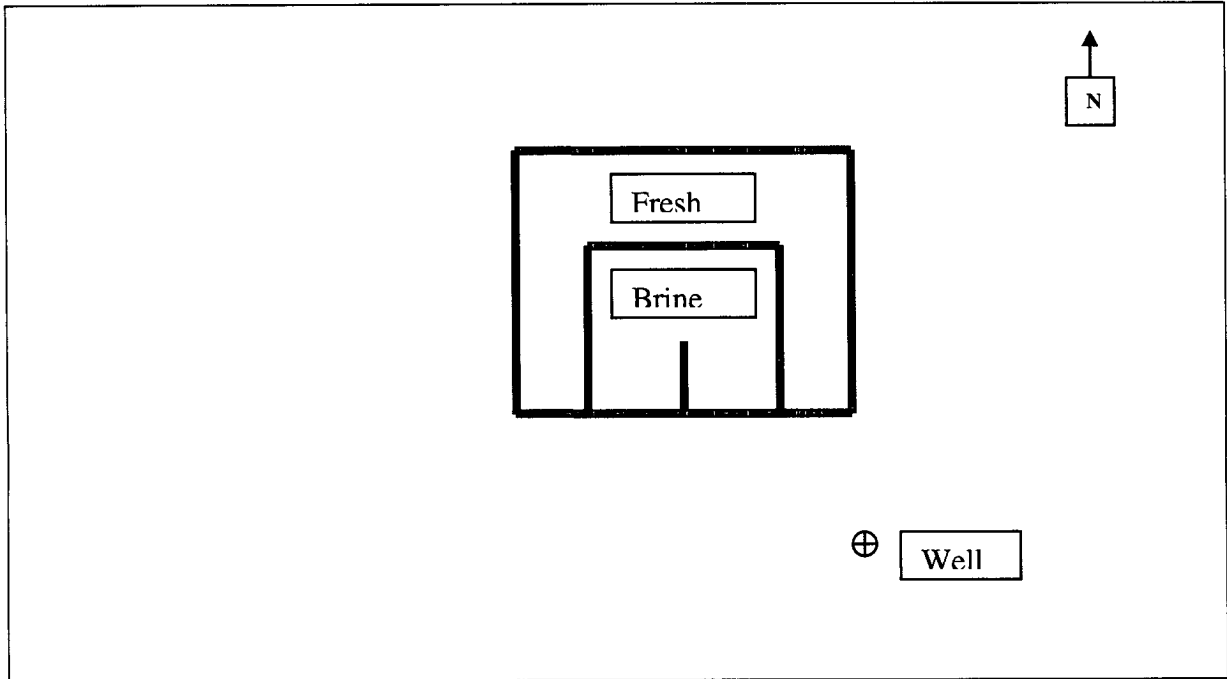

Occidental Permian Ltd.

North Hobbs Unit 29-711

API #30-025-37451

Unit Letter 'C', Section 29, T-18-S, R-38-E

Long N 32°43'29.19" Lat W 103°10'24.31"

100' X 100' Pit 50' North of Wellhead

