

District I
1625 N. French Dr., Hobbs, NM 88240
District II
1301 W. Grand Avenue, Artesia, NM 88210
District III
1000 Rio Brazos Road, Aztec, NM 87410
District IV
1220 S. St. Francis Dr., Santa Fe, NM 87505

State of New Mexico
Energy Minerals and Natural Resources

Oil Conservation Division
1220 South St. Francis Dr.
Santa Fe, NM 87505

Form C-144
June 1, 2004

For drilling and production facilities,
submit to appropriate NMOCD District
Office.
For downstream facilities, submit to
Santa Fe office

Pit or Below-Grade Tank Registration or Closure

Is pit or below-grade tank covered by a "general plan"? Yes ☒ No ☐

Type of action: Registration of a pit or below-grade tank ☒ Closure of a pit or below-grade tank ☒

Operator: Latigo Petroleum, Inc. Telephone: 432-661-5369 e-mail address: bhcarne@latigopetro.com		
Address: 2121 French Drive Hobbs, New Mexico 88240		
Facility or well name: North Lusk 32 State #5 API #: 30-025-36982 Unit Letter (UL): M Qtr/Qtr: SW¼ SW¼ Section: 32, T18S, R32E		
County: Lea Latitude: N 32°41'54.82" Longitude: W 103°47'40.42" NAD: 1927 <input type="checkbox"/> 1983 <input type="checkbox"/> WGS 84 <input checked="" type="checkbox"/>		
Surface Owner: Federal <input type="checkbox"/> State <input checked="" type="checkbox"/> Private <input type="checkbox"/> Indian <input type="checkbox"/>		
Pit		Below-grade tank
Type: Drilling <input checked="" type="checkbox"/> Production <input type="checkbox"/> Disposal <input type="checkbox"/> Workover <input type="checkbox"/> Emergency <input type="checkbox"/>	Volume: bbl Type of fluid:	
Lined <input checked="" type="checkbox"/> Unlined <input type="checkbox"/>	Construction material:	
Liner type: Synthetic <input checked="" type="checkbox"/> Thickness 12 mil Clay <input type="checkbox"/>	Double-walled, with leak detection? Yes <input type="checkbox"/> If not, explain why not.	
Pit Volume: ~3,000 bbl		
Depth to ground water (vertical distance from bottom of pit to seasonal high water elevation of ground water.) greater than 100 feet or intermittent as evidenced by lack of wells within a one mile radius.	Less than 50 feet	(20 points) <input type="checkbox"/>
	50 feet or more, but less than 100 feet	(10 points) <input type="checkbox"/>
	100 feet or more	(0 points) <input checked="" type="checkbox"/>
Wellhead protection area: (Less than 200 feet from a private domestic water source, or less than 1000 feet from all other water sources.)	Yes	(20 points) <input type="checkbox"/>
	No	(0 points) <input checked="" type="checkbox"/>
Distance to surface water: (horizontal distance to all wetlands, playas, irrigation canals, ditches, and perennial and ephemeral watercourses.)	Less than 200 feet	(20 points) <input type="checkbox"/>
	200 feet or more, but less than 1,000 feet	(10 points) <input type="checkbox"/>
	1,000 feet or more	(0 points) <input checked="" type="checkbox"/>
Ranking Score (Total Points)		0

If this is a pit closure: (1) Attach a diagram of the facility showing the pit's relationship to other equipment and tanks. (2) Indicate disposal location: (check the onsite box if you are burying in place) onsite ☒ offsite ☐ If offsite, name of facility: (3) Attach a general description of remedial action taken including remediation start date and end date. (4) Groundwater encountered: No ☒ Yes ☐ If yes, show depth below ground surface _____ ft. and attach sample results.

(5) Attach soil sample results and a diagram of sample locations and excavations.

Additional Comments: It is proposed to close this pit consistent with the NMOCD Pit and Below-Grade Tank Guidelines, November 1, 2004 as promulgated under NMOCD Rule 50 (19.15.2.50 NMAC).

Pit Status: Liner intact ☒ Liner punctured or torn ☐

Method of Closure: A portion of the pit contents will be excavated and placed in a deep burial trench located east of and adjacent to the reserve pit. Prior to placing any drilling mud in the deep burial pit, the pit will be lined with a 12-mil liner with sufficient material left over to fold over the contents of the pit upon completion of transferring the mud. Upon the deep burial pit contents being stiffened as required, the edges of the liner will be folded over the edges of the stiffened mud and cuttings and the pit will be covered with a 20-mil thick impervious, reinforced synthetic or fabricated liner meeting ASTM standards that is designed to be resistant to the material encapsulated. The liner will then be covered with a minimum of three feet of clean soil or like material that is capable of supporting native plant growth. The remaining contents of the reserve pit will be stiffened and encapsulated on site. Encapsulation will consist of mixing earthen materials with the pit contents, as necessary to stiffen the pit contents sufficiently to provide physical stability and support the pit cover. Upon the pit contents being stiffened as required, the edges of the liner will be folded over the edges of the stiffened mud and cuttings and the pit will be covered with a 20-mil thick impervious, reinforced synthetic or fabricated liner meeting ASTM standards that is designed to be resistant to the material encapsulated. The liner will then be covered with a minimum of three feet of clean soil or like material that is capable of supporting native plant growth.

I hereby certify that the information above is true and complete to the best of my knowledge and belief. I further certify that the above-described pit or below-grade tank will be closed according to NMOCD guidelines ☒, a general permit ☒, or an (attached) alternative OCD-approved plan ☐.

Date: _____ Printed Name/Title Bill Hearne Signature _____

Your certification and NMOCD approval of this application/closure does not relieve the operator of liability should the contents of the pit or tank contaminate ground water or otherwise endanger public health or the environment. Nor does it relieve the operator of its responsibility for compliance with any other federal, state, or local laws and/or regulations.

Approval:

Printed Name/Title GARY W. WINK / STAFF MGR Signature Gary W. Wink 3/1/06



ENVIRONMENTAL PLUS, INC.
CONSULTING AND REMEDIAL CONSTRUCTION

7 February 2006

Mr. Larry Johnson, Environmental Engineer
New Mexico Energy, Minerals and Natural Resources Department
Oil Conservation Division Environmental Bureau
1625 North French
Hobbs, New Mexico 88240

Re: Initial C-144
Latigo Petroleum, Inc. North Lusk 32 State #5 (Ref. #110023)
UL-M, Section 32, Township 18 South, Range 32 East
Latitude: N 32°41'54.82" and Longitude: W 103°47'40.42"

Dear Mr. Johnson:

Environmental Plus, Inc. (EPI), on behalf of the Latigo Petroleum, Inc. (Latigo) submits the enclosed New Mexico Oil Conservation Division (NMOCD) form C-144 and supporting information. Latigo is proposing to close the drill pit at the above-referenced well site in accordance with the "NMOCD Pit and Below-Grade Tank Guidelines, November 1, 2004". Please direct all official communications to:

Latigo Petroleum, Inc.
Bill Hearne
2121 French Drive
Hobbs, New Mexico 88240
Telephone: (432) 661-5369
bhearne@latigopetro.com

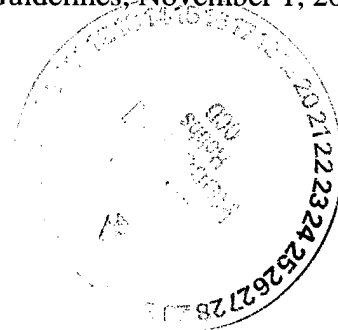

Should you have any questions or concerns, please feel free to contact me at (505) 394-3481 or via e-mail at iolness@envplus.net. Mr. Bill Hearne's contact information is listed above.

Sincerely,

ENVIRONMENTAL PLUS, INC.

Iain Olness, P.G.
Hydrogeologist

ENVIRONMENTAL PLUS, INC.



ENVIRONMENTAL PLUS, INC.
CONSULTING AND REMEDIAL CONSTRUCTION

cc: Bill Hearne, Latigo Petroleum, Inc. – Hobbs, NM
File

Enclosures: Topographical Map
Site Location Map
Site Map
Proposed Deep Burial Pit Location
Photographs
NMOCD Form C-144

ENVIRONMENTAL PLUS, INC.

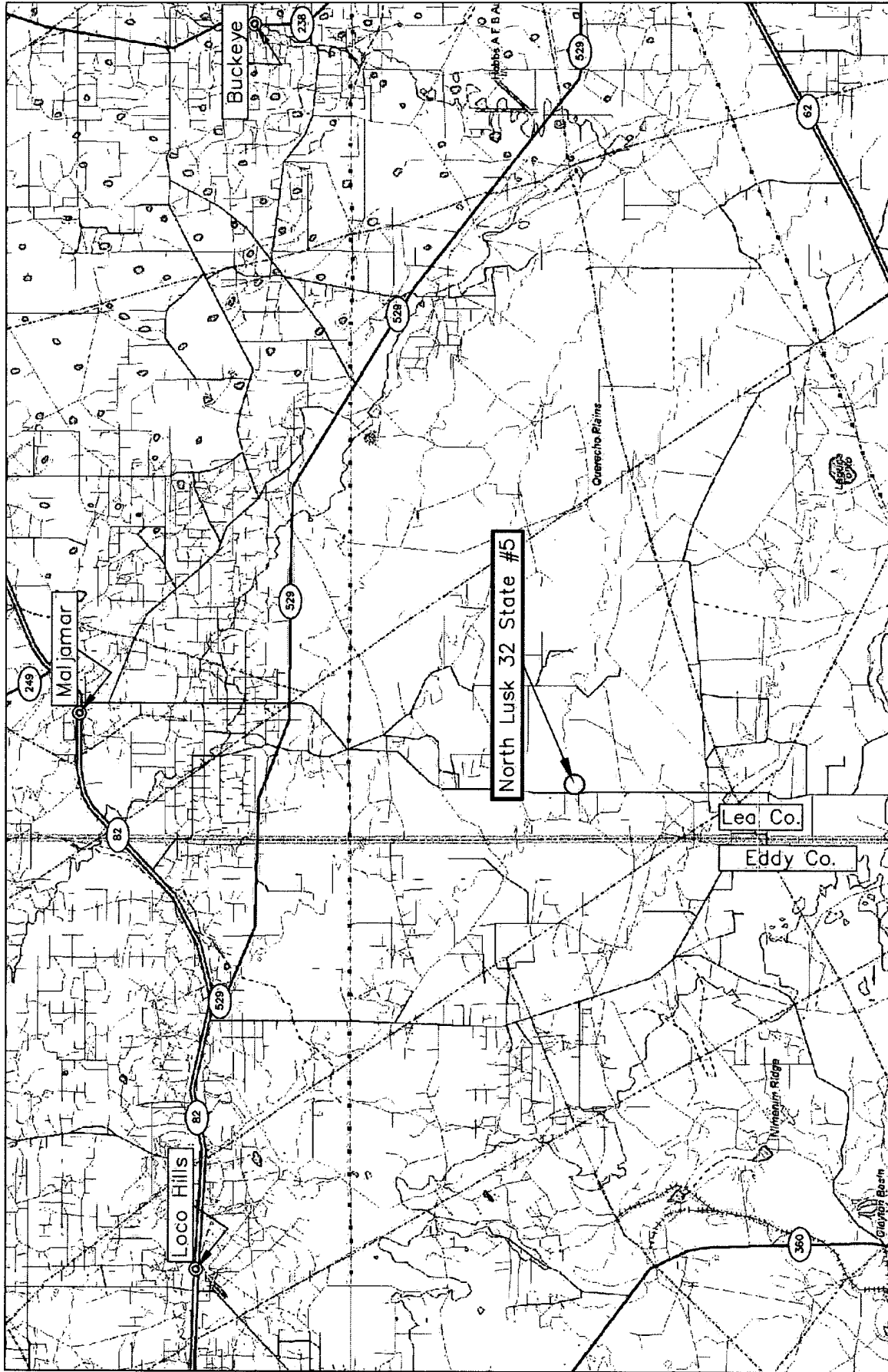

Figure 1
Area Map
Latigo Petroleum, Inc.
North Lusk 32 State #5

Lea County, New Mexico
SW 1/4 of the SW 1/4, Sec. 32, T18S, R32E
N 32° 41' 54.82" W 103° 47' 40.42"
Elevation: 3,676 feet amsl

DWG By: Daniel Dominguez
February 2006

REVISED:



SHEET
1 of 1

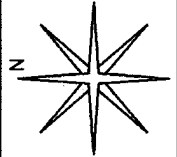

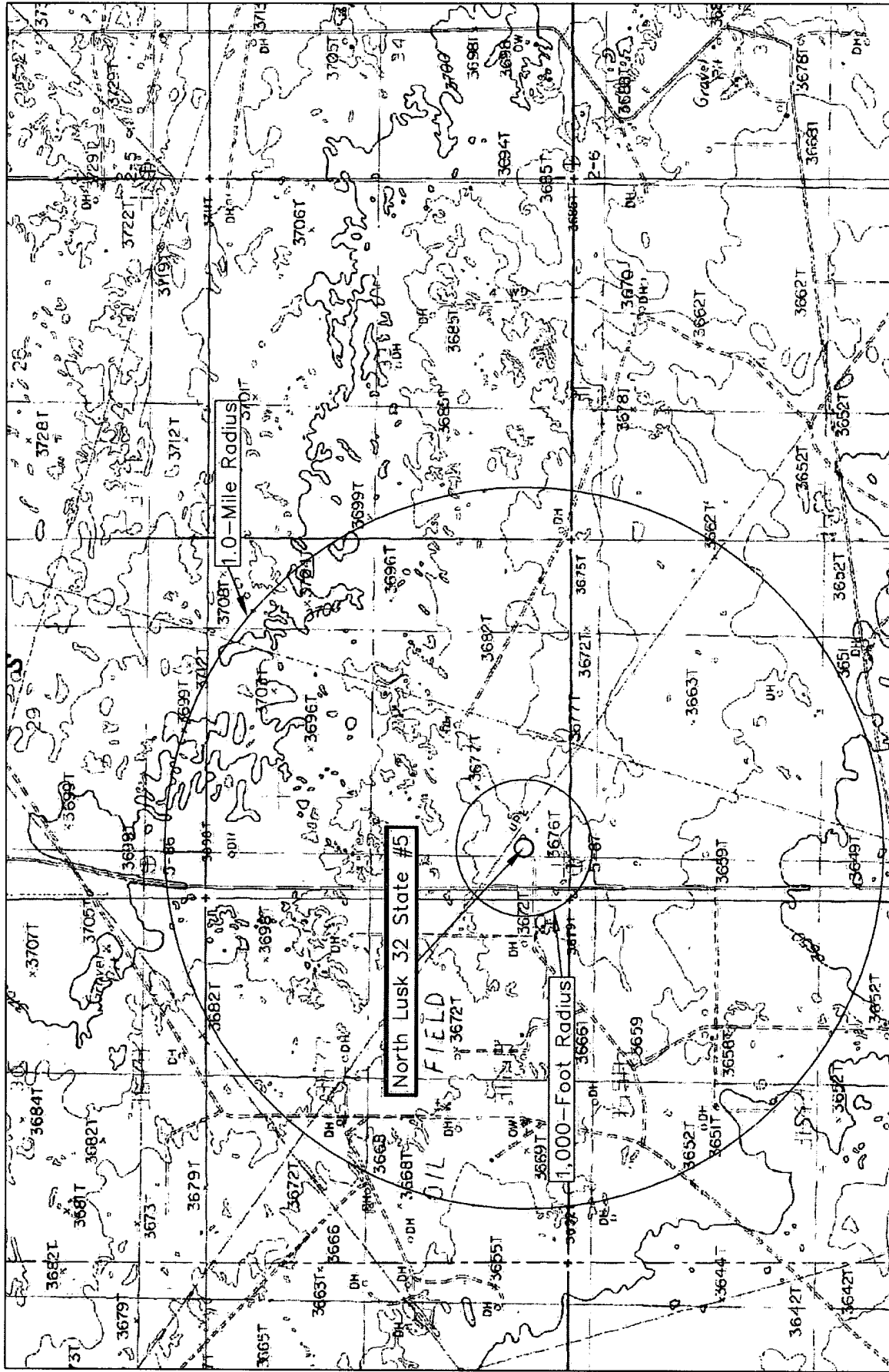

<p>Figure 2</p> <p>Site Location Map</p> <p>Latigo Petroleum, Inc.</p> <p>North Lusk 32 State #5</p>	<p>Lea County, New Mexico</p> <p>SW 1/4 of the SW 1/4, Sec. 32, T18S, R32E</p> <p>N 32° 41' 54.82" W 103° 47' 40.42"</p> <p>Elevation: 3,676 feet amsl</p>	<p>DWG By: Daniel Dominguez</p> <p>February 2006</p>	<p>REVISED:</p> <p>0 2,000 4,000 SHEET 1 of 1</p> <p>Feet</p> <p>North Arrow</p>
--	--	--	--

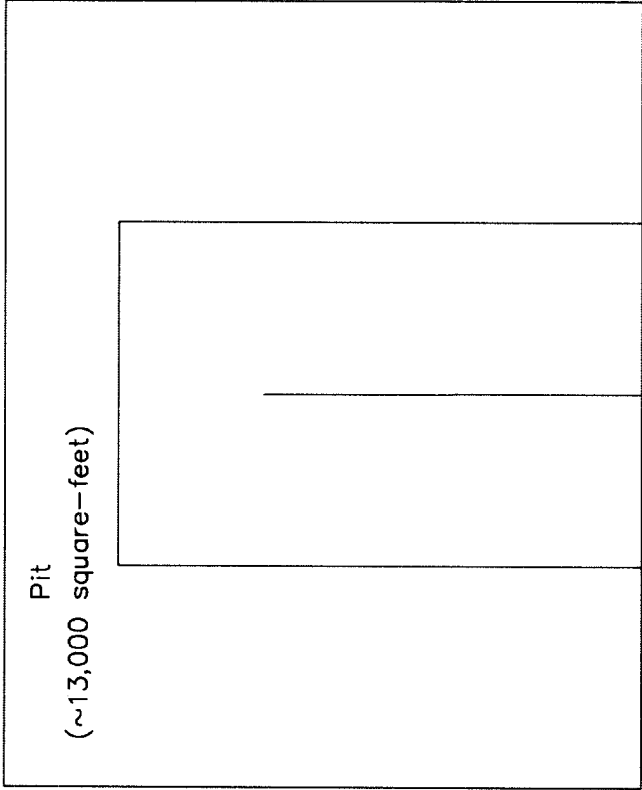

LEGEND



Oil Well

Figure 3
Site Map
Latigo Petroleum, Inc.
North Lusk 32 State #5

Lea County, New Mexico
SW 1/4 of the SW 1/4, Sec. 32, T18S, R32E
N 32° 41' 54.82" W 103° 47' 40.42"
Elevation: 3,676 feet amsl

DWG By: Daniel Dominguez
February 2006

REVISED:



70
SHEET
1 of 1

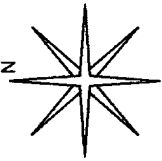

Proposed deep Burial Pit
(15' Wide X 125' Long X 15' Deep)

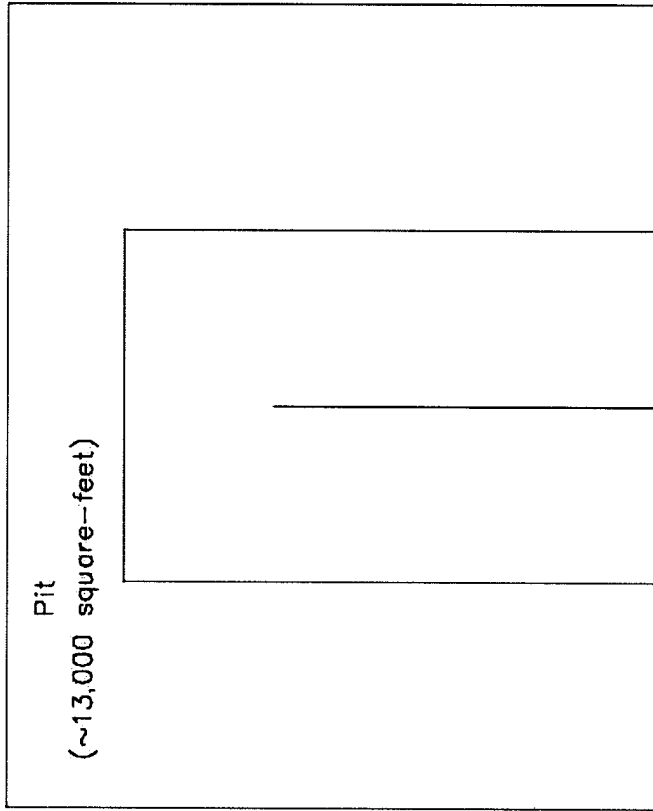

LEGEND



Oil Well

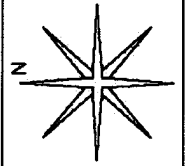

REvised:

DWG By: Daniel Dominguez
February 2006

SHEET
1 of 1

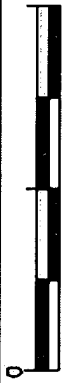

Lea County, New Mexico
SW 1/4 of the SW 1/4, Sec. 32, T18S, R32E
N 32° 41' 54.82" W 103° 47' 40.42"
Elevation: 3,676 feet amsl

Figure 4
Proposed Deep Burial Pit Location
Latigo Petroleum, Inc.
North Lusk 32 State #5

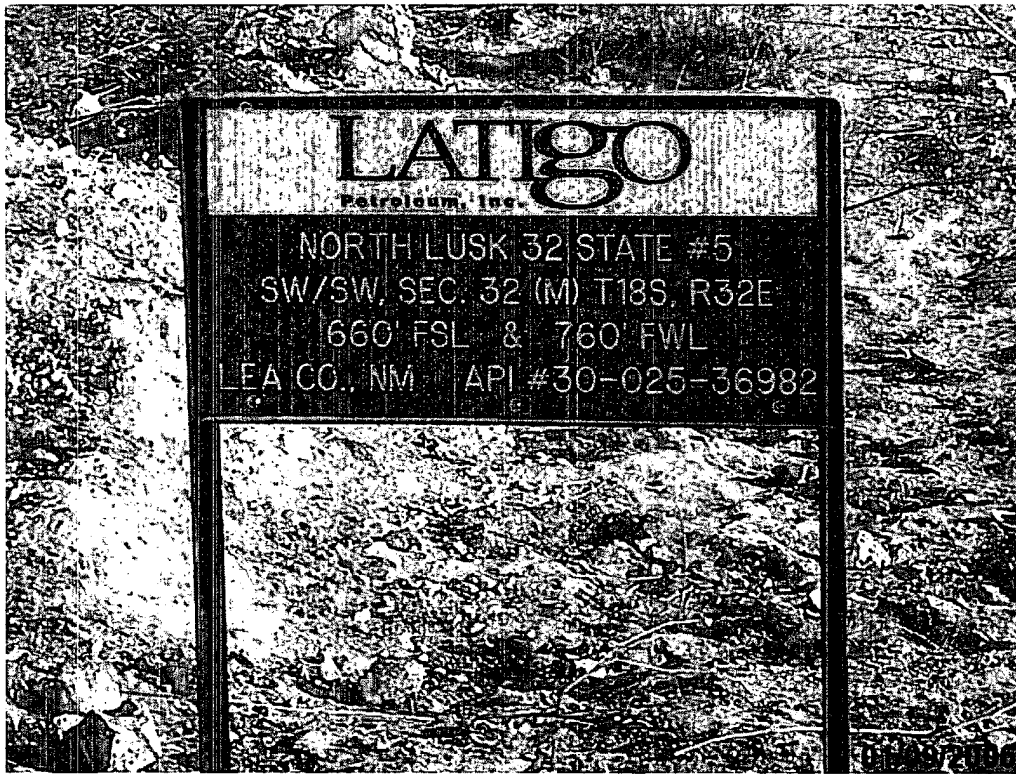

Photograph #1-Lease Sign.

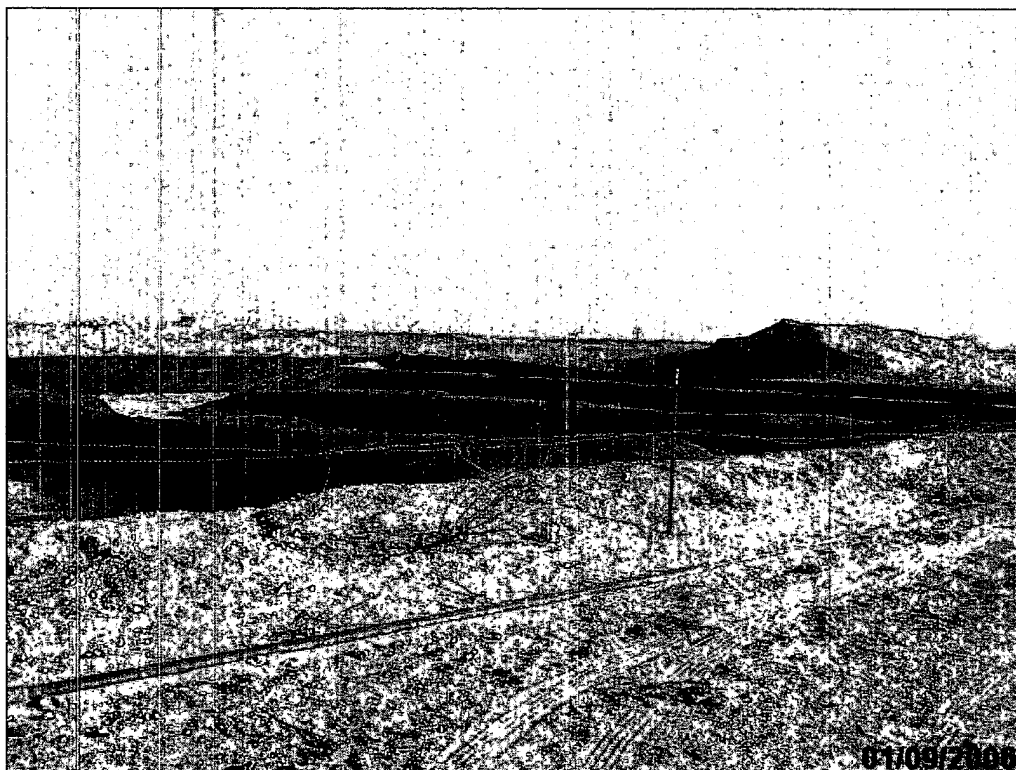

Photograph #2- Pit and berm, looking northeasterly.

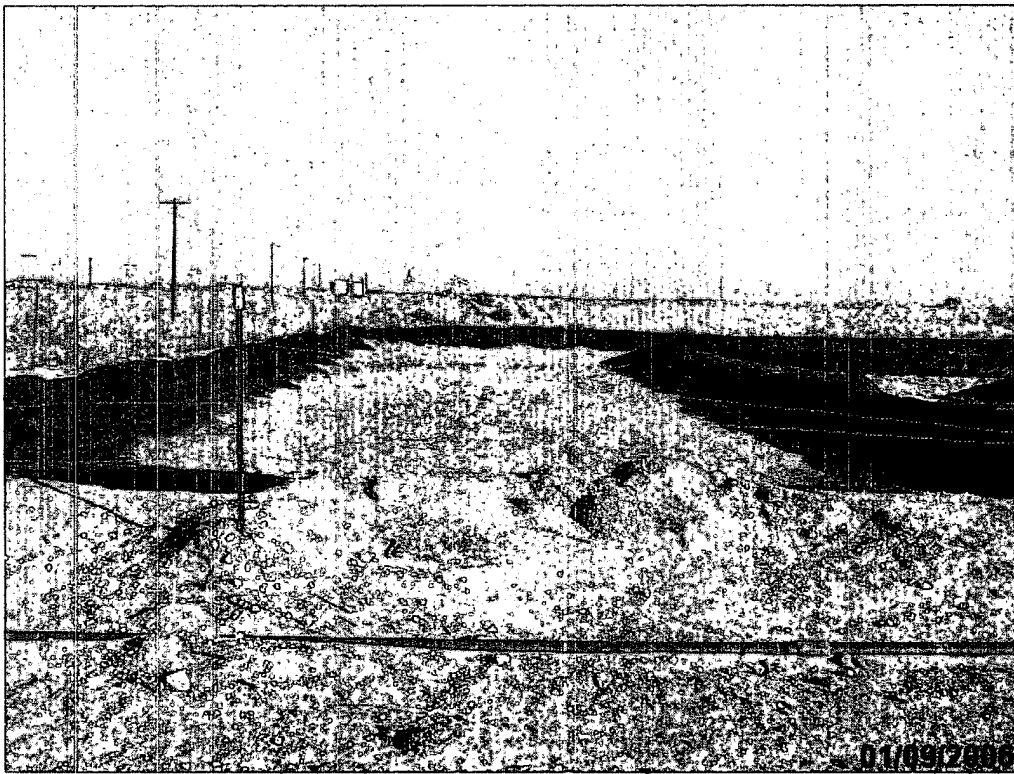

Photograph #3-Pit and berm, looking northerly.

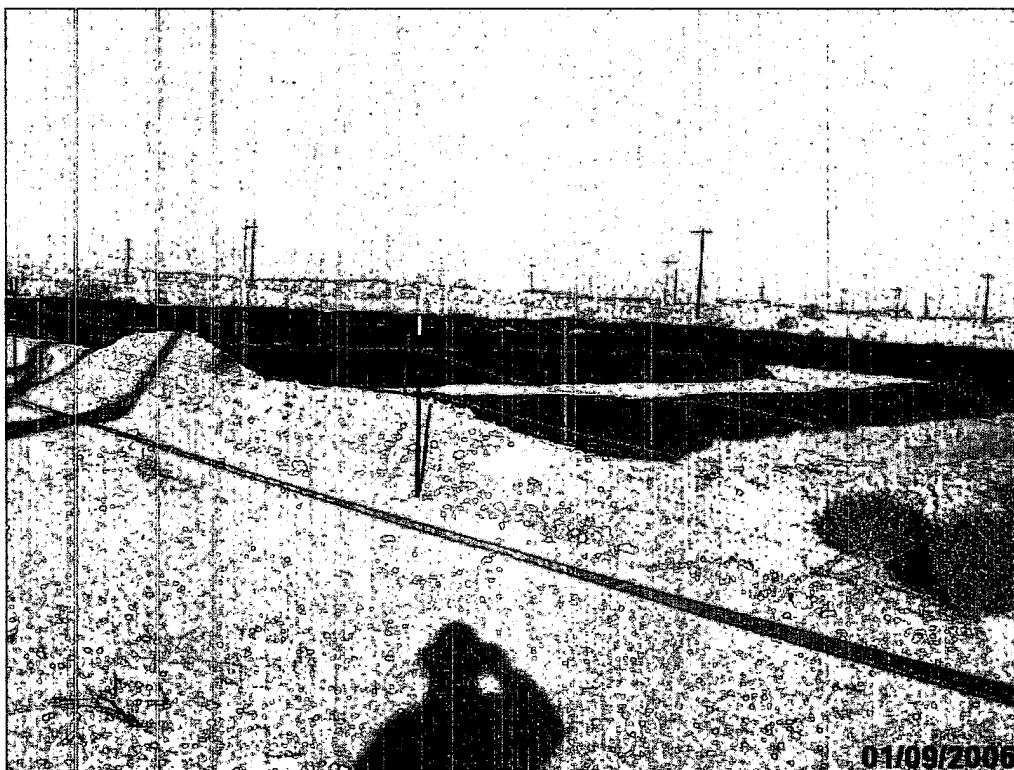

Photograph #4-Pit and berm, looking northwesterly.