



## **Occidental Permian Limited Partnership**

---

February 27, 2006

New Mexico Oil Conservation Division  
District I  
1625 N. French Drive  
Hobbs, New Mexico 88240

Attn: Environmental Engineering

RE: Final Drilling Pit Closure  
State 'A' #11y  
UL 'H', Sec. 29, T-18-S, R-38-E

This letter is being sent as final pit closure for the drilling pit at the above mentioned location. This pit will be closed as follows:

1. Drill cuttings and liner were removed from brine side of pit area.
2. Drill cuttings from the brine side of the pit were disposed of at Sundance Services, Parabo Facility near Eunice, New Mexico.
3. Drill cuttings from the fresh water side of the pit area were mixed with soil and deep buried on site.
4. All cuttings from fresh water pit area were encapsulated in a lined area.
5. Native soils, stored on site, were used for backfill of the area.
6. NMOCDD Pit and Below-Grade Tank Guidelines, dated 11-01-2004, were used for pit closure compliance.
7. Start date on drill cutting removal was 12/15/2005.
8. Work was completed on 01/28/2006.
9. A final form C-144 is attached.

If you have any questions, or if I can be of further assistance, please contact me at (505) 397-8251.

A handwritten signature in black ink that reads "Steven M. Bishop".

Steven M. Bishop  
HES Technician/Hobbs RMT  
Steven\_Bishop@oxy.com  
(505) 397-8251

Attachments: Form C-144  
Diagram of pit and well location

District I  
1625 N. French Dr., Hobbs, NM 88240  
District II  
1301 W. Grand Avenue, Artesia, NM 88210  
District III  
1000 Rio Brazos Road, Aztec, NM 87410  
District IV  
1220 S. St. Francis Dr., Santa Fe, NM 87505

State of New Mexico  
Energy Minerals and Natural Resources

Oil Conservation Division  
1220 South St. Francis Dr.  
Santa Fe, NM 87505

Form C-144  
March 12, 2004

For drilling and production facilities, submit to appropriate NMOCD District Office.  
For downstream facilities, submit to Santa Fe office

**Pit or Below-Grade Tank Registration or Closure**

Is pit or below-grade tank covered by a "general plan"? Yes ☐ No ☒

Type of action: Registration of a pit or below-grade tank ☐ Closure of a pit or below-grade tank ☒

Operator: Oxy USA WTP Limited Partnership Telephone: 505.397.8251 e-mail address: Steven\_Bishop@oxy.com

Address: 1017 W. Stanolind Road, Hobbs, NM 88240

Facility or well name: State A # 11 API #: 30-025-37349 U/L P Sec 29 T 18-S R 38-E

County: Lea Latitude 32°42'54.36" N Longitude 103°09'59.49" W NAD: 1927 ☒ 1983 ☐ Surface Owner Federal ☐ State ☒ Private ☒ Indian ☐

**Pit**

Type: Drilling ☒ Production ☐ Disposal ☐

Workover ☐ Emergency ☐

Lined ☒ Unlined ☐

Liner type: Synthetic ☒ Thickness 12 mil Clay ☐ Volume 8,000 bbl

**Below-grade tank**

Volume: bbl Type of fluid:

Construction material:

Double-walled, with leak detection? Yes ☐ If not, explain why not.

Depth to ground water (vertical distance from bottom of pit to seasonal high water elevation of ground water.)

Less than 50 feet

(20 points)

50 feet or more, but less than 100 feet

(10 points) 10

100 feet or more

( 0 points)

Wellhead protection area: (Less than 200 feet from a private domestic water source, or less than 1000 feet from all other water sources.)

Yes

(20 points) 0

No

( 0 points)

Distance to surface water: (horizontal distance to all wetlands, playas, irrigation canals, ditches, and perennial and ephemeral watercourses.)

Less than 200 feet

(20 points)

200 feet or more, but less than 1000 feet

(10 points)

1000 feet or more

( 0 points) 0

**Ranking Score (Total Points)**

10

**If this is a pit closure:** (1) attach a diagram of the facility showing the pit's relationship to other equipment and tanks. (2) Indicate disposal location:

onsite ☐ offsite ☒ If offsite, name of facility Sundance Services, Parabo Facility. (3) Attach a general description of remedial action taken including remediation start date

and end date. (4) Groundwater encountered: No ☒ Yes ☐ If yes, show depth below ground surface ft. and attach sample results. (5) Attach soil sample results and a diagram of sample locations and excavations.

I hereby certify that the information above is true and complete to the best of my knowledge and belief. I further certify that the above-described pit or below-grade tank has been/will be constructed or closed according to NMOCD guidelines ☒, a general permit ☐, or an (attached) alternative OCD-approved plan ☐.

Date: 02/27/2006

Printed Name/Title Steven M. Bishop HES Spec.

Signature

*Steven M. Bishop*

Your certification and NMOCD approval of this application/closure does not relieve the operator of liability should the contents of the pit or tank contaminate ground water or otherwise endanger public health or the environment. Nor does it relieve the operator of its responsibility for compliance with any other federal, state, or local laws and/or regulations

Approval:

Date: 3/2/06

Printed Name/Title GARY W. WINK STAFF MGR.

Signature

*Gary W. Wink*

State A #11y

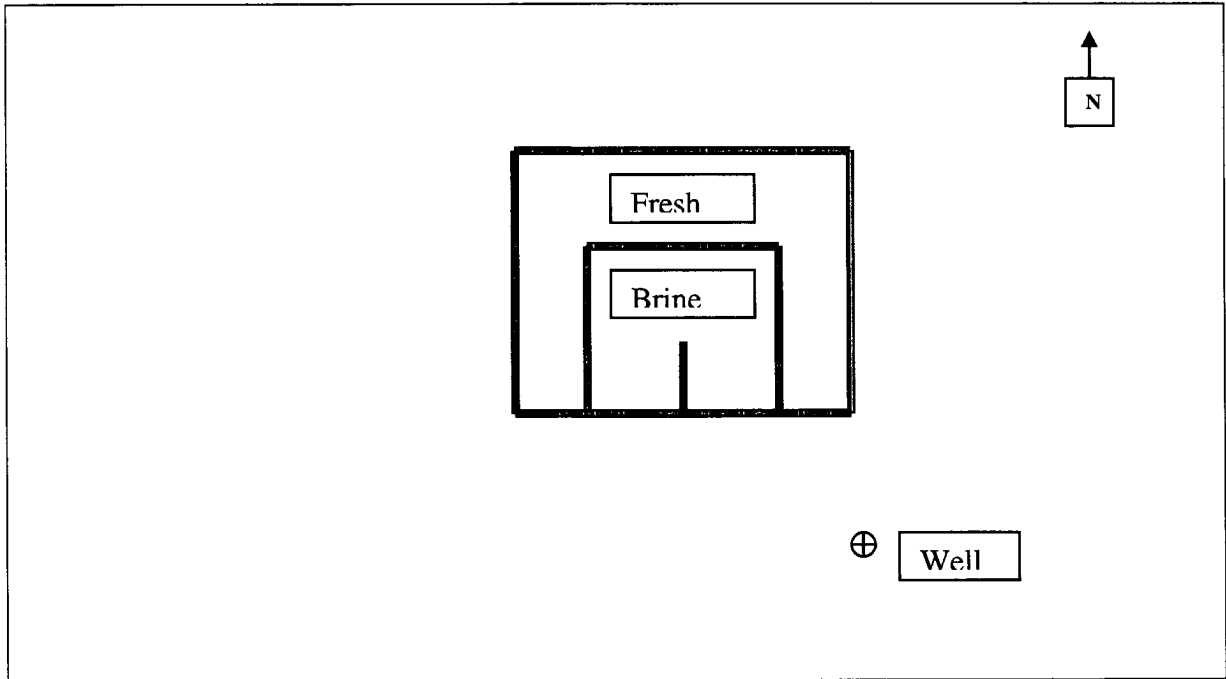

Occidental Permian Ltd.

State A #11y

API #30-025-37349

Unit Letter 'F', Section 29, T-18-S, R-38-E

Long N 32°42'54.36" Lat W 103°09'59.49"

100' X 100' Pit 80' North of Wellhead