

District I
1625 N. French Dr., Hobbs, NM 88240
District II
1301 W. Grand Avenue, Artesia, NM 88210
District III
1000 Rio Brazos Road, Aztec, NM 87410
District IV
1220 S. St. Francis Dr., Santa Fe, NM 87505

State of New Mexico
Energy Minerals and Natural Resources

Form C-101
May 27, 2004

Oil Conservation Division
1220 South St. Francis Dr.
Santa Fe, NM 87505

Submit to appropriate District Office

☐ AMENDED REPORT

APPLICATION FOR PERMIT TO DRILL, RE-ENTER, DEEPEN, PLUGBACK, OR ADD A ZONE

| | | |
|---|---|---|
| ¹ Operator Name and Address POGO PRODUCING COMPANY P.O. BOX 10340 MIDLAND, TEXAS 79702-7340 | | ² OGRID Number 17891 ³ API Number 30 - 005-27945 |
| ⁴ Property Code 35493 | ⁵ Property Name HOMINY "36" STATE | ⁶ Well No. 1 |
| ⁷ Proposed Pool 1 WILDCAT-DEVONIAN | | ⁸ Proposed Pool 2 |

⁷ Surface Location

| UL or lot no. | Section | Township | Range | Lot Idn. | Feet from the | North-South line | Feet from the | East/West line | County |
|---------------|---------|----------|-------|----------|---------------|------------------|---------------|----------------|--------|
| 0 | 36 | 15S | 31E | | 660' | South | 2310' | EAST | CHAVES |

⁸ Proposed Bottom Hole Location If Different From Surface

| UL or lot no. | Section | Township | Range | Lot Idn. | Feet from the | North-South line | Feet from the | East/West line | County |
|---------------|---------|----------|-------|----------|---------------|------------------|---------------|----------------|--------|
| | | | | | | | | | |

Additional Well Information

| | | | | |
|---|---|---|---------------------------------------|---|
| ⁹ Work Type Code N | ¹⁰ Well Type Code O | ¹¹ Cable/Rotary ROTARY | ¹² Lease Type Code S | ¹³ Ground Level Elevation 4355' |
| ¹⁴ Multiple NO | ¹⁵ Proposed Depth 14,000' | ¹⁶ Formation DEVONIAN | ¹⁷ Contractor PATTERSON | ¹⁸ Spud Date WHEN APPROVED |
| Depth to Groundwater 65' + | | Distance from nearest fresh water well 2 Miles | | Distance from nearest surface water Playa lake 1500' North |
| Pir. Liner: Synthetic <input checked="" type="checkbox"/> 12 mils thick Clay <input type="checkbox"/> Pit Volume: 20M bbls Drilling Method: Closed-Loop System <input type="checkbox"/> Fresh Water <input checked="" type="checkbox"/> Brine <input checked="" type="checkbox"/> Diesel/Oil-based <input type="checkbox"/> Gas/Air <input type="checkbox"/> | | | | |

²¹ Proposed Casing and Cement Program

| Hole Size | Casing Size | Casing weight/foot | Setting Depth | Sacks of Cement | Estimated TOC |
|-----------|-------------|--------------------|---------------|-----------------|---------------|
| 26" | 20" | Conductor | 40' | Redi-mix | Surface |
| 17 1/2" | 13 3/8" | 48# | 800' | 800 Sx. | Surface |
| 11" | 9 5/8" | 40# | 4500' | 1200 Sx. | surface |
| 8 1/2"* | 5 1/2" | 17# | 14,000' | 1200 Sx. 2stage | Surface |

²² Describe the proposed program. If this application is to DEEPEN or PLUG BACK, give the data on the present productive zone and proposed new productive zone. Describe the blowout prevention program, if any. Use additional sheets if necessary.

Permit Expires 1 Year From Approval
Date Unless Drilling Underway

* If no lost circulation or other hole problems occur above 10,900' reduce hole to 7 7/8" and continue to drill to TD.

SEE ATTACHED SHEET

Conditions of approval
may not produce well
until NSL is obtained

| | | | |
|--|---------------------|--|--|
| ²³ I hereby certify that the information given above is true and complete to the best of my knowledge and belief. I further certify that the drilling pit will be constructed according to NMOCD guidelines <input checked="" type="checkbox"/> a general permit <input type="checkbox"/> or an (attached) alternative OCD-approved plan <input type="checkbox"/> . | | OIL CONSERVATION DIVISION | |
| Printed name: Joe T. Janica | | Approved by: <i>Paul H. Kautz</i> | |
| Title: Agent | | Title: PETROLEUM ENGINEER | |
| E-mail Address: joejanica@valornet.com | | Approval Date: MAR 23 2006 Expiration Date: | |
| Date: 03/22/06 | Phone: 505-391-8503 | Conditions of Approval Attached <input type="checkbox"/> | |

POGO PRODUCING COMPANY
HOMINY "36" STATE #1
UNIT "O" SECTION 36
T15S-R31E CHAVES CO. NM

1. Drill 26" hole to 40'. Set 40' of 20" conductor pipe and cement to surface with Redi-mix.
2. Drill 17½" hole to 800' with fresh water. Run and set 800' of 13 3/8" 48# H-40 ST&C casing. Cement with 600 Sx. of 65/35/6 Class "C" POZ/GEL, tail in with 200 Sx. of Class "C" cement, circulate cement to surface.
3. Drill 11" hole to 4500' with brine water. Run and set 4500' of 9 5/8" 40# N-08 ST&C casing. Cement with 1000 Sx. of 65/35/6 Class "C" POZ/GEL, + 5% Salt, tail in with 200 Sx. of Class "C" cement + 2% CaCl, + ¼# Flocale/Sx., circulate cement to surface. Nipple up 3000 PSI WP B.O.P. prior to drilling out cement on surface casing.
4. Nipple up 5000 PSI WP B.O.P. on 9 5/8" casing. Drill 8½" hole with cut Brine, mud up at 10,000' with Salt Gel and Starch to control water loss and drill to 10,900' if no lost circulation problems occur reduce hole to 7 7/8" and drill to 14,000'. Run and set 14,000' of 5½" 17# P-110 LT&C,BTC. Cement in two stages with DV Tool at 8000'±. Cement 1st stage with 650 Sx. of Class "H" Premium Plus cement + additives, cement 2nd stage with 600 Sx. of Class "C" cement with 8# of Gilsonite/Sx. circulate cement to surface. Volumes of cement may be altered after caliper and/or fluid caliper is run.

DISTRICT I

1625 N. FRENCH DR., HOBBBS, NM 88240

DISTRICT II

1301 W. GRAND AVENUE, ARTESIA, NM 88210

DISTRICT III

1000 Rio Brazos Rd., Aztec, NM 87410

DISTRICT IV

1220 S. ST. FRANCIS DR., SANTA FE, NM 87505

State of New Mexico

Energy, Minerals and Natural Resources Department

OIL CONSERVATION DIVISION
1220 SOUTH ST. FRANCIS DR.
Santa Fe, New Mexico 87505

Form C-102

Revised October 12, 2005

Submit to Appropriate District Office

State Lease - 4 Copies

Fee Lease - 3 Copies

WELL LOCATION AND ACREAGE DEDICATION PLAT

☐ AMENDED REPORT

| | | |
|-----------------------------------|--|--------------------------------------|
| API Number 30-005-27945 | Pool Code / | Pool Name WILDCAT-DEVONIAN |
| Property Code 35493 | Property Name HOMINY 36 STATE | Well Number 1 |
| OGRID No. 017891 | Operator Name POGO PRODUCING COMPANY | Elevation 4355' |

Surface Location

| UL or lot No. | Section | Township | Range | Lot Idn | Feet from the | North/South line | Feet from the | East/West line | County |
|---------------|---------|----------|-------|---------|---------------|------------------|---------------|----------------|--------|
| 0 | 36 | 15-S | 31-E | | 660 | SOUTH | 2310 | EAST | CHAVES |

Bottom Hole Location If Different From Surface

| UL or lot No. | Section | Township | Range | Lot Idn | Feet from the | North/South line | Feet from the | East/West line | County |
|------------------------|-----------------|--------------------|-----------|---------|---------------|------------------|---------------|----------------|--------|
| | | | | | | | | | |
| Dedicated Acres 320 | Joint or Infill | Consolidation Code | Order No. | | | | | | |

NO ALLOWABLE WILL BE ASSIGNED TO THIS COMPLETION UNTIL ALL INTERESTS HAVE BEEN CONSOLIDATED
OR A NON-STANDARD UNIT HAS BEEN APPROVED BY THE DIVISION

| | |
|---|---|
| <p>GEODETIC COORDINATES NAD 27 NME</p> <p>Y=715931.5 N X=671711.7 E</p> <p>LAT.=32°58'00.88" N LONG.=103°46'24.47" W</p> <p>2310'</p> <p>699'</p> | <p>OPERATOR CERTIFICATION</p> <p>I hereby certify that the information herein is true and complete to the best of my knowledge and belief, and that this organization either owns a working interest or unleased mineral interest in the land including the proposed bottom hole location or has a right to drill this well at this location pursuant to a contract with an owner of such mineral or working interest, or to a voluntary pooling agreement or a compulsory pooling order heretofore entered by the Division.</p> <p><i>Joe T. Janica</i> 03/22/06 Signature Date</p> <p>Joe T. Janica Agent Printed Name</p> |
| | <p>SURVEYOR CERTIFICATION</p> <p>I hereby certify that the well location shown on this plat was plotted from field notes of actual surveys made by me or under my supervision, and that the same is true and correct to the best of my belief.</p> <p>MARCH 21, 2006</p> <p>Date Surveyed LA</p> <p>Signature & Seal of Professional Surveyor <i>GARY EIDSON</i> 3/22/06 06.11.05245</p> <p>Certificate No. GARY EIDSON 12641</p> |

MAR-22-2006 02:56 PM TIERRA EXPLORATION

3918603

P. 02

DISTRICT I

1625 N. FRENCH DR., BOHEM, NM 87400

State of New Mexico

Energy, Minerals and Natural Resources Department

DISTRICT II

1201 E. GRAND AVENUE, ALBUQUERQUE, NM 87216

OIL CONSERVATION DIVISION

1220 SOUTH ST. FRANCIS DR.

Santa Fe, New Mexico 87505

DISTRICT III

1000 Rio Grande Rd., Artes, NM 87410

Form C-102

Revised October 12, 2005

Submit to Appropriate District Office

State Lease - 4 Copies

Fee Lease - 3 Copies

DISTRICT IV

1220 S. ST. FRANCIS DR., SANTA FE, NM 87505

WELL LOCATION AND ACREAGE DEDICATION PLAT

☐ AMENDED REPORT

| | | |
|---------------|------------------------|--------------------|
| API Number | Pool Code | Pool Name |
| | | Wildcat - Devonian |
| Property Code | Property Name | Well Number |
| | HOMINY 36 STATE | 1 |
| OCRID No. | Operator Name | Elevation |
| 017891 | POGO PRODUCING COMPANY | 4355' |

Surface Location

| UL or lot No. | Section | Township | Range | Lot Idn | Feet from the | North/South line | Feet from the | East/West line | County |
|---------------|---------|----------|-------|---------|---------------|------------------|---------------|----------------|--------|
| 0 | 36 | 15-S | 31-E | | 660 | SOUTH | 2310 | EAST | CHAVES |

Bottom Hole Location If Different From Surface

| UL or lot No. | Section | Township | Range | Lot Idn | Feet from the | North/South line | Feet from the | East/West line | County |
|-----------------|---------|-----------------|-------|--------------------|---------------|------------------|---------------|----------------|--------|
| | | | | | | | | | |
| Dedicated Acres | | Joint or Infill | | Consolidation Code | | Order No. | | | |
| 40 | | | | | | | | | |

NO ALLOWABLE WILL BE ASSIGNED TO THIS COMPLETION UNTIL ALL INTERESTS HAVE BEEN CONSOLIDATED
OR A NON-STANDARD UNIT HAS BEEN APPROVED BY THE DIVISION

| | |
|---|---|
| <p>GEODETIC COORDINATES NAD 27 NME</p> <p>Y=715931.5 N X=571711.7 E</p> <p>LAT.=32°58'00.88" N LONG.=103°46'24.47" W</p> <p>2310'</p> <p>560'</p> | <p>OPERATOR CERTIFICATION</p> <p>I hereby certify that the information herein is true and complete to the best of my knowledge and belief, and that this organization either owns a working interest or undivided mineral interest in the land including the proposed bottom hole location or has a right to drill this well at this location pursuant to a contract with an owner of such mineral or working interest, or to a voluntary pooling agreement or a compulsory pooling order heretofore entered by the division.</p> <p><i>Cathy Wright</i> 3/23/06 Signature Date</p> <p>Cathy Wright Printed Name</p> |
| | <p>SURVEYOR CERTIFICATION</p> <p>I hereby certify that the well location shown on this plat was plotted from field notes of actual surveys made by me or under my supervision, and that the same is true and correct to the best of my belief.</p> <p>MARCH 21, 2006</p> <p>Date Surveyed LA</p> <p>Signature of Professional Surveyor</p> <p><i>Darryl G. Edson</i> 3/23/06 06-11-0524</p> <p>Certification No. 12841</p> |
| | |
| | |

SECTION 36, TOWNSHIP 15 SOUTH, RANGE 31 EAST, N.M.P.M.,
 CHAVES COUNTY, NEW MEXICO

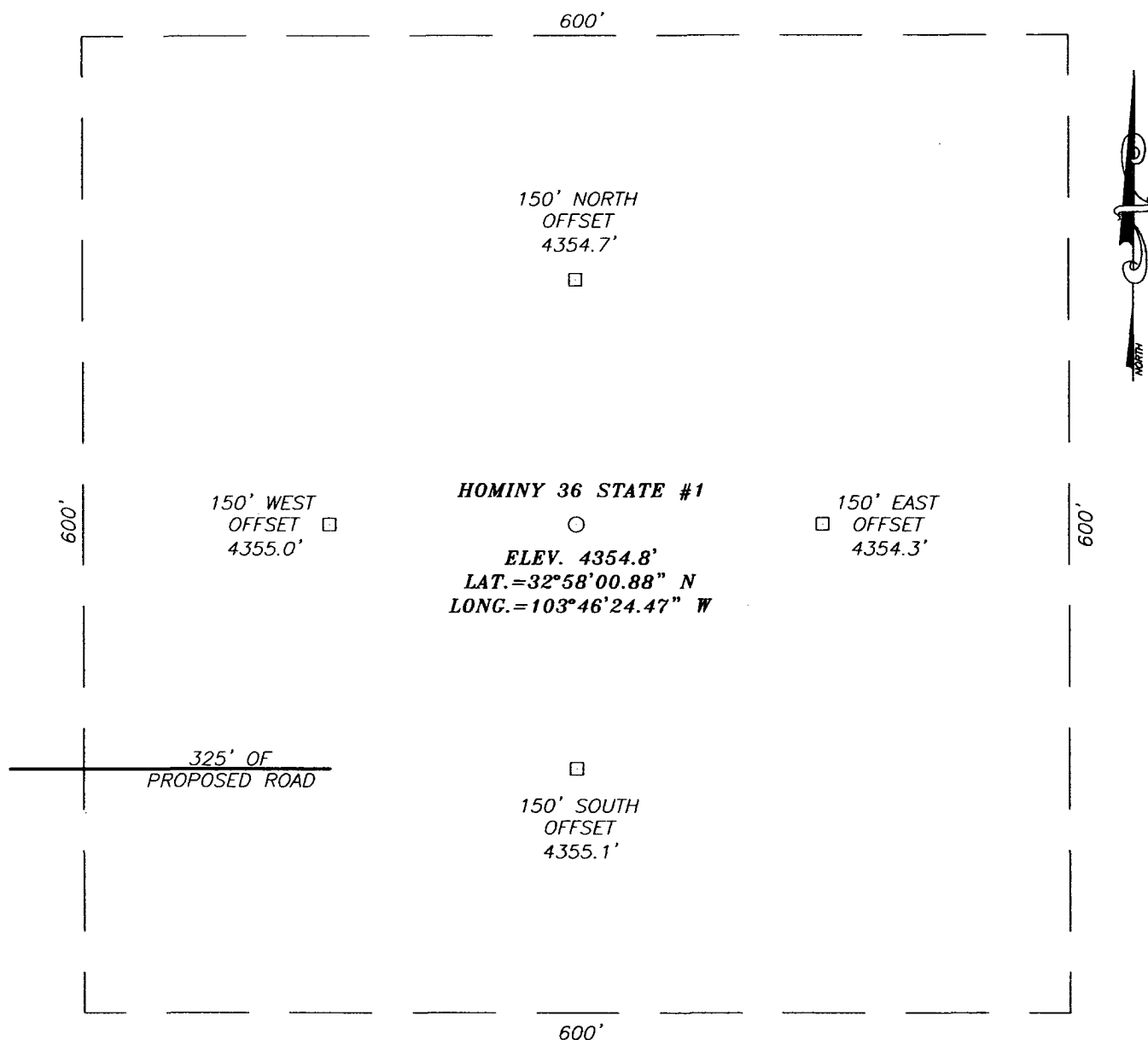

DIRECTIONS TO LOCATION

FROM INTERSECTION OF ST. HWY. 243 AND CO. RD. L121 (MENDEL RD.) GO EAST ON CO. RD. L121 FOR APPROX. 1.3 MILES. TURN LEFT AND GO NORTH APPROX. 0.1 MILES. TURN RIGHT ONTO EXISTING LEASE ROAD AND GO 0.1 MILES TO EXISTING WELL. PROPOSED LOCATION IS APPROX. 475' EAST.

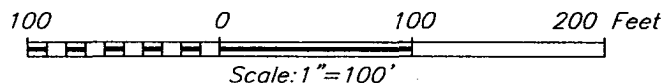

POGO PRODUCING COMPANY

HOMINY 36 STATE #1 WELL
 LOCATED 660 FEET FROM THE SOUTH LINE
 AND 2310 FEET FROM THE EAST LINE OF SECTION 36,
 TOWNSHIP 15 SOUTH, RANGE 31 EAST, N.M.P.M.,
 CHAVES COUNTY, NEW MEXICO.

| | |
|-------------------------|---------------------|
| Survey Date: 3/21/06 | Sheet 1 of 1 Sheets |
| W.O. Number: 06.11.0524 | Dr By: L.A |
| Date: 3/22/06 | Disk: CD#5 |
| 06110524 | Scale: 1"=100' |

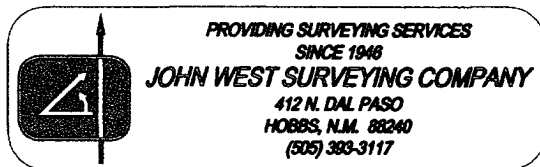

VICINITY MAP

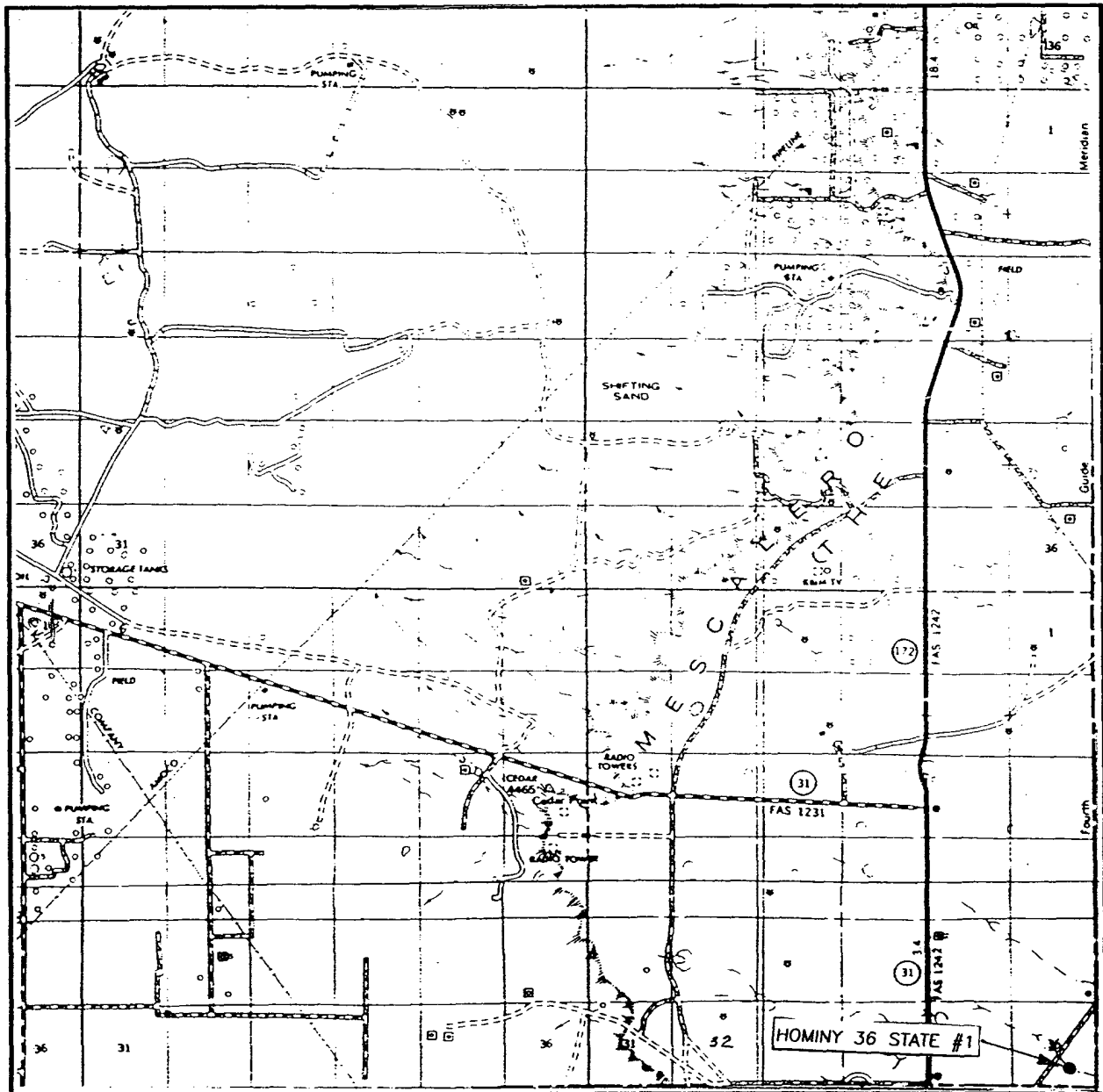

SCALE: 1" = 2 MILES

SEC. 36 TWP. 15-S RGE. 31-E

SURVEY N.M.P.M.

COUNTY CHAVES STATE NEW MEXICO

DESCRIPTION 660' FSL & 2310' FEL

ELEVATION 4355'

POGO
OPERATOR PRODUCING COMPANY

LEASE HOMINY 36 STATE

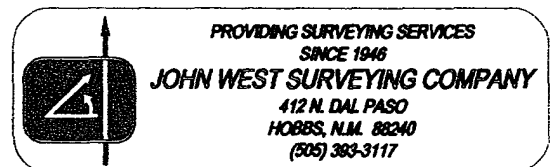

LOCATION VERIFICATION MAP

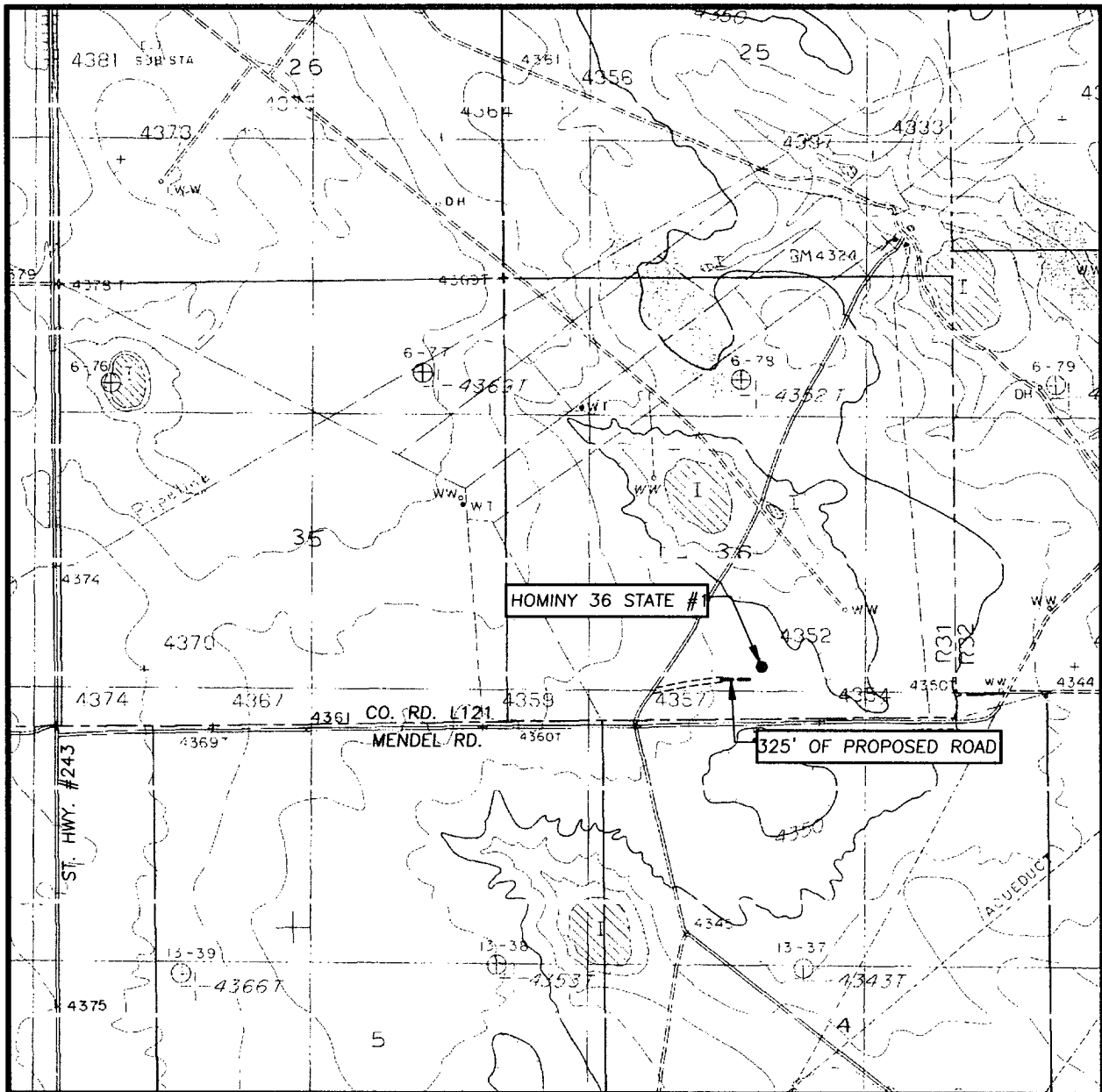

SCALE: 1" = 2000'

CONTOUR INTERVAL:
MALJAMAR NE., N.M. - 10'
SUPPLEMENTAL - 5'

SEC. 36 TWP. 15-S RGE. 31-E

SURVEY N.M.P.M.

COUNTY CHAVES STATE NEW MEXICO

DESCRIPTION 660' FSL & 2310' FEL

ELEVATION 4355'

OPERATOR POGO PRODUCING COMPANY

LEASE HOMINY 36 STATE

U.S.G.S. TOPOGRAPHIC MAP
MALJAMAR NE., N.M.

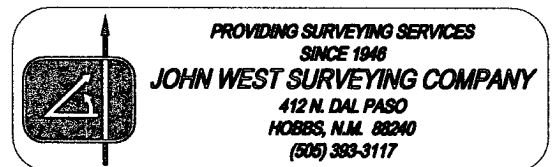

BLOWOUT PREVENTER SYSTEM

5000 PSI

Choke Manifold Assembly for 5M WP System

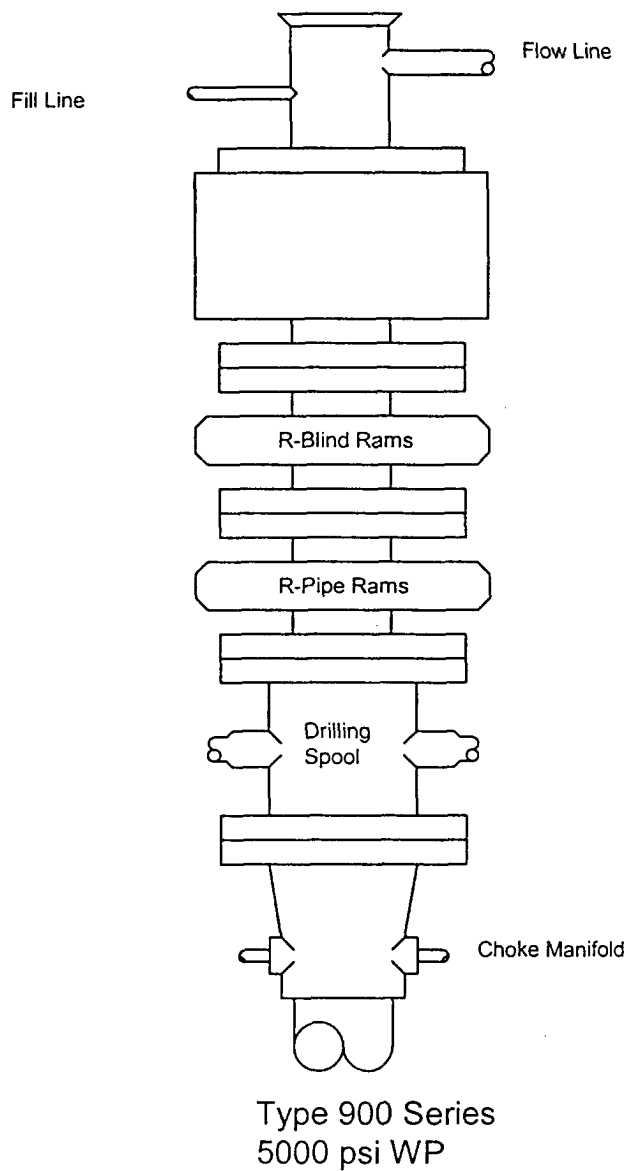
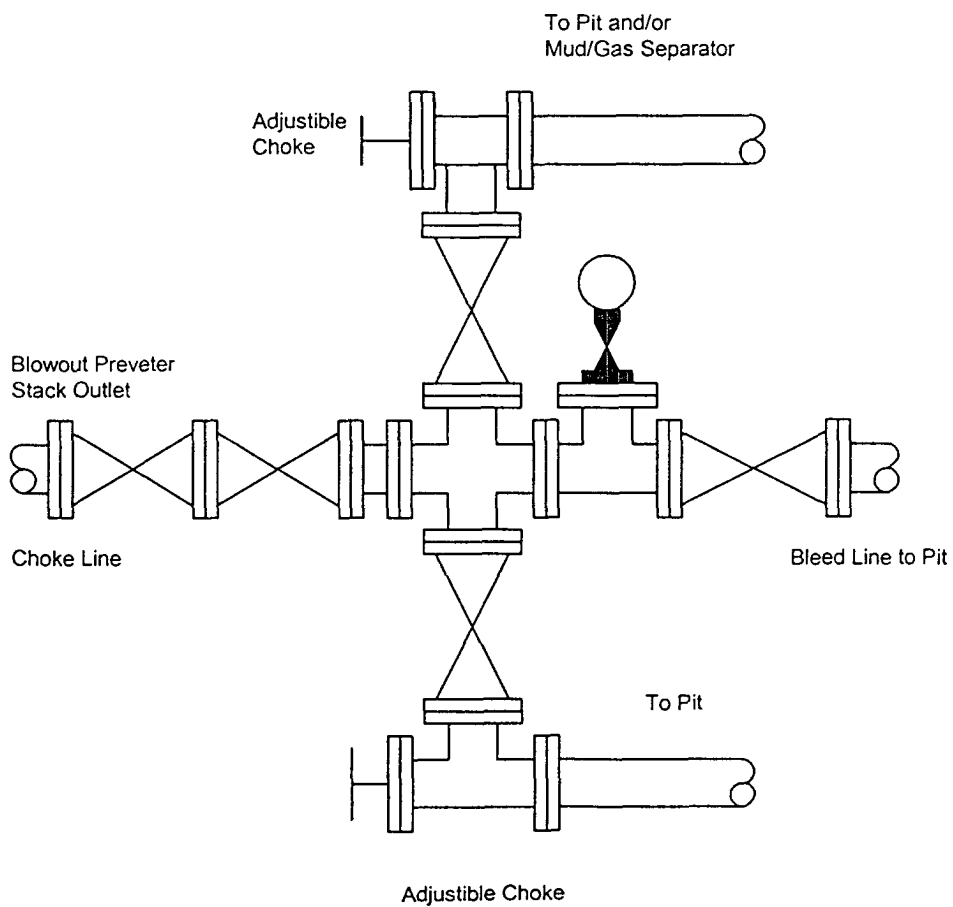

BLOWOUT PREVENTER SYSTEM

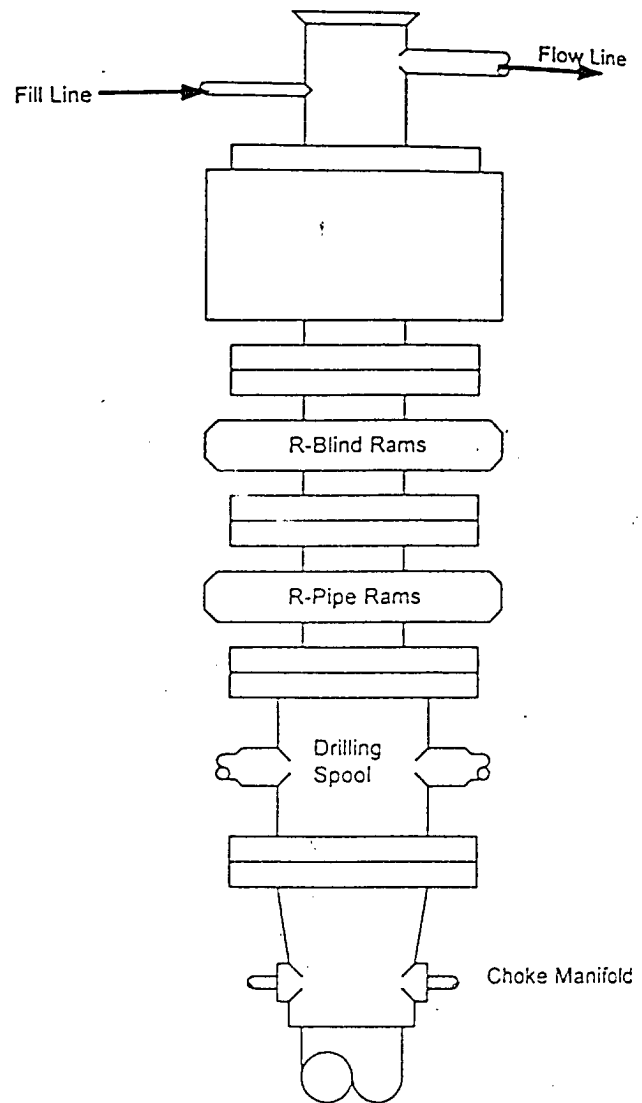

Type 900 Series
3000 psi WP

Choke Manifold Assembly for 3M WP System

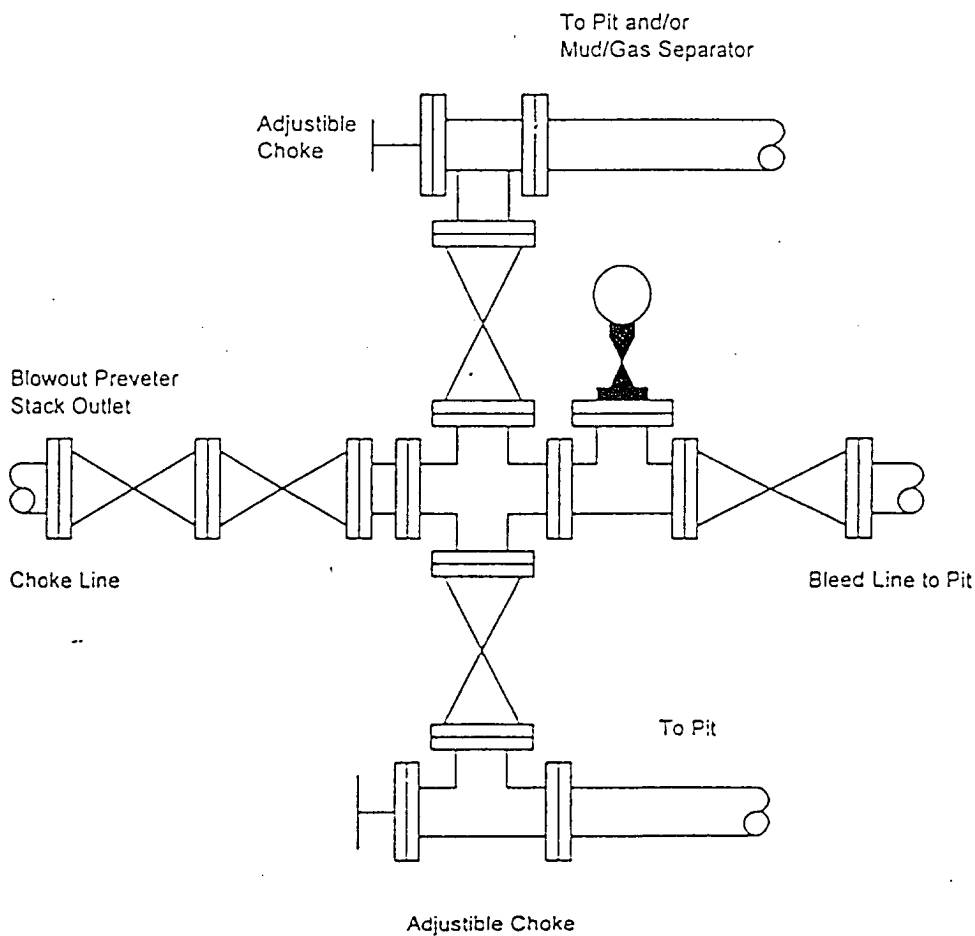

 The sender of this message has requested a read receipt. [Click here to send a receipt.](#)

Mull, Donna, EMNRD

From: Phillips, Dorothy, EMNRD
To: Mull, Donna, EMNRD
Cc:
Subject: RE: Financial Assurance Requirement
Attachments:

Sent: Mon 3/13/2006 12:58 PM

All okay.

From: Mull, Donna, EMNRD
Sent: Monday, March 13, 2006 9:43 AM
To: Phillips, Dorothy, EMNRD
Cc: Macquesten, Gail, EMNRD; Sanchez, Daniel J., EMNRD
Subject: Financial Assurance Requirement

Dorothy,

These Operators have C-101, Intent to drill:

Pogo Producing Co (17891)
Chevron USA Inc (4323)

These Operators have C-104, Request for Allowable:

Range Operating New Mexico Inc (227588)
Apache Corp (873)
Chevron USA Inc (4323)
Pure Resources LP (150628)
Chesapeake Operating Inc (147179)

Is their Financial Assurance Requirements OK?

Thanks Donna