

N ←

CapRock Maljamar UNIT # 89
2nd sampled 3-18-14

Excavation 3' Deep

5/7/14

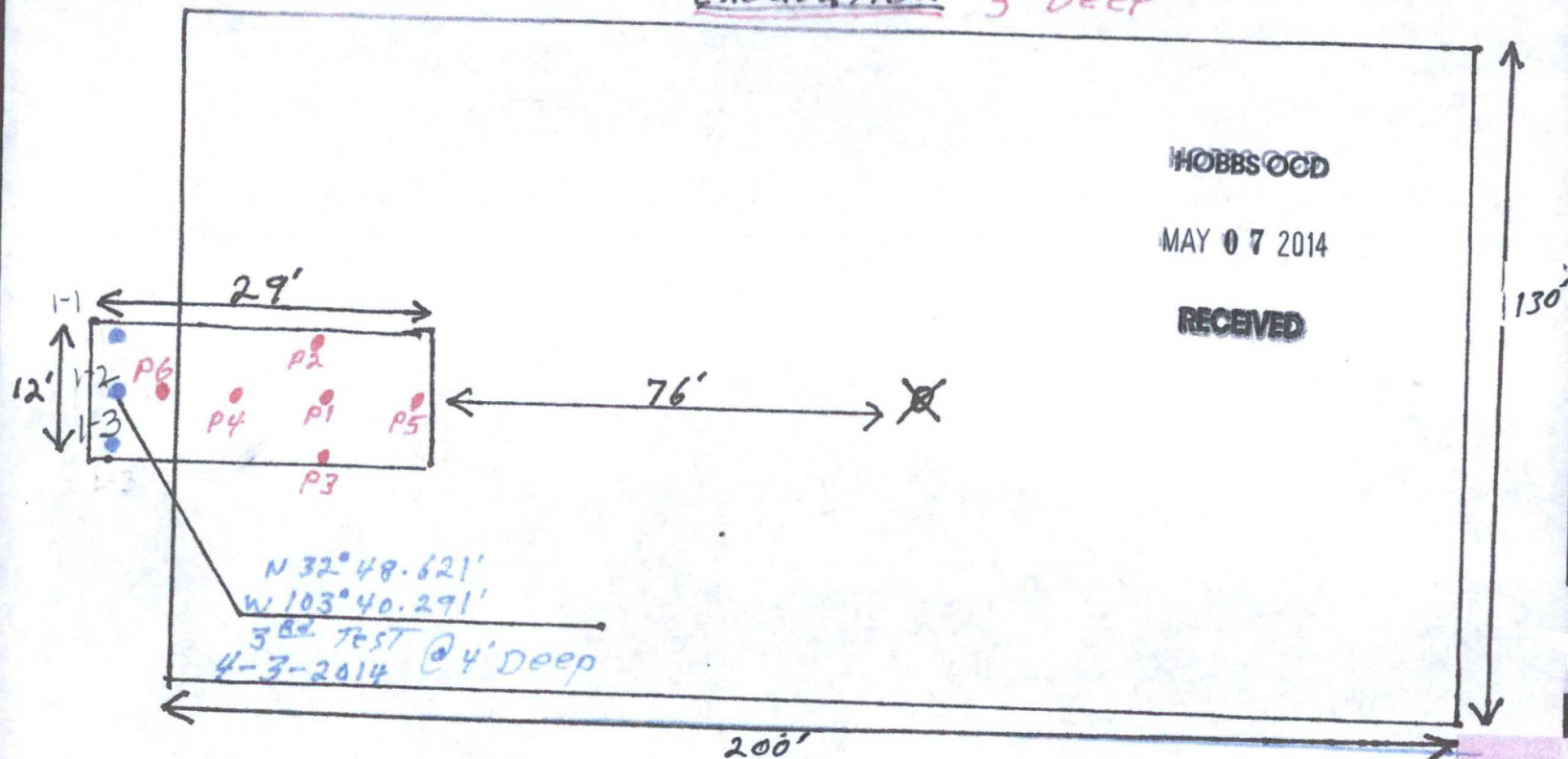

UL-E 1980 FNL-060 FNL

SEC 21 T175-R33E

API-#30-025-01509 ✓

OGR # 269324 LEA CO. NM

5/7/14 89



HOBBS OCD

JUN 03 2014

RECEIVED

Analytical Results For:

LINN OPERATING-HOBBS
BRIAN WALL
2130 W. BENDER
HOBBS NM, 88240
Fax To: (575) 738-1740

6/3/14 MTG

Received: 05/08/2014
Reported: 05/09/2014
Project Name: CAPROCK MALJAMAR UNITS
Project Number: NONE GIVEN
Project Location: ANGEL RANCH

Sampling Date: 05/08/2014
Sampling Type: Soil
Sampling Condition: Cool & Intact
Sample Received By: Jodi Henson

Sample ID: 2 G 3 CMU #89 (H401396-09)

| BTEX 8260B | | mg/kg | | Analyzed By: ms | | | | | | |
|----------------|--------|-----------------|------------|-----------------|------|------------|---------------|--------|-----------|--|
| Analyte | Result | Reporting Limit | Analyzed | Method Blank | BS | % Recovery | True Value QC | RPD | Qualifier | |
| Benzene* | <0.050 | 0.050 | 05/09/2014 | ND | 2.37 | 119 | 2.00 | 0.0531 | | |
| Toluene* | <0.050 | 0.050 | 05/09/2014 | ND | 2.38 | 119 | 2.00 | 0.125 | | |
| Ethylbenzene* | <0.050 | 0.050 | 05/09/2014 | ND | 2.24 | 112 | 2.00 | 0.819 | | |
| Total Xylenes* | <0.150 | 0.150 | 05/09/2014 | ND | 6.91 | 115 | 6.00 | 0.228 | | |
| Total BTEX | <0.300 | 0.300 | 05/09/2014 | ND | | | | | | |

Surrogate: Dibromofluoromethane 95.4 % 61.3-142
Surrogate: Toluene-d8 109 % 71.3-129
Surrogate: 4-Bromofluorobenzene 98.1 % 65.7-141

| Chloride, SM4500Cl-B | | mg/kg | | Analyzed By: AP | | | | | |
|----------------------|--------|-----------------|------------|-----------------|-----|------------|---------------|------|-----------|
| Analyte | Result | Reporting Limit | Analyzed | Method Blank | BS | % Recovery | True Value QC | RPD | Qualifier |
| Chloride | 32.0 | 16.0 | 05/09/2014 | ND | 416 | 104 | 400 | 3.92 | |

| TPH 8015M | | mg/kg | | Analyzed By: MS | | | | | |
|--------------|--------|-----------------|------------|-----------------|-----|------------|---------------|------|-----------|
| Analyte | Result | Reporting Limit | Analyzed | Method Blank | BS | % Recovery | True Value QC | RPD | Qualifier |
| GRO C6-C10 | <10.0 | 10.0 | 05/09/2014 | ND | 189 | 94.3 | 200 | 6.97 | |
| DRO >C10-C28 | 14.1 | 10.0 | 05/09/2014 | ND | 204 | 102 | 200 | 14.0 | |

Surrogate: 1-Chlorooctane 105 % 65.2-140
Surrogate: 1-Chlorooctadecane 106 % 63.6-154

Cardinal Laboratories

*=Accredited Analyte

PLEASE NOTE: Liability and Damages. Cardinal's liability and client's exclusive remedy for any claim arising, whether based in contract or tort, shall be limited to the amount paid by client for analyses. All claims, including those for negligence and any other cause whatsoever shall be deemed waived unless made in writing and received by Cardinal within thirty (30) days after completion of the applicable service. In no event shall Cardinal be liable for incidental or consequential damages, including, without limitation, business interruptions, loss of use, or loss of profits incurred by client, its subsidiaries, affiliates or successors arising out of or related to the performance of the services hereunder by Cardinal, regardless of whether such claim is based upon any of the above stated reasons or otherwise. Results relate only to the samples identified above. This report shall not be reproduced except in full with written approval of Cardinal Laboratories.

Caley D. Keene, Lab Director/Quality Manager

Analytical Results For:

LINN OPERATING-HOBBS
 BRIAN WALL
 2130 W. BENDER
 HOBBS NM, 88240
 Fax To: (575) 738-1740

Received: 05/08/2014
 Reported: 05/09/2014
 Project Name: CAPROCK MALJAMAR UNITS
 Project Number: NONE GIVEN
 Project Location: ANGEL RANCH

Sampling Date: 05/08/2014
 Sampling Type: Soil
 Sampling Condition: Cool & Intact
 Sample Received By: Jodi Henson

Sample ID: 2 G 4 CMU #89 (H401396-10)

| BTEX 8260B | | mg/kg | | Analyzed By: ms | | | | | | |
|----------------|--------|-----------------|------------|-----------------|------|------------|---------------|--------|-----------|--|
| Analyte | Result | Reporting Limit | Analyzed | Method Blank | BS | % Recovery | True Value QC | RPD | Qualifier | |
| Benzene* | <0.050 | 0.050 | 05/09/2014 | ND | 2.37 | 119 | 2.00 | 0.0531 | | |
| Toluene* | <0.050 | 0.050 | 05/09/2014 | ND | 2.38 | 119 | 2.00 | 0.125 | | |
| Ethylbenzene* | <0.050 | 0.050 | 05/09/2014 | ND | 2.24 | 112 | 2.00 | 0.819 | | |
| Total Xylenes* | <0.150 | 0.150 | 05/09/2014 | ND | 6.91 | 115 | 6.00 | 0.228 | | |
| Total BTEX | <0.300 | 0.300 | 05/09/2014 | ND | | | | | | |

Surrogate: Dibromofluoromethane 93.1 % 61.3-142
 Surrogate: Toluene-d8 106 % 71.3-129
 Surrogate: 4-Bromofluorobenzene 95.5 % 65.7-141

| Chloride, SM4500Cl-B | | mg/kg | Analyzed By: AP | | | | | | |
|----------------------|--------|-----------------|-----------------|--------------|-----|------------|---------------|------|-----------|
| Analyte | Result | Reporting Limit | Analyzed | Method Blank | BS | % Recovery | True Value QC | RPD | Qualifier |
| Chloride | 80.0 | 16.0 | 05/09/2014 | ND | 416 | 104 | 400 | 3.92 | |

| TPH 8015M | | mg/kg | | Analyzed By: MS | | | | | |
|--------------|--------|-----------------|------------|-----------------|-----|------------|---------------|------|-----------|
| Analyte | Result | Reporting Limit | Analyzed | Method Blank | BS | % Recovery | True Value QC | RPD | Qualifier |
| GRO C6-C10 | <10.0 | 10.0 | 05/09/2014 | ND | 189 | 94.3 | 200 | 6.97 | |
| DRO >C10-C28 | <10.0 | 10.0 | 05/09/2014 | ND | 204 | 102 | 200 | 14.0 | |

Surrogate: 1-Chlorooctane 104 % 65.2-140
 Surrogate: 1-Chlorooctadecane 108 % 63.6-154

Cardinal Laboratories

*=Accredited Analyte

PLEASE NOTE: Liability and Damages. Cardinal's liability and client's exclusive remedy for any claim arising, whether based in contract or tort, shall be limited to the amount paid by client for analyses. All claims, including those for negligence and any other cause whatsoever shall be deemed waived unless made in writing and received by Cardinal within thirty (30) days after completion of the applicable service. In no event shall Cardinal be liable for incidental or consequential damages, including, without limitation, business interruptions, loss of use, or loss of profits incurred by client, its subsidiaries, affiliates or successors arising out of or related to the performance of the services hereunder by Cardinal, regardless of whether such claim is based upon any of the above stated reasons or otherwise. Results relate only to the samples identified above. This report shall not be reproduced except in full with written approval of Cardinal Laboratories.

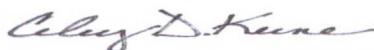

Celey D. Keene, Lab Director/Quality Manager

Analytical Results For:

LINN OPERATING-HOBBS
BRIAN WALL
2130 W. BENDER
HOBBS NM, 88240
Fax To: (575) 738-1740

HOBBS OCD

MAY 07 2014

RECEIVED

Received: 03/18/2014
Reported: 03/19/2014
Project Name: CAPROCK MALJAMAR UNITS
Project Number: NONE GIVEN
Project Location: ANGEL RANCH

Sampling Date: 03/18/2014
Sampling Type: Soil
Sampling Condition: Cool & Intact
Sample Received By: Jodi Henson

Sample ID: P1 CMU #89 (H400820-01)

| BTEX 8021B | | | mg/kg | | Analyzed By: MS | | | | |
|----------------|--------|-----------------|------------|--------------|-----------------|------------|---------------|------|-----------|
| Analyte | Result | Reporting Limit | Analyzed | Method Blank | BS | % Recovery | True Value QC | RPD | Qualifier |
| Benzene* | <0.050 | 0.050 | 03/19/2014 | ND | 2.39 | 119 | 2.00 | 3.72 | |
| Toluene* | <0.050 | 0.050 | 03/19/2014 | ND | 2.30 | 115 | 2.00 | 4.96 | |
| Ethylbenzene* | <0.050 | 0.050 | 03/19/2014 | ND | 2.27 | 114 | 2.00 | 6.01 | |
| Total Xylenes* | <0.150 | 0.150 | 03/19/2014 | ND | 6.62 | 110 | 6.00 | 6.80 | |
| Total BTEX | <0.300 | 0.300 | 03/19/2014 | ND | | | | | |

Surrogate: 4-Bromofluorobenzene (PIE) 103 % 89.4-126

| Chloride, SM4500Cl-B | | | mg/kg | | Analyzed By: AP | | | | |
|----------------------|--------|-----------------|------------|--------------|-----------------|------------|---------------|------|-----------|
| Analyte | Result | Reporting Limit | Analyzed | Method Blank | BS | % Recovery | True Value QC | RPD | Qualifier |
| Chloride | 368 | 16.0 | 03/19/2014 | ND | 416 | 104 | 400 | 0.00 | |

| TPH 8015M | | | mg/kg | | Analyzed By: ms | | | | |
|--------------|--------|-----------------|------------|--------------|-----------------|------------|---------------|-------|-----------|
| Analyte | Result | Reporting Limit | Analyzed | Method Blank | BS | % Recovery | True Value QC | RPD | Qualifier |
| GRO C6-C10 | <10.0 | 10.0 | 03/19/2014 | ND | 222 | 111 | 200 | 1.06 | |
| DRO >C10-C28 | <10.0 | 10.0 | 03/19/2014 | ND | 212 | 106 | 200 | 0.464 | |

Surrogate: 1-Chlorooctane 115 % 65.2-140

Surrogate: 1-Chlorooctadecane 117 % 63.6-154

Cardinal Laboratories

*=Accredited Analyte

PLEASE NOTE: Liability and Damages. Cardinal's liability and client's exclusive remedy for any claim arising, whether based in contract or tort, shall be limited to the amount paid by client for analyses. All claims, including those for negligence and any other cause whatsoever shall be deemed waived unless made in writing and received by Cardinal within thirty (30) days after completion of the applicable service. In no event shall Cardinal be liable for incidental or consequential damages, including, without limitation, business interruptions, loss of use, or loss of profits incurred by client, its subsidiaries, affiliates or successors arising out of or related to the performance of the services hereunder by Cardinal, regardless of whether such claim is based upon any of the above stated reasons or otherwise. Results relate only to the samples identified above. This report shall not be reproduced except in full with written approval of Cardinal Laboratories.

Celestine D. Keene

Celestine D. Keene, Lab Director/Quality Manager

Analytical Results For:

 LINN OPERATING-HOBBS
 BRIAN WALL
 2130 W. BENDER
 HOBBS NM, 88240
 Fax To: (575) 738-1740

 Received: 03/18/2014
 Reported: 03/19/2014
 Project Name: CAPROCK MALJAMAR UNITS
 Project Number: NONE GIVEN
 Project Location: ANGEL RANCH

 Sampling Date: 03/18/2014
 Sampling Type: Soil
 Sampling Condition: Cool & Intact
 Sample Received By: Jodi Henson

Sample ID: P2 CMU #89 (H400820-02)

| BTEX 8021B | | | mg/kg | | Analyzed By: MS | | | | |
|----------------|--------|-----------------|------------|--------------|-----------------|------------|---------------|------|-----------|
| Analyte | Result | Reporting Limit | Analyzed | Method Blank | BS | % Recovery | True Value QC | RPD | Qualifier |
| Benzene* | <0.050 | 0.050 | 03/19/2014 | ND | 2.39 | 119 | 2.00 | 3.72 | |
| Toluene* | <0.050 | 0.050 | 03/19/2014 | ND | 2.30 | 115 | 2.00 | 4.96 | |
| Ethylbenzene* | <0.050 | 0.050 | 03/19/2014 | ND | 2.27 | 114 | 2.00 | 6.01 | |
| Total Xylenes* | <0.150 | 0.150 | 03/19/2014 | ND | 6.62 | 110 | 6.00 | 6.80 | |
| Total BTEX | <0.300 | 0.300 | 03/19/2014 | ND | | | | | |

Surrogate: 4-Bromofluorobenzene (PII) 103 % 89.4-126

| Chloride, SM4500Cl-B | | | mg/kg | | Analyzed By: AP | | | | |
|----------------------|--------|-----------------|------------|--------------|-----------------|------------|---------------|------|-----------|
| Analyte | Result | Reporting Limit | Analyzed | Method Blank | BS | % Recovery | True Value QC | RPD | Qualifier |
| Chloride | 336 | 16.0 | 03/19/2014 | ND | 416 | 104 | 400 | 0.00 | |

| TPH 8015M | | | mg/kg | | Analyzed By: ms | | | | |
|--------------|--------|-----------------|------------|--------------|-----------------|------------|---------------|-------|-----------|
| Analyte | Result | Reporting Limit | Analyzed | Method Blank | BS | % Recovery | True Value QC | RPD | Qualifier |
| GRO C6-C10 | <10.0 | 10.0 | 03/19/2014 | ND | 222 | 111 | 200 | 1.06 | |
| DRO >C10-C28 | 13.5 | 10.0 | 03/19/2014 | ND | 212 | 106 | 200 | 0.464 | |

Surrogate: 1-Chlorooctane 88.5 % 65.2-140

Surrogate: 1-Chlorooctadecane 99.4 % 63.6-154

Cardinal Laboratories

*=Accredited Analyte

PLEASE NOTE: Liability and Damages. Cardinal's liability and client's exclusive remedy for any claim arising, whether based in contract or tort, shall be limited to the amount paid by client for analyses. All claims, including those for negligence and any other cause whatsoever shall be deemed waived unless made in writing and received by Cardinal within thirty (30) days after completion of the applicable service. In no event shall Cardinal be liable for incidental or consequential damages, including, without limitation, business interruptions, loss of use, or loss of profits incurred by client, its subsidiaries, affiliates or successors arising out of or related to the performance of the services hereunder by Cardinal, regardless of whether such claim is based upon any of the above stated reasons or otherwise. Results relate only to the samples identified above. This report shall not be reproduced except in full with written approval of Cardinal Laboratories.

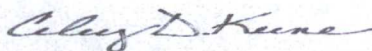

Celey D. Keene, Lab Director/Quality Manager

Analytical Results For:

 LINN OPERATING-HOBBS
 BRIAN WALL
 2130 W. BENDER
 HOBBS NM, 88240
 Fax To: (575) 738-1740

 Received: 03/18/2014
 Reported: 03/19/2014
 Project Name: CAPROCK MALJAMAR UNITS
 Project Number: NONE GIVEN
 Project Location: ANGEL RANCH

 Sampling Date: 03/18/2014
 Sampling Type: Soil
 Sampling Condition: Cool & Intact
 Sample Received By: Jodi Henson

Sample ID: P3 CMU #89 (H400820-03)

| BTEX 8021B | | | mg/kg | | Analyzed By: MS | | | | |
|----------------|--------|-----------------|------------|--------------|-----------------|------------|---------------|------|-----------|
| Analyte | Result | Reporting Limit | Analyzed | Method Blank | BS | % Recovery | True Value QC | RPD | Qualifier |
| Benzene* | <0.050 | 0.050 | 03/19/2014 | ND | 2.39 | 119 | 2.00 | 3.72 | |
| Toluene* | <0.050 | 0.050 | 03/19/2014 | ND | 2.30 | 115 | 2.00 | 4.96 | |
| Ethylbenzene* | <0.050 | 0.050 | 03/19/2014 | ND | 2.27 | 114 | 2.00 | 6.01 | |
| Total Xylenes* | <0.150 | 0.150 | 03/19/2014 | ND | 6.62 | 110 | 6.00 | 6.80 | |
| Total BTEX | <0.300 | 0.300 | 03/19/2014 | ND | | | | | |

Surrogate: 4-Bromofluorobenzene (PIC) 105 % 89.4-126

| Chloride, SM4500Cl-B | | | mg/kg | | Analyzed By: AP | | | | |
|----------------------|--------|-----------------|------------|--------------|-----------------|------------|---------------|------|-----------|
| Analyte | Result | Reporting Limit | Analyzed | Method Blank | BS | % Recovery | True Value QC | RPD | Qualifier |
| Chloride | 224 | 16.0 | 03/19/2014 | ND | 416 | 104 | 400 | 0.00 | |

| TPH 8015M | | | mg/kg | | Analyzed By: ms | | | | |
|--------------|--------|-----------------|------------|--------------|-----------------|------------|---------------|-------|-----------|
| Analyte | Result | Reporting Limit | Analyzed | Method Blank | BS | % Recovery | True Value QC | RPD | Qualifier |
| GRO C6-C10 | <10.0 | 10.0 | 03/19/2014 | ND | 222 | 111 | 200 | 1.06 | |
| DRO >C10-C28 | 14.6 | 10.0 | 03/19/2014 | ND | 212 | 106 | 200 | 0.464 | |

Surrogate: 1-Chlorooctane 98.5 % 65.2-140

Surrogate: 1-Chlorooctadecane 108 % 63.6-154

Cardinal Laboratories

* = Accredited Analyte

PLEASE NOTE: Liability and Damages. Cardinal's liability and client's exclusive remedy for any claim arising, whether based in contract or tort, shall be limited to the amount paid by client for analyses. All claims, including those for negligence and any other cause whatsoever shall be deemed waived unless made in writing and received by Cardinal within thirty (30) days after completion of the applicable service. In no event shall Cardinal be liable for incidental or consequential damages, including, without limitation, business interruptions, loss of use, or loss of profits incurred by client, its subsidiaries, affiliates or successors arising out of or related to the performance of the services hereunder by Cardinal, regardless of whether such claim is based upon any of the above stated reasons or otherwise. Results relate only to the samples identified above. This report shall not be reproduced except in full with written approval of Cardinal Laboratories.



Celey D. Keene, Lab Director/Quality Manager

Analytical Results For:

 LINN OPERATING-HOBBS
 BRIAN WALL
 2130 W. BENDER
 HOBBS NM, 88240
 Fax To: (575) 738-1740

 Received: 03/18/2014
 Reported: 03/19/2014
 Project Name: CAPROCK MALJAMAR UNITS
 Project Number: NONE GIVEN
 Project Location: ANGEL RANCH

 Sampling Date: 03/18/2014
 Sampling Type: Soil
 Sampling Condition: Cool & Intact
 Sample Received By: Jodi Henson

Sample ID: P4 CMU #89 (H400820-04)

| BTEX 8021B | | | mg/kg | | Analyzed By: MS | | | | |
|----------------|--------|-----------------|------------|--------------|-----------------|------------|---------------|------|-----------|
| Analyte | Result | Reporting Limit | Analyzed | Method Blank | BS | % Recovery | True Value QC | RPD | Qualifier |
| Benzene* | <0.050 | 0.050 | 03/19/2014 | ND | 2.39 | 119 | 2.00 | 3.72 | |
| Toluene* | <0.050 | 0.050 | 03/19/2014 | ND | 2.30 | 115 | 2.00 | 4.96 | |
| Ethylbenzene* | <0.050 | 0.050 | 03/19/2014 | ND | 2.27 | 114 | 2.00 | 6.01 | |
| Total Xylenes* | <0.150 | 0.150 | 03/19/2014 | ND | 6.62 | 110 | 6.00 | 6.80 | |
| Total BTEX | <0.300 | 0.300 | 03/19/2014 | ND | | | | | |

Surrogate: 4-Bromofluorobenzene (PIE) 103 % 89.4-126

| Chloride, SM4500Cl-B | | | mg/kg | | Analyzed By: AP | | | | |
|----------------------|--------|-----------------|------------|--------------|-----------------|------------|---------------|------|-----------|
| Analyte | Result | Reporting Limit | Analyzed | Method Blank | BS | % Recovery | True Value QC | RPD | Qualifier |
| Chloride | 352 | 16.0 | 03/19/2014 | ND | 416 | 104 | 400 | 0.00 | |

| TPH 8015M | | | mg/kg | | Analyzed By: ms | | | | |
|--------------|--------|-----------------|------------|--------------|-----------------|------------|---------------|-------|-----------|
| Analyte | Result | Reporting Limit | Analyzed | Method Blank | BS | % Recovery | True Value QC | RPD | Qualifier |
| GRO C6-C10 | <10.0 | 10.0 | 03/19/2014 | ND | 222 | 111 | 200 | 1.06 | |
| DRO >C10-C28 | 20.5 | 10.0 | 03/19/2014 | ND | 212 | 106 | 200 | 0.464 | |

Surrogate: 1-Chlorooctane 117 % 65.2-140

Surrogate: 1-Chlorooctadecane 122 % 63.6-154

Cardinal Laboratories

*=Accredited Analyte

PLEASE NOTE: Liability and Damages. Cardinal's liability and client's exclusive remedy for any claim arising, whether based in contract or tort, shall be limited to the amount paid by client for analyses. All claims, including those for negligence and any other cause whatsoever shall be deemed waived unless made in writing and received by Cardinal within thirty (30) days after completion of the applicable service. In no event shall Cardinal be liable for incidental or consequential damages, including, without limitation, business interruptions, loss of use, or loss of profits incurred by client, its subsidiaries, affiliates or successors arising out of or related to the performance of the services hereunder by Cardinal, regardless of whether such claim is based upon any of the above stated reasons or otherwise. Results relate only to the samples identified above. This report shall not be reproduced except in full with written approval of Cardinal Laboratories.



Celey D. Keene, Lab Director/Quality Manager

Analytical Results For:

 LINN OPERATING-HOBBS
 BRIAN WALL
 2130 W. BENDER
 HOBBS NM, 88240
 Fax To: (575) 738-1740

 Received: 03/18/2014
 Reported: 03/19/2014
 Project Name: CAPROCK MALJAMAR UNITS
 Project Number: NONE GIVEN
 Project Location: ANGEL RANCH

 Sampling Date: 03/18/2014
 Sampling Type: Soil
 Sampling Condition: Cool & Intact
 Sample Received By: Jodi Henson

Sample ID: P5 CMU #89 (H400820-05)

| BTEX 8021B | | mg/kg | | Analyzed By: MS | | | | | | |
|----------------|--------|-----------------|------------|-----------------|------|------------|---------------|------|-----------|--|
| Analyte | Result | Reporting Limit | Analyzed | Method Blank | BS | % Recovery | True Value QC | RPD | Qualifier | |
| Benzene* | <0.050 | 0.050 | 03/19/2014 | ND | 2.39 | 119 | 2.00 | 3.72 | | |
| Toluene* | <0.050 | 0.050 | 03/19/2014 | ND | 2.30 | 115 | 2.00 | 4.96 | | |
| Ethylbenzene* | <0.050 | 0.050 | 03/19/2014 | ND | 2.27 | 114 | 2.00 | 6.01 | | |
| Total Xylenes* | <0.150 | 0.150 | 03/19/2014 | ND | 6.62 | 110 | 6.00 | 6.80 | | |
| Total BTEX | <0.300 | 0.300 | 03/19/2014 | ND | | | | | | |

Surrogate: 4-Bromofluorobenzene (PIE) 104 % 89.4-126

| Chloride, SM4500Cl-B | | mg/kg | | Analyzed By: AP | | | | | | |
|----------------------|--------|-----------------|------------|-----------------|-----|------------|---------------|------|-----------|--|
| Analyte | Result | Reporting Limit | Analyzed | Method Blank | BS | % Recovery | True Value QC | RPD | Qualifier | |
| Chloride | 336 | 16.0 | 03/19/2014 | ND | 416 | 104 | 400 | 0.00 | | |

| TPH 8015M | | mg/kg | | Analyzed By: ms | | | | | |
|--------------|--------|-----------------|------------|-----------------|-----|------------|---------------|-------|-----------|
| Analyte | Result | Reporting Limit | Analyzed | Method Blank | BS | % Recovery | True Value QC | RPD | Qualifier |
| GRO C6-C10 | <10.0 | 10.0 | 03/19/2014 | ND | 222 | 111 | 200 | 1.06 | |
| DRO >C10-C28 | 13.4 | 10.0 | 03/19/2014 | ND | 212 | 106 | 200 | 0.464 | |

Surrogate: 1-Chlorooctane 101 % 65.2-140

Surrogate: 1-Chlorooctadecane 110 % 63.6-154

Cardinal Laboratories

*=Accredited Analyte

PLEASE NOTE: Liability and Damages. Cardinal's liability and client's exclusive remedy for any claim arising, whether based in contract or tort, shall be limited to the amount paid by client for analyses. All claims, including those for negligence and any other cause whatsoever shall be deemed waived unless made in writing and received by Cardinal within thirty (30) days after completion of the applicable service. In no event shall Cardinal be liable for incidental or consequential damages, including, without limitation, business interruptions, loss of use, or loss of profits incurred by client, its subsidiaries, affiliates or successors arising out of or related to the performance of the services hereunder by Cardinal, regardless of whether such claim is based upon any of the above stated reasons or otherwise. Results relate only to the samples identified above. This report shall not be reproduced except in full with written approval of Cardinal Laboratories.



Celey D. Keene, Lab Director/Quality Manager

Analytical Results For:

 LINN OPERATING-HOBBS
 BRIAN WALL
 2130 W. BENDER
 HOBBS NM, 88240
 Fax To: (575) 738-1740

 Received: 03/18/2014
 Reported: 03/19/2014
 Project Name: CAPROCK MALJAMAR UNITS
 Project Number: NONE GIVEN
 Project Location: ANGEL RANCH

 Sampling Date: 03/18/2014
 Sampling Type: Soil
 Sampling Condition: Cool & Intact
 Sample Received By: Jodi Henson

Sample ID: P6 CMU #89 (H400820-06)

| BTEX 8021B | | mg/kg | | Analyzed By: MS | | | | | | |
|----------------|--------|-----------------|------------|-----------------|------|------------|---------------|------|-----------|--|
| Analyte | Result | Reporting Limit | Analyzed | Method Blank | BS | % Recovery | True Value QC | RPD | Qualifier | |
| Benzene* | <0.050 | 0.050 | 03/19/2014 | ND | 2.39 | 119 | 2.00 | 3.72 | | |
| Toluene* | <0.050 | 0.050 | 03/19/2014 | ND | 2.30 | 115 | 2.00 | 4.96 | | |
| Ethylbenzene* | <0.050 | 0.050 | 03/19/2014 | ND | 2.27 | 114 | 2.00 | 6.01 | | |
| Total Xylenes* | <0.150 | 0.150 | 03/19/2014 | ND | 6.62 | 110 | 6.00 | 6.80 | | |
| Total BTEX | <0.300 | 0.300 | 03/19/2014 | ND | | | | | | |

Surrogate: 4-Bromofluorobenzene (PIE) 104 % 89.4-126

| Chloride, SM4500Cl-B | | mg/kg | | Analyzed By: AP | | | | | |
|----------------------|--------|-----------------|------------|-----------------|-----|------------|---------------|------|-----------|
| Analyte | Result | Reporting Limit | Analyzed | Method Blank | BS | % Recovery | True Value QC | RPD | Qualifier |
| Chloride | 592 | 16.0 | 03/19/2014 | ND | 416 | 104 | 400 | 0.00 | |
| TPH 8015M | | mg/kg | | Analyzed By: ms | | | | | |

| TPH 8015M | | mg/kg | | Analyzed By: ms | | | | | |
|--------------|--------|-----------------|------------|-----------------|-----|------------|---------------|-------|-----------|
| Analyte | Result | Reporting Limit | Analyzed | Method Blank | BS | % Recovery | True Value QC | RPD | Qualifier |
| GRO C6-C10 | <10.0 | 10.0 | 03/19/2014 | ND | 222 | 111 | 200 | 1.06 | |
| DRO >C10-C28 | <10.0 | 10.0 | 03/19/2014 | ND | 212 | 106 | 200 | 0.464 | |

Surrogate: 1-Chlorooctane 108 % 65.2-140

Surrogate: 1-Chlorooctadecane 108 % 63.6-154

Cardinal Laboratories

* = Accredited Analyte

PLEASE NOTE: Liability and Damages. Cardinal's liability and client's exclusive remedy for any claim arising, whether based in contract or tort, shall be limited to the amount paid by client for analyses. All claims, including those for negligence and any other cause whatsoever shall be deemed waived unless made in writing and received by Cardinal within thirty (30) days after completion of the applicable service. In no event shall Cardinal be liable for incidental or consequential damages, including, without limitation, business interruptions, loss of use, or loss of profits incurred by client, its subsidiaries, affiliates or successors arising out of or related to the performance of the services hereunder by Cardinal, regardless of whether such claim is based upon any of the above stated reasons or otherwise. Results relate only to the samples identified above. This report shall not be reproduced except in full with written approval of Cardinal Laboratories.



Celey D. Keene, Lab Director/Quality Manager

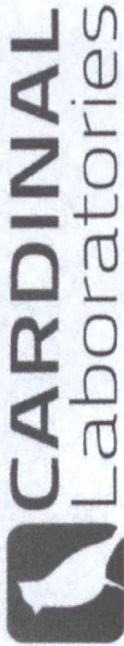

101 East Marland, Hobbs, NM 88240
(575) 393-2326 FAX (575) 393-2476

CHAIN-OF-CUSTODY AND ANALYSIS REQUEST

| BILL TO | | ANALYSIS REQUEST | | | | | | | | | | | | | | | | | |
|---|----------|------------------|--------------|-------------|------------|------|-----|--------|--------|------------|------------|--------|---------|----------|---------|------|-----|-----|----|
| P.O. #: | | | | | | | | | | | | | | | | | | | |
| Company: <i>Linn Operating</i> | | | | | | | | | | | | | | | | | | | |
| Address: <i>State line R.V. Park #36</i> | | | | | | | | | | | | | | | | | | | |
| City: <i>Hobbs</i> State: <i>N.M.</i> Zip: <i>88241</i> | | | | | | | | | | | | | | | | | | | |
| Phone #: <i>940-395-3308</i> Fax #: | | | | | | | | | | | | | | | | | | | |
| Project #: | | | | | | | | | | | | | | | | | | | |
| Project Owner: <i>Linn</i> | | | | | | | | | | | | | | | | | | | |
| Project Name: <i>CA. PROCK MALJAMAR W.I.T.S</i> | | | | | | | | | | | | | | | | | | | |
| Project Location: <i>CMU ANGEL RANCH</i> | | | | | | | | | | | | | | | | | | | |
| Sampler Name: <i>Dusty Boggs</i> | | | | | | | | | | | | | | | | | | | |
| FOR LAB USE ONLY | Lab I.D. | Sample I.D. | # CONTAINERS | GROUNDWATER | WASTEWATER | SOIL | OIL | SLUDGE | OTHER: | ACID/BASE: | ICE / COOL | OTHER: | PRESERV | SAMPLING | DATE | TIME | TPH | BTX | CL |
| | 1 | P1 CMV # 89 | 9 | ✓ | ✓ | ✓ | ✓ | ✓ | ✓ | ✓ | ✓ | ✓ | ✓ | ✓ | 3-18-14 | 8:25 | ✓ | ✓ | ✓ |
| | 2 | P2 CMV # 89 | 9 | ✓ | ✓ | ✓ | ✓ | ✓ | ✓ | ✓ | ✓ | ✓ | ✓ | ✓ | " | 8:30 | ✓ | ✓ | ✓ |
| | 3 | P3 CMV # 89 | 9 | ✓ | ✓ | ✓ | ✓ | ✓ | ✓ | ✓ | ✓ | ✓ | ✓ | ✓ | " | 8:35 | ✓ | ✓ | ✓ |
| | 4 | P4 CMV # 89 | 9 | ✓ | ✓ | ✓ | ✓ | ✓ | ✓ | ✓ | ✓ | ✓ | ✓ | ✓ | " | 8:40 | ✓ | ✓ | ✓ |
| | 5 | P5 CMV # 89 | 9 | ✓ | ✓ | ✓ | ✓ | ✓ | ✓ | ✓ | ✓ | ✓ | ✓ | ✓ | " | 8:50 | ✓ | ✓ | ✓ |
| | 6 | P6 CMV # 89 | 9 | ✓ | ✓ | ✓ | ✓ | ✓ | ✓ | ✓ | ✓ | ✓ | ✓ | ✓ | " | 9:00 | ✓ | ✓ | ✓ |

PLEASE NOTE: Liability and Damages. Cardinal's liability and client's exclusive remedy for any claim arising whether based in contract or tort, shall be limited to the amount paid by the client for the analyses. All claims including those for negligence and any other causes whatsoever shall be deemed waived unless made in writing and received by Cardinal within 30 days after completion of the applicable service. In no event shall Cardinal be liable for incidental or consequential damages, including without limitation, business interruptions, loss of use, or loss of profits incurred by client, its subsidiaries, affiliates or successors arising out of or related to the performance of services hereunder by Cardinal, regardless of whether such claim is based upon any of the above stated theories of liability.

| | | | | | | | |
|---|----------------------------------|----------------------|--------------------|---|----------------------------------|-------------------|-------------------|
| Relinquished By: <i>Dusty Boggs</i> | Received By: <i>Spedi Henson</i> | Date: <i>3-18-14</i> | Time: <i>12:15</i> | Relinquished By: <i>Spedi Henson</i> | Received By: <i>Spedi Henson</i> | Date: <i>4-10</i> | Time: <i>4:10</i> |
| Delivered By: (Circle One) Sampler - UPS - Bus - Other: | | | | Sample Condition Cool Intact <input checked="" type="checkbox"/> Yes <input type="checkbox"/> No | | | |
| CHECKED BY: <i>Spedi Henson</i> | | | | CHECKED BY: <i>Spedi Henson</i> | | | |
| REMARKS: <i>Dusty Boggs @ j.d. King Corp. com</i> <i>Fred Ramsey III @ gmail. com</i> <i>Best!!</i> | | | | REMARKS: <i>Dusty Boggs @ j.d. King Corp. com</i> <i>Fred Ramsey III @ gmail. com</i> <i>Best!!</i> | | | |



HOBBS OCD

MAY 07 2014

CHAIN-OF-CUSTODY AND ANALYSIS REQUEST

101 East Marland, Hobbs, NM 88240
(575) 393-2326 FAX (575) 393-2476

RECEIVED

ANALYSIS REQUEST

BILL TO

Company Name: **Viper**

Project Manager: **Fred Ramsey #36**

Address: **STATE line R.V. Park #36**

City: **Hobbs** State: **NM** Zip: **88241**

Phone #: **940-395-3308** Fax #:

Project #: Project Owner: **Linn**

Project Name: **CARROLL MALJAMAR WITS**

Project Location: **CMU ANGEL RANCH**

Sample Name: **DUSTY BOGGS**

FOR LAB USE ONLY

Lab I.D. Sample I.D.

114006710

1 P1 CMU # 89

2 P2 CMU # 89

3 P3 CMU # 89

4 P4 CMU # 89

5 P5 CMU # 89

6 P6 CMU # 89

(G)RAB OR (C)OMP.

CONTAINERS

GROUNDWATER

WASTEWATER

SOIL

OIL

SLUDGE

OTHER:

ACID/BASE:

ICE / COOL

OTHER:

DATE

TIME

TPH

BTX

CL

3-18-14 8:25

8:30

8:35

8:40

8:50

9:00

Relinquished By: **Dusty Boggs** Date: **3-18-14** Received By: **Fred Ramsey**
Relinquished By: **Fred Ramsey** Date: **3-18-14** Received By: **Dusty Boggs**
Time: _____

Delivered By: (Circle One) **UPS** - Bus - Other: **4.12**
Sample Condition: ☒ Yes ☐ No
Cool Intact: ☒ Yes ☐ No
CHECKED BY: **Fred Ramsey**
REMARKS: **Dusty Boggs @ jdking corp. com**
Fred Ramsey @ gmail. com
114006710

Analytical Results For:

 LINN OPERATING-HOBBS
 BRIAN WALL
 2130 W. BENDER
 HOBBS NM, 88240
 Fax To: (575) 738-1740

 Received: 03/18/2014
 Reported: 03/19/2014
 Project Name: CAPROCK MALJAMAR UNITS
 Project Number: NONE GIVEN
 Project Location: ANGEL RANCH

 Sampling Date: 03/18/2014
 Sampling Type: Soil
 Sampling Condition: Cool & Intact
 Sample Received By: Jodi Henson

Sample ID: P1 CMU #89 (H400820-01)

| BTEX 80218 | | mg/kg | Analyzed By: MS | | | | | | |
|----------------|--------|-----------------|-----------------|--------------|------|------------|---------------|------|-----------|
| Analyte | Result | Reporting Limit | Analyzed | Method Blank | BS | % Recovery | True Value QC | RPD | Qualifier |
| Benzene* | <0.050 | 0.050 | 03/19/2014 | ND | 2.39 | 119 | 2.00 | 3.72 | |
| Toluene* | <0.050 | 0.050 | 03/19/2014 | ND | 2.30 | 115 | 2.00 | 4.96 | |
| Ethylbenzene* | <0.050 | 0.050 | 03/19/2014 | ND | 2.27 | 114 | 2.00 | 6.01 | |
| Total Xylenes* | <0.150 | 0.150 | 03/19/2014 | ND | 6.62 | 110 | 6.00 | 6.80 | |
| Total BTEX | <0.300 | 0.300 | 03/19/2014 | ND | | | | | |

Surrogate: 4-Bromofluorobenzene (PIE) 103 % 89.4-126

| Chloride, SM4500Cl-B | | mg/kg | Analyzed By: AP | | | | | | |
|----------------------|--------|-----------------|-----------------|--------------|-----|------------|---------------|------|-----------|
| Analyte | Result | Reporting Limit | Analyzed | Method Blank | BS | % Recovery | True Value QC | RPD | Qualifier |
| Chloride | 368 | 16.0 | 03/19/2014 | ND | 416 | 104 | 400 | 0.00 | |

| TPH 8015M | | mg/kg | Analyzed By: ms | | | | | | |
|--------------|--------|-----------------|-----------------|--------------|-----|------------|---------------|-------|-----------|
| Analyte | Result | Reporting Limit | Analyzed | Method Blank | BS | % Recovery | True Value QC | RPD | Qualifier |
| GRO C6-C10 | <10.0 | 10.0 | 03/19/2014 | ND | 222 | 111 | 200 | 1.06 | |
| DRO >C10-C28 | <10.0 | 10.0 | 03/19/2014 | ND | 212 | 106 | 200 | 0.464 | |

Surrogate: 1-Chlorooctane 115 % 65.2-140

Surrogate: 1-Chlorooctadecane 117 % 63.6-154

Cardinal Laboratories

*=Accredited Analyte

PLEASE NOTE: Liability and Damages. Cardinal's liability and client's exclusive remedy for any claim arising, whether based in contract or tort, shall be limited to the amount paid by client for analyses. All claims, including those for negligence and any other cause whatsoever shall be deemed waived unless made in writing and received by Cardinal within thirty (30) days after completion of the applicable service. In no event shall Cardinal be liable for incidental or consequential damages, including, without limitation, business interruptions, loss of use, or loss of profits incurred by client, its subsidiaries, affiliates or successors arising out of or related to the performance of the services hereunder by Cardinal, regardless of whether such claim is based upon any of the above stated reasons or otherwise. Results relate only to the samples identified above. This report shall not be reproduced except in full with written approval of Cardinal Laboratories.



Celey D. Keene, Lab Director/Quality Manager

Analytical Results For:

LINN OPERATING-HOBBS
 BRIAN WALL
 2130 W. BENDER
 HOBBS NM, 88240
 Fax To: (575) 738-1740

Received: 03/18/2014
 Reported: 03/19/2014
 Project Name: CAPROCK MALJAMAR UNITS
 Project Number: NONE GIVEN
 Project Location: ANGEL RANCH

Sampling Date: 03/18/2014
 Sampling Type: Soil
 Sampling Condition: Cool & Intact
 Sample Received By: Jodi Henson

Sample ID: P2 CMU #89 (H400820-02)

| BTEX 8021B | | | mg/kg | | | | | | | | Analyzed By: MS | |
|----------------|--------|-----------------|------------|--------------|------|------------|---------------|------|-----------|--|-----------------|--|
| Analyte | Result | Reporting Limit | Analyzed | Method Blank | BS | % Recovery | True Value QC | RPD | Qualifier | | | |
| Benzene* | <0.050 | 0.050 | 03/19/2014 | ND | 2.39 | 119 | 2.00 | 3.72 | | | | |
| Toluene* | <0.050 | 0.050 | 03/19/2014 | ND | 2.30 | 115 | 2.00 | 4.96 | | | | |
| Ethylbenzene* | <0.050 | 0.050 | 03/19/2014 | ND | 2.27 | 114 | 2.00 | 6.01 | | | | |
| Total Xylenes* | <0.150 | 0.150 | 03/19/2014 | ND | 6.62 | 110 | 6.00 | 6.80 | | | | |
| Total BTEX | <0.300 | 0.300 | 03/19/2014 | ND | | | | | | | | |

Surrogate: 4-Bromofluorobenzene (PIE) 103 % 89.4-126

| Chloride, SM4500Cl-B | | | mg/kg | | | | | | | | Analyzed By: AP | |
|----------------------|--------|-----------------|------------|--------------|-----|------------|---------------|------|-----------|--|-----------------|--|
| Analyte | Result | Reporting Limit | Analyzed | Method Blank | BS | % Recovery | True Value QC | RPD | Qualifier | | | |
| Chloride | 336 | 16.0 | 03/19/2014 | ND | 416 | 104 | 400 | 0.00 | | | | |

| TPH 8015M | | mg/kg | | Analyzed By: ms | | | | | |
|--------------|--------|-----------------|------------|-----------------|-----|------------|---------------|-------|-----------|
| Analyte | Result | Reporting Limit | Analyzed | Method Blank | BS | % Recovery | True Value QC | RPD | Qualifier |
| GRO C6-C10 | <10.0 | 10.0 | 03/19/2014 | ND | 222 | 111 | 200 | 1.06 | |
| DRO >C10-C28 | 13.5 | 10.0 | 03/19/2014 | ND | 212 | 106 | 200 | 0.464 | |

Surrogate: 1-Chlorooctane 88.5 % 65.2-140

Surrogate: 1-Chlorooctadecane 99.4 % 63.6-154

Cardinal Laboratories

*=Accredited Analyte

PLEASE NOTE: Liability and Damages. Cardinal's liability and client's exclusive remedy for any claim arising, whether based in contract or tort, shall be limited to the amount paid by client for analyses. All claims, including those for negligence and any other cause whatsoever shall be deemed waived unless made in writing and received by Cardinal within thirty (30) days after completion of the applicable service. In no event shall Cardinal be liable for incidental or consequential damages, including, without limitation, business interruptions, loss of use, or loss of profits incurred by client, its subsidiaries, affiliates or successors arising out of or related to the performance of the services hereunder by Cardinal, regardless of whether such claim is based upon any of the above stated reasons or otherwise. Results relate only to the samples identified above. This report shall not be reproduced except in full with written approval of Cardinal Laboratories.



Celey D. Keene, Lab Director/Quality Manager

Analytical Results For:

 LINN OPERATING-HOBBS
 BRIAN WALL
 2130 W. BENDER
 HOBBS NM, 88240
 Fax To: (575) 738-1740

 Received: 03/18/2014
 Reported: 03/19/2014
 Project Name: CAPROCK MALJAMAR UNITS
 Project Number: NONE GIVEN
 Project Location: ANGEL RANCH

 Sampling Date: 03/18/2014
 Sampling Type: Soil
 Sampling Condition: Cool & Intact
 Sample Received By: Jodi Henson

Sample ID: P3 CMU #89 (H400820-03)

| BTEX 8021B | | | mg/kg | | Analyzed By: MS | | | | | |
|----------------|--------|-----------------|------------|--------------|-----------------|------------|---------------|------|-----------|--|
| Analyte | Result | Reporting Limit | Analyzed | Method Blank | BS | % Recovery | True Value QC | RPD | Qualifier | |
| Benzene* | <0.050 | 0.050 | 03/19/2014 | ND | 2.39 | 119 | 2.00 | 3.72 | | |
| Toluene* | <0.050 | 0.050 | 03/19/2014 | ND | 2.30 | 115 | 2.00 | 4.96 | | |
| Ethylbenzene* | <0.050 | 0.050 | 03/19/2014 | ND | 2.27 | 114 | 2.00 | 6.01 | | |
| Total Xylenes* | <0.150 | 0.150 | 03/19/2014 | ND | 6.62 | 110 | 6.00 | 6.80 | | |
| Total BTEX | <0.300 | 0.300 | 03/19/2014 | ND | | | | | | |

Surrogate: 4-Bromofluorobenzene (PIE) 105 % 89.4-126

| Chloride, SM4500Cl-B | | mg/kg | | Analyzed By: AP | | | | | | |
|----------------------|--------|-----------------|------------|-----------------|-----|------------|---------------|------|-----------|--|
| Analyte | Result | Reporting Limit | Analyzed | Method Blank | BS | % Recovery | True Value QC | RPD | Qualifier | |
| Chloride | 224 | 16.0 | 03/19/2014 | ND | 416 | 104 | 400 | 0.00 | | |

| TPH 8015M | | mg/kg | | Analyzed By: ms | | | | | |
|--------------|--------|-----------------|------------|-----------------|-----|------------|---------------|-------|-----------|
| Analyte | Result | Reporting Limit | Analyzed | Method Blank | BS | % Recovery | True Value QC | RPD | Qualifier |
| GRO C6-C10 | <10.0 | 10.0 | 03/19/2014 | ND | 222 | 111 | 200 | 1.06 | |
| DRO >C10-C28 | 14.6 | 10.0 | 03/19/2014 | ND | 212 | 106 | 200 | 0.464 | |

Surrogate: 1-Chlorooctane 98.5 % 65.2-140

Surrogate: 1-Chlorooctadecane 108 % 63.6-154

Cardinal Laboratories

* = Accredited Analyte

PLEASE NOTE: Liability and Damages. Cardinal's liability and client's exclusive remedy for any claim arising, whether based in contract or tort, shall be limited to the amount paid by client for analyses. All claims, including those for negligence and any other cause whatsoever shall be deemed waived unless made in writing and received by Cardinal within thirty (30) days after completion of the applicable service. In no event shall Cardinal be liable for incidental or consequential damages, including, without limitation, business interruptions, loss of use, or loss of profits incurred by client, its subsidiaries, affiliates or successors arising out of or related to the performance of the services hereunder by Cardinal, regardless of whether such claim is based upon any of the above stated reasons or otherwise. Results relate only to the samples identified above. This report shall not be reproduced except in full with written approval of Cardinal Laboratories.



Celey D. Keene, Lab Director/Quality Manager

Analytical Results For:

LINN OPERATING-HOBBS
 BRIAN WALL
 2130 W. BENDER
 HOBBS NM, 88240
 Fax To: (575) 738-1740

Received: 03/18/2014
 Reported: 03/19/2014
 Project Name: CAPROCK MALJAMAR UNITS
 Project Number: NONE GIVEN
 Project Location: ANGEL RANCH

Sampling Date: 03/18/2014
 Sampling Type: Soil
 Sampling Condition: Cool & Intact
 Sample Received By: Jodi Henson

Sample ID: P4 CMU #89 (H400820-04)

| BTEX 8021B | | mg/kg | Analyzed By: MS | | | | | | |
|----------------|--------|-----------------|-----------------|--------------|------|------------|---------------|------|-----------|
| Analyte | Result | Reporting Limit | Analyzed | Method Blank | BS | % Recovery | True Value QC | RPD | Qualifier |
| Benzene* | <0.050 | 0.050 | 03/19/2014 | ND | 2.39 | 119 | 2.00 | 3.72 | |
| Toluene* | <0.050 | 0.050 | 03/19/2014 | ND | 2.30 | 115 | 2.00 | 4.96 | |
| Ethylbenzene* | <0.050 | 0.050 | 03/19/2014 | ND | 2.27 | 114 | 2.00 | 6.01 | |
| Total Xylenes* | <0.150 | 0.150 | 03/19/2014 | ND | 6.62 | 110 | 6.00 | 6.80 | |
| Total BTEX | <0.300 | 0.300 | 03/19/2014 | ND | | | | | |

Surrogate: 4-Bromofluorobenzene (PIE) 103 % 89.4-126

| Chloride, SM4500Cl-B | | mg/kg | Analyzed By: AP | | | | | | | |
|----------------------|--------|-----------------|-----------------|--------------|-----|------------|---------------|------|-----------|--|
| Analyte | Result | Reporting Limit | Analyzed | Method Blank | BS | % Recovery | True Value QC | RPD | Qualifier | |
| Chloride | 352 | 16.0 | 03/19/2014 | ND | 416 | 104 | 400 | 0.00 | | |

| TPH 8015M | | mg/kg | | Analyzed By: ms | | | | | |
|--------------|--------|-----------------|------------|-----------------|-----|------------|---------------|-------|-----------|
| Analyte | Result | Reporting Limit | Analyzed | Method Blank | BS | % Recovery | True Value QC | RPD | Qualifier |
| GRO C6-C10 | <10.0 | 10.0 | 03/19/2014 | ND | 222 | 111 | 200 | 1.06 | |
| DRO >C10-C28 | 20.5 | 10.0 | 03/19/2014 | ND | 212 | 106 | 200 | 0.464 | |

Surrogate: 1-Chlorooctane 117 % 65.2-140

Surrogate: 1-Chlorooctadecane 122 % 63.6-154

Cardinal Laboratories

*=Accredited Analyte

PLEASE NOTE: Liability and Damages. Cardinal's liability and client's exclusive remedy for any claim arising, whether based in contract or tort, shall be limited to the amount paid by client for analyses. All claims, including those for negligence and any other cause whatsoever shall be deemed waived unless made in writing and received by Cardinal within thirty (30) days after completion of the applicable service. In no event shall Cardinal be liable for incidental or consequential damages, including, without limitation, business interruptions, loss of use, or loss of profits incurred by client, its subsidiaries, affiliates or successors arising out of or related to the performance of the services hereunder by Cardinal, regardless of whether such claim is based upon any of the above stated reasons or otherwise. Results relate only to the samples identified above. This report shall not be reproduced except in full with written approval of Cardinal Laboratories.



Celey D. Keene, Lab Director/Quality Manager

Analytical Results For:

LINN OPERATING-HOBBS
 BRIAN WALL
 2130 W. BENDER
 HOBBS NM, 88240
 Fax To: (575) 738-1740

Received: 03/18/2014
 Reported: 03/19/2014
 Project Name: CAPROCK MALJAMAR UNITS
 Project Number: NONE GIVEN
 Project Location: ANGEL RANCH

Sampling Date: 03/18/2014
 Sampling Type: Soil
 Sampling Condition: Cool & Intact
 Sample Received By: Jodi Henson

Sample ID: P5 CMU #89 (H400820-05)

| BTEX 8021B | | mg/kg | | Analyzed By: MS | | | | | |
|----------------|--------|-----------------|------------|-----------------|------|------------|---------------|------|-----------|
| Analyte | Result | Reporting Limit | Analyzed | Method Blank | BS | % Recovery | True Value QC | RPD | Qualifier |
| Benzene* | <0.050 | 0.050 | 03/19/2014 | ND | 2.39 | 119 | 2.00 | 3.72 | |
| Toluene* | <0.050 | 0.050 | 03/19/2014 | ND | 2.30 | 115 | 2.00 | 4.96 | |
| Ethylbenzene* | <0.050 | 0.050 | 03/19/2014 | ND | 2.27 | 114 | 2.00 | 6.01 | |
| Total Xylenes* | <0.150 | 0.150 | 03/19/2014 | ND | 6.62 | 110 | 6.00 | 6.80 | |
| Total BTEX | <0.300 | 0.300 | 03/19/2014 | ND | | | | | |

Surrogate: 4-Bromofluorobenzene (PIC) 104 % 89.4-126

| Chloride, SM4500Cl-B | | mg/kg | | Analyzed By: AP | | | | | |
|----------------------|--------|-----------------|------------|-----------------|-----|------------|---------------|------|-----------|
| Analyte | Result | Reporting Limit | Analyzed | Method Blank | BS | % Recovery | True Value QC | RPD | Qualifier |
| Chloride | 336 | 16.0 | 03/19/2014 | ND | 416 | 104 | 400 | 0.00 | |

| TPH 8015M | | mg/kg | | Analyzed By: ms | | | | | |
|--------------|--------|-----------------|------------|-----------------|-----|------------|---------------|-------|-----------|
| Analyte | Result | Reporting Limit | Analyzed | Method Blank | BS | % Recovery | True Value QC | RPD | Qualifier |
| GRO C6-C10 | <10.0 | 10.0 | 03/19/2014 | ND | 222 | 111 | 200 | 1.06 | |
| DRO >C10-C28 | 13.4 | 10.0 | 03/19/2014 | ND | 212 | 106 | 200 | 0.464 | |

Surrogate: 1-Chlorooctane 101 % 65.2-140

Surrogate: 1-Chlorooctadecane 110 % 63.6-154

Cardinal Laboratories

*=Accredited Analyte

PLEASE NOTE: Liability and Damages. Cardinal's liability and client's exclusive remedy for any claim arising, whether based in contract or tort, shall be limited to the amount paid by client for analyses. All claims, including those for negligence and any other cause whatsoever shall be deemed waived unless made in writing and received by Cardinal within thirty (30) days after completion of the applicable service. In no event shall Cardinal be liable for incidental or consequential damages, including, without limitation, business interruptions, loss of use, or loss of profits incurred by client, its subsidiaries, affiliates or successors arising out of or related to the performance of the services hereunder by Cardinal, regardless of whether such claim is based upon any of the above stated reasons or otherwise. Results relate only to the samples identified above. This report shall not be reproduced except in full with written approval of Cardinal Laboratories.



Celey D. Keene, Lab Director/Quality Manager

Analytical Results For:

LINN OPERATING-HOBBS
 BRIAN WALL
 2130 W. BENDER
 HOBBS NM, 88240
 Fax To: (575) 738-1740

Received: 03/18/2014
 Reported: 03/19/2014
 Project Name: CAPROCK MALJAMAR UNITS
 Project Number: NONE GIVEN
 Project Location: ANGEL RANCH

Sampling Date: 03/18/2014
 Sampling Type: Soil
 Sampling Condition: Cool & Intact
 Sample Received By: Jodi Henson

Sample ID: P6 CMU #89 (H400820-06)

| BTEX 8021B | | | mg/kg | | Analyzed By: MS | | | | | |
|----------------|--------|-----------------|------------|--------------|-----------------|------------|---------------|------|-----------|--|
| Analyte | Result | Reporting Limit | Analyzed | Method Blank | BS | % Recovery | True Value QC | RPD | Qualifier | |
| Benzene* | <0.050 | 0.050 | 03/19/2014 | ND | 2.39 | 119 | 2.00 | 3.72 | | |
| Toluene* | <0.050 | 0.050 | 03/19/2014 | ND | 2.30 | 115 | 2.00 | 4.96 | | |
| Ethylbenzene* | <0.050 | 0.050 | 03/19/2014 | ND | 2.27 | 114 | 2.00 | 6.01 | | |
| Total Xylenes* | <0.150 | 0.150 | 03/19/2014 | ND | 6.62 | 110 | 6.00 | 6.80 | | |
| Total BTEX | <0.300 | 0.300 | 03/19/2014 | ND | | | | | | |

Surrogate: 4-Bromofluorobenzene (PIC) 104 % 89.4-126

| Chloride, SM4500Cl-B | | mg/kg | | Analyzed By: AP | | | | | | |
|----------------------|--------|-----------------|------------|-----------------|-----|------------|---------------|------|-----------|--|
| Analyte | Result | Reporting Limit | Analyzed | Method Blank | BS | % Recovery | True Value QC | RPD | Qualifier | |
| Chloride | 592 | 16.0 | 03/19/2014 | ND | 416 | 104 | 400 | 0.00 | | |
| TPH 8015M | | mg/kg | | Analyzed By: ms | | | | | | |

| TPH 8015M | | mg/kg | | Analyzed By: ms | | | | | |
|--------------|--------|-----------------|------------|-----------------|-----|------------|---------------|-------|-----------|
| Analyte | Result | Reporting Limit | Analyzed | Method Blank | BS | % Recovery | True Value QC | RPD | Qualifier |
| GRO C6-C10 | <10.0 | 10.0 | 03/19/2014 | ND | 222 | 111 | 200 | 1.06 | |
| DRO >C10-C28 | <10.0 | 10.0 | 03/19/2014 | ND | 212 | 106 | 200 | 0.464 | |

Surrogate: 1-Chlorooctane 108 % 65.2-140

Surrogate: 1-Chlorooctadecane 108 % 63.6-154

Cardinal Laboratories

*=Accredited Analyte

PLEASE NOTE: Liability and Damages. Cardinal's liability and client's exclusive remedy for any claim arising, whether based in contract or tort, shall be limited to the amount paid by client for analyses. All claims, including those for negligence and any other cause whatsoever shall be deemed waived unless made in writing and received by Cardinal within thirty (30) days after completion of the applicable service. In no event shall Cardinal be liable for incidental or consequential damages, including, without limitation, business interruptions, loss of use, or loss of profits incurred by client, its subsidiaries, affiliates or successors arising out of or related to the performance of the services hereunder by Cardinal, regardless of whether such claim is based upon any of the above stated reasons or otherwise. Results relate only to the samples identified above. This report shall not be reproduced except in full with written approval of Cardinal Laboratories.



Celey D. Keene, Lab Director/Quality Manager



OCD

#89

PHONE (575) 393-2326 • 101 E. MARLAND • HOBBS, NM 88240

April 04, 2014

BRIAN WALL

LINN OPERATING-HOBBS

2130 W. BENDER

HOBBS, NM 88240

HOBBS OCD

APR 07 2014

RECEIVED

RE: CAPROCK MALJAMAR UNITS

Enclosed are the results of analyses for samples received by the laboratory on 04/03/14 9:45.

Cardinal Laboratories is accredited through Texas NELAP under certificate number T104704398-13-5. Accreditation applies to drinking water, non-potable water and solid and chemical materials. All accredited analytes are denoted by an asterisk (*). For a complete list of accredited analytes and matrices visit the TCEQ website at www.tceq.texas.gov/field/qa/lab_accred_certif.html.

Cardinal Laboratories is accredited through the State of Colorado Department of Public Health and Environment for:

| | |
|------------------|------------------------------|
| Method EPA 552.2 | Haloacetic Acids (HAA-5) |
| Method EPA 524.2 | Total Trihalomethanes (TTHM) |
| Method EPA 524.4 | Regulated VOCs (V1, V2, V3) |

Accreditation applies to public drinking water matrices.

This report meets NELAP requirements and is made up of a cover page, analytical results, and a copy of the original chain-of-custody. If you have any questions concerning this report, please feel free to contact me.

Sincerely,

A handwritten signature in cursive script that reads "Caley D. Keene".

Caley D. Keene

Lab Director/Quality Manager

Analytical Results For:

 LINN OPERATING-HOBBS
 BRIAN WALL
 2130 W. BENDER
 HOBBS NM, 88240
 Fax To: (575) 738-1740

HOBBS OCD

APR 07 2014

RECEIVED

 Received: 04/03/2014
 Reported: 04/04/2014
 Project Name: CAPROCK MALJAMAR UNITS
 Project Number: NONE GIVEN
 Project Location: ANGEL RANCH

 Sampling Date: 04/03/2014
 Sampling Type: Soil
 Sampling Condition: Cool & Intact
 Sample Received By: Jodi Henson

Sample ID: 1-1 CMU #89 (H400990-01)

| BTX 8021B | | mg/kg | | Analyzed By: MS | | | | | | |
|----------------|--------|-----------------|------------|-----------------|------|------------|---------------|-------|-----------|--|
| Analyte | Result | Reporting Limit | Analyzed | Method Blank | BS | % Recovery | True Value QC | RPD | Qualifier | |
| Benzene* | <0.050 | 0.050 | 04/03/2014 | ND | 2.59 | 129 | 2.00 | 1.32 | | |
| Toluene* | <0.050 | 0.050 | 04/03/2014 | ND | 2.50 | 125 | 2.00 | 0.955 | | |
| Ethylbenzene* | <0.050 | 0.050 | 04/03/2014 | ND | 2.47 | 124 | 2.00 | 1.10 | | |
| Total Xylenes* | <0.150 | 0.150 | 04/03/2014 | ND | 7.08 | 118 | 6.00 | 0.890 | | |
| Total BTX | <0.300 | 0.300 | 04/03/2014 | ND | | | | | | |

Surrogate: 4-Bromofluorobenzene (PIE) 117 % 89.4-126

| Chloride, SM4500Cl-B | | mg/kg | | Analyzed By: AP | | | | | |
|----------------------|--------|-----------------|------------|-----------------|-----|------------|---------------|------|-----------|
| Analyte | Result | Reporting Limit | Analyzed | Method Blank | BS | % Recovery | True Value QC | RPD | Qualifier |
| Chloride | 16.0 | 16.0 | 04/04/2014 | ND | 400 | 100 | 400 | 3.92 | |
| TPH 8015M | | mg/kg | | Analyzed By: ms | | | | | |

| TPH 8015M | | mg/kg | | Analyzed By: ms | | | | | |
|--------------|--------|-----------------|------------|-----------------|-----|------------|---------------|-------|-----------|
| Analyte | Result | Reporting Limit | Analyzed | Method Blank | BS | % Recovery | True Value QC | RPD | Qualifier |
| GRO C6-C10 | <10.0 | 10.0 | 04/03/2014 | ND | 194 | 97.1 | 200 | 0.486 | |
| DRO >C10-C28 | 45.6 | 10.0 | 04/03/2014 | ND | 207 | 104 | 200 | 5.18 | |

Surrogate: 1-Chlorooctane 126 % 65.2-140

Surrogate: 1-Chlorooctadecane 118 % 63.6-154

Cardinal Laboratories

*=Accredited Analyte

PLEASE NOTE: Liability and Damages. Cardinal's liability and client's exclusive remedy for any claim arising, whether based in contract or tort, shall be limited to the amount paid by client for analyses. All claims, including those for negligence and any other cause whatsoever shall be deemed waived unless made in writing and received by Cardinal within thirty (30) days after completion of the applicable service. In no event shall Cardinal be liable for incidental or consequential damages, including, without limitation, business interruptions, loss of use, or loss of profits incurred by client, its subsidiaries, affiliates or successors arising out of or related to the performance of the services hereunder by Cardinal, regardless of whether such claim is based upon any of the above stated reasons or otherwise. Results relate only to the samples identified above. This report shall not be reproduced except in full with written approval of Cardinal Laboratories.



Celey D. Keene, Lab Director/Quality Manager

Analytical Results For:

 LINN OPERATING-HOBBS
 BRIAN WALL
 2130 W. BENDER
 HOBBS NM, 88240
 Fax To: (575) 738-1740

 Received: 04/03/2014
 Reported: 04/04/2014
 Project Name: CAPROCK MALJAMAR UNITS
 Project Number: NONE GIVEN
 Project Location: ANGEL RANCH

 Sampling Date: 04/03/2014
 Sampling Type: Soil
 Sampling Condition: Cool & Intact
 Sample Received By: Jodi Henson

Sample ID: 1-2 CMU #89 (H400990-02)

| BTEX 8021B | | mg/kg | | Analyzed By: MS | | | | | |
|----------------|--------|-----------------|------------|-----------------|------|------------|---------------|-------|-----------|
| Analyte | Result | Reporting Limit | Analyzed | Method Blank | BS | % Recovery | True Value QC | RPD | Qualifier |
| Benzene* | <0.050 | 0.050 | 04/03/2014 | ND | 2.59 | 129 | 2.00 | 1.32 | |
| Toluene* | <0.050 | 0.050 | 04/03/2014 | ND | 2.50 | 125 | 2.00 | 0.955 | |
| Ethylbenzene* | <0.050 | 0.050 | 04/03/2014 | ND | 2.47 | 124 | 2.00 | 1.10 | |
| Total Xylenes* | <0.150 | 0.150 | 04/03/2014 | ND | 7.08 | 118 | 6.00 | 0.890 | |
| Total BTEX | <0.300 | 0.300 | 04/03/2014 | ND | | | | | |

Surrogate: 4-Bromofluorobenzene (PIE) 115 % 89.4-126

| Chloride, SM4500Cl-B | | mg/kg | | Analyzed By: AP | | | | | |
|----------------------|--------|-----------------|------------|-----------------|-----|------------|---------------|------|-----------|
| Analyte | Result | Reporting Limit | Analyzed | Method Blank | BS | % Recovery | True Value QC | RPD | Qualifier |
| Chloride | 32.0 | 16.0 | 04/04/2014 | ND | 400 | 100 | 400 | 3.92 | |

| TPH 8015M | | mg/kg | | Analyzed By: ms | | | | | |
|--------------|--------|-----------------|------------|-----------------|-----|------------|---------------|-------|-----------|
| Analyte | Result | Reporting Limit | Analyzed | Method Blank | BS | % Recovery | True Value QC | RPD | Qualifier |
| GRO C6-C10 | <10.0 | 10.0 | 04/03/2014 | ND | 194 | 97.1 | 200 | 0.486 | |
| DRO >C10-C28 | <10.0 | 10.0 | 04/03/2014 | ND | 207 | 104 | 200 | 5.18 | |

Surrogate: 1-Chlorooctane 112 % 65.2-140

Surrogate: 1-Chlorooctadecane 110 % 63.6-154

Cardinal Laboratories

*=Accredited Analyte

PLEASE NOTE: Liability and Damages. Cardinal's liability and client's exclusive remedy for any claim arising, whether based in contract or tort, shall be limited to the amount paid by client for analyses. All claims, including those for negligence and any other cause whatsoever shall be deemed waived unless made in writing and received by Cardinal within thirty (30) days after completion of the applicable service. In no event shall Cardinal be liable for incidental or consequential damages, including, without limitation, business interruptions, loss of use, or loss of profits incurred by client, its subsidiaries, affiliates or successors arising out of or related to the performance of the services hereunder by Cardinal, regardless of whether such claim is based upon any of the above stated reasons or otherwise. Results relate only to the samples identified above. This report shall not be reproduced except in full with written approval of Cardinal Laboratories.



Celey D. Keene, Lab Director/Quality Manager

Analytical Results For:

LINN OPERATING-HOBBS
 BRIAN WALL
 2130 W. BENDER
 HOBBS NM, 88240
 Fax To: (575) 738-1740

Received: 04/03/2014
 Reported: 04/04/2014
 Project Name: CAPROCK MALJAMAR UNITS
 Project Number: NONE GIVEN
 Project Location: ANGEL RANCH

Sampling Date: 04/03/2014
 Sampling Type: Soil
 Sampling Condition: Cool & Intact
 Sample Received By: Jodi Henson

Sample ID: 1-3 CMU #89 (H400990-03)

| BTEX 8021B | | | mg/kg | | Analyzed By: MS | | | | | |
|----------------|--------|-----------------|------------|--------------|-----------------|------------|---------------|-------|-----------|--|
| Analyte | Result | Reporting Limit | Analyzed | Method Blank | BS | % Recovery | True Value QC | RPD | Qualifier | |
| Benzene* | <0.050 | 0.050 | 04/03/2014 | ND | 2.59 | 129 | 2.00 | 1.32 | | |
| Toluene* | <0.050 | 0.050 | 04/03/2014 | ND | 2.50 | 125 | 2.00 | 0.955 | | |
| Ethylbenzene* | <0.050 | 0.050 | 04/03/2014 | ND | 2.47 | 124 | 2.00 | 1.10 | | |
| Total Xylenes* | <0.150 | 0.150 | 04/03/2014 | ND | 7.08 | 118 | 6.00 | 0.890 | | |
| Total BTEX | <0.300 | 0.300 | 04/03/2014 | ND | | | | | | |

Surrogate: 4-Bromofluorobenzene (PIE) 113 % 89.4-126

| Chloride, SM4500Cl-B | | mg/kg | | Analyzed By: AP | | | | | |
|----------------------|--------|-----------------|------------|-----------------|-----|------------|---------------|------|-----------|
| Analyte | Result | Reporting Limit | Analyzed | Method Blank | BS | % Recovery | True Value QC | RPD | Qualifier |
| Chloride | 496 | 16.0 | 04/04/2014 | ND | 400 | 100 | 400 | 3.92 | |
| TPH 8015M | | mg/kg | | Analyzed By: ms | | | | | |

| TPH 8015M | | mg/kg | | Analyzed By: ms | | | | | |
|--------------|--------|-----------------|------------|-----------------|-----|------------|---------------|-------|-----------|
| Analyte | Result | Reporting Limit | Analyzed | Method Blank | BS | % Recovery | True Value QC | RPD | Qualifier |
| GRO C6-C10 | <10.0 | 10.0 | 04/03/2014 | ND | 194 | 97.1 | 200 | 0.486 | |
| DRO >C10-C28 | 91.3 | 10.0 | 04/03/2014 | ND | 207 | 104 | 200 | 5.18 | |

Surrogate: 1-Chlorooctane 118 % 65.2-140

Surrogate: 1-Chlorooctadecane 114 % 63.6-154

Cardinal Laboratories

*=Accredited Analyte

PLEASE NOTE: Liability and Damages. Cardinal's liability and client's exclusive remedy for any claim arising, whether based in contract or tort, shall be limited to the amount paid by client for analyses. All claims, including those for negligence and any other cause whatsoever shall be deemed waived unless made in writing and received by Cardinal within thirty (30) days after completion of the applicable service. In no event shall Cardinal be liable for incidental or consequential damages, including, without limitation, business interruptions, loss of use, or loss of profits incurred by client, its subsidiaries, affiliates or successors arising out of or related to the performance of the services hereunder by Cardinal, regardless of whether such claim is based upon any of the above stated reasons or otherwise. Results relate only to the samples identified above. This report shall not be reproduced except in full with written approval of Cardinal Laboratories.



Celey D. Keene, Lab Director/Quality Manager

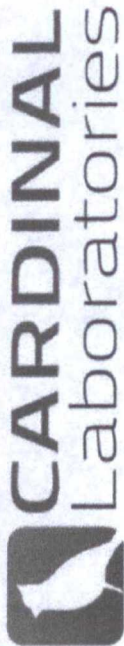

101 East Marland, Hobbs, NM 88240
(575) 393-2326 FAX (575) 393-2476

CHAIN-OF-CUSTODY AND ANALYSIS REQUEST

| BILL TO | | ANALYSIS REQUEST | | | | | | | | | | | | | | | | | |
|---|------------------|--------------------|--------------|-------------|------------|------|-----|--------|--------|------------|------------|--------|---------|----------|--------|------|-----|-----|----|
| P.O. #: | | | | | | | | | | | | | | | | | | | |
| Company: <i>Linn Operating</i> | | | | | | | | | | | | | | | | | | | |
| Address: <i>State line Rv Park #36</i> | | | | | | | | | | | | | | | | | | | |
| City: <i>Hobbs</i> | | | | | | | | | | | | | | | | | | | |
| Phone #: <i>940-395-3308</i> | | | | | | | | | | | | | | | | | | | |
| Fax #: <i>940-395-3308</i> | | | | | | | | | | | | | | | | | | | |
| Project Owner: <i>Linn O.P.</i> | | | | | | | | | | | | | | | | | | | |
| Project Name: <i>Caplock Maljamar units</i> | | | | | | | | | | | | | | | | | | | |
| Project Location: <i>CMU Angel Ranch</i> | | | | | | | | | | | | | | | | | | | |
| Sampler Name: <i>Dusty Boggs</i> | | | | | | | | | | | | | | | | | | | |
| Lab I.D. | Sample I.D. | (G) RAB OR (C) OMP | # CONTAINERS | GROUNDWATER | WASTEWATER | SOIL | OIL | SLUDGE | OTHER: | ACID/BASE: | ICE / COOL | OTHER: | PRESERV | SAMPLING | DATE | TIME | TPH | RTX | CL |
| H400910 | 1-1-2 CMU # 89 | G | 1 | ✓ | ✓ | ✓ | ✓ | ✓ | ✓ | ✓ | ✓ | ✓ | ✓ | ✓ | 4/5/14 | ✓ | ✓ | ✓ | ✓ |
| | 2-1-2 CMU # 89 | G | 1 | ✓ | ✓ | ✓ | ✓ | ✓ | ✓ | ✓ | ✓ | ✓ | ✓ | ✓ | | ✓ | ✓ | ✓ | ✓ |
| | 3-1-3 CMU # 89 | G | 1 | ✓ | ✓ | ✓ | ✓ | ✓ | ✓ | ✓ | ✓ | ✓ | ✓ | ✓ | | ✓ | ✓ | ✓ | ✓ |
| | 4-2-1 CMU # 195 | G | 1 | ✓ | ✓ | ✓ | ✓ | ✓ | ✓ | ✓ | ✓ | ✓ | ✓ | ✓ | | ✓ | ✓ | ✓ | ✓ |
| | 5-2-2 CMU # 195 | G | 1 | ✓ | ✓ | ✓ | ✓ | ✓ | ✓ | ✓ | ✓ | ✓ | ✓ | ✓ | | ✓ | ✓ | ✓ | ✓ |
| | 6-2-3 CMU # 195 | G | 1 | ✓ | ✓ | ✓ | ✓ | ✓ | ✓ | ✓ | ✓ | ✓ | ✓ | ✓ | | ✓ | ✓ | ✓ | ✓ |
| | 7-2-4 CMU # 195 | G | 1 | ✓ | ✓ | ✓ | ✓ | ✓ | ✓ | ✓ | ✓ | ✓ | ✓ | ✓ | | ✓ | ✓ | ✓ | ✓ |
| | 8-2-5 CMU # 195 | G | 1 | ✓ | ✓ | ✓ | ✓ | ✓ | ✓ | ✓ | ✓ | ✓ | ✓ | ✓ | | ✓ | ✓ | ✓ | ✓ |
| | 9-2-6 CMU # 195 | G | 1 | ✓ | ✓ | ✓ | ✓ | ✓ | ✓ | ✓ | ✓ | ✓ | ✓ | ✓ | | ✓ | ✓ | ✓ | ✓ |
| | 10-2-7 CMU # 195 | G | 1 | ✓ | ✓ | ✓ | ✓ | ✓ | ✓ | ✓ | ✓ | ✓ | ✓ | ✓ | | ✓ | ✓ | ✓ | ✓ |

PLEASE NOTE: Liability and Damages. Cardinal's liability and client's exclusive remedy for any claim arising whether based in contract or tort, shall be limited to the amount paid by the client for the analyses. All claims including those for negligence and any other causes whatsoever shall be deemed waived unless made in writing and received by Cardinal within 30 days after completion of the applicable service. In no event shall Cardinal be liable for incidental or consequential damages, including without limitation, business interruptions, loss of use, or loss of profits incurred by client, its subsidiaries, affiliates or successors arising out of or related to the performance of services hereunder by Cardinal.

| | | | |
|--|---|---------------------------------|------------------------------|
| Relinquished By: <i>[Signature]</i> | Date: <i>4-3-14</i> | Received By: <i>[Signature]</i> | Date: <i>4-4-14</i> |
| Relinquished By: <i>[Signature]</i> | Date: <i>4-4-14</i> | Received By: <i>[Signature]</i> | Date: <i>4-4-14</i> |
| Delivered By: (Circle One) Sampler - UPS - Bus - Other: | Sample Condition Cool <input checked="" type="checkbox"/> Intact <input checked="" type="checkbox"/> | Checked By: <i>[Signature]</i> | Initials: <i>[Signature]</i> |

† Cardinal cannot accept verbal changes. Please fax written changes to (575) 393-2326

#54