

1 EXISTING KING TUT FED #1H	2 EXISTING WINDWARD FED #1H	3 PROPOSED WINDWARD FED #5H	4 PROPOSED WINDWARD FED #6H
5 EXISTING KING TUT FED #2H	6 EXISTING WINDWARD FED #2H	7 PROPOSED WINDWARD FED #7H	8 PROPOSED WINDWARD FED #8H
9 PROPOSED WINDWARD FED #14H	10 EXISTING KING TUT FED #3H	11 EXISTING WINDWARD FED #3H	12 PROPOSED WINDWARD FED #9H
13 PROPOSED WINDWARD FED #10H	14 PROPOSED WINDWARD FED #15H	16 PROPOSED WINDWARD FED #12H	17 EXISTING WINDWARD FED #4H
18 EXISTING KING TUT FED #4H			

R  
3  
1  
E

R  
3  
2  
E

T 24 S

**LEGEND**

- WELL
- WELLPAD
- EXISTING ROAD

**WINDWARD FEDERAL #11H**

SEC: 30	TWP: 24 S.	RGE: 32 E.	ELEVATION: 3547.8'
STATE: NEW MEXICO		COUNTY: LEA	210' FNL & 560' FEL
W.O. # 16-185	LEASE: WINDWARD FED		SURVEY: N.M.P.M

0 2,500 5,000 FEET

0 0.125 0.25 0.5 Miles

1 IN = 2,000 FT

LOCATION MAP      TOPO      04/13/2016      A.F.

**CONCHO**
  
 COG PRODUCTION, LLC

---

**HARCROW SURVEYING, LLC.**
  
 2314 W. MAIN ST, ARTESIA, NM 88210
   
 PH: (575) 746-2158 FAX: (575) 746-2158
   
 c.harcrow@harcrowsurveying.com

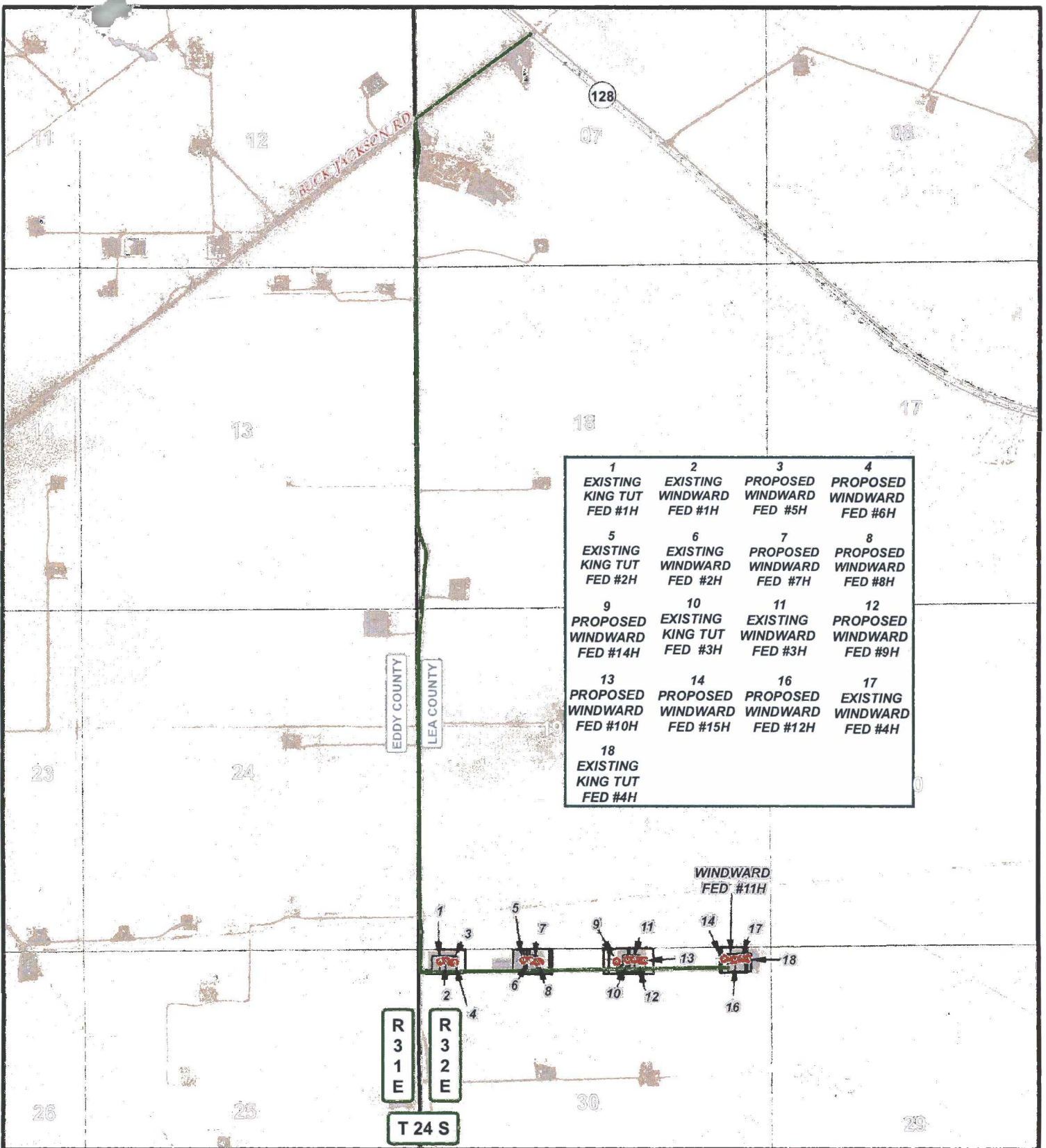

1 EXISTING KING TUT FED #1H	2 EXISTING WINDWARD FED #1H	3 PROPOSED WINDWARD FED #5H	4 PROPOSED WINDWARD FED #6H
5 EXISTING KING TUT FED #2H	6 EXISTING WINDWARD FED #2H	7 PROPOSED WINDWARD FED #7H	8 PROPOSED WINDWARD FED #8H
9 PROPOSED WINDWARD FED #14H	10 EXISTING KING TUT FED #3H	11 EXISTING WINDWARD FED #3H	12 PROPOSED WINDWARD FED #9H
13 PROPOSED WINDWARD FED #10H	14 PROPOSED WINDWARD FED #15H	16 PROPOSED WINDWARD FED #12H	17 EXISTING WINDWARD FED #4H
18 EXISTING KING TUT FED #4H			

R  
3  
1  
E

R  
3  
2  
E

T 24 S

WINDWARD  
FED #11H

**LEGEND**

- WELL
- WELLPAD
- EXISTING ROAD

**WINDWARD FEDERAL #11H**

SEC: 30    TWP: 24 S.    RGE: 32 E.    ELEVATION: 3547.8'

STATE: NEW MEXICO    COUNTY: LEA    210' FNL & 260' FEL

W.O. # 16-185    LEASE: WINDWARD FED    SURVEY: N.M.P.M

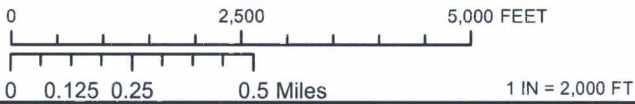

LOCATION MAP    IMAGERY    04/13/2016    A.F.

**CONCHO**  
COG PRODUCTION, LLC

**HARCROW SURVEYING, LLC.**  
2314 W. MAIN ST, ARTESIA, NM 88210  
PH: (575) 746-2158 FAX: (575) 746-2158  
c.harcrow@harcrowsurveying.com

# EXHIBIT 2

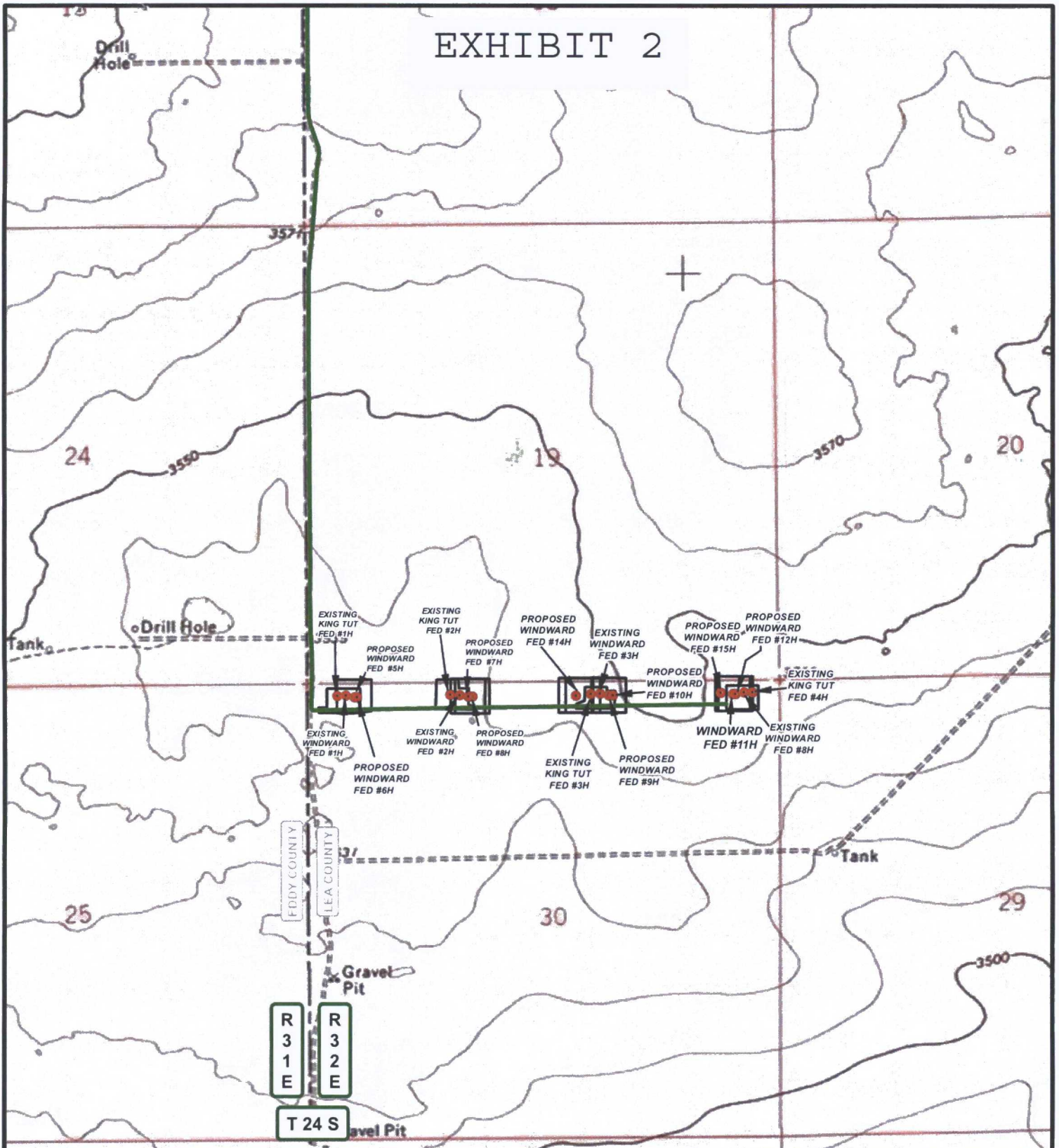

## LEGEND

- WELL
- WELLPAD
- EXISTING ROAD

## WINDWARD FEDERAL #11H

SEC: 30	TWP: 24 S.	RGE: 32 E.	ELEVATION: 3547.8'
STATE: NEW MEXICO		COUNTY: LEA	210' FNL & 560' FEL
W.O. # 16-185		LEASE: WINDWARD FED	SURVEY: N.M.P.M

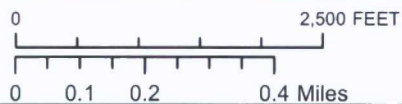

LOCATION MAP      TOPO ROAD      04/13/2016      A.F.



COG PRODUCTION, LLC



HARCROW SURVEYING, LLC.  
 2314 W. MAIN ST, ARTESIA, NM 88210  
 PH: (575) 746-2158 FAX: (575) 746-2158  
 c.harcrow@harcrowsurveying.com

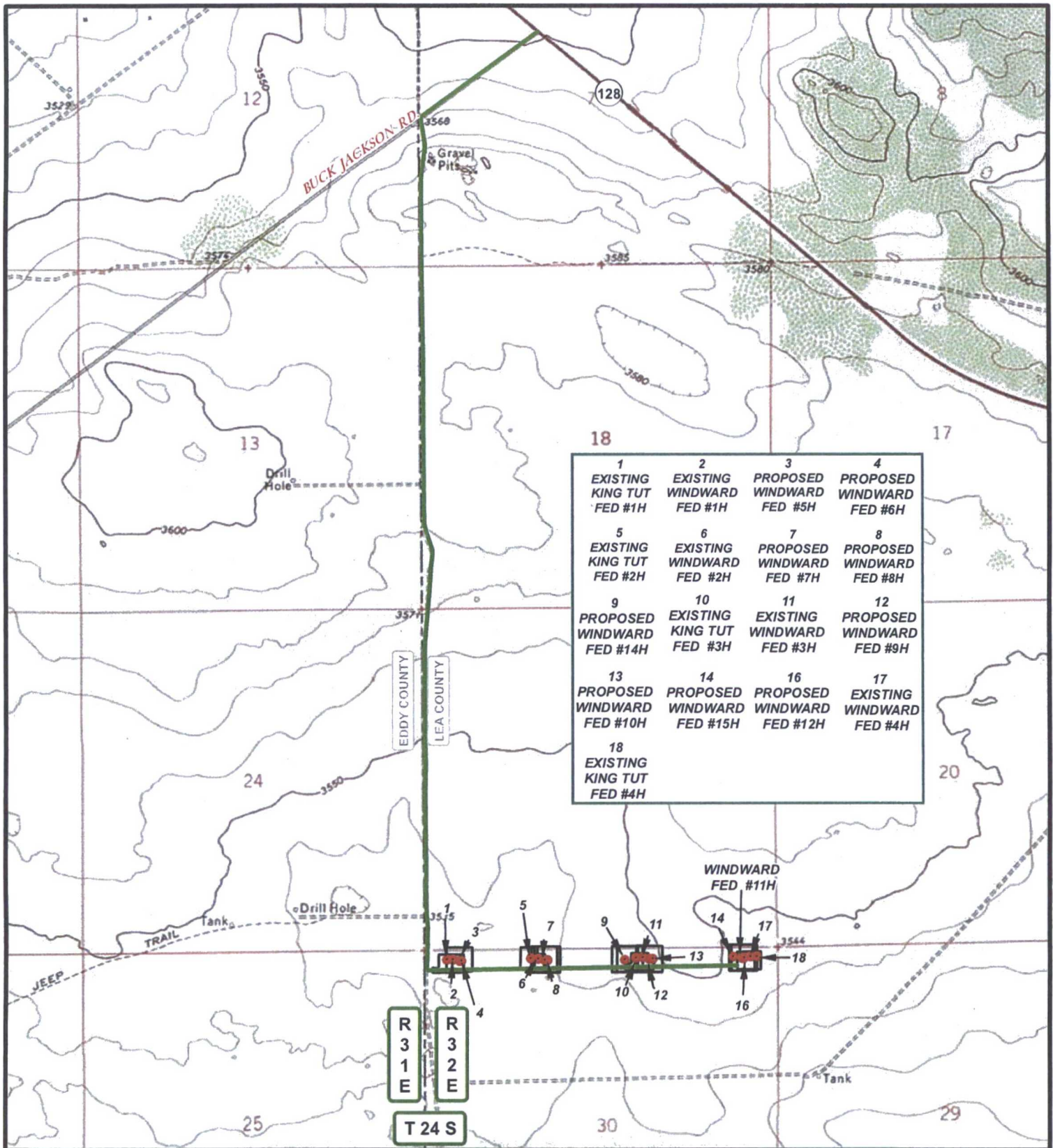

**LEGEND**

- WELL
- WELLPAD
- EXISTING ROAD

**WINDWARD FEDERAL #11H**

SEC: 30	TWP: 24 S.	RGE: 32 E.	ELEVATION: 3547.8'
STATE: NEW MEXICO		COUNTY: LEA	210' FNL & 560' FEL
W.O. # 16-185		LEASE: WINDWARD FED	SURVEY: N.M.P.M

0 2,500 5,000 FEET

0 0.125 0.25 0.5 Miles 1 IN = 2,000 FT

LOCATION MAP TOPO 04/13/2016 A.F.

  
**CONCHO**  
 COG PRODUCTION, LLC

  
**HARCROW SURVEYING, LLC.**  
 2314 W. MAIN ST, ARTESIA, NM 88210  
 PH: (575) 746-2158 FAX: (575) 746-2158  
 c.harcrow@harcrowsurveying.com

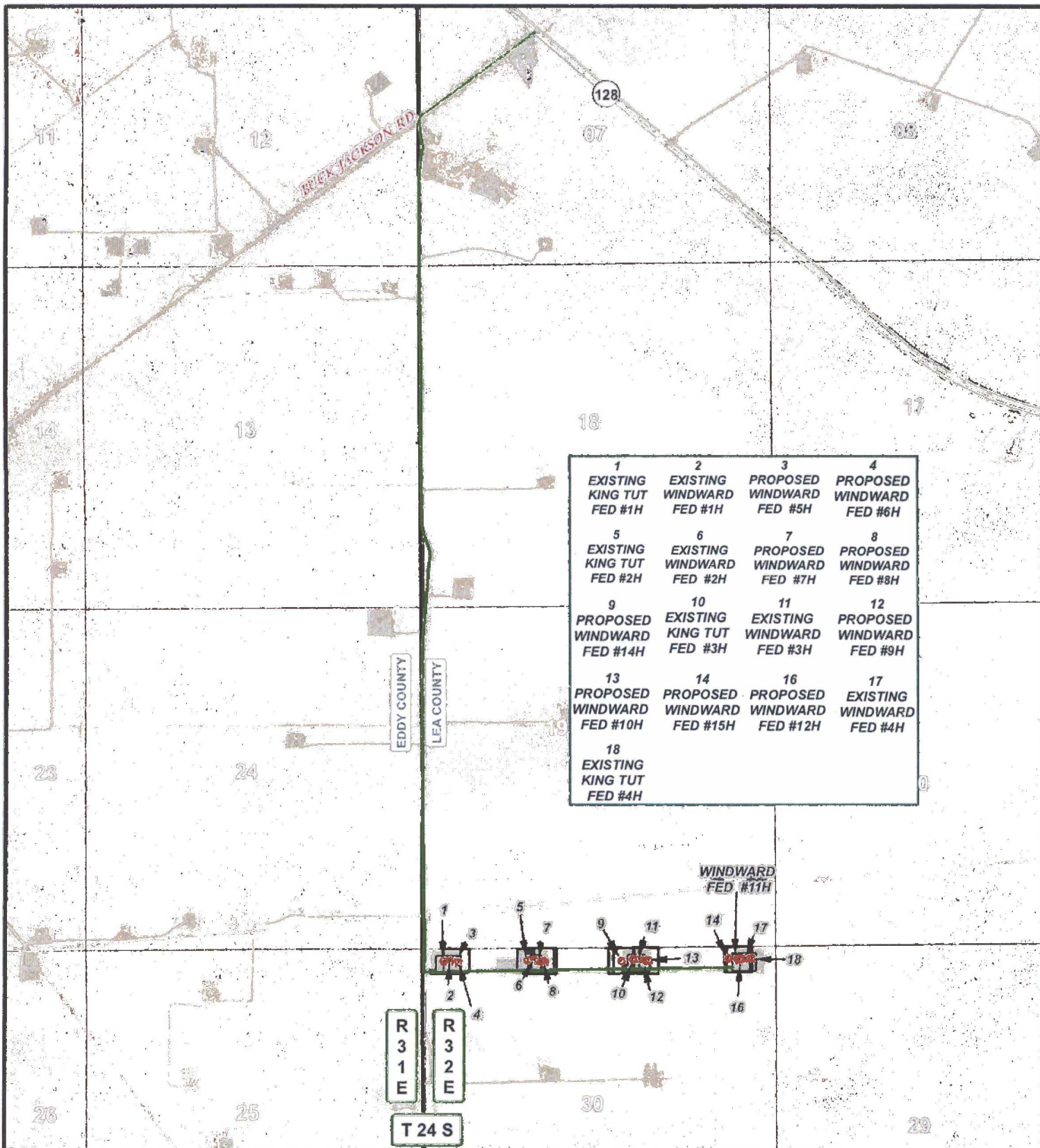

1 EXISTING KING TUT FED #1H	2 EXISTING WINDWARD FED #1H	3 PROPOSED WINDWARD FED #5H	4 PROPOSED WINDWARD FED #6H
5 EXISTING KING TUT FED #2H	6 EXISTING WINDWARD FED #2H	7 PROPOSED WINDWARD FED #7H	8 PROPOSED WINDWARD FED #8H
9 PROPOSED WINDWARD FED #14H	10 EXISTING KING TUT FED #3H	11 EXISTING WINDWARD FED #3H	12 PROPOSED WINDWARD FED #9H
13 PROPOSED WINDWARD FED #10H	14 PROPOSED WINDWARD FED #15H	16 PROPOSED WINDWARD FED #12H	17 EXISTING WINDWARD FED #4H
18 EXISTING KING TUT FED #4H			

**LEGEND**

- WELL
- WELLPAD
- EXISTING ROAD

**WINDWARD FEDERAL #11H**

SEC: 30    TWP: 24 S.    RGE: 32 E.    ELEVATION: 3547.8'  
 STATE: NEW MEXICO    COUNTY: LEA    210' FNL & 260' FEL  
 W.O. # 16-185    LEASE: WINDWARD FED    SURVEY: N.M.P.M

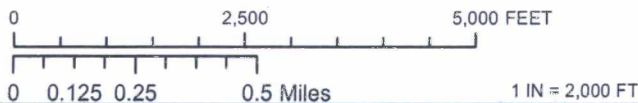

LOCATION MAP    IMAGERY    04/13/2016    A.F.



COG PRODUCTION, LLC

**HARCROW SURVEYING, LLC.**  
 2314 W. MAIN ST, ARTESIA, NM 88210  
 PH: (575) 746-2158 FAX: (575) 746-2158  
 c.harcrow@harcrowsurveying.com

# EXHIBIT 2

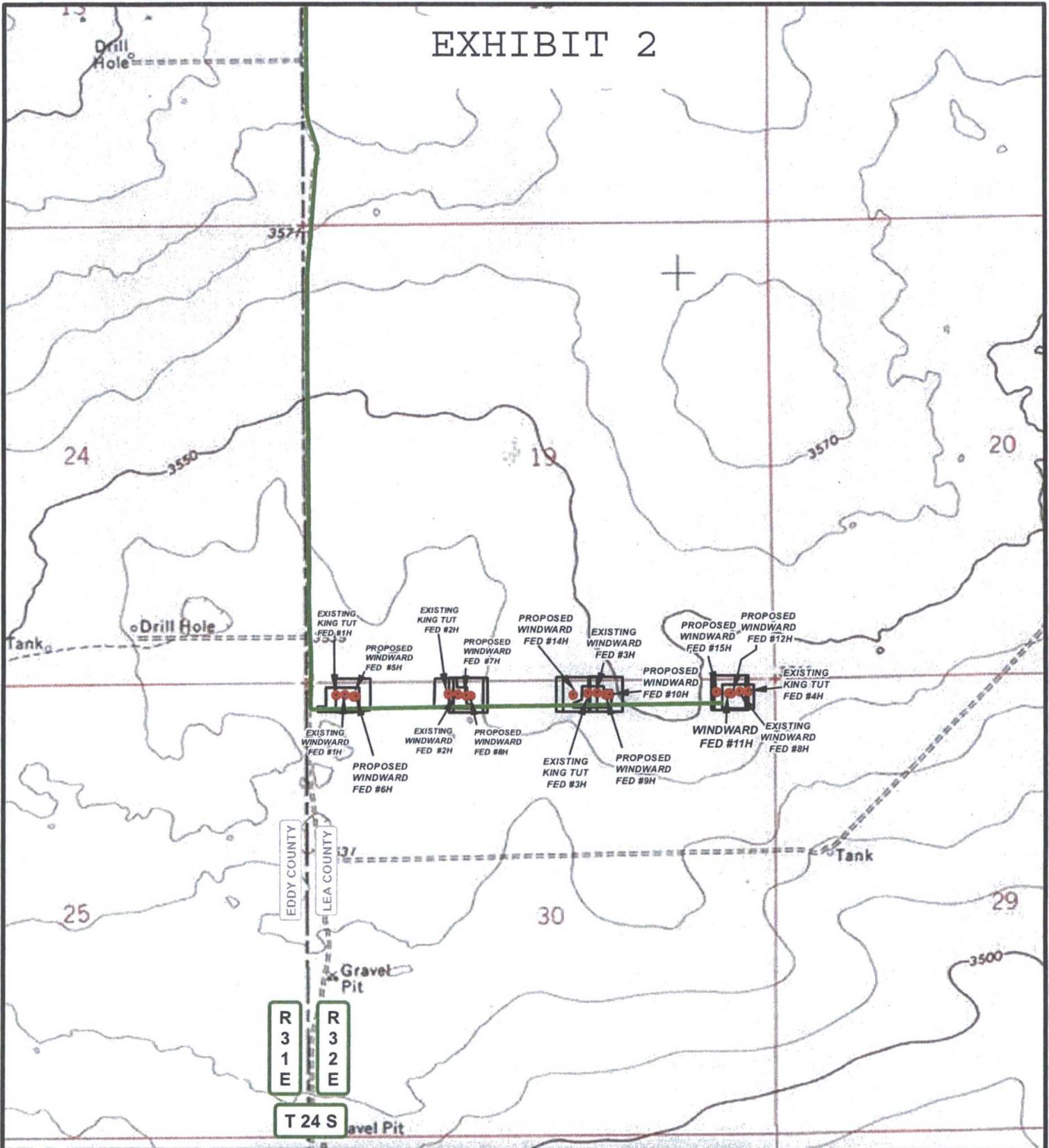

## LEGEND

- WELL
- WELLPAD
- EXISTING ROAD

## WINDWARD FEDERAL #11H

SEC: 30	TWP: 24 S.	RGE: 32 E.	ELEVATION: 3547.8'
STATE: NEW MEXICO		COUNTY: LEA	210' FNL & 560' FEL
W.O. # 16-185	LEASE: WINDWARD FED		SURVEY: N.M.P.M



LOCATION MAP TOPO ROAD 04/13/2016 A.F.



COG PRODUCTION, LLC

**HARCROW SURVEYING, LLC.**  
 2314 W. MAIN ST, ARTESIA, NM 88210  
 PH: (575) 746-2158 FAX: (575) 746-2158  
 c.harcrow@harcrowsurveying.com

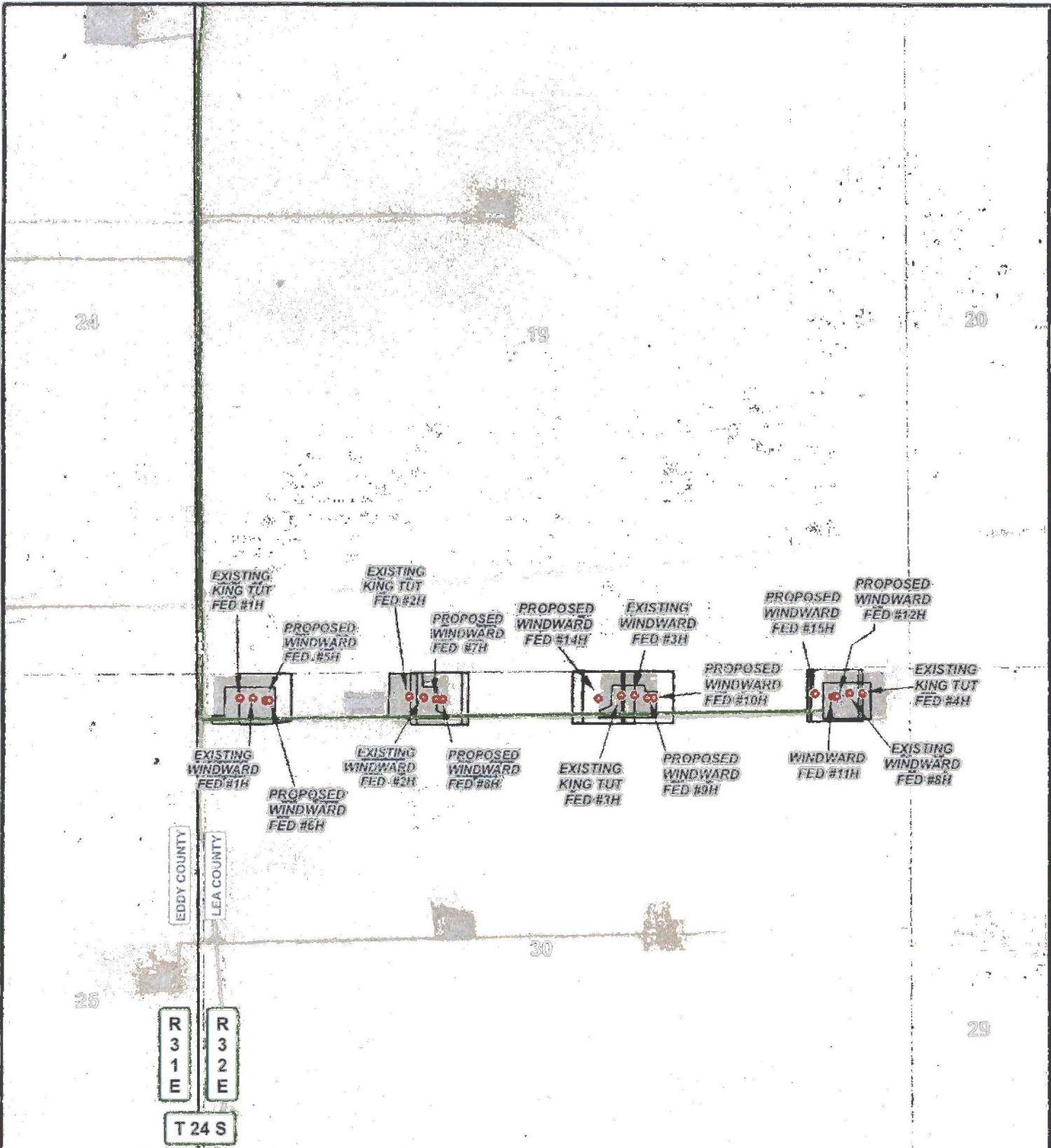

**LEGEND**

- WELL
- WELLPAD
- EXISTING ROAD

**WINDWARD FEDERAL #11H**

SEC: 30	TWP: 24 S.	RGE: 32 E.	ELEVATION: 3547.8'
STATE: NEW MEXICO	COUNTY: LEA	210' FNL & 560' FEL	
W.O. # 16-185	LEASE: WINDWARD FED	SURVEY: N.M.P.M	

0 0.05 0.1 0.2 Miles

0 2,500 FEET

1 IN = 1,000 FT

**CONCHO**

COG PRODUCTION, LLC

**HARCROW SURVEYING, LLC.**  
 2314 W. MAIN ST, ARTESIA, NM 88210  
 PH: (575) 746-2158 FAX: (575) 746-2158  
 c.harcrow@harcrowsurveying.com

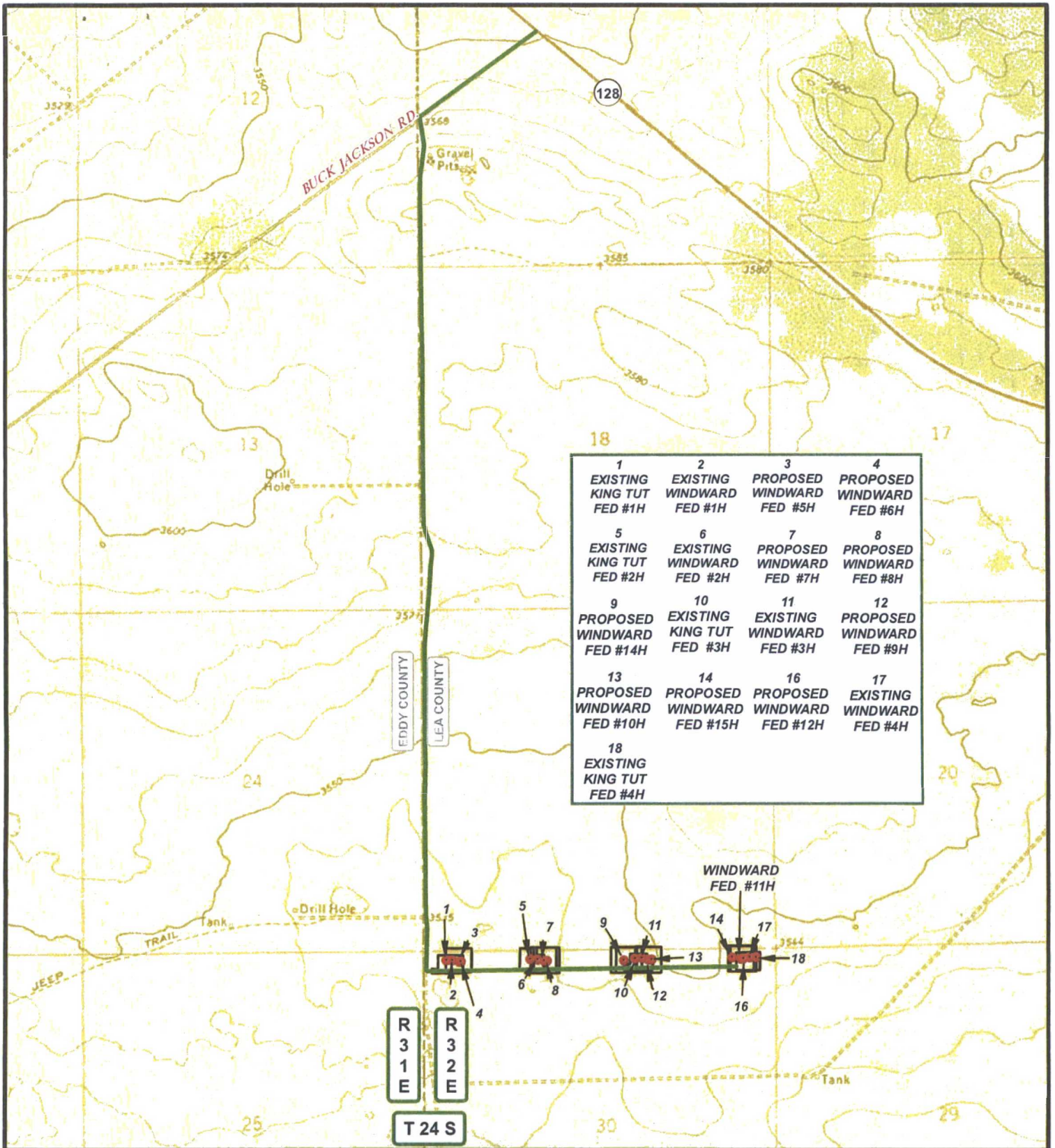

**LEGEND**

- WELL
- WELLPAD
- EXISTING ROAD
- US BLM

**WINDWARD FEDERAL #11H**

SEC: 30 TWP: 24 S. RGE: 32 E. ELEVATION: 3547.8'  
 STATE: NEW MEXICO COUNTY: LEA 210' FNL & 560' FEL  
 W.O. # 16-185 LEASE: WINDWARD FED SURVEY: N.M.P.M

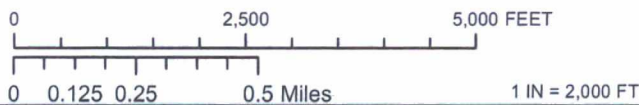

LOCATION MAP LAND STATUS 04/13/2016 A.F.



COG PRODUCTION, LLC

**HARCROW SURVEYING, LLC.**  
 2314 W. MAIN ST, ARTESIA, NM 88210  
 PH: (575) 746-2158 FAX: (575) 746-2158  
 c.harcrow@harcrowsurveying.com



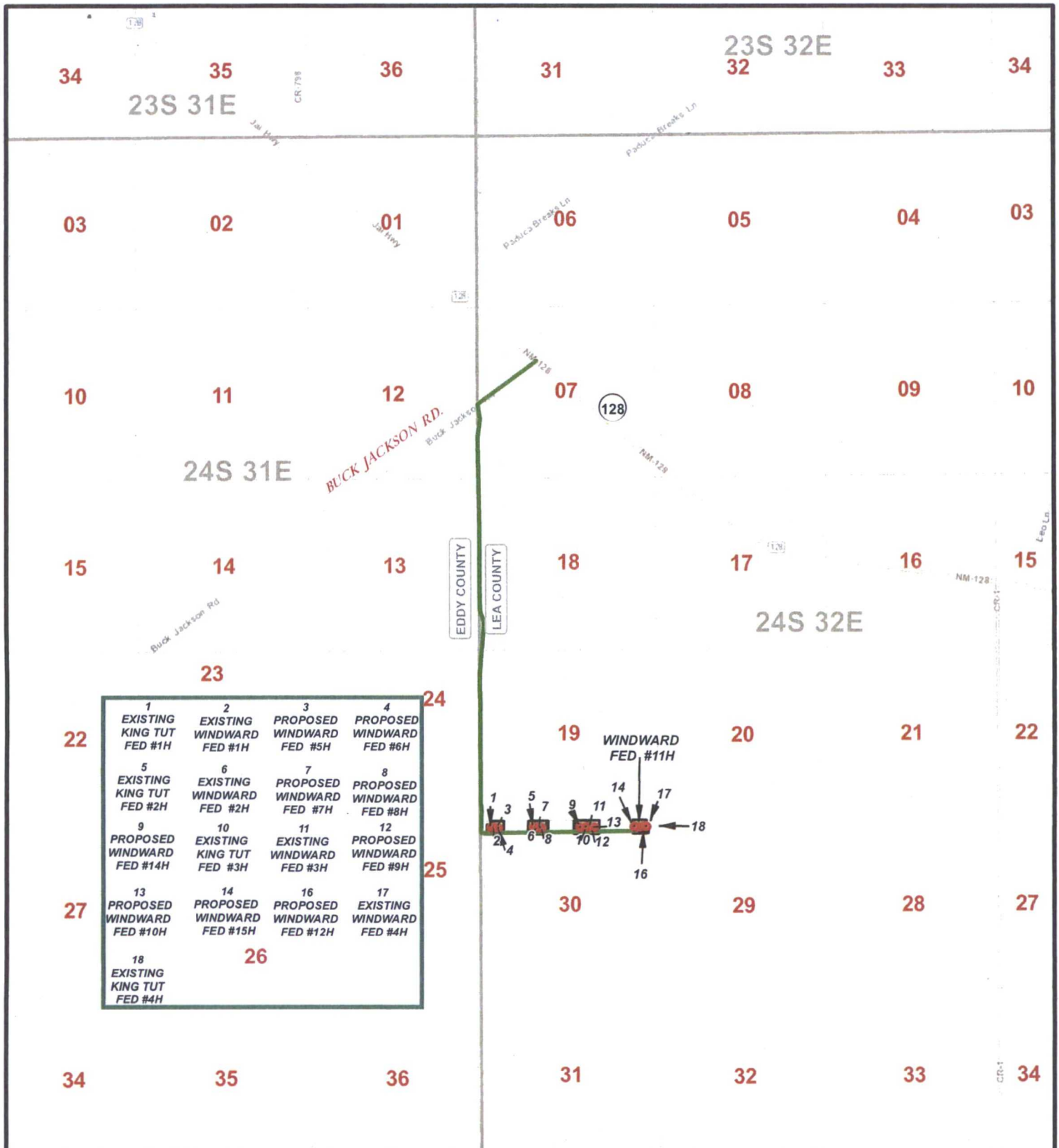

1 EXISTING KING TUT FED #1H	2 EXISTING WINDWARD FED #1H	3 PROPOSED WINDWARD FED #5H	4 PROPOSED WINDWARD FED #6H
5 EXISTING KING TUT FED #2H	6 EXISTING WINDWARD FED #2H	7 PROPOSED WINDWARD FED #7H	8 PROPOSED WINDWARD FED #8H
9 PROPOSED WINDWARD FED #14H	10 EXISTING KING TUT FED #3H	11 EXISTING WINDWARD FED #3H	12 PROPOSED WINDWARD FED #9H
13 PROPOSED WINDWARD FED #10H	14 PROPOSED WINDWARD FED #15H	16 PROPOSED WINDWARD FED #12H	17 EXISTING WINDWARD FED #4H
18 EXISTING KING TUT FED #4H	26		

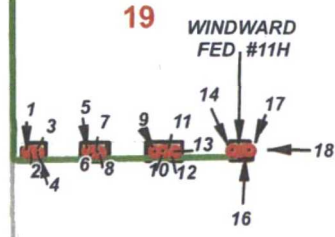

**LEGEND**

- WELL
- WELLPAD
- EXISTING ROAD

**WINDWARD FEDERAL #11H**

SEC: 30	TWP: 24 S.	RGE: 32 E.	ELEVATION: 3547.8'
STATE: NEW MEXICO		COUNTY: LEA	210' FNL & 560' FEL
W.O. # 16-185	LEASE: WINDWARD FED		SURVEY: N.M.P.M

0 2,500 5,000 7,500 10,000 FEET  
0 0.275 0.55 1.1 Miles 1 IN = 4,000 FT

VICINITY MAP 04/13/2016 A.F.

**CONCHO**  
COG PRODUCTION, LLC

**HARCROW SURVEYING, LLC.**  
2314 W. MAIN ST, ARTESIA, NM 88210  
PH: (575) 746-2158 FAX: (575) 746-2158  
c.harcrow@harcrowsurveying.com

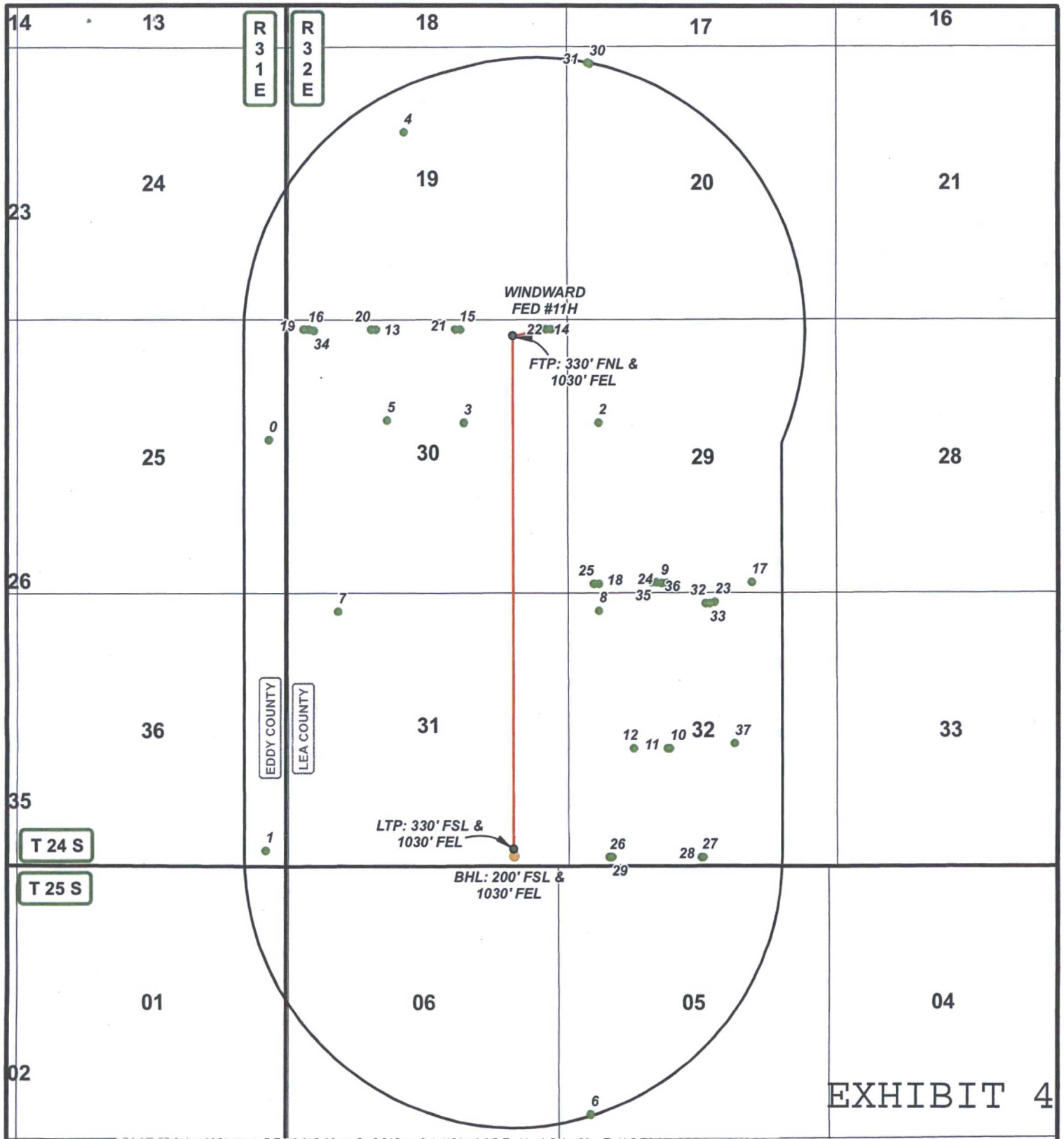

**EXHIBIT 4**

DATA FOR "WELLS WITHIN 1 MI." IS TAKEN FROM THE NEW MEXICO EMNRD WEBSITE. THE DATA HAS BEEN UPDATED THROUGH OCTOBER 29, 2016.

**LEGEND**

- WELL
- BOTTOMHOLE
- WELLS WITHIN 1 MI.
- 1 MI. BUFFER

**WINDWARD FEDERAL COM #11H**

SEC: 30	TWP: 24 S.	RGE: 32 E.	ELEVATION: 3547.8'
STATE: NEW MEXICO		COUNTY: LEA	210' FNL & 560' FEL
W.O. # 16-1087		LEASE: WINDWARD FED	SURVEY: N.M.P.M

0 2,500 5,000 7,500 FEET

0 0.2 0.4 0.8 Miles

1 IN = 3,000 FT

1 MILE MAP      12/16/2016      J.H.

**CONCHO**

COG PRODUCTION, LLC

**HARCROW SURVEYING, LLC.**

2314 W. MAIN ST, ARTESIA, NM 88210  
 PH: (575) 746-2158 FAX: (575) 746-2158  
 c.harcrow@harcrowsurveying.com