

District I
1625 N. French Dr., Hobbs, NM 88240
District II
1301 W. Grand Avenue, Artesia, NM 88210
District III
1000 Rio Brazos Road, Aztec, NM 87410
District IV
1220 S. St. Francis Dr., Santa Fe, NM 87505

State of New Mexico
Energy Minerals and Natural Resources

Form C-101
May 27, 2004

Oil Conservation Division
1220 South St. Francis Dr.
Santa Fe, NM 87505

RECEIVED
MAR 30 2006
AMENDED REPORT

OCD-ARTESIA

APPLICATION FOR PERMIT TO DRILL, RE-ENTER, DEEPEN, PLUGBACK, OR ADD A ZONE

Operator Name and Address Marbob Energy Corporation, P.O. Box 227, Artesia, NM 88211-0227		OGRID Number 14049
Property Code 35574		API Number 30 - 025-24912
Property Name Bell 17 State		Well No. 1
Proposed Pool 1 Undesignated	Proposed Pool 2	

UL or lot no. G	Section 17	Township 16S	Range 33E	Lot Idn	Feet from the 1980'	North/South line North	Feet from the 1980'	East/West line East	County Lea
--------------------	---------------	-----------------	--------------	---------	------------------------	---------------------------	------------------------	------------------------	---------------

Proposed Bottom Hole Location If Different From Surface

UL or lot no.	Section	Township	Range	Lot Idn	Feet from the	North/South line	Feet from the	East/West line	County
---------------	---------	----------	-------	---------	---------------	------------------	---------------	----------------	--------

Additional Well Information

Work Type Code E	Well Type Code G	Cable/Rotary	Lease Type Code S	Ground Level Elevation 4240'
Multiple	Proposed Depth 4300'	Formation Penrose	Contractor	Spud Date 4/28/06
Depth to Groundwater 200		Distance from nearest fresh water well > 1000		Distance from nearest surface water > 1000
Pit: Liner: Synthetic <input checked="" type="checkbox"/> 12 mils thick Clay <input type="checkbox"/> Pit Volume: 3000 bbls Drilling Method: Fresh Water <input type="checkbox"/> Brine <input checked="" type="checkbox"/> Diesel/Oil-based <input type="checkbox"/> Gas/Air <input type="checkbox"/>				

Proposed Casing and Cement Program

Hole Size	Casing Size	Casing weight/foot	Setting Depth	Sacks of Cement	Estimated TOC
17 1/2"	13 3/8"	54.5#	407'	400	Circ
11"	8 5/8"	32#	4455'	375	3400'

22 Describe the proposed program. If this application is to DEEPEN or PLUG BACK, give the data on the present productive zone and proposed new productive zone. Describe the blowout prevention program, if any. Use additional sheets if necessary.

Reentry

Plan to drill out cement plugs 0-103' and 347'-521' (top of 8 5/8"), dress off 8 5/8" stub, run 8 5/8" / 24 / J55 / STC from 521' to surface and cement from 521' to surface with 250 sx Class "C" with 2% CaCl2 (14.8 ppg, 1.32 cfps).

Will drill out cement 521' to 571', 1281'-1450', and 2530'-2750' then clean out to ± 4300' PBD. Will pressure test the 8 5/8" casing to 500 psi and test the Penrose 3880'-3900' on rod pump. The Penrose will be acidized with 1000 gals. 7 1/2% HCl and proppant fractured with 40,000 lbs. sand.

If the 8 5/8" won't test, will run 5 1/2" / 17 / J55 / STC casing to approximately 4300' and cement it to surface.

23 I hereby certify that the information given above is true and complete to the best of my knowledge and belief. I further certify that the drilling pit will be constructed according to NMOCD guidelines ☐, a general permit ☒, or an (attached) alternative OCD-approved plan ☐.

Printed name: Nancy T. Bratcher

Title: Land Department

E-mail Address: landtech@marbob.com

Date: 3/28/06

Phone: 505-748-3303

OIL CONSERVATION DIVISION

Approved by:

Title:

Approval Date:

Conditions of Approval Attached ☐

Expiration Date:

District I

1625 N. French Dr., Hobbs, NM 88240

District II

1301 W. Grand Avenue, Artesia, NM 88210

District III

1000 Rio Brazos Rd., Aztec, NM 87410

District IV

1220 S. St. Francis Dr., Santa Fe, NM 87505

State of New Mexico
Energy, Minerals & Natural Resources Department
OIL CONSERVATION DIVISION
1220 South St. Francis Dr.
Santa Fe, NM 87505

Form C-102

Revised October 12, 2005

Submit to Appropriate District Office

State Lease - 4 Copies

Fee Lease - 3 Copies

☐ AMENDED REPORT**WELL LOCATION AND ACREAGE DEDICATION PLAT**

¹ API Number 30-025-28530	² Pool Code 3356D	³ Pool Name Undesignated <i>Hume Queen West</i>
⁴ Property Code 35574	⁵ Property Name Bell 17 State	
⁷ OGRID No. 14049	⁸ Operator Name Marbob Energy Corporation	
		⁶ Well Number 1
		⁹ Elevation 4240

¹⁰ Surface Location

UL or lot no.	Section	Township	Range	Lot Idn	Feet from the	North/South line	Feet from the	East/West line	County
G	17	16S	33E		1980'	North	1980'	East	Lea

¹¹ Bottom Hole Location If Different From Surface

UL or lot no.	Section	Township	Range	Lot Idn	Feet from the	North/South line	Feet from the	East/West line	County

¹² Dedicated Acres 40	¹³ Joint or Infill	¹⁴ Consolidation Code	¹⁵ Order No.
--	-------------------------------	----------------------------------	-------------------------

No allowable will be assigned to this completion until all interests have been consolidated or a non-standard unit has been approved by the division.

<div style="text-align: center;"> </div>	<div> ¹⁷ OPERATOR CERTIFICATION <i>I hereby certify that the information contained herein is true and complete to the best of my knowledge and belief, and that this organization either owns a working interest or unleased mineral interest in the land including the proposed bottom hole location or has a right to drill this well at this location pursuant to a contract with an owner of such a mineral or working interest, or to a voluntary pooling agreement or a compulsory pooling order heretofore entered by the division.</i> </div> <div style="margin-top: 10px;"> <div style="display: flex; justify-content: space-between;"> <div><i>Nancy Bratcher</i></div> <div>3/28/06</div> </div> <div style="display: flex; justify-content: space-between; font-size: small;"> Signature Date </div> <div style="margin-top: 10px;"> <div>Nancy T. Bratcher</div> <div style="font-size: x-small;">Printed Name</div> </div> </div> <div> ¹⁸ SURVEYOR CERTIFICATION <i>I hereby certify that the well location shown on this plat was plotted from field notes of actual surveys made by me or under my supervision, and that the same is true and correct to the best of my belief.</i> </div> <div style="margin-top: 10px;"> <div>Date of Survey</div> <div>Signature and Seal of Professional Surveyor:</div> <div style="margin-top: 20px;">Certificate Number</div> </div>
--	---

43-782	500 SHEETS FULL	5 SQUARE
42-361	500 SHEETS CYCLASE	5 SQUARE
42-362	500 SHEETS EXT. CASE	5 SQUARE
42-363	500 SHEETS EXT. CASE	5 SQUARE
42-362	500 RECYCLED WHITE	5 SQUARE
42-363	500 RECYCLED WHITE	5 SQUARE

March 1, 1998

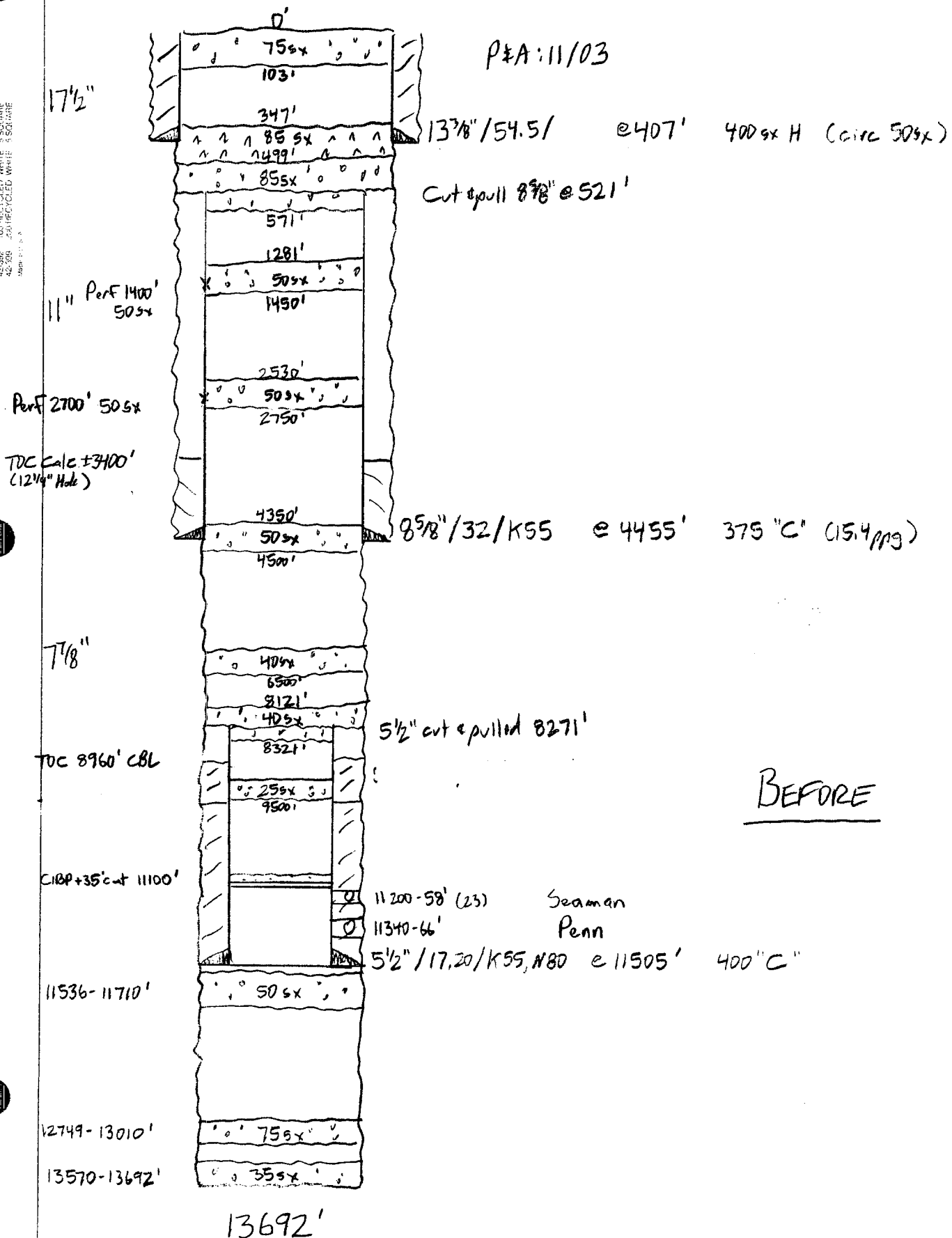

13-782	500 SHEETS, FILLER	5 SQUARE
42-381	50 SHEETS EYE-EASE®	5 SQUARE
42-382	100 SHEETS EYE-EASE®	5 SQUARE
42-389	200 SHEETS EYE-EASE®	5 SQUARE
42-392	100 RECYCLED WHITE	5 SQUARE
42-399	200 RECYCLED WHITE	5 SQUARE

Made in U.S.A.

National® Brand

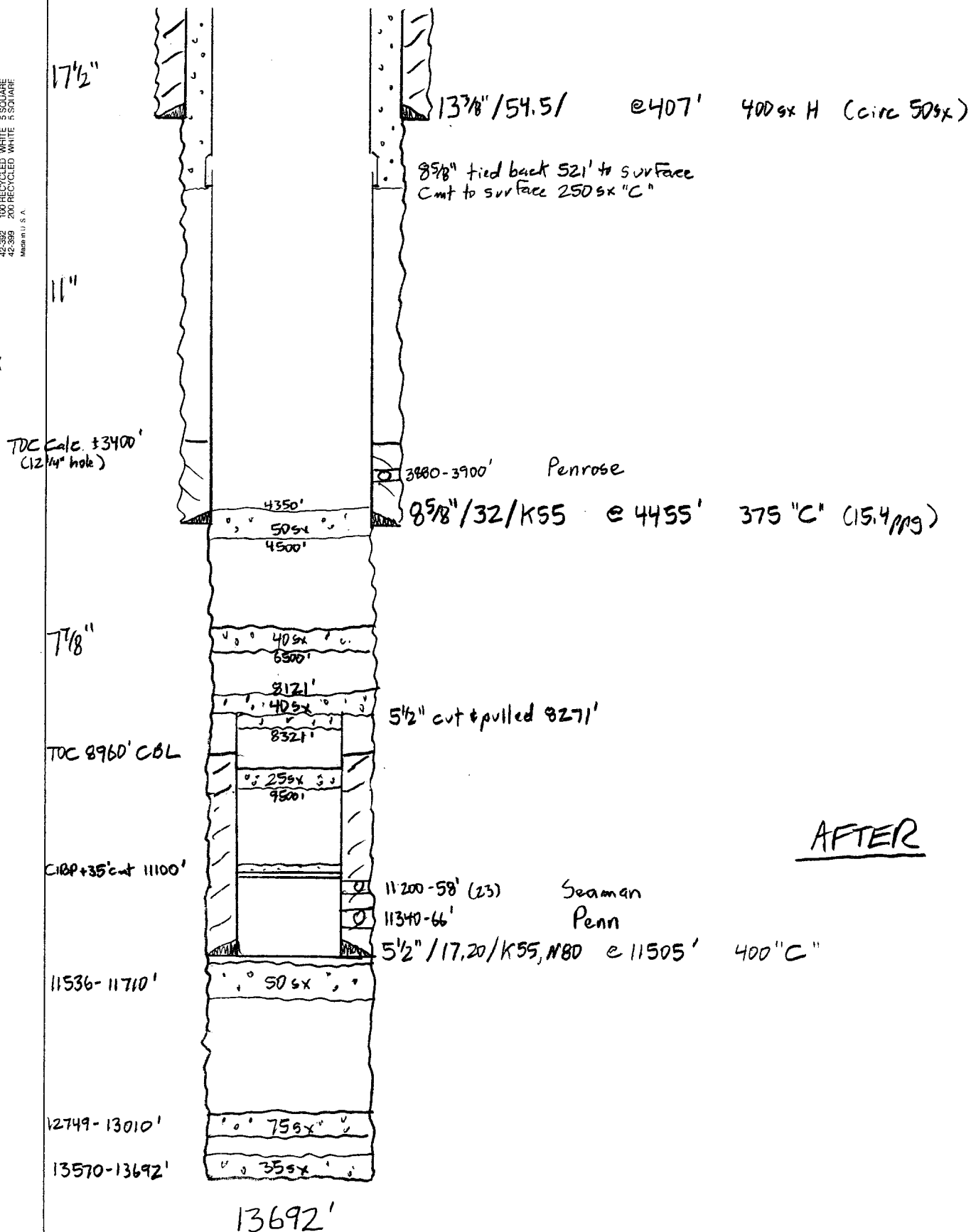

NEW MEXICO OIL CONSERVATION COMMISSION
WELL LOCATION AND ACREAGE DEDICATION PLAT

Form O-112
Supersedes O-128
Effective 1-1-65

All distances must be from the outer boundary of the Section

County		Section		Twp		Range		Meridian	
Dalco		Bell 17 State		1					
Section	Block	Subsection	Block	Subsection	Block	Subsection	Block	Subsection	Block
G	17	16 South	33 East	Lea					
Acres		North		1980		East			
4240.3									

- Outline the acreage dedicated to the subject well by colored pencil or hatchure marks on the plat below.
- If more than one lease is dedicated to the well, outline each and identify the ownership thereof (both as to working interest and royalty).
- If more than one lease of different ownership is dedicated to the well, have the interests of all owners been consolidated by communitization, unitization, force-pooling etc?

☐ Yes ☐ No If answer is "yes" type of consolidation _____

If answer is "no" list the owners and tract descriptions which have actually been consolidated (Use reverse side of this form if necessary) _____

No allowable will be assigned to the well until all interests have been consolidated (by communitization, unitization, forced-pooling, or otherwise) or until a non-standard unit, eliminating such interests, has been approved by the Commission.

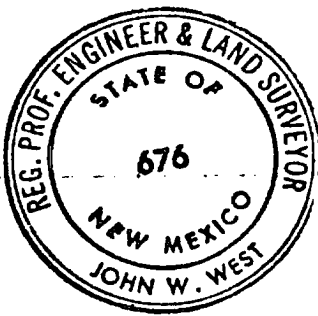
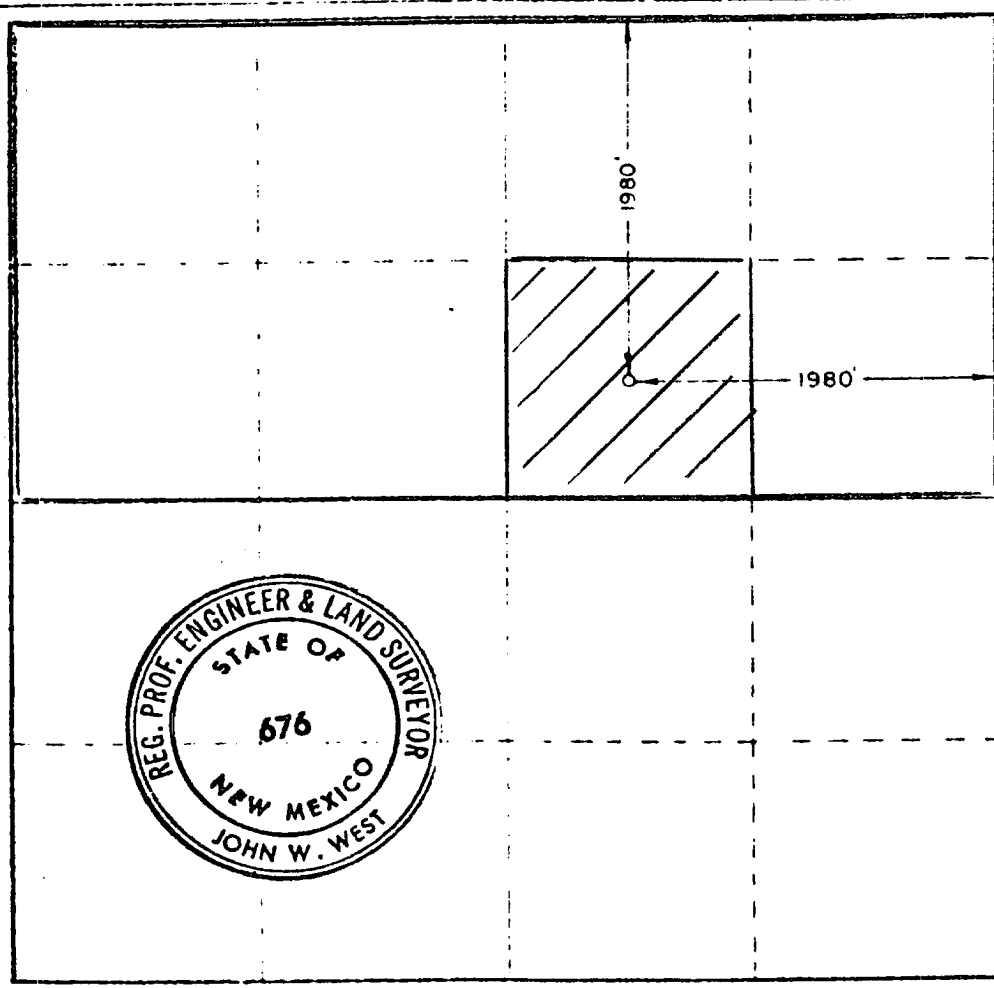

CERTIFICATION

I hereby certify that the information contained herein is true and complete to the best of my knowledge and belief.

C. H. Madsen

C. H. Madsen

Division Geologist

Dalco Oil Company

June 30, 1975

I hereby certify that the well location shown on this plat was plotted from field notes of actual surveys made by me or under my supervision and that the same is true and correct to the best of my knowledge and belief.

November 9, 1974

John W. West

676

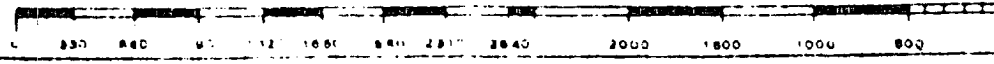

 The sender of this message has requested a read receipt. [Click here to send a receipt.](#)

Mull, Donna, EMNRD

From: Phillips, Dorothy, EMNRD
To: Mull, Donna, EMNRD
Cc:
Subject: RE: Financial Assurance Requirement
Attachments:

Sent: Fri 4/7/2006 8:06 AM

All have blanket bonds and none appear on Jane's list.

From: Mull, Donna, EMNRD
Sent: Friday, April 07, 2006 7:44 AM
To: Phillips, Dorothy, EMNRD
Cc: Macquesten, Gail, EMNRD; Sanchez, Daniel J., EMNRD
Subject: Financial Assurance Requirement

Dorothy,

Is the Financial Assurance Requirement for these Operators OK ?

EOG Resources Inc (7377)
Pogo Producing Co (17891)
Range Operating New Mexico Inc (227588)
Harvard Petroleum Corp (10155)
Yates Petroleum Corp (25575)
Platinum Exploration Inc (227103)
Marbob Energy Corp (14049)
Chevron USA Inc (4323)
Marathon Oil Co (14021)
XTO Energy Inc (5380)

Please let me know. Donna