

UNITED STATES  
DEPARTMENT OF THE INTERIOR  
BUREAU OF LAND MANAGEMENT

OCD Hobbs

FORM APPROVED  
OMB NO. 1004-0137  
Expires: January 31, 2018**SUNDRY NOTICES AND REPORTS ON WELLS**  
*Do not use this form for proposals to drill or to recomplete an abandoned well. Use form 3160-3 (APD) for such proposals.*5. Lease Serial No.  
NMNM082

6. If Indian, Allottee or Tribe Name

7. If Unit or CA/Agreement, Name and/or No.

SUBMIT IN TRIPLICATE - Other instructions on page 2

NOV 29 2017

## 1. Type of Well

☒ Oil Well ☐ Gas Well ☐ Other

RECEIVED

8. Well Name and No.  
PERRY 22 FEDERAL COM 4H

## 2. Name of Operator

CIMAREX ENERGY COMPANY OF CO

Contact: ARICKA EASTERLING

E-Mail: aeasterling@cimarex.com

## 9. API Well No.

30-025-41608-00-X1

## 3a. Address

202 S CHEYENNE AVE. SUITE 1000  
TULSA, OK 74103

## 3b. Phone No. (include area code)

Ph: 918-560-7060

10. Field and Pool or Exploratory Area  
LEA

## 4. Location of Well (Footage, Sec., T., R., M., or Survey Description)

Sec 22 T20S R34E NWNW 0330FNL 0660FWL  
32.335538 N Lat, 103.331627 W Lon

## 11. County or Parish, State

LEA COUNTY, NM

## 12. CHECK THE APPROPRIATE BOX(ES) TO INDICATE NATURE OF NOTICE, REPORT, OR OTHER DATA

TYPE OF SUBMISSION	TYPE OF ACTION			
<input checked="" type="checkbox"/> Notice of Intent	<input type="checkbox"/> Acidize	<input type="checkbox"/> Deepen	<input type="checkbox"/> Production (Start/Resume)	<input type="checkbox"/> Water Shut-Off
<input type="checkbox"/> Subsequent Report	<input type="checkbox"/> Alter Casing	<input type="checkbox"/> Hydraulic Fracturing	<input type="checkbox"/> Reclamation	<input type="checkbox"/> Well Integrity
<input type="checkbox"/> Final Abandonment Notice	<input type="checkbox"/> Casing Repair	<input type="checkbox"/> New Construction	<input type="checkbox"/> Recomplete	<input checked="" type="checkbox"/> Other
	<input type="checkbox"/> Change Plans	<input type="checkbox"/> Plug and Abandon	<input type="checkbox"/> Temporarily Abandon	Change to Original APD
	<input type="checkbox"/> Convert to Injection	<input type="checkbox"/> Plug Back	<input type="checkbox"/> Water Disposal	

13. Describe Proposed or Completed Operation: Clearly state all pertinent details, including estimated starting date of any proposed work and approximate duration thereof. If the proposal is to deepen directionally or recomplete horizontally, give subsurface locations and measured and true vertical depths of all pertinent markers and zones. Attach the Bond under which the work will be performed or provide the Bond No. on file with BLM/BIA. Required subsequent reports must be filed within 30 days following completion of the involved operations. If the operation results in a multiple completion or recompletion in a new interval, a Form 3160-4 must be filed once testing has been completed. Final Abandonment Notices must be filed only after all requirements, including reclamation, have been completed and the operator has determined that the site is ready for final inspection.

Cimarex respectfully requests approval to change the SHL, BHL and completion formation. Cimarex proposes to drill the well as a Wolfcamp there for changing the directional plan. Additional surface disturbance will be required.

Approved:

SHL: 330 FNL &amp; 660 FWL

BHL: 330 FSL &amp; 660 FWL

Proposed:

SHL: 630 FNL &amp; 380 FWL

BHL: 330 FSL &amp; 380 FWL

Cimarex also proposes to construct a battery on the well pad. Additional disturbance is required.

Approved. CCR. See attached Stipulations. 11/16/2017

## 14. I hereby certify that the foregoing is true and correct.

Electronic Submission #380377 verified by the BLM Well Information System

For CIMAREX ENERGY COMPANY OF CO, sent to the Hobbs

Committed to AFMSS for processing by PRISCILLA PEREZ on 07/17/2017 (17PP0425SE)

Name (Printed/Typed) ARICKA EASTERLING

Title REGULATORY ANALYST

Signature

(Electronic Submission)

Date 06/30/2017

## THIS SPACE FOR FEDERAL OR STATE OFFICE USE

Approved By

Title

Date

Conditions of approval, if any, are attached. Approval of this notice does not warrant or certify that the applicant holds legal or equitable title to those rights in the subject lease which would entitle the applicant to conduct operations thereon.

Office

Title 18 U.S.C. Section 1001 and Title 43 U.S.C. Section 1212, make it a crime for any person knowingly and willfully to make to any department or agency of the United States any false, fictitious or fraudulent statements or representations as to any matter within its jurisdiction.

(Instructions on page 2)

\*\* BLM REVISED \*\* BLM REVISED \*\* BLM REVISED \*\* BLM REVISED \*\* BLM REVISED \*\*

KZ

**Additional data for EC transaction #380377 that would not fit on the form**

**32. Additional remarks, continued**

Gas Sales, SWD, Road and Eline specifications listed below.

Gas pipeline: 5063', 12" 8" & 4" steel, buried pipelines

SWD: 5429', 4" surface poly & 12" buried poly pipeline

Road: 1311'

E-line: 718', 480 volt, 4 wire, 3 phase

Please see attached plat, directional plan, drilling plan, location layout, Gas sales route, SWD route, Road route & e-line route for changes regarding the well and well pad.

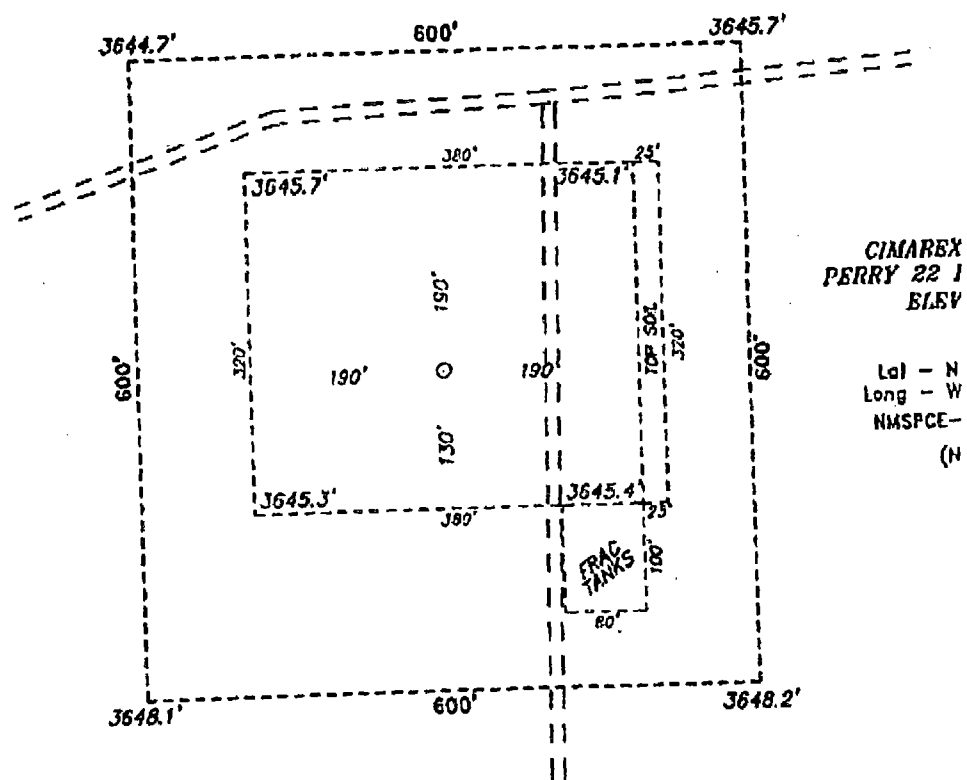

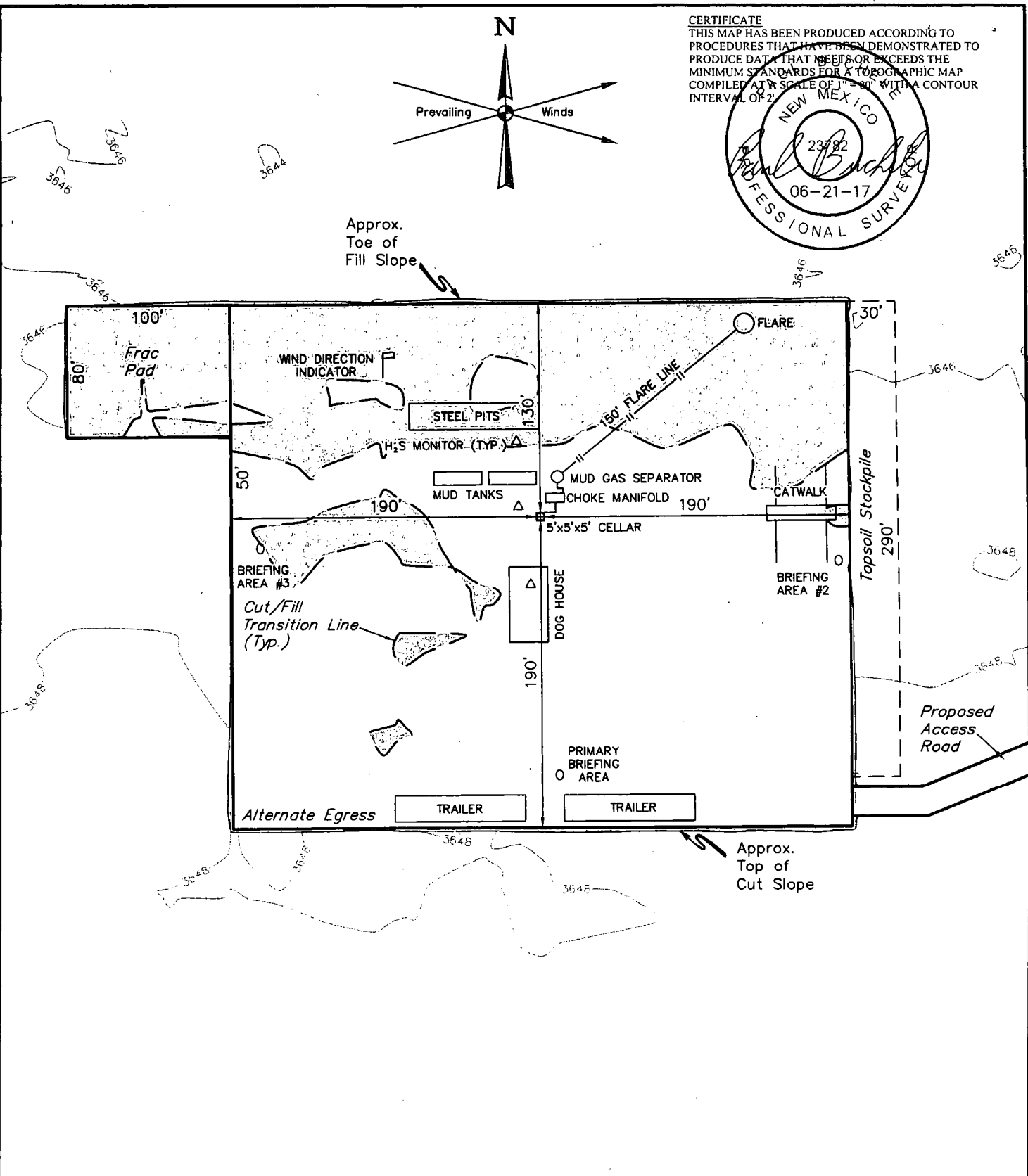

**NOTES:**

- Contours shown at 2' intervals.

**CIMAREX ENERGY CO.**

**PERRY 22 FEDERAL 4H**  
**630' FNL 380' FWL**  
**NW 1/4 NW 1/4, SECTION 22, T20S, R34E, N.M.P.M.**  
**LEA COUNTY, NEW MEXICO**

SURVEYED BY	J.A.V., R.D.	06-08-17	SCALE
DRAWN BY	B.D.H.	06-21-17	1" = 80'

**TYPICAL RIG LAYOUT**

**EXHIBIT D**



**UELS, LLC**  
 Corporate Office \* 85 South 200 East  
 Vernal, UT 84078 \* (435) 789-1017

District I  
1625 N. French Dr., Hobbs, NM 88240  
Phone: (575) 393-6161 Fax: (575) 393-0720  
District II  
811 S. First St., Artesia, NM 88210  
Phone: (575) 748-1283 Fax: (575) 748-9720  
District III  
1000 Rio Brazos Road, Aztec, NM 87410  
Phone: (505) 334-6178 Fax: (505) 334-6170  
District IV  
1220 S. St. Francis Dr., Santa Fe, NM 87505  
Phone: (505) 476-3460 Fax: (505) 476-3462

State of New Mexico  
Energy, Minerals & Natural Resources Department  
**OIL CONSERVATION DIVISION**  
1220 South St. Francis Dr.  
Santa Fe, NM 87505

Form C-102  
Revised August 1, 2011  
Submit one copy to appropriate  
District Office

☐ AMENDED REPORT

**WELL LOCATION AND ACREAGE DEDICATION PLAT**

<sup>1</sup> API Number 30-025-41608	<sup>2</sup> Pool Code 98247	<sup>3</sup> Pool Name Wildcat, Wolfcamp	<sup>4</sup> Property Code	<sup>5</sup> Property Name PERRY 22 FEDERAL	<sup>6</sup> Well Number 4H
<sup>7</sup> OGRID No. 215099	<sup>8</sup> Operator Name CIMAREX ENERGY CO.			<sup>9</sup> Elevation 3647.1'	

<sup>10</sup> Surface Location

UL or lot no.	Section	Township	Range	Lot Idn	Feet from the	North/South line	Feet from the	East/West line	County
D	22	20S	34E		630	NORTH	380	WEST	LEA

<sup>11</sup> Bottom Hole Location If Different From Surface

UL or lot no.	Section	Township	Range	Lot Idn	Feet from the	North/South line	Feet from the	East/West line	County
M	22	20S	34E		330	SOUTH	380	WEST	LEA

<sup>12</sup> Dedicated Acres 320	<sup>13</sup> Joint or Infill	<sup>14</sup> Consolidation Code	<sup>15</sup> Order No.
--------------------------------------	-------------------------------	----------------------------------	-------------------------

No allowable will be assigned to this completion until all interests have been consolidated or a non-standard unit has been approved by the division.

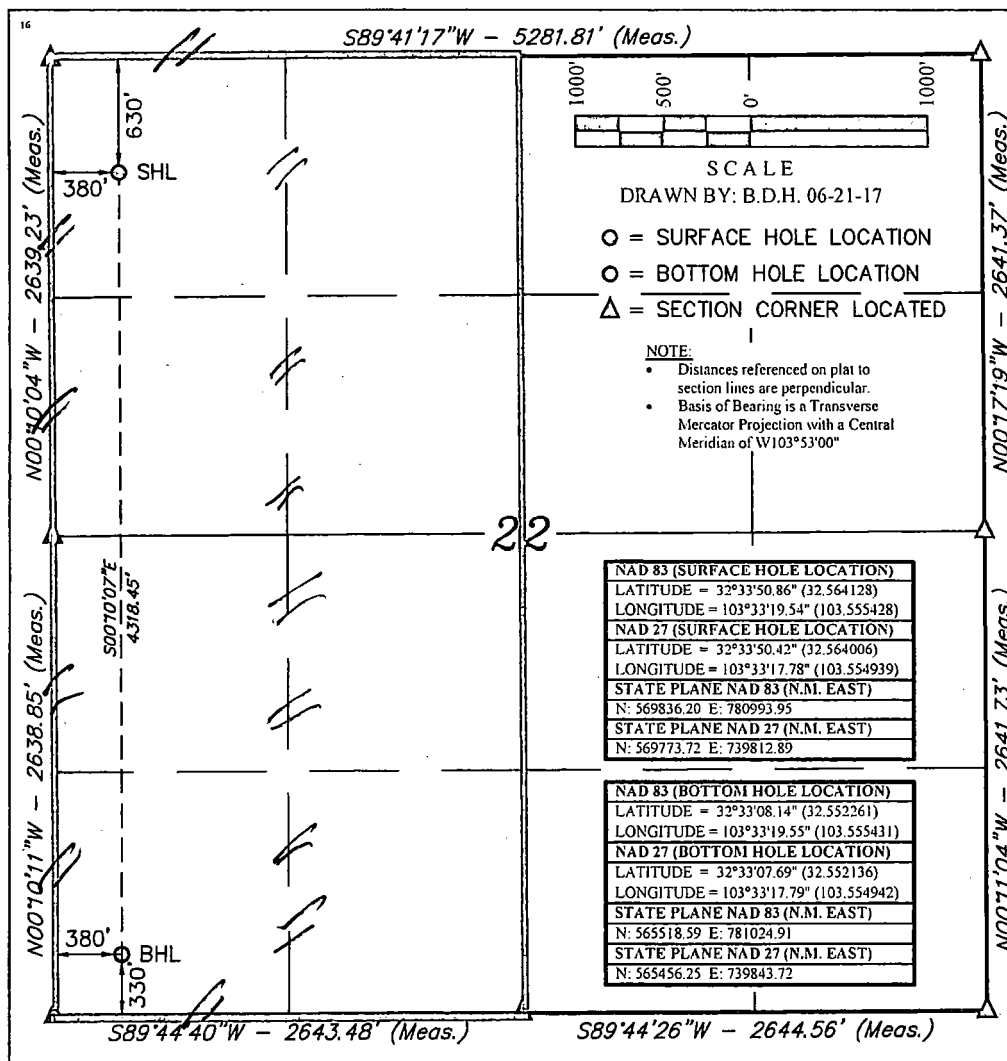

**<sup>17</sup> OPERATOR CERTIFICATION**

I hereby certify that the information contained herein is true and complete to the best of my knowledge and belief, and that this organization either owns a working interest or unleased mineral interest in the land including the proposed bottom hole location or has a right to drill this well at this location pursuant to a contract with an owner of such a mineral or working interest, or to a voluntary pooling agreement or a compulsory pooling order heretofore entered by the division.

*Aricka Easterling* 6/30/17  
Signature Date

Aricka Easterling

Printed Name

aeasterling@cimarex.com

E-mail Address

**<sup>18</sup> SURVEYOR CERTIFICATION**

I hereby certify that the well location shown on this plat was plotted from field notes of actual surveys made by me or under my supervision, and that the same is true and correct to the best of my belief.

JUNE 08, 2017

Date of Survey

Signature and Seal of Professional Surveyor:



Certificate Number:

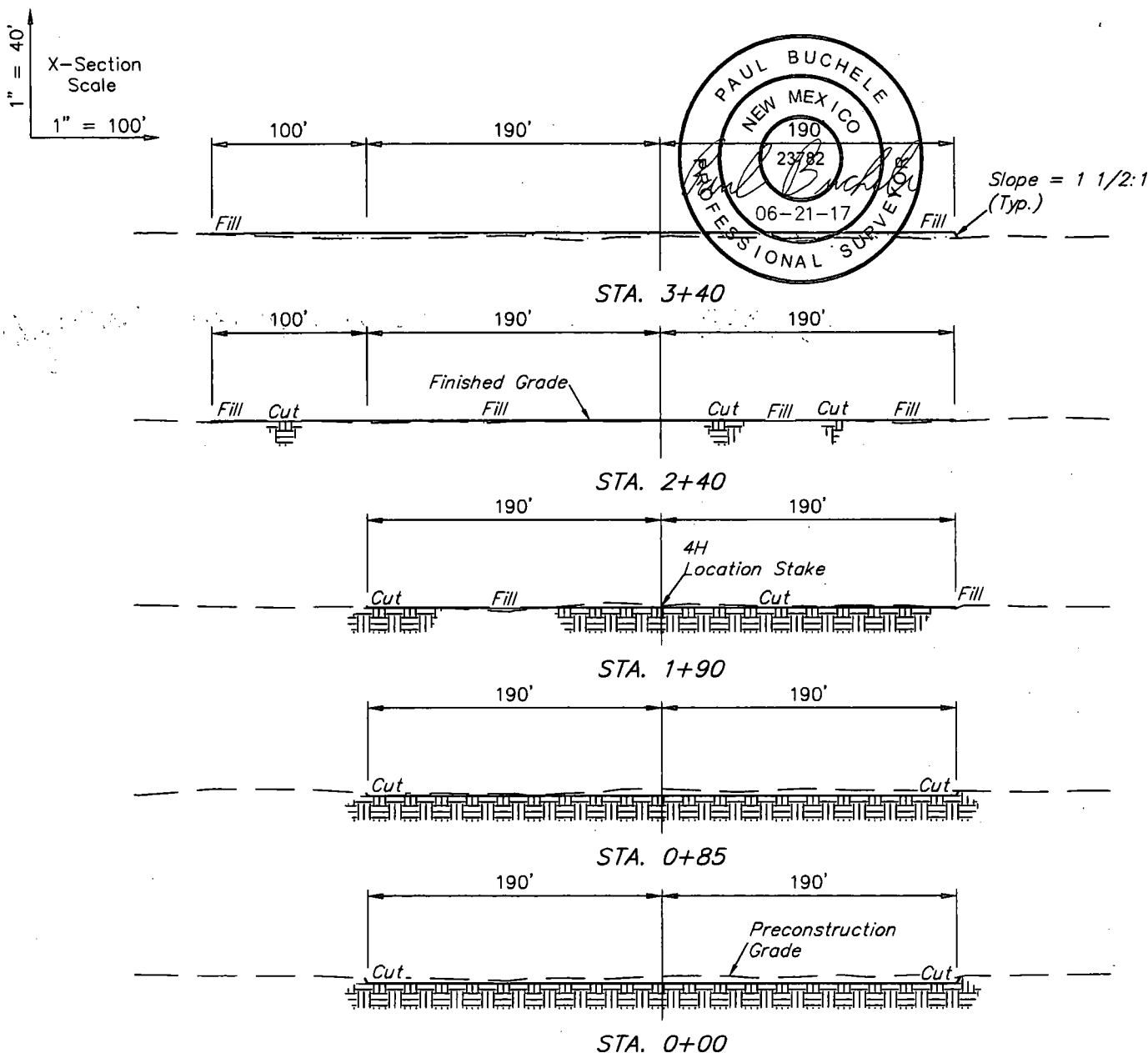

APPROXIMATE EARTHWORK QUANTITIES	
(4") TOPSOIL STRIPPING	1.630 Cu. Yds.
REMAINING LOCATION	1.790 Cu. Yds.
<b>TOTAL CUT</b>	<b>3,420 Cu. Yds.</b>
<b>FILL</b>	<b>1,790 Cu. Yds.</b>
EXCESS MATERIAL	1.630 Cu. Yds.
TOPSOIL	1.630 Cu. Yds.
<b>EXCESS UNBALANCE</b> (After Interim Rehabilitation)	<b>0 Cu. Yds.</b>

APPROXIMATE SURFACE DISTURBANCE AREAS		
	DISTANCE	ACRES
WELL SITE DISTURBANCE	NA	±3.227
30' WIDE ACCESS ROAD R-O-W DISTURBANCE	±1310.34'	±0.902
30' WIDE SWD PIPELINE R-O-W DISTURBANCE	±5428.67'	±3.739
30' WIDE SALES PIPELINE R-O-W DISTURBANCE	±5062.61'	±3.487
30' WIDE POWER LINE R-O-W DISTURBANCE	±717.61'	±0.494
<b>TOTAL SURFACE USE AREA</b>		<b>±11.849</b>

#### NOTES:

- Fill quantity includes 5% for compaction.
- Cut/Fill slopes 1 1/2:1 (Typ. except where noted)

#### CIMAREX ENERGY CO.

PERRY 22 FEDERAL 4H  
630' FNL 380' FWL  
NW 1/4 NW 1/4, SECTION 22, T20S, R34E, N.M.P.M.  
LEA COUNTY, NEW MEXICO

SURVEYED BY	J.A.V., R.D.	06-08-17	SCALE
DRAWN BY	B.D.H.	06-21-17	AS SHOWN
<b>TYPICAL CROSS SECTIONS</b>		<b>EXHIBIT D</b>	



**UELS, LLC**  
Corporate Office \* 85 South 200 East  
Vernal, UT 84078 \* (435) 789-1017

**CERTIFICATE**  
 THIS MAP HAS BEEN PRODUCED ACCORDING TO  
 PROCEDURES THAT HAVE BEEN DEMONSTRATED TO  
 PRODUCE DATA THAT MEET OR EXCEEDS THE  
 MINIMUM STANDARDS FOR A TOPOGRAPHIC MAP  
 COMPILED AT A SCALE OF 1" = 80' WITH A CONTOUR  
 INTERVAL OF 2'

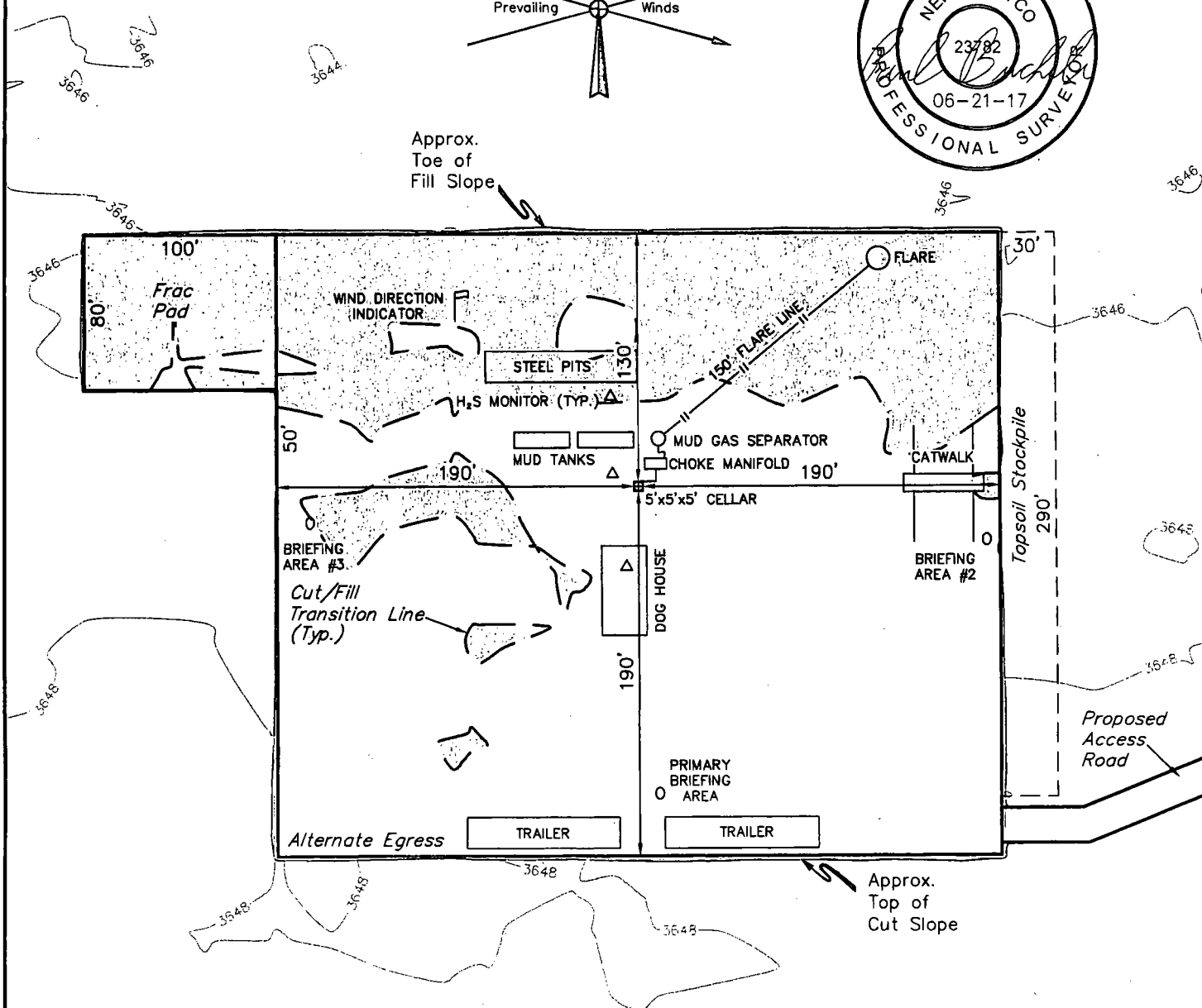
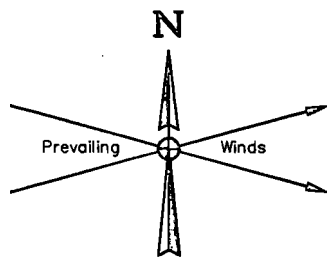
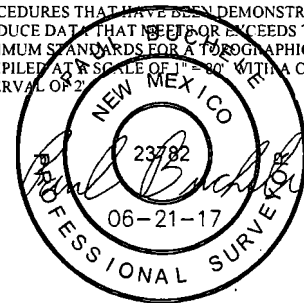

**NOTES:**

- Contours shown at 2' intervals.

**CIMAREX ENERGY CO.**

**PERRY 22 FEDERAL 4H**  
 630' FNL 380' FWL  
 NW 1/4 NW 1/4, SECTION 22, T20S, R34E, N.M.P.M.  
 LEA COUNTY, NEW MEXICO

SURVEYED BY	J.A.V., R.D.	06-08-17	SCALE
DRAWN BY	B.D.H.	06-21-17	1" = 80'
<b>TYPICAL RIG LAYOUT</b>			<b>EXHIBIT D</b>



**UELS, LLC**  
 Corporate Office \* 85 South 200 East  
 Vernal, UT 84078 \* (435) 789-1017

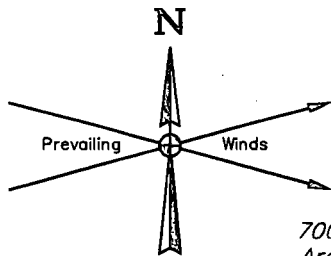

700' X 520'  
Archaeological Survey  
Boundary

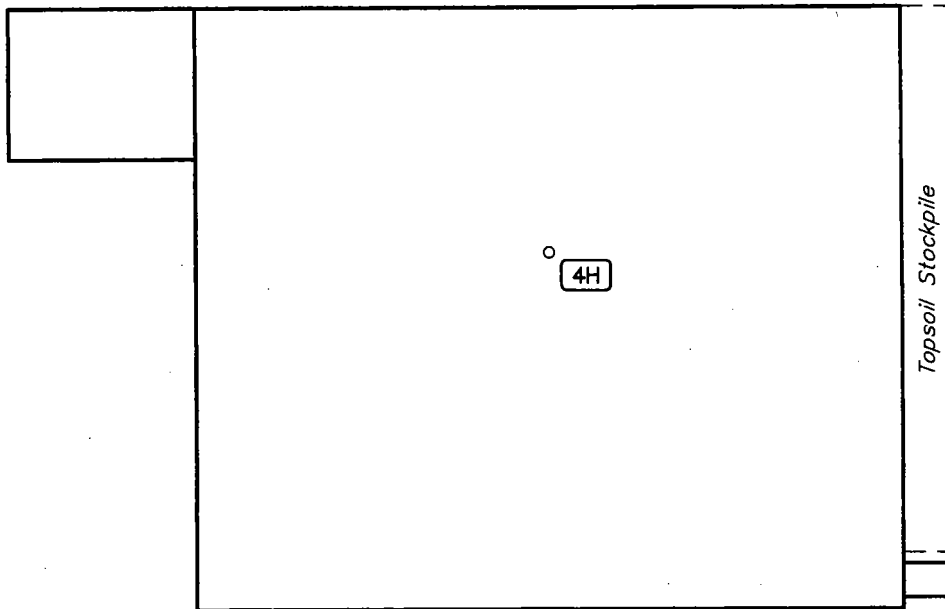
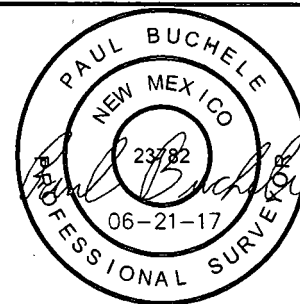

Topsoil Stockpile

Proposed  
Access  
Road

Section 21  
Section 22

**NOTES:**

**CIMAREX ENERGY CO.**

**PERRY 22 FEDERAL 4H**  
630' FNL 380' FWL  
NW 1/4 NW 1/4, SECTION 22, T20S, R34E, N.M.P.M.  
LEA COUNTY, NEW MEXICO



**UELS, LLC**  
Corporate Office \* 85 South 200 East  
Vernal, UT 84078 \* (435) 789-1017

SURVEYED BY	J.A.V., R.D.	06-08-17	SCALE
DRAWN BY	B.D.H.	06-21-17	1" = 100'
ARCHAEOLOGICAL SURVEY BOUNDARY			EXHIBIT D





**T20S**

15

3650

**PROPOSED PERRY 22  
FEDERAL COM 3H WELL PAD  
(AS STAKED BY OTHERS)**

**PROPOSED  
POWER (AS STAKED  
BY OTHER)**

**PROPOSED  
POWER**

**T20S R34E**

**EXISTING 2-TRACK  
NEEDS UPGRADED**

**EXISTING PERRY 22  
FEDERAL COM 2H WELL PAD  
(AS STAKED BY OTHERS)**

**NM-62 6.0 MI. +/-**

**1,291' +/-**

**0.4 MI. +/-**

**250' +/-**

**SEE DETAIL "A"**

**PROPOSED ACCESS 1,310' +/-**

**PROPOSED LOCATION:  
PERRY 22 FEDERAL 4H**

**T OVER V RANCH  
LAND LLLP**

**PROPOSED SWD PIPELINE**

22

**EXISTING POWER LINE**

**TIE-IN POINT**

**TIE-IN POINT**

**EXISTING PERRY  
22 FEDERAL COM  
1H WELL PAD**

**DETAIL "A"**

**PROPOSED SALES PIPELINE**

**R  
34  
E****LEGEND:**

- PROPOSED POWER LINE (SERVICING OTHER WELLS)
- PROPOSED SWD PIPELINE
- PROPOSED POWER LINE

**APPROXIMATE TOTAL SALES PIPELINE DISTANCE = 5,063' +/-**

**APPROXIMATE TOTAL SWD PIPELINE DISTANCE = 5,429' +/-**

**APPROXIMATE TOTAL POWER LINE DISTANCE = 718' +/-**

**NOTE: PARCEL DATA SHOWN HAS BEEN OBTAINED FROM VARIOUS SOURCES AND SHOULD BE USED FOR MAPPING, GRAPHIC AND PLANNING PURPOSES ONLY. NO WARRANTY IS MADE BY UINTAH ENGINEERING AND LAND SURVEYING (UELS) FOR ACCURACY OF THE PARCEL DATA.**

**LEGEND:**

- EXISTING ROAD
- EXISTING PIPELINE / FLOW LINE
- PROPOSED ROAD
- EXISTING POWER LINE
- PROPOSED SALES PIPELINE
- EXISTING 2-TRACK



**UELS, LLC**  
Corporate Office \* 85 South 200 East  
Vernal, UT 84078 \* (435) 789-1017

**CIMAREX ENERGY CO.**

**PERRY 22 FEDERAL 4H**  
630' FNL 380' FWL  
NW 1/4 NW 1/4, SECTION 22, T20S, R34E, N.M.P.M.  
LEA COUNTY, NEW MEXICO

SURVEYED BY	J.A.V., R.D.	06-08-17	SCALE
DRAWN BY	L.W.	06-16-17	1:12,000

**TOPOGRAPHIC MAP****EXHIBIT C-1**

**T20S**

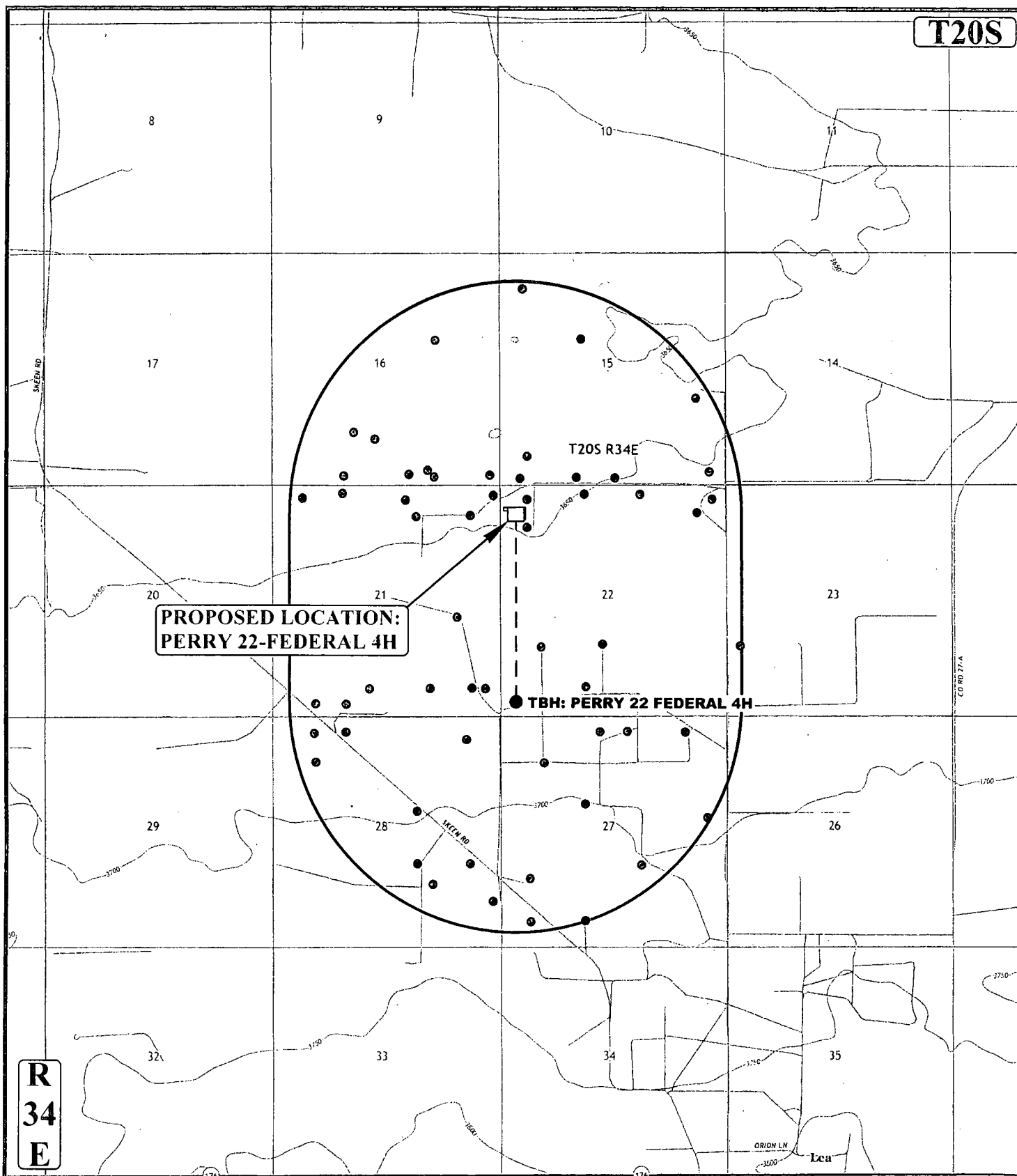

**R  
34  
E**

**LEGEND:**

- EXISTING WELLS



**UELS, LLC**  
Corporate Office \* 85 South 200 East  
Vernal, UT 84078 \* (435) 789-1017



**CIMAREX ENERGY CO.**

**PERRY 22 FEDERAL 4H**  
630' FNL 380' FWL  
NW 1/4 NW 1/4, SECTION 22, T20S, R34E, N.M.P.M.  
LEA COUNTY, NEW MEXICO

SURVEYED BY	J.A.V., R.D.	06-08-17	SCALE
DRAWN BY	L.W.	06-16-17	1" = 36.000'
<b>WELL PROXIMITY MAP</b>			<b>EXHIBIT A</b>

BEGINNING AT THE INTERSECTION OF NM-62 AND COUNTY ROAD 27-A TO THE SOUTH (LOCATED AT NAD83 LATITUDE N32.6352° AND LONGITUDE W103.5155°) PROCEED IN A SOUTHERLY DIRECTION APPROXIMATELY 4.5 MILES TO THE JUNCTION OF THIS ROAD AND AN EXISTING ROAD TO THE WEST; TURN RIGHT AND PROCEED IN A WESTERLY DIRECTION APPROXIMATELY 175' TO THE JUNCTION OF THIS ROAD AND AN EXISTING ROAD TO THE SOUTHWEST; TURN LEFT AND PROCEED IN A SOUTHWESTERLY DIRECTION APPROXIMATELY 0.4 MILES TO THE JUNCTION OF THIS ROAD AND AN EXISTING ROAD TO THE WEST; TURN RIGHT AND PROCEED IN A WESTERLY DIRECTION APPROXIMATELY 0.4 MILES TO THE JUNCTION OF THIS ROAD AND AN EXISTING ROAD TO THE SOUTHWEST; TURN LEFT AND PROCEED IN A SOUTHWESTERLY, THEN WESTERLY, THEN NORTHWESTERLY DIRECTION APPROXIMATELY 0.7 MILES TO THE JUNCTION OF THIS ROAD AND AN EXISTING ROAD TO THE SOUTH; TURN LEFT AND PROCEED IN A SOUTHERLY DIRECTION APPROXIMATELY 250' TO THE JUNCTION OF THIS ROAD AND AN EXISTING ROAD TO THE NORTHWEST; TURN RIGHT AND PROCEED IN A NORTHWESTERLY, THEN WESTERLY DIRECTION APPROXIMATELY 0.4 MILES TO THE EXISTING PERRY 22 FEDERAL COM 2H LOCATION AND AN EXISTING ROAD TO THE WEST; PROCEED IN A WESTERLY DIRECTION APPROXIMATELY 1,291' TO THE PROPOSED PERRY 22 FEDERAL COM 3H LOCATION AND THE BEGINNING OF THE PROPOSED ACCESS TO THE SOUTHWEST; FOLLOW ROAD FLAGS IN A SOUTHWESTERLY, THEN WESTERLY DIRECTION APPROXIMATELY 1,310' TO THE PROPOSED LOCATION.

TOTAL DISTANCE FROM THE INTERSECTION OF NM-62 AND COUNTY ROAD 27-A TO THE SOUTH (LOCATED AT NAD83 LATITUDE N32.6352° AND LONGITUDE W103.5155°) TO THE PROPOSED WELL LOCATION IS APPROXIMATELY 6.9 MILES.

# **CIMAREX ENERGY CO.**

**PERRY 22 FEDERAL 4H**  
**630' FNL 380' FWL**  
**NW 1/4 NW 1/4, SECTION 22, T20S, R34E, N.M.P.M.**  
**LEA COUNTY, NEW MEXICO**

SURVEYED BY	J.A.V., R.D.	06-08-17	
DRAWN BY	L.W.	06-16-17	
<b>ROAD DESCRIPTION</b>			



**UELS, LLC**  
 Corporate Office \* 85 South 200 East  
 Vernal, UT 84078 \* (435) 789-1017

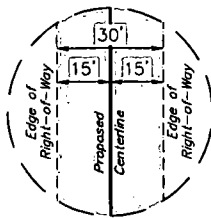

**TYPICAL  
RIGHT-OF-WAY  
DETAIL**  
NO SCALE

LINE TABLE		
LINE	DIRECTION	LENGTH
L1	S68°01'30"W	1265.28'
L2	S89°39'22"W	45.06'

W 1/4 Cor. Sec. 22  
1/2" Iron Pipe

SW Cor. Sec. 22  
Brass Cap W/  
2" Iron Pipe

NW Cor. Sec. 22  
Brass Cap W/  
2" Iron Pipe

NE Cor. Sec. 22  
Brass Cap W/  
2" Iron Pipe

N00°10'04"W - 2639.23' (Meas.)

N00°10'11"W - 2638.85' (Meas.)

SW Cor. Sec. 22  
Brass Cap W/  
2" Iron Pipe

T OVER V  
RANCH LAND  
LLP

See Detail "A"  
Below Right  
Existing 2-Track

NW 1/4

S89°41'17"W - 5281.81' (Meas.)

Proposed Perry 22  
Federal 4H Well Pad  
(As Staked by Others)

BEGINNING OF PROPOSED  
ROAD RIGHT-OF-WAY  
(At Edge of Proposed Perry  
22 Federal 4H Well Pad  
as Staked by Others)

NE 1/4

Sec. 22

E 1/4 Cor. Sec. 22  
Brass Cap W/  
1" Iron Pipe

1/4 Section Line

1/16 Section Line

SE 1/4

S89°44'26"W - 2644.56' (Meas.)

Proposed Perry 22  
Federal 4H Well Pad

END OF PROPOSED  
ROAD RIGHT-OF-WAY  
(At Edge of Proposed Perry  
22 Federal 4H Well Pad)

**Detail "A"**  
No Scale

### ROAD RIGHT-OF-WAY DESCRIPTION

A 30' WIDE RIGHT-OF-WAY 15' ON EACH SIDE OF THE FOLLOWING DESCRIBED CENTERLINE.

BEGINNING AT A POINT IN THE NE 1/4 NW 1/4 OF SECTION 22, T20S, R34E, N.M.P.M., WHICH BEARS S79°37'09"E 1820.97' FROM THE NORTHWEST CORNER OF SAID SECTION 22, THENCE S68°01'30"W 1265.28'; THENCE S89°39'22"W 45.06' TO A POINT IN THE NW 1/4 NW 1/4 OF SAID SECTION 22, WHICH BEARS S35°32'14"E 985.41' FROM THE NORTHWEST CORNER OF SAID SECTION 22. THE SIDE LINES OF SAID DESCRIBED RIGHT-OF-WAY BEING SHORTENED OR ELONGATED TO MEET THE GRANTOR'S PROPERTY LINES. BASIS OF BEARINGS IS A TRANSVERSE MERCATOR PROJECTION WITH A CENTRAL MERIDIAN OF W103°53'00". CONTAINS 0.902 ACRES MORE OR LESS.

BEGINNING OF ROAD BEARS S79°37'09"E  
1820.97' FROM THE NORTHWEST CORNER OF  
SECTION 22, T20S, R34E, N.M.P.M.

END OF ROAD BEARS S35°32'14"E 985.41'  
FROM THE NORTHWEST CORNER OF SECTION  
22, T20S, R34E, N.M.P.M.



ACREAGE / LENGTH TABLE			
OWNERSHIP	FEET	RODS	ACRES
T OVER V RANCH LAND LLP	1310.34	79.41	0.902

Δ = SECTION CORNERS LOCATED.

#### NOTES:

- The maximum grade of existing ground for the proposed access road is ±0.4%.
- Basis of Bearings is a Transverse Mercator Projection with a Central Meridian of W103°53'00"



**UELS, LLC**  
Corporate Office \* 85 South 200 East  
Vernal, UT 84078 \* (435) 789-1017

N

**CIMAREX ENERGY CO.**

PERRY 22 FEDERAL 4H  
SECTION 22, T20S, R34E, N.M.P.M.  
LEA COUNTY, NEW MEXICO

SURVEYED BY	J.A.V.R.D.	06-08-17	SCALE
DRAWN BY	B.D.H.	06-21-17	1" = 1000'
ACCESS ROAD R-O-W		EXHIBIT C-2	

CERTIFICATE  
THIS IS TO CERTIFY THAT THIS EASEMENT PLAT AND  
THE ACTUAL SURVEY OF THE GROUND UPON WHICH IT  
IS BASED WERE PERFORMED BY ME OR UNDER MY  
DIRECT SUPERVISION, THAT I AM RESPONSIBLE FOR  
THIS SURVEY, THAT THIS SURVEY MEETS THE  
MINIMUM STANDARDS FOR SURVEYING IN NEW  
MEXICO, AND THAT IT IS TRUE AND CORRECT TO THE  
BEST OF MY KNOWLEDGE AND BELIEF.



FILE: 61813-A

Sheet 1 of 2

PERRY 22 FEDERAL 4H			
SECTION CORNER	DESCRIPTION	LATITUDE (NAD 83)	LONGITUDE (NAD 83)
NW COR. SEC. 22, T20S, R34E	2" IRON PIPE W/ BRASS CAP	N 32°33'57.09"	W 103°33'23.98"
NE COR. SEC. 22, T20S, R34E	2" IRON PIPE W/ BRASS CAP	N 32°33'57.21"	W 103°32'22.27"
W 1/4 COR. SEC. 22, T20S, R34E	1/2" IRON PIPE	N 32°33'30.97"	W 103°33'23.98"
E 1/4 COR. SEC. 22, T20S, R34E	1" IRON PIPE W/ BRASS CAP	N 32°33'31.07"	W 103°32'22.22"
SW COR. SEC. 22, T20S, R34E	2" IRON PIPE W/ BRASS CAP	N 32°33'04.87"	W 103°33'23.99"
S 1/4 COR. SEC. 22, T20S, R34E	1" IRON PIPE W/ BRASS CAP	N 32°33'04.90"	W 103°32'53.11"
SE COR. SEC. 22, T20S, R34E	2" IRON PIPE W/ BRASS CAP	N 32°33'04.94"	W 103°32'22.22"

PERRY 22 FEDERAL 4H ACCESS ROAD			
NUMBER	STATION	LATITUDE (NAD 83)	LONGITUDE (NAD 83)
BEGIN	0+00	N 32°33'53.78"	W 103°33'03.06"
1	12+65.28	N 32°33'49.14"	W 103°33'16.79"
END	13+10.34	N 32°33'49.13"	W 103°33'17.32"

**CERTIFICATE**

THIS IS TO CERTIFY THAT THIS EASEMENT PLAT AND THE ACTUAL SURVEY ON THE GROUND UPON WHICH IT IS BASED WERE PERFORMED BY ME OR UNDER MY DIRECT SUPERVISION, THAT I AM RESPONSIBLE FOR THIS SURVEY, THAT THIS SURVEY MEETS THE MINIMUM STANDARDS FOR SURVEYING IN NEW MEXICO, AND THAT IT IS TRUE AND CORRECT TO THE BEST OF MY KNOWLEDGE AND BELIEF.

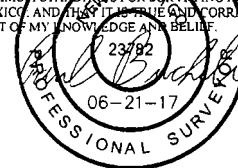

FILE: 61813-B

Sheet 2 of 2

**NOTES:**

**CIMAREX ENERGY CO.**

**PERRY 22 FEDERAL 4H  
SECTION 22, T20S, R34E, N.M.P.M.  
LEA COUNTY, NEW MEXICO**



**UELS, LLC**  
Corporate Office \* 85 South 200 East  
Vernal, UT 84078 \* (435) 789-1017

SURVEYED BY	J.A.V., R.D.	06-08-17	SCALE
DRAWN BY	B.D.H.	06-21-17	N/A
<b>ACCESS ROAD R-O-W</b>		<b>EXHIBIT C-2</b>	

CERTIFICATE  
THIS MAP HAS BEEN PRODUCED ACCORDING TO  
PROCEDURES THAT HAVE BEEN DEMONSTRATED TO  
PRODUCE DATA THAT MEETS OR EXCEEDS THE  
MINIMUM STANDARDS FOR A TOPOGRAPHIC MAP  
COMPILED AT A SCALE OF 1" = 80' WITH A CONTOUR  
INTERVAL OF 2'

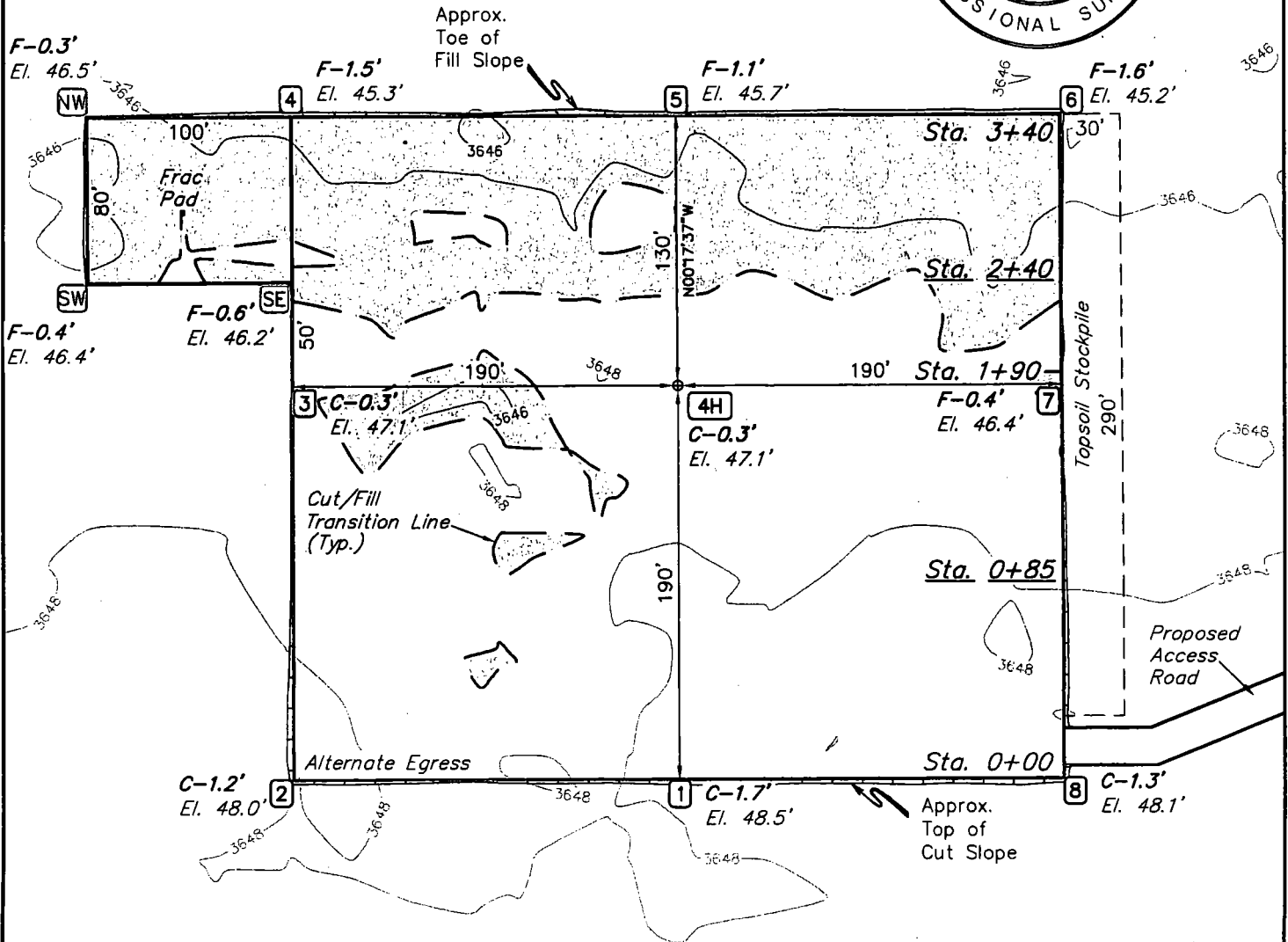
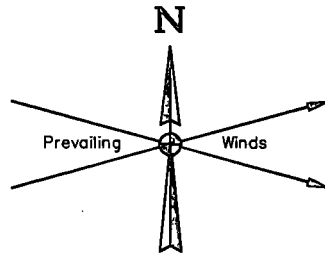

FINISHED GRADE ELEVATION = 3646.8'

**NOTES:**

- Contours shown at 2' intervals.
- Cut/Fill slopes 1 1/2:1 (Typ. except where noted)

**CIMAREX ENERGY CO.**

PERRY 22 FEDERAL 4H  
630' FNL 380' FWL  
NW 1/4 NW 1/4, SECTION 22, T20S, R34E, N.M.P.M.  
LEA COUNTY, NEW MEXICO



**UELS, LLC**  
Corporate Office \* 85 South 200 East  
Vernal, UT 84078 \* (435) 789-1017

SURVEYED BY	J.A.V., R.D.	06-08-17	SCALE
DRAWN BY	B.D.H.	06-21-17	1" = 80'
LOCATION LAYOUT			EXHIBIT D

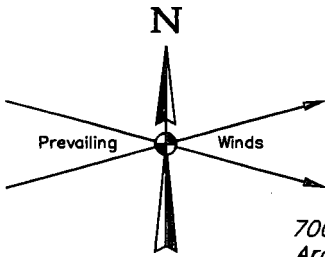

700' X 520'  
Archaeological Survey  
Boundary

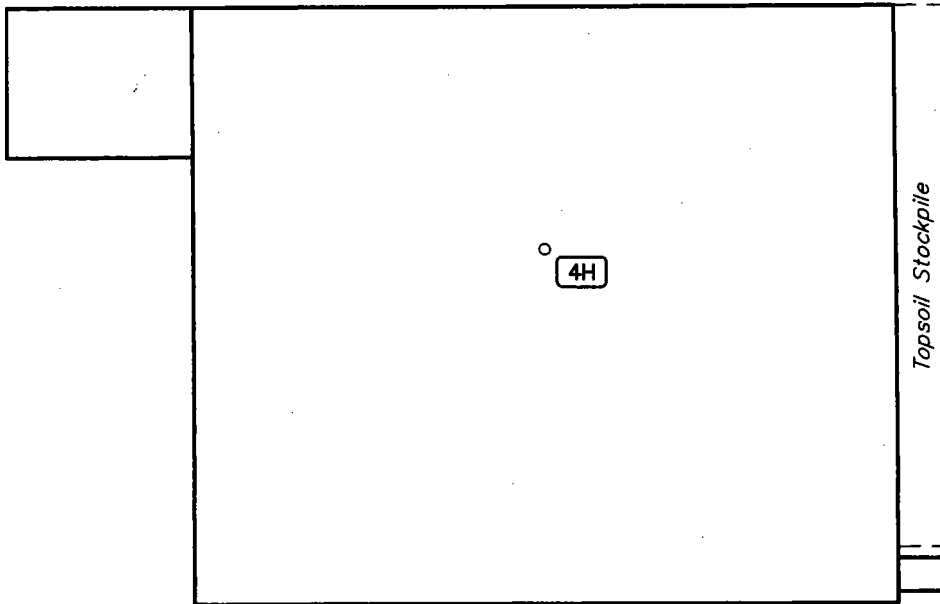
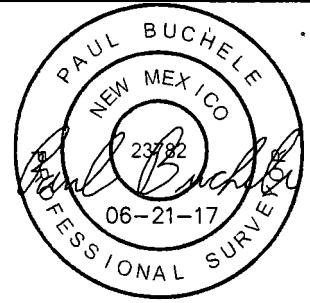

Section 21  
Section 22

NOTES:

**CIMAREX ENERGY CO.**

**PERRY 22 FEDERAL 4H**  
630' FNL 380' FWL  
NW 1/4 NW 1/4, SECTION 22, T20S, R34E, N.M.P.M.  
LEA COUNTY, NEW MEXICO

SURVEYED BY	J.A.V., R.D.	06-08-17	SCALE
DRAWN BY	B.D.H.	06-21-17	1" = 100'
ARCHAEOLOGICAL SURVEY BOUNDARY			EXHIBIT D



**UELS, LLC**  
Corporate Office \* 85 South 200 East  
Vernal, UT 84078 \* (435) 789-1017



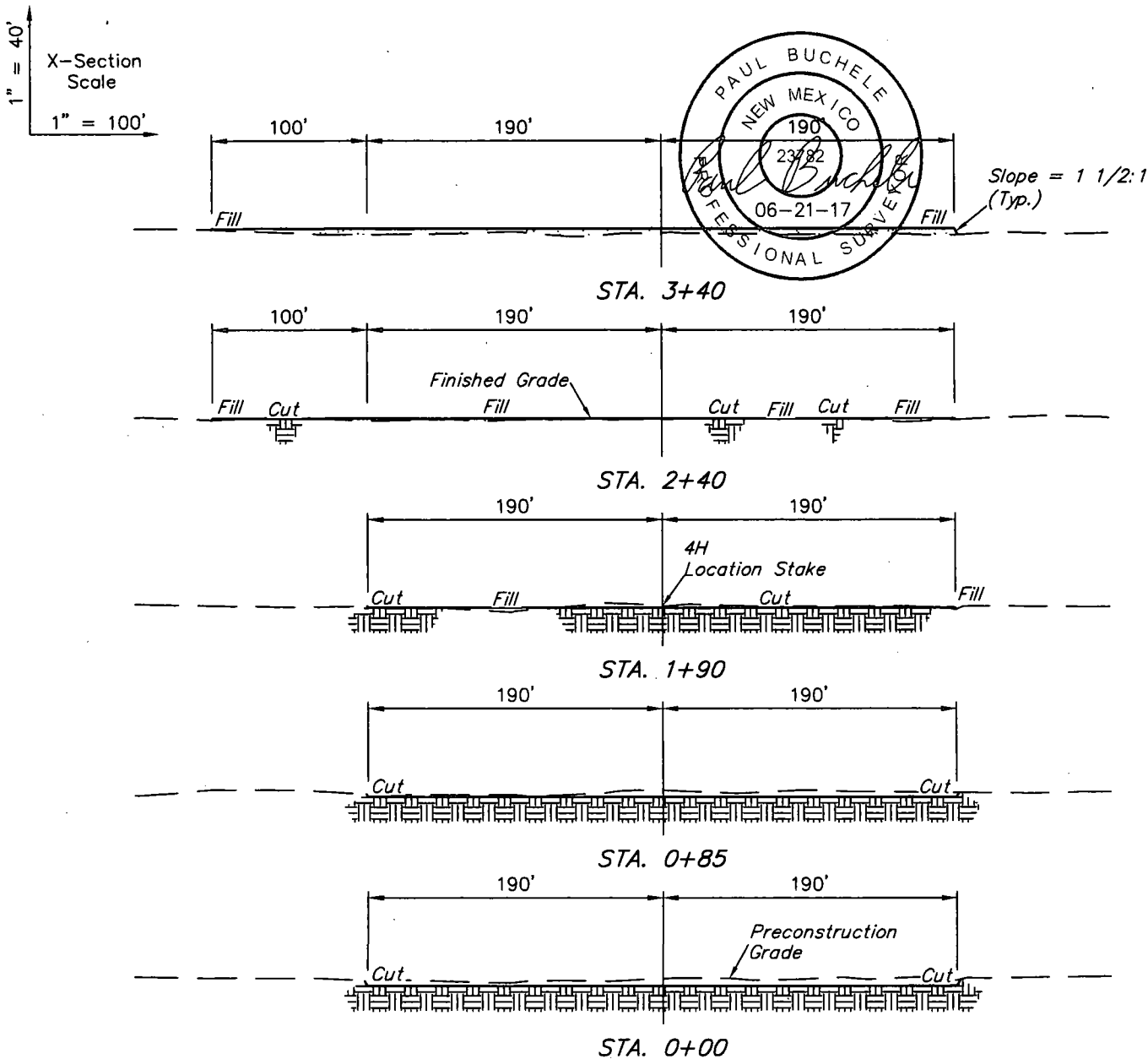

APPROXIMATE EARTHWORK QUANTITIES	
(4") TOPSOIL STRIPPING	1,630 Cu. Yds.
REMAINING LOCATION	1,790 Cu. Yds.
<b>TOTAL CUT</b>	<b>3,420 Cu. Yds.</b>
<b>FILL</b>	<b>1,790 Cu. Yds.</b>
EXCESS MATERIAL	1,630 Cu. Yds.
TOPSOIL	1,630 Cu. Yds.
<b>EXCESS UNBALANCE</b> (After Interim Rehabilitation)	<b>0 Cu. Yds.</b>

APPROXIMATE SURFACE DISTURBANCE AREAS		
	DISTANCE	ACRES
WELL SITE DISTURBANCE	NA	±3.227
30' WIDE ACCESS ROAD R-O-W DISTURBANCE	±1310.34'	±0.902
30' WIDE SWD PIPELINE R-O-W DISTURBANCE	±5428.67'	±3.739
30' WIDE SALES PIPELINE R-O-W DISTURBANCE	±5062.61'	±3.487
30' WIDE POWER LINE R-O-W DISTURBANCE	±717.61'	±0.494
<b>TOTAL SURFACE USE AREA</b>		<b>±11.849</b>

#### NOTES:

- Fill quantity includes 5% for compaction.
- Cut/Fill slopes 1 1/2:1 (Typ. except where noted)

#### CIMAREX ENERGY CO.

PERRY 22 FEDERAL 4H  
630' FNL 380' FWL  
NW 1/4 NW 1/4, SECTION 22, T20S, R34E, N.M.P.M.  
LEA COUNTY, NEW MEXICO

SURVEYED BY	J.A.V., R.D.	06-08-17	SCALE
DRAWN BY	B.D.H.	06-21-17	AS SHOWN
<b>TYPICAL CROSS SECTIONS</b>		<b>EXHIBIT D</b>	



UELS, LLC  
Corporate Office \* 85 South 200 East  
Vernal, UT 84078 \* (435) 789-1017

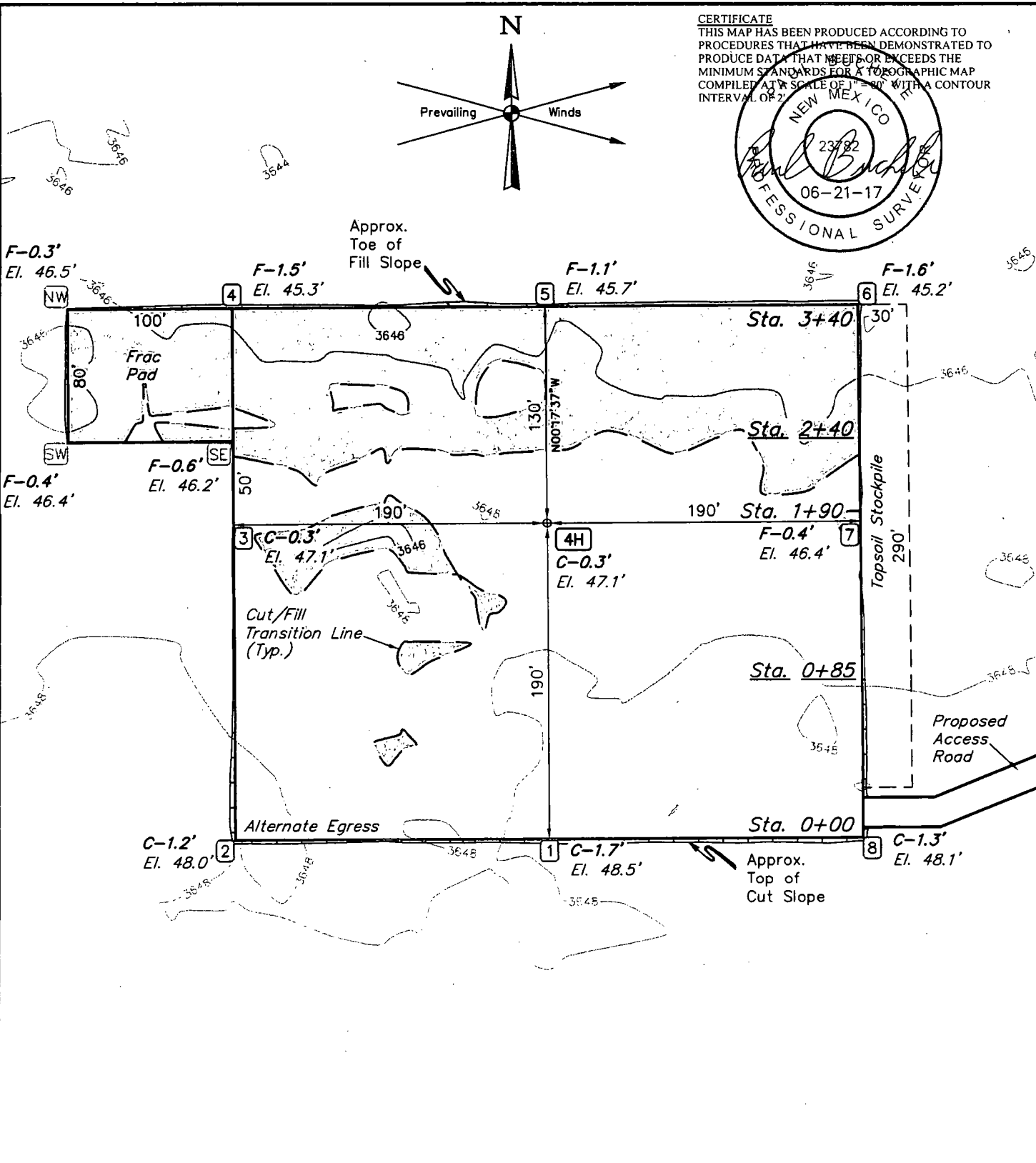

CERTIFICATE  
THIS MAP HAS BEEN PRODUCED ACCORDING TO  
PROCEDURES THAT HAVE BEEN DEMONSTRATED TO  
PRODUCE DATA THAT MEET OR EXCEEDS THE  
MINIMUM STANDARDS FOR A TOPOGRAPHIC MAP  
COMPILED AT A SCALE OF 1" = 80' WITH A CONTOUR  
INTERVAL OF 2'

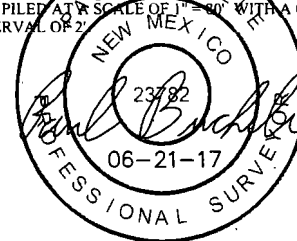

FINISHED GRADE ELEVATION = 3646.8'

**NOTES:**

- Contours shown at 2' intervals.
- Cut/Fill slopes 1 1/2:1 (Typ. except where noted)

**CIMAREX ENERGY CO.**

**PERRY 22 FEDERAL 4H**  
630' FNL 380' FWL  
NW 1/4 NW 1/4, SECTION 22, T20S, R34E, N.M.P.M.  
LEA COUNTY, NEW MEXICO

SURVEYED BY	J.A.V., R.D.	06-08-17	SCALE
DRAWN BY	B.D.H.	06-21-17	1" = 80'
LOCATION LAYOUT			EXHIBIT D



**UELS, LLC**  
Corporate Office \* 85 South 200 East  
Vernal, UT 84078 \* (435) 789-1017

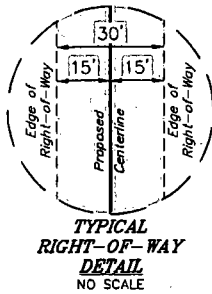

LINE TABLE		
LINE	DIRECTION	LENGTH
L1	S00°24'34"E	35.01'
L2	N89°29'23"E	4356.00'
L3	N01°08'29"E	600.01'
L4	N01°09'00"E	56.80'
L5	N89°35'00"E	14.80'

BEGINNING OF PROPOSED SALES PIPELINE RIGHT-OF-WAY (At Edge of Proposed Perry 22 Federal 4H Well Pad)

Detail "A" No Scale

Detail "B" No Scale

### SALES PIPELINE RIGHT-OF-WAY DESCRIPTION

A 30' WIDE RIGHT-OF-WAY 15' ON EACH SIDE OF THE FOLLOWING DESCRIBED CENTERLINE.

BEGINNING AT A POINT IN THE NW 1/4 NW 1/4 OF SECTION 22, T20S, R34E, N.M.P.M., WHICH BEARS S24°38'48"E 899.96' FROM THE NORTHWEST CORNER OF SAID SECTION 22, THENCE S00°24'34"E 35.01'; THENCE N89°29'23"E 4356.00'; THENCE N01°08'29"E 600.01'; THENCE N01°09'00"E 56.80'; THENCE N89°35'00"E 14.80' TO A POINT IN THE NE 1/4 NE 1/4 OF SAID SECTION 22, WHICH BEARS S70°23'18"W 554.64' FROM THE NORTHEAST CORNER OF SAID SECTION 22. THE SIDE LINES OF SAID DESCRIBED RIGHT-OF-WAY BEING SHORTENED OR ELONGATED TO MEET THE GRANTOR'S PROPERTY LINES. BASIS OF BEARINGS IS A TRANSVERSE MERCATOR PROJECTION WITH A CENTRAL MERIDIAN OF W103°53'00". CONTAINS 3.487 ACRES MORE OR LESS.

BEGINNING OF SALES PIPELINE BEARS S24°38'48"E 899.96' FROM THE NORTHWEST CORNER OF SECTION 22, T20S, R34E, N.M.P.M.

END OF SALES PIPELINE BEARS S70°23'18"W 554.64' FROM THE NORTHEAST CORNER OF SECTION 22, T20S, R34E, N.M.P.M.



ACREAGE / LENGTH TABLE			
OWNERSHIP	FEET	RODS	ACRES
T OVER V RANCH LAND LLLP	5062.61	306.82	3.487

▲ = SECTION CORNERS LOCATED.

#### NOTES:

- Basis of Bearings is a Transverse Mercator Projection with a Central Meridian of W103°53'00"



UELS, LLC  
Corporate Office \* 85 South 200 East  
Vernal, UT 84078 \* (435) 789-1017



FILE 61814-A

CIMAREX ENERGY CO.

PERRY 22 FEDERAL 4H  
SECTION 22, T20S, R34E, N.M.P.M.  
LEA COUNTY, NEW MEXICO

SURVEYED BY	J.A.V. R.D.	06-08-17	SCALE
DRAWN BY	B.D.H.	06-21-17	1" = 1000'
SALES PIPELINE R-O-W		EXHIBIT G	

CERTIFICATE  
THIS IS TO CERTIFY THAT THIS EASEMENT PLAT AND THE ACTUAL SURVEY ON THE GROUND UPON WHICH IT IS BASED WERE PERFORMED BY ME OR UNDER MY DIRECT SUPERVISION, THAT I AM RESPONSIBLE FOR THIS SURVEY, THAT THIS SURVEY MEETS THE MINIMUM STANDARDS FOR SURVEYING IN NEW MEXICO, AND THAT IT IS TRUE AND CORRECT TO THE BEST OF MY KNOWLEDGE AND BELIEF.

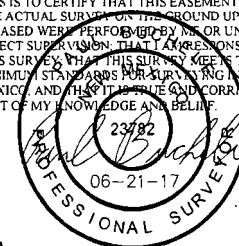

Sheet 1 of 2

PERRY 22 FEDERAL 4H			
SECTION CORNER	DESCRIPTION	LATITUDE (NAD 83)	LONGITUDE (NAD 83)
NW COR. SEC. 22, T20S, R34E	2" IRON PIPE W/ BRASS CAP	N 32°33'57.09"	W 103°33'23.98"
NE COR. SEC. 22, T20S, R34E	2" IRON PIPE W/ BRASS CAP	N 32°33'57.21"	W 103°32'22.27"
W 1/4 COR. SEC. 22, T20S, R34E	1/2" IRON PIPE	N 32°33'30.97"	W 103°33'23.98"
E 1/4 COR. SEC. 22, T20S, R34E	1" IRON PIPE W/ BRASS CAP	N 32°33'31.07"	W 103°32'22.22"
SW COR. SEC. 22, T20S, R34E	2" IRON PIPE W/ BRASS CAP	N 32°33'04.87"	W 103°33'23.99"
S 1/4 COR. SEC. 22, T20S, R34E	1" IRON PIPE W/ BRASS CAP	N 32°33'04.90"	W 103°32'53.11"
SE COR. SEC. 22, T20S, R34E	2" IRON PIPE W/ BRASS CAP	N 32°33'04.94"	W 103°32'22.22"

PERRY 22 FEDERAL 4H SALES PIPELINE			
NUMBER	STATION	LATITUDE (NAD 83)	LONGITUDE (NAD 83)
BEGIN	0+00	N 32°33'48.98"	W 103°33'19.62"
1	0+35.01	N 32°33'48.64"	W 103°33'19.62"
2	43+91.01	N 32°33'48.88"	W 103°32'28.73"
3	49+91.02	N 32°33'54.82"	W 103°32'28.57"
4	50+47.82	N 32°33'55.38"	W 103°32'28.56"
END	50+62.61	N 32°33'55.38"	W 103°32'28.38"

CERTIFICATE  
THIS IS TO CERTIFY THAT THIS EASEMENT PLAT AND  
THE ACTUAL SURVEY ON THE GROUND UPON WHICH IT  
IS BASED WERE PERFORMED BY ME OR UNDER MY  
DIRECT SUPERVISION, THAT I AM RESPONSIBLE FOR  
THIS SURVEY, THAT THIS SURVEY MEETS THE  
MINIMUM STANDARDS FOR SURVEYING IN NEW  
MEXICO, AND THAT IT IS TRUE AND CORRECT TO THE  
BEST OF MY KNOWLEDGE AND BELIEF.

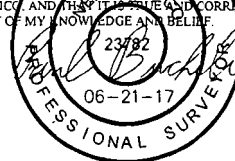

FILE 61814-B

Sheet 2 of 2

**NOTES:**

- Basis of Bearings is a Transverse Mercator Projection with a Central Meridian of W103°53'00"

**CIMAREX ENERGY CO.**

PERRY 22 FEDERAL 4H  
SECTION 22, T20S, R34E, N.M.P.M.  
LEA COUNTY, NEW MEXICO



**UELS, LLC**  
Corporate Office \* 85 South 200 East  
Vernal, UT 84078 \* (435) 789-1017

SURVEYED BY	J.A.V., R.D.	06-08-17	SCALE
DRAWN BY	B.D.H.	06-21-17	N/A
<b>SALES PIPELINE R-O-W</b>		<b>EXHIBIT C</b>	

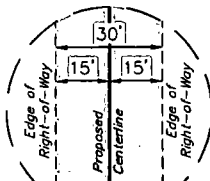

TYPICAL  
RIGHT-OF-WAY  
DETAIL  
NO SCALE

LINE TABLE		
LINE	DIRECTION	LENGTH
L1	S89°41'03"W	325.54'
L2	S00°09'39"E	392.07'

W 1/4 Cor. Sec. 22  
1/2" Iron Pipe

SW Cor. Sec. 22  
Brass Cap W/  
2" Iron Pipe

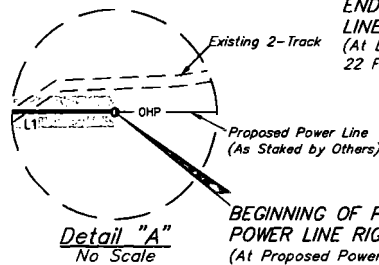

Detail "A"  
No Scale

BEGINNING OF PROPOSED  
POWER LINE RIGHT-OF-WAY  
(At Proposed Power Pole)

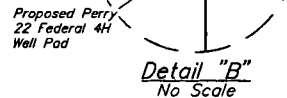

Detail "B"  
No Scale

### POWER LINE RIGHT-OF-WAY DESCRIPTION

A 30' WIDE RIGHT-OF-WAY 15' ON EACH SIDE OF THE FOLLOWING DESCRIBED CENTERLINE.

BEGINNING AT A POINT IN THE NW 1/4 NW 1/4 OF SECTION 22, T20S, R34E, N.M.P.M., WHICH BEARS S83°19'03"E 886.59' FROM THE NORTHWEST CORNER OF SAID SECTION 22, THENCE S89°41'03"W 325.54'; THENCE S00°09'39"E 392.07' TO A POINT IN THE NW 1/4 NW 1/4 OF SAID SECTION 22, WHICH BEARS S48°12'41"E 745.87' FROM THE NORTHWEST CORNER OF SAID SECTION 22. THE SIDE LINES OF SAID DESCRIBED RIGHT-OF-WAY BEING SHORTENED OR ELONGATED TO MEET THE GRANTOR'S PROPERTY LINES. BASIS OF BEARINGS IS A TRANSVERSE MERCATOR PROJECTION WITH A CENTRAL MERIDIAN OF W103°53'00". CONTAINS 0.494 ACRES MORE OR LESS.

BEGINNING OF POWER LINE BEARS  
S83°19'03"E 886.59' FROM THE NORTHWEST  
CORNER OF SECTION 22, T20S, R34E,  
N.M.P.M.

END OF POWER LINE BEARS S48°12'41"E  
745.87' FROM THE NORTHWEST CORNER OF  
SECTION 22, T20S, R34E, N.M.P.M.



### ACREAGE / LENGTH TABLE

OWNERSHIP	FEET	RODS	ACRES
T OVER V RANCH LAND LLLP	717.61	43.49	0.494

Δ = SECTION CORNERS LOCATED.

FILE: 61816-A

Sheet 1 of 2

#### NOTES:

- Basis of Bearings is a Transverse Mercator Projection with a Central Meridian of W103°53'00"



UELS, LLC  
Corporate Office \* 85 South 200 East  
Vernal, UT 84078 \* (435) 789-1017



### CIMAREX ENERGY CO.

PERRY 22 FEDERAL 4H  
SECTION 22, T20S, R34E, N.M.P.M.  
LEA COUNTY, NEW MEXICO

SURVEYED BY	J.A.V. R.D.	06-08-17	SCALE
DRAWN BY	B.D.H.	06-21-17	1" = 1000'
POWER LINE R-O-W		EXHIBIT H	

CERTIFICATE  
THIS IS TO CERTIFY THAT THIS EASEMENT PLAT AND  
THE ACTUAL SURVEY ON THE GROUND UPON WHICH IT  
IS BASED WERE PERFORMED BY ME OR UNDER MY  
DIRECT SUPERVISION, THAT I AM RESPONSIBLE FOR  
THIS SURVEY, THAT THIS SURVEY MEETS THE  
MINIMUM STANDARDS FOR SURVEYING IN NEW  
MEXICO, AND THAT IT IS TRUE AND CORRECT TO THE  
BEST OF MY KNOWLEDGE AND BELIEF.

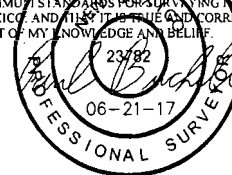

PERRY 22 FEDERAL 4H			
SECTION CORNER	DESCRIPTION	LATITUDE (NAD 83)	LONGITUDE (NAD 83)
NW COR. SEC. 22, T20S, R34E	2" IRON PIPE W/ BRASS CAP	N 32°33'57.09"	W 103°33'23.98"
NE COR. SEC. 22, T20S, R34E	2" IRON PIPE W/ BRASS CAP	N 32°33'57.21"	W 103°32'22.27"
W 1/4 COR. SEC. 22, T20S, R34E	1/2" IRON PIPE	N 32°33'30.97"	W 103°33'23.98"
E 1/4 COR. SEC. 22, T20S, R34E	1" IRON PIPE W/ BRASS CAP	N 32°33'31.07"	W 103°32'22.22"
SW COR. SEC. 22, T20S, R34E	2" IRON PIPE W/ BRASS CAP	N 32°33'04.87"	W 103°33'23.99"
S 1/4 COR. SEC. 22, T20S, R34E	1" IRON PIPE W/ BRASS CAP	N 32°33'04.90"	W 103°32'53.11"
SE COR. SEC. 22, T20S, R34E	2" IRON PIPE W/ BRASS CAP	N 32°33'04.94"	W 103°32'22.22"

PERRY 22 FEDERAL 4H POWER LINE			
NUMBER	STATION	LATITUDE (NAD 83)	LONGITUDE (NAD 83)
BEGIN	0+00	N 32°33'56.04"	W 103°33'13.69"
1	3+25.54	N 32°33'56.03"	W 103°33'17.50"
END	7+17.61	N 32°33'52.15"	W 103°33'17.50"

CERTIFICATE  
THIS IS TO CERTIFY THAT THIS EASEMENT PLAT AND  
THE ACTUAL SURVEY ON THE GROUND UPON WHICH IT  
IS BASED WERE PERFORMED BY ME OR UNDER MY  
DIRECT SUPERVISION, THAT I AM RESPONSIBLE FOR  
THIS SURVEY, THAT THIS SURVEY MEETS THE  
MINIMUM STANDARDS FOR SURVEYING IN NEW  
MEXICO, AND THAT IT IS TRUE AND CORRECT TO THE  
BEST OF MY KNOWLEDGE AND BELIEF.



FILE: 61816-B

Sheet 2 of 2

**NOTES:**

- \* Basis of Bearings is a Transverse Mercator Projection with a Central Meridian of W103°53'00"

**CIMAREX ENERGY CO.**

PERRY 22 FEDERAL 4H  
SECTION 22, T20S, R34E, N.M.P.M.  
LEA COUNTY, NEW MEXICO



**UELS, LLC**  
Corporate Office \* 85 South 200 East  
Vernal, UT 84078 \* (435) 789-1017

SURVEYED BY	J.A.V., R.D.	06-08-17	SCALE
DRAWN BY	B.D.H.	06-21-17	N/A
<b>POWER LINE ROW</b>		<b>EXHIBIT H</b>	

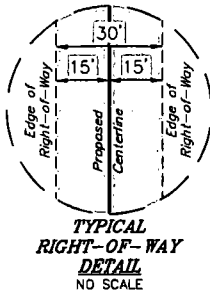

LINE TABLE		
LINE	DIRECTION	LENGTH
L1	S00°21'23"E	19.94'
L2	N89°29'15"E	4326.33'
L3	N01°08'38"E	585.26'
L4	N00°18'06"E	156.37'
L5	S86°48'51"E	305.33'
L6	S00°17'23"W	35.44'

BEGINNING OF PROPOSED SWD PIPELINE RIGHT-OF-WAY.  
(At Edge of Proposed Perry 22 Federal #4H Well Pad)

Detail "A"  
No Scale

Detail "B"  
No Scale

END OF PROPOSED SWD PIPELINE RIGHT-OF-WAY  
(At Edge of Proposed Perry 22 Federal 3H Well Pad as Staked by Others)

### SWD PIPELINE RIGHT-OF-WAY DESCRIPTION

A 30' WIDE RIGHT-OF-WAY 15' ON EACH SIDE OF THE FOLLOWING DESCRIBED CENTERLINE.

BEGINNING AT A POINT IN THE NW 1/4 NW 1/4 OF SECTION 22, T20S, R34E, N.M.P.M., WHICH BEARS S25°30'47"E 906.26' FROM THE NORTHWEST CORNER OF SAID SECTION 22, THENCE S00°21'23"E 19.94'; THENCE N89°29'15"E 4326.33'; THENCE N01°08'38"E 585.26'; THENCE N00°18'06"E 156.37'; THENCE S86°48'51"E 305.33'; THENCE S00°17'23"W 35.44' TO A POINT IN THE NE 1/4 NE 1/4 OF SAID SECTION 22, WHICH BEARS S60°45'29"W 284.13' FROM THE NORTHEAST CORNER OF SAID SECTION 22. THE SIDE LINES OF SAID DESCRIBED RIGHT-OF-WAY BEING SHORTENED OR ELONGATED TO MEET THE GRANTOR'S PROPERTY LINES. BASIS OF BEARINGS IS A TRANSVERSE MERCATOR PROJECTION WITH A CENTRAL MERIDIAN OF W103°53'00". CONTAINS 3.739 ACRES MORE OR LESS.

BEGINNING OF SWD PIPELINE BEARS S25°30'47"E 906.26' FROM THE NORTHWEST CORNER OF SECTION 22, T20S, R34E, N.M.P.M.

END OF SWD PIPELINE BEARS S60°45'29"W 284.13' FROM THE NORTHEAST CORNER OF SECTION 22, T20S, R34E, N.M.P.M.



ACREAGE / LENGTH TABLE			
OWNERSHIP	FEET	RODS	ACRES
T OVER V RANCH LAND LLLP	5428.67	329.01	3.739

Δ = SECTION CORNERS LOCATED.

#### NOTES:

\* Basis of Bearings is a Transverse Mercator Projection with a Central Meridian of W103°53'00"



UELS, LLC  
Corporate Office \* 85 South 200 East  
Vernal, UT 84078 \* (435) 789-1017



FILE: 61815-A

CIMAREX ENERGY CO.

PERRY 22 FEDERAL 4H  
SECTION 22, T20S, R34E, N.M.P.M.  
LEA COUNTY, NEW MEXICO

SURVEYED BY	J.A.V.R.D.	06-08-17	SCALE
DRAWN BY	B.D.H.	06-21-17	1" = 1000'
SWD PIPELINE R-O-W		EXHIBIT I	

#### CERTIFICATE

THIS IS TO CERTIFY THAT THIS EASEMENT PLAT AND THE ACTUAL SURVEY ON THE GROUND UPON WHICH IT IS BASED WERE PERFORMED BY ME OR UNDER MY DIRECT SUPERVISION, THAT I AM RESPONSIBLE FOR THIS SURVEY, THAT THIS SURVEY MEETS THE MINIMUM STANDARDS FOR SURVEYING IN NEW MEXICO, AND THAT IT IS TRUE AND CORRECT TO THE BEST OF MY KNOWLEDGE AND BELIEF.



Sheet 1 of 2

PERRY 22 FEDERAL 4H			
SECTION CORNER	DESCRIPTION	LATITUDE (NAD 83)	LONGITUDE (NAD 83)
NW COR. SEC. 22, T20S, R34E	2" IRON PIPE W/ BRASS CAP	N 32°33'57.09"	W 103°33'23.98"
NE COR. SEC. 22, T20S, R34E	2" IRON PIPE W/ BRASS CAP	N 32°33'57.21"	W 103°32'22.27"
W 1/4 COR. SEC. 22, T20S, R34E	1/2" IRON PIPE	N 32°33'30.97"	W 103°33'23.98"
E 1/4 COR. SEC. 22, T20S, R34E	1" IRON PIPE W/ BRASS CAP	N 32°33'31.07"	W 103°32'22.22"
SW COR. SEC. 22, T20S, R34E	2" IRON PIPE W/ BRASS CAP	N 32°33'04.87"	W 103°33'23.99"
S 1/4 COR. SEC. 22, T20S, R34E	1" IRON PIPE W/ BRASS CAP	N 32°33'04.90"	W 103°32'53.11"
SE COR. SEC. 22, T20S, R34E	2" IRON PIPE W/ BRASS CAP	N 32°33'04.94"	W 103°32'22.22"

PERRY 22 FEDERAL 4H SWD PIPELINE			
NUMBER	STATION	LATITUDE (NAD 83)	LONGITUDE (NAD 83)
BEGIN	0+00	N 32°33'48.98"	W 103°33'19.45"
1	0+19.94	N 32°33'48.78"	W 103°33'19.45"
2	43+46.27	N 32°33'49.03"	W 103°32'28.90"
3	49+31.54	N 32°33'54.82"	W 103°32'28.75"
4	50+87.90	N 32°33'56.37"	W 103°32'28.73"
5	53+93.23	N 32°33'56.19"	W 103°32'25.17"
END	54+28.67	N 32°33'55.84"	W 103°32'25.17"

CERTIFICATE  
THIS IS TO CERTIFY THAT THIS EASEMENT PLAT AND THE ACTUAL SURVEY ON THE GROUND UPON WHICH IT IS BASED WERE PERFORMED BY ME OR UNDER MY DIRECT SUPERVISION THAT I AM RESPONSIBLE FOR THIS SURVEY, THAT THIS SURVEY MEETS THE MINIMUM STANDARDS FOR SURVEYING IN NEW MEXICO, AND THAT IT IS TRUE AND CORRECT TO THE BEST OF MY KNOWLEDGE AND BELIEF.

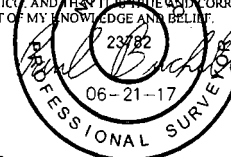

FILE: 61815-B

Sheet 2 of 2

**NOTES:**

- Basis of Bearings is a Transverse Mercator Projection with a Central Meridian of W 103°53'00"

**CIMAREX ENERGY CO.**

PERRY 22 FEDERAL 4H  
SECTION 22, T20S, R34E, N.M.P.M.  
LEA COUNTY, NEW MEXICO



**UELS, LLC**  
Corporate Office \* 85 South 200 East  
Vernal, UT 84078 \* (435) 789-1017

SURVEYED BY	J.A.V., R.D.	06-08-17	SCALE
DRAWN BY	B.D.H.	06-21-17	N/A
<b>SWD PIPELINE ROW</b>			<b>EXHIBIT I</b>



<b>Borehole:</b> Original Borehole	<b>Well:</b> Perry 22 Federal 4H	<b>Field:</b> NM Lea County (NAD 83)	<b>Structure:</b> Cimarex Perry 22 Federal 4H
<b>Gravity &amp; Magnetic Parameters</b> Model: HDGM 2017 Dip: 60.534° Date: 26-Jun-2017 MagDec: 6.767° FS: 48330.827nT Gravity FS: 998.504mgm (8.80665 Based)		<b>Surface Location</b> NAD83 New Mexico State Plane, Eastern Zone, US Feet Lat: N 32 33 59.88 Northing: 569836.28US Grid Conv: 0.4187° Lon: W 103 33 18.54 Easting: 780993.85RUS Scale Fact: 0.88987487	
		<b>Miscellaneous</b> Slot: Perry 22 Federal 4H TVD Ref: RKB(3671.1ft above MSL) Plan: Cimarex Energy Perry 22 Federal 4H Rev2 tnn 26Jun17	

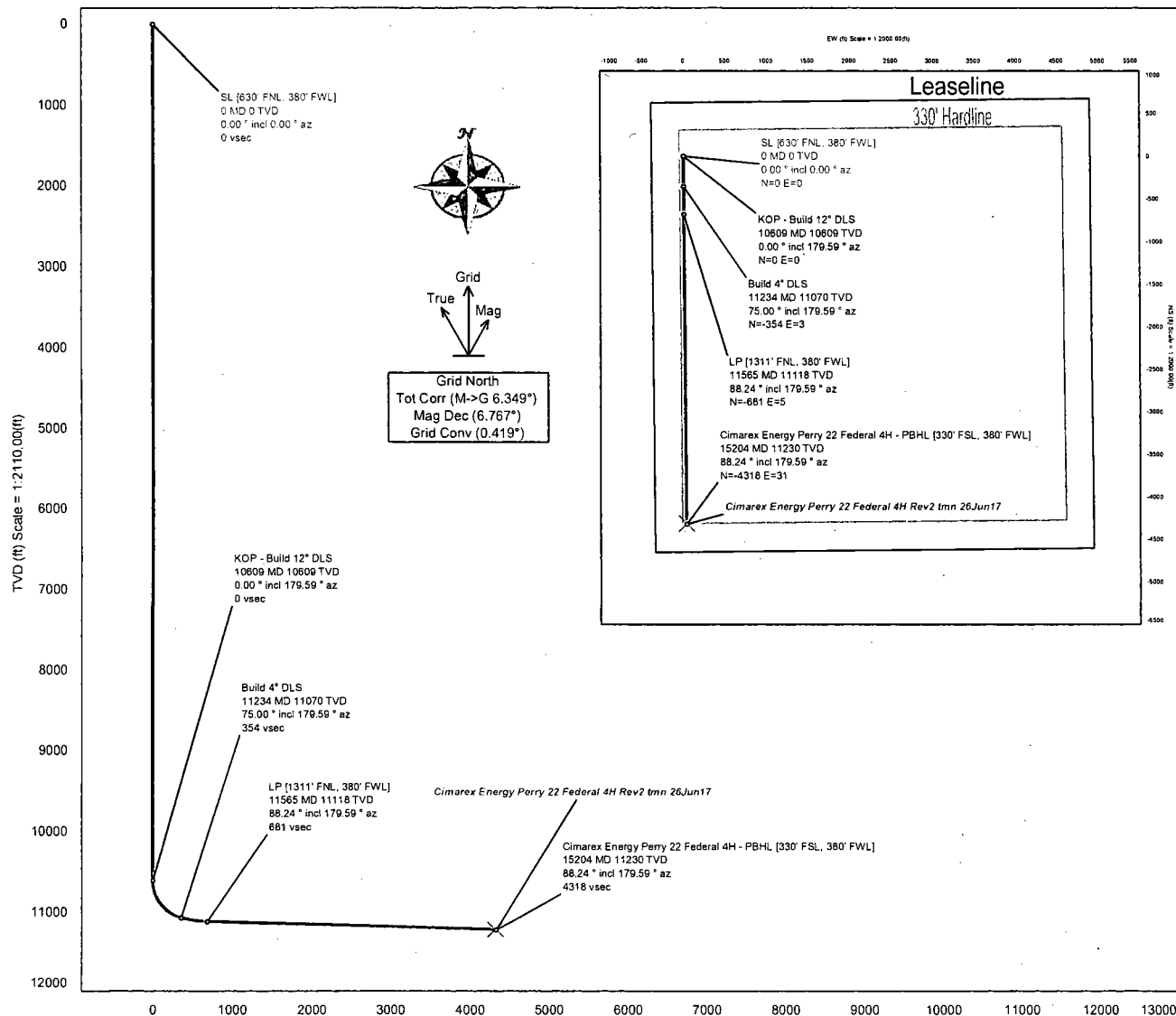

Vertical Section (ft) Azim = 179.59° Scale = 1:2110.00(ft) Origin = ON/S, OE/W

### Critical Points

Critical Point	MD	INCL	AZIM	TVD	VSEC	N(+)/S(-)	E(+)/W(-)	DLS
SL [630' FNL, 380' FWL]	0.00	0.00	0.00	0.00	0.00	0.00	0.00	
KOP - Build 12° DLS	10608.68	0.00	179.59	10608.68	0.00	0.00	0.00	0.00
Build 4° DLS	11233.68	75.00	179.59	11069.87	353.89	-353.88	2.56	12.00
LP [1311' FNL, 380' FWL]	11564.58	88.24	179.59	11118.00	680.53	-680.52	4.92	4.00
WFMP	11564.59	88.24	179.59	11118.00	680.54	-680.53	4.92	0.00
Cimarex Energy Perry 22 Federal 4H - PBHL [330' FSL, 380' FWL]	15203.61	88.24	179.59	11230.00	4317.84	-4317.73	30.96	0.00

# **Cimarex Energy Perry 22 Federal 4H Rev2 tmn 26Jun17 Proposal Geodetic Report (Def Plan)**

Report Date: June 26, 2017 - 11:46 AM  
 Client: Cimarex Energy  
 Field: NM Lea County (NAD 83)  
 Structure / Slot: Cimarex Perry 22 Federal 4H / Perry 22 Federal 4H  
 Well: Perry 22 Federal 4H  
 Borehole: Original Borehole  
 UWI / API#: Unknown / Unknown  
 Survey Name: Cimarex Energy Perry 22 Federal 4H Rev2 tmn 26Jun17  
 Survey Date: June 26, 2017  
 Tort / AHD / DDI / ERD Ratio: 88.236 ° / 4317.838 ft / 5.712 / 0.384  
 Coordinate Reference System: NAD83 New Mexico State Plane, Eastern Zone, US Feet  
 Location Lat / Long: N 32° 33' 50.86125", W 103° 33' 19.53993"  
 Location Grid N/E Y/X: N 569836.200 RUS, E 780993.950 RUS  
 CRS Grid Convergence Angle: 0.4187 °  
 Grid Scale Factor: 0.99997487  
 Version / Patch: 2.10.302.0

Survey / DLS Computation: Minimum Curvature / Lubinski  
 Vertical Section Azimuth: 179.590 ° (Grid North)  
 Vertical Section Origin: 0.000 ft, 0.000 ft  
 TVD Reference Datum: RKB  
 TVD Reference Elevation: 3671.100 ft above MSL  
 Seabed / Ground Elevation: 3647.100 ft above MSL  
 Magnetic Declination: 6.767 °  
 Total Gravity Field Strength: 998.5038mgn (9.80665 Based)  
 Gravity Model: GARM  
 Total Magnetic Field Strength: 48330.627 nT  
 Magnetic Dip Angle: 60.534 °  
 Declination Date: June 26, 2017  
 Magnetic Declination Model: HDGM 2017  
 North Reference: Grid North  
 Grid Convergence Used: 0.4187 °  
 Total Corr Mag North->Grid North: 6.3486 °  
 Local Coord Referenced To: Well Head

Comments	MD (ft)	Incl (°)	Azim Grid (°)	TVD (ft)	TVDSS (ft)	VSEC (ft)	NS (ft)	EW (ft)	DLS (°/100ft)	Closure (ft)	Closure Azimuth (°)	Northing (ftUS)	Easting (ftUS)	Latitude (N/S ° ' ")	Longitude (E/W ° ' ")
SL [630' FNL, 380' FWL]	0.00	0.00	0.00	0.00	-3671.10	0.00	0.00	0.00	N/A	0.00	0.00	569836.20	780993.95	N 32 33 50.86	W 103 33 19.54
	100.00	0.00	179.59	100.00	-3571.10	0.00	0.00	0.00	0.00	0.00	0.00	569836.20	780993.95	N 32 33 50.86	W 103 33 19.54
	200.00	0.00	179.59	200.00	-3471.10	0.00	0.00	0.00	0.00	0.00	0.00	569836.20	780993.95	N 32 33 50.86	W 103 33 19.54
	300.00	0.00	179.59	300.00	-3371.10	0.00	0.00	0.00	0.00	0.00	0.00	569836.20	780993.95	N 32 33 50.86	W 103 33 19.54
	400.00	0.00	179.59	400.00	-3271.10	0.00	0.00	0.00	0.00	0.00	0.00	569836.20	780993.95	N 32 33 50.86	W 103 33 19.54
	500.00	0.00	179.59	500.00	-3171.10	0.00	0.00	0.00	0.00	0.00	0.00	569836.20	780993.95	N 32 33 50.86	W 103 33 19.54
	600.00	0.00	179.59	600.00	-3071.10	0.00	0.00	0.00	0.00	0.00	0.00	569836.20	780993.95	N 32 33 50.86	W 103 33 19.54
	700.00	0.00	179.59	700.00	-2971.10	0.00	0.00	0.00	0.00	0.00	0.00	569836.20	780993.95	N 32 33 50.86	W 103 33 19.54
	800.00	0.00	179.59	800.00	-2871.10	0.00	0.00	0.00	0.00	0.00	0.00	569836.20	780993.95	N 32 33 50.86	W 103 33 19.54
	900.00	0.00	179.59	900.00	-2771.10	0.00	0.00	0.00	0.00	0.00	0.00	569836.20	780993.95	N 32 33 50.86	W 103 33 19.54
	1000.00	0.00	179.59	1000.00	-2671.10	0.00	0.00	0.00	0.00	0.00	0.00	569836.20	780993.95	N 32 33 50.86	W 103 33 19.54
	1100.00	0.00	179.59	1100.00	-2571.10	0.00	0.00	0.00	0.00	0.00	0.00	569836.20	780993.95	N 32 33 50.86	W 103 33 19.54
	1200.00	0.00	179.59	1200.00	-2471.10	0.00	0.00	0.00	0.00	0.00	0.00	569836.20	780993.95	N 32 33 50.86	W 103 33 19.54
	1300.00	0.00	179.59	1300.00	-2371.10	0.00	0.00	0.00	0.00	0.00	0.00	569836.20	780993.95	N 32 33 50.86	W 103 33 19.54
	1400.00	0.00	179.59	1400.00	-2271.10	0.00	0.00	0.00	0.00	0.00	0.00	569836.20	780993.95	N 32 33 50.86	W 103 33 19.54
	1500.00	0.00	179.59	1500.00	-2171.10	0.00	0.00	0.00	0.00	0.00	0.00	569836.20	780993.95	N 32 33 50.86	W 103 33 19.54
	1600.00	0.00	179.59	1600.00	-2071.10	0.00	0.00	0.00	0.00	0.00	0.00	569836.20	780993.95	N 32 33 50.86	W 103 33 19.54
	1700.00	0.00	179.59	1700.00	-1971.10	0.00	0.00	0.00	0.00	0.00	0.00	569836.20	780993.95	N 32 33 50.86	W 103 33 19.54
	1800.00	0.00	179.59	1800.00	-1871.10	0.00	0.00	0.00	0.00	0.00	0.00	569836.20	780993.95	N 32 33 50.86	W 103 33 19.54
	1900.00	0.00	179.59	1900.00	-1771.10	0.00	0.00	0.00	0.00	0.00	0.00	569836.20	780993.95	N 32 33 50.86	W 103 33 19.54
	2000.00	0.00	179.59	2000.00	-1671.10	0.00	0.00	0.00	0.00	0.00	0.00	569836.20	780993.95	N 32 33 50.86	W 103 33 19.54
	2100.00	0.00	179.59	2100.00	-1571.10	0.00	0.00	0.00	0.00	0.00	0.00	569836.20	780993.95	N 32 33 50.86	W 103 33 19.54
	2200.00	0.00	179.59	2200.00	-1471.10	0.00	0.00	0.00	0.00	0.00	0.00	569836.20	780993.95	N 32 33 50.86	W 103 33 19.54
	2300.00	0.00	179.59	2300.00	-1371.10	0.00	0.00	0.00	0.00	0.00	0.00	569836.20	780993.95	N 32 33 50.86	W 103 33 19.54
	2400.00	0.00	179.59	2400.00	-1271.10	0.00	0.00	0.00	0.00	0.00	0.00	569836.20	780993.95	N 32 33 50.86	W 103 33 19.54
	2500.00	0.00	179.59	2500.00	-1171.10	0.00	0.00	0.00	0.00	0.00	0.00	569836.20	780993.95	N 32 33 50.86	W 103 33 19.54
	2600.00	0.00	179.59	2600.00	-1071.10	0.00	0.00	0.00	0.00	0.00	0.00	569836.20	780993.95	N 32 33 50.86	W 103 33 19.54
	2700.00	0.00	179.59	2700.00	-971.10	0.00	0.00	0.00	0.00	0.00	0.00	569836.20	780993.95	N 32 33 50.86	W 103 33 19.54
	2800.00	0.00	179.59	2800.00	-871.10	0.00	0.00	0.00	0.00	0.00	0.00	569836.20	780993.95	N 32 33 50.86	W 103 33 19.54
	2900.00	0.00	179.59	2900.00	-771.10	0.00	0.00	0.00	0.00	0.00	0.00	569836.20	780993.95	N 32 33 50.86	W 103 33 19.54
	3000.00	0.00	179.59	3000.00	-671.10	0.00	0.00	0.00	0.00	0.00	0.00	569836.20	780993.95	N 32 33 50.86	W 103 33 19.54
	3100.00	0.00	179.59	3100.00	-571.10	0.00	0.00	0.00	0.00	0.00	0.00	569836.20	780993.95	N 32 33 50.86	W 103 33 19.54
	3200.00	0.00	179.59	3200.00	-471.10	0.00	0.00	0.00	0.00	0.00	0.00	569836.20	780993.95	N 32 33 50.86	W 103 33 19.54
	3300.00	0.00	179.59	3300.00	-371.10	0.00	0.00	0.00	0.00	0.00	0.00	569836.20	780993.95	N 32 33 50.86	W 103 33 19.54
	3400.00	0.00	179.59	3400.00	-271.10	0.00	0.00	0.00	0.00	0.00	0.00	569836.20	780993.95	N 32 33 50.86	W 103 33 19.54
	3500.00	0.00	179.59	3500.00	-171.10	0.00	0.00	0.00	0.00	0.00	0.00	569836.20	780993.95	N 32 33 50.86	W 103 33 19.54
	3600.00	0.00	179.59	3600.00	-71.10	0.00	0.00	0.00	0.00	0.00	0.00	569836.20	780993.95	N 32 33 50.86	W 103 33 19.54
	3700.00	0.00	179.59	3700.00	28.90	0.00	0.00	0.00	0.00	0.00	0.00	569836.20	780993.95	N 32 33 50.86	W 103 33 19.54
	3800.00	0.00	179.59	3800.00	128.90	0.00	0.00	0.00	0.00	0.00	0.00	569836.20	780993.95	N 32 33 50.86	W 103 33 19.54
	3900.00	0.00	179.59	3900.00	228.90	0.00	0.00	0.00	0.00	0.00	0.00	569836.20	780993.95	N 32 33 50.86	W 103 33 19.54
	4000.00	0.00	179.59	4000.00	328.90	0.00	0.00	0.00	0.00	0.00	0.00	569836.20	780993.95	N 32 33 50.86	W 103 33 19.54
	4100.00	0.00	179.59	4100.00	428.90	0.00	0.00	0.00	0.00	0.00	0.00	569836.20	780993.95	N 32 33 50.86	W 103 33 19.54
	4200.00	0.00	179.59	4200.00	528.90	0.00	0.00	0.00	0.00	0.00	0.00	569836.20	780993.95	N 32 33 50.86	W 103 33 19.54
	4300.00	0.00	179.59	4300.00	628.90	0.00	0.00	0.00	0.00	0.00	0.00	569836.20	780993.95	N 32 33 50.86	W 103 33 19.54
	4400.00	0.00	179.59	4400.00	728.90	0.00	0.00	0.00	0.00	0.00	0.00	569836.20	780993.95	N 32 33 50.86	W 103 33 19.54
	4500.00	0.00	179.59	4500.00	828.90	0.00	0.00	0.00	0.00	0.00	0.00	569836.20	780993.95	N 32 33 50.86	W 103 33 19.54
	4600.00	0.00	179.59	4600.00	928.90	0.00	0.00	0.00	0.00	0.00	0.00	569836.20	780993.95	N 32 33 50.86	W 103 33 19.54

[illegible]

Comments	MD (ft)	Incl (°)	Azim Grid (°)	TVD (ft)	TVDSS (ft)	VSEC (ft)	NS (ft)	EW (ft)	DLS (°/100ft)	Closure (ft)	Closure Azimuth (°)	Northing (RUS)	Easting (RUS)	Latitude (N/S ° ' '')	Longitude (E/W ° ' '')
	12000.00	88.24	179.59	11131.40	7460.30	1115.74	-1115.72	8.03	0.00	1115.74	179.59	568720.51	781001.98	N 32 33 39.82	W 103 33 19.54
	12100.00	88.24	179.59	11134.48	7463.38	1215.70	-1215.67	8.75	0.00	1215.70	179.59	568620.57	781002.70	N 32 33 38.83	W 103 33 19.54
	12200.00	88.24	179.59	11137.56	7466.46	1315.65	-1315.62	9.46	0.00	1315.65	179.59	568520.62	781003.41	N 32 33 37.84	W 103 33 19.54
	12300.00	88.24	179.59	11140.63	7469.53	1415.60	-1415.57	10.18	0.00	1415.60	179.59	568420.67	781004.13	N 32 33 36.85	W 103 33 19.54
	12400.00	88.24	179.59	11143.71	7472.61	1515.56	-1515.52	10.89	0.00	1515.56	179.59	568320.73	781004.84	N 32 33 35.87	W 103 33 19.54
	12500.00	88.24	179.59	11146.79	7475.69	1615.51	-1615.47	11.61	0.00	1615.51	179.59	568220.78	781005.56	N 32 33 34.88	W 103 33 19.54
	12600.00	88.24	179.59	11149.87	7478.77	1715.46	-1715.42	12.33	0.00	1715.46	179.59	568120.83	781006.28	N 32 33 33.89	W 103 33 19.54
	12700.00	88.24	179.59	11152.95	7481.85	1815.41	-1815.37	13.04	0.00	1815.41	179.59	568020.88	781006.99	N 32 33 32.90	W 103 33 19.54
	12800.00	88.24	179.59	11156.02	7484.92	1915.37	-1915.32	13.76	0.00	1915.37	179.59	567920.94	781007.71	N 32 33 31.91	W 103 33 19.54
	12900.00	88.24	179.59	11159.10	7488.00	2015.32	-2015.27	14.47	0.00	2015.32	179.59	567820.99	781008.42	N 32 33 30.92	W 103 33 19.54
	13000.00	88.24	179.59	11162.18	7491.08	2115.27	-2115.22	15.19	0.00	2115.27	179.59	567721.04	781009.14	N 32 33 29.93	W 103 33 19.54
	13100.00	88.24	179.59	11165.26	7494.16	2215.22	-2215.17	15.90	0.00	2215.22	179.59	567621.09	781009.85	N 32 33 28.94	W 103 33 19.54
	13200.00	88.24	179.59	11168.33	7497.23	2315.18	-2315.12	16.62	0.00	2315.18	179.59	567521.15	781010.57	N 32 33 27.95	W 103 33 19.54
	13300.00	88.24	179.59	11171.41	7500.31	2415.13	-2415.07	17.34	0.00	2415.13	179.59	567421.20	781011.29	N 32 33 26.96	W 103 33 19.54
	13400.00	88.24	179.59	11174.49	7503.39	2515.08	-2515.02	18.05	0.00	2515.08	179.59	567321.25	781012.00	N 32 33 25.98	W 103 33 19.54
	13500.00	88.24	179.59	11177.57	7506.47	2615.03	-2614.97	18.77	0.00	2615.03	179.59	567221.30	781012.72	N 32 33 24.99	W 103 33 19.54
	13600.00	88.24	179.59	11180.64	7509.54	2714.99	-2714.92	19.48	0.00	2714.99	179.59	567121.36	781013.43	N 32 33 24.00	W 103 33 19.54
	13700.00	88.24	179.59	11183.72	7512.62	2814.94	-2814.87	20.20	0.00	2814.94	179.59	567021.41	781014.15	N 32 33 23.01	W 103 33 19.54
	13800.00	88.24	179.59	11186.80	7515.70	2914.89	-2914.82	20.91	0.00	2914.89	179.59	566921.46	781014.86	N 32 33 22.02	W 103 33 19.54
	13900.00	88.24	179.59	11189.88	7518.78	3014.84	-3014.77	21.63	0.00	3014.84	179.59	566821.52	781015.58	N 32 33 21.03	W 103 33 19.54
	14000.00	88.24	179.59	11192.96	7521.86	3114.80	-3114.72	22.35	0.00	3114.80	179.59	566721.57	781016.30	N 32 33 20.04	W 103 33 19.54
	14100.00	88.24	179.59	11196.03	7524.93	3214.75	-3214.67	23.06	0.00	3214.75	179.59	566621.62	781017.01	N 32 33 19.05	W 103 33 19.54
	14200.00	88.24	179.59	11199.11	7528.01	3314.70	-3314.62	23.78	0.00	3314.70	179.59	566521.67	781017.73	N 32 33 18.06	W 103 33 19.55
	14300.00	88.24	179.59	11202.19	7531.09	3414.65	-3414.57	24.49	0.00	3414.65	179.59	566421.73	781018.44	N 32 33 17.07	W 103 33 19.55
	14400.00	88.24	179.59	11205.27	7534.17	3514.61	-3514.52	25.21	0.00	3514.61	179.59	566321.78	781019.16	N 32 33 16.09	W 103 33 19.55
	14500.00	88.24	179.59	11208.34	7537.24	3614.56	-3614.47	25.92	0.00	3614.56	179.59	566221.83	781019.87	N 32 33 15.10	W 103 33 19.55
	14600.00	88.24	179.59	11211.42	7540.32	3714.51	-3714.42	26.64	0.00	3714.51	179.59	566121.88	781020.59	N 32 33 14.11	W 103 33 19.55
	14700.00	88.24	179.59	11214.50	7543.40	3814.47	-3814.37	27.36	0.00	3814.47	179.59	566021.94	781021.31	N 32 33 13.12	W 103 33 19.55
	14800.00	88.24	179.59	11217.58	7546.48	3914.42	-3914.32	28.07	0.00	3914.42	179.59	565921.99	781022.02	N 32 33 12.13	W 103 33 19.55
	14900.00	88.24	179.59	11220.66	7549.56	4014.37	-4014.27	28.79	0.00	4014.37	179.59	565822.04	781022.74	N 32 33 11.14	W 103 33 19.55
	15000.00	88.24	179.59	11223.73	7552.63	4114.32	-4114.22	29.50	0.00	4114.32	179.59	565722.09	781023.45	N 32 33 10.15	W 103 33 19.55
	15100.00	88.24	179.59	11226.81	7555.71	4214.28	-4214.17	30.22	0.00	4214.28	179.59	565622.15	781024.17	N 32 33 9.16	W 103 33 19.55
	15200.00	88.24	179.59	11229.89	7558.79	4314.23	-4314.12	30.93	0.00	4314.23	179.59	565522.20	781024.88	N 32 33 8.17	W 103 33 19.55
Cimarex Energy Perry 22 Federal 4H - PBHL [330° FSL, 380° FWL]	15203.61	88.24	179.59	11230.00	7558.90	4317.84	-4317.73	30.96	0.00	4317.84	179.59	565518.59	781024.91	N 32 33 8.14	W 103 33 19.55

Survey Type:

Def Plan

**5. Mud Program**

Depth	Type	Weight (ppg)	Viscosity	Water Loss
0' to 1700'	FW Spud Mud	8.30 - 8.80	28	N/C
1700' to 5600'	Brine Water	9.70 - 10.20	30-32	N/C
5600' to 11565'	FW/Cut Brine	8.70 - 9.20	30-32	N/C
11565' to 15204'	Oil Based Mud	12.00 - 12.50	50-70	N/C

Sufficient mud materials to maintain mud properties and meet minimum lost circulation and weight increase requirements will be kept on location at all times.

What will be used to monitor the loss or gain of fluid?

PVT/Pason/Visual Monitoring

**6. Logging and Testing Procedures**

Logging, Coring and Testing	
X	Will run GR/CNL from TD to surface (horizontal well – vertical portion of hole). Stated logs run will be in the Completion Report and submitted to the BLM.
	No logs are planned based on well control or offset log information.
	Drill stem test?
	Coring?

Additional Logs Planned	Interval
-------------------------	----------

**7. Drilling Conditions**

Condition	
BH Pressure at deepest TVD	7299 psi
Abnormal Temperature	No

Hydrogen Sulfide (H<sub>2</sub>S) monitors will be installed prior to drilling out the surface shoe. If H<sub>2</sub>S is detected in concentrations greater than 100 ppm, the operator will comply with the provisions of Onshore Oil and Gas Order #6. If Hydrogen Sulfide is encountered, measured values and formations will be provided to the BLM.

X	H <sub>2</sub> S is present
X	H <sub>2</sub> S plan is attached

**8. Other Facets of Operation**

**4. Pressure Control Equipment**

A variance is requested for the use of a diverter on the surface casing. See attached for schematic.					
BOP installed and tested before drilling which hole?	Size	Min. Required WP	Type		Tested To
12 1/4	13 5/8	2M	Annular	X	50% of working pressure
			Blind Ram		2M
			Pipe Ram	X	
			Double Ram	X	
			Other		
8 3/4	13 5/8	5M	Annular	X	50% of working pressure
			Blind Ram		5M
			Pipe Ram	X	
			Double Ram	X	
			Other		
6	13 5/8	10M	Annular	X	50% of working pressure
			Blind Ram		10M
			Pipe Ram	X	
			Double Ram	X	
			Other		

BOP/BOPE will be tested by an independent service company to 250 psi low and the high pressure indicated above per Onshore Order 2 requirements. The System may be upgraded to a higher pressure but still tested to the working pressure listed in the table above. If the system is upgraded all the components installed will be functional and tested.

Pipe rams will be operationally checked each 24 hour period. Blind rams will be operationally checked on each trip out of the hole. These checks will be noted on the daily tour sheets. Other accessories to the BOP equipment will include a Kelly cock and floor safety valve (inside BOP) and choke lines and choke manifold. See attached schematics.

X	Formation integrity test will be performed per Onshore Order #2. On Exploratory wells or on that portion of any well approved for a 5M BOPE system or greater, a pressure integrity test of each casing shoe shall be performed. Will be tested in accordance with Onshore Oil and Gas Order #2 III.B.1.i.				
X	A variance is requested for the use of a flexible choke line from the BOP to Choke Manifold. See attached for specs and hydrostatic test chart.				
N	Are anchors required by manufacturer?				

**3. Cementing Program**

Casing	# Sks	Wt. lb/gal	Yld ft <sup>3</sup> /sack	H <sub>2</sub> O gal/sk	500# Comp. Strength (hours)	Slurry Description
Surface	824	13.50	1.72	9.15	15.5	Lead: Class C + Bentonite
	221	14.80	1.34	6.32	9.5	Tail: Class C + LCM
Intermediate	1054	12.90	1.88	9.65	12	Lead: 35:65 (Poz:C) + Salt + Bentonite
	288	14.80	1.36	6.57	9.5	Tail: Class C + Retarder
Production	158	9.20	6.18	28.80		Lead: Class C + Extender + Salt + Strength Enhancement + LCM + Fluid Loss + Retarder
	123	14.20	1.30	5.86	14:30	Tail: 50:50 (Poz:H) + Salt + Bentonite + Fluid Loss + Dispersant + SMS
Completion System	264	14.20	1.30	5.86	14:30	Tail: 50:50 (Poz:H) + Salt + Bentonite + Fluid Loss + Dispersant + SMS

Casing String	TOC	% Excess
Surface	0	45
Intermediate	0	44
Production	5400	23
Completion System	11565	10

	Y or N
Is casing new? If used, attach certification as required in Onshore Order #1	Y
Does casing meet API specifications? If no, attach casing specification sheet.	Y
Is premium or uncommon casing planned? If yes attach casing specification sheet.	N
Does the above casing design meet or exceed BLM's minimum standards? If not provide justification (loading assumptions, casing design criteria).	Y
Will the intermediate pipe be kept at a minimum 1/3 fluid filled to avoid approaching the collapse pressure rating of the casing?	Y
Is well located within Capitan Reef?	N
If yes, does production casing cement tie back a minimum of 50' above the Reef?	N
Is well within the designated 4 string boundary.	N
Is well located in SOPA but not in R-111-P?	N
If yes, are the first 2 strings cemented to surface and 3rd string cement tied back 500' into previous casing?	N
Is well located in R-111-P and SOPA?	N
If yes, are the first three strings cemented to surface?	N
Is 2nd string set 100' to 600' below the base of salt?	N
Is well located in high Cave/Karst?	N
If yes, are there two strings cemented to surface?	N
(For 2 string wells) If yes, is there a contingency casing if lost circulation occurs?	N
Is well located in critical Cave/Karst?	N
If yes, are there three strings cemented to surface?	N



**1. Geological Formations**

TVD of target 11,230

Pilot Hole TD N/A

MD at TD 15,204

Deepest expected fresh water

Formation	Depth (TVD) from KB	Water/Mineral Bearing/Target Zone	Hazards
OSE Groundwater	200	N/A	
Rustler	1650	N/A	
Salt	1800	N/A	
Tansill	3400	N/A	
Capitan Reef	3970	N/A	
Cherry Canyon	5700	N/A	
Bone Spring	8390	Hydrocarbons	
1st BSS	9560	Hydrocarbons	
2nd BSS	10750	Hydrocarbons	
3rd BSS	10800	Hydrocarbons	
Wolfcamp	11073	Hydrocarbons	

**2. Casing Program**

Hole Size	Casing Depth From	Casing Depth To	Casing Size	Weight (lb/ft)	Grade	Conn	SF Collapse	SF Burst	SF Tension
17 1/2	0	1700	13-3/8"	54.50	J-55	ST&C	1.45	3.52	5.55
12 1/4	0	5600	9-5/8"	40.00	J-55	LT&C	1.29	1.33	2.32
8 3/4	0	10607	7"	26.00	L-80	LT&C		1.43	1.75
8 3/4	10607	11565	7"	26.00	L-80	BT&C		1.35	37.29
6	10607	15204	4-1/2"	11.60	P-110	BT&C		1.47	50.78
BLM Minimum Safety Factor							1.125	1	1.6 Dry 1.8 Wet

All casing strings will be tested in accordance with Onshore Oil and Gas Order #2 III.B.1.h

**BLM LEASE NUMBER:** NMNM000082

**COMPANY NAME:** Cimarex Energy Company

**ASSOCIATED WELL NAME:** Perry 22 Federal Com 4H

#### STANDARD STIPULATIONS FOR OIL AND GAS RELATED SITES

A copy of the application (Grant/Sundry Notice) and attachments, including stipulations and map, will be on location during construction. BLM personnel may request to view a copy of your permit during construction to ensure compliance with all stipulations.

The holder agrees to comply with the following stipulations to the satisfaction of the Authorized Officer, BLM.

1. The holder shall indemnify the United States against any liability for damage to life or property arising from the occupancy or use of public lands under this grant and for all response costs, penalties, damages, claims, and other costs arising from the provisions of the Resource Conservation and Recovery Act (RCRA), 42 U.S.C. Chap. 82, Section 6901 et. seq., from the Comprehensive Environmental Response, Compensation and Liability Act (CERCLA), 42 U.S.C. Chap. 109, Section 9601 et. seq., and from other applicable environmental statutes.
2. The holder shall comply with all applicable Federal laws and regulations existing or hereafter enacted or promulgated. In any event, the holder shall comply with the Toxic Substances Control Act of 1976, as amended (15 U.S.C. 2601, et. seq.) with regard to any toxic substances that are used, generated by or stored on the right-of-way or on facilities authorized by this grant. (See 40 CFR, Part 702-799 and especially, provisions on polychlorinated biphenyls, 40 CFR 761.1-761.193.) Additionally, any release of toxic substances (leaks, spills, etc.) in excess of the reportable quantity established by 40 CFR, Part 117 shall be reported as required by the Comprehensive Environmental Response, Compensation and Liability Act, Section 102b. A copy of any report required or requested by any Federal agency or State government as a result of a reportable release or spill of any toxic substances shall be furnished to the Authorized Officer concurrent with the filing of the reports to the involved Federal agency or State government.
3. The holder agrees to indemnify the United States against any liability arising from the release of any hazardous substance or hazardous waste (as these terms are defined in the Comprehensive Environmental Response, Compensation and Liability Act of 1980, 42 U.S.C. 9601, et. seq. or the Resource Conservation and Recovery Act, 42 U.S.C. 6901, et. seq.) on the right-of-way (unless the release or threatened release is wholly unrelated to the right-of-way holder's activity on the right-of-way). This agreement applies without regard to whether a release is caused by the holder, its agent, or unrelated third parties.
4. If, during any phase of the construction, operation, maintenance, or termination of the site or related pipeline(s), any oil or other pollutant should be discharged from site facilities, the pipeline(s) or from containers or vehicles impacting Federal lands, the control and total removal, disposal, and cleanup of such oil or other pollutant, wherever found, shall be the responsibility of the holder, regardless of fault. Upon failure of the holder to control, dispose of, or clean up such discharge on or affecting Federal lands, or to repair all damages to Federal lands resulting therefrom, the Authorized Officer may take such measures as deemed necessary to control and cleanup the discharge and restore the area, including, where appropriate, the aquatic environment and fish and wildlife habitats, at the full expense of the holder. Such action by the Authorized Officer shall not relieve the holder of any liability or responsibility.
5. Sites shall be maintained in an orderly, sanitary condition at all times. Waste materials, both liquid and solid, shall be disposed of promptly at an appropriate, authorized waste disposal facility in accordance with all applicable State and Federal laws. "Waste" means all discarded matter including, but not limited to, human waste, trash, garbage, refuse, petroleum products, brines, chemicals, oil drums, ashes, and equipment.

6. The operator will notify the Bureau of Land Management (BLM) authorized officer and nearest Fish and Wildlife Service (FWS) Law Enforcement office within 24 hours, if the operator discovers a dead or injured federally protected species (i.e., migratory bird species, bald or golden eagle, or species listed by the FWS as threatened or endangered) in or adjacent to a pit, trench, tank, exhaust stack, or fence. (If the operator is unable to contact the FWS Law Enforcement office, the operator must contact the nearest FWS Ecological Services office.)

7. All above-ground structures not subject to safety requirements shall be painted by the holder to blend with the natural color of the landscape. The paint used shall be a color which simulates "Standard Environmental Colors" designated by the Rocky Mountain Five-State Interagency Committee. The color selected for this project is **Shale Green**, Munsell Soil Color Chart Number 5Y 4/2.

8. Any cultural and/or paleontological resource (historic or prehistoric site or object) discovered by the holder, or any person working on the holder's behalf, on public or Federal land shall be immediately reported to the Authorized Officer. The holder shall suspend all operations in the immediate area of such discovery until written authorization to proceed is issued by the Authorized Officer. An evaluation of the discovery will be made by the Authorized Officer to determine appropriate actions to prevent the loss of significant cultural or scientific values. The holder will be responsible for the cost of evaluation and any decision as to the proper mitigation measures will be made by the Authorized Officer after consulting with the holder.

9. A sales contract for removal of mineral material (caliche, sand, gravel, fill dirt) from an authorized pit, site, or on location must be obtained from the BLM prior to commencing construction. There are several options available for purchasing mineral material: contact the BLM office (575-234-5972).

10. The operator shall be held responsible if noxious weeds become established within the areas of operations. Weed control shall be required on the disturbed land where noxious weeds exist, which includes the roads, pads, associated pipeline corridor, and adjacent land affected by the establishment of weeds due to this action. The operator shall consult with the Authorized Officer for acceptable weed control methods, which include following EPA and BLM requirements and policies.

11. Once the site is no longer in service or use, the site must undergo final abandonment. At final abandonment, the site and access roads must undergo "final" reclamation so that the character and productivity of the land are restored. Earthwork for final reclamation must be completed within six (6) months of the abandonment of the site. All pads and facility locations and roads must be reclaimed to a satisfactory revegetated, safe, and stable condition, unless an agreement is made with the landowner or BLM to keep the road and/or pad intact. After all disturbed areas have been satisfactorily prepared, these areas need to be revegetated with the seed mixture provided. Seeding should be accomplished by drilling on the contour whenever practical or by other approved methods. Seeding may need to be repeated until revegetation is successful, as determined by the BLM.

Operators shall contact a BLM surface protection specialist prior to surface abandonment operations for site specific objectives (Jim Amos: 575-234-5909).

12. The holder shall stockpile an adequate amount of topsoil where blading occurs. The topsoil to be stripped is approximately 6 inches in depth. The topsoil will be segregated from other spoil piles. The topsoil will be used for final reclamation.

13. The holder will reseed all disturbed areas. Seeding will be done according to the attached seeding requirements, using the following seed mix.

- |                                                        |                                                  |
|--------------------------------------------------------|--------------------------------------------------|
| <input type="checkbox"/> seed mixture 1                | <input type="checkbox"/> seed mixture 3          |
| <input type="checkbox"/> seed mixture 2                | <input type="checkbox"/> seed mixture 4          |
| <input checked="" type="checkbox"/> seed mixture 2/LPC | <input type="checkbox"/> Aplomado Falcon Mixture |

14. In those areas where erosion control structures are required to stabilize soil conditions, the holder shall install such structures as are suitable for the specific soil conditions being encountered and which are in accordance with sound management practices. Any earth work will require prior approval by the Authorized Officer.

15. Open-topped Tanks - The operator will take actions necessary to prevent wildlife and livestock access, including avian wildlife, to all open-topped tanks that contain or have the potential to contain salinity sufficient to cause harm to wildlife or livestock, hydrocarbons, or Resource Conservation and Recovery Act of 1976-exempt hazardous substances. At a minimum, the operator will net, screen, or cover open-topped tanks to exclude wildlife and livestock and prevent mortality. If the operator uses netting, the operator will cover and secure the open portion of the tank to prevent wildlife entry. The operator will net, screen, or cover the tanks until the operator removes the tanks from the location or the tanks no longer contain substances that could be harmful to wildlife or livestock. Use a maximum netting mesh size of 1 ½ inches. The netting must not be in contact with fluids and must not have holes or gaps

16. The operator will prevent all hazardous, poisonous, flammable, and toxic substances from coming into contact with soil and water. At a minimum, the operator will install and maintain an impervious secondary containment system for any tank or barrel containing hazardous, poisonous, flammable, or toxic substances sufficient to contain the contents of the tank or barrel and any drips, leaks, and anticipated precipitation. The operator will dispose of fluids within the containment system that do not meet applicable state or U. S. Environmental Protection Agency livestock water standards in accordance with state law; the operator must not drain the fluids to the soil or ground. The operator will design, construct, and maintain all secondary containment systems to prevent wildlife and livestock exposure to harmful substances. At a minimum, the operator will install effective wildlife and livestock enclosure systems such as fencing, netting, expanded metal mesh, lids, and grate covers. Use a maximum netting mesh size of 1 ½ inches.

17. Open-Vent Exhaust Stack Enclosures - The operator will construct, modify, equip, and maintain all open-vent exhaust stacks on production equipment to prevent birds and bats from entering, and to discourage perching, roosting, and nesting. (Recommended enclosure structures on open-vent exhaust stacks are in the shape of a cone.) Production equipment includes, but may not be limited to, tanks, heater-treaters, separators, dehydrators, flare stacks, in-line units, and compressor mufflers.

18. Containment Structures - Proposed production facilities such as storage tanks and other vessels will have a secondary containment structure that is constructed to hold the capacity of 1.5 times the largest tank, plus freeboard to account for precipitation, unless more stringent protective requirements are deemed necessary.

19. Special Stipulations:

**Lesser Prairie-Chicken**

Oil and gas activities will not be allowed in lesser prairie-chicken habitat during the period from March 1st through June 15th annually. During that period, other activities that produce noise or involve human activity, such as the maintenance of oil and gas facilities, geophysical exploration other than 3-D operations, and pipeline, road, and well pad construction, will be allowed except between 3:00 am and 9:00 am. The 3:00 am to 9:00 am restriction will not apply to normal, around-the-clock operations, such as venting, flaring, or pumping, which do not require a human presence during this period. Normal vehicle use on existing roads will not be restricted. Exhaust noise from permanent engines must be muffled or otherwise controlled so as not to exceed 75 db measured at 30 ft. from the source of the noise.

This authorization is subject to your Certificate of Participation and/or Certificate of Inclusion under the New Mexico Candidate Conservation Agreement. Because it involves surface disturbing activities covered under your Certificate, your Habitat Conservation Fund Account with the Center of Excellence for Hazardous

Materials Management (CEHMM) will be debited according to Exhibit B Part 2 of the Certificate of Participation.

#### **Watershed/Water Quality**

The entire perimeter of the well pad will be bermed to prevent oil, salt, and other chemical contaminants from leaving the well pad.

- The compacted berm shall be constructed at a minimum of 12 inches high with impermeable mineral material (e.g. caliche).
- No water flow from the uphill side(s) of the pad shall be allowed to enter the well pad.
- The topsoil stockpile shall be located outside the bermed well pad.
- Topsoil, either from the well pad or surrounding area, shall not be used to construct the berm.
- No storm drains, tubing or openings shall be placed in the berm.
- If fluid collects within the bermed area, the fluid must be vacuumed into a safe container and disposed of properly at a state approved facility.
- The integrity of the berm shall be maintained around the surfaced pad throughout the life of the well and around the downsized pad after interim reclamation has been completed.
- Any access road entering the well pad shall be constructed so that the integrity of the berm height surrounding the well pad is not compromised. (Any access road crossing the berm cannot be lower than the berm height.)

#### **Tank Battery**

Tank battery locations will be lined and bermed. A 20 mil permanent liner will be installed with a 4 oz. felt backing to prevent tears or punctures. Tank battery berms must be large enough to contain 1 ½ times the content of the largest tank. Automatic shut off, check valves, or similar systems will be installed for tanks to minimize the effects of catastrophic line failures used in production or drilling.

**BLM LEASE NUMBER:** NMNM000082

**COMPANY NAME:** Cimarex Energy Company

**ASSOCIATED WELL NAME:** Perry 22 Federal Com 4H

**Seed Mixture for LPC Sand/Shinnery Sites**

Holder shall seed all disturbed areas with the seed mixture listed below. The seed mixture shall be planted in the amounts specified in pounds of pure live seed (PLS)\* per acre. There shall be no primary or secondary noxious weeds in the seed mixture. Seed will be tested and the viability testing of seed shall be done in accordance with State law(s) and within nine (9) months prior to purchase. Commercial seed shall be either certified or registered seed. The seed container shall be tagged in accordance with State law(s) and available for inspection by the Authorized Officer.

Seed will be planted using a drill equipped with a depth regulator to ensure proper depth of planting where drilling is possible. The seed mixture will be evenly and uniformly planted over the disturbed area (smaller/heavier seeds have a tendency to drop the bottom of the drill and are planted first). Holder shall take appropriate measures to ensure this does not occur. Where drilling is not possible, seed will be broadcast and the area shall be raked or chained to cover the seed. When broadcasting the seed, the pounds per acre are to be doubled. Seeding shall be repeated until a satisfactory stand is established as determined by the Authorized Officer. Evaluation of growth may not be made before completion of at least one full growing season after seeding.

Species to be planted in pounds of pure live seed\* per acre:

<u>Species</u>	<u>lb/acre</u>
Plains Bristlegrass	5lbs/A
Sand Bluestem	5lbs/A
Little Bluestem	3lbs/A
Big Bluestem	6lbs/A
Plains Coreopsis	2lbs/A
Sand Dropseed	1lbs/A

\*Pounds of pure live seed:

Pounds of seed x percent purity x percent germination = pounds pure live seed

**BLM LEASE NUMBER:** NMNM000082  
**COMPANY NAME:** Cimarex Energy Company  
**ASSOCIATED WELL NAME:** Perry 22 Federal Com 4H

#### BURIED PIPELINE STIPULATIONS

A copy of the application (Grant, APD, or Sundry Notice) and attachments, including conditions of approval, survey plat and/or map, will be on location during construction. BLM personnel may request to you a copy of your permit during construction to ensure compliance with all stipulations.

Holder agrees to comply with the following stipulations to the satisfaction of the Authorized Officer:

1. The Holder shall indemnify the United States against any liability for damage to life or property arising from the occupancy or use of public lands under this grant.
2. The Holder shall comply with all applicable Federal laws and regulations existing or hereafter enacted or promulgated. In any event, the holder shall comply with the Toxic Substances Control Act of 1976 as amended, 15 USC 2601 et seq. (1982) with regards to any toxic substances that are used, generated by or stored on the right-of-way or on facilities authorized under this right-of-way grant. (See 40 CFR Part 702-799 and especially, provisions on polychlorinated biphenyls, 40 CFR 761.1-761.193.) Additionally, any release of toxic substances (leaks, spills, etc.) in excess of the reportable quantity established by 40 CFR Part 117 shall be reported as required by the Comprehensive Environmental Response, Compensation, and Liability Act, section 102b. A copy of any report required or requested by any Federal agency or State government as a result of a reportable release or spill of any toxic substances shall be furnished to the authorized officer concurrent with the filing of the reports to the involved Federal agency or State government.
3. The holder agrees to indemnify the United States against any liability arising from the release of any hazardous substance or hazardous waste (as these terms are defined in the Comprehensive Environmental Response, Compensation and Liability Act of 1980, 42 U.S.C. 9601, et seq. or the Resource Conservation and Recovery Act, 42 U.S.C. 6901, et seq.) on the Right-of-Way (unless the release or threatened release is wholly unrelated to the Right-of-Way holder's activity on the Right-of-Way), or resulting from the activity of the Right-of-Way holder on the Right-of-Way. This agreement applies without regard to whether a release is caused by the holder, its agent, or unrelated third parties.
4. If, during any phase of the construction, operation, maintenance, or termination of the pipeline, any oil or other pollutant should be discharged from the pipeline system, impacting Federal lands, the control and total removal, disposal, and cleaning up of such oil or other pollutant, wherever found, shall be the responsibility of holder, regardless of fault. Upon failure of holder to control, dispose of, or clean up such discharge on or affecting Federal lands, or to repair all damages resulting therefrom, on the Federal lands, the Authorized Officer may take such measures as he deems necessary to control and clean up the discharge and restore the area, including where appropriate, the aquatic environment and fish and wildlife habitats, at the full expense of the holder. Such action by the Authorized Officer shall not relieve holder of any responsibility as provided herein.
5. All construction and maintenance activity will be confined to the authorized right-of-way.
6. The pipeline will be buried with a minimum cover of 36 inches between the top of the pipe and ground level.
7. The maximum allowable disturbance for construction in this right-of-way will be 30 feet:

- Blading of vegetation within the right-of-way will be allowed: maximum width of blading operations will not exceed 20 feet. The trench is included in this area. (*Blading is defined as the complete removal of brush and ground vegetation.*)
- Clearing of brush species within the right-of-way will be allowed: maximum width of clearing operations will not exceed 30 feet. The trench and bladed area are included in this area. (*Clearing is defined as the removal of brush while leaving ground vegetation (grasses, weeds, etc.) intact. Clearing is best accomplished by holding the blade 4 to 6 inches above the ground surface.*)
- The remaining area of the right-of-way (if any) shall only be disturbed by compressing the vegetation. (*Compressing can be caused by vehicle tires, placement of equipment, etc.*)

8. The holder shall stockpile an adequate amount of topsoil where blading is allowed. The topsoil to be stripped is approximately 6 inches in depth. The topsoil will be segregated from other spoil piles from trench construction. The topsoil will be evenly distributed over the bladed area for the preparation of seeding.

9. The holder shall minimize disturbance to existing fences and other improvements on public lands. The holder is required to promptly repair improvements to at least their former state. Functional use of these improvements will be maintained at all times. The holder will contact the owner of any improvements prior to disturbing them. When necessary to pass through a fence line, the fence shall be braced on both sides of the passageway prior to cutting of the fence. No permanent gates will be allowed unless approved by the Authorized Officer.

10. Vegetation, soil, and rocks left as a result of construction or maintenance activity will be randomly scattered on this right-of-way and will not be left in rows, piles, or berms, unless otherwise approved by the Authorized Officer. The entire right-of-way shall be recontoured to match the surrounding landscape. The backfilled soil shall be compacted and a 6 inch berm will be left over the ditch line to allow for settling back to grade.

11. In those areas where erosion control structures are required to stabilize soil conditions, the holder will install such structures as are suitable for the specific soil conditions being encountered and which are in accordance with sound resource management practices.

12. The holder will reseed all disturbed areas. Seeding will be done according to the attached seeding requirements, using the following seed mix.

- |                                                        |                                                  |
|--------------------------------------------------------|--------------------------------------------------|
| <input type="checkbox"/> seed mixture 1                | <input type="checkbox"/> seed mixture 3          |
| <input type="checkbox"/> seed mixture 2                | <input type="checkbox"/> seed mixture 4          |
| <input checked="" type="checkbox"/> seed mixture 2/LPC | <input type="checkbox"/> Aplomado Falcon Mixture |

13. All above-ground structures not subject to safety requirements shall be painted by the holder to blend with the natural color of the landscape. The paint used shall be color which simulates "Standard Environmental Colors" – **Shale Green**, Munsell Soil Color No. 5Y 4/2.

14. The pipeline will be identified by signs at the point of origin and completion of the right-of-way and at all road crossings. At a minimum, signs will state the holder's name, BLM serial number, and the product being transported. All signs and information thereon will be posted in a permanent, conspicuous manner, and will be maintained in a legible condition for the life of the pipeline.

15. The holder shall not use the pipeline route as a road for purposes other than routine maintenance as determined necessary by the Authorized Officer in consultation with the holder before maintenance begins. The holder will take whatever steps are necessary to ensure that the pipeline route is not used as a roadway. As determined necessary during the life of the pipeline, the Authorized Officer may ask the holder to construct temporary deterrence structures.



16. Any cultural and/or paleontological resources (historic or prehistoric site or object) discovered by the holder, or any person working on his behalf, on public or Federal land shall be immediately reported to the Authorized Officer. Holder shall suspend all operations in the immediate area of such discovery until written authorization to proceed is issued by the Authorized Officer. An evaluation of the discovery will be made by the Authorized Officer to determine appropriate actions to prevent the loss of significant cultural or scientific values. The holder will be responsible for the cost of evaluation and any decision as to proper mitigation measures will be made by the Authorized Officer after consulting with the holder.

17. The operator shall be held responsible if noxious weeds become established within the areas of operations. Weed control shall be required on the disturbed land where noxious weeds exist, which includes associated roads, pipeline corridor and adjacent land affected by the establishment of weeds due to this action. The operator shall consult with the Authorized Officer for acceptable weed control methods, which include following EPA and BLM requirements and policies.

18. Escape Ramps - The operator will construct and maintain pipeline/utility trenches [that are not otherwise fenced, screened, or netted] to prevent livestock, wildlife, and humans from becoming entrapped. At a minimum, the operator will construct and maintain escape ramps, ladders, or other methods of avian and terrestrial wildlife escape in the trenches according to the following criteria:

- a. Any trench left open for eight (8) hours or less is not required to have escape ramps; however, before the trench is backfilled, the contractor/operator shall inspect the trench for wildlife, remove all trapped wildlife, and release them at least 100 yards from the trench.
- b. For trenches left open for eight (8) hours or more, earthen escape ramps (built at no more than a 30 degree slope and spaced no more than 500 feet apart) shall be placed in the trench.

19. Special Stipulations:

**Lesser Prairie-Chicken**

Oil and gas activities will not be allowed in lesser prairie-chicken habitat during the period from March 1st through June 15th annually. During that period, other activities that produce noise or involve human activity, such as the maintenance of oil and gas facilities, geophysical exploration other than 3-D operations, and pipeline, road, and well pad construction, will be allowed except between 3:00 am and 9:00 am. The 3:00 am to 9:00 am restriction will not apply to normal, around-the-clock operations, such as venting, flaring, or pumping, which do not require a human presence during this period. Normal vehicle use on existing roads will not be restricted. Exhaust noise from pump jack engines must be muffled or otherwise controlled so as not to exceed 75 db measured at 30 ft. from the source of the noise.

**BLM LEASE NUMBER:** NMNM000082  
**COMPANY NAME:** Cimarex Energy Company  
**ASSOCIATED WELL NAME:** Perry 22 Federal Com 4H

Seed Mixture for LPC Sand/Shinnery Sites

Holder shall seed all disturbed areas with the seed mixture listed below. The seed mixture shall be planted in the amounts specified in pounds of pure live seed (PLS)\* per acre. There shall be no primary or secondary noxious weeds in the seed mixture. Seed will be tested and the viability testing of seed shall be done in accordance with State law(s) and within nine (9) months prior to purchase. Commercial seed shall be either certified or registered seed. The seed container shall be tagged in accordance with State law(s) and available for inspection by the Authorized Officer.

Seed will be planted using a drill equipped with a depth regulator to ensure proper depth of planting where drilling is possible. The seed mixture will be evenly and uniformly planted over the disturbed area (smaller/heavier seeds have a tendency to drop the bottom of the drill and are planted first). Holder shall take appropriate measures to ensure this does not occur. Where drilling is not possible, seed will be broadcast and the area shall be raked or chained to cover the seed. When broadcasting the seed, the pounds per acre are to be doubled. Seeding shall be repeated until a satisfactory stand is established as determined by the Authorized Officer. Evaluation of growth may not be made before completion of at least one full growing season after seeding.

Species to be planted in pounds of pure live seed\* per acre:

<u>Species</u>	<u>lb/acre</u>
Plains Bristlegrass	5lbs/A
Sand Bluestem	5lbs/A
Little Bluestem	3lbs/A
Big Bluestem	6lbs/A
Plains Coreopsis	2lbs/A
Sand Dropseed	1lbs/A

\*Pounds of pure live seed:

Pounds of seed x percent purity x percent germination = pounds pure live seed

**BLM LEASE NUMBER: NMNM000082**

**COMPANY NAME: Cimarex Energy Company**

**ASSOCIATED WELL NAME: Perry 22 Federal Com 4H**

#### STANDARD STIPULATIONS FOR SURFACE INSTALLED PIPELINES

**A copy of the application (Grant, Sundry Notice, APD) and attachments, including stipulations, survey plat and/or map, will be on location during construction. BLM personnel may request to you a copy of your permit during construction to ensure compliance with all stipulations.**

Holder agrees to comply with the following stipulations to the satisfaction of the Authorized Officer:

1. The holder shall indemnify the United States against any liability for damage to life or property arising from the occupancy or use of public lands under this grant.
2. The holder shall comply with all applicable Federal laws and regulations existing or hereafter enacted or promulgated. In any event, the holder shall comply with the Toxic Substances Control Act of 1976 as amended, 15 USC 2601 et seq. (1982) with regards to any toxic substances that are used, generated by or stored on the right-of-way or on facilities authorized under this right-of-way grant. (See 40 CFR, Part 702-799 and especially, provisions on polychlorinated biphenyls, 40 CFR 761.1-761.193.) Additionally, any release of toxic substances (leaks, spills, etc.) in excess of the reportable quantity established by 40 CFR, Part 117 shall be reported as required by the Comprehensive Environmental Response, Compensation, and Liability Act, section 102b. A copy of any report required or requested by any Federal agency or State government as a result of a reportable release or spill of any toxic substances shall be furnished to the authorized officer concurrent with the filing of the reports to the involved Federal agency or State government.
3. The holder agrees to indemnify the United States against any liability arising from the release of any hazardous substance or hazardous waste (as these terms are defined in the Comprehensive Environmental Response, Compensation and Liability Act of 1980, 42 U.S.C. 9601, et seq. or the Resource Conservation and Recovery Act, 42 U.S.C. 6901, et seq.) on the Right-of-Way (unless the release or threatened release is wholly unrelated to activity of the Right-of-Way holder's activity on the Right-of-Way), or resulting from the activity of the Right-of-Way holder on the Right-of-Way. This agreement applies without regard to whether a release is caused by the holder, its agent, or unrelated third parties.
4. The holder shall be liable for damage or injury to the United States to the extent provided by 43 CFR Sec. 2883.1-4. The holder shall be held to a standard of strict liability for damage or injury to the United States resulting from pipe rupture, fire, or spills caused or substantially aggravated by any of the following within the right-of-way or permit area:
  - a. Activities of the holder including, but not limited to construction, operation, maintenance, and termination of the facility.
  - b. Activities of other parties including, but not limited to:
    - (1) Land clearing.
    - (2) Earth-disturbing and earth-moving work.
    - (3) Blasting.
    - (4) Vandalism and sabotage.
  - c. Acts of God.

The maximum limitation for such strict liability damages shall not exceed one million dollars (\$1,000,000) for any one event, and any liability in excess of such amount shall be determined by the ordinary rules of negligence of the jurisdiction in which the damage or injury occurred.

This section shall not impose strict liability for damage or injury resulting primarily from an act of war or from the negligent acts or omissions of the United States.

5. If, during any phase of the construction, operation, maintenance, or termination of the pipeline, any oil, salt water, or other pollutant should be discharged from the pipeline system, impacting Federal lands, the control and total removal, disposal, and cleaning up of such oil, salt water, or other pollutant, wherever found, shall be the responsibility of the holder, regardless of fault. Upon failure of the holder to control, dispose of, or clean up such discharge on or affecting Federal lands, or to repair all damages resulting therefrom, on the Federal lands, the Authorized Officer may take such measures as he deems necessary to control and clean up the discharge and restore the area, including, where appropriate, the aquatic environment and fish and wildlife habitats, at the full expense of the holder. Such action by the Authorized Officer shall not relieve the holder of any responsibility as provided herein.

6. All construction and maintenance activity will be confined to the authorized right-of-way width of 20 feet. If the pipeline route follows an existing road or buried pipeline right-of-way, the surface pipeline must be installed no farther than 10 feet from the edge of the road or buried pipeline right-of-way. If existing surface pipelines prevent this distance, the proposed surface pipeline must be installed immediately adjacent to the outer surface pipeline. All construction and maintenance activity will be confined to existing roads or right-of-ways.

7. No blading or clearing of any vegetation will be allowed unless approved in writing by the Authorized Officer.

8. The holder shall install the pipeline on the surface in such a manner that will minimize suspension of the pipeline across low areas in the terrain. In hummocky or dune areas, the pipeline will be "snaked" around hummocks and dunes rather than suspended across these features.

9. The pipeline shall be buried with a minimum of 24 inches under all roads, "two-tracks," and trails. Burial of the pipe will continue for 20 feet on each side of each crossing. The condition of the road, upon completion of construction, shall be returned to at least its former state with no bumps or dips remaining in the road surface.

10. The holder shall minimize disturbance to existing fences and other improvements on public lands. The holder is required to promptly repair improvements to at least their former state. Functional use of these improvements will be maintained at all times. The holder will contact the owner of any improvements prior to disturbing them. When necessary to pass through a fence line, the fence shall be braced on both sides of the passageway prior to cutting of the fence. No permanent gates will be allowed unless approved by the Authorized Officer.

11. In those areas where erosion control structures are required to stabilize soil conditions, the holder will install such structures as are suitable for the specific soil conditions being encountered and which are in accordance with sound resource management practices.

12. Excluding the pipe, all above-ground structures not subject to safety requirement shall be painted by the holder to blend with the natural color of the landscape. The paint used shall be a color which simulates "Standard Environmental Colors" – **Shale Green**, Munsell Soil Color No. 5Y 4/2; designated by the Rocky Mountain Five State Interagency Committee.

13. The pipeline will be identified by signs at the point of origin and completion of the right-of-way and at all road crossings. At a minimum, signs will state the holder's name, BLM serial number, and the product being transported. Signs will be maintained in a legible condition for the life of the pipeline.

14. The holder shall not use the pipeline route as a road for purposes other than routine maintenance as determined necessary by the Authorized Officer in consultation with the holder. The holder will take whatever steps are necessary to ensure that the pipeline route is not used as a roadway.

15. Any cultural and/or paleontological resource (historic or prehistoric site or object) discovered by the holder, or any person working on his behalf, on public or Federal land shall be immediately reported to the authorized officer. Holder shall suspend all operations in the immediate area of such discovery until written authorization to proceed is issued by the authorized officer. An evaluation of the discovery will be made by the authorized officer to determine appropriate cultural or scientific values. The holder will be responsible for the cost of evaluation and any decision as to proper mitigation measures will be made by the authorized officer after consulting with the holder.

16. The operator shall be held responsible if noxious weeds become established within the areas of operations. Weed control shall be required on the disturbed land where noxious weeds exist, which includes the roads, powerline corridor, and adjacent land affected by the establishment of weeds due to this action. The operator shall consult with the Authorized Officer for acceptable weed control methods, which include following EPA and BLM requirements and policies.

17. Surface pipelines must be less than or equal to 4 inches and a working pressure below 125 psi.

18. Special Stipulations:

- a. **Lesser Prairie-Chicken:** Oil and gas activities will not be allowed in lesser prairie-chicken habitat during the period from March 1st through June 15th annually. During that period, other activities that produce noise or involve human activity, such as the maintenance of oil and gas facilities and pipeline, road, and well pad construction, will be allowed except between 3:00 am and 9:00 am. The 3:00 am to 9:00 am restriction will not apply to normal, around-the-clock operations, such as venting, flaring, or pumping, which do not require a human presence during this period. Normal vehicle use on existing roads will not be restricted.

#### **Dunes Sagebrush Lizard Trench Stipulation**

- Pre-construction contact with a BLM wildlife biologist is required within 5 days before any ground disturbing activities associated with the project occurs.
- Successful completion of the BLM Trench Stipulation Workshop is required for a non-agency person to be approved as a monitor.
- Any trench left open for (8) hours or less is not required to have escape ramps; however, before the trench is backfilled, an agency approved monitor shall walk the entire length of the open trench and remove all trapped vertebrates. The bottom surface of the trench will be disturbed a minimum of 2 inches in order to arouse any buried vertebrates. All vertebrates will be released a minimum of 100 yards from the trench.
- For trenches left open for eight (8) hours or more the following requirements apply:
  - Earthen escape ramps and/or structures (built at no more than a 30 degree slope and spaced no more than 500 feet apart) shall be placed in the trench. Metal structures will not be authorized. Options will be discussed in detail at the required Trench Stipulation Workshop.
  - One approved monitor shall be required to survey up to three miles of trench between the hours of 11 AM-2 PM. A daily report (consolidate if there is more than one monitor) on the vertebrates found and removed from the trench shall be provided to the BLM (email/fax is acceptable) the following morning.
  - Prior to backfilling of the trench all structures used as escape ramps will be removed and the bottom surface of the trench will be disturbed a minimum of 2 inches in order to arouse any buried vertebrates. All vertebrates will be released a minimum of 100 yards from the trench.

- This stipulation shall apply to the entire length of the project in the DSL habitat polygon regardless of land ownership or CCA/CCAA enrollment status.
- A project closeout will be required within three business days of the completion of the project.

**Surface Pipeline:**

A leak detection plan will be submitted to the BLM Carlsbad Field Office for approval prior to pipeline installation. The method could incorporate gauges to detect pressure drops, siting valves and lines so they can be visually inspected periodically or installing electronic sensors to alarm when a leak is present. The leak detection plan will incorporate an automatic shut off system that will be installed for proposed pipelines to minimize the effects of an undesirable event.

**BLM LEASE NUMBER:** NMNM000082

**COMPANY NAME:** Cimarex Energy Company

**ASSOCIATED WELL NAME:** Perry 22 Federal Com 4H

**Seed Mixture for LPC Sand/Shinnery Sites**

Holder shall seed all disturbed areas with the seed mixture listed below. The seed mixture shall be planted in the amounts specified in pounds of pure live seed (PLS)\* per acre. There shall be no primary or secondary noxious weeds in the seed mixture. Seed will be tested and the viability testing of seed shall be done in accordance with State law(s) and within nine (9) months prior to purchase. Commercial seed shall be either certified or registered seed. The seed container shall be tagged in accordance with State law(s) and available for inspection by the Authorized Officer.

Seed will be planted using a drill equipped with a depth regulator to ensure proper depth of planting where drilling is possible. The seed mixture will be evenly and uniformly planted over the disturbed area (smaller/heavier seeds have a tendency to drop the bottom of the drill and are planted first). Holder shall take appropriate measures to ensure this does not occur. Where drilling is not possible, seed will be broadcast and the area shall be raked or chained to cover the seed. When broadcasting the seed, the pounds per acre are to be doubled. Seeding shall be repeated until a satisfactory stand is established as determined by the Authorized Officer. Evaluation of growth may not be made before completion of at least one full growing season after seeding.

Species to be planted in pounds of pure live seed\* per acre:

<u>Species</u>	<u>lb/acre</u>
Plains Bristlegrass	5lbs/A
Sand Bluestem	5lbs/A
Little Bluestem	3lbs/A
Big Bluestem	6lbs/A
Plains Coreopsis	2lbs/A
Sand Dropseed	1lbs/A

\*Pounds of pure live seed:

Pounds of seed x percent purity x percent germination = pounds pure live seed

**BLM LEASE NUMBER:** NMNM000082  
**COMPANY NAME:** Cimarex Energy Company  
**ASSOCIATED WELL NAME:** Perry 22 Federal Com 4H

STANDARD STIPULATIONS FOR OVERHEAD ELECTRIC DISTRIBUTION LINES

**A copy of the grant and attachments, including stipulations, survey plat and/or map, will be on location during construction. BLM personnel may request to you a copy of your permit during construction to ensure compliance with all stipulations.**

Holder agrees to comply with the following stipulations to the satisfaction of the Authorized Officer:

1. The holder shall indemnify the United States against any liability for damage to life or property arising from the occupancy or use of public lands under this grant.
2. The holder shall comply with all applicable Federal laws and regulations existing or hereafter enacted or promulgated. In any event, the holder shall comply with the Toxic Substances Control Act of 1976 as amended, 15 USC 2601 et seq. (1982) with regards to any toxic substances that are used, generated by or stored on the right-of-way or on facilities authorized under this right-of-way grant. (See 40 CFR, Part 702-799 and especially, provisions on polychlorinated biphenyls, 40 CFR 761.1-761.193.) Additionally, any release of toxic substances (leaks, spills, etc.) in excess of the reportable quantity established by 40 CFR, Part 117 shall be reported as required by the Comprehensive Environmental Response, Compensation, and Liability Act, section 102b. A copy of any report required or requested by any Federal agency or State government as a result of a reportable release or spill of any toxic substances shall be furnished to the authorized officer concurrent with the filing of the reports to the involved Federal agency or State government.
3. The holder agrees to indemnify the United States against any liability arising from the release of any hazardous substance or hazardous waste (as these terms are defined in the Comprehensive Environmental Response, Compensation and Liability Act of 1980, 42 U.S.C. 9601, et seq. or the Resource Conservation and Recovery Act, 42 U.S.C. 6901, et seq.) on the Right-of-Way (unless the release or threatened release is wholly unrelated to the Right-of-Way holder's activity on the Right-of-Way), or resulting from the activity of the Right-of-Way holder on the Right-of-Way. This agreement applies without regard to whether a release is caused by the holder, its agent, or unrelated third parties.
4. There will be no clearing or blading of the right-of-way unless otherwise agreed to in writing by the Authorized Officer.
5. Power lines shall be constructed and designed in accordance to standards outlined in "Suggested Practices for Avian Protection on Power lines: The State of the Art in 2006" Edison Electric Institute, APLIC, and the California Energy Commission 2006 . The holder shall assume the burden and expense of proving that pole designs not shown in the above publication deter raptor perching, roosting, and nesting. Such proof shall be provided by a raptor expert approved by the Authorized Officer. The BLM reserves the right to require modification or additions to all powerline structures placed on this right-of-way, should they be necessary to ensure the safety of large perching birds. Such modifications and/or additions shall be made by the holder without liability or expense to the United States.

Raptor deterrence will consist of but not limited to the following: triangle perch discouragers shall be placed on each side of the cross arms and a nonconductive perching deterrence shall be placed on all



vertical poles that extend past the cross arms.

6. The holder shall minimize disturbance to existing fences and other improvements on public lands. The holder is required to promptly repair improvements to at least their former state. Functional use of these improvements will be maintained at all times. The holder will contact the owner of any improvements prior to disturbing them. When necessary to pass through a fence line, the fence shall be braced on both sides of the passageway prior to cutting the fence. No permanent gates will be allowed unless approved by the Authorized Officer.

7. The BLM serial number assigned to this authorization shall be posted in a permanent, conspicuous manner where the power line crosses roads and at all serviced facilities. Numbers will be at least two inches high and will be affixed to the pole nearest the road crossing and at the facilities served.

8. Upon cancellation, relinquishment, or expiration of this grant, the holder shall comply with those abandonment procedures as prescribed by the Authorized Officer.

9. All surface structures (poles, lines, transformers, etc.) shall be removed within 180 days of abandonment, relinquishment, or termination of use of the serviced facility or facilities or within 180 days of abandonment, relinquishment, cancellation, or expiration of this grant, whichever comes first. This will not apply where the power line extends service to an active, adjoining facility or facilities.

10. Any cultural and/or paleontological resource (historic or prehistoric site or object) discovered by the holder, or any person working on his behalf, on public or Federal land shall be immediately reported to the Authorized Officer. Holder shall suspend all operations in the immediate area of such discovery until written authorization to proceed is issued by the Authorized Officer. An evaluation of the discovery will be made by the Authorized Officer to determine appropriate actions to prevent the loss of significant cultural or scientific values. The holder will be responsible for the cost of evaluation and any decision as to proper mitigation measures will be made by the Authorized Officer after consulting with the holder.

11. Special Stipulations:

- For reclamation remove poles, lines, transformer, etc. and dispose of properly.
- Fill in any holes from the poles removed.

**Timing Limitation Stipulation/Condition of Approval for Lesser Prairie-Chicken:**

Oil and gas activities including 3-D geophysical exploration, and drilling will not be allowed in lesser prairie-chicken habitat during the period from March 1st through June 15th annually. During that period, other activities that produce noise or involve human activity, such as the maintenance of oil and gas facilities, geophysical exploration other than 3-D operations, and pipeline, road, and well pad construction, will be allowed except between 3:00 am and 9:00 am. The 3:00 am to 9:00 am restriction will not apply to normal, around-the-clock operations, such as venting, flaring, or pumping, which do not require a human presence during this period. Additionally, no new drilling will be allowed within up to 200 meters of leks known at the time of permitting. Normal vehicle use on existing roads will not be restricted. Exhaust noise from pump jack engines must be muffled or otherwise controlled so as not to exceed 75 db measured at 30 ft. from the source of the noise.

**BLM LEASE NUMBER:** NMNM000082  
**COMPANY NAME:** Cimarex Energy Company  
**ASSOCIATED WELL NAME:** Perry 22 Federal Com 4H

Seed Mixture for LPC Sand/Shinnery Sites

Holder shall seed all disturbed areas with the seed mixture listed below. The seed mixture shall be planted in the amounts specified in pounds of pure live seed (PLS)\* per acre. There shall be no primary or secondary noxious weeds in the seed mixture. Seed will be tested and the viability testing of seed shall be done in accordance with State law(s) and within nine (9) months prior to purchase. Commercial seed shall be either certified or registered seed. The seed container shall be tagged in accordance with State law(s) and available for inspection by the Authorized Officer.

Seed will be planted using a drill equipped with a depth regulator to ensure proper depth of planting where drilling is possible. The seed mixture will be evenly and uniformly planted over the disturbed area (smaller/heavier seeds have a tendency to drop the bottom of the drill and are planted first). Holder shall take appropriate measures to ensure this does not occur. Where drilling is not possible, seed will be broadcast and the area shall be raked or chained to cover the seed. When broadcasting the seed, the pounds per acre are to be doubled. Seeding shall be repeated until a satisfactory stand is established as determined by the Authorized Officer. Evaluation of growth may not be made before completion of at least one full growing season after seeding.

Species to be planted in pounds of pure live seed\* per acre:

<u>Species</u>	<u>lb/acre</u>
Plains Bristlegrass	5lbs/A
Sand Bluestem	5lbs/A
Little Bluestem	3lbs/A
Big Bluestem	6lbs/A
Plains Coreopsis	2lbs/A
Sand Dropseed	1lbs/A

\*Pounds of pure live seed:

Pounds of seed x percent purity x percent germination = pounds pure live seed