

District I  
1625 N. French Dr., Hobbs, NM 88240  
District II  
1301 W. Grand Avenue, Artesia, NM 88210  
District III  
1000 Rio Brazos Road, Aztec, NM 87410  
District IV  
1220 S. St. Francis Dr., Santa Fe, NM 87505

State of New Mexico  
Energy Minerals and Natural Resources

Form C-144  
June 1, 2004

Oil Conservation Division  
1220 South St. Francis Dr.  
Santa Fe, NM 87505

For drilling and production facilities, submit to  
appropriate NMOCD District Office.  
For downstream facilities, submit to Santa Fe  
office

**Pit or Below-Grade Tank Registration or Closure**

Is pit or below-grade tank covered by a "general plan"? Yes ☒ No ☐

Type of action: Registration of a pit or below-grade tank ☐ Closure of a pit or below-grade tank ☒

Operator: <u>Yates Petroleum Corporation</u> Telephone: <u>505-748-4500</u> e-mail address: <u>mikes@yppcnm.com</u>		
Address: <u>105 South 4<sup>th</sup> Street, Artesia, N.M. 88210</u>		
Facility or well name: <u>Milsap State Unit 2</u> API #: <u>30-025-37544</u> U/L or Qtr/Qtr H_Sec <u>36</u> T <u>12S</u> R <u>33E</u>		
County: <u>Lea</u> Latitude <u>33.23672</u> Longitude <u>103.56047</u> NAD: 1927 <input checked="" type="checkbox"/> 1983 <input type="checkbox"/>		
Surface Owner: Federal <input type="checkbox"/> State <input checked="" type="checkbox"/> Private <input type="checkbox"/> Indian <input type="checkbox"/>		
<b>Pit</b> Type: Drilling <input checked="" type="checkbox"/> Production <input type="checkbox"/> Disposal <input type="checkbox"/> Work over <input type="checkbox"/> Emergency <input type="checkbox"/> Lined <input checked="" type="checkbox"/> Unlined <input type="checkbox"/> Liner type: Synthetic <input checked="" type="checkbox"/> Thickness <u>12</u> mil Clay <input type="checkbox"/> Pit Volume <u>24,000</u> bbl	<b>Below-grade tank</b> Volume: _____ bbl Type of fluid: _____ Construction material: _____ Double-walled, with leak detection? Yes <input type="checkbox"/> If not, explain why not. _____	
Depth to ground water (vertical distance from bottom of pit to seasonal high water elevation of ground water.)	Less than 50 feet 50 feet or more, but less than 100 feet 100 feet or more	(20 points) (10 points) XXXX (0 points)
Wellhead protection area: (Less than 200 feet from a private domestic water source, or less than 1000 feet from all other water sources.)	Yes No	(20 points) (0 points) XXXX
Distance to surface water: (horizontal distance to all wetlands, playas, irrigation canals, ditches, and perennial and ephemeral watercourses.)	Less than 200 feet 200 feet or more, but less than 1000 feet 1000 feet or more	(20 points) (10 points) (0 points) XXXX
	<b>Ranking Score (Total Points)</b>	<b>10 POINTS</b>

**If this is a pit closure:** (1) Attach a diagram of the facility showing the pit's relationship to other equipment and tanks. (2) Indicate disposal location: (check the onsite box if you are burying in place) onsite ☒ offsite ☐ If offsite, name of facility NA. (3) Attach a general description of remedial action taken including remediation start date and end date.

(4) Groundwater encountered: No ☐ Yes ☐ If yes, show depth below ground surface \_\_\_\_\_ ft. and attach sample results.

(5) Attach soil sample results and a diagram of sample locations and excavations.

Additional Comments: Closure workplan for drilling pit The drilling pit contents will be mixed to stiffen the pit contents. A encapsulation trench will be excavated and lined with a 12 mil synthetic liner on former drilling pit site. Drilling pit contents will then be emplaced into the encapsulation trench. A 20 mil synthetic liner will then be placed over the pit contents with a minimum of a 3' over lap of the underlying trench areas. The encapsulation trench will then be backfilled to grade using a minimum of 3' of clean soil and like material. A one call and 48 hour notice will be provided to the Oil Conservation Division before pit closure actions begin.

Pit Closure actions to begin by NA. Ending date NA

I hereby certify that the information above is true and complete to the best of my knowledge and belief. I further certify that the above-described pit or below-grade tank has been/will be constructed or closed according to NMOCD guidelines ☐, a general permit ☒, or an (attached) alternative OCD-approved plan ☐.

Date: 04/20/2006

Printed Name/Title Mike Stubblefield / Regulatory Agent

Signature Mike Stubblefield

Your certification and NMOCD approval of this application/closure does not relieve the operator of liability should the contents of the pit or tank contaminate ground water or otherwise endanger public health or the environment. Nor does it relieve the operator of its responsibility for compliance with any other federal, state, or local laws and/or regulations.

Approval:

Printed Name/Title GARY W. WINK / STAFF MGR

Signature Gary W. Wink

Date: 4/27/06

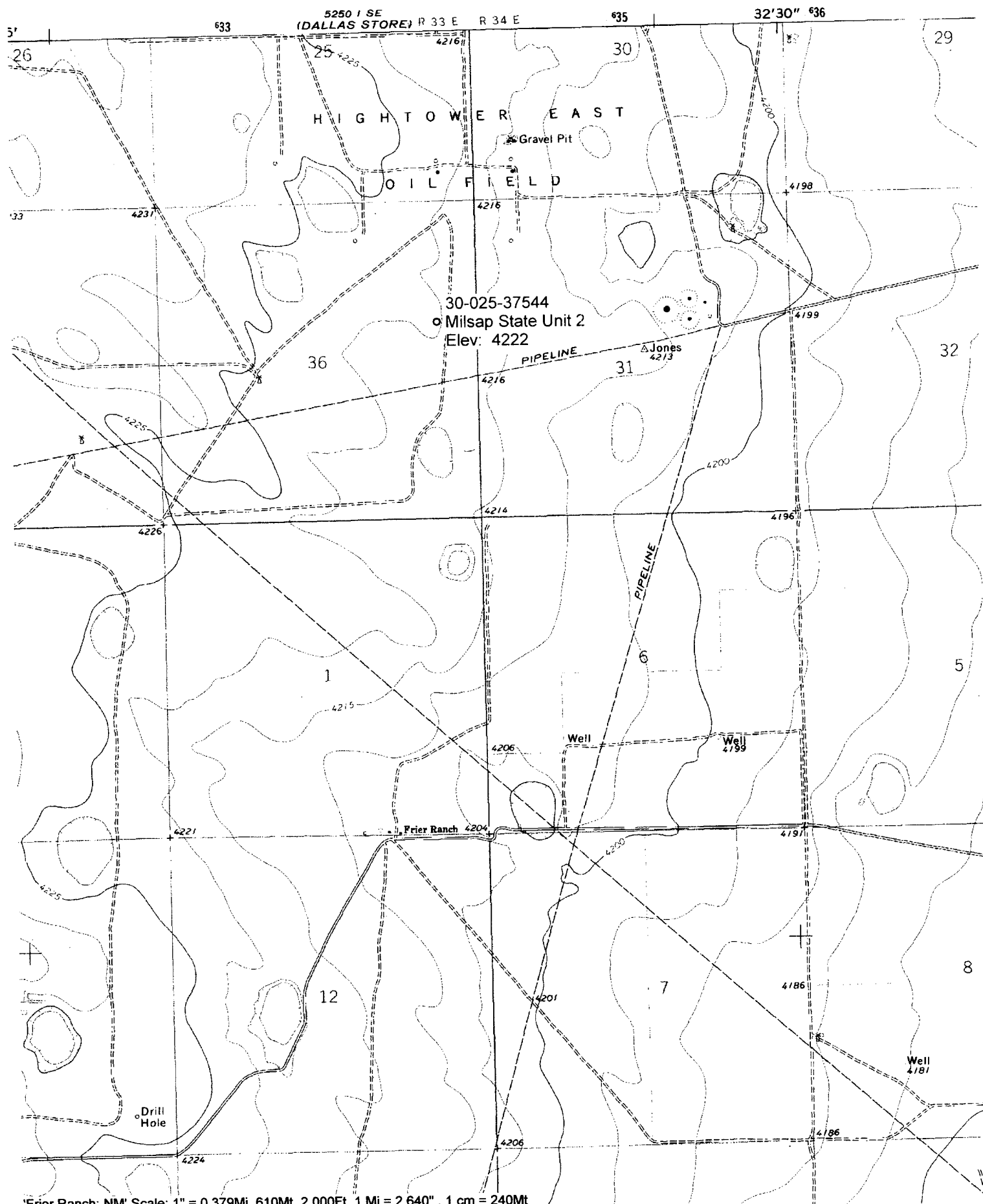

Frier Ranch, NM Scale: 1" = 0.379Mi 610Mt 2,000Ft, 1 Mi = 2.640", 1 cm = 240Mt

**New Mexico Office of the State Engineer**  
**POD Reports and Downloads**

MILSAP STATE UNIT 2

Township: 12S Range: 33E Sections:

NAD27 X: Y: Zone: Search Radius:

County: Basin: Number: Suffix:

Owner Name: (First) (Last) ☐ Non-Domestic ☐ Domestic  
☒ All

POD / Surface Data Report

Avg Depth to Water Report

Water Column Report

Clear Form

iWATERS Menu

Help

**AVERAGE DEPTH OF WATER REPORT 04/18/2006**

Bsn	Tws	Rng	Sec	Zone	X	Y	Wells	(Depth Water in Feet)		
								Min	Max	Avg
L	12S	33E	01				3	46	55	52
L	12S	33E	02				7	42	55	50
L	12S	33E	03				5	45	68	53
L	12S	33E	04				2	70	70	70
L	12S	33E	05				2	80	80	80
L	12S	33E	11				1	65	65	65
L	12S	33E	12				1	50	50	50
L	12S	33E	14				1	55	55	55
L	12S	33E	15				1	80	80	80
L	12S	33E	18				1	70	70	70
L	12S	33E	20				1	95	95	95
L	12S	33E	25				1	78	78	78
L	12S	33E	29				1	80	80	80
L	12S	33E	33				2	100	100	100
L	12S	33E	34				2	90	90	90

Record Count: 31

MILSAP STATE UNIT 2

	A	B	C	D	E	F	G	H	I	J	K	L	M	N	O	P	Q	R	S
3	UL	SEC	TWN	RNG	SPOT	COUNTY	SOURCE	USGS SITE NUM.	QTY	SITE LOCATION	DATE	LEVEL	DATUM	Formation	DEPTH	LAT	LON	SORT1	SORT2
864	K	36	12S	33E	32114	LEA	SEO		1	12S.33E.36.32114	1981-03-11	76.95						S12E33.36.32114	1981-03-11