

District I  
1625 N. French Dr., Hobbs, NM 88240  
District II  
1301 W. Grand Avenue, Artesia, NM 88210  
District III  
1000 Rio Brazos Road, Aztec, NM 87410  
District IV  
1220 S. St. Francis Dr., Santa Fe, NM 87505

State of New Mexico  
Energy Minerals and Natural Resources

Form C-144  
June 1, 2004

Oil Conservation Division  
1220 South St. Francis Dr.  
Santa Fe, NM 87505

For drilling and production facilities, submit to appropriate NMOCD District Office.  
For downstream facilities, submit to Santa Fe office

**Pit or Below-Grade Tank Registration or Closure**

Is pit or below-grade tank covered by a "general plan"? Yes ☒ No ☐

Type of action: Registration of a pit or below-grade tank ☐ Closure of a pit or below-grade tank ☒

|  |  |
|--|--|
| Operator: <u>Apache Corp.</u> Telephone: <u>918-491-4900</u> e-mail address: <u>seay et @laco.net</u>  |  |
| Address: <u>6120 S. Yale</u> <u>Tulsa, OK 74136</u>  |  |
| Facility or well name: <u>NEDU #843</u>  | API #: <u>30-025-37619</u> U/L or Qtr/Qtr <u>A</u> Sec <u>23</u> T <u>21</u> R <u>37</u>   |
| County: <u>Lea</u>   | Latitude <u>32 28 19</u> Longitude <u>103 07 19</u> NAD: 1927 <input type="checkbox"/> 1983 <input type="checkbox"/>   |
| Surface Owner: Federal <input type="checkbox"/> State <input checked="" type="checkbox"/> Private <input checked="" type="checkbox"/> Indian <input type="checkbox"/>  |  |
| <b>Pit</b><br>Type: Drilling <input type="checkbox"/> Production <input type="checkbox"/> Disposal <input type="checkbox"/><br>Workover <input type="checkbox"/> Emergency <input type="checkbox"/><br>Lined <input type="checkbox"/> Unlined <input type="checkbox"/><br>Liner type: Synthetic <input type="checkbox"/> Thickness <u>      </u> mil Clay <input type="checkbox"/><br>Pit Volume <u>      </u> bbl | <b>Below-grade tank</b><br>Volume: <u>      </u> bbl Type of fluid: <u>      </u><br>Construction material: <u>      </u><br>Double-walled, with leak detection? Yes <input type="checkbox"/> If not, explain why not: <u>      </u> |
| Depth to ground water (vertical distance from bottom of pit to seasonal high water elevation of ground water.) <u>42 ft</u>  | <u>Less than 50 feet</u> (20 points)<br>50 feet or more, but less than 100 feet (10 points)<br>100 feet or more (0 points)   |
| Wellhead protection area: (Less than 200 feet from a private domestic water source, or less than 1000 feet from all other water sources.)  | Yes (20 points)<br><u>No</u> (0 points)  |
| Distance to surface water: (horizontal distance to all wetlands, playas, irrigation canals, ditches, and perennial and ephemeral watercourses.)  | Less than 200 feet (20 points)<br><u>200 feet or more, but less than 1000 feet</u> (10 points)<br>1000 feet or more (0 points)   |
| Ranking Score (Total Points) <u>30</u>   |  |

If this is a pit closure: (1) Attach a diagram of the facility showing the pit's relationship to other equipment and tanks. (2) Indicate disposal location: (check the onsite box if you are burying in place) onsite ☐ offsite ☒ If offsite, name of facility       . (3) Attach a general description of remedial action taken including remediation start date and end date. (4) Groundwater encountered: No ☐ Yes ☐ If yes, show depth below ground surface        ft. and attach sample results.

(5) Attach soil sample results and a diagram of sample locations and excavations.

Additional Comments: Plan to excavate and haul contents of drilling pit to the current OCD approved disposal facility. Sample bottoms of excavation and backfill, only after OCD approves. contents to be lined  
Notify OCD before starting + before sampling. Site survey notes after closure will begin soon after approval.

I hereby certify that the information above is true and complete to the best of my knowledge and belief. I further certify that the above-described pit or below-grade tank has been/will be constructed or closed according to NMOCD guidelines ☒ a general permit ☐ or an (attached) alternative OCD-approved plan ☒.

Date: 5/1/06

Printed Name/Title Eddie W Seay Agent Signature Eddie W Seay

Your certification and NMOCD approval of this application/closure does not relieve the operator of liability should the contents of the pit or tank contaminate ground water or otherwise endanger public health or the environment. Nor does it relieve the operator of its responsibility for compliance with any other federal, state, or local laws and/or regulations.

Approval:

Printed Name/Title GARY W. WINK / STAFF MGR Signature Gary W. Wink Date: 5/1/06

**District I**

1625 N. French Dr., Hobbs, NM 88240  
 Phone:(505) 393-6161 Fax:(505) 393-0720

**District II**

1301 W. Grand Ave., Artesia, NM 88210  
 Phone:(505) 748-1283 Fax:(505) 748-9720

**District III**

1000 Rio Brazos Rd., Aztec, NM 87410  
 Phone:(505) 334-6178 Fax:(505) 334-6170

**District IV**

1220 S. St Francis Dr., Santa Fe, NM 87505  
 Phone:(505) 476-3470 Fax:(505) 476-3462

**State of New Mexico**

Form C-102  
 Permit 20825

**Energy, Minerals and Natural Resources****Oil Conservation Division****1220 S. St Francis Dr.****Santa Fe, NM 87505****WELL LOCATION AND ACREAGE DEDICATION PLAT**

|                               |   |   |
|-------------------------------|---|---|
| 1. API Number<br>30-025-37619 | 2. Pool Code<br>22900                       | 3. Pool Name<br>EUNICE,BLI-TU-DR, NORTH |
| 4. Property Code<br>22503     | 5. Property Name<br>NORTHEAST DRINKARD UNIT | 6. Well No.<br>843                      |
| 7. OGRID No.<br>873           | 8. Operator Name<br>APACHE CORP             | 9. Elevation<br>3408                    |

**10. Surface Location**

| UL - Lot | Section | Township | Range | Lot Idn | Feet From | N/S Line | Feet From | E/W Line | County |
|----------|---------|----------|-------|---------|-----------|----------|-----------|----------|--------|
| A        | 23      | 21S      | 37E   | 1       | 1095      | N        | 330       | E        | LEA    |

**11. Bottom Hole Location If Different From Surface**

| UL - Lot                     | Section             | Township               | Range         | Lot Idn | Feet From | N/S Line | Feet From | E/W Line | County |
|------------------------------|---------------------|------------------------|---------------|---------|-----------|----------|-----------|----------|--------|
| 12. Dedicated Acres<br>40.00 | 13. Joint or Infill | 14. Consolidation Code | 15. Order No. |         |           |          |           |          |        |

**NO ALLOWABLE WILL BE ASSIGNED TO THIS COMPLETION UNTIL ALL INTERESTS HAVE BEEN CONSOLIDATED OR A NON-STANDARD UNIT HAS BEEN APPROVED BY THE DIVISION**

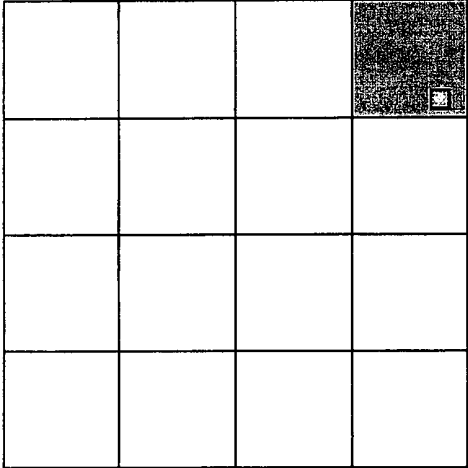
|   |  |  |
|---|--|--|
|  | <b>OPERATOR CERTIFICATION</b>  |  |
|   | <i>I hereby certify that the information contained herein is true and complete to the best of my knowledge and belief.</i><br>E-Signed By: Lana Williams<br>Title: Sr. Department Clerk<br>Date: 1/4/2006  |  |
|   | <b>SURVEYOR CERTIFICATION</b>  |  |
|   | <i>I hereby certify that the well location shown on this plat was plotted from field notes of actual surveys made by me or under my supervision, and that the same is true and correct to the best of my belief.</i><br>Surveyed By: GARY EIDSON<br>Date of Survey: 5/27/2005<br>Certificate Number: 12641 |  |

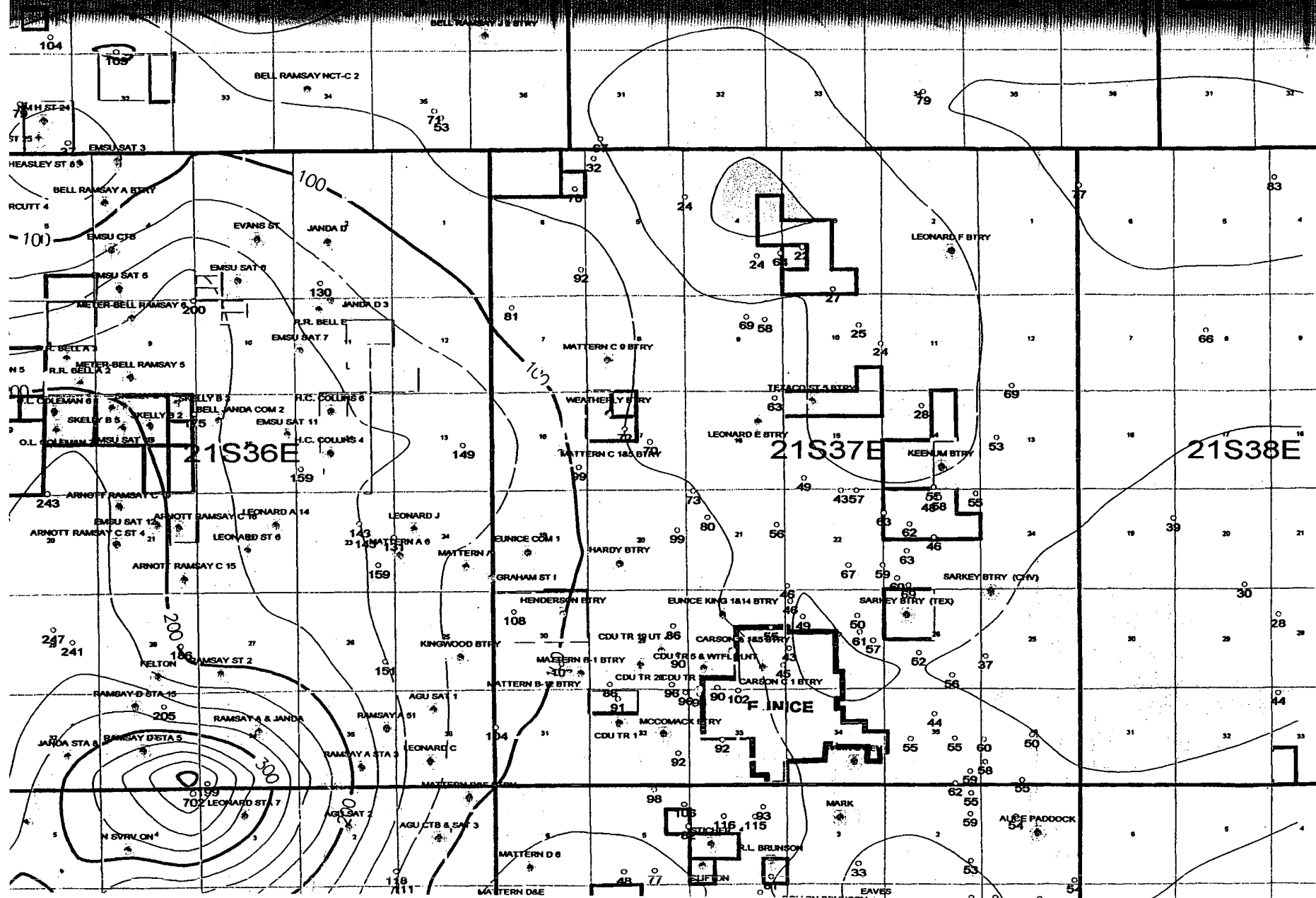

New Mexico Office of the State Engineer  
Well Reports and DownloadsTownship: **21S** Range: **37E** Sections: NAD27 X:  Y:  Zone:  Search Radius: County:  Basin:  Number:  Suffix: Owner Name: (First)  (Last)  ☐ Non-Domestic ☐ Domestic ☒ All**Well / Surface Data Report****Avg Depth to Water Report****Water Column Report****Clear Form****WATERS Menu****Help****AVERAGE DEPTH OF WATER REPORT 10/14/2005**

| Bsn | Tws | Rng | Sec | Zone | X      | Y       | Wells | (Depth Water in Feet) |     |     |
|-----|-----|-----|-----|------|--------|---------|-------|-----------------------|-----|-----|
|     |     |     |     |      |        |         |       | Min                   | Max | Avg |
| CP  | 21S | 37E | 04  |      |        |         | 2     | 75                    | 75  | 75  |
| CP  | 21S | 37E | 06  |      |        |         | 1     | 73                    | 73  | 73  |
| CP  | 21S | 37E | 16  |      |        |         | 1     | 70                    | 70  | 70  |
| CP  | 21S | 37E | 22  |      |        |         | 1     | 53                    | 53  | 53  |
| CP  | 21S | 37E | 23  |      |        |         | 1     | 65                    | 65  | 65  |
| CP  | 21S | 37E | 23  |      | 924000 | 6600000 | 1     | 65                    | 65  | 65  |
| CP  | 21S | 37E | 27  |      |        |         | 1     | 76                    | 76  | 76  |
| CP  | 21S | 37E | 28  |      |        |         | 3     | 65                    | 75  | 71  |
| CP  | 21S | 37E | 33  |      |        |         | 1     | 100                   | 100 | 100 |

Record Count: 12