

UNITED STATES
DEPARTMENT OF THE INTERIOR
BUREAU OF LAND MANAGEMENTNOV 29 2018
OCD Hobbs
RECEIVEDFORM APPROVED
OMB No. 1004-0137
Expires: July 31, 2010

WELL COMPLETION OR RECOMPLETION REPORT AND LOG

5. Lease Serial No.
NMNM1226221a. Type of Well ☒ Oil Well ☐ Gas Well ☐ Dry ☐ Other
b. Type of Completion ☒ New Well ☐ Work Over ☐ Deepen ☐ Plug Back ☐ Diff. Resvr.
Other _____

6. If Indian, Allottee or Tribe Name

7. Unit or CA Agreement Name and No.

2. Name of Operator
EOG RESOURCES INCORPORATED
Contact: KAY MADDOX
E-Mail: KAY_MADDOX@EOGRESOURCES.COM8. Lease Name and Well No.
OPHELIA 22 FED COM 710H3. Address
MIDLAND, TX 797023a. Phone No. (include area code)
Ph: 432-686-36589. API Well No.
30-025-44643-00-S1

4. Location of Well (Report location clearly and in accordance with Federal requirements)*

At surface NWNW 200FNL 1199FWL 32.035668 N Lat, 103.564847 W Lon
Sec 22 T26S R33E Mer NMP
At top prod interval reported below NWNW 391FNL 669FWL 32.035147 N Lat, 103.566557 W Lon
Sec 27 T26S R33E Mer NMP
At total depth SWNW 2525FNL 649FWL 32.014761 N Lat, 103.566622 W Lon10. Field and Pool, or Exploratory
SANDERS TANK-UPR WOLFCAMP11. Sec., T., R., M., or Block and Survey
or Area Sec 22 T26S R33E Mer NMP12. County or Parish
LEA13. State
NM14. Date Spudded
07/21/201815. Date T.D. Reached
08/12/201816. Date Completed
☐ D & A ☒ Ready to Prod.
09/04/201817. Elevations (DF, KB, RT, GL)*
3306 GL18. Total Depth: MD 20494
TVD 1292119. Plug Back T.D.: MD 20453
TVD 1292120. Depth Bridge Plug Set: MD
TVD21. Type Electric & Other Mechanical Logs Run (Submit copy of each)
3306 GL22. Was well cored? ☒ No ☐ Yes (Submit analysis)
Was DST run? ☒ No ☐ Yes (Submit analysis)
Directional Survey? ☐ No ☒ Yes (Submit analysis)

23. Casing and Liner Record (Report all strings set in well)

| Hole Size | Size/Grade | Wt. (#/ft.) | Top (MD) | Bottom (MD) | Stage Cementer Depth | No. of Sk. & Type of Cement | Slurry Vol. (BBL) | Cement Top* | Amount Pulled |
|-----------|--------------|-------------|----------|-------------|----------------------|-----------------------------|-------------------|-------------|---------------|
| 17.500 | 13.375 J55 | 54.5 | | 968 | | 980 | | 0 | |
| 12.250 | 9.625 J55 | 40.0 | | 4908 | | 1650 | | 0 | |
| 8.750 | 7.625 HCP110 | 29.7 | | 12505 | | 995 | | 0 | |
| 6.750 | 5.500 HCP110 | 20.0 | | 20464 | | 760 | | 9950 | |

24. Tubing Record

| Size | Depth Set (MD) | Packer Depth (MD) | Size | Depth Set (MD) | Packer Depth (MD) | Size | Depth Set (MD) | Packer Depth (MD) |
|------|----------------|-------------------|------|----------------|-------------------|------|----------------|-------------------|
| | | | | | | | | |

25. Producing Intervals

26. Perforation Record

| Formation | Top | Bottom | Perforated Interval | Size | No. Holes | Perf. Status |
|-------------|-------|--------|---------------------|-------|-----------|--------------|
| A) WOLFCAMP | 13066 | 20453 | 13066 TO 20453 | 3.000 | 1422 | OPEN |
| B) | | | | | | |
| C) | | | | | | |
| D) | | | | | | |

27. Acid, Fracture, Treatment, Cement Squeeze, Etc.

| Depth Interval | Amount and Type of Material |
|----------------|--|
| 13066 TO 20453 | 17,729,439 LBS PROPPANT, 335,030 BBLs LOAD FLUID |
| | |
| | |

28. Production - Interval A

| Date First Produced | Test Date | Hours Tested | Test Production | Oil BBL | Gas MCF | Water BBL | Oil Gravity Corr. API | Gas Gravity | Production Method |
|---------------------|----------------------|--------------|-----------------|---------|---------|-----------|-----------------------|-------------|-------------------|
| 09/04/2018 | 09/08/2018 | 24 | → | 1740.0 | 3953.0 | 8867.0 | 43.0 | | FLows FROM WELL |
| Choke Size | Tbg. Press. Flwg. SI | Csg. Press. | 24 Hr. Rate | Oil BBL | Gas MCF | Water BBL | Gas:Oil Ratio | Well Status | |
| 64 | SI | 1409.0 | → | 1740 | 3953 | 8867 | 2272 | POW | |

28a. Production - Interval B

| Date First Produced | Test Date | Hours Tested | Test Production | Oil BBL | Gas MCF | Water BBL | Oil Gravity Corr. API | Gas Gravity | Production Method |
|---------------------|----------------------|--------------|-----------------|---------|---------|-----------|-----------------------|-------------|-------------------|
| | | | → | | | | | | |
| Choke Size | Tbg. Press. Flwg. SI | Csg. Press. | 24 Hr. Rate | Oil BBL | Gas MCF | Water BBL | Gas:Oil Ratio | Well Status | |
| | SI | | → | | | | | | |

(See Instructions and spaces for additional data on reverse side)

ELECTRONIC SUBMISSION #437560 VERIFIED BY THE BLM WELL INFORMATION SYSTEM

** BLM REVISED ** BLM REVISED ** BLM REVISED ** BLM REVISED ** BLM REVISED **

Reclamation Due: 3/4/2019

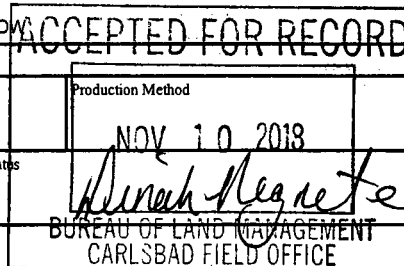

28b. Production - Interval C

| | | | | | | | | | |
|---------------------|----------------------|--------------|----------------------|---------|---------|-----------|-----------------------|-------------|-------------------|
| Date First Produced | Test Date | Hours Tested | Test Production → | Oil BBL | Gas MCF | Water BBL | Oil Gravity Corr. API | Gas Gravity | Production Method |
| Choke Size | Tbg. Press. Flwg. SI | Csg. Press. | 24 Hr. Rate → | Oil BBL | Gas MCF | Water BBL | Gas:Oil Ratio | Well Status | |

28c. Production - Interval D

| | | | | | | | | | |
|---------------------|----------------------|--------------|----------------------|---------|---------|-----------|-----------------------|-------------|-------------------|
| Date First Produced | Test Date | Hours Tested | Test Production → | Oil BBL | Gas MCF | Water BBL | Oil Gravity Corr. API | Gas Gravity | Production Method |
| Choke Size | Tbg. Press. Flwg. SI | Csg. Press. | 24 Hr. Rate → | Oil BBL | Gas MCF | Water BBL | Gas:Oil Ratio | Well Status | |

29. Disposition of Gas(Sold, used for fuel, vented, etc.)

SOLD

30. Summary of Porous Zones (Include Aquifers):

Show all important zones of porosity and contents thereof: Cored intervals and all drill-stem tests, including depth interval tested, cushion used, time tool open, flowing and shut-in pressures and recoveries.

31. Formation (Log) Markers

| Formation | Top | Bottom | Descriptions, Contents, etc. | Name | Top Meas. Depth |
|-----------------|-------|--------|------------------------------|-----------------|--------------------|
| RUSTLER | 911 | | BARREN | RUSTLER | 911 |
| TOP OF SALT | 1191 | | BARREN | TOP OF SALT | 1191 |
| BASE OF SALT | 4741 | | BARREN | BASE OF SALT | 4741 |
| BRUSHY CANYON | 7661 | | OIL & GAS | BRUSHY CANYON | 7661 |
| BONE SPRING 1ST | 10069 | | OIL & GAS | BONE SPRING 1ST | 10069 |
| BONE SPRING 2ND | 10611 | | OIL & GAS | BONE SPRING 2ND | 10611 |
| BONE SPRING 3RD | 11751 | | OIL & GAS | BONE SPRING 3RD | 11751 |
| WOLFCAMP | 12198 | | OIL & GAS | WOLFCAMP | 12198 |

32. Additional remarks (include plugging procedure):

PLEASE REFERENCE ATTACHMENTS

33. Circle enclosed attachments:

- | | | | |
|---|--------------------|---------------|-----------------------|
| 1. Electrical/Mechanical Logs (1 full set req'd.) | 2. Geologic Report | 3. DST Report | 4. Directional Survey |
| 5. Sundry Notice for plugging and cement verification | 6. Core Analysis | 7 Other: | |

34. I hereby certify that the foregoing and attached information is complete and correct as determined from all available records (see attached instructions):

Electronic Submission #437560 Verified by the BLM Well Information System.
For EOG RESOURCES INCORPORATED, sent to the Hobbs
Committed to AFMSS for processing by DUNCAN WHITLOCK on 10/10/2018 (19DW0019SE)

Name (please print) KAY MADDOX

Title REGULATORY SPECIALIST

Signature (Electronic Submission)

Date 09/28/2018

Title 18 U.S.C. Section 1001 and Title 43 U.S.C. Section 1212, make it a crime for any person knowingly and willfully to make to any department or agency of the United States any false, fictitious or fraudulent statements or representations as to any matter within its jurisdiction.

**** REVISED ** REVISED ** REVISED ** REVISED ** REVISED ** REVISED ** REVISED ** REVISED ****

District I
1625 N. French Dr., Hobbs, NM 88240
Phone: (575) 393-6161 Fax: (575) 393-0720
District II
811 S. First St., Artesia, NM 88210
Phone: (575) 748-1283 Fax: (575) 748-9720
District III
1000 Rio Brazos Road, Aztec, NM 87410
Phone: (505) 334-6176 Fax: (505) 334-6170
District IV
1220 S. St. Francis Dr., Santa Fe, NM 87505
Phone: (505) 476-3460 Fax: (505) 476-3462

State of New Mexico
Energy, Minerals & Natural Resources
Department
OIL CONSERVATION DIVISION
1220 South St. Francis Dr.
Santa Fe, NM 87505

FORM C-102
Revised August 1, 2011
Submit one copy to appropriate
District Office

☐ AMENDED REPORT

WELL LOCATION AND ACREAGE DEDICATION PLAT

| | | |
|--|---|---|
| ¹ API Number 30-025- 44643 | ² Pool Code 98097 | ³ Pool Name SANDERS TANK ; Upper Wolfcamp |
| ⁴ Property Code 319569 | ⁵ Property Name OPHELIA 22 FED COM | ⁶ Well Number #710H |
| ⁷ OGRID No. 7377 | ⁸ Operator Name EOG RESOURCES, INC. | ⁹ Elevation 3306' |

¹⁰Surface Location

| UL or lot no. | Section | Township | Range | Lot Idn | Feet from the | North/South line | Feet from the | East/West line | County |
|---------------|---------|----------|-------|---------|---------------|------------------|---------------|----------------|--------|
| D | 22 | 26-S | 33-E | - | 200' | NORTH | 1199' | WEST | LEA |

| UL or lot no. | Section | Township | Range | Lot Idn | Feet from the | North/South line | Feet from the | East/West line | County |
|---------------|---------|----------|-------|---------|---------------|------------------|---------------|----------------|--------|
| E | 27 | 26-S | 33-E | - | 2525' | NORTH | 649' | WEST | LEA |

| | | | |
|---|-------------------------------|----------------------------------|-------------------------|
| ¹¹ Dedicated Acres 240.00 | ¹² Joint or Infill | ¹³ Consolidation Code | ¹⁴ Order No. |
|---|-------------------------------|----------------------------------|-------------------------|

No allowable will be assigned to this completion until all interests have been consolidated or a non-standard unit has been approved by the division.

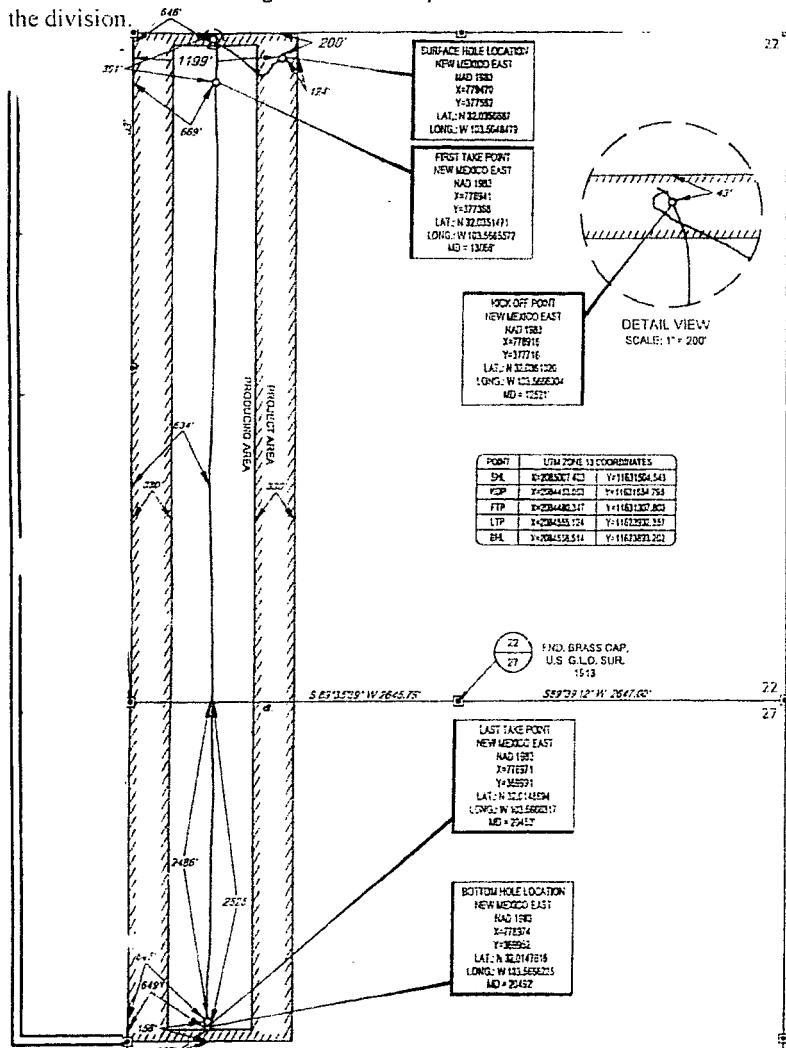

¹⁷OPERATOR CERTIFICATION

I hereby certify that the information contained herein is true and complete to the best of my knowledge and belief, and that this organization either owns a working interest or undivided mineral interest in the land including the proposed bottom hole location or has a right to drill this well of this location pursuant to a contract with an owner of such a mineral or working interest, or to a voluntary pooling agreement or a compulsory pooling order heretofore entered by the division.

Signature *Kay Maddox* Date *9/28/18*

Printed Name *KAY MADDOX*

E-mail Address

¹⁸SURVEYOR CERTIFICATION

I hereby certify that the well location shown on this plat was plotted from field notes of actual surveys made by me or under my supervision, and that the same is true to the best of my belief.

Date of Survey *09/28/2017*
Signature and Seal of Professional Surveyor

MC CHASE BROWN
NEW MEXICO
18329
PROFESSIONAL SURVEYOR

Certificate Number

