

DISTRICT I  
1625 N. French Dr., Hobbs, NM 88240  
Phone: (575) 393-6161 Fax: (575) 393-0720

DISTRICT II  
811 S. First St., Artesia, NM 88210  
Phone: (575) 748-1283 Fax: (575) 748-0720

DISTRICT III  
1000 Rio Brazos Rd., Artec, NM 87410  
Phone: (505) 334-6178 Fax: (505) 334-6170

DISTRICT IV  
1220 S. St. Francis Dr., Santa Fe, NM 87505  
Phone: (505) 476-3460 Fax: (505) 476-3462

State of New Mexico  
Energy, Minerals & Natural Resources Department

OIL CONSERVATION DIVISION

1220 South St. Frances Dr. MAY 01 2019  
Santa Fe, NM 87505

RECEIVED

Form C-102  
Revised August 1, 2011  
Submit one copy to appropriate  
District Office

☐ AMENDED REPORT

WELL LOCATION AND ACREAGE DEDICATION PLAT

API Number <b>30-025-45901</b>	Pool Code <b>98247</b>	Pool Name <b>WC-025 G-08 S203435D; Wolfcamp</b>
Property Code <b>302802</b>	Property Name <b>LEA UNIT</b>	Well Number <b>121H</b>
OGRID No. <b>240974</b>	Operator Name <b>LEGACY RESERVES OPERATING LP</b>	Elevation <b>3678'</b>

Surface Location

UL or lot No.	Section	Township	Range	Lot Idn	Feet from the	North/South line	Feet from the	East/West line	County
L	19	20 S	35 E	3	2,200	SOUTH	685	WEST	LEA

Bottom Hole Location If Different From Surface

UL or lot No.	Section	Township	Range	Lot Idn	Feet from the	North/South line	Feet from the	East/West line	County
D	18	20 S	35 E	1	100	NORTH	1,000	WEST	LEA

Dedicated Acres	Joint or Infill	Consolidation Code	Order No.
<b>239.77</b>			

NO ALLOWABLE WILL BE ASSIGNED TO THIS COMPLETION UNTIL ALL INTERESTS HAVE BEEN CONSOLIDATED OR A NON-STANDARD UNIT HAS BEEN APPROVED BY THE DIVISION

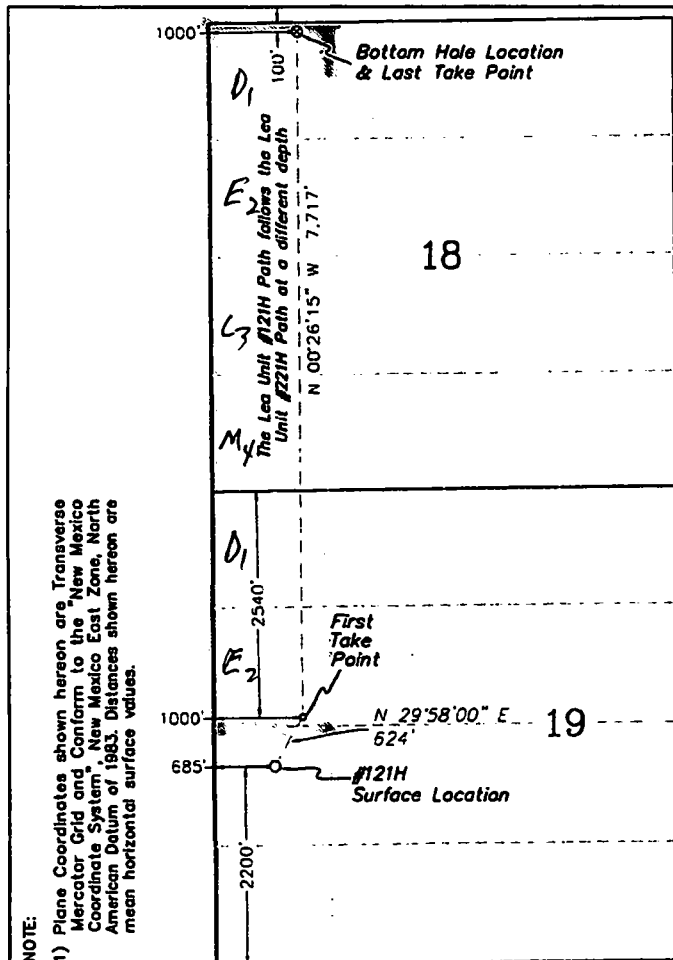

BOTTOM HOLE LOCATION  
& LAST TAKE POINT  
(NAD83)

Plane Coordinate  
X = 797,434.2  
Y = 575,774.1  
Geodetic (D.D.)  
32.58010675° N  
103.50191813° W

FIRST TAKE POINT  
(NAD83)

Plane Coordinate  
X = 797,493.1  
Y = 568,056.9  
Geodetic (D.D.)  
32.55889492° N  
103.50192257° W

SURFACE LOCATION  
(NAD83)

Plane Coordinate  
X = 797,181.4  
Y = 567,516.2  
Geodetic (D.D.)  
32.55741558° N  
103.50294798° W

OPERATOR CERTIFICATION

I hereby certify that the information contained herein is true and complete to the best of my knowledge and belief, and that this organization either owns a working interest or undivided mineral interest in the land including the proposed bottom hole location or has a right to drill this well at this location pursuant to a contract with an owner of such a mineral or working interest, or to a voluntary pooling agreement or a compulsory pooling order heretofore entered by the division.

*Sherry Morrow* 11/21/19  
Signature Date

*Sherry Morrow*  
Printed Name

*Smorrow@legacyreserves.com*  
E-mail Address

SURVEYOR CERTIFICATION

I hereby certify that the well location shown on this plat was plotted from field notes of actual surveys made by me or under my supervision, and that the same is true and correct to the best of my belief.

March 22, 2018

Date of Survey

Signature & Seal of Professional Surveyor

*Lindsay Gygox*  
11-05-18  
LINDSAY GYGAX  
NEW MEXICO  
23263  
PROFESSIONAL SURVEYOR

W.O. Num. 2018-1126

Certificate No. Lindsay Gygox 23263