

District I
1625 N. French Dr., Hobbs, NM 88240
Phone: (575) 393-6161 Fax: (575) 393-0720
District II
811 S. First St., Artesia, NM 88210
Phone: (575) 748-1283 Fax: (575) 748-9720
District III
1000 Rio Brazos Road, Aztec, NM 87410
Phone: (505) 334-6178 Fax: (505) 334-6170
District IV
1220 S. St. Francis Dr., Santa Fe, NM 87505
Phone: (505) 476-3460 Fax: (505) 476-3462

State of New Mexico
Natural Resources Department
OIL CONSERVATION DIVISION
220 South St. Francis Dr.
Santa Fe, NM 87505

Form C-102
Revised August 1, 2011
Submit one copy to appropriate
District Office

RECEIVED

RECEIVED

☐ AMENDED REPORT

WELL LOCATION AND ACREAGE DEDICATION PLAT

1 API Number 30029-48910		2 Pool Code 98065		3 Pool Name UPPER WOLFCAMP	
4 Property Code 39542		5 Property Name RED HILLS WEST UNIT			
6 Well Number 17H		7 OGRID NO. 14744			
8 Operator Name MEWBOURNE OIL COMPANY		9 Elevation 3219'			
10 Surface Location					
UL or lot no. M	Section 10	Township 26S	Range 32E	Lot Idn 150	Feet from the 150
North/South line SOUTH		Feet from the 1250		East/West line WEST	
County LEA					
11 Bottom Hole Location If Different From Surface					
UL or lot no. C	Section 3	Township 26S	Range 32E	Lot Idn 100	Feet from the 100
North/South line NORTH		Feet from the 2310		East/West line WEST	
County LEA					
12 Dedicated Acres 320		13 Joint or Infill		14 Consolidation Code	
15 Order No.					

No allowable will be assigned to this completion until all interest have been consolidated or a non-standard unit has been approved by the division.

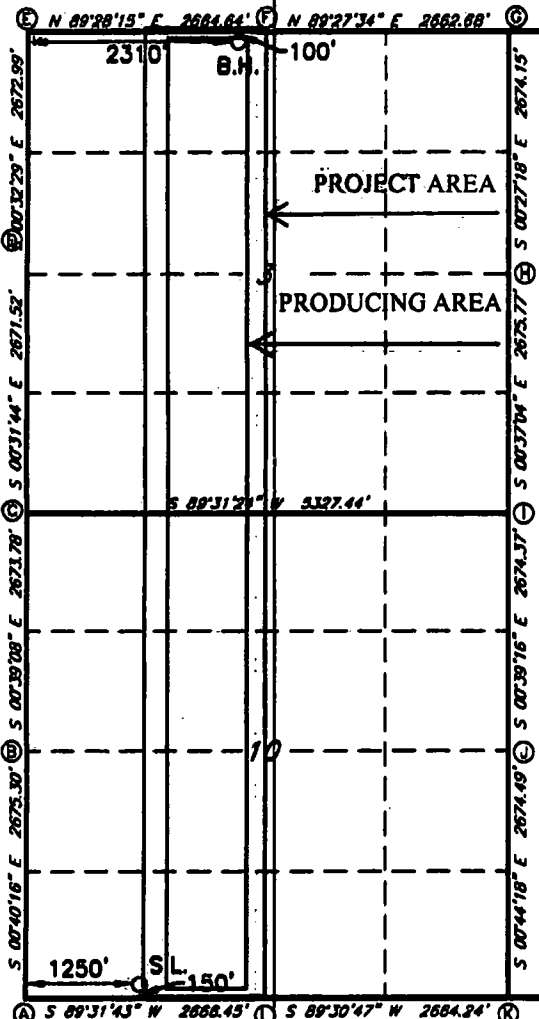

GEODETIC DATA
NAD 83 GRID - NM EAST
SURFACE LOCATION
N: 382818.9 - E: 747885.1
LAT: 32.0506938° N
LONG: 103.6673102° W
BOTTOM HOLE
N: 383268.9 - E: 748635.9
LAT: 32.0784080° N
LONG: 103.6640324° W
CORNER DATA
NAD 83 GRID - NM EAST
A: FOUND BRASS CAP "1939"
N: 382858.8 - E: 748437.1
B: FOUND BRASS CAP "1939"
N: 385331.2 - E: 748405.8
C: FOUND BRASS CAP "1939"
N: 388004.3 - E: 748375.4
D: FOUND BRASS CAP "1939"
N: 390675.2 - E: 748350.7
E: FOUND BRASS CAP "1916"
N: 393347.5 - E: 748325.5
F: FOUND BRASS CAP "1916"
N: 393372.1 - E: 748989.5
G: FOUND BRASS CAP "1916"
N: 393397.2 - E: 751631.5
H: FOUND BRASS CAP "1939"
N: 390723.7 - E: 751672.7
I: FOUND BRASS CAP "1939"
N: 388048.6 - E: 751701.8
J: FOUND BRASS CAP "1939"
N: 385374.9 - E: 751732.1
K: FOUND BRASS CAP "1939"
N: 382701.2 - E: 751766.8
L: FOUND BRASS CAP "1939"
N: 382878.5 - E: 749103.0

17 OPERATOR CERTIFICATION

I hereby certify that the information contained herein is true and complete to the best of my knowledge and belief, and that this organization either owns a working interest or unleased mineral interest in the land including the proposed bottom hole location or has a right to drill this well at this location pursuant to a contract with an owner of such a mineral or working interest, or in a voluntary pooling agreement or a compulsory pooling order heretofore entered by the division.

Signature: *Bradley Bishop* Date: 6-13-19
Printed Name: BRADLEY BISHOP
E-mail Address: BBISHOP@MEWBOURNE.COM

18 SURVEYOR CERTIFICATION

I hereby certify that the well location shown on this plat was plotted from field notes of actual surveys made by me or under my supervision, and that the same is true and correct to the best of my belief.

Date of Survey: 05-22-2019
Signature and Seal of Professional Surveyor: *Robert M. Howett*
Certificate Number: 19680

RRC-Job No: LS19050617