

UNITED STATES
DEPARTMENT OF THE INTERIOR
BUREAU OF LAND MANAGEMENT

APPLICATION FOR PERMIT TO DRILL OR REENTER

FORM APPROVED
OMB No. 1004-0137
Expires March 31, 2007

1a. Type of work: ☒ DRILL ☐ REENTER

1b. Type of Well: ☒ Oil Well ☐ Gas Well ☐ Other ☐ Single Zone ☐ Multiple Zone

2. Name of Operator
Range Operating New Mexico, Inc.

3a. Address 777 Main St., Ste. 800
Fort Worth, TX 76102

3b. Phone No. (include area code)
817-810-1916

4. Location of Well (Report location clearly and in accordance with any State requirements.)
At surface 1650' FSL & 2310' FEL
At proposed prod. zone 1650' FSL & 2310' FEL

5. Field and Pool, or Exploratory
Eunice; San Andres, Southwest

6. Lease Serial No.
LC-032753-B

7. If Indian, Allottee or Tribe Name

8. Lease Name and Well No.
Elliott B Federal #11

9. API Well No.
30-025-37877

10. Field and Pool, or Exploratory
Eunice; San Andres, Southwest

11. Sec., T. R. M. or Blk and Survey or Area
Sec. 6, T22S, R37E, N.M.P.M.

12. County or Parish
Lea

13. State
TX

14. Distance in miles and direction from nearest town or post office*
2 miles SE from Eunice, NM

15. Distance from proposed* location to nearest property or lease line, ft. (Also to nearest drig. unit line, if any)

16. No. of acres in lease
360

17. Spacing Unit dedicated to this well
40

18. Distance from proposed location* to nearest well, drilling, completed, applied for, on this lease, ft.

19. Proposed Depth
4500

20. BLM/BIA Bond No. on file
NM2399

21. Elevations (Show whether DF, KDB, RT, GL, etc.)
3448

22. Approximate date work will start*
04/20/2006

23. Estimated duration
9 days

24. Attachments
Capitan Controlled Water Basin

The following, completed in accordance with the requirements of Onshore Oil and Gas Order No.1, shall be attached to this form:

- Well plat certified by a registered surveyor.
- A Drilling Plan.
- A Surface Use Plan (if the location is on National Forest System Lands, the SUPO shall be filed with the appropriate Forest Service Office).
- Bond to cover the operations unless covered by an existing bond on file (see item 20 above).
- Operator certification
- Such other site specific information and/or plans as may be required by the authorized officer.

25. Signature *Paula Hale* Name (Printed/Typed) Paula Hale Date 03/22/2006

Title Sr. Reg. Sp.

Approved by (Signature) /S/ Russell E. Sorensen Name (Printed/Typed) /S/ Russell E. Sorensen Date MAY 16 2006

ACTING FIELD MANAGER Office CARLSBAD FIELD OFFICE

Application approval does not warrant or certify that the applicant holds legal or equitable title to those rights in the subject lease which would entitle the applicant to conduct operations thereon.

Conditions of approval, if any, are attached.

APPROVAL FOR 1 YEAR

Title 18 U.S.C. Section 1001 and Title 43 U.S.C. Section 1212, make it a crime for any person knowingly and willfully to make to any department or agency of the United States any false, fictitious or fraudulent statements or representations as to any matter within its jurisdiction.

*(Instructions on page 2)

Witness Surface Casing

APPROVAL SUBJECT TO
GENERAL REQUIREMENTS AND
SPECIAL STIPULATIONS
ATTACHED

DISTRICT I

1625 N. FRENCH DR., HOBBS, NM 88240

DISTRICT II

1301 W. GRAND AVENUE, ARTESIA, NM 88210

DISTRICT III

1000 Rio Brazos Rd., Aztec, NM 87410

DISTRICT IV

1220 S. ST. FRANCIS DR., SANTA FE, NM 87505

State of New Mexico

Energy, Minerals and Natural Resources Department

OIL CONSERVATION DIVISION
1220 SOUTH ST. FRANCIS DR.
Santa Fe, New Mexico 87505

Form C-102

Revised October 12, 2005

Submit to Appropriate District Office

State Lease - 4 Copies

Fee Lease - 3 Copies

WELL LOCATION AND ACREAGE DEDICATION PLAT

☐ AMENDED REPORT

API Number 30-025-37877	Pool Code 24180	Pool Name Eunice San Andres Southwest
Property Code 301545	Property Name ELLIOTT B FEDERAL	Well Number 11
OGRID No. 227588	Operator Name RANGE OPERATING NEW MEXICO, INC.	Elevation 3448'

Surface Location

UL or lot No.	Section	Township	Range	Lot Idn	Feet from the	North/South line	Feet from the	East/West line	County
J	6	22-S	37-E		1650	SOUTH	2310	EAST	LEA

Bottom Hole Location If Different From Surface

UL or lot No.	Section	Township	Range	Lot Idn	Feet from the	North/South line	Feet from the	East/West line	County
Dedicated Acres 40	Joint or Infill	Consolidation Code	Order No.						

NO ALLOWABLE WILL BE ASSIGNED TO THIS COMPLETION UNTIL ALL INTERESTS HAVE BEEN CONSOLIDATED
OR A NON-STANDARD UNIT HAS BEEN APPROVED BY THE DIVISION

LOT 4	LOT 3	LOT 2	LOT 1
37.24 AC LOT 5	40.12 AC	40.21 AC	40.30 AC
<p>GEODETIC COORDINATES NAD 27 NME</p> <p>Y=517639.3 N X=849521.4 E</p> <p>LAT.=32°25'04.84" N LONG.=103°12'02.48" W</p> <p>SEE DETAIL</p>			
37.13 AC LOT 6			
37.07 AC LOT 7			
36.99 AC	3450.6'	3446.5'	3447.6'
	600'	600'	
	3448.9'		
		1650'	2310'

OPERATOR CERTIFICATION

I hereby certify that the information herein is true and complete to the best of my knowledge and belief, and that this organization either owns a working interest or unleased mineral interest in the land including the proposed bottom hole location or has a right to drill this well at this location pursuant to a contract with an owner of such mineral or working interest, or to a voluntary pooling agreement or a compulsory pooling order heretofore entered by the division.

Paula Hale 3/24/06
Signature Date

Paula Hale
Printed Name

Sr. Reg. Sp.

SURVEYOR CERTIFICATION

I hereby certify that the well location shown on this plat was plotted from field notes of actual surveys made by me or under my supervision, and that the same is true and correct to the best of my belief.

FEBRUARY 13, 2006

Date Surveyed DSR

Signature & Seal of Professional Surveyor
GARY EIDSON
NEW MEXICO
06.11.0282

Certificate No. GARY EIDSON 12641

United State Department of the Interior

Bureau of Land Management

ROSWELL FIELD OFFICE
2902 West Second Street
Roswell, New Mexico 88201

Statement Accepting Responsibility for Operations

Operator Name: Range Operating New Mexico, Inc.
Street or Box: 777 Main Street, Suite 800
City, State: Fort Worth, TX
Zip Code: 76102

The undersigned accepts all applicable terms, conditions, stipulations and restrictions concerning operations conducted on the leased land or portion thereof, as described below:

Lease No.: LC 032573B
Legal Description of Land: Sec. 6, T22S, R37E
NW/4 SE/4
Formations: Eunice San Andres Southwest
Bond Coverage: (State, Nationwide or Individual) Statewide
BLM Bond File No.: NM2399

Authorized Signature: _____



Title: Petroleum Engineer

Date: 3/24/06

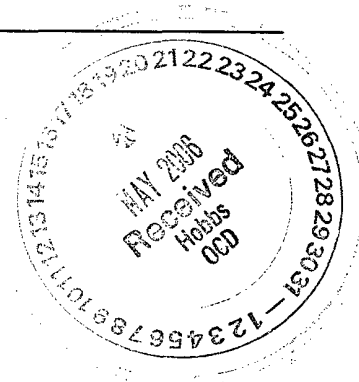

NOTICE TO SURFACE OWNER

Surface Owner

Range Operating New Mexico, Inc.
777 Main St., Ste. 800
Fort Worth, TX 76102

Notice Date

3-24-06

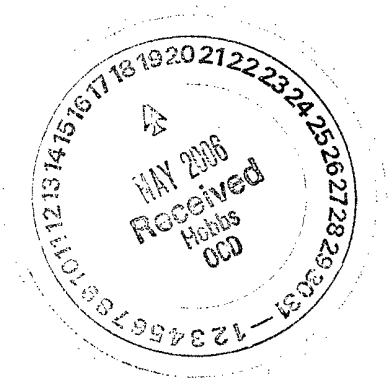

SECTION 6, TOWNSHIP 22 SOUTH, RANGE 37 EAST, N.M.P.M.,
LEA COUNTY, NEW MEXICO

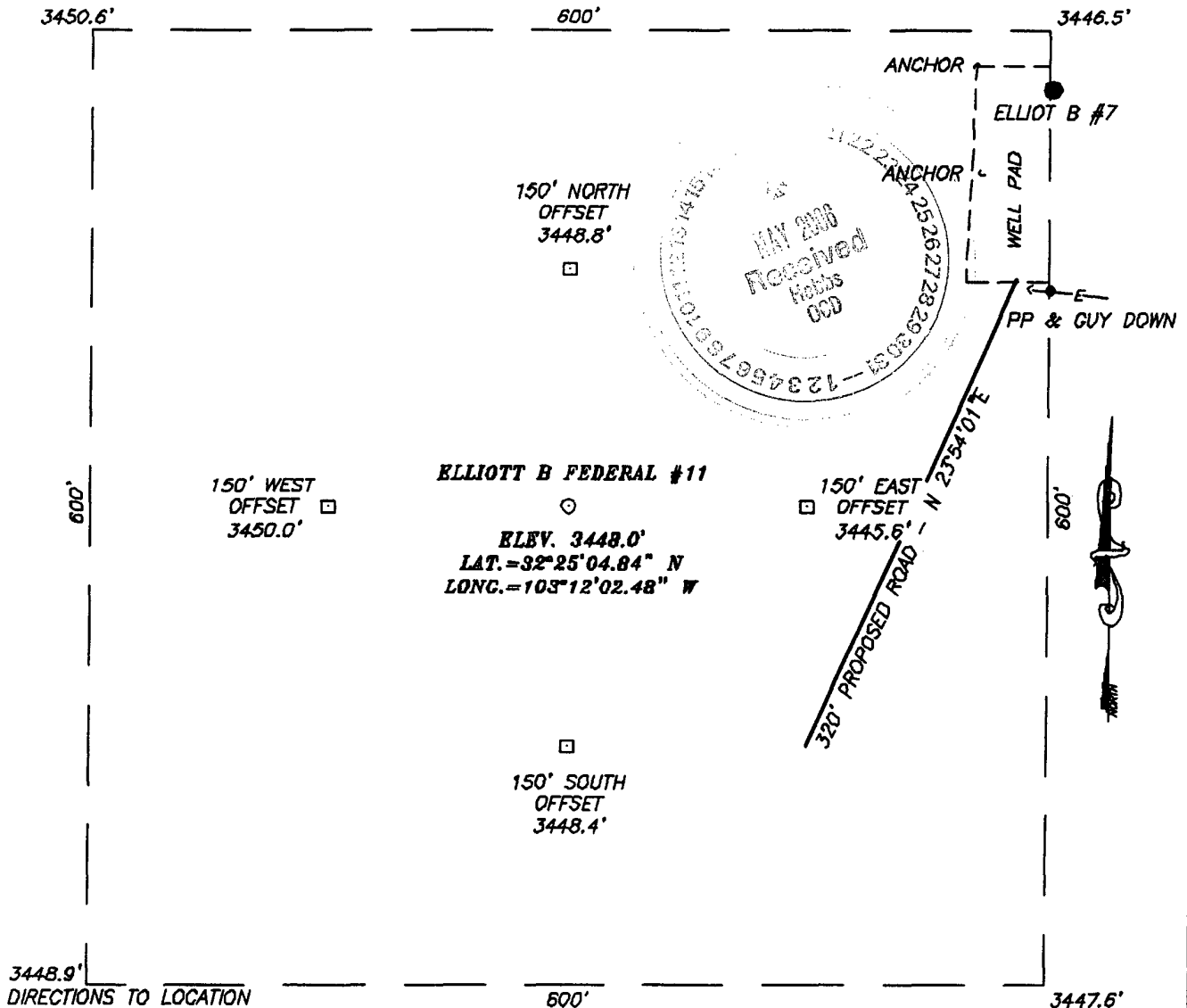

DIRECTIONS TO LOCATION

FROM THE INTERSECTION OF CO. RD. E-33 (LEGION RD.) AND CO. RD. E-21 (DELAWARE BASIN RD.), GO NORTH ON CO. RD. E-33 APPROX. 1.2 MILES. TURN LEFT AND GO WEST APPROX. 0.15 MILES TO A "Y" INTERSECTION. STAY TO THE RIGHT (W) AND GO WEST APPROX. 0.1 MILES TO A BEND TO THE LEFT. CONTINUE WEST-SOUTHWEST APPROX. 0.8 MILES TO A BEND TO THE RIGHT. GO WEST APPROX. 0.25 MILES AND TURN RIGHT. GO NORTH APPROX. 0.5 MILES TO A ROAD INTERSECTION. TURN LEFT AND GO WEST APPROX. 0.15 MILES TO THE SOUTHWEST CORNER OF THE ELLIOTT B FEDERAL #7 WELL PAD. THIS LOCATION IS APPROX. 285 FEET SOUTHWEST.

ORIGINAL
2120

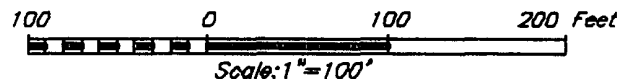

RANGE OPERATING NEW MEXICO, Inc.

ELLIOTT B FEDERAL #11 WELL
LOCATED 1650 FEET FROM THE SOUTH LINE
AND 2310 FEET FROM THE EAST LINE OF SECTION 6,
TOWNSHIP 22 SOUTH, RANGE 37 EAST, N.M.P.M.,
LEA COUNTY, NEW MEXICO.

Survey Date: 02/13/06	Sheet 1 of 1 Sheets
W.O. Number: 06.11.0282	Dr By: D.S.R. Rev 1:N/A
Date: 02/16/06	Disk: CD#1 06110282 Scale: 1"=100'

LOCATION VERIFICATION MAP

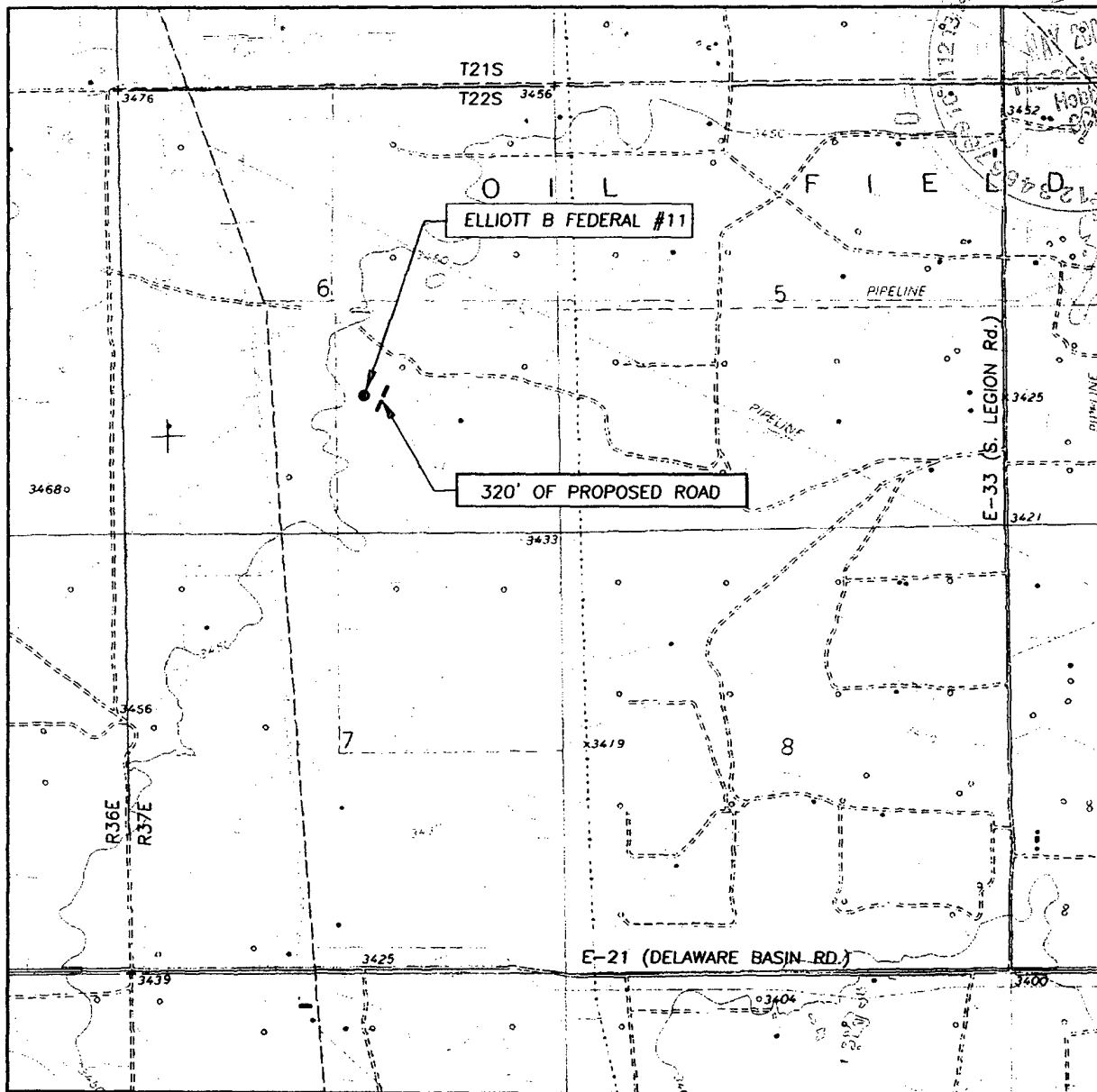

SCALE: 1" = 2000'

CONTOUR INTERVAL:
EUNICE, N.M. - 10'

SEC. 6 TWP. 22-S RGE. 37-E
 SURVEY N.M.P.M.
 COUNTY LEA STATE NEW MEXICO
 DESCRIPTION 1650' FSL & 2310' FEL
 ELEVATION 3448'
 OPERATOR RANGE OPERATING
NEW MEXICO Inc.
 LEASE ELLIOTT B FEDERAL
 U.S.G.S. TOPOGRAPHIC MAP
EUNICE, N.M.

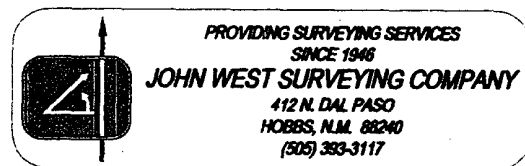
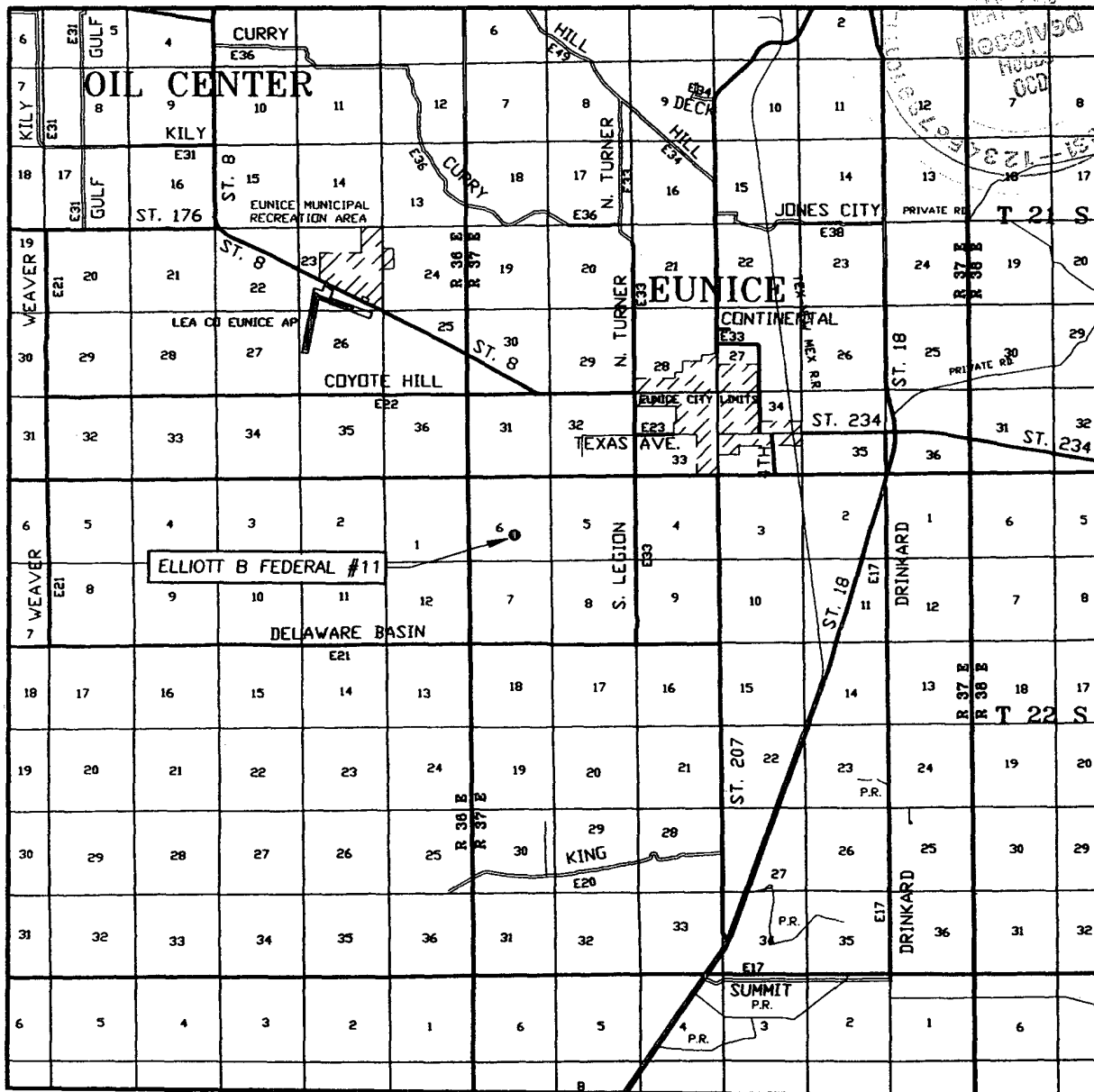

EXHIBIT A

VICINITY MAP



SCALE: 1" = 2 MILES

SEC. 6 TWP. 22-S RGE. 37-E
 SURVEY N.M.P.M.
 COUNTY LEA STATE NEW MEXICO
 DESCRIPTION 1650' FSL & 2310' FEL
 ELEVATION 3448'
 OPERATOR RANGE OPERATING
NEW MEXICO, Inc.
 LEASE ELLIOTT B FEDERAL

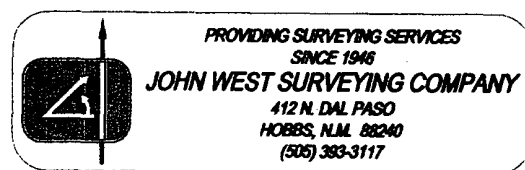

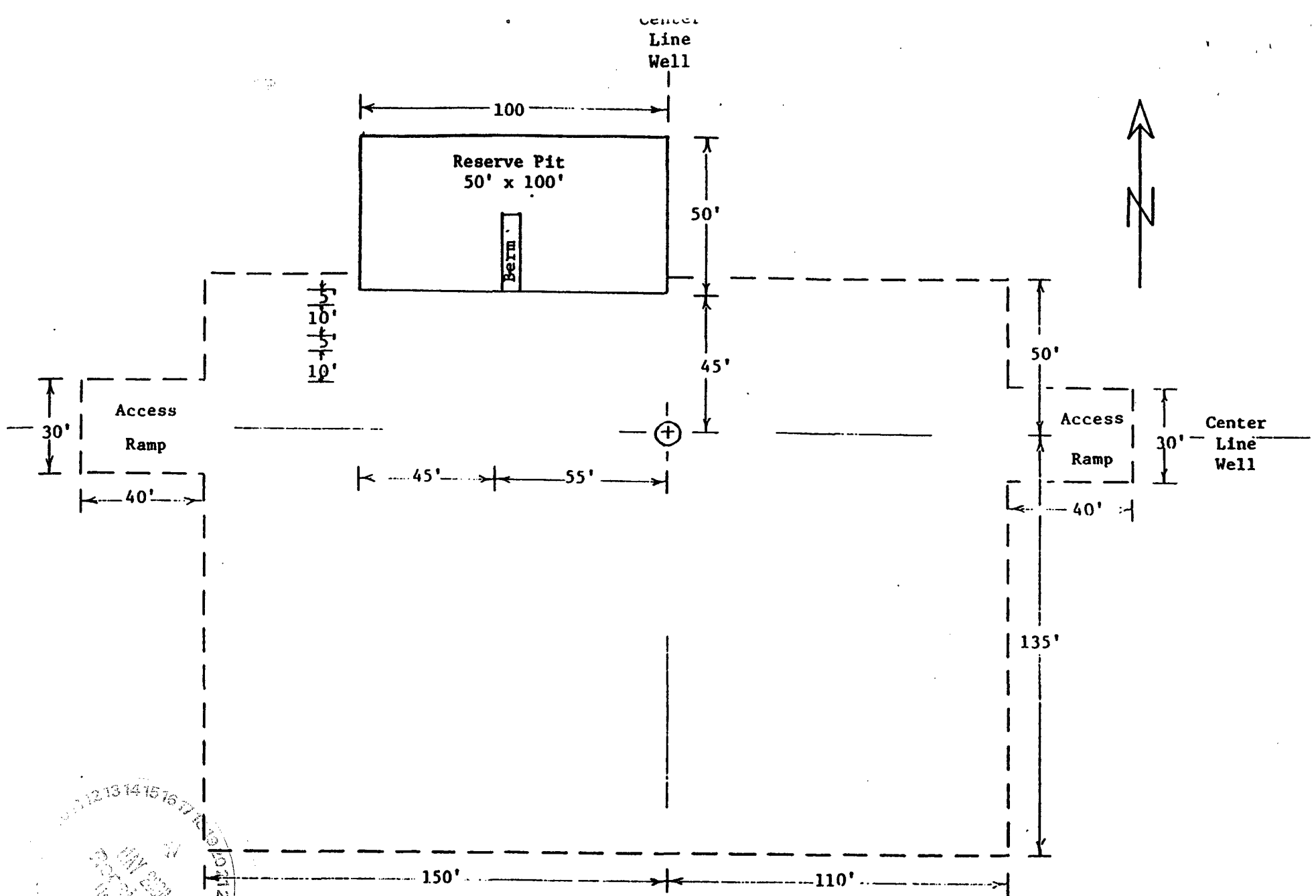

EXHIBIT C

UNITED DRILLING, INC.

LOCATION PLAT

RIG 24

Scale: 1"=40'

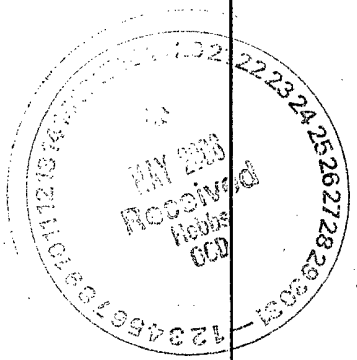

District I
1625 N. French Dr., Hobbs, NM 88240
District II
1301 W. Grand Avenue, Artesia, NM 88210
District III
1000 Rio Brazos Road, Aztec, NM 87410
District IV
1220 S. St. Francis Dr., Santa Fe, NM 87505

State of New Mexico
Energy Minerals and Natural Resources

Form C-144
June 1, 2004

Oil Conservation Division
1220 South St. Francis Dr.
Santa Fe, NM 87505

For drilling and production facilities, submit to appropriate NMOCD District Office.
For downstream facilities, submit to Santa Fe office

Pit or Below-Grade Tank Registration or Closure

Is pit or below-grade tank covered by a "general plan"? Yes ☐ No ☐

Type of action: Registration of a pit or below-grade tank ☐ Closure of a pit or below-grade tank ☐

Operator: Range Operating New Mexico, Inc. Telephone: 817/810-1916 e-mail address: phale@rangeresources.com
Address: 777 Main St., Ste. 800, Ft. Worth, TX 76102
Facility or well name: Elliott B Federal #11 API #: 30-025- 37877 U/L or Qtr/Qtr J Sec 6 T 22S R 37E
County: Lea Latitude 32°25'04.84" N Longitude 103°12'02.48" W NAD: 1927 ☒ 1983 ☐
Surface Owner: Federal ☒ State ☐ Private ☐ Indian ☐

Pit	Below-grade tank
Type: Drilling <input checked="" type="checkbox"/> Production <input type="checkbox"/> Disposal <input type="checkbox"/> Workover <input type="checkbox"/> Emergency <input type="checkbox"/> Lined <input checked="" type="checkbox"/> Unlined <input type="checkbox"/> Liner type: Synthetic <input checked="" type="checkbox"/> Thickness <u>12</u> mil Clay <input type="checkbox"/> Pit Volume <u>6,000</u> bbl	Volume: _____ bbl Type of fluid: _____ Construction material: _____ Double-walled, with leak detection? Yes <input type="checkbox"/> If not, explain why not. _____
Depth to ground water (vertical distance from bottom of pit to seasonal high water elevation of ground water.)	Less than 50 feet (20 points) 50 feet or more, but less than 100 feet (10 points) 100 feet or more (0 points)
Wellhead protection area: (Less than 200 feet from a private domestic water source, or less than 1000 feet from all other water sources.)	Yes (20 points) No (0 points)
Distance to surface water: (horizontal distance to all wetlands, playas, irrigation canals, ditches, and perennial and ephemeral watercourses.)	Less than 200 feet (20 points) 200 feet or more, but less than 1000 feet (10 points) 1000 feet or more (0 points)
Ranking Score (Total Points)	

If this is a pit closure: (1) Attach a diagram of the facility showing the pit's relationship to other equipment and tanks. (2) Indicate disposal location: (check the onsite box if you are burying in place) onsite ☐ offsite ☐ If offsite, name of facility _____. (3) Attach a general description of remedial action taken including remediation start date and end date. (4) Groundwater encountered: No ☐ Yes ☐ If yes, show depth below ground surface _____ ft. and attach sample results. (5) Attach soil sample results and a diagram of sample locations and excavations.

Additional Comments: Pit will also have a felt liner under the synthetic liner.

I hereby certify that the information above is true and complete to the best of my knowledge and belief. I further certify that the above-described pit or below-grade tank has been/will be constructed or closed according to NMOCD guidelines ☐, a general permit ☒, or an (attached) alternative OCD-approved plan ☐.

Date: 3-24-06

Printed Name/Title Paula Hale

Signature 

Your certification and NMOCD approval of this application/closure does not relieve the operator of liability should the contents of the pit or tank contaminate ground water or otherwise endanger public health or the environment. Nor does it relieve the operator of its responsibility for compliance with any other federal, state, or local laws and/or regulations.

Approval:

Printed Name/Title

PAUL F. KAUFZ
PETROLEUM ENGINEER

Signature 

Date:

MAY 22 2006

 The sender of this message has requested a read receipt. [Click here to send a receipt.](#)

Mull, Donna, EMNRD

From: Phillips, Dorothy, EMNRD
To: Mull, Donna, EMNRD
Cc:
Subject: RE: Financial Assurance Requirement
Attachments:

Sent: Mon 5/22/2006 9:24 AM

All but Apache are okay.

From: Mull, Donna, EMNRD
Sent: Monday, May 22, 2006 8:27 AM
To: Phillips, Dorothy, EMNRD
Cc: Macquesten, Gail, EMNRD; Sanchez, Daniel J., EMNRD
Subject: Financial Assurance Requirement

Dorothy,

Is the Financial Assurance Requirement for these Operators OK?

Cimarex Energy Co of Colorado (162683)
ConocoPhillips Co (217817)
Fasken Oil & Ranch LTD (151416)
Range Operating New Mexico Inc (227588)
Apache Corp (873)
Nadel and Gussman Permian LLC (155615)

I have checked each operator for Inactive wells.

Please let me know. Thanks and have a nice day. Donna