

District I

1625 N. French Dr., Hobbs, NM 88240

District II

1301 W. Grand Avenue, Artesia, NM 88210

District III

1000 Rio Brazos Road, Aztec, NM 87410

District IV

1220 S. St. Francis Dr., Santa Fe, NM 87505

State of New Mexico
Energy Minerals and Natural ResourcesOil Conservation Division
1220 South St. Francis Dr.
Santa Fe, NM 87505Form C-144
June 1, 2004For drilling and production facilities, submit to
appropriate NMOCD District Office.
For downstream facilities, submit to Santa Fe
office**Pit or Below-Grade Tank Registration or Closure**Is pit or below-grade tank covered by a "general plan"? Yes ☒ No ☐Type of action: Registration of a pit or below-grade tank ☒ Closure of a pit or below-grade tank ☐

Operator: Chevron Telephone: 505-394-1237 e-mail address: lcwl@chevron.com
 Address: Box 1949 2401 Ave. O Eunice New Mexico 88231
 Facility or well name: HT Mattern C #18 API #: 30-025-37109 U/L or Qtr/Qtr E Sec 18 T 21 S R 37 E
 County: Lea Latitude 32 - 28'50.32" N Longitude 103 - 12' 27.68 W ☐ 1983 ☐
 Surface Owner: Federal ☐ State ☐ Private ☒ Indian ☐

Pit Type: Drilling <input checked="" type="checkbox"/> Production <input type="checkbox"/> Disposal <input type="checkbox"/> Workover <input type="checkbox"/> Emergency <input type="checkbox"/> Lined <input checked="" type="checkbox"/> Unlined <input type="checkbox"/> Liner type: Synthetic <input checked="" type="checkbox"/> Thickness <u>20</u> mil Clay <input type="checkbox"/> Pit Volume <u>3,000</u> bbl	Below-grade tank Volume: <u> </u> bbl Type of fluid: <u> </u> Construction material: <u> </u> Double-walled, with leak detection? Yes <input type="checkbox"/> If not, explain why not. <u> </u>
Depth to ground water (vertical distance from bottom of pit to seasonal high water elevation of ground water.)	Less than 50 feet (20 points) 50 feet or more, but less than 100 feet (10 points) 100 feet or more (0 points)
Wellhead protection area: (Less than 200 feet from a private domestic water source, or less than 1000 feet from all other water sources.)	Yes (20 points) No (0 points)
Distance to surface water: (horizontal distance to all wetlands, playas, irrigation canals, ditches, and perennial and ephemeral watercourses.)	Less than 200 feet (20 points) 200 feet or more, but less than 1000 feet (10 points) 1000 feet or more (0 points)
Ranking Score (Total Points) 10 points	

If this is a pit closure: (1) Attach a diagram of the facility showing the pit's relationship to other equipment and tanks. (2) Indicate disposal location: (check the onsite box if you are burying in place) onsite ☒ offsite ☐ If offsite, name of facility . (3) Attach a general description of remedial action taken including remediation start date and end date. (4) Groundwater encountered: No ☒ Yes ☐ If yes, show depth below ground surface ft. and attach sample results. (5) Attach soil sample results and a diagram of sample locations and excavations.

Additional Comments: Will close Pit according to the OCD Pit Closure Rules IV -B-3-A-V Final closure. & Chevron Pit Rules Approved by O C D.

I hereby certify that the information above is true and complete to the best of my knowledge and belief. I further certify that the above-described pit or below-grade tank has been/will be constructed or closed according to NMOCD guidelines ☐, a general permit ☐, or an (attached) alternative OCD-approved plan ☐.

Date: 5-18-06Printed Name/Title Larry Williams Chevron HES ChampionSignature 

Your certification and NMOCD approval of this application/closure does not relieve the operator of liability should the contents of the pit or tank contaminate ground water or otherwise endanger public health or the environment. Nor does it relieve the operator of its responsibility for compliance with any other federal, state, or local laws and/or regulations.

Approval:

Printed Name/Title GARY W. WINK / STAFF MGRSignature Date: 5/19/06

SECTION 18, TOWNSH. 21 SOUTH, RANGE 3. EAST, N.M.P.M.,
LEA COUNTY, NEW MEXICO

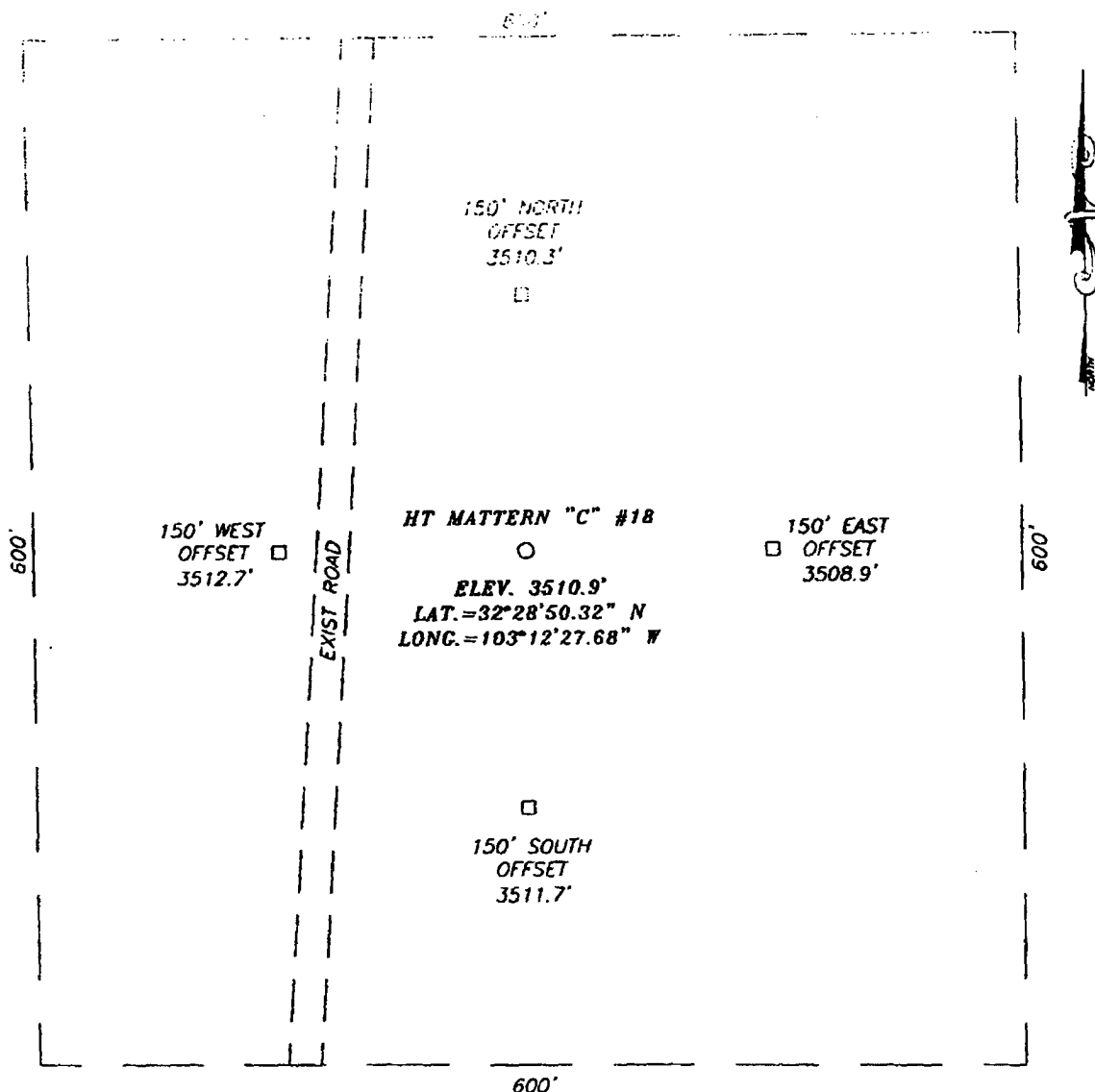

DIRECTIONS TO LOCATION

FROM THE INTERSECTION OF ST. HWY. #8 AND CO. RD. #33 (N. TURNER RD.) GO NORTH ON CO. RD. #33 FOR APPROX. 2.0 MILES. TURN LEFT (WEST) ON CO. RD. #36 (CURRY RD.) AND GO APPROX. 1.7 MILES. TURN RIGHT (NORTH) AND GO APPROX. 0.4 MILES. PROPOSED LOCATION IS APPROX. 120' EAST.

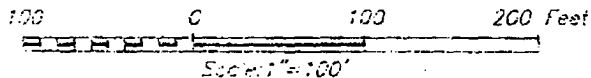

CHEVRON U.S.A., INC.

HT MATTERN "C" #18 WELL
 LOCATED 1389 FEET FROM THE NORTH LINE
 AND 710 FEET FROM THE WEST LINE OF SECTION 18,
 TOWNSHIP 21 SOUTH, RANGE 37 EAST, N.M.P.M.,
 LEA COUNTY, NEW MEXICO.

Survey Date: 1/12/05	Sheet 1 of 1 Sheets
W.O. Number: 04.11.1714	Dr By: J.R.
Date: 1/13/05	Scale: 1"=100'

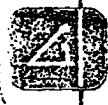

PROVIDING SURVEYING SERVICES
 SINCE 1948
JOHN WEST SURVEYING COMPANY
 412 N. DAL PASO
 HOBBS, N.M. 88240
 (505) 350-3117