

## District I

1625 N. French Dr., Hobbs, NM 88240

## District II

1301 W. Grand Avenue, Artesia, NM 88210

## District III

1000 Rio Brazos Road, Aztec, NM 87410

## District IV

1220 S. St. Francis Dr., Santa Fe, NM 87505

State of New Mexico  
Energy Minerals and Natural ResourcesOil Conservation Division  
1220 South St. Francis Dr.  
Santa Fe, NM 87505Form C-144  
June 1, 2004For drilling and production facilities, submit to  
appropriate NMOCD District Office.  
For downstream facilities, submit to Santa Fe  
office

## Pit or Below-Grade Tank Registration or Closure

Is pit or below-grade tank covered by a "general plan"? Yes ☒ No ☐Type of action: Registration of a pit or below-grade tank ☐ Closure of a pit or below-grade tank ☒

Operator: Stanolind Operating Corp. Telephone: 432/688-4256 e-mail address: bwatson@stanolind.com  
 Address: P.O. Box 1311, Midland, Texas 79702  
 Facility or well name: Berry Hobbs Unit 17 API #: 30-025-36657 U/L or Qtr/Qtr J Sec 17 T 17 R 16S  
 County: Lea Latitude Longitude NAD: 1927 ☐ 1983 ☐  
 Surface Owner: Federal ☐ State ☒ Private ☐ Indian ☐

## Pit

Type: Drilling ☐ Production ☐ Disposal ☐Workover ☒ Emergency ☐Lined ☒ Unlined ☐Liner type: Synthetic ☐ Thickness 1.5 mil Clay ☐

Pit Volume bbl

## Below-grade tank

Volume: bbl Type of fluid:

Construction material:

Double-walled, with leak detection? Yes ☐ If not, explain why not.Depth to ground water (vertical distance from bottom of pit to seasonal  
high water elevation of ground water.)

Less than 50 feet

50 feet or more, but less than 100 feet X 65'

100 feet or more

(20 points)

(10 points) X

(0 points)

Wellhead protection area: (Less than 200 feet from a private domestic  
water source, or less than 1000 feet from all other water sources.)

Yes

No X

(20 points)

(0 points) X

Distance to surface water: (horizontal distance to all wetlands, playas,  
irrigation canals, ditches, and perennial and ephemeral watercourses.)

Less than 200 feet

200 feet or more, but less than 1000 feet

1000 feet or more X

(20 points)

(10 points)

(0 points) X

Ranking Score (Total Points)

If this is a pit closure: (1) Attach a diagram of the facility showing the pit's relationship to other equipment and tanks. (2) Indicate disposal location: (check the onsite box if  
you are burying in place) onsite ☒ offsite ☐ If offsite, name of facility (3) Attach a general description of remedial action taken including  
remediation start date and end date. (4) Groundwater encountered: No X Yes ☐ If yes, show depth below ground surface ft. and attach sample results.  
(5) Attach soil sample results and a diagram of sample locations and excavations.

## Additional Comments:

~~Pit has been~~ will be closed according to OCD Rule 4.B.3.b beginning 5/18/06 and completed by 5/20-06. Pit has been de-watered.

I hereby certify that the information above is true and complete to the best of my knowledge and belief. I further certify that the above-described pit or below-grade tank  
has been/will be constructed or closed according to NMOCD guidelines X ☐, a general permit ☐, or an (attached) alternative OCD-approved plan ☐.

Date: 5/17/06

Printed Name/Title Barbara Watson

Signature

*Barbara Watson*

Your certification and NMOCD approval of this application/closure does not relieve the operator of liability should the contents of the pit or tank contaminate ground water or  
otherwise endanger public health or the environment. Nor does it relieve the operator of its responsibility for compliance with any other federal, state, or local laws and/or  
regulations.

Approval:

Printed Name/Title

GARY W. WINK / STAFF MGR

Signature

*Gary W. Wink*

Date:

5/17/06



## TYPICAL TANK BATTERY SCHEMATIC

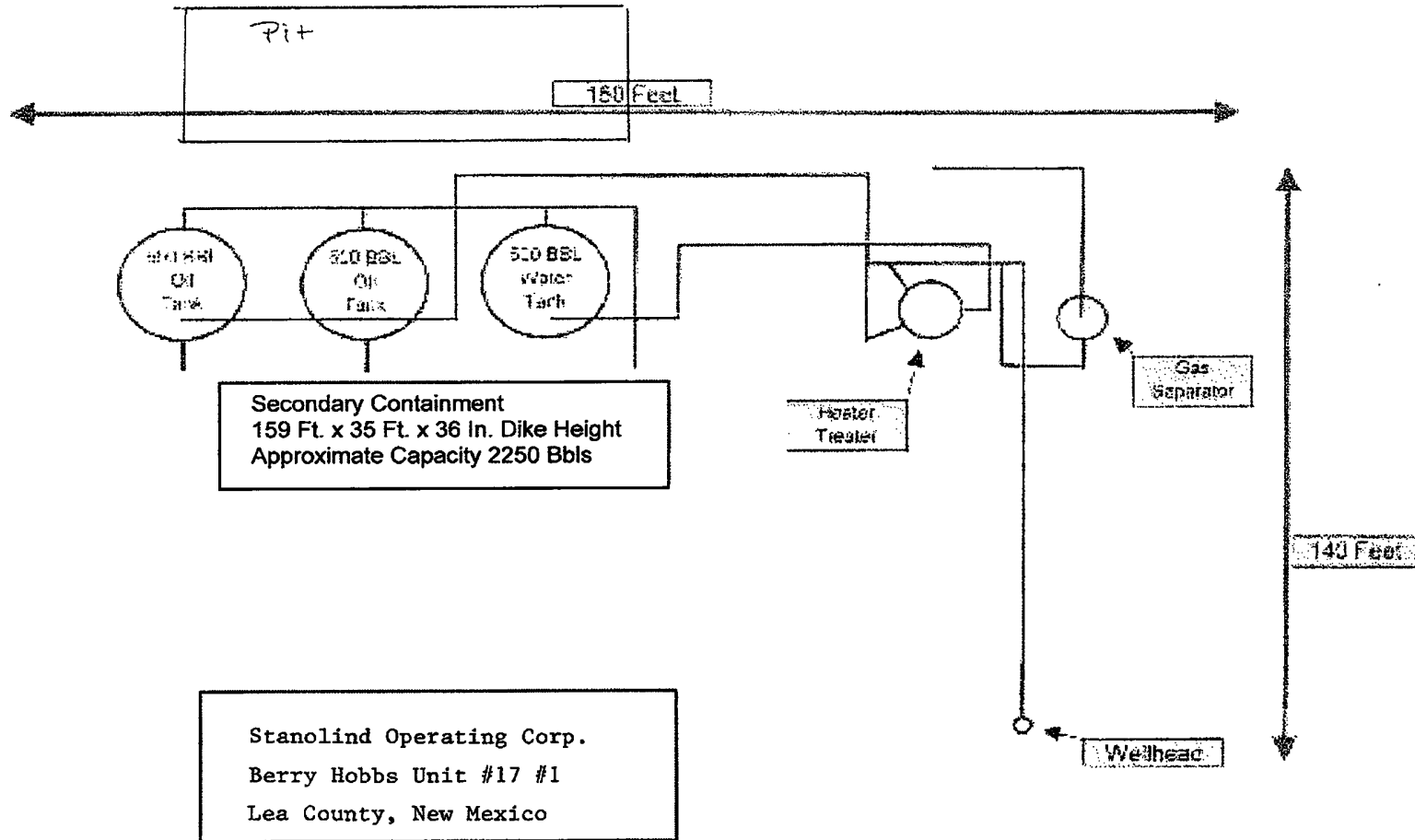

# LOCATION VERIFICATION MAP

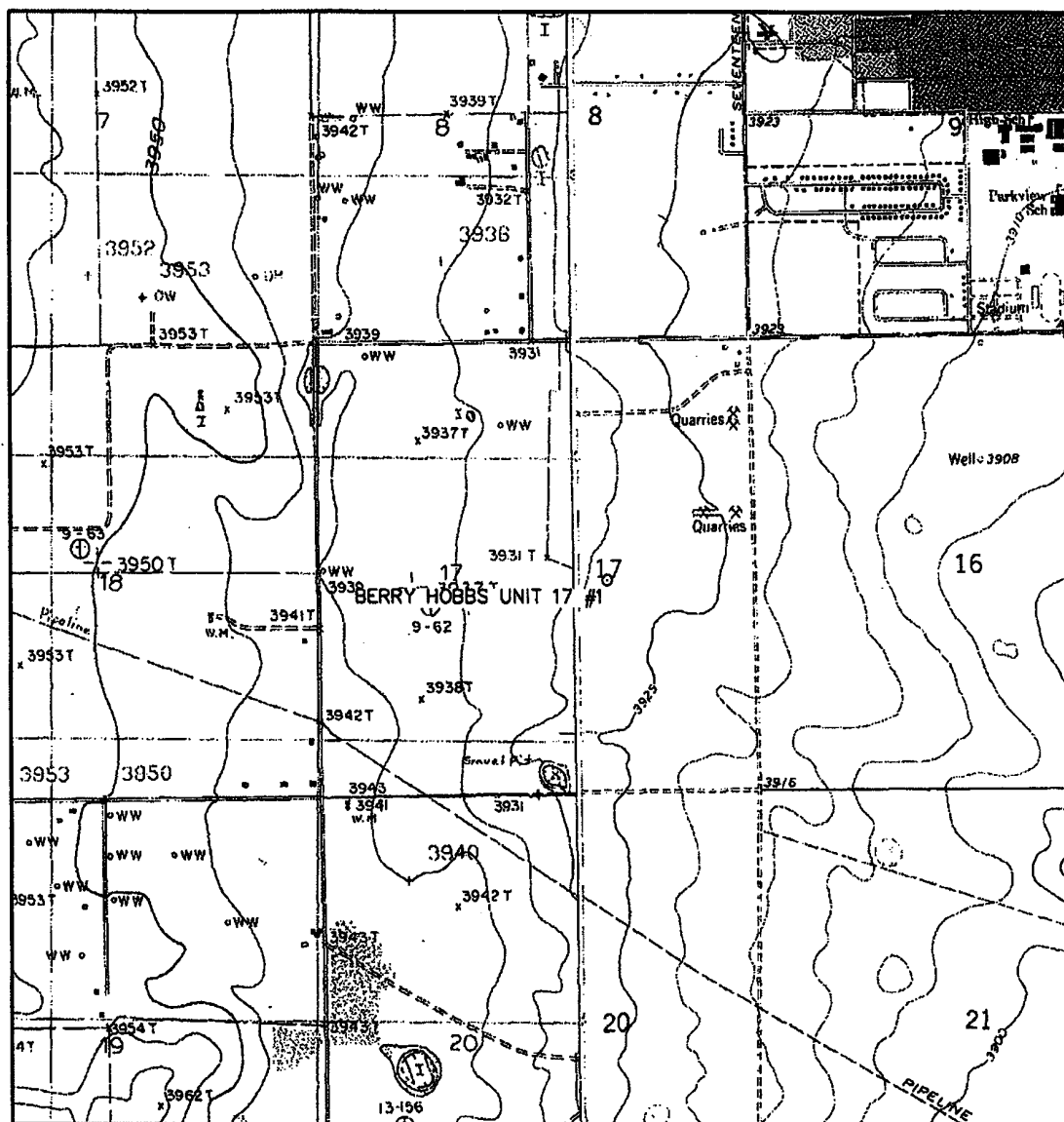

SCALE: 1" = 2000'

CONTOUR INTERVAL: 5'  
LOVINGTONSEC. 17 TWP. 16-S RGE. 36-ESURVEY N.M.P.M.COUNTY LEA, NEW MEXICODESCRIPTION 2490' FSL & 1850' FELELEVATION 3929'OPERATOR PERMIAN RESOURCES, INC.LEASE BERRY HOBBS UNIT 17U.S.G.S. TOPOGRAPHIC MAP  
LOVINGTON
**WEST  
COMPANY**  
of Midland, Inc.

 110 W. LOUISIANA, STE. 110  
MIDLAND TEXAS, 79701  
(915) 687-0865 - (915) 687-0868 FAX

## VICINITY MAP

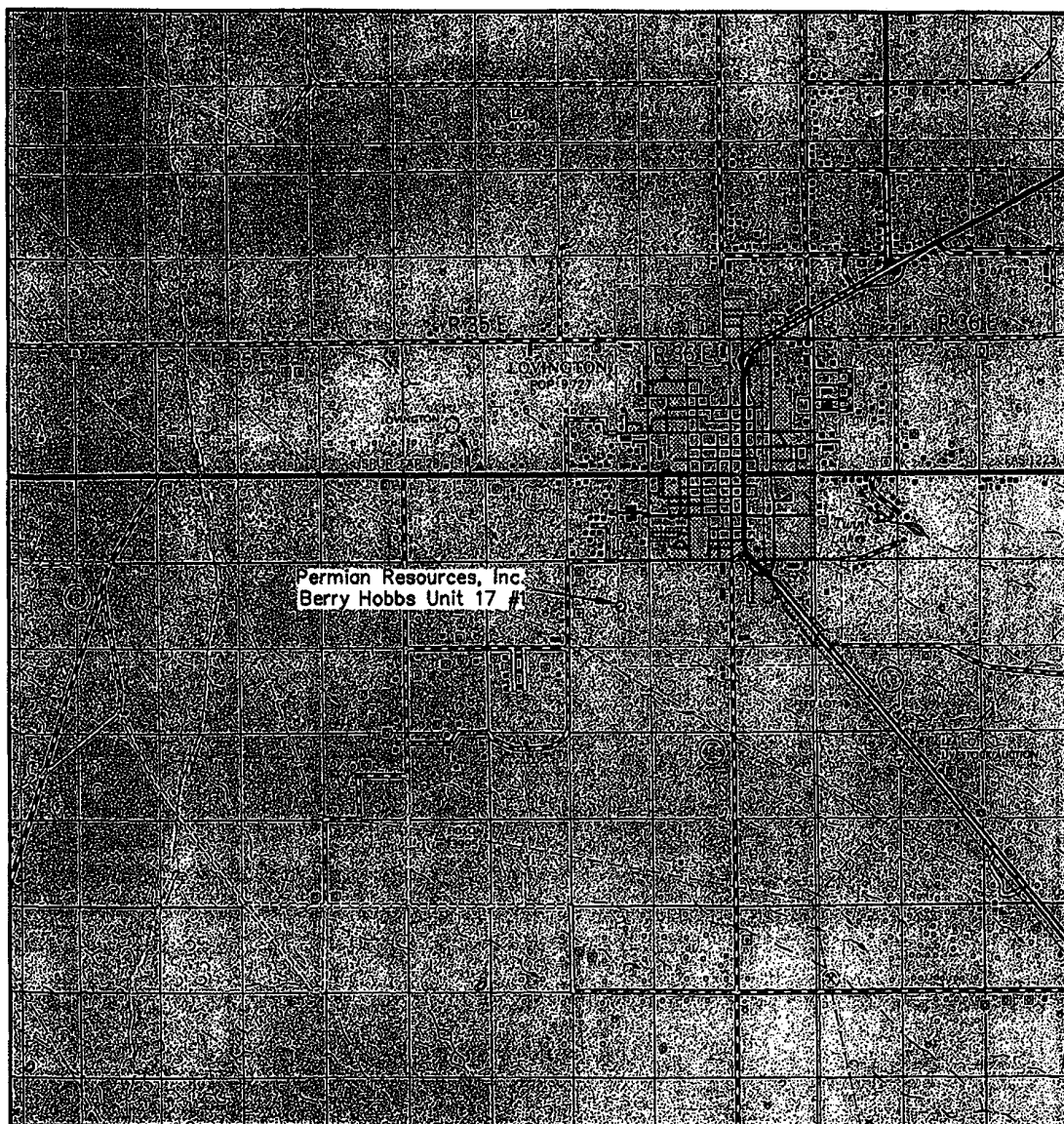

SCALE: 1" = 2 MILES

SEC. 17 TWP. 16-S RGE. 36-ESURVEY N.M.P.M.COUNTY LEA, NEW MEXICODESCRIPTION 2490' FSL & 1850' FELELEVATION 3929'OPERATOR PERMIAN RESOURCES, INC.LEASE BERRY HOBBS UNIT 17**WEST  
COMPANY**  
of Midland, Inc.110 W. LOUISIANA, STE. 110  
MIDLAND TEXAS, 79701  
(915) 687-0865 - (915) 687-0868 FAX