

District I  
1625 N. French Dr., Hobbs, NM 88240  
District II  
1301 W. Grand Avenue, Artesia, NM 88210  
District III  
1000 Rio Brazos Road, Aztec, NM 87410  
District IV  
1220 S. St. Francis Dr., Santa Fe, NM 87505

State of New Mexico  
Energy Minerals and Natural  
Resources

Oil Conservation Division  
1220 South St. Francis Dr.  
Santa Fe, NM 87505

Form C-144  
June 1, 2004

For drilling and production facilities, submit  
to appropriate NMOCD District Office.  
For downstream facilities, submit to Santa Fe  
office

**Pit or Below-Grade Tank Registration or Closure**

Is pit or below-grade tank covered by a "general plan"? Yes ☒ No ☐

Type of action: Registration of a pit or below-grade tank ☐ Closure of a pit or below-grade tank ☒

Operator: Yates Petroleum Corporation Telephone: 505-748-4500 e-mail address: mikes@ypcnm.com

Address: 105 South 4<sup>th</sup> Street, Artesia, N.M. 88210

Facility or well name: Eidson Ranch AOB State #2 API #: 30-025-31272 U/L or Qtr/Qtr Q Sec 5 T 16S R 33E

County: Lea Latitude 32.94904 Longitude 103.67842 NAD: 1927 ☒ 1983 ☐

Surface Owner: Federal ☐ State ☒ Private ☐ Indian ☐

**Pit**

Type: Drilling ☐ Production ☐ Disposal ☐

Work over ☐ Emergency ☒

Lined ☒ Unlined ☐

Liner type: Synthetic ☒ Thickness 12 mil Clay ☐

Pit Volume \_\_\_\_\_ bbl

**Below-grade tank**

Volume: \_\_\_\_\_ bbl Type of fluid: \_\_\_\_\_

Construction material: \_\_\_\_\_

Double-walled, with leak detection? Yes ☐ If not, explain why not.

Depth to ground water (vertical distance from bottom of pit to seasonal high water elevation of ground water.)

Less than 50 feet

(20 points)

50 feet or more, but less than 100 feet

(10 points)

100 feet or more

( 0 points) XXXX

Wellhead protection area: (Less than 200 feet from a private domestic water source, or less than 1000 feet from all other water sources.)

Yes

(20 points)

No

( 0 points) XXXX

Distance to surface water: (horizontal distance to all wetlands, playas, irrigation canals, ditches, and perennial and ephemeral watercourses.)

Less than 200 feet

(20 points)

200 feet or more, but less than 1000 feet

(10 points)

1000 feet or more

( 0 points) XXXX

**Ranking Score (Total Points)**

**0 Points**

**If this is a pit closure:** (1) Attach a diagram of the facility showing the pit's relationship to other equipment and tanks. (2) Indicate disposal location: (check the onsite box if you are burying in place) on-site ☒ off-site ☐ If off-site, name of facility: \_\_\_\_\_. (3) Attach a general description of remedial action taken including remediation start date and end date. (4) Groundwater encountered: No ☐ Yes ☐ If yes, show depth below ground surface \_\_\_\_\_ ft. and attach sample results. (5) Attach soil sample results and a diagram of sample locations and excavations.

Additional Comments: Work plan for the Closure of an Emergency Pit. A 20 mil liner will be placed 3' below grade with a minimum of 3' over-lap of the underlaying pit.

Backfill encapsulated wastes with a minimum of 3' of clean soil or like material capable of supporting native plant growth.

A one-call and 48 hour notice will be provided to OCD prior to pit closure actions.

I hereby certify that the information above is true and complete to the best of my knowledge and belief. I further certify that the above-described pit or below-grade tank has been/will be constructed or closed according to NMOCD guidelines ☐, a general permit ☒, or an (attached) alternative OCD-approved plan ☐.

Date: 05/26/02006

Printed Name/Title Mike Stubblefield / Regulatory Agent

Signature Mike Stubblefield

Your certification and NMOCD approval of this application/closure does not relieve the operator of liability should the contents of the pit or tank contaminate ground water or otherwise endanger public health or the environment. Nor does it relieve the operator of its responsibility for compliance with any other federal, state, or local laws and/or regulations.

Approval:

Printed Name/Title GARY W. WINK / STAFF MGR

Signature Gary W. Wink

Date: 6/5/06

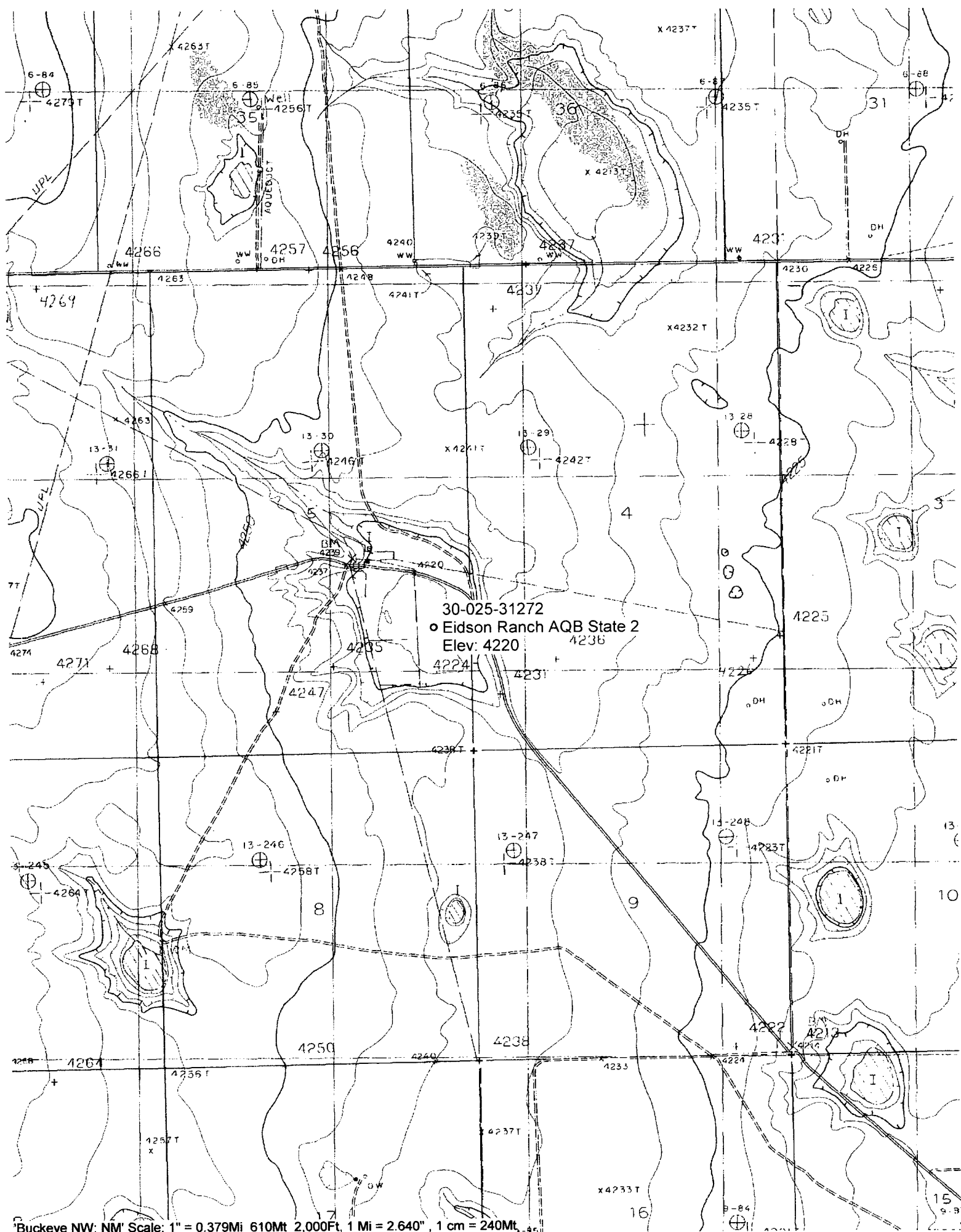

'Buckeye NW; NM' Scale: 1" = 0.379Mi 610Mt 2,000Ft, 1 Mi = 2.640", 1 cm = 240Mt

## New Mexico Office of the State Engineer

## POD Reports and Downloads

EIDSON RANCH AQB  
STATE #2

Township: 16S Range: 33E Sections:

NAD27 X: Y: Zone: Search Radius:

County: Basin: Number: Suffix:

Owner Name: (First) (Last) ☐ Non-Domestic ☐ Domestic  
☒ All

POD / Surface Data Report

Avg Depth to Water Report

Water Column Report

Clear Form

iWATERS Menu

Help

## AVERAGE DEPTH OF WATER REPORT 05/25/2006

Bsn	Tws	Rng	Sec	Zone	X	Y	Wells	(Depth Water in Feet)		
								Min	Max	Avg
L	16S	33E	01				2	160	160	160
L	16S	33E	02				2	125	170	148
L	16S	33E	03				2	130	130	130
L	16S	33E	04				2	150	150	150
L	16S	33E	05				1	180	180	180
L	16S	33E	08				1	200	200	200
L	16S	33E	10				3	166	190	182
L	16S	33E	12				3	135	145	142
L	16S	33E	13				3	70	130	110
L	16S	33E	14				3	130	150	143
L	16S	33E	16				1	180	180	180
L	16S	33E	17				1	182	182	182
L	16S	33E	18				1	190	190	190
L	16S	33E	23				1	80	80	80
L	16S	33E	25				6	115	124	120
L	16S	33E	26				5	135	154	143
L	16S	33E	27				1	130	130	130
L	16S	33E	30				2	191	191	191
L	16S	33E	31				1	190	190	190
L	16S	33E	32				2	168	168	168
L	16S	33E	34				2	160	160	160

Record Count: 45