

District I
1625 N. French Dr., Hobbs, NM 88240
District II
1301 W. Grand Avenue, Artesia, NM 88210
District III
1000 Rio Brazos Road, Aztec, NM 87410
District IV
1220 S. St. Francis Dr., Santa Fe, NM 87505

State of New Mexico
Energy Minerals and Natural Resources

Form C-101
May 27, 2004

Oil Conservation Division
1220 South St. Francis Dr.
Santa Fe, NM 87505

Submit to appropriate District Office

☐ AMENDED REPORT

APPLICATION FOR PERMIT TO DRILL, RE-ENTER, DEEPEN, PLUGBACK, OR ADD A ZONE

| | | |
|---|--|--|
| ¹ Operator Name and Address Plantation Operating, LLC 2203 Timberloch Place, Suite 229, The Woodlands, Texas 77380 | | ² OGRID Number 237788 |
| | | ³ APL Number 30-025-3-1458 |
| ³ Property Code 302135 | ⁵ Property Name Turner State | ⁶ Well No. 4 |
| ⁹ Proposed Pool 1 Eumont Gas (Yates-7Rivers-Queen) | | ¹⁰ Proposed Pool 2 |

7 Surface Location

| UL or lot no. | Section | Township | Range | Lot Idn | Feet from the | North/South line | Feet from the | East/West line | County |
|---------------|---------|----------|-------|---------|---------------|------------------|---------------|----------------|--------|
| B | 32 | 20S | 37E | | 660' | North | 1980' | East | Lea |

8 Proposed Bottom Hole Location If Different From Surface

| UL or lot no. | Section | Township | Range | Lot Idn | Feet from the | North/South line | Feet from the | East/West line | County |
|---------------|---------|----------|-------|---------|---------------|------------------|---------------|----------------|--------|
| | | | | | | | | | |

Additional Well Information

| | | | | |
|--|---------------------------------------|--|--|---|
| ¹¹ Work Type Code N | ¹² Well Type Code G | ¹³ Cable/Rotary R | ¹⁴ Lease Type Code S | ¹⁵ Ground Level Elevation 3525' |
| ¹⁶ Multiple No | ¹⁷ Proposed Depth 3800' | ¹⁸ Formation Yates - 7 Rivers-Queen | ¹⁹ Contractor To Be Determined | ²⁰ Spud Date ASAP |
| Depth to Groundwater N/A | | Distance from nearest fresh water well > 1,000' | | Distance from nearest surface water > 1,000' |
| Pit: Liner: Synthetic <input type="checkbox"/> _____mils thick Clay <input type="checkbox"/> Pit Volume: _____bbls Drilling Method: Drilling | | | | |
| Closed-Loop System <input checked="" type="checkbox"/> Fresh Water <input type="checkbox"/> Brine <input checked="" type="checkbox"/> Diesel/Oil-based <input type="checkbox"/> Gas/Air <input type="checkbox"/> | | | | |

21 Proposed Casing and Cement Program

| Hole Size | Casing Size | Casing weight/foot | Setting Depth | Sacks of Cement | Estimated TOC |
|--------------------|-------------|--------------------|---------------|-----------------|---------------|
| 9 1/2" 8 3/4" PERM | 7" | 20# | 450' | 350 | Surface |
| 6 1/8" | 4 1/2" | 11.6# | 3800' | 600 | Surface |
| | | | | | |
| | | | | | |
| | | | | | |

22 Describe the proposed program. If this application is to DEEPEN or PLUG BACK, give the data on the present productive zone and proposed new productive zone. Describe the blowout prevention program, if any. Use additional sheets if necessary.

Before drilling out from surface pipe, the well will be equipped with a 3000-psi 10-inch Series-900 double-ram hydraulic BOP and Hydril and surface pipe and BOP system will be tested to a minimum pressure of 1500 psig. Cement volumes may be adjusted to insure that the cement behind both the 7" and 4-1/2" casing strings will be circulated in sufficient volumes to the surface.

Permit Expires 1 Year From Approval
Date Unless Drilling Underway

23 I hereby certify that the information given above is true and complete to the best of my knowledge and belief. I further certify that the drilling pit will be constructed according to NMOCD guidelines ☒ a general permit ☐, or an (attached) alternative OCD-approved plan ☐.

Printed name: Donald P. Dotson, P.E.

Title: COO

E-mail Address: ddotson@plantationpetro.com

Date: 4/27/2006

Phone: 281-296-7222

OIL CONSERVATION DIVISION

Approved by:

Title:

Approval Date:

JUN 23 2006

Expiration Date:

Conditions of Approval Attached ☐

PETROLEUM ENGINEER

State of New Mexico

Energy, Minerals and Natural Resources Department

DISTRICT I

1626 N. FRENCH DR., HOBBES, NM 88240

DISTRICT II

1301 W. GRAND AVENUE, ARTERIA, NM 86210

DISTRICT III

1000 Rio Brazos Rd., Aztec, NM 87410

DISTRICT IV

1220 S. ST. FRANCIS DR., SANTA FE, NM 87505

OIL CONSERVATION DIVISION

1220 SOUTH ST. FRANCIS DR.
Santa Fe, New Mexico 87505

Form C-102

Revised October 12, 2005

Submit to Appropriate District Office

State Lease - 4 Copies

Fee Lease - 3 Copies

WELL LOCATION AND ACREAGE DEDICATION PLAT

☐ AMENDED REPORT

| | | |
|-----------------------------------|---|---|
| API Number 30-025-37858 | Pool Code 76480 | Pool Name Eumont (Y-7R-Q) Gas |
| Property Code 302135 | Property Name TURNER STATE | Well Number 4 |
| GRID No. 237788 | Operator Name PLANTATION OPERATING, LLC | Elevation 3525' |

Surface Location

| UL or lot No. | Section | Township | Range | Lot Idn | Feet from the | North/South line | Feet from the | East/West line | County |
|---------------|---------|----------|-------|---------|---------------|------------------|---------------|----------------|--------|
| B | 32 | 20-S | 37-E | | 660 | NORTH | 1980 | EAST | LEA |

Bottom Hole Location If Different From Surface

| UL or lot No. | Section | Township | Range | Lot Idn | Feet from the | North/South line | Feet from the | East/West line | County |
|---------------|---------|----------|-------|---------|---------------|------------------|---------------|----------------|--------|
| | | | | | | | | | |

| Dedicated Acres | Joint or Infill | Consolidation Code | Order No. |
|-----------------|-----------------|--------------------|---|
| 160 | Y | | Administrative Order No. SD-89-1 (6/5/89) |

NO ALLOWABLE WILL BE ASSIGNED TO THIS COMPLETION UNTIL ALL INTERESTS HAVE BEEN CONSOLIDATED
OR A NON-STANDARD UNIT HAS BEEN APPROVED BY THE DIVISION

| | |
|--|--|
| | <h3>OPERATOR CERTIFICATION</h3> <p>I hereby certify that the information herein is true and complete to the best of my knowledge and belief, and that this organization either owns a working interest or unleased mineral interest in the land including the proposed bottom hole location or has a right to drill this well at this location pursuant to a contract with an owner of such mineral or working interest, or to a voluntary pooling agreement or a compulsory pooling order heretofore entered by the Division.</p> <p><i>John Allred</i> 6/22/06 Signature Date John Allred Printed Name</p> <h3>SURVEYOR CERTIFICATION</h3> <p>I hereby certify that the well location shown on this plat was plotted from field notes of actual surveys made by me or under my supervision, and that the same is true and correct to the best of my belief.</p> <p>MARCH 09, 2006</p> <p>Date Surveyed MR Signature & Seal Professional Surveyor GARY E. EIDSON NEW MEXICO 8/17/06 06.11.0467 Certificate No. GARY E. EIDSON 12841 PROFESSIONAL SURVEYOR</p> |
|--|--|

SECTION 32, TOWNSHIP 20 SOUTH, RANGE 37 EAST, N.M.P.M.,
LEA COUNTY, NEW MEXICO

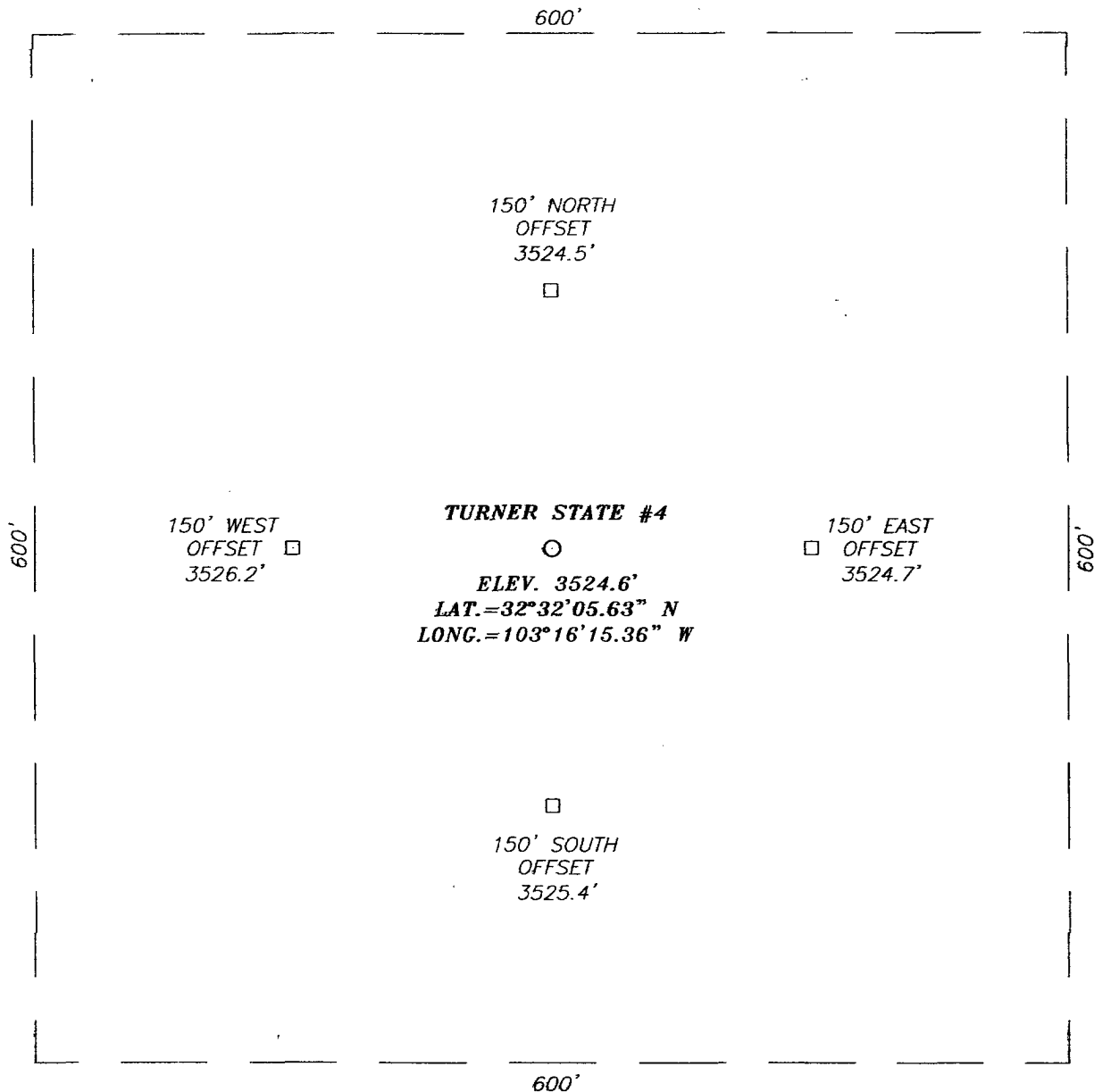

DIRECTIONS TO LOCATION

FROM THE INTERSECTION OF CO. RD. H-41
(MADDOX RD.) AND ST. HWY. 8, GO WEST ON
MADDOX RD. APPROX. 0.88 MILES. THIS LOCATION
IS APPROX. 660 FEET SOUTH.

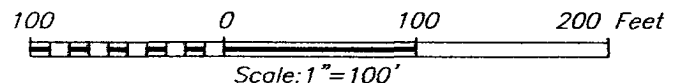

PLANTATION OPERATING, LLC

TURNER STATE #4
LOCATED 660 FEET FROM THE NORTH LINE
AND 1980 FEET FROM THE EAST LINE OF SECTION 32,
TOWNSHIP 20 SOUTH, RANGE 37 EAST, N.M.P.M.,
LEA COUNTY, NEW MEXICO.

| | |
|-------------------------|------------------------------------|
| Survey Date: 03/09/06 | Sheet 1 of 1 Sheets |
| W.O. Number: 06.11.0467 | Dr By: M.R. Rev 1:N/A |
| Date: 03/14/06 | Disk: CD#1 06110467 Scale: 1"=100' |

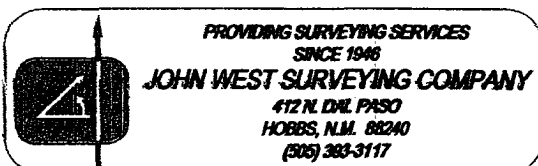

VICINITY MAP

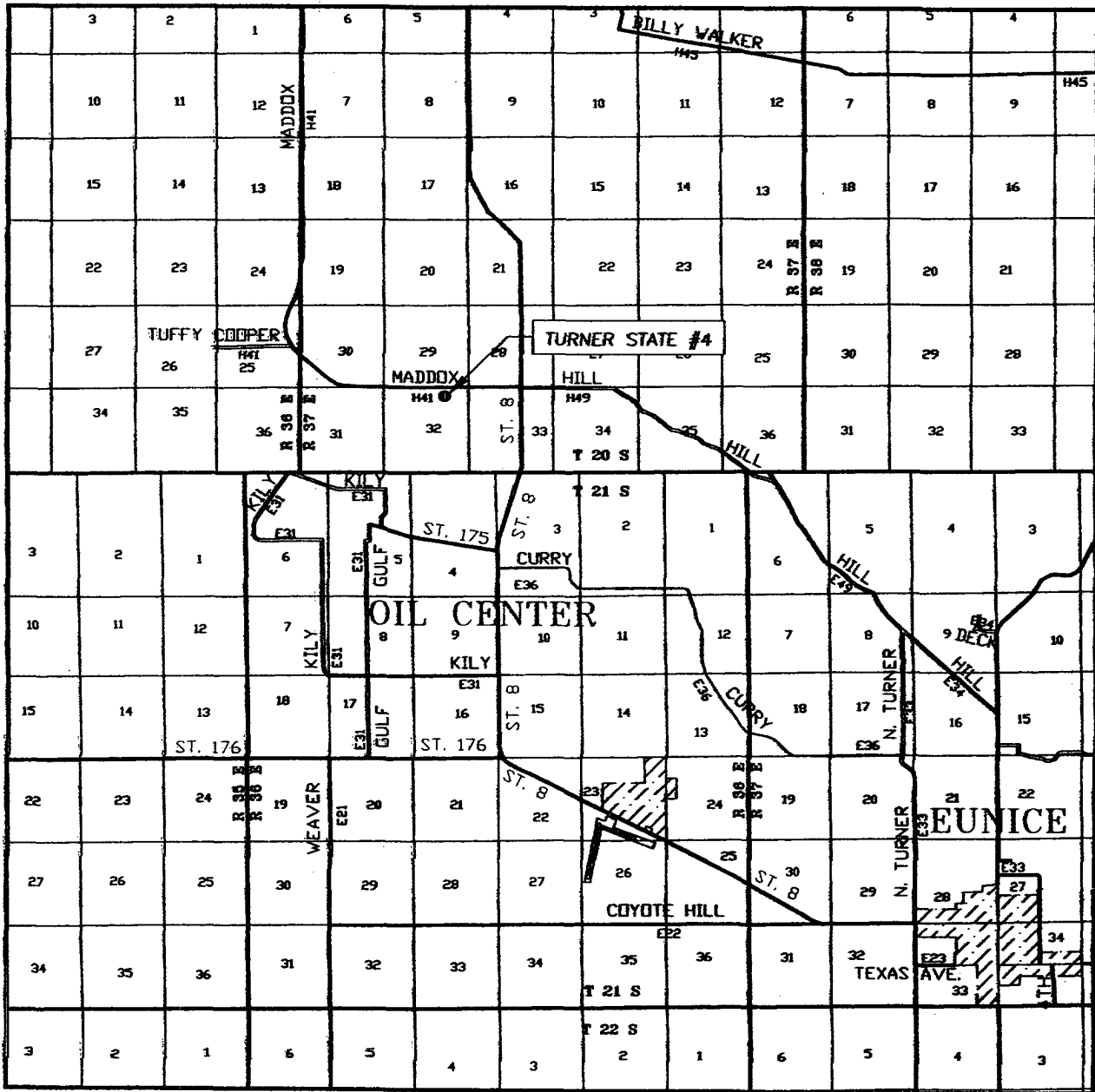

SCALE: 1" = 2 MILES

SEC. 32 TWP. 20-S RGE. 37-E

SURVEY N.M.P.M.

COUNTY LEA STATE NEW MEXICO

DESCRIPTION 660' FNL & 1980' FEL

ELEVATION 3525'

OPERATOR PLANTATION OPERATING, LLC

LEASE TURNER STATE

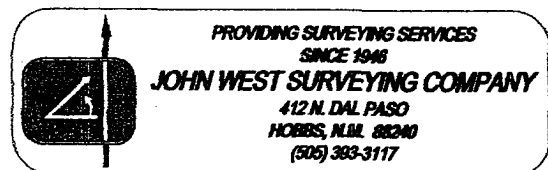

LOCATION VERIFICATION MAP

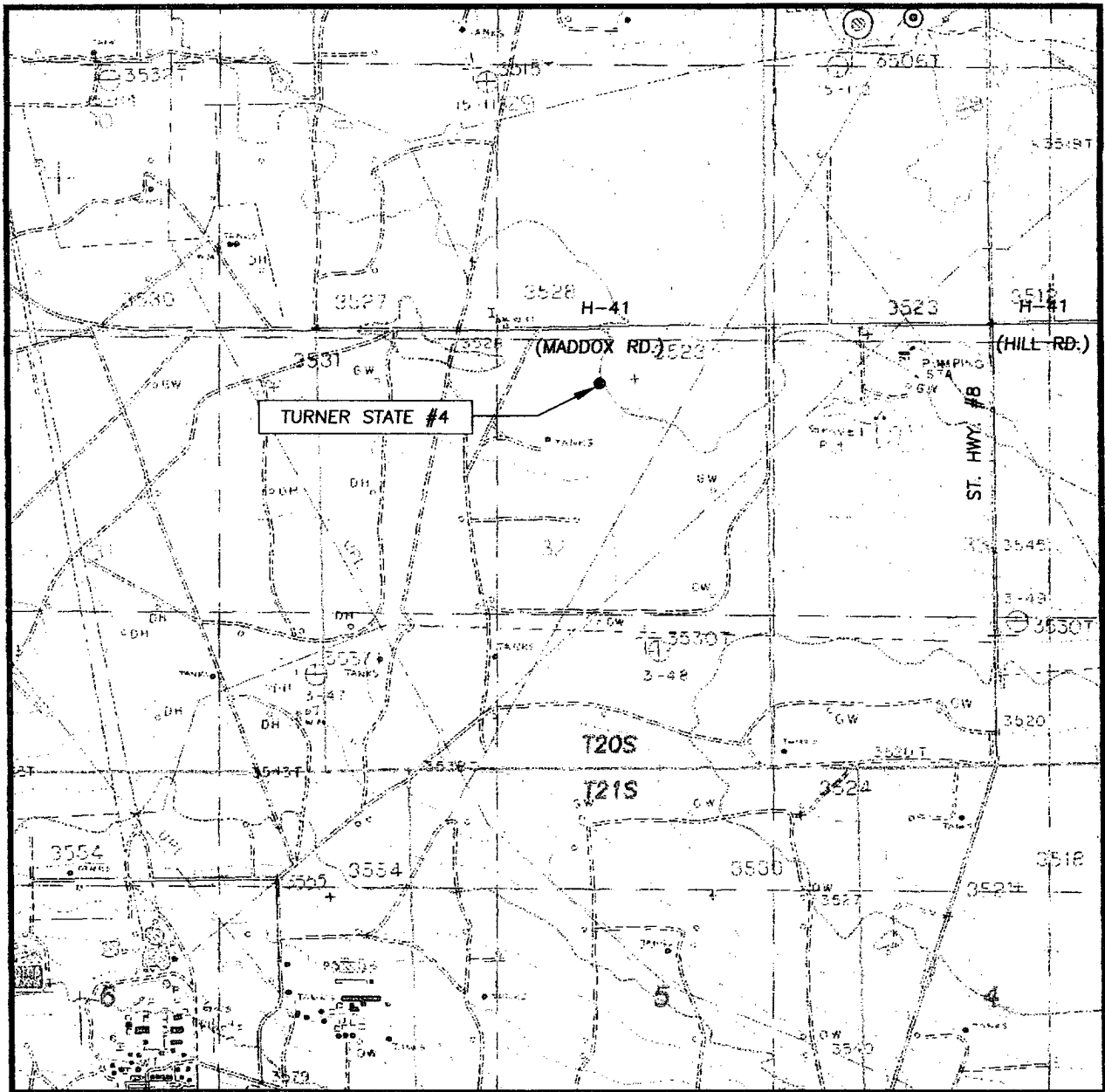

SCALE: 1" = 2000'

CONTOUR INTERVAL:
MONUMENT SOUTH, N.M. - 5'

SEC. 32 TWP. 20-S RGE. 37-E

SURVEY N.M.P.M.

COUNTY LEA STATE NEW MEXICO

DESCRIPTION 660' FNL & 1980' FEL

ELEVATION 3525'

OPERATOR PLANTATION OPERATING, LLC

LEASE TURNER STATE

U.S.G.S. TOPOGRAPHIC MAP
MONUMENT SOUTH, N.M.

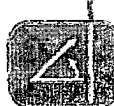

PROVIDING SURVEYING SERVICES
SINCE 1946
JOHN WEST SURVEYING COMPANY
412 N. DAL PASO
HOBBS, N.M. 88240
(505) 393-3117

BOP Schematic for 8-3/4 or- 7-7/8" Hole



Plantation Operating, LLC
BOP Schematic for 6-1/8 or- 7-7/8" Hole

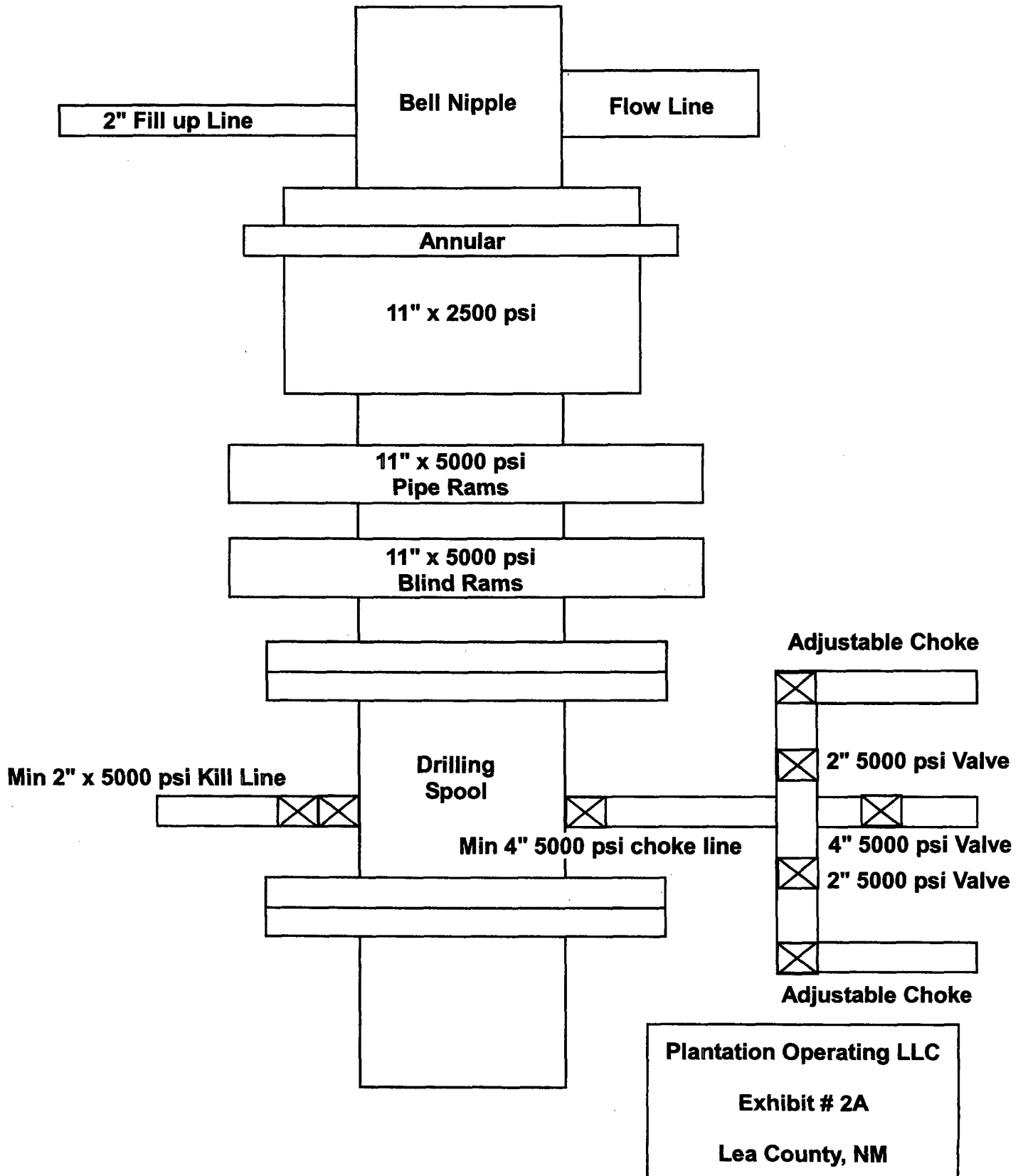

DISTRICT I
1625 N. French Dr., Hobbs, NM 88240
District II
1301 W. Grand Avenue, Artesia, NM 88210
District III
1000 Rio Brazos Road, Aztec, NM 87410
District IV
1220 S. St. Francis Dr., Santa Fe, NM 87505

State of New Mexico
Energy Minerals and Natural Resources

Oil Conservation Division
1220 South St. Francis Dr.
Santa Fe, NM 87505

Form C-144
June 1, 2004

For drilling and production facilities, submit to
appropriate NMOCD District Office.
For downstream facilities, submit to Santa Fe
office

Pit or Below-Grade Tank Registration or Closure

Is pit or below-grade tank covered by a "general plan"? Yes ☒ No ☐

Type of action: Registration of a pit or below-grade tank ☒ Closure of a pit or below-grade tank ☐

Operator: Plantation Operating, LLC Telephone: 281-296-7222 e-mail address: ddotson@plantationpetro.com
Address: 2203 Timberloch Place, Suite 229, The Woodlands, Texas 77380
Facility or well name: Turner State #4 API #: 30-025-37958 U/L or Qtr/Qtr B Sec 32 T 20S R 37E
County: Lea Latitude 32° 32'05.63" N Longitude 103° 16'15.36" W NAD: 1927 ☐ 1983 ☐
Surface Owner: Federal ☐ State ☐ Private ☒ Indian ☐

| | | | | | | | |
|--|---|--------------------|-------------|---|----------------------|-------------------|----------------------|
| Pit Type: Drilling <input type="checkbox"/> Production <input type="checkbox"/> Disposal <input type="checkbox"/> Workover <input type="checkbox"/> Emergency <input type="checkbox"/> Lined <input type="checkbox"/> Unlined <input type="checkbox"/> Liner type: Synthetic <input type="checkbox"/> Thickness <u> </u> mil Clay <input type="checkbox"/> Pit Volume <u> </u> bbl | Below-grade tank Volume: <u> </u> bbl Type of fluid: <u> </u> Construction material: <u> </u> Double-walled, with leak detection? Yes <input type="checkbox"/> If not, explain why not. <u> </u> | | | | | | |
| Depth to ground water (vertical distance from bottom of pit to seasonal high water elevation of ground water.) <u>N/A</u> | <table border="1"><tr><td>Less than 50 feet</td><td>(20 points)</td></tr><tr><td>50 feet or more, but less than 100 feet</td><td>(10 points) <u>0</u></td></tr><tr><td>100 feet or more</td><td>(0 points)</td></tr></table> | Less than 50 feet | (20 points) | 50 feet or more, but less than 100 feet | (10 points) <u>0</u> | 100 feet or more | (0 points) |
| Less than 50 feet | (20 points) | | | | | | |
| 50 feet or more, but less than 100 feet | (10 points) <u>0</u> | | | | | | |
| 100 feet or more | (0 points) | | | | | | |
| Wellhead protection area: (Less than 200 feet from a private domestic water source, or less than 1000 feet from all other water sources.) | <table border="1"><tr><td>Yes</td><td>(20 points)</td></tr><tr><td>No</td><td>(0 points) <u>0</u></td></tr></table> | Yes | (20 points) | No | (0 points) <u>0</u> | | |
| Yes | (20 points) | | | | | | |
| No | (0 points) <u>0</u> | | | | | | |
| Distance to surface water: (horizontal distance to all wetlands, playas, irrigation canals, ditches, and perennial and ephemeral watercourses.) | <table border="1"><tr><td>Less than 200 feet</td><td>(20 points)</td></tr><tr><td>200 feet or more, but less than 1000 feet</td><td>(10 points)</td></tr><tr><td>1000 feet or more</td><td>(0 points) <u>0</u></td></tr></table> | Less than 200 feet | (20 points) | 200 feet or more, but less than 1000 feet | (10 points) | 1000 feet or more | (0 points) <u>0</u> |
| Less than 200 feet | (20 points) | | | | | | |
| 200 feet or more, but less than 1000 feet | (10 points) | | | | | | |
| 1000 feet or more | (0 points) <u>0</u> | | | | | | |
| Ranking Score (Total Points) <u>0</u> | | | | | | | |

If this is a pit closure: (1) Attach a diagram of the facility showing the pit's relationship to other equipment and tanks. (2) Indicate disposal location: (check the onsite box if you are burying in place) onsite ☐ offsite ☐ If offsite, name of facility . (3) Attach a general description of remedial action taken including remediation start date and end date. (4) Groundwater encountered: No ☐ Yes ☐ If yes, show depth below ground surface ft. and attach sample results. (5) Attach soil sample results and a diagram of sample locations and excavations.

| |
|---------------------------|
| Additional Comments: |
| <u>Closed Loop System</u> |
| |
| |
| |
| |

I hereby certify that the information above is true and complete to the best of my knowledge and belief. I further certify that the above-described pit or below-grade tank has been/will be constructed or closed according to NMOCD guidelines ☐, a general permit ☐, or an (attached) alternative OCD-approved plan ☐.

Date: 4/27/2006

Printed Name/Title Donald P. Dotson / COO

Signature 

Your certification and NMOCD approval of this application/closure does not relieve the operator of liability should the contents of the pit or tank contaminate ground water or otherwise endanger public health or the environment. Nor does it relieve the operator of its responsibility for compliance with any other federal, state, or local laws and/or regulations.

Approval:

Printed Name/Title PETROLEUM ENGINEER

Signature 

Date: JUN 23 2006

 The sender of this message has requested a read receipt. [Click here to send a receipt.](#)

Mull, Donna, EMNRD

From: Phillips, Dorothy, EMNRD
To: Mull, Donna, EMNRD
Cc:
Subject: RE: Financial Assurance Requirement
Attachments:

Sent: Thu 6/22/2006 8:29 AM

Plantation has to submit a one well bond for 30-025-25962 according to Jane's list.
All of the have a blanket bond and the rest do not appear on Jane's list.

From: Mull, Donna, EMNRD
Sent: Thursday, June 22, 2006 8:13 AM
To: Phillips, Dorothy, EMNRD
Cc: Macquesten, Gail, EMNRD; Sanchez, Daniel J., EMNRD
Subject: Financial Assurance Requirement

Dorothy,

Is the Financial Assurance Requirement for these Operators OK?

Plantation Operating LLC (237788)
COG Operating LLC (229137)
Range Operating New Mexico Inc (227588)
Pogo Producing Co (17891)

I have checked the Inactive well list for each Operator.

Please let me know. Thanks and have a nice day. Donna