

Submit 3 Copies To Appropriate District  
Office  
District I  
1625 N. French Dr., Hobbs, NM 88240  
District II  
1301 W. Grand Ave., Artesia, NM 88210  
District III  
1000 Rio Brazos Rd., Aztec, NM 87410  
District IV  
1220 S. St. Francis Dr., Santa Fe, NM  
87505

State of New Mexico  
Energy, Minerals and Natural Resources

Form C-103  
May 27, 2004

OIL CONSERVATION DIVISION  
1220 South St. Francis Dr.  
Santa Fe, NM 87505

WELL API NO. 30-025-28805
5. Indicate Type of Lease STATE <input type="checkbox"/> FEE <input checked="" type="checkbox"/>
6. State Oil & Gas Lease No.
7. Lease Name or Unit Agreement Name B. M. Justis
8. Well Number 12
9. OGRID Number 237788
10. Pool name or Wildcat Jalmat (Tan-Yates-7 Rivers) (Gas)
11. Elevation (Show whether DR, RKB, RT, GR, etc.) 3074' GR
Pit or Below-grade Tank Application <input type="checkbox"/> or Closure <input type="checkbox"/>
Pit type _____ Depth to Groundwater _____ Distance from nearest fresh water well _____ Distance from nearest surface water _____
Pit Liner Thickness: _____ mil Below-Grade Tank: Volume _____ bbls; Construction Material _____

12. Check Appropriate Box to Indicate Nature of Notice, Report or Other Data

NOTICE OF INTENTION TO:

PERFORM REMEDIAL WORK ☐ PLUG AND ABANDON ☐  
TEMPORARILY ABANDON ☐ CHANGE PLANS ☐  
PULL OR ALTER CASING ☐ MULTIPLE COMPL ☐  
OTHER: ☐

SUBSEQUENT REPORT OF:

REMEDIAL WORK ☐ ALTERING CASING ☐  
COMMENCE DRILLING OPNS. ☐ P AND A ☐  
CASING/CEMENT JOB ☐  
OTHER: Recompletion ☒

13. Describe proposed or completed operations. (Clearly state all pertinent details, and give pertinent dates, including estimated date of starting any proposed work). SEE RULE 1103. For Multiple Completions: Attach wellbore diagram of proposed completion or recompletion.

6/8/2006:

Perfed Upper Yates from 2892-3060'.

Acidized with 4000 gal 15% MDA w/60 ball sealers.

Fracced w/123,434 gal of Water Frac G- R (33)/N-2 foam 65/48% quality carrying 250,060 lbs of sand.

Returned well to production.

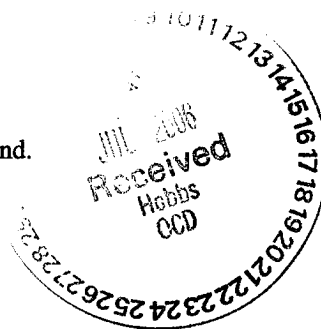

I hereby certify that the information above is true and complete to the best of my knowledge and belief. I further certify that any pit or below-grade tank has been/will be constructed or closed according to NMOCD guidelines ☐, a general permit ☐ or an (attached) alternative OCD-approved plan ☐.

SIGNATURE Donald Dotson TITLE \_\_\_\_\_ COO \_\_\_\_\_ DATE 7/6/2006

Type or print name Donald Dotson  
For State Use Only

E-mail address: ddotson@plantationpetro.com Telephone No. 281-296-7222

APPROVED BY: [Signature] TITLE PETROLEUM ENGINEER DATE JUL 31 2006  
Conditions of Approval (if any): \_\_\_\_\_

N MEXICO OIL CONSERVATION COMMISSION  
WELL LOCATION AND ACREAGE DEDICATION PLAT

Form C-102  
Supersedes C-128  
Effective 1-1-65

All distances must be from the outer boundaries of the Section

**30-025-288D5**

Operator <b>Doyle Hartman Oil Operator</b>			Lease <b>B. M. Justis</b>		Well No. <b>12</b>
Unit Letter <b>E</b>	Section <del>30R</del> <b>20</b>	Township <b>25 South</b>	Range <b>37 East</b>	County <b>Lea</b>	
Actual Footage Location of Well: <b>1450</b> <del>983</del> feet from the <b>North</b> line and <b>120</b> <del>339</del> feet from the <b>West</b> <del>E</del> line					
Ground Level Elev. <b>3074.0</b>	Producing Formation <b>Seven Rivers</b>		Pool <b>Jalmat (Oil) (Gas)</b>	Dedicated Acreage: <b>40 80</b> Acres	

1. Outline the acreage dedicated to the subject well by colored pencil or hatchure marks on the plat below.
2. If more than one lease is dedicated to the well, outline each and identify the ownership thereof (both as to working interest and royalty).
3. If more than one lease of different ownership is dedicated to the well, have the interests of all owners been consolidated by communitization, unitization, force-pooling, etc?

☐ Yes ☒ No If answer is "yes," type of consolidation \_\_\_\_\_

If answer is "no," list the owners and tract descriptions which have actually been consolidated. (Use reverse side of this form if necessary.) \_\_\_\_\_

No allowable will be assigned to the well until all interests have been consolidated (by communitization, unitization, forced-pooling, or otherwise) or until a non-standard unit, eliminating such interests, has been approved by the Commission.

**SD-06-03 (NSBHL)**

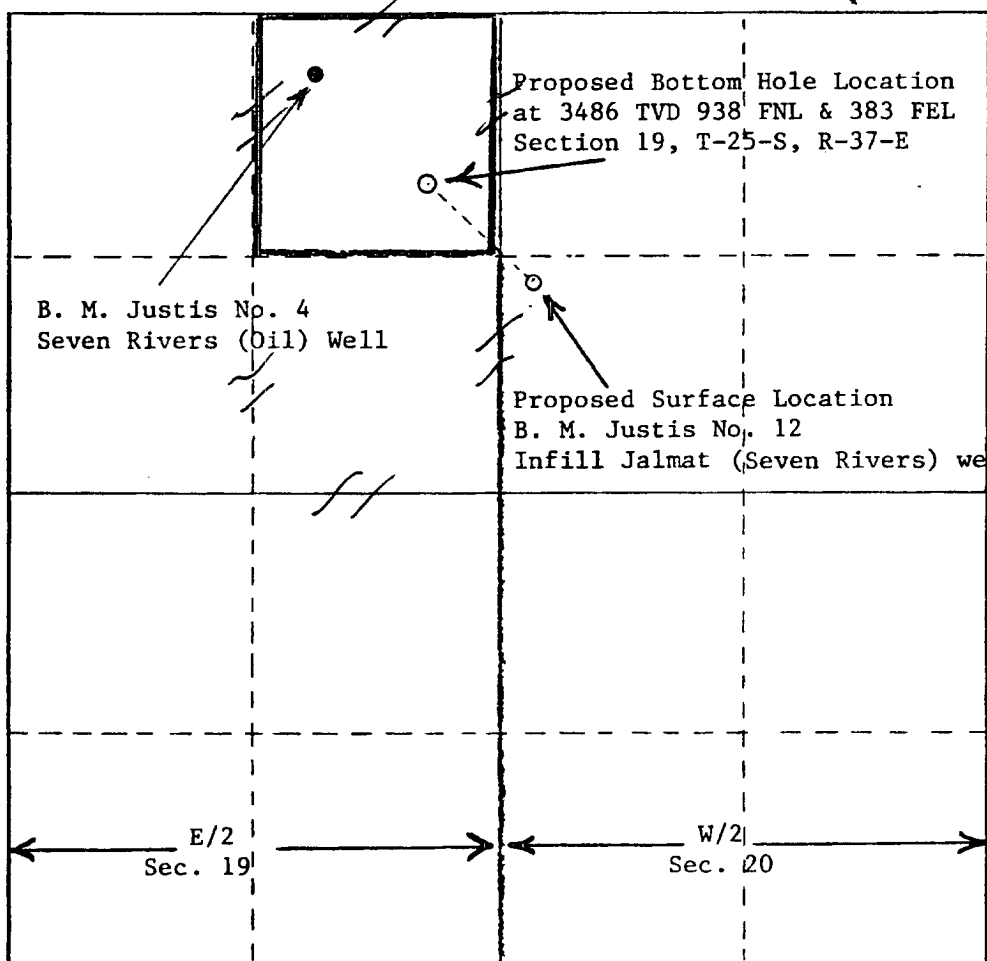

**CERTIFICATION**

I hereby certify that the information contained herein is true and complete to the best of my knowledge and belief.

*Larry A. Nermyr*  
Name

**Larry A. Nermyr**  
Position

**Engineer**  
Company

**Doyle Hartman**  
Date

**July 10, 1984**

I hereby certify that the well location shown on this plat was plotted from field notes of actual surveys made by me or under my supervision, and that the same is true and correct to the best of my knowledge and belief.

Date Surveyed

Registered Professional Engineer and/or Land Surveyor

Certificate No.

0 330 660 990 1320 1650 1980 2310 2640 2000 1500 1000 500