

District I
1625 N. Franch Dr., Hobbs, NM 88240
District II
1301 W. Grand Avenue, Artesia, NM 88210
District III
1000 Rio Brazos Road, Aztec, NM 87410
District IV
1220 S. St. Francis Dr., Santa Fe, NM 87505

State of New Mexico
Energy Minerals and Natural Resources

Form C-101
May 27, 2004

Oil Conservation Division
1220 South St. Francis Dr.
Santa Fe, NM 87505

Submit to appropriate District Office

☐ AMENDED REPORT

APPLICATION FOR PERMIT TO DRILL, RE-ENTER, DEEPEN, PLUGBACK, OR ADD A ZONE

¹ Operator Name and Address MANZANO, LLC P.O. BOX 2107 - ROSWELL, NM 88202-2107		² OGRD Number 231429
³ Property Code 35157	⁴ Property Name CAM-FEE	⁵ API Number 30 - 041-20926
⁹ Proposed Pool 1 CHAUVEROO, LOWER PENN, N (GAS)		⁶ Well No. 2
¹⁰ Proposed Pool 2		

7 Surface Location

UL or lot no.	Section	Township	Range	Lot Idn	Feet from the	North/South line	Feet from the	East/West line	County
0	34	6s	33e		990	SOUTH	1650	EAST	ROOSEVELT

8 Proposed Bottom Hole Location If Different From Surface

UL or lot no.	Section	Township	Range	Lot Idn	Feet from the	North/South line	Feet from the	East/West line	County

Additional Well Information

¹¹ Work Type Code N	¹² Well Type Code G	¹³ Cable/Rotary R	¹⁴ Lease Type Code P	¹⁵ Ground Level Elevation 4379'
¹⁶ Multiple N	¹⁷ Proposed Depth 9200	¹⁸ Formation MISSISSIPPIAN	¹⁹ Contractor UNITED DRILLING	²⁰ Spud Date SEPTEMBER 20, 2006
Depth to Groundwater 250'		Distance from nearest fresh water well 3000 FEET		Distance from nearest surface water MORE THAN ONE MILE
Pit: Liner: Synthetic <input checked="" type="checkbox"/> 12_mils thick Clay <input type="checkbox"/> Pit Volume: 10000_bbls				
Drilling Method: Fresh Water <input type="checkbox"/> Brine <input checked="" type="checkbox"/> Diesel/Oil-based <input type="checkbox"/> Gas/Air <input type="checkbox"/>				
Closed-Loop System <input type="checkbox"/>				

21 Proposed Casing and Cement Program

Hole Size	Casing Size	Casing weight/foot	Setting Depth	Sacks of Cement	Estimated TOC
17 1/2"	13 3/8"	48 #/FT	400'	400sx "C"	CIRCULATED
11"	8 5/8"	32 #/FT	3700'	1200sx "C"	CIRCULATED
7 7/8"	5 1/2"	17 #/FT	9200'	2000sx "C"	3000'

²² Describe the proposed program. If this application is to DEEPEN or PLUG BACK, give the data on the present productive zone and proposed new productive zone. Describe the blowout prevention program, if any. Use additional sheets if necessary.

Drill 17 1/2" hole to 400', run 13 3/8" 48#/ft casing to TD & cement with sufficient amount to circulate cement to surface - WOC 12hrs prior to drilling on shoe - NU 3000# WP BOPE & test to 500# w/rig pumps - Drill 11" hole to 3700', run 8 5/8" casing to TD & cement with sufficient amount to circulate to surface - WOC 12 hours prior to drilling on shoe - NU 3000# WP BOPE & test to 1000# w/rig pumps - Drill 7 7/8" hole to 9200', log well, if logs indicate productive will run 5 1/2" 17#/ft casing to TD and cement with sufficient amount to bring cement back into 8 5/8" annulus (3000' or higher) - If non-productive will plug and abandon as per NMOCD instructions. Previous drilling and production operations in this immediate area indicate that potentially hazardous amounts of H2S have not been encountered and we respectfully request that this Application for Permit To Drill be approved without a H2S Contingency Plan

²³ I hereby certify that the information given above is true and complete to the best of my knowledge and belief. I further certify that the drilling pit will be constructed according to NMOCD guidelines ☒, a general permit ☐, or an (attached) alternative OCD-approved plan ☐.

Printed name: Mike Hanagan

Title: Manager

E-mail Address: mhanagan@dfn.com

Date: 9/03/06

Phone: 505-623-1996

OIL CONSERVATION DIVISION

Approved by:

Chris Williams

Title:

OC DISTRICT SUPERVISOR/GENERAL MANAGER

Approval Date:

SEP 07 2006

Expiration Date:

Conditions of Approval Attached ☐

Revised June 10, 2003

Submit to Appropriate District Office

State Lease - 4 Copies

Fee Lease - 3 Copies

☐ AMENDED REPORT

State of New Mexico
Energy, Minerals & Natural Resources Department

OIL CONSERVATION DIVISION

1220 South St. Francis Dr.

Santa Fe, NM 87505

WELL LOCATION AND ACREAGE DEDICATION PLAT

¹ API Number 30-041-20926		² Pool Code 97445		³ Pool Name CHAUEROO, LOWER PENN, N (GAS)	
⁴ Property Code 35157		⁵ Property Name Cam-Fee			⁶ Well Number 2
⁷ GRID No. 231429		⁸ Operator Name Manzano, LLC			⁹ Elevation 4379'

¹⁰Surface Location

IL or lot no.	Section	Township	Range	Lot Idn	Feet from the	North/South line	Feet from the	East/West line	County
0	34	6 S	33 E		990	South	1650	East	Roosevelt

¹¹Bottom Hole Location If Different From Surface

IL or lot no.	Section	Township	Range	Lot Idn	Feet from the	North/South line	Feet from the	East/West line	County

¹² Dedicated Acres 320	¹³ Joint or Infill Y	¹⁴ Consolidation Code	¹⁵ Order No.
--------------------------------------	------------------------------------	----------------------------------	-------------------------

NO ALLOWABLE WILL BE ASSIGNED TO THIS COMPLETION UNTIL ALL INTERESTS HAVE BEEN CONSOLIDATED OR A NON-STANDARD UNIT HAS BEEN APPROVED BY THE DIVISION

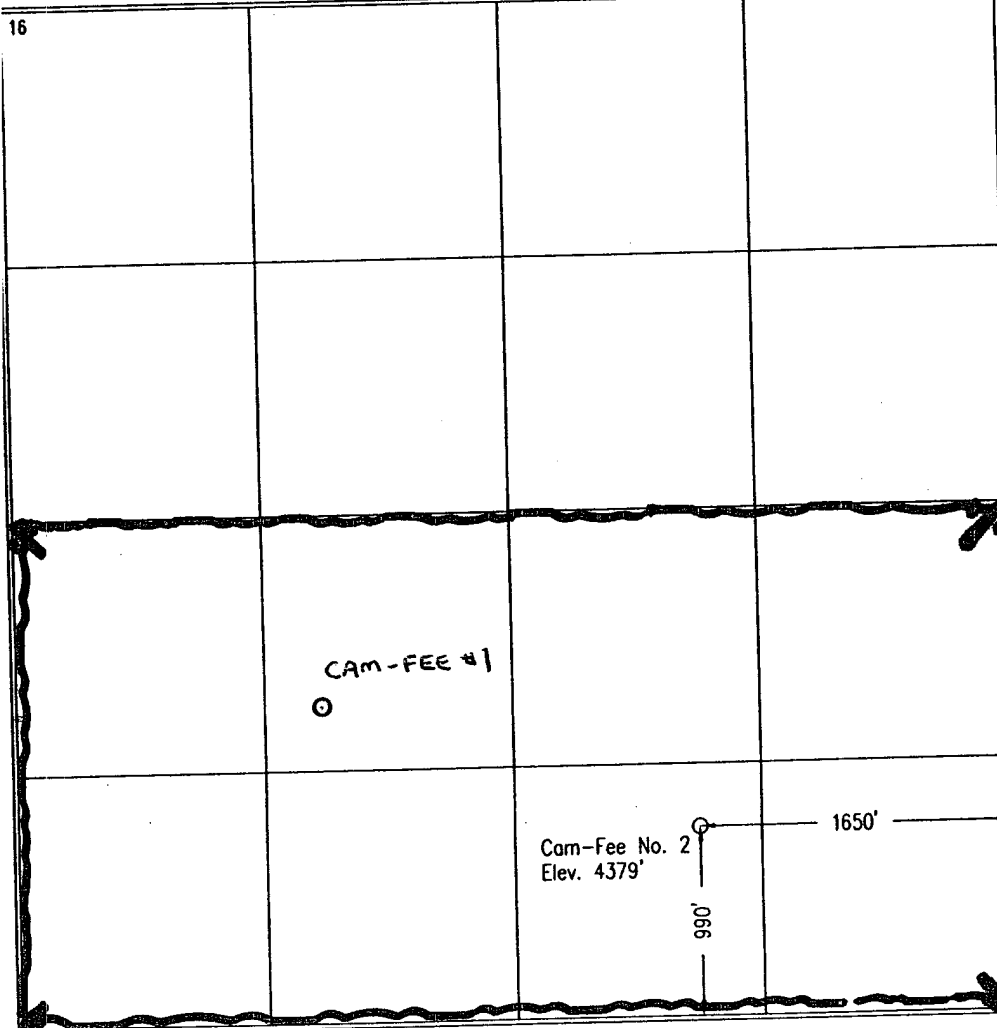
¹⁷OPERATOR CERTIFICATION

I hereby certify that the information contained herein is true and complete to the best of my knowledge and belief.

Mike Hanagan
Signature

MIKE HANAGAN
Printed Name

MANAGER - mhanagan@dmr.nm.gov
Title and E-mail Address

9/3/06
Date

¹⁸SURVEYOR CERTIFICATION

I hereby certify that the well location shown on this plat was plotted from field notes of actual surveys made by me or under my supervision, and that the same is true and correct to the best of my belief.

08-30-2006
Date of Survey

Signature and Seal of Professional Surveyor

Michael L. Stanford
Certificate Number

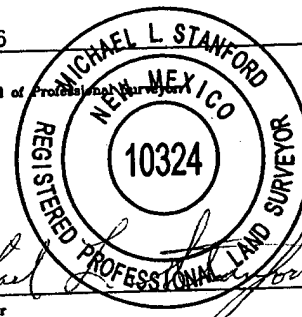

Manzano Cam-Fee #2

BOP DIAGRAM

3000# SYSTEM

