

District I  
1625 N. French Dr., Hobbs, NM 88240  
District II  
1301 W. Grand Avenue, Artesia, NM 88210  
District III  
1000 Rio Brazos Road, Aztec, NM 87410  
District IV  
1220 S. St. Francis Dr., Santa Fe, NM 87505

State of New Mexico  
Energy Minerals and Natural Resources

Oil Conservation Division  
1220 South St. Francis Dr.  
Santa Fe, NM 87505

Form C-144  
June 1, 2004

For drilling and production facilities, submit to appropriate NMOCD District Office.  
For downstream facilities, submit to Santa Fe office

**Pit or Below-Grade Tank Registration or Closure**

Is pit or below-grade tank covered by a "general plan"? Yes ☒ No ☐

Type of action: Registration of a pit or below-grade tank ☐ Closure of a pit or below-grade tank ☒

Operator: Chevron USA (O-Grid #4323) Telephone: 505-394-1237 e-mail address: lcwl@chevron.com		
Address: PO Box 1949 2401 Avenue O Eunice, New Mexico 88231		
Facility or well name: W. T. McComack #24 API #: 30-025-37837 Unit Letter (UL): B Qtr/Qtr: NW¼ NE¼ Section: 32, T21S, R37E		
County: Lea Latitude: N 32° 26' 30.9" Longitude: W 103° 10' 52.5" NAD: 1927 <input type="checkbox"/> 1983 <input type="checkbox"/> WGS 84 <input checked="" type="checkbox"/>		
Surface Owner: Federal <input type="checkbox"/> State <input type="checkbox"/> Private <input checked="" type="checkbox"/> (G. P. Sims) Indian <input type="checkbox"/>		
<b>Pit</b>	<b>Below-grade tank</b>	
Type: Drilling <input checked="" type="checkbox"/> Production <input type="checkbox"/> Disposal <input type="checkbox"/> Workover <input type="checkbox"/> Emergency <input type="checkbox"/>	Volume: bbl Type of fluid:	
Lined <input checked="" type="checkbox"/> Unlined <input type="checkbox"/>	Construction material:	
Liner type: Synthetic <input checked="" type="checkbox"/> Thickness 20 mil Clay <input type="checkbox"/>	Double-walled, with leak detection? Yes <input type="checkbox"/> If not, explain why not.	
Pit Volume: ~3,000 bbl		
Depth to ground water (vertical distance from bottom of pit to seasonal high water elevation of ground water.) ~96' bgs	Less than 50 feet	(20 points) <input type="checkbox"/>
	50 feet or more, but less than 100 feet	(10 points) <input checked="" type="checkbox"/>
	100 feet or more	( 0 points) <input type="checkbox"/>
Wellhead protection area: (Less than 200 feet from a private domestic water source, or less than 1000 feet from all other water sources.)	Yes	(20 points) <input type="checkbox"/>
	No	( 0 points) <input checked="" type="checkbox"/>
Distance to surface water: (horizontal distance to all wetlands, playas, irrigation canals, ditches, and perennial and ephemeral watercourses.)	Less than 200 feet	(20 points) <input type="checkbox"/>
	200 feet or more, but less than 1,000 feet	(10 points) <input type="checkbox"/>
	1,000 feet or more	( 0 points) <input checked="" type="checkbox"/>
<b>Ranking Score (Total Points)</b>		<b>10</b>

**If this is a pit closure:** (1) Attach a diagram of the facility showing the pit's relationship to other equipment and tanks. (2) Indicate disposal location: (check the onsite box if you are burying in place) onsite ☒ offsite ☐ If offsite, name of facility \_\_\_\_\_. (3) Attach a general description of remedial action taken including remediation start date and end date. (4) Groundwater encountered: No ☒ Yes ☐ If yes, show depth below ground surface \_\_\_\_\_ ft. and attach sample results. (5) Attach soil sample results and a diagram of sample locations and excavations.

Additional Comments: The pit has been closed consistent with the "ChevronTexaco Drilling and Reserve Pit Closure General Plan, December 2004" and the NMOCD Pit and Below-Grade Tank Guidelines, November 1, 2004 as promulgated under NMOCD Rule 50 (19.15.2.50 NMAC).
Pit Status: Liner intact <input checked="" type="checkbox"/> Liner punctured or torn <input type="checkbox"/>
Method of Closure: The pit has been closed via encapsulation, which consisted of mixing earthen materials with the pit contents, as necessary to stiffen the pit contents sufficiently to provide physical stability and support a pit cover. Upon the pit contents being stiffened as required, the edges of the liner were folded over the edges of the stiffened mud and cuttings and the pit covered with a 20-mil thick impervious, reinforced synthetic polyethylene liner meeting ASTM standards designed to be resistant to the material encapsulated. The liner was then covered with a minimum of three feet of clean soil or like material capable of supporting native plant growth.

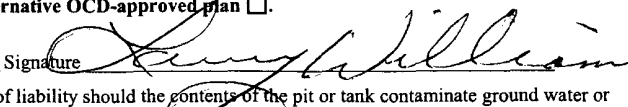
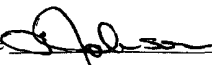
I hereby certify that the information above is true and complete to the best of my knowledge and belief. I further certify that the above-described pit or below-grade tank will be closed according to NMOCD guidelines <input checked="" type="checkbox"/> , a general permit <input checked="" type="checkbox"/> , or an (attached) alternative OCD-approved plan <input type="checkbox"/> .		
Date: 8-28-06	Printed Name/Title: Larry Williams, HES Champion	Signature: 
Your certification and NMOCD approval of this application/closure does not relieve the operator of liability should the contents of the pit or tank contaminate ground water or otherwise endanger public health or the environment. Nor does it relieve the operator of its responsibility for compliance with any other federal, state, or local laws and/or regulations.		
Approval:		
Printed Name/Title: L. Johnson, Enviro Engr	Signature: 	Date: 9.12.06



**ENVIRONMENTAL PLUS, INC.**  
CONSULTING AND REMEDIAL CONSTRUCTION

15 August 2006

Mr. Larry Johnson, Environmental Engineer  
New Mexico Energy, Minerals and Natural Resources Department  
Oil Conservation Division Environmental Bureau  
1625 North French  
Hobbs, New Mexico 88240

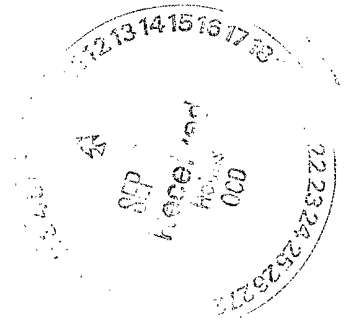

Re: Final C-144  
Chevron USA (O-Grid #4323)  
W. T. McComack #24 (Ref. #200095)  
UL-B, Section 32, Township 21 South, Range 37 East

Dear Mr. Johnson:

Environmental Plus, Inc., on behalf of Chevron USA (Chevron) submits the enclosed New Mexico Oil Conservation Division (NMOCD) form C-144 and supporting information. Chevron has closed the drill pit at the above-referenced well site in accordance with the NMOCD Pit and Below-Grade Tank Guidelines, November 1, 2004 and the "ChevronTexaco Drilling and Reserve Pit Closure General Plan, December 2004." Please direct all official communications to:

Chevron USA  
Larry Williams, HES Champion  
P.O. Box 1949  
Eunice, New Mexico 88231  
Telephone: 505-394-1237  
Email: [lcwl@chevron.com](mailto:lcwl@chevron.com)

Should you have any questions or concerns, please call me at (505) 394-3481. Mr. Larry Williams can be contacted at (505) 394-1237 or via e-mail at [lcwl@chevron.com](mailto:lcwl@chevron.com).

Sincerely,

ENVIRONMENTAL PLUS, INC.

Pat McCasland  
Senior Consultant

ENVIRONMENTAL PLUS, INC.



**ENVIRONMENTAL PLUS, INC.**  
CONSULTING AND REMEDIAL CONSTRUCTION

---

cc: Larry Williams, Chevron USA  
Nathan Mouser, Chevron USA  
G. P. Sims, Landowner  
File

Enclosures: Topographical Map  
Site Location Map  
Site Map  
Groundwater Map  
Well Data Table  
Photographs  
NMOCD Form C-144

ENVIRONMENTAL PLUS, INC.

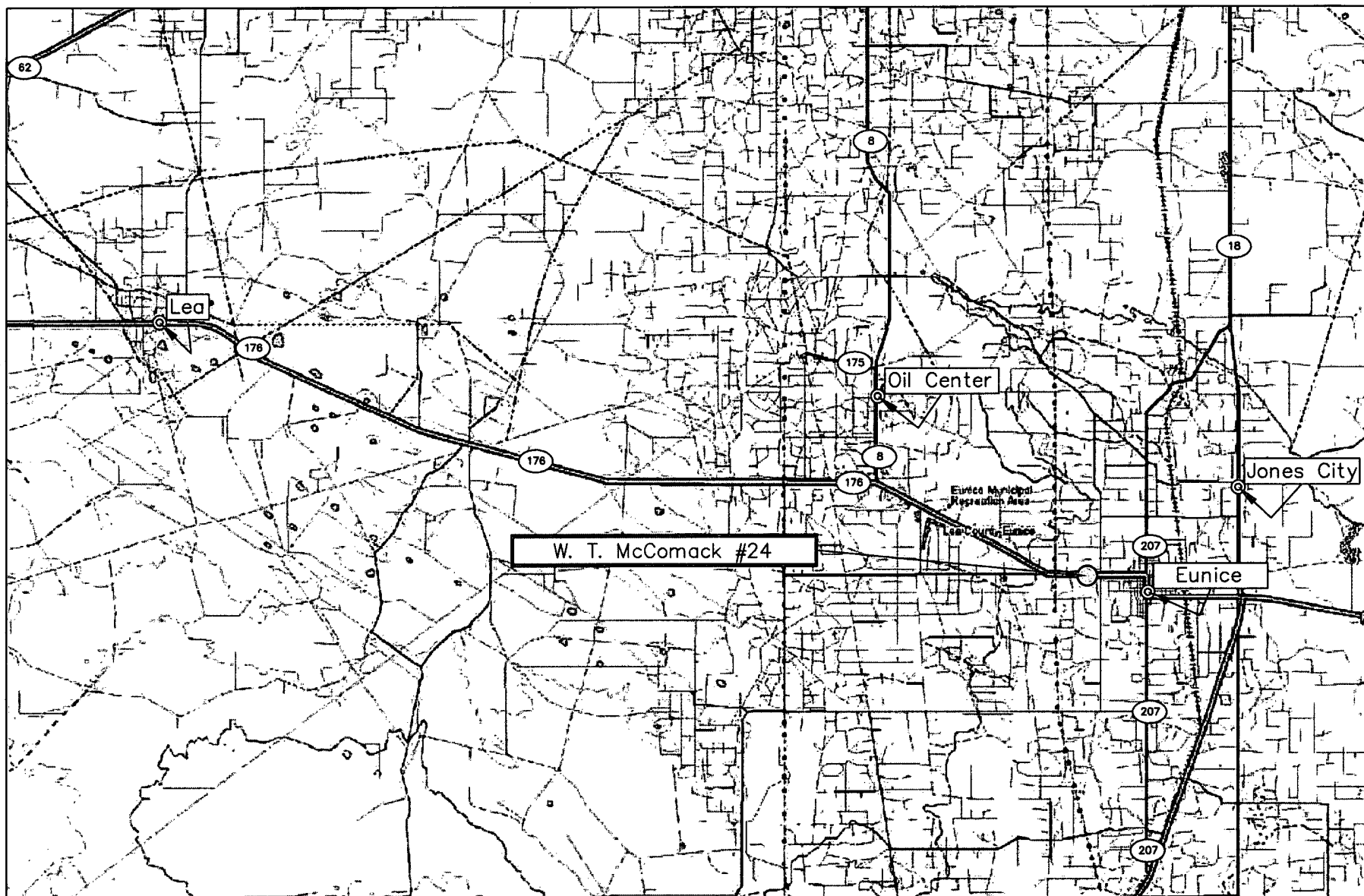
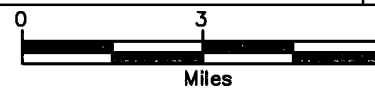

Figure 1  
Area Map  
Chevron Corporation  
W. T. McComack #24

Lea County, New Mexico  
NW 1/4 of the NE 1/4, Sec. 32, T21S, R37E  
N 32° 26' 30.9" W 103° 10' 52.5"  
Elevation: 3,462 feet amsl

DWG By: Daniel Dominguez  
July 2006

REVISED:



SHEET  
1 of 1

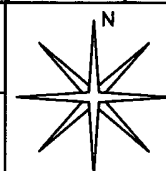

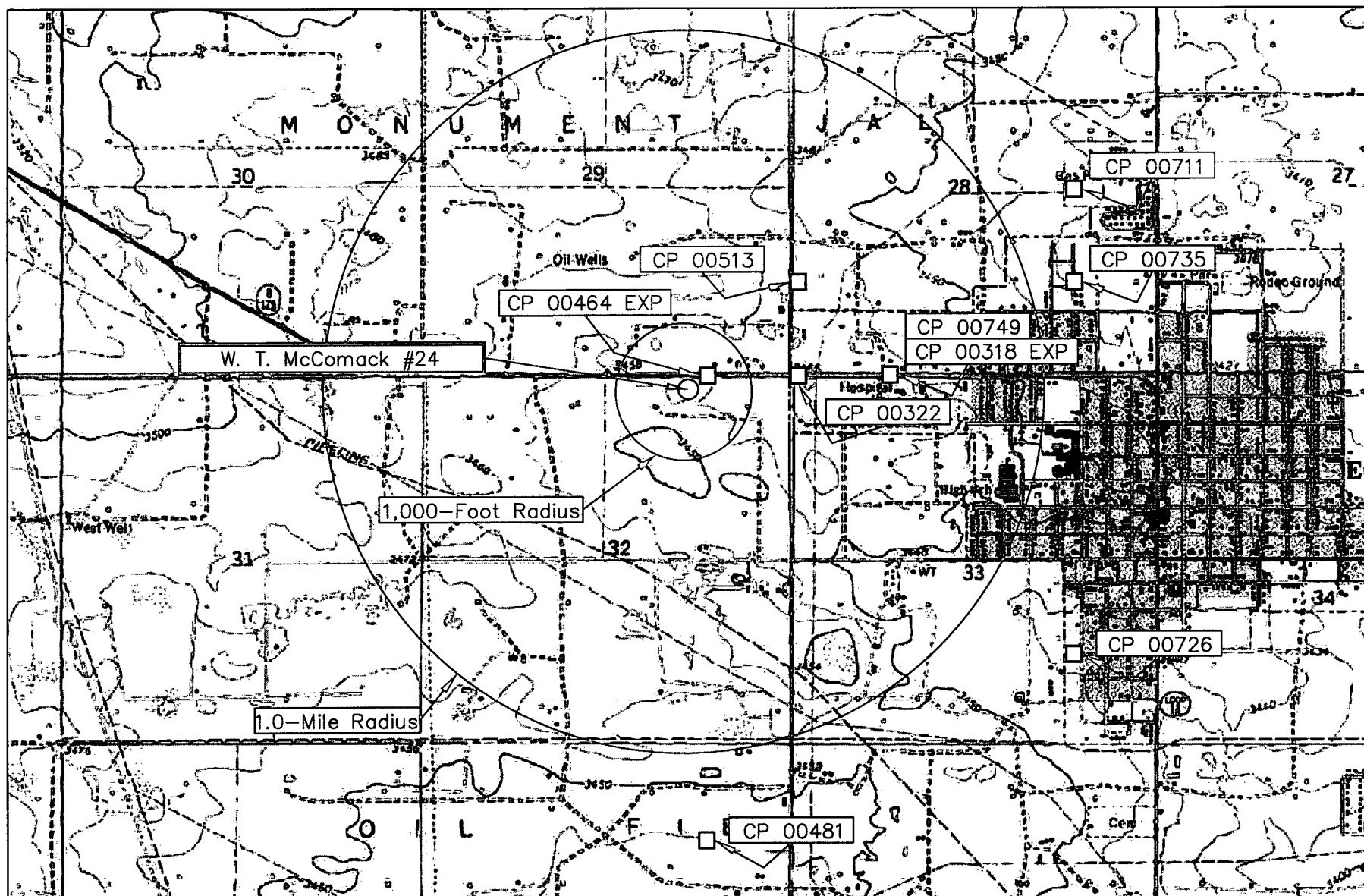

Figure 2  
Site Location Map  
Chevron Corporation  
W. T. McComack #24

Lea County, New Mexico  
NW 1/4 of the NE 1/4, Sec. 32, T21S, R37E  
N 32° 26' 30.9" W 103° 10' 52.5"  
Elevation: 3,462 feet amsl

DWG By: Daniel Dominguez  
July 2006

REVISED:

0 2,000 4,000  
Feet

SHEET  
1 of 1

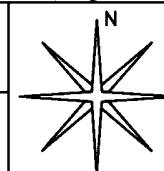

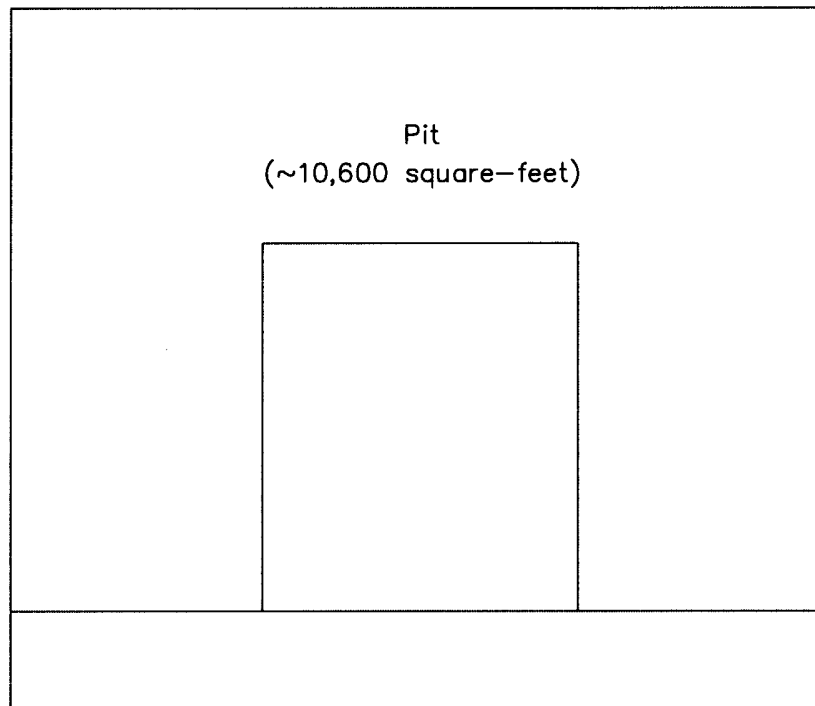

LEGEND

Ⓢ Oil Well

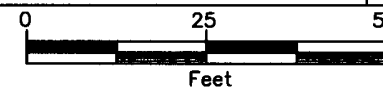

Figure 3  
Site Map  
Chevron Corporation  
W. T. McCormack #24

Lea County, New Mexico  
NW 1/4 of the NE 1/4, Sec. 32, T21S, R37E  
N 32° 26' 30.9" W 103° 10' 52.5"  
Elevation: 3,462 feet amsl

DWG By: Daniel Dominguez  
July 2006

REVISED:



SHEET  
1 of 1

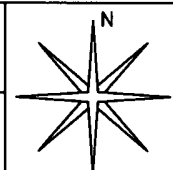

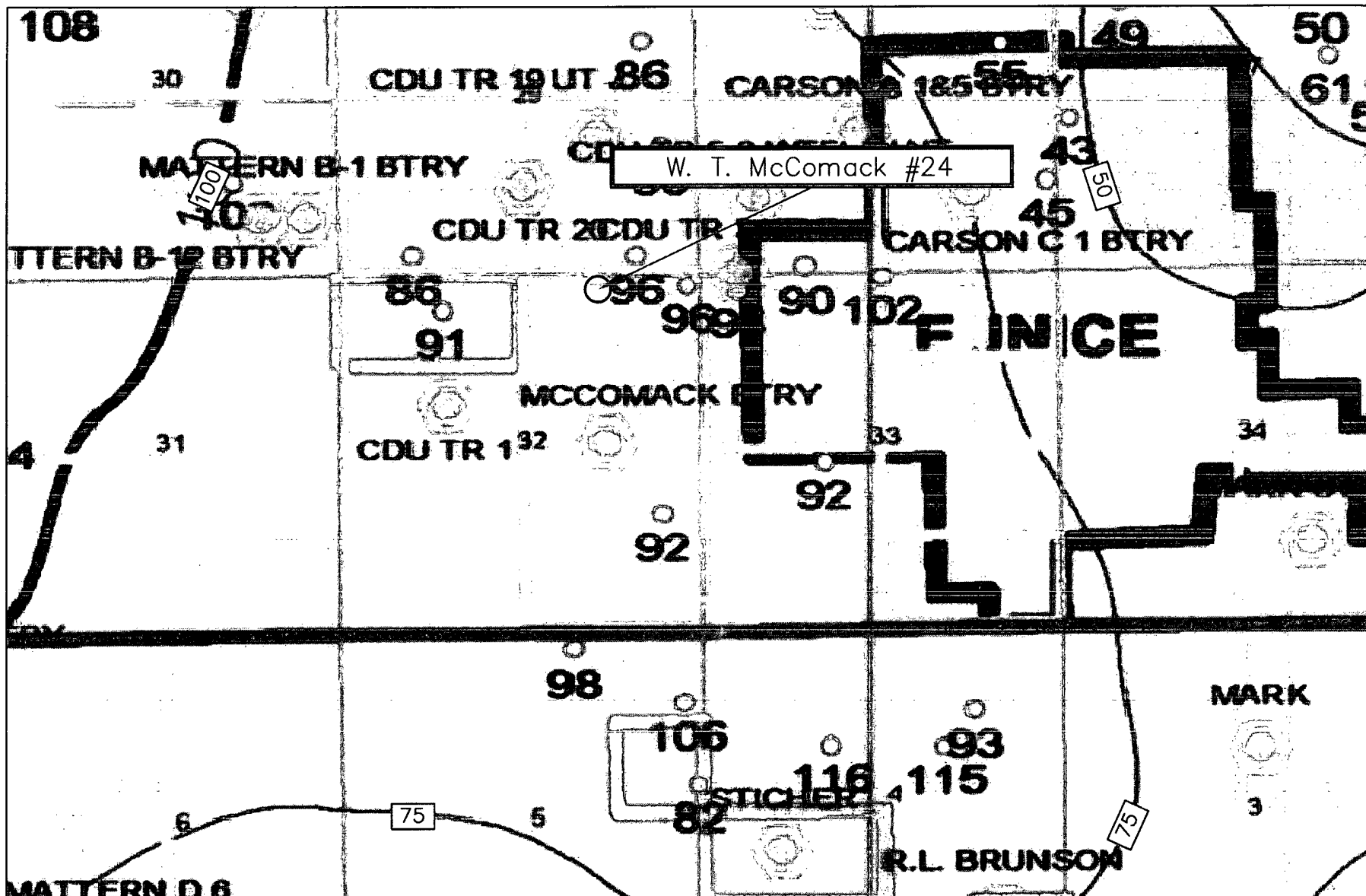
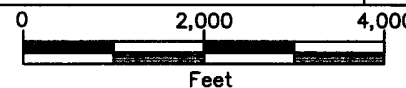

Figure 4  
Groundwater Map  
Chevron Corporation  
W. T. McComack #24

Lea County, New Mexico  
NW 1/4 of the NE 1/4, Sec. 32, T21S, R37E  
N 32° 26' 30.9" W 103° 10' 52.5"  
Elevation: 3,462 feet amsl

DWG By: Daniel Dominguez  
July 2006

REVISED:



SHEET  
1 of 1

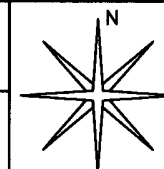

**TABLE 1**  
**WELL INFORMATION REPORT\***  
**Chevron USA W. T. McComack #24 - Ref #200095**

Well Number	Diversion <sup>A</sup>	Owner	Use	Twsp	Rng	Sec q q q	Latitude	Longitude	Date Measured	Surface Elevation <sup>B</sup>	Depth to Water (ft bgs)
CP 00318 EXP	0	MCCASLAND HOT OIL SERVICE INC	SAN	21S	37E	28 3 4	N32° 26' 32.92"	W103° 10' 18.29"		3,465	
CP 00322	3	MILLARD DECK	DOM	21S	37E	28 3	N32° 26' 32.92"	W103° 10' 33.69"	10-Jun-66	3,475	73
CP 00513	0	CORPORATION GULF OIL	SRO	21S	37E	28 3 1 3	N32° 26' 45.98"	W103° 10' 33.70"		3,471	
CP 00711	3	FLOYD G. BLOCK	DOM	21S	37E	28 2 4	N32° 26' 59.02"	W103° 09' 47.52"	02-Oct-87	3,439	65
CP 00735	3	CHARLES W. JENNINGS	DOM	21S	37E	28 4 2	N32° 26' 45.97"	W103° 09' 47.51"	27-Jul-88	3,435	
CP 00749	3	D.M. CRISWELL	DOM	21S	37E	28 3 4 2	N32° 26' 32.92"	W103° 10' 33.69"	22-Jun-90	3,475	75
CP 00464 EXP	0	EUGENE WINKER	DOM	21S	37E	29 4 4 4	N32° 26' 32.94"	W103° 10' 49.08"		3,466	
CP 00726	3	CLAYTON L. WOOTEN	DOM	21S	37E	33 4 2	N32° 25' 53.76"	W103° 09' 47.50"	23-Feb-88	3,445	100
CP 00481	3	MIX OSBORN	DOM	22S	37E	05 2 2 4	N32° 25' 27.64"	W103° 10' 49.08"	11-Apr-70	3,445	90
CP 00254	64	VERSADO GAS PROCESSORS, LLC	IND	22S	37E	04 1 4 2	N32° 25' 14.63"	W103° 10' 18.31"	31-Aug-50	3,438	
CP 00255	60	VERSADO GAS PROCESSORS, LLC	IND	22S	37E	04 1 4 1	N32° 25' 14.63"	W103° 10' 18.31"	31-May-54	3,438	
CP 00451	0	SKELLY OIL COMPANY	PUB	22S	37E	04 3 1 3	N32° 25' 1.55"	W103° 10' 33.70"		3,433	
CP 00468 DGL	0	LAWERISTO	DOM	22S	37E	04 4 4 3	N32° 24' 48.55"	W103° 09' 47.56"		3,425	
CP 00439 EXP	0	BOBBY REARCE	DOM	22S	37E	05 2 4 2	N32° 25' 14.58"	W103° 10' 49.09"		3,435	
CP 00666	3	LARRY HENSON	DOM	22S	37E	05 2	N32° 25' 14.55"	W103° 11' 4.49"	27-Aug-84	3,435	79

\* = Data obtained from the New Mexico Office of the State Engineer Website ([http://iwaters.ose.state.nm.us:7001/iWATERS/wr\\_RegisServlet](http://iwaters.ose.state.nm.us:7001/iWATERS/wr_RegisServlet)) and USGS Database.

<sup>A</sup> = in acre feet per annum

<sup>B</sup> = Interpolated from USGS Topographical Map

SAN = 72-12-1 Sanitary in conjunction with commercial use

DOM = Domestic one household

SRO = Secondary recovery of oil

IND = Industrial

PUB = 2-12-1 Construction of public works

(quarters are 1=NW, 2=NE, 3=SW, 4=SE)

(quarters are biggest to smallest - X Y are in Feet - UTM are in Meters)

Shaded area indicates wells not shown on Figure 2





Photograph #1 - Lease sign.



Photograph #2 - Pit and berm, looking southerly.



Photograph #3 – Pit and berm, looking southerly.



Photograph #4 – Liner folded over stiffened pit contents.



Photograph #5 – Liner covering stiffened pit contents.

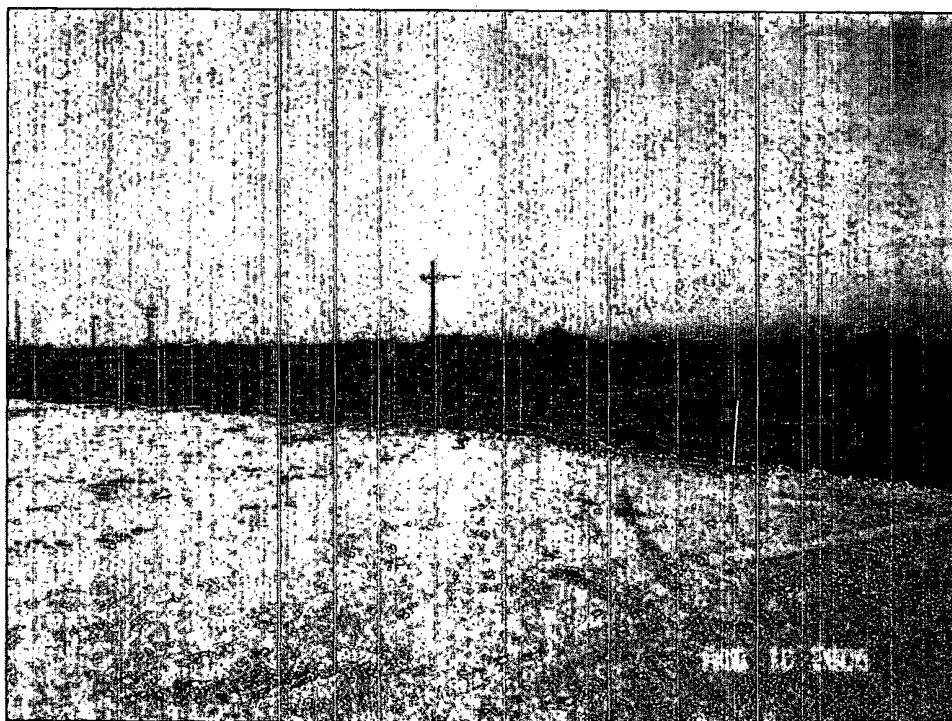

Photograph #6 – Closed pit.