

DISTRICT I
1625 N. FRENCH DR., HOBBS, NM 88240

DISTRICT II
1301 W. GRAND AVENUE, ARTESIA, NM 88210

DISTRICT III
1000 Rio Brazos Rd., Aztec, NM 87410

DISTRICT IV
1220 S. ST. FRANCIS DR., SANTA FE, NM 87505

State of New Mexico
Energy, Minerals and Natural Resources Department

OIL CONSERVATION DIVISION
1220 SOUTH ST. FRANCIS DR.
Santa Fe, New Mexico 87505

Form C-102
Revised October 12, 2005
Submit to Appropriate District Office
State Lease - 4 Copies
Fee Lease - 3 Copies

WELL LOCATION AND ACREAGE DEDICATION PLAT

☐ AMENDED REPORT

API Number 30-025-38147	Pool Code 23000	Pool Name Eunice Monument GB/SA
Property Code 302708	Property Name NMGSAU	Well Number 345
OGRID No. 873	Operator Name APACHE CORPORATION	Elevation 3616'

Surface Location

UL or lot No. F	Section 29	Township 19-S	Range 37-E	Lot Idn	Feet from the 1360	North/South line NORTH	Feet from the 2510	East/West line WEST	County LEA
---------------------------	----------------------	-------------------------	----------------------	---------	------------------------------	----------------------------------	------------------------------	-------------------------------	----------------------

Bottom Hole Location If Different From Surface

UL or lot No.	Section	Township	Range	Lot Idn	Feet from the	North/South line	Feet from the	East/West line	County
---------------	---------	----------	-------	---------	---------------	------------------	---------------	----------------	--------

Dedicated Acres 40	Joint or Infill	Consolidation Code	Order No.
------------------------------	-----------------	--------------------	-----------

NO ALLOWABLE WILL BE ASSIGNED TO THIS COMPLETION UNTIL ALL INTERESTS HAVE BEEN CONSOLIDATED
OR A NON-STANDARD UNIT HAS BEEN APPROVED BY THE DIVISION

	<p>OPERATOR CERTIFICATION</p> <p>I hereby certify that the information herein is true and complete to the best of my knowledge and belief, and that this organization either owns a working interest or unleased mineral interest in the land including the proposed bottom hole location or has a right to drill this well at this location pursuant to a contract with an owner of such mineral or working interest, or to a voluntary pooling agreement or a compulsory pooling order heretofore entered by the division.</p> <p><i>Lana Williams</i> 9/28/06 Signature Date</p> <p><u>Lana Williams</u> Printed Name</p>
	<p>SURVEYOR CERTIFICATION</p> <p>I hereby certify that the well location shown on this plat was plotted from field notes of actual surveys made by me or under my supervision, and that the same is true and correct to the best of my belief.</p> <p>MAY 09, 2006</p> <p>Date Surveyed REVISION DATE: 06/13/06 Signature & Seal of Professional Surveyor MR</p> <p><i>Gary Edson</i> 6/14/06 06.13.1013</p> <p>Certificate No. GARY EDSON 12641 RONALD J. EDSON 3239</p>

DISTRICT I
1625 N. FRANCHI DR., HOBBS, NM 88240

DISTRICT II
1301 W. GRAND AVENUE, ARTESIA, NM 88210

DISTRICT III
1000 Rio Brazos Rd., Aztec, NM 87410

DISTRICT IV
1220 S. ST. FRANCIS DR., SANTA FE, NM 87505

State of New Mexico
Energy, Minerals and Natural Resources Department

OIL CONSERVATION DIVISION
1220 SOUTH ST. FRANCIS DR.
Santa Fe, New Mexico 87505

Form C-102
Revised October 12, 2005
Submit to Appropriate District Office
State Lease - 4 Copies
Fee Lease - 3 Copies

WELL LOCATION AND ACREAGE DEDICATION PLAT

☐ AMENDED REPORT

API Number	Pool Code	Pool Name
Property Code	Property Name NMGSAU	Well Number 345
OGRID No.	Operator Name APACHE CORPORATION	Elevation 3616'

Surface Location

UL or lot No.	Section	Township	Range	Lot Idn	Feet from the	North/South line	Feet from the	East/West line	County
F	29	19-S	37-E		1360	NORTH	2510	WEST	LEA

Bottom Hole Location If Different From Surface

UL or lot No.	Section	Township	Range	Lot Idn	Feet from the	North/South line	Feet from the	East/West line	County
Dedicated Acres	Joint or Infill	Consolidation Code	Order No.						

NO ALLOWABLE WILL BE ASSIGNED TO THIS COMPLETION UNTIL ALL INTERESTS HAVE BEEN CONSOLIDATED
OR A NON-STANDARD UNIT HAS BEEN APPROVED BY THE DIVISION

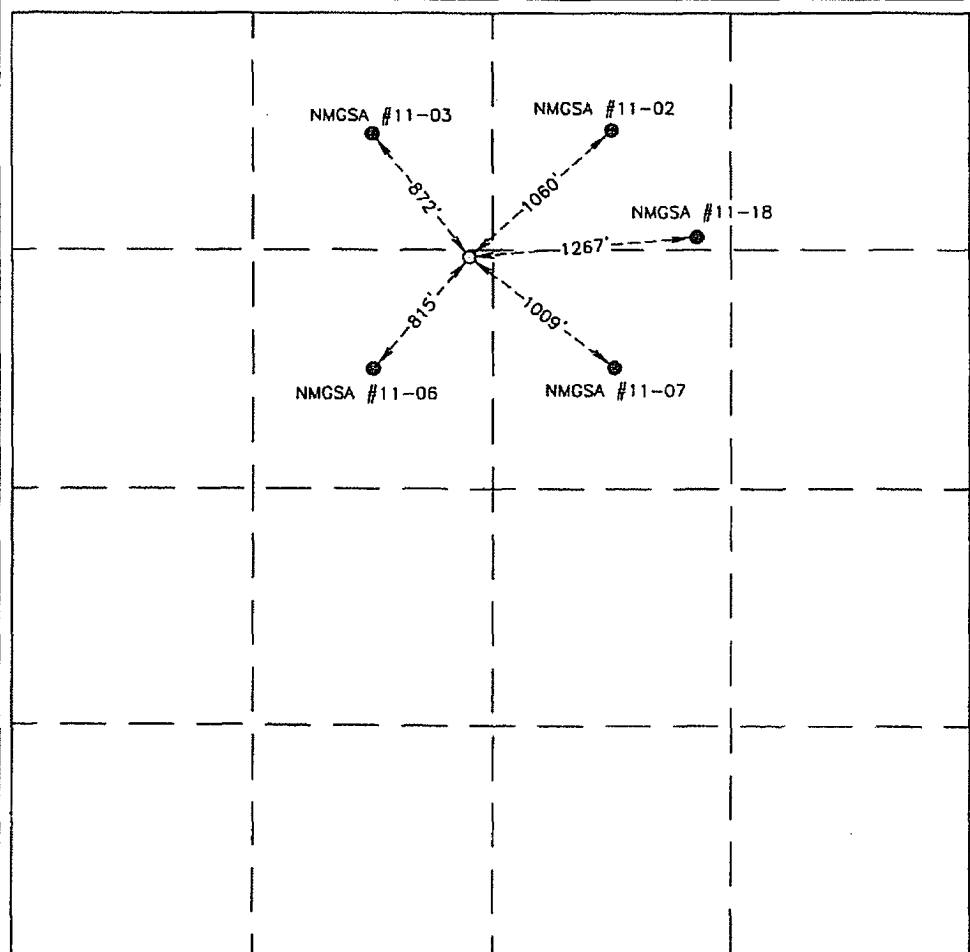
	<p>OPERATOR CERTIFICATION</p> <p>I hereby certify that the information herein is true and complete to the best of my knowledge and belief, and that this organization either owns a working interest or unleased mineral interest in the land including the proposed bottom hole location or has a right to drill this well at this location pursuant to a contract with an owner of such mineral or working interest, or to a voluntary pooling agreement or a compulsory pooling order heretofore entered by the division.</p> <p><i>Lana Williams</i> 9/28/06 Signature Date</p> <p><u>Lana Williams</u> Printed Name</p> <p>SURVEYOR CERTIFICATION</p> <p>I hereby certify that the well location shown on this plat was plotted from field notes of actual surveys made by me or under my supervision, and that the same is true and correct to the best of my belief.</p> <p>MAY 09, 2006</p> <p>Date Surveyed REVISION DATE: 06/13/06 Signature & Seal of Professional Surveyor MR</p> <p>06.13.1013</p> <p>Certificate No. GARY EIDSON 12841 RONALD J. EIDSON 3239</p>
---	--

SECTION 29, TOWNSHIP 19 SOUTH, RANGE 37 EAST, N.M.P.M.,
 LEA COUNTY, NEW MEXICO

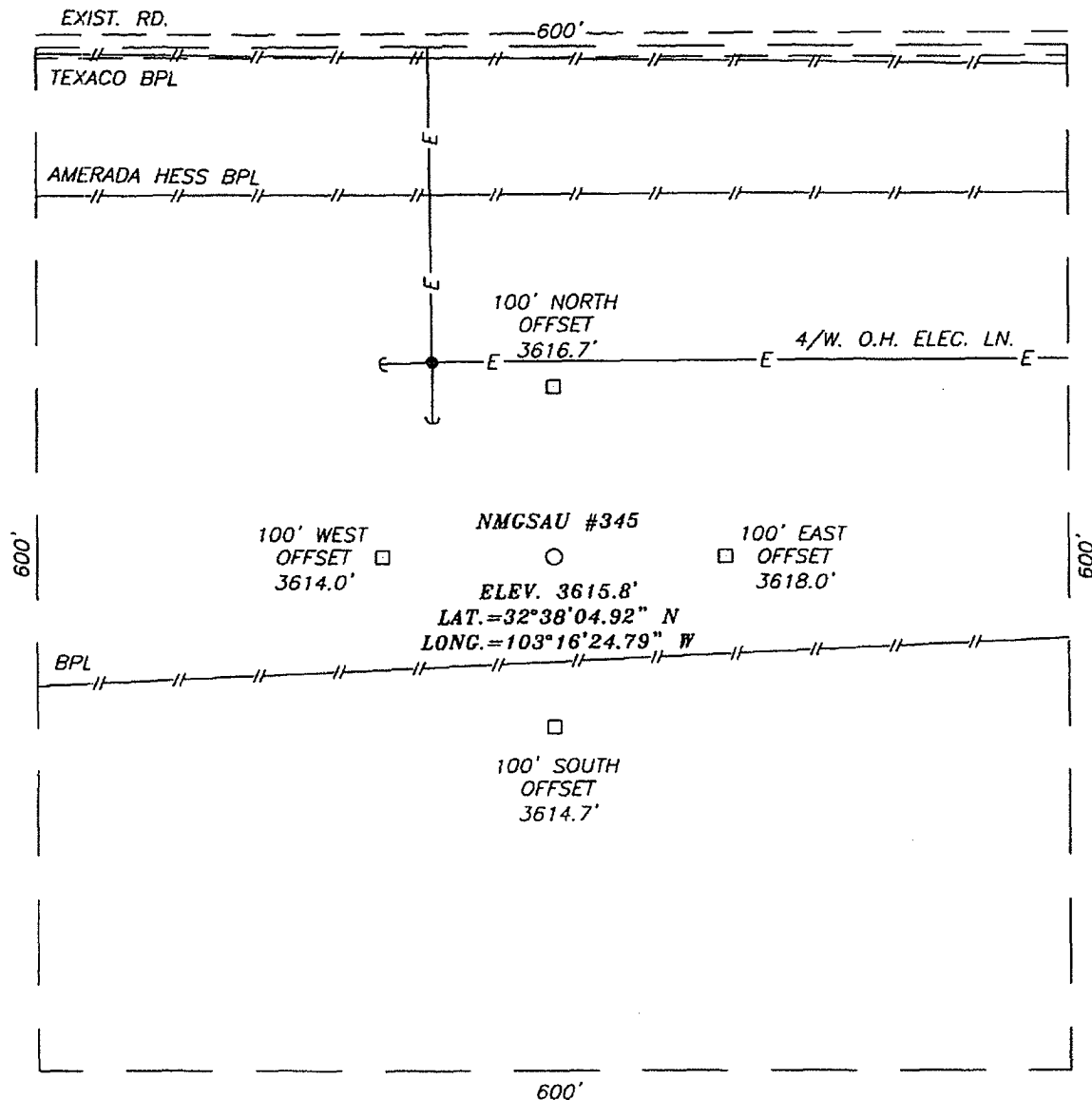

DIRECTIONS TO LOCATION

FROM THE INTERSECTION OF ST. HWY. #8 AND ST. HWY. #322, GO NORTH ON ST. HWY. #8 APPROX. 1.4 MILES. TURN LEFT (THROUGH CATTLE GUARD) AND GO WEST APPROX. 0.4 MILES. TURN LEFT AND GO SOUTH APPROX. 0.4 MILES TO A ROAD INTERSECTION. TURN RIGHT AND GO SOUTHWEST APPROX. 0.25 MILES. THIS LOCATION IS APPROX. 300 FEET SOUTH.

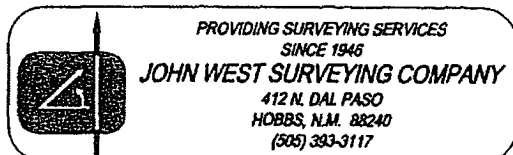
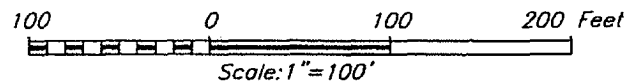

APACHE CORPORATION

NMGSAU #345
 LOCATED 1360 FEET FROM THE NORTH LINE
 AND 2510 FEET FROM THE WEST LINE OF SECTION 29,
 TOWNSHIP 19 SOUTH, RANGE 37 EAST, N.M.P.M.,
 LEA COUNTY, NEW MEXICO.

Survey Date: 05/09/06	Sheet 1 of 1 Sheets
W.O. Number: 06.13.1013	Dr By: M.R.
Date: 05/12/06	Disk: CD#6
06131013	Scale: 1"=100'

VICINITY MAP

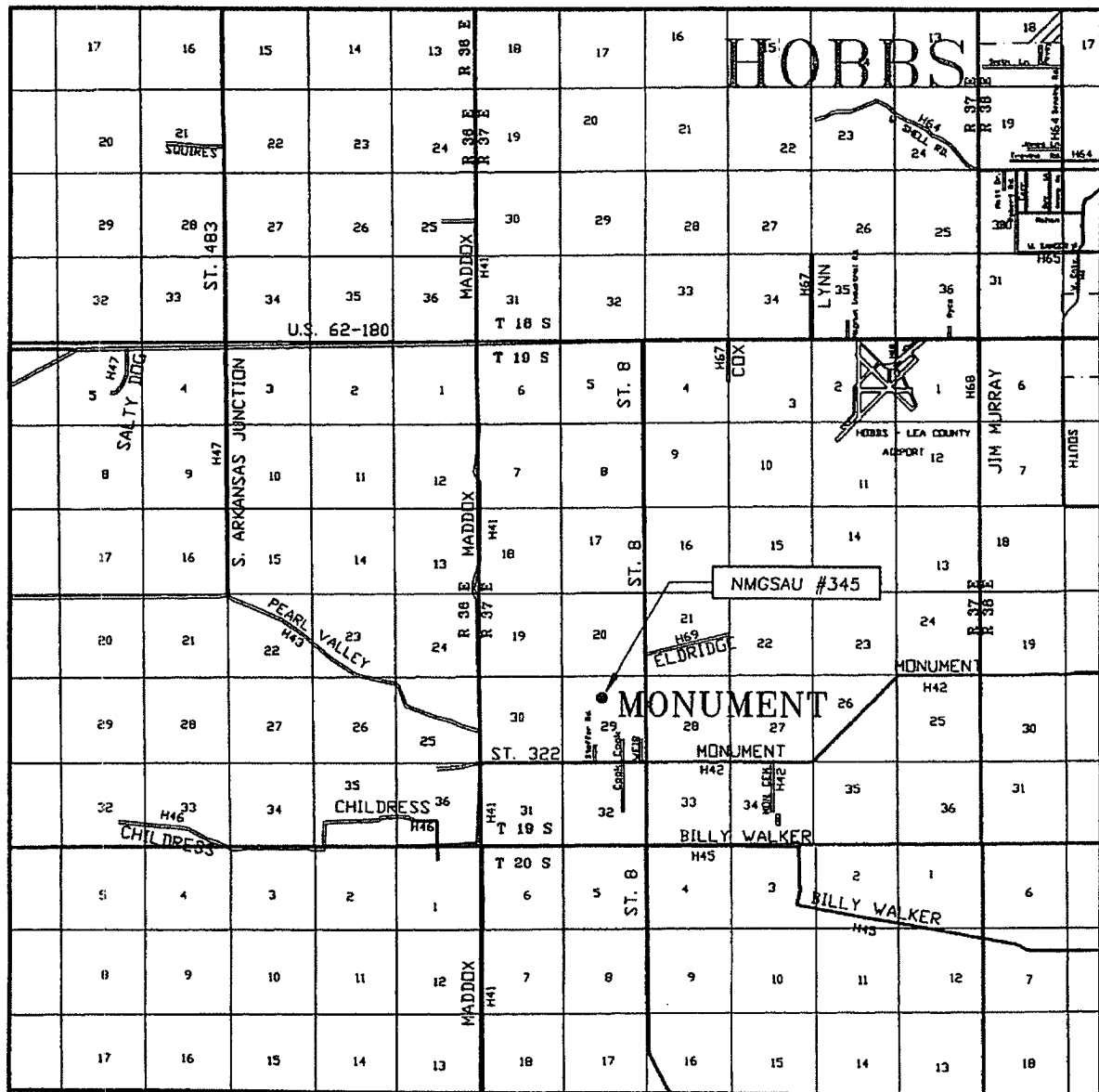

SCALE: 1" = 2 MILES

SEC. 29 TWP. 19-S RGE. 37-E
 SURVEY N.M.P.M.
 COUNTY LEA STATE NEW MEXICO
 DESCRIPTION 1360' FNL & 2510' FWL
 ELEVATION 3616'
 OPERATOR APACHE CORPORATION
 LEASE NMGS AU

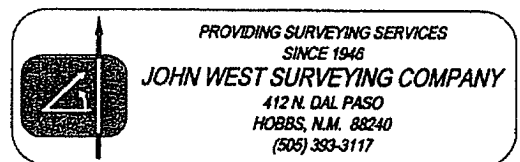

LOCATION VERIFICATION MAP

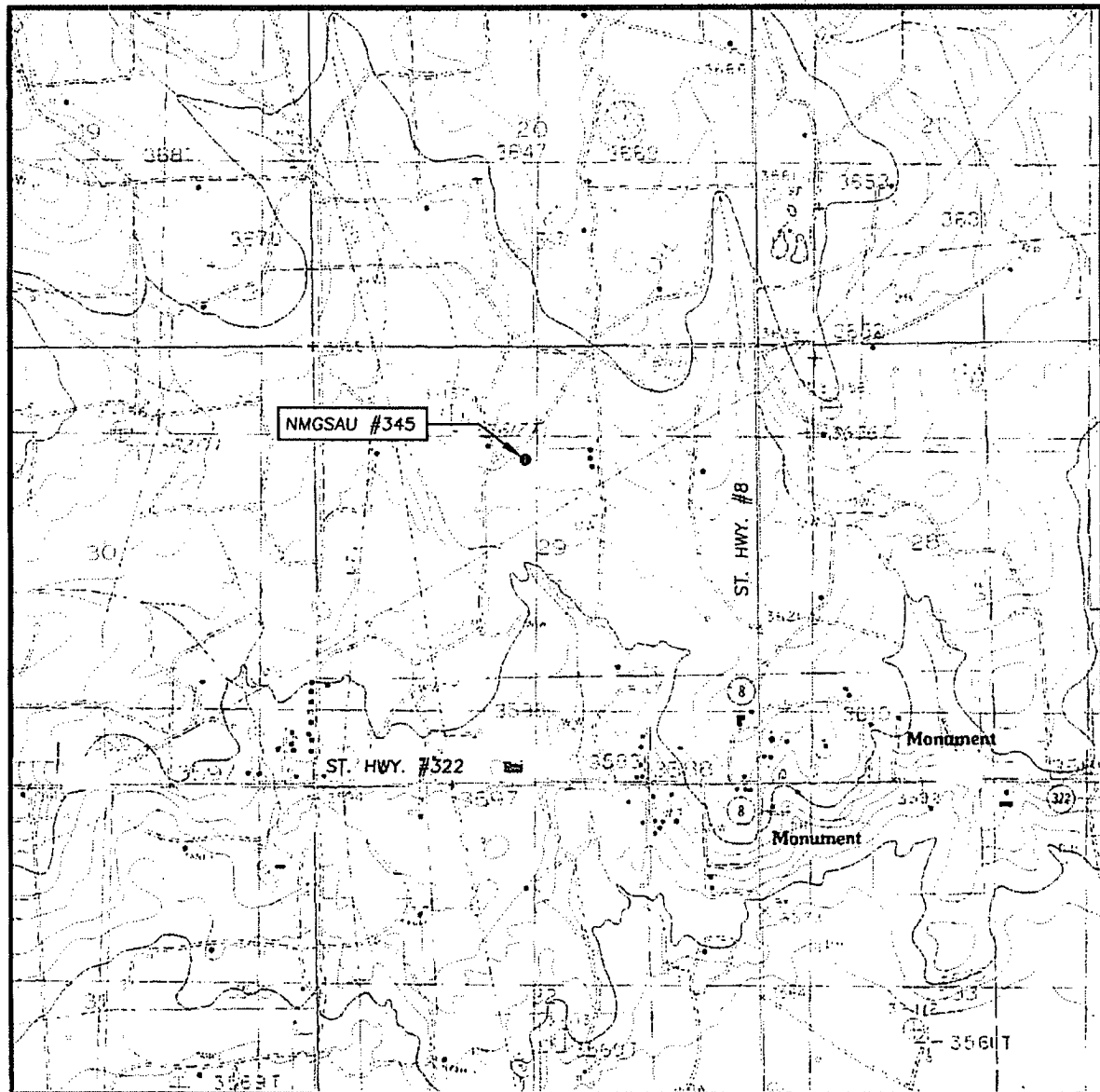

SCALE: 1" = 2000'

SEC. 29 TWP. 19-S RGE. 37-E

SURVEY _____ N.M.P.M.

COUNTY LEA STATE NEW MEXICO

DESCRIPTION 1360' FNL & 2510' FWL

ELEVATION 3616'

OPERATOR APACHE CORPORATION

LEASE NMGS AU

U.S.G.S. TOPOGRAPHIC MAP
MONUMENT NORTH, N.M.

CONTOUR INTERVAL:
MONUMENT NORTH, N.M. - 10'
(WITH 5' SUPPLEMENTARY CONTOUR INTERVALS)
MONUMENT SOUTH, N.M. - 5'

