

UNITED STATES
DEPARTMENT OF THE INTERIOR
BUREAU OF LAND MANAGEMENT

OCD-HOBBS

FORM APPROVED
OMB No. 1004-0135
Expires: January 31, 2004

SUNDRY NOTICES AND REPORTS ON WELLS
Do not use this form for proposals to drill or to re-enter an abandoned well. Use Form 3160-3 (APD) for such proposals.

5. Lease Serial No.	NMNM23006
6. If Indian, Allottee or Tribe Name	
7. If Unit or CA/Agreement, Name and/or No.	
8. Well Name and No.	LPC 31 Federal #3 — WBO #1
9. API Well No.	30-025-37859
10. Field and Pool, or Exploratory Area	Lusk Bone Spring, North
11. County or Parish, State	Lea County, New Mexico

SUBMIT IN TRIPLICATE - Other instructions on reverse side

1. Type of Well <input type="checkbox"/> Oil Well <input checked="" type="checkbox"/> Gas Well <input type="checkbox"/> Other	
2. Name of Operator MarbobEnergy Corporation	
3a. Address P.O. Box 227, Artesia, NM 88211-0227	3b. Phone No. (include area code) 505-748-3303
4. Location of Well (Footage, Sec., T. R., M., or Survey Description) 1825 FNL 1980 FWL, Unit F Sec. 31-T18S-R32E, SE/4NW/4	

12. CHECK APPROPRIATE BOX(ES) TO INDICATE NATURE OF NOTICE, REPORT, OR OTHER DATA

TYPE OF SUBMISSION	TYPE OF ACTION			
<input checked="" type="checkbox"/> Notice of Intent	<input type="checkbox"/> Acidize	<input type="checkbox"/> Deepen	<input type="checkbox"/> Production (Start/Resume)	<input type="checkbox"/> Water Shut-Off
<input type="checkbox"/> Subsequent Report	<input type="checkbox"/> Alter Casing	<input type="checkbox"/> Fracture Treat	<input type="checkbox"/> Reclamation	<input type="checkbox"/> Well Integrity
<input type="checkbox"/> Final Abandonment Notice	<input type="checkbox"/> Casing Repair	<input type="checkbox"/> New Construction	<input type="checkbox"/> Recomplete	<input checked="" type="checkbox"/> Other <u>Collection Facility</u>
	<input type="checkbox"/> Change Plans	<input type="checkbox"/> Plug and Abandon	<input type="checkbox"/> Temporarily Abandon	
	<input type="checkbox"/> Convert to Injection	<input type="checkbox"/> Plug Back	<input type="checkbox"/> Water Disposal	

3. Describe Proposed or Completed Operation (clearly state all pertinent details, including estimated starting date of any proposed work and approximate duration thereof. If the proposal is to deepen directionally or recompleate horizontally, give subsurface locations and measured and true vertical depths of all pertinent markers and zones. Attach the Bond under which the work will be performed or provide the Bond No. on file with BLM/BIA. Required subsequent reports shall be filed within 30 days following completion of the involved operations. If the operation results in a multiple completion or recompleation in a new interval, a Form 3160-4 shall be filed once testing has been completed. Final Abandonment Notices shall be filed only after all requirements, including reclamation, have been completed, and the operator has determined that the site is ready for final inspection.)

Marbob Energy Corporation will be using an existing collection facility that is located on the LPC 31 Federal #1 well pad:

LPC 31 Federal #1
1980' FNL & 2280' FEL
BHL: 1890' FNL & 2432' FEL
Section 31 T-18S R-32E

Exhibit #2 attached

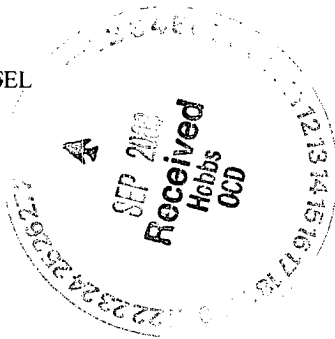

14. I hereby certify that the foregoing is true and correct
Name (Printed/Typed)

Nancy T. Bratcher

Title Land Department

Signature

Nancy T. Bratcher

Date 9/11/06

THIS SPACE FOR FEDERAL OR STATE OFFICE USE

Approved by (Signature)

/s/ Tony J. Herrell

Name /s/ Tony J. Herrell
(Printed Typed)

Title FIELD MANAGER

Conditions of approval, if any, are attached. Approval of this notice does not warrant or certify that the applicant holds legal or equitable title to those rights in the subject lease which would entitle the applicant to conduct operations thereon.

Office
CARLSBAD FIELD OFFICE

Date
SEP 27 2006

Title 18 U.S.C. Section 1001 and Title 43 U.S.C. Section 1212, make it a crime for any person knowingly and willfully to make to any department or agency of the United States any false, fictitious or fraudulent statements or representations as to any matter within its jurisdiction.

(Continued on next page)

LOCATION VERIFICATION MAP

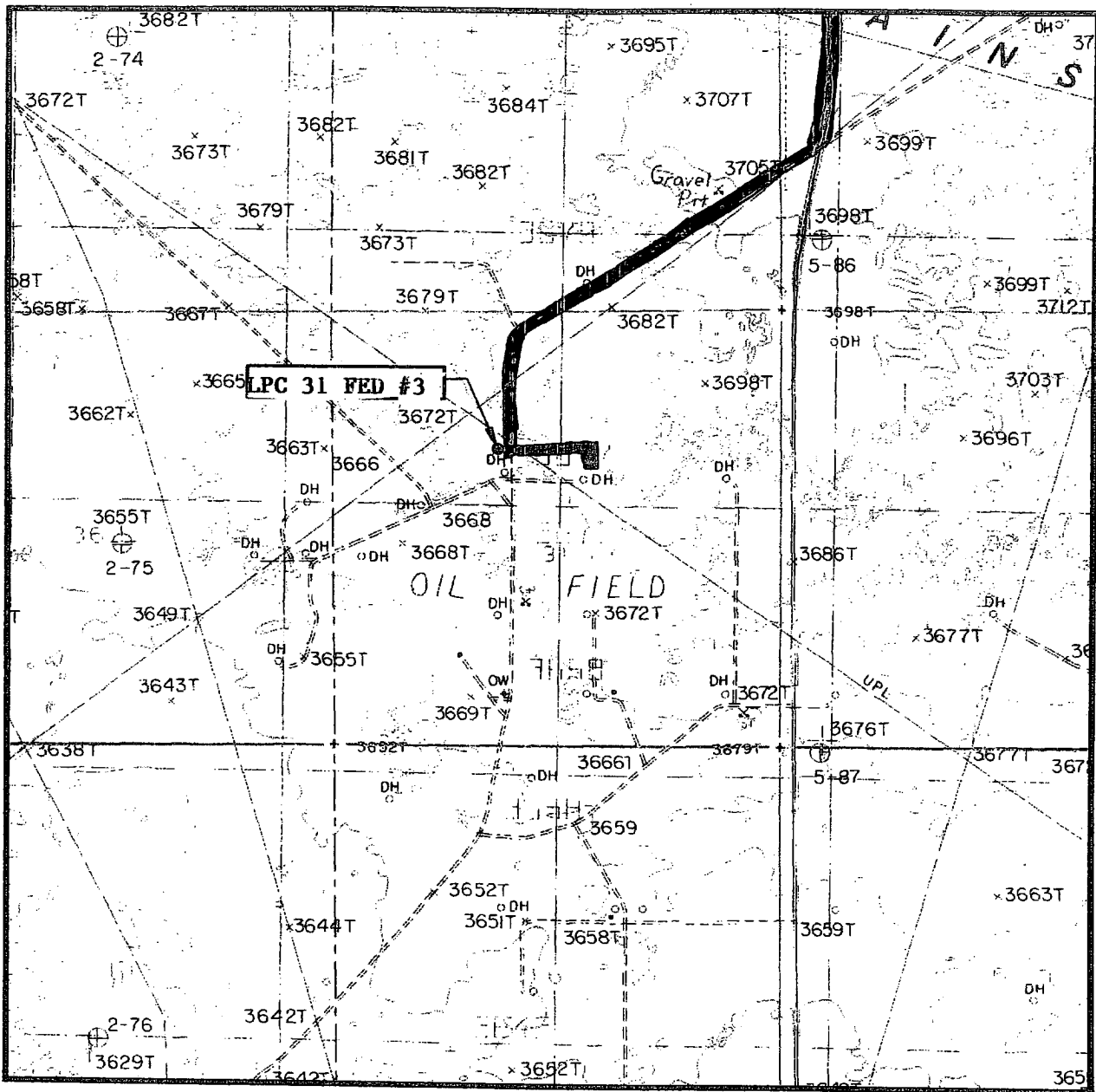

SCALE: 1" = 2000'

CONTOUR INTERVAL:
GREENWOOD LAKE, N.M. - 10'

SEC. 31 TWP. 18-S RGE. 32-E

SURVEY N.M.P.M.

COUNTY LEA

DESCRIPTION 1650' FNL & 1980' FWL

ELEVATION 3681'

OPERATOR MARBOB ENERGY CORPORATION

LEASE LPC 31 FEDERAL #3

U.S.G.S. TOPOGRAPHIC MAP
GREENWOOD LAKE, N.M.

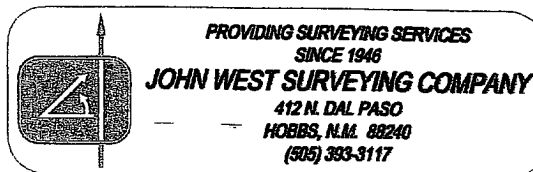

EXHIBIT #2