

District I
1625 N. French Dr., Hobbs, NM 88240
District II
1301 W. Grand Avenue, Artesia, NM 88210
District III
1000 Rio Brazos Road, Aztec, NM 87410
District IV
1220 S. St. Francis Dr., Santa Fe, NM 87505

State of New Mexico
Energy Minerals and Natural Resources

Form C-101
May 27, 2004

Oil Conservation Division
1220 South St. Francis Dr.
Santa Fe, NM 87505

Submit to appropriate District Office

☐ AMENDED REPORT

APPLICATION FOR PERMIT TO DRILL, RE-ENTER, DEEPEN, PLUGBACK, OR ADD A ZONE

1 Operator Name and Address Mewbourne Oil Company Po Box 5270 Hobbs, NM 88240		2 PROGRIN Number A744	
3 Property Code 35282	4 Property Name Osudo South 20 State Com	5 Well No. 1	6 Well Number 30-025-37560
9 Proposed Pool 1 Osudo Strawn, South LG-457		10 Proposed Pool 2	

7 Surface Location

UL or lot no.	Section	Township	Range	Lot Idn	Feet from the	North/South line	Feet from the	East/West line	County
C	20	21S	35E		660'	N	1980'	W	Lea

8 Proposed Bottom Hole Location If Different From Surface

UL or lot no.	Section	Township	Range	Lot Idn	Feet from the	North/South line	Feet from the	East/West line	County

Additional Well Information

11 Work Type Code Plugback - Different Reservoir	12 Well Type Code G	13 Cable/Rotary R	14 Lease Type Code S	15 Ground Level Elevation 3649'
16 Multiple No	17 Proposed Depth PBTD @ 12515' / 11005'	18 Formation Strawn	19 Contractor	20 Spud Date
Depth to Groundwater 50 or more but less than 100' (10 pts)		Distance from nearest fresh water well Less than 1000 from all other wtr sources (1000' or more --0 pts)		Distance from nearest surface water (1000' or more --0 pts)
Pit: Liner: Synthetic <input checked="" type="checkbox"/> 12 miles thick Clay <input type="checkbox"/> Pit Volume: 24000 bbls Drilling Method: Production Closed-Loop System <input type="checkbox"/> Fresh Water <input checked="" type="checkbox"/> Brine <input checked="" type="checkbox"/> Diesel/Oil Based <input type="checkbox"/> Gas/Air <input type="checkbox"/>				

21 Proposed Casing and Cement Program

Hole Size	Casing Size	Casing weight/foot	Setting Depth	Sacks of Cement	Estimated TOC

Describe the proposed program. If this application is to DEEPEN or PLUG BACK, give the data on the present productive zone and proposed new productive zone. Describe the blowout prevention program, if any. Use additional sheets if necessary

Mewbourne Oil Company has completed the above captioned well in the Morrow @ 12124' to 12256'. MOC would like to temporarily isolate the Morrow, Perforate and test Strawn @ 11005' to 11045'. New C102 is attached.

A 7 1/16" - 5000 BOP will be installed on wellhead during all operations. MOC has researched the area for possible H2S problems. No problems were found.

**Permit Expires 1 Year From Approval
Date Unless Drilling Underway**

23 I hereby certify that the information given above is true and complete to the best of my knowledge and belief. I further certify that the drilling pit will be constructed according to NMOCD guidelines ☒ a general permit ☐ or an (attached) alternative OCD-approved plan ☐.

Printed name: Kristi Green
Title: Hobbs Production
E-mail Address: kgreen@mewbourne.com
Date: 10/10/06
Phone: 505-393-5905

OIL CONSERVATION DIVISION	
Approved by: <i>Chris Williams</i>	
Title: DISTRICT SUPERVISOR/GENERAL MANAGER	
Approval Date: OCT 18 2006	Expiration Date:
Conditions of Approval Attached <input type="checkbox"/>	

DISTRICT I
1625 N. French Dr., Hobbs, NM 88240

DISTRICT II
811 South First, Artesia, NM 88210

DISTRICT III
1000 Rio Brazos Rd., Aztec, NM 87410

DISTRICT IV
2040 South Pacheco, Santa Fe, NM 87505

State of New Mexico
Energy, Minerals and Natural Resources Department

Form C-102
Revised March 17, 1999
Instruction on back
Submit to Appropriate District Office
State Lease - 4 Copies
Fee Lease - 3 Copies

OIL CONSERVATION DIVISION
P.O. Box 2088
Santa Fe, New Mexico 87504-2088

☐ AMENDED REPORT

WELL LOCATION AND ACREAGE DEDICATION PLAT

API Number 30-025-37560	Pool Code 97396	Pool Name Osudo strawn, South (Gas)
Property Code 35232	Property Name OSUDO SOUTH "20" STATE COM.	
OCRID No. 14744	Operator Name MEWBOURNE OIL COMPANY	Well Number 1
		Elevation 3649

Surface Location

UL or lot No.	Section	Township	Range	Lot Idn	Feet from the	North/South line	Feet from the	East/West line	County
C	20	21S	35E		660	NORTH	1980	WEST	LEA

Bottom Hole Location If Different From Surface

UL or lot No.	Section	Township	Range	Lot Idn	Feet from the	North/South line	Feet from the	East/West line	County

Dedicated Acres	Joint or Infill	Consolidation Code	Order No.
320			

**NO ALLOWABLE WILL BE ASSIGNED TO THIS COMPLETION UNTIL ALL INTERESTS HAVE BEEN CONSOLIDATED
OR A NON-STANDARD UNIT HAS BEEN APPROVED BY THE DIVISION**

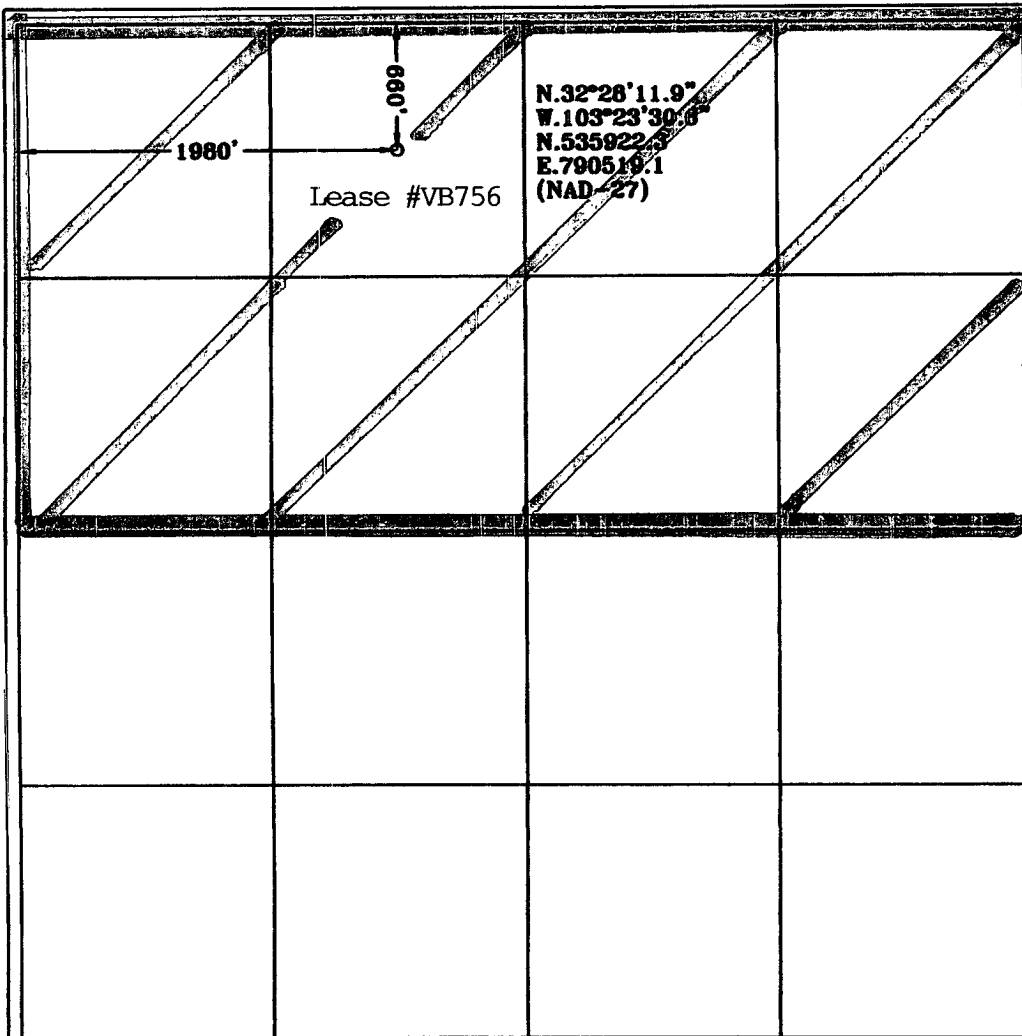

OPERATOR CERTIFICATION

I hereby certify that the information contained herein is true and complete to the best of my knowledge and belief.

Kristi Green

Signature

Kristi Green
Printed Name
Hobbs Regulatory

Title
10/11/06

Date

SURVEYOR CERTIFICATION

I hereby certify that the well location shown on this plat was plotted from field notes of actual surveys made by me or under my supervision, and that the same is true and correct to the best of my belief.

8/22/2005

Date Surveyed

Signature & Seal of
Professional Surveyor

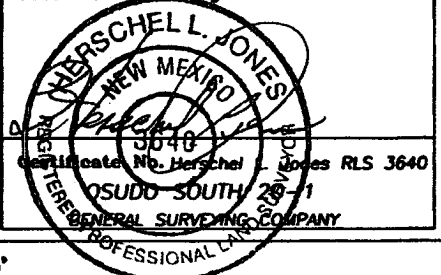

0 330' 660' 990' 1650' 1980' 2310' 2310' 1980' 1650' 990' 660' 330' 0'