

UNITED STATES
DEPARTMENT OF THE INTERIOR
BUREAU OF LAND MANAGEMENT

OCD-HOBBS

FORM APPROVED
OMB No. 1004-0135
Expires July 31, 1996

SUNDRY NOTICES AND REPORTS ON WELLS
**Do not use this form for proposals to drill or to re-enter an
abandoned well. Use form 3160-3 (APD) for such proposals.**

SUBMIT IN TRIPLICATE - Other instructions on reverse side

1. Type of Well
☒ Oil Well ☐ Gas Well ☐ Other

2. Name of Operator
Cimarex Energy Co. of Colorado

3a. Address
PO Box 140907; Irving, TX 75014-0907

3b. Phone No. (include area code)
972-401-3111

4. Location of Well (Footage, Sec., T., R., M., or Survey Description)
Section 18-T19S-R34E
See Locations Below...

5. Lease Serial No.

NM-3622

6. If Indian, Allottee or Tribe Name

7. If Unit or CA/Agreement, Name and/or No.

8. Well Name and No.

See below

9. API Well No.

See below.

10. Field and Pool, or Exploratory Area

Tonto; 7 Rivers

11. County or Parish, State

Lea County, NM

12. CHECK APPROPRIATE BOX(ES) TO INDICATE NATURE OF NOTICE, REPORT, OR OTHER DATA

TYPE OF SUBMISSION

TYPE OF ACTION

☒ Notice of Intent

☐ Subsequent Report

☐ Final Abandonment Notice

☐ Acidize

☐ Alter Casing

☐ Casing Repair

☐ Change Plans

☐ Convert to Injection

☐ Deepen

☐ Fracture Treat

☐ New Construction

☐ Plug and Abandon

☐ Plug Back

☐ Production (Start/Resume)

☐ Reclamation

☐ Recomplete

☐ Temporarily Abandon

☐ Water Disposal

☐ Water Shut-Off

☐ Well Integrity

☒ Other Lay on-lease

Flowline

13. Describe Proposed or Completed Operation (clearly state all pertinent details, included estimated starting date of any proposed work and approximate duration thereof.
If the proposal is to deepen directionally or recompleat horizontally, give subsurface locations and measured and true vertical depths of all pertinent markers and zones.
Attach the bond under which the work will be performed or provide the Bond No. on file with BLM/BIA. Required subsequent reports shall be filed within 30 days following completion of the involved operations. If the operation results in a multiple completion or recompleat in a new interval, a Form 3160-4 shall be filed once testing has been completed. Final Abandonment Notices shall be filed only after all requirements, including reclamation, have been completed, and the operator has determined that the site is ready for final inspection.)

Lay on-lease 2 3/8" J-55 4.7# steel flowline from our Scout 18 Federal No. 1, 2, 3, 5, and 6 wells to our Scout 18 Federal No. 4 Central Tank Battery as shown on attached topo. The flowline will be laid on the surface adjacent to existing lease access roads in accordance with the approved Plan of Development for the lease. The line will be hydrostatically tested to 2000 psi and have a working pressure of 40 - 60 psi. Production from all wells will be sold at the Scout 18 Federal No. 4 tank battery and allocated back to the individual wells based on periodic well tests.

Scout 18 Federal No. 1	30-025-37890	1800' FSL & 410' FWL
Scout 18 Federal No. 2	30-025-37892	710' FSL & 660' FWL
Scout 18 Federal No. 3	30-025-37893	810' FSL & 1830' FWL
Scout 18 Federal No. 5	30-025-37881	660' FSL & 2030' FEL
Scout 18 Federal No. 6	30-025-37884	660' FSL & 660' FEL

14. I hereby certify that the foregoing is true and correct
Name (Printed/Typed)

Zeno Farris

Signature

Zeno Farris

Title

Manager, Operations Administration

Date

October 6, 2006

THIS SPACE FOR FEDERAL OR STATE OFFICE USE

Approved by

/S/ James Stovall

FIELD MANAGER

Date

OCT 23 2006

Conditions of Approval, if any, are attached. Approval of this notice does not warrant or certify that the applicant holds legal or equitable title to those rights in the subject lease which would entitle the applicant to conduct operations thereon.

Office

CARLSBAD FIELD OFFICE

Title 18 U.S.C. Section 1001, makes it a crime for any person knowingly and willfully to make to any department or agency of the United States any false, fictitious or fraudulent statements or representations as to any matter within its jurisdiction.

(Instructions on reverse)

GWW

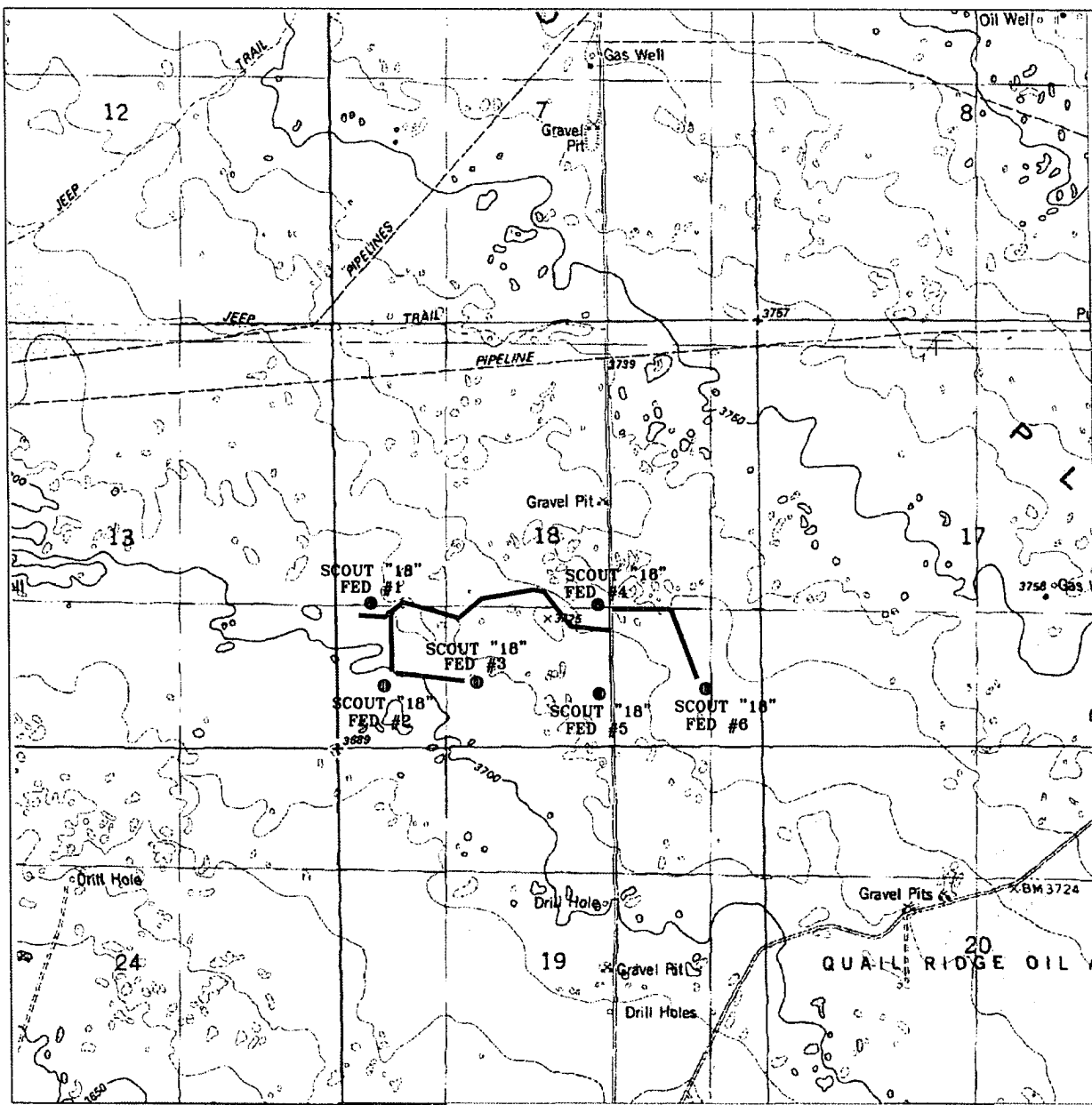

PIPELINE WELLS - PROPOSED ROAD PLAT

Section 18 Township 19 South, Range 34 East,
N.M.P.M., LEA County, New Mexico.

basin
surveys
focused on excellence
in the oilfield

P.O. Box 1786
1120 N. West County Rd.
Hobbs, New Mexico 88241
(505) 393-7316 - Office
(505) 392-3074 - Fax
basinsurveys.com

W.O. Number: ROADPLAT2

Survey Date: VARIES

Scale: 1" = 2000'

Date: 10-06-2006

CIMAREX
ENERGY CO.
OF COLORADO