

UNITED STATES  
DEPARTMENT OF THE INTERIOR  
BUREAU OF LAND MANAGEMENT

APPLICATION FOR PERMIT TO DRILL OR REENTER

AD-07-55  
FORM APPROVED  
OMB No. 1004-0137  
Expires March 31, 2007

OCD HOBBS

Received  
Hobbs  
OCD

5. Lease Serial No.  
NMLC-068035  
If Indian, Allottee or Tribe Name  
If Unit or CA Agreement, Name and No.  
8. Lease Name and Well No. JCT FEDERAL 18  
9. API Well No. 30-018-025-38178  
10. Field and Pool, or Exploratory  
SAWYER (DEVONIAN) 55290  
11. Sec., T. R. M. or Blk. and Survey or Area  
SEC. 18, T9S, R38E

1a. Type of work: ☒ DRILL ☐ REENTER  
1b. Type of Well: ☒ Oil Well ☐ Gas Well ☐ Other ☒ Single Zone ☐ Multiple Zone  
2. Name of Operator  
THOMPSON, J. CLEO  
3a. Address P.O. BOX 12577  
ODESSA, TX 79768-2577  
3b. Phone No (include area code)  
(432)550-8887  
4. Location of Well (Report location clearly and in accordance with any State requirements. \*)  
At surface 542' FNL & 2100' FWL  
At proposed prod. zone Unit C  
14. Distance in miles and direction from nearest town or post office\*  
23 MILES NE OF TATUM  
15. Distance from proposed\* location to nearest property or lease line, ft.  
(Also to nearest drig. unit line, if any) 542'  
16. No. of acres in lease 160  
17. Spacing Unit dedicated to this well 80  
18. Distance from proposed location\* to nearest well, drilling, completed, applied for, on this lease, ft.  
19. Proposed Depth 12,000  
20. BLM/BIA Bond No. on file NM0348  
21. Elevations (Show whether DF, KDB, RT, GL, etc.) 3977'  
22. Approximate date work will start\* 11/10/2006  
23. Estimated duration 30 DAYS

24. Attachments

The following, completed in accordance with the requirements of Onshore Oil and Gas Order No.1, shall be attached to this form:

- Well plat certified by a registered surveyor.
- A Drilling Plan.
- A Surface Use Plan (if the location is on National Forest System Lands, the SUPO shall be filed with the appropriate Forest Service Office).
- Bond to cover the operations unless covered by an existing bond on file (see Item 20 above).
- Operator certification
- Such other site specific information and/or plans as may be required by the authorized officer.

25. Signature J. Stevens Name (Printed/Typed) JIM STEVENS Date 10/20/2006  
Title OPERATIONS MANAGER  
Approved by (Signature) James Stovall Name (Printed/Typed) Per DP Date 11/07/06  
Title ACTING FIELD MANAGER Office CARLSBAD FIELD OFFICE

Application approval does not warrant or certify that the applicant holds legal or equitable title to those rights in the subject lease which would entitle the applicant to conduct operations thereon.  
Conditions of approval, if any, are attached.

APPROVAL FOR 1 YEAR

Title 18 U.S.C. Section 1001 and Title 43 U.S.C. Section 1212, make it a crime for any person knowingly and willfully to make to any department or agency of the United States any false, fictitious or fraudulent statements or representations as to any matter within its jurisdiction.

\*(Instructions on page 2)

Witness Surface Casing

SEE ATTACHED FOR  
CONDITIONS OF APPROVAL

APPROVAL SUBJECT TO  
GENERAL REQUIREMENTS  
AND SPECIAL STIPULATIONS  
ATTACHED

# SELF-CERTIFICATION STATEMENT FROM LESSEE/OPERATOR

## SURFACE OWNER IDENTIFICATION

Federal or Indian Lease No. NMLC- 068035

I hereby certify to the Authorized Officer of the Bureau of Land Management that I have reached one of the following agreements with the Surface Owner; or after failure of my good-faith effort to come to an agreement of any kind with the Surface Owner, have provided a bond and will provide evidence of service of such bond to the Surface Owner:

- 1) \_\_\_\_\_ I have signed access agreement to enter the leased lands.
- 2) \_\_\_\_\_ I have a signed waiver from the surface owner.
- 3) X I have entered into an agreement regarding compensation to the surface owner for damages for loss of crops and tangible improvements.
- 4) \_\_\_\_\_ because I have been unable to reach 1), 2), or 3) with the surface owner, I have obtained a bond to cover loss of crops and damages to tangible improvements and served the surface owner with a copy of the bond.

Surface owner information: (if available after diligent effort)

Surface Owner Name: David Bilbrey

Surface Owner Address: HC 65 Box 55, <sup>Crossroads</sup> ~~Chambers~~, NM 88114

Surface Owner Phone Number: <sup>cell #</sup> (505) 369-5599, <sup>Home</sup> (505) 398-6226 (cell #)

Signed this 10<sup>th</sup> day of OCTOBER, 2006

J. Cleo Thompson, operator

(Name of lessee/operator)

J. E. STEVENS, OAS Manager

I (Surface Owner) accept X do not accept \_\_\_\_\_ the leases or operator -s  
Surface Owner Agreement under 1, 2, or 3 above.

Signed this 11<sup>th</sup> day of OCTOBER, 2006

David A. Bilbrey

(Signature of Surface Owner if an Agreement has been reached)

Attachment 1-1



District I  
1625 N. French Dr., Hobbs NM 88240  
District II  
1301 W. Grand Avenue, Artesia, NM 88210  
District III  
1000 Rio Brazos Rd., Aztec, NM 87410  
District IV  
1220 S. St. Francis Dr., Santa Fe, NM 87505

State of New Mexico  
Energy, Minerals & Natural Resources Department  
OIL CONSERVATION DIVISION  
1220 South St. Francis Dr.  
Santa Fe, NM 87505

Form C-102

Revised June 10, 2003

Submit to Appropriate District Office  
State Lease - 4 Copies  
Fee Lease - 3 Copies  
AMENDED REPORT

WELL LOCATION AND ACREAGE DEDICATION PLAT

<sup>1</sup> API Number 30-025-38178	<sup>2</sup> Pool Code 55290	<sup>3</sup> Pool Name Sawyer Devon
<sup>4</sup> Property Code 36147	<sup>5</sup> Property Name Federal 18	<sup>6</sup> Well Number 1
<sup>7</sup> GRID No. 11161	<sup>8</sup> Operator Name J. Cleo Thompson	<sup>9</sup> Elevation 3977'



<sup>10</sup>Surface Location

UL or lot no.	Section	Township	Range	Lot Idn	Feet from the	North/South line	Feet from the	East/West line	County
C	18	9 S	38 E		542'	North	2100'	West	Lea

<sup>11</sup>Bottom Hole Location If Different From Surface

UL or lot no.	Section	Township	Range	Lot Idn	Feet from the	North/South line	Feet from the	East/West line	County
<sup>12</sup> Dedicated Acres 40	<sup>13</sup> Joint or Infill	<sup>14</sup> Consolidation Code	<sup>15</sup> Order No.						

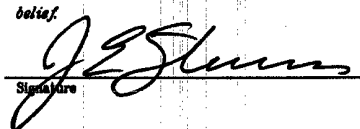
NO ALLOWABLE WILL BE ASSIGNED TO THIS COMPLETION UNTIL ALL INTERESTS HAVE BEEN CONSOLIDATED OR A NON-STANDARD UNIT HAS BEEN APPROVED BY THE DIVISION

<div>16</div> <div>2100'</div> <div>542'</div> <div>Federal 18-1 Elev. 3977' NAD 27 NM East X= 878862 Y= 926221</div>				<div><sup>17</sup>OPERATOR CERTIFICATION</div> <div>I hereby certify that the information contained herein is true and complete to the best of my knowledge and belief.</div> <div></div> <div>Signature</div> <div>Jim Stevens</div> <div>Printed Name</div> <div>Operations Manager</div> <div>jstevens@jcleo.com</div> <div>Title and E-mail Address</div> <div>October 10, 2006</div> <div>Date</div>	
				<div><sup>18</sup>SURVEYOR CERTIFICATION</div> <div>I hereby certify that the well location shown on this plat was plotted from field notes of actual surveys made by me or under my supervision, and that the same is true and correct to the best of my belief.</div> <div>9-21-2006</div> <div>Date of Survey</div> <div>Signature and Seal of Professional Land Surveyor</div> <div></div> <div>Certificate Number</div>	

23 Miles NE of Tatum, New Mexico.

File No. A-3180.DWG

**DRILLING PROGRAM**  
**J. Cleo Thompson & James Cleo Thompson, Jr., L.P.**  
**JCT Federal 18, Well #1**  
**542' FNL & 2100' FWL, Sec. 18, T9S, R38E**  
**Lea County, New Mexico**

In accordance with form 3160 and our application to drill, please find the following items as included in the proposed drilling program.

1. Estimated tops of geological markers:

Rustler:	2,324'
Yates:	2,869'
Seven Rivers:	3,067'
Queen:	3,591'
San Andres:	4,149'
Glorieta	5,554'
Tubb:	6,889'
ABO:	7,624'
Wolfcamp:	8,812'
Base Three Brothers	9,321'
Cisco:	9,392'
Bough C:	9,466'
Canyon:	9,874'
Strawn:	10,424'
Atoka:	11,154'
Mississippi	11,362'
Woodford:	11,504'
Silurian:	11,606'
TD:	12,000'

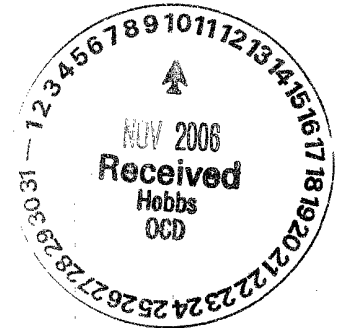

2. Estimated depths to water, oil, or gas formations.

Water: Surface water between 400' – 1400'  
Oil: Possible in the Delaware below 5000'  
Gas: Possible in the San Andres below 4,500' & the Wolfcamp, Strawn, Atoka and Morrow.

3. Proposed Casing Program:

<u>Hole Size</u>	<u>Setting Depth</u>	<u>Csg Size &amp; Weight</u>	<u>Grade/Joint</u>
17 1/2"	0' to 500'	13 3/8", 48# per foot	J-55/ ST&C
12 1/4"	0' to 5100'	9 5/8", 42# per foot 40#	J-55/ ST&C
8 3/4"	0' to 1,000'	5 1/2", 17# per foot	P-110/ LTC
8 3/4"	1,000' to 10,000'	5 1/2", 17# per foot	N-80/ LTC
8 3/4"	10,000' to 11,600'	5 1/2", 17# per foot	P-110/ LTC

**DRILLING PROGRAM**  
**J. Cleo Thompson & James Cleo Thompson, Jr., L.P.**  
**JCT Federal 18, Well #1**

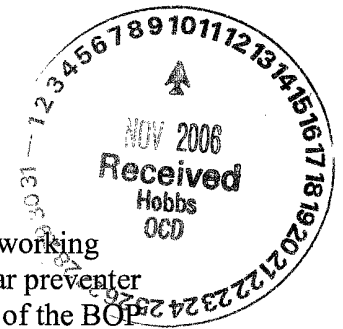

**4. Pressure Control Equipment:**

The blowout preventer equipment (BOP) will be a 12", 5,000 psi working pressure stack with both blind and pipe rams. In addition a annular preventer rated to 5,000 psi will be installed on top of the stack. A diagram of the BOP stack and choke manifold is attached. All BOP and accessory equipment will be tested according to Onshore order #2 before drilling out with the 8 3/4" hole and tested weekly.

**5. Proposed Mud Program:**

Mud Program		Mud Weight	Viscosity	Waterloss
0' to 500'	Fresh Wtr	8.6 to 9.2 ppg	34 to 36	NC
500' to 2,100'	Fresh Wtr	8.4 to 8.5 ppg	28 to 29	NC
2,100' to 9,600'	Cut Brine	9.4 to 9.7 ppg	28 to 29	NC
9,600' to 11,600'	Brine	9.4 to 9.7 ppg	34 to 40	10 to 6 cc

**6. Proposed Cementing Program:**

**13 3/8" Surface:** 180 sxs "H" + 10% A10 + 10# LCM + 1/4 # Celloflake + 1% CaCl  
Lead cement 228 sxs 35:65:6 "C" + 2% CaCl + 1/4 # Cello + 5# LCM 1  
Tail cement 200 sxs "C" + 2% CaCl. TOC at surface.

**9 5/8" Int:** 360 sxs H + 10% A-10 + 10# LCM-1 + 1% CaCl + 1/4 # CelloFlake  
Lead Cement 800 sxs 50:50:10 + 5% Salt + 5# LCM-1 + 1/4 # CelloFlake  
Tail Cement 200 sxs "C" + 2% CaCl. TOC at surface.

**5 1/2" Prod:** Two stage cement job w/ DV tool at +/- 7,000'  
1<sup>st</sup> stage - Pump 725 sxs 15-61-11 "H" + 6% FL 52 + 5% Salt + 3# LCM.  
2<sup>nd</sup> stage - pump 800 sxs 35:65:6 + 3% FL-52 + 3% SMS + 2% KCL + 1/4 # Cello Flake.  
Tail Cement pump 750 sxs C + 1% FL-62 + 3% CD-32 + .2% SMS.

**7. Auxiliary Equipment:**

Blowout preventer, gas detector, kelly cock and stabbing valve.

**8. Testing, Logging and Coring Program:**

Drill Stem Tests: As deemed necessary in the Devonian  
Logging: Platform Express TD to Intermediate Csg  
(Possible FMI & Repeat Formation Tester)

**DRILLING PROGRAM**  
**J. Cleo Thompson & James Cleo Thompson, Jr., L.P.**  
**JCT Federal 18, Well #1**

Coring:                      No coring anticipated

9.    No abnormal pressures or temperatures are anticipated. In the event abnormal pressures are encountered the proposed mud program will be modified to safely handle the increased pressures. The estimated BHP is estimated to be 5100 psi with a temperature of 160 degrees.
10.   H2S:        None expected
11.   Anticipated Start Date:            **November 10, 2006**  
      Anticipated Drilling Time:        Approximately 30 to 40 days

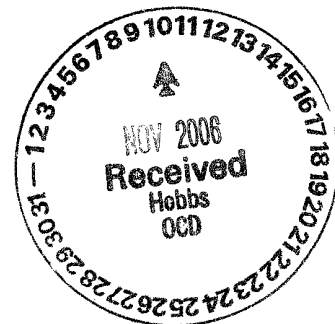

# EXHIBIT "D"

J. Cleo Thompson & James Cleo Thompson, Jr., L.P.

JCT Federal 18, Well No. 1

Located 542' FNL & 2100' FWL,  
Section 18, T-9-S, R-38-E, Lea County, NM

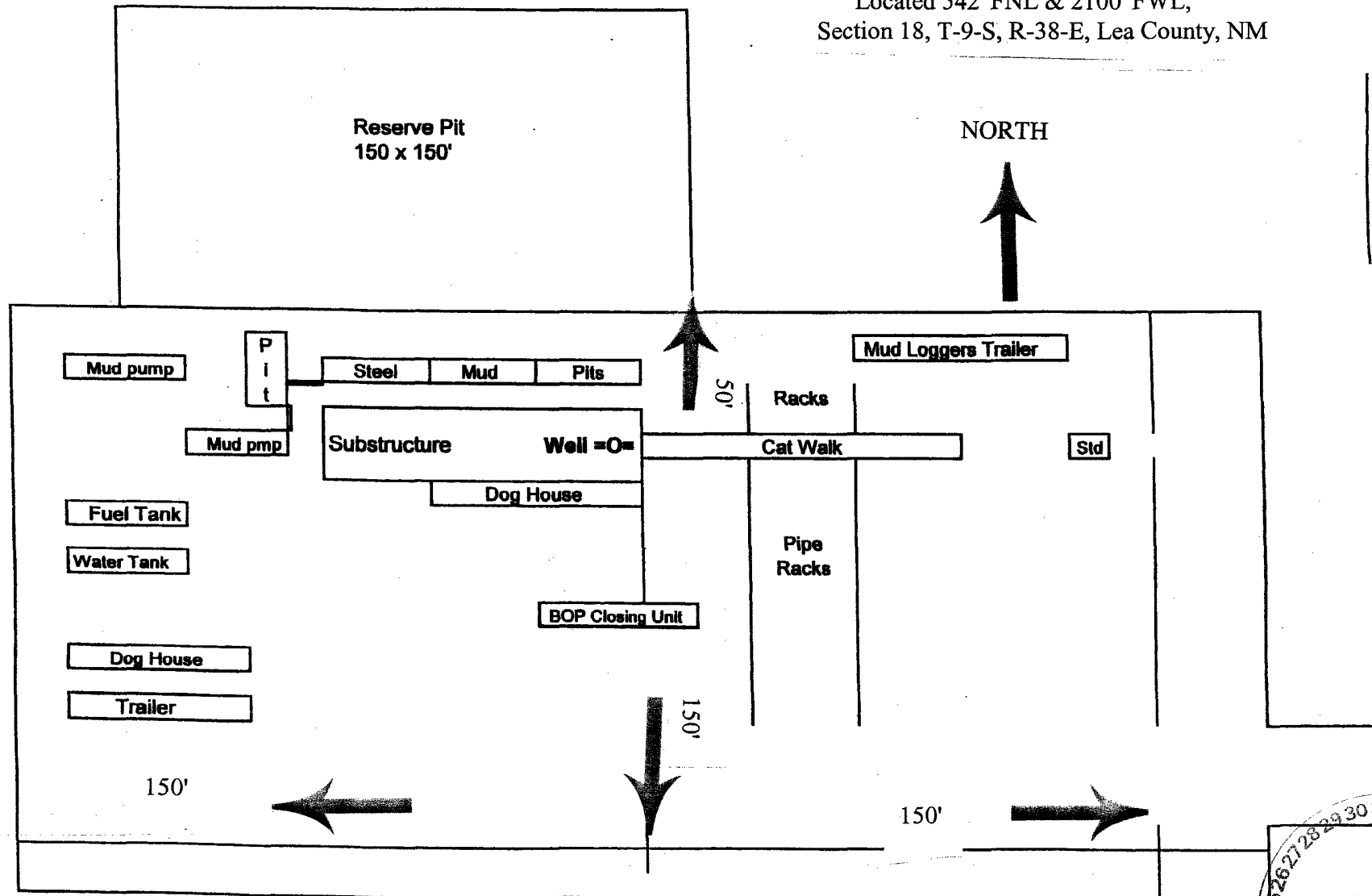

Rig Location Schematic

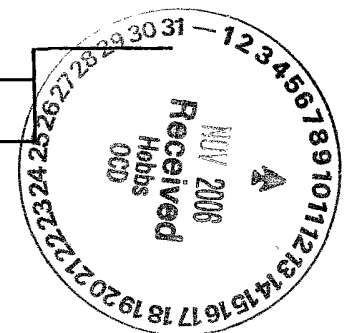

BOP Schematic for  
12 1/4" Hole

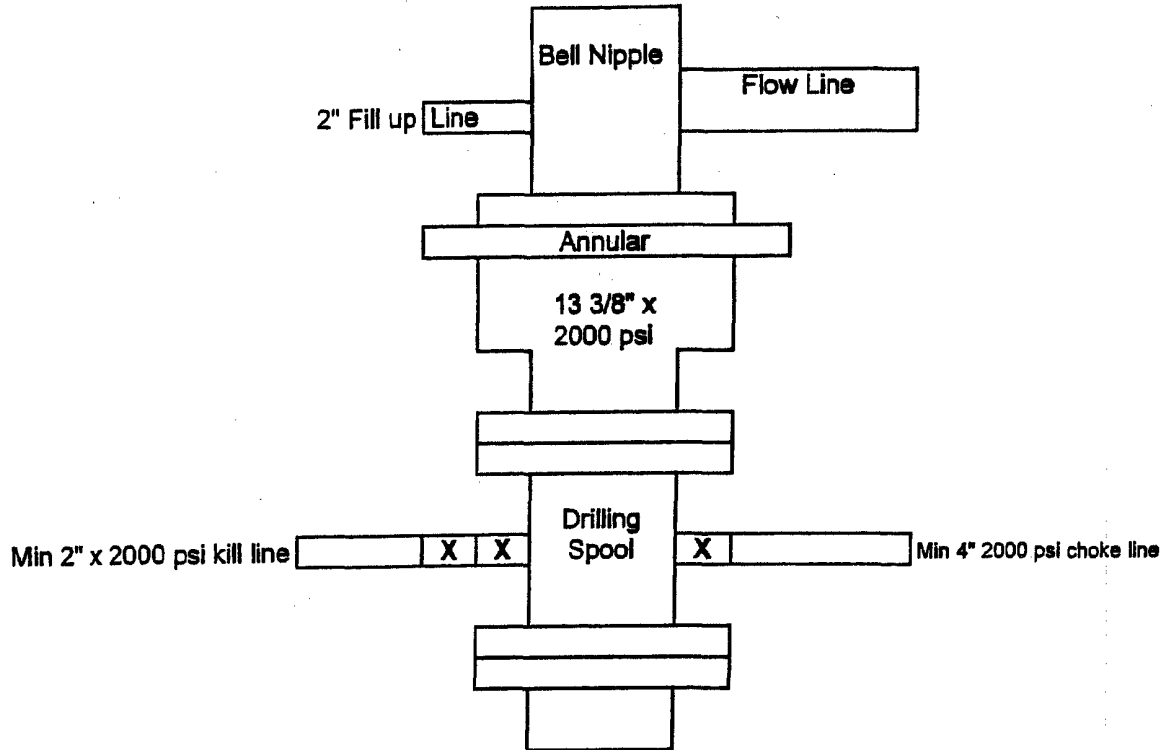

Exhibit #2





# 5000 PSI WORKING PRESSURE BLOWOUT PREVENTER STACK

## EXHIBIT C-1

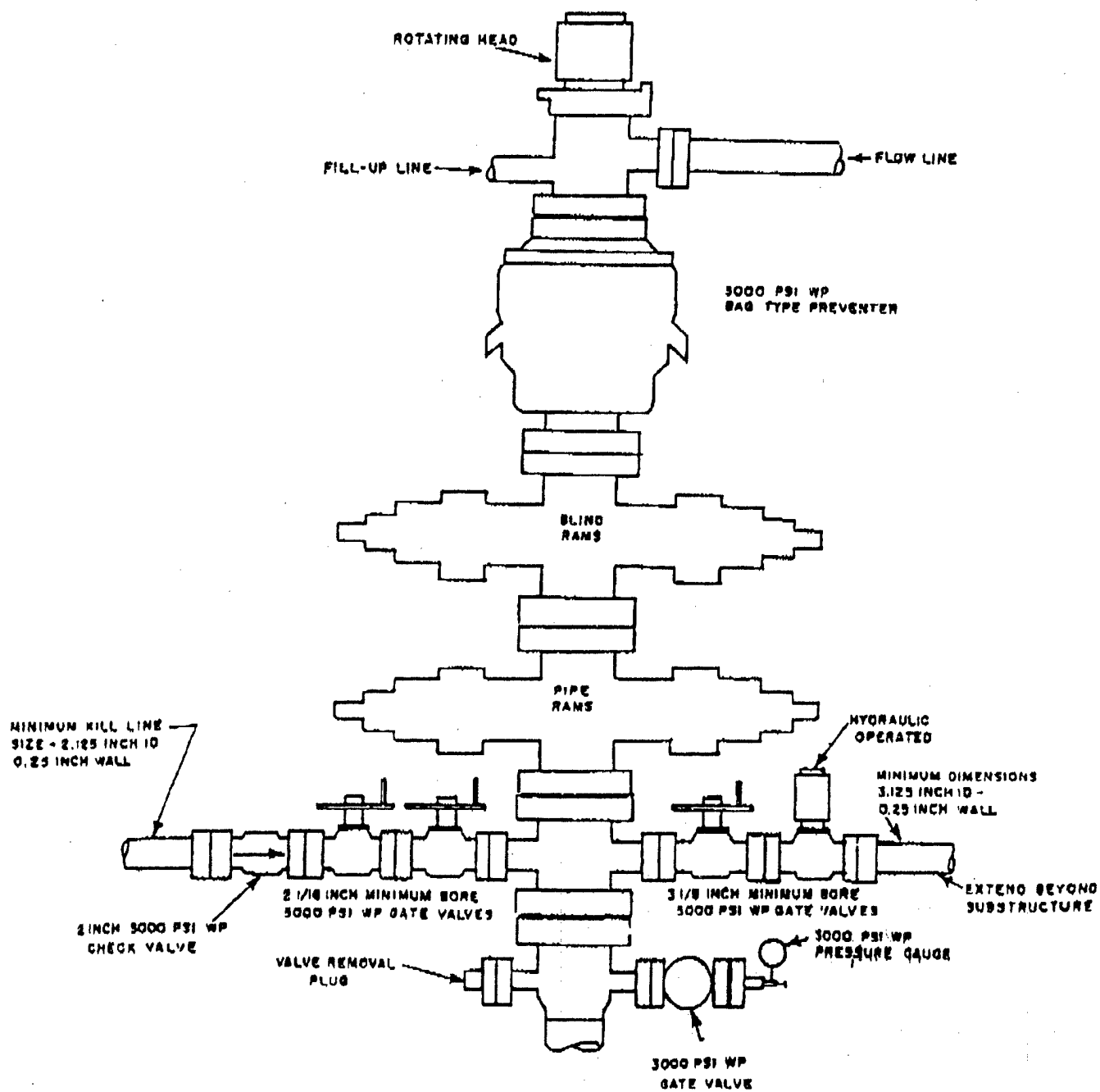
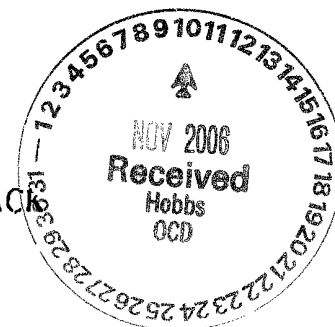

## **MULTI POINT SURFACE USE AND OPERATIONS PLAN**

**J. CLEO THOMPSON & JAMES CLEO THOMPSON, JR., L.P.**

**JCT Federal 18, Well No. 1**

**542' FNL & 2100' FWL, Sec. 18-T9S-R38E**

**Lea County, New Mexico**

**Lease No.: LC-068035**

This plan is submitted with the Application for Permit to drill the above described well. The purpose of the plan is to describe the location of the proposed well; the proposed construction activities and operations plan to be followed in rehabilitating the surface and environmental effects associated with the operations.

### **1. EXISTING ROADS:**

- A. Exhibit "A" is a portion of a Topo Map showing the location of the proposed well as staked. The well location is approximately 9 miles east of Crossroads, NM. There is an existing caliche road going to this location.
- B. Directions: Travel South from Bledsoe on NM 125 3 miles. Turn west on road 508 ½ mile to cattle guard on left (South). Travel 500 feet South to location.

### **2. PLANNED ACCESS ROAD**

- A. Length and Width: The proposed access road will be approximately 500 feet long. The proposed existing roads are color coded on Exhibits "A" of which only 75' will be new road.
- B. Construction: The proposed and existing road will be constructed and repaired by grading and topping with compacted caliche. The surface will properly drained.
- C. Turnouts: None
- D. Culverts: None
- E. Cuts and Fills: None required.
- F. Gates, Cattle guards: Use existing cattle guard
- G. Off lease right of way: None required.

### **3. LOCATION OF EXISTING WELLS:**

- A. Existing wells are shown on Exhibit "C".



**J. CLEO THOMPSON & JAMES CLEO THOMPSON, JR., L.P.**  
**JCT Federal 18, Well No. 1**

**4. LOCATION OF EXISTING AND/OR PROPOSED FACILITIES:**

- A. J. Cleo Thompson and James Cleo Thompson Jr., L.P. has no existing wells or facilities.
- B. If the well proves to be commercial, the necessary production facilities, gas separation-process equipment and tank battery, if required, will be installed on the drilling pad.

**5. LOCATION AND TYPE OF WATER SUPPLY:**

- A. It is planned to drill the proposed well with fresh water that will be obtained from private or commercial sources and will be transported over the existing and proposed access roads.

**6. SOURCE OF CONSTRUCTION MATERIALS:**

- A. Caliche for surfacing the proposed access road and well site pad will be obtained from the location, if available, or from a commercial site. No surface materials will be disturbed except those necessary for actual grading and leveling of the drill site and access road.

**7. METHODS OF HANDLING WASTE DISPOSAL:**

- B. Drill cuttings will be disposed of in the reserve pits.
- C. Drilling fluids will be allowed to evaporate in the reserve pits until the pits are dry.
- D. All pits will be fenced with normal fencing materials to prevent livestock from entering the area.
- E. Water produced during operations will be collected in tanks until hauled to an approved disposal system, or a separate disposal application will be submitted to the BLM for approval.
- F. Oil produced during operations will be stored in tanks until sold.
- G. Current laws and regulations pertaining to the disposal of human waste will be complied with.

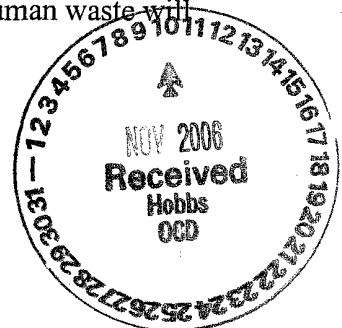

**J. CLEO THOMPSON & JAMES CLEO THOMPSON, JR., L.P.**  
**JCT Federal 18, Well No. 1**

- H. Trash, waste paper, garbage and junk will be contained in trash bins to prevent scattering by the wind and will be removed for deposit in an approved sanitary landfill within 30 days after finishing drilling and/or completion operations.

**8. ANCILLARY FACILITIES:**

- A. None Required

**9. WELL SITE LAYOUT:**

- A. Exhibit "D" shows the relative location and dimensions of the well pad, reserve pits, and major rig components. The pad and pit area has been staked, 400' X 400'.
- B. Mat size: 285' X 192', plus 150' X 125' reserve pits on the North.
- C. Cut and Fill: None required
- D. The surface will be topped with compacted caliche and the reserve pits will be plastic lined.

**10. PLANS FOR RESTORATION OF THE SURFACE:**

- A. After completion of drilling and /or completion operations, all equipment and other material not required for operations will be removed. Pits will be filled and the location cleaned of all trash and junk to leave the well site in an aesthetically pleasing a condition as possible.
- B. Any unguarded pits containing fluids will be fenced until are filled.
- C. If the proposed well is non-productive, all rehabilitation and/or vegetation requirements of the Bureau of Land Management will be complied with and will be accomplished as expeditiously as possible. All pits will be filled and leveled as soon as they are dry enough to be worked.

**11. OTHER INFORMATION**

- A. Topography: The proposed well site and access road are located on flat plains East of crossroads.

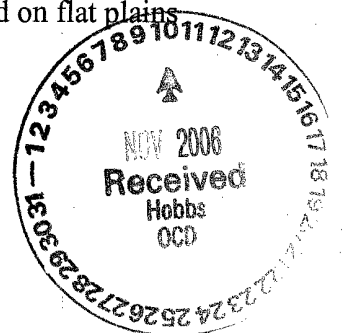

**J. CLEO THOMPSON & JAMES CLEO THOMPSON, JR., L.P.  
JCT Federal 18, Well No. 1**

- B. Soil: The topsoil at the well site is a moderately red dirt and caliche.
- C. Flora and Fauna: The vegetation cover has a very sparse grass cover, with the primary cover beings plants of mesquite, yucca, broomweed, catclaw, creosote bush, cacti and miscellaneous weeds and wildflowers. The wildlife consists of rabbits, coyotes, antelope, deer, rattlesnakes, lizards, dove, quail, and other wildlife typical of the semi-arid desert land.
- D. Ponds and Streams: None.
- E. Residences and Other Structures: None in the immediate vicinity.
- F. Land use: Cattle grazing (but not at the present time).
- G. Surface Ownership: The proposed well site and part of the access road is on fee surface with Federal minerals.
- H. There is no evidence of archaeological, historical or cultural sites in the staked area.

**12. OPERATOR'S REPRESENTATIVE**

- A. The field representative for assuring compliance with the approved use and operations plan is as follows:

**Jim Stevens  
J. Cleo Thompson & James Cleo Thompson, Jr., L.P.  
P.O. Box 12577  
Odessa, Tx 79768  
Office Phone: (432) 550-8887  
Cell Phone: (432) 664-2917**



**J. CLEO THOMPSON & JAMES CLEO THOMPSON, JR., L.P.**  
**JCT Federal 18, Well No. 1**

**13. CERTIFICATION:**

I hereby certify that I have inspected the proposed drill site and access route; that I am familiar with the conditions which presently exist; that the statements made in the plan are, to the best of my knowledge, true and correct; and that the work associated with the operations proposed herein will be performed by J. Cleo Thompson and James Cleo Thompson, Jr., L.P. and its contractors and sub contractors in conformity with this plan and the terms and conditions under which it is approved. This statement is subject to the provisions of 18 U.S.C 1001 for the filing of a false statement.

Date: 10/20/06

Jim Stevens  
Jim Stevens, Operations Manager for J. Cleo Thompson



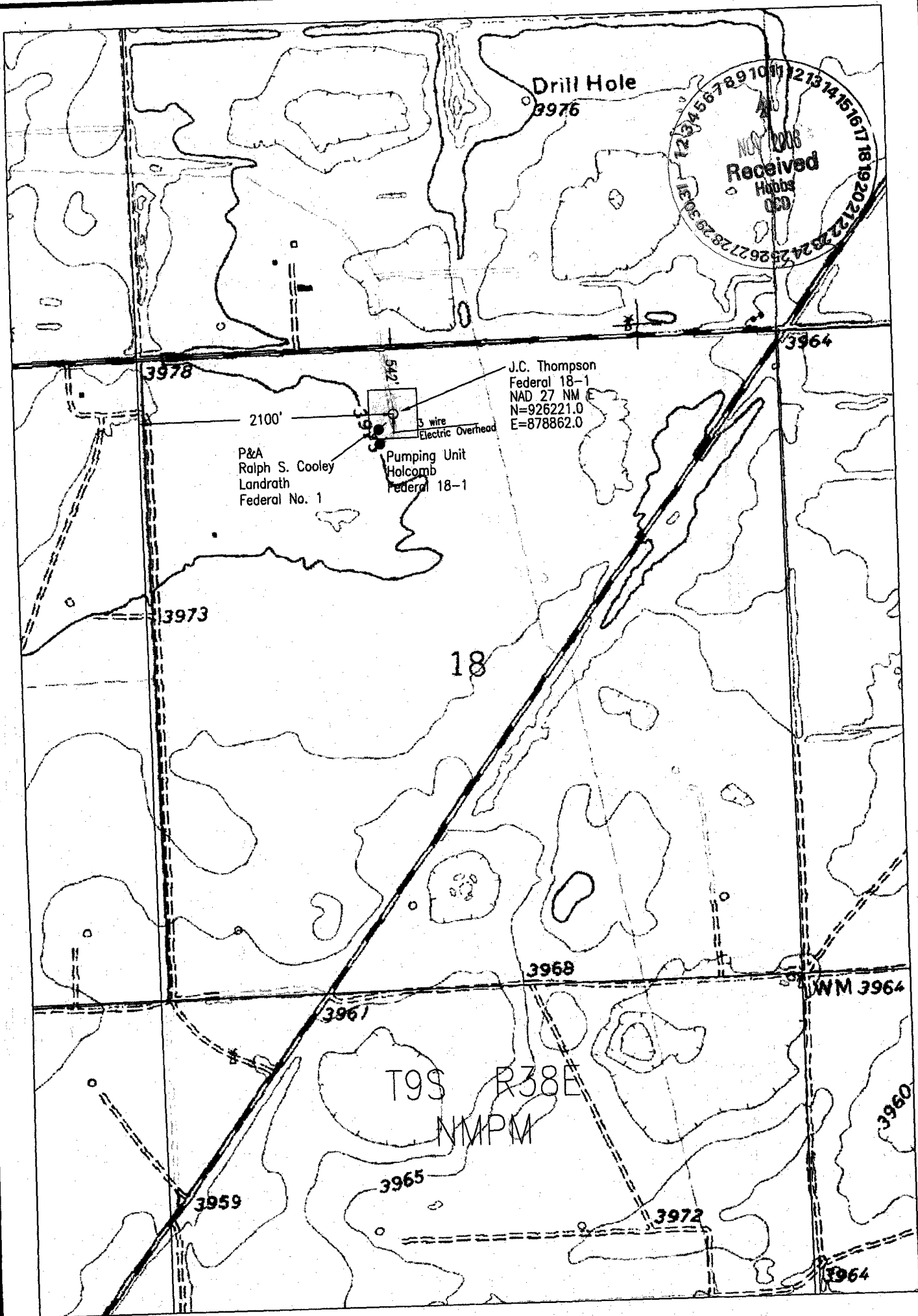
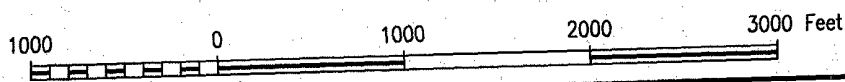

EXHIBIT "A"  
J. CLEO THOMPSON  
JCT FEDERAL 18, WELL NO. 1



J. Cleo Thompson  
Topographic Site Plan  
Section 18, T-9-S, R-38-E, NMPM  
Lea County, New Mexico

STANFORD SURVEYING COMPANY  
P.O. BOX 8490  
MIDLAND, TEXAS 79708-8490  
432-699-5708

DRAWN BY Mike Stanford

DATE 9-29-2006

SCALE 1" = 1000'

FILE NAME A-3192

R38E

TO BLESS

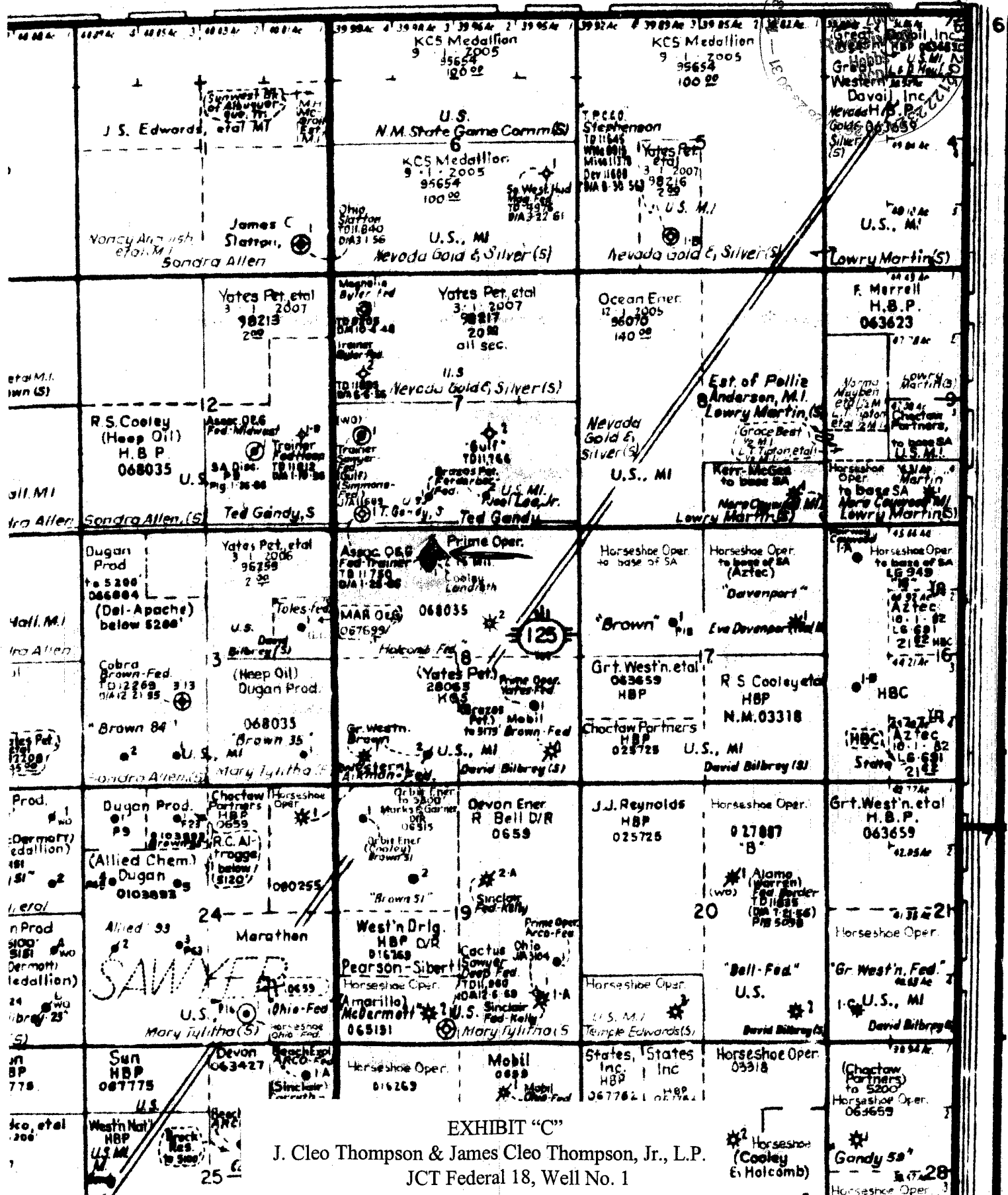



District I  
1625 N. French Dr., Hobbs, NM 88240  
District II  
1301 W. Grand Avenue, Artesia, NM 88210  
District III  
1000 Rio Brazos Road, Aztec, NM 87410  
District IV  
1220 S. St. Francis Dr., Santa Fe, NM 87505

State of New Mexico  
Energy Minerals and Natural Resources

Form C-144  
June 1, 2004

Oil Conservation Division  
1220 South St. Francis Dr.  
Santa Fe, NM 87505

For drilling and production facilities submit to  
appropriate NMOCD District Office.  
For downstream facilities, submit to Santa Fe  
office

Pit or Below-Grade Tank Registration or Closure

Is pit or below-grade tank covered by a "general plan"? Yes ☐ No ☒  
Type of action: Registration of a pit or below-grade tank ☒ Closure of a pit or below-grade tank ☐

Operator: THOMPSON, J. CLEO Telephone: (432) 550-8887 e-mail address: jstevens@jcleo.com  
Address: P.O. BOX 12577 ODESSA, TX 79768-2577  
Facility or well name: JCT FEDERAL 18 #1 API#: 30-045-025-38178 U/L or Qw/Qtr: C Sec: 18 T: 9S R: 38E  
County: LEA Latitude: Longitude: NAD: 1927 ☐ 1983 ☐ Surface Owner Federal ☐ State ☐ Private ☒ Indian ☐

Pit	Below-grade tank
Type: Drilling <input checked="" type="checkbox"/> Production <input type="checkbox"/> Disposal <input type="checkbox"/> Workover <input type="checkbox"/> Emergency <input type="checkbox"/> Lined <input checked="" type="checkbox"/> Unlined <input type="checkbox"/> Liner type: Synthetic <input checked="" type="checkbox"/> Thickness: 12 mil Clay <input type="checkbox"/> Pit Volume: bbl	Volume: bbl Type of fluid: Construction material: Double-walled, with leak detection? Yes <input type="checkbox"/> If not, explain why not: 
Depth to ground water (vertical distance from bottom of pit to seasonal high water elevation of ground water.)	Less than 50 feet (20 points) 50 feet or more, but less than 100 feet (10 points) 100 feet or more (0 points)
Wellhead protection area: (Less than 200 feet from a private domestic water source, or less than 1000 feet from all other water sources.)	Yes (20 points) No (0 points)
Distance to surface water: (horizontal distance to all wetlands, playas, irrigation canals, ditches, and perennial and ephemeral watercourses.)	Less than 200 feet (20 points) 200 feet or more, but less than 1000 feet (10 points) 1000 feet or more (0 points)
Ranking Score (Total Points)	

If this is a pit closure: (1) attach a diagram of the facility showing the pit's relationship to other equipment and tanks. (2) Indicate disposal location: (check the onsite box if you are burying in place) onsite ☐ offsite ☐ If offsite, name of facility: (3) Attach a general description of remedial action taken including remediation start date and end date. (4) Groundwater encountered: No ☐ Yes ☐ If yes, show depth below ground surface: ft. and attach sample results. (5) Attach soil sample results and a diagram of sample locations and excavations.

Additional Comments:

I hereby certify that the information above is true and complete to the best of my knowledge and belief. I further certify that the above-described pit or below-grade tank has been/will be constructed or closed according to NMOCD guidelines ☒, a general permit ☐, or an (attached) alternative OCD-approved plan ☐.

Date: 11/22/2006

Printed Name/Title: JIM STEVENS OPERATIONS MANAGER Signature: *Jim Stevens*

Your certification and NMOCD approval of this application/closure does not relieve the operator of liability should the contents of the pit or tank contaminate ground water or otherwise endanger public health or the environment. Nor does it relieve the operator of its responsibility for compliance with any other federal, state, or local laws and/or regulations.

Approval:

Printed Name/Title: CHRIS WILLIAMS / DIST. SUPV Signature: *Chris Williams*

Date: 11/21/06