

State of New Mexico
Energy, Minerals & Natural Resources

Form C-101
May 27, 2004

District I
1625 N. French Dr., Hobbs, NM 88240
District II
1301 W. Grand Avenue, Artesia, NM 88210
District III
1000 Rio Brazos Rd., Aztec, NM 87410
District IV
1220 S. St. Francis Dr., Santa Fe, NM 87505

Oil Conservation Division
1220 S. St. Francis Dr.
Santa Fe, NM 87505

Submit to appropriate District Office

☐ AMENDED REPORT

APPLICATION FOR PERMIT TO DRILL, RE-ENTER, DEEPEN, PLUGBACK, OR ADD A ZONE

¹ Operator Name and Address Nearburg Producing Company 3300 N A St. Bldg 2, Ste 120, Midland, TX 79705		² OGRID Number 015742
		³ API Number 30- 025-29999
⁴ Property Code 8424	⁵ Property Name Wright	⁶ Well No. 2
⁹ Proposed Pool 1 Humble City; Wolfcamp		¹⁰ Proposed Pool 2

⁷ Surface Location

UL or lot no.	Section	Township	Range	Lot. Idn	Feet from the	North/South Line	Feet from the	East/West line	County
P	12	17S	37E		1200	South	760	East	Lea

⁸ Proposed Bottom Hole Location If Different From Surface

UL or lot no.	Section	Township	Range	Lot. Idn	Feet from the	North/South Line	Feet from the	East/West line	County

Additional Well Location

¹¹ Work Type Code PB	¹² Well Type Code O	¹³ Cable/Rotary	¹⁴ Lease Type Code SP	¹⁵ Ground Level Elevation 3723
¹⁶ Multiple	¹⁷ Proposed Depth 11940	¹⁸ Formation Wolfcamp	¹⁹ Contractor	²⁰ Spud Date 10/1/06
Depth to ground water		Distance from nearest fresh water well		Distance from nearest surface water
Pit: Liner: Synthetic <input type="checkbox"/> _____ mils thick Clay <input type="checkbox"/> Pit Volume _____ bbls Drilling Method: Closed-Loop System <input type="checkbox"/> Fresh Water <input type="checkbox"/> Brine <input type="checkbox"/> Diesel/Oil-based <input type="checkbox"/> Gas/Air <input type="checkbox"/>				

²¹ Proposed Casing and Cement Program

Hole Size	Casing Size	Casing weight/foot	Setting Depth	Sacks of Cement	Estimated TOC
17-1/2	13-3/8	68#	480	500	NA
11	8-5/8	24 & 32	4695	1700	NA
7-7/8	5-1/2	17	11940	650	NA
All csg is existing					

²² Describe the proposed program. If this application is to DEEPEN or PLUG BACK, give the data on the present productive zone and proposed new productive zone. Describe the blowout prevention program, if any. Use additional sheets if necessary.

See attached for plugback procedure. **Permit Expires 1 Year From Approval Date Unless Drilling Underway**
 Plat attached

NSL Approved for this pool 11/30/07

Plugback

Received

²³ I hereby certify that the information given above is true and complete to the best of my knowledge and belief. I further certify that the drilling pit will be constructed according to NMOCD guidelines <input checked="" type="checkbox"/> a general permit <input type="checkbox"/> , or an (attached) alternative OGD-approved plan <input type="checkbox"/> . Signature: <i>Sarah Jordan</i>		OIL CONSERVATION DIVISION	
Printed name: Sarah Jordan		Approved by: <i>Chris Williams</i>	
Title: Production/Regulatory Analyst		Title: OGC DISTRICT SUPERVISOR/GENERAL MANAGER	
E-mail Address: sjordan@nearburg.com		Approval Date: FEB 20 2007 Expiration Date:	
Date: 9/27/06 <i>9/28/06</i>	Phone: 432/686-8235 x 203	Conditions of Approval: Attached <input type="checkbox"/>	

DISTRICT I
1625 N. FRENCH DR., ROSES, NM 88240

State of New Mexico
Energy, Minerals and Natural Resources Department

Form C-102

DISTRICT II
1301 W. GRAND AVENUE, ARTESIA, NM 88210

OIL CONSERVATION DIVISION
1220 SOUTH ST. FRANCIS DR.
Santa Fe, New Mexico 87505

Revised October 12, 2005
Submit to Appropriate District Office
State Lease - 4 Copies
Fee Lease - 3 Copies

DISTRICT III
1000 Rio Brazos Rd., Aztec, NM 87410

DISTRICT IV
1220 S. ST. FRANCIS DR., SANTA FE, NM 87505

WELL LOCATION AND ACREAGE DEDICATION PLAT

☐ AMENDED REPORT

API Number 30-025-29999	Pool Code 3351D	Pool Name Humble City; Wolfcamp
Property Code 8424	Property Name WRIGHT	Well Number 2
OGRID No. 015742	Operator Name NEARBURG PRODUCING COMPANY	Elevation 3723'

Surface Location

UL or lot No.	Section	Township	Range	Lot Idn	Feet from the	North/South line	Feet from the	East/West line	County
P	12	17-S	37-E		1200	SOUTH	760	EAST	LEA

Bottom Hole Location If Different From Surface

UL or lot No.	Section	Township	Range	Lot Idn	Feet from the	North/South line	Feet from the	East/West line	County

Dedicated Acres 8042	Joint or Infill	Consolidation Code	Order No.
-------------------------	-----------------	--------------------	-----------

NO ALLOWABLE WILL BE ASSIGNED TO THIS COMPLETION UNTIL ALL INTERESTS HAVE BEEN CONSOLIDATED
OR A NON-STANDARD UNIT HAS BEEN APPROVED BY THE DIVISION

	OPERATOR CERTIFICATION <i>I hereby certify that the information herein is true and complete to the best of my knowledge and belief, and that this organization either owns a working interest or unleased mineral interest in the land including the proposed bottom hole location or has a right to drill this well at this location pursuant to a contract with an owner of such mineral or working interest, or to a voluntary pooling agreement or a compulsory pooling order heretofore entered by the Division.</i> Signature: <u>[Signature]</u> Date: <u>4-27-06</u> Printed Name: <u>G. Jordan</u>
	SURVEYOR CERTIFICATION <i>I hereby certify that the well location shown on this plat was plotted from field notes of actual surveys made by me or under my supervision, and that the same is true and correct to the best of my belief.</i>
	Signature & Seal of Professional Surveyor
	06.13.1512

**NEW MEXICO OIL CONSERVATION COMMISSION
WELL LOCATION AND ACREAGE DEDICATION PLAT**

Form C-102
Supersedes C-128
Effective 1-1-65

All distances must be from the outer boundaries of the Section

Operator Nearburg Producing Company			Lease Wright		Well No. 2
Unit Letter P	Section 12	Township 17 South	Range 37 East	County Lea County	
Actual Footage Location of Well: 760 feet from the East line and 1200 feet from the South line					
Ground Level Elev. 3723.1	Producing Formation Strawn		Pool South Humble City Strawn		Dedicated Acreage: 80 Acres

1. Outline the acreage dedicated to the subject well by colored pencil or hatchure marks on the plat below.
2. If more than one lease is dedicated to the well, outline each and identify the ownership thereof (both as to working interest and royalty).
3. If more than one lease of different ownership is dedicated to the well, have the interests of all owners been consolidated by communitization, unitization, force-pooling, etc?

☒ Yes ☐ No If answer is "yes," type of consolidation **Pooling**

If answer is "no," list the owners and tract descriptions which have actually been consolidated. (Use reverse side of this form if necessary.) _____

No allowable will be assigned to the well until all interests have been consolidated (by communitization, unitization, forced-pooling, or otherwise) or until a non-standard unit, eliminating such interests, has been approved by the Commission.

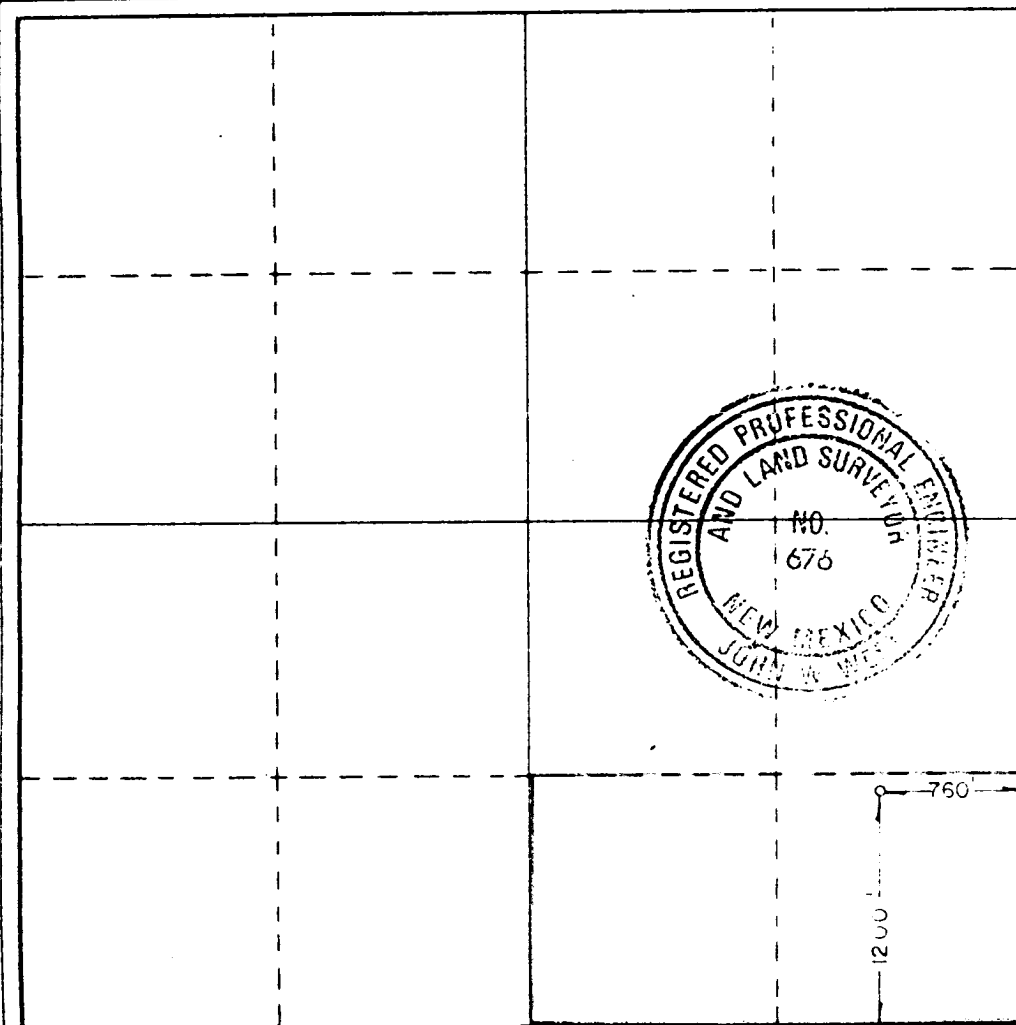

CERTIFICATION

I hereby certify that the information contained herein is true and complete to the best of my knowledge and belief.

Name
Charles E. Nearburg
Position
President
Company
Nearburg Producing Company
Date
August 7, 1987

I hereby certify that the well location shown on this plat was plotted from field notes of actual surveys made by me or under my supervision, and that the same is true and correct to the best of my knowledge and belief.

Date Surveyed
July 31, 1987
Registered Professional Engineer and/or Land Surveyor

[Signature]
Certificate No. **JOHN W. WEST, 676**
RONALD J. EIDSON, 3239

RECOMMENDED PROCEDURE:

NOTE: MARY ANN 12C WOLFCAMP HAD 350+ PPM H₂S. BE PREPARED FOR BAD GAS.

- 1) MIRU PU. Check for pressure on WH. ND WH NU BOP.**
- 2) PU pkr On/Off tool and 2-7/8" N-80 or L-80 tbg & RIH to 10,150'. Set pkr and test to 500#. If tbg is new pickle tbg w/300 g Xylene followed by 900g 15 % NEFE. Displace to EOT then reverse out tbg to pit.**
- 3) Get back on pkr. Swab well down to 4500'.**
- 4) RU JSI to perforate the following intervals w/4 spf 1-11/16" STRIP GUN with OWEN NTX CHARGE". THESE GUNS ARE 0 PHASED W/ 19.54" PEN & .23 EHD. Perforate under a 5000# lubricator.**
10,202-10,226' 96 holes
Correlate to Schlumberger "Compensated Neutron / Litho-Density" log dated 14 Sep 87, Run Number One. RD JSI.
- 5) RU BJ to pump 2,500 g 15% NEFE acid in stages as follows:**
 - a) 500 g 15% NEFE**
 - b) drop 30 1.1 balls**
 - a) 500 g 15% NEFE**
 - b) drop 30 1.1 balls**
 - a) 500 g 15% NEFE**
 - b) drop 30 1.1 balls**
 - a) 500 g 15% NEFE**
 - b) drop 30 1.1 balls**
 - a) 500 g 15% NEFE**
 - b) drop 30 1.1 balls**
 - b) Flush to btm perf w/2% KCL w/.5 gpt Claymaster 5.****RD BJ.**
- 6) Flow/swab back acid load. Report results to Matt Lee & Brian Huzzey.**
- 7) If necessary pump test well w/portable unit to determine economics of purchasing permanent pumping equipment.**