

District I  
1625 N. French Dr., Hobbs, NM 88240  
District II  
1301 W. Grand Avenue, Artesia, NM 88210  
District III  
1000 Rio Brazos Road, Aztec, NM 87410  
District IV  
1220 S. St. Francis Dr., Santa Fe, NM 87505

State of New Mexico  
Energy Minerals and Natural Resources

Form C-101  
May 27, 2004

Oil Conservation Division  
1220 South St. Francis Dr.  
Santa Fe, NM 87505

Submit to appropriate District Office

☐ AMENDED REPORT

**APPLICATION FOR PERMIT TO DRILL, RE-ENTER, DEEPEN, PLUGBACK, OR ADD A ZONE**

|   |   |   |
|---|---|---|
| <sup>1</sup> Operator Name and Address<br>Pride Energy Company<br>PO Box 701950, Tulsa, OK 74170-1950 |   | <sup>2</sup> OGRID Number<br>151323       |
|   |   | <sup>3</sup> API Number<br>30 - 025-20460 |
| <sup>4</sup> Property Code<br>36382   | <sup>5</sup> Property Name<br>Humble "AO" State | <sup>6</sup> Well No.<br>2                |
| <sup>9</sup> Proposed Pool 1<br>Monument, Abo, North  |   | <sup>10</sup> Proposed Pool 2             |

**7 Surface Location**

|                    |               |                 |              |         |                      |                           |                       |                        |               |
|--------------------|---------------|-----------------|--------------|---------|----------------------|---------------------------|-----------------------|------------------------|---------------|
| UL or lot no.<br>N | Section<br>11 | Township<br>19S | Range<br>36E | Lot Idn | Feet from the<br>660 | North/South line<br>South | Feet from the<br>1920 | East/West line<br>West | County<br>Lea |
|--------------------|---------------|-----------------|--------------|---------|----------------------|---------------------------|-----------------------|------------------------|---------------|

**8 Proposed Bottom Hole Location If Different From Surface**

|               |         |          |       |         |               |                  |               |                |        |
|---------------|---------|----------|-------|---------|---------------|------------------|---------------|----------------|--------|
| UL or lot no. | Section | Township | Range | Lot Idn | Feet from the | North/South line | Feet from the | East/West line | County |
|---------------|---------|----------|-------|---------|---------------|------------------|---------------|----------------|--------|

**Additional Well Information**

|   |   |  |                                     |  |
|---|---|--|-------------------------------------|--|
| <sup>11</sup> Work Type Code<br>E   | <sup>12</sup> Well Type Code<br>O                     | <sup>13</sup> Cable/Rotary<br>R                  | <sup>14</sup> Lease Type Code<br>S  | <sup>15</sup> Ground Level Elevation<br>3,748' |
| <sup>16</sup> Multiple<br>No  | <sup>17</sup> Proposed Depth<br>8,415' (orig TD 9141) | <sup>18</sup> Formation<br>Abo                   | <sup>19</sup> Contractor<br>unknown | <sup>20</sup> Spud Date<br>ASAP                |
| Depth to Groundwater<br>55'   |   | Distance from nearest fresh water well<br>1,500' |                                     | Distance from nearest surface water<br>none    |
| <b>Pit:</b> Liner: Synthetic <input checked="" type="checkbox"/> 12 mils thick Clay <input type="checkbox"/> Pit Volume: 2,000 bbls Drilling Method:<br>Closed-Loop System <input type="checkbox"/> Fresh Water <input checked="" type="checkbox"/> Brine <input type="checkbox"/> Diesel/Oil-based <input type="checkbox"/> Gas/Air <input type="checkbox"/> |   |  |                                     |  |

**21 Proposed Casing and Cement Program**

| Hole Size | Casing Size | Casing weight/foot | Setting Depth     | Sacks of Cement | Estimated TOC        |
|-----------|-------------|--------------------|-------------------|-----------------|----------------------|
| 17 1/2"   | 13 3/8"     | 48#                | 300' (in place)   | 375             | Surface              |
| 11"       | 8 5/8"      | 24# & 32#          | 3,377' (in place) | 500             | 2,160 by temp survey |
|           |             |                    |                   |                 |                      |
|           |             |                    |                   |                 |                      |
|           |             |                    |                   |                 |                      |

<sup>22</sup> Describe the proposed program. If this application is to DEEPEN or PLUG BACK, give the data on the present productive zone and proposed new productive zone. Describe the blowout prevention program, if any. Use additional sheets if necessary.

The wellbore will be re-entered using a workover rig and a reverse unit. The cement plugs at the surface, 1,500-1,700'; 3,150-3,477'; 3,900-4,200'; 4,900-5,000' and the CIBP at 6,255' will be drilled out and wellbore circulated clean. 5 1/2" cs'g will be pressure tested, Bone Springs perms at 6,304' to 6,424' will be squeezed. Abo will be perforated; acidized and tested. If unsuccessful, the Queen and/or Seven Rivers will be tested. A 5,000# BOP will be installed on the 5 1/2" casing.

Permit Expires 1 Year From Approval  
Data Unless Drilling Underway  
Re-Entry

<sup>23</sup> I hereby certify that the information given above is true and complete to the best of my knowledge and belief. I further certify that the drilling pit will be constructed according to NMOCD guidelines ☒, a general permit ☐, or an (attached) alternative OCD-approved plan ☐.

Printed name: John W. Pride

Title: Pres. Of Pride Oil & Gas Co., Inc. as Gen. Partner of Pride Energy Company

E-mail Address: johnp@pride-energy.com

Date: 3/2/07

Phone: (918) 524-9200

OIL CONSERVATION DIVISION

Approved by:

Title:

Approval MAR 14 2007

Expiration Date:

Conditions of Approval Attached ☐

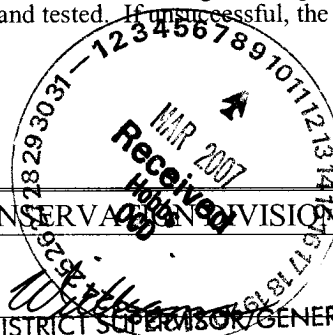

District I  
1625 N. French Dr., Hobbs, NM 88240  
District II  
1301 W. Grand Avenue, Artesia, NM 88210  
District III  
1000 Rio Brazos Rd., Aztec, NM 87410  
District IV  
1220 S. St. Francis Dr., Santa Fe, NM 87505

State of New Mexico  
Energy, Minerals & Natural Resources Department  
OIL CONSERVATION DIVISION  
1220 South St. Francis Dr.  
Santa Fe, NM 87505

Form C-102  
Revised June 10, 2003  
Submit to Appropriate District Office  
State Lease - 4 Copies  
Fee Lease - 3 Copies

☐ AMENDED REPORT

WELL LOCATION AND ACREAGE DEDICATION PLAT

|   |  |  |
|---|--|--|
| <sup>1</sup> API Number<br>30-025-20460 | <sup>2</sup> Pool Code<br>469812                   | <sup>3</sup> Pool Name<br>Monument; Abo, North |
| <sup>4</sup> Property Code<br>36382     | <sup>5</sup> Property Name<br>Humble "AO" State    | <sup>6</sup> Well Number<br>2                  |
| <sup>7</sup> OGRID No.<br>151323        | <sup>8</sup> Operator Name<br>Pride Energy Company | <sup>9</sup> Elevation<br>3,748'               |

<sup>10</sup> Surface Location

|               |         |          |       |         |               |                  |               |                |        |
|---------------|---------|----------|-------|---------|---------------|------------------|---------------|----------------|--------|
| UL or lot no. | Section | Township | Range | Lot Idn | Feet from the | North/South line | Feet from the | East/West line | County |
| N             | 11      | 19S      | 36E   |         | 600'          | South            | 1920'         | West           | Lea    |

<sup>11</sup> Bottom Hole Location If Different From Surface

|                                     |                                    |                                  |                         |         |               |                  |               |                |        |
|-------------------------------------|------------------------------------|----------------------------------|-------------------------|---------|---------------|------------------|---------------|----------------|--------|
| UL or lot no.                       | Section                            | Township                         | Range                   | Lot Idn | Feet from the | North/South line | Feet from the | East/West line | County |
|                                     |                                    |                                  |                         |         |               |                  |               |                |        |
| <sup>12</sup> Dedicated Acres<br>40 | <sup>13</sup> Joint or Infill<br>N | <sup>14</sup> Consolidation Code | <sup>15</sup> Order No. |         |               |                  |               |                |        |

NO ALLOWABLE WILL BE ASSIGNED TO THIS COMPLETION UNTIL ALL INTERESTS HAVE BEEN CONSOLIDATED OR A NON-STANDARD UNIT HAS BEEN APPROVED BY THE DIVISION

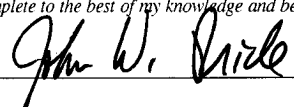
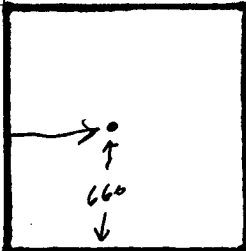
|               |   |  |  |  |
|---------------|---|--|--|--|
| <sup>16</sup> |   |  |  | <sup>17</sup> OPERATOR CERTIFICATION<br><i>I hereby certify that the information contained herein is true and complete to the best of my knowledge and belief.</i><br><br>Signature<br>John W. Pride<br>Printed Name<br>Pres. of Pride Oil & Gas Co., Inc., as Gen. Partner of Pride Energy Company<br>johnp@pride-energy.com<br>Title and E-mail Address<br>3/2/07<br>Date |
|               |   |  |  |  |
|               |   |  |  |  |
|               |   |  |  |  |
|               |   |  |  | <sup>18</sup> SURVEYOR CERTIFICATION<br><i>I hereby certify that the well location shown on this plat was plotted from field notes of actual surveys made by me or under my supervision, and that the same is true and correct to the best of my belief.</i><br><br>Date of Survey<br>Signature and Seal of Professional Surveyor:<br><br>(see original survey attached)<br><br>Certificate Number   |
|               |   |  |  |  |
|               |   |  |  |  |
|               |   |  |  |  |
|               |  |  |  |  |

STATE LEASE NO.  
FEDERAL LEASE NO.

## Well Location and Acreage Dedication Plat

Revised 5/1/57

Section A.

Date Sept. 20, 1963

Operator Humble Oil & Ref. Co. Lease New Mexico State "A.O." 5'  
 Well No. 2 Unit Letter N Section 11 Township 19 South Range 36 East NMPM  
 Located 600 Feet From South Line, 1920 Feet From West Line  
 County Lea G. L. Elevation Later Dedicated Acreage 40 Acres  
 Name of Producing Formation Yeso Pool Abo

1. Is the Operator the only owner\* in the dedicated acreage outlined on the plat below?  
 Yes ☒ No ☐
2. If the answer to question one is "no", have the interests of all the owners been consolidated by communitization agreement or otherwise? Yes ☐ No ☐ If answer is "yes," Type of Consolidation \_\_\_\_\_
3. If the answer to question two is "no," list all the owners and thier respective interests below:

Owner

Land Description

\_\_\_\_\_  
 \_\_\_\_\_  
 \_\_\_\_\_

\_\_\_\_\_  
 \_\_\_\_\_  
 \_\_\_\_\_

Section B

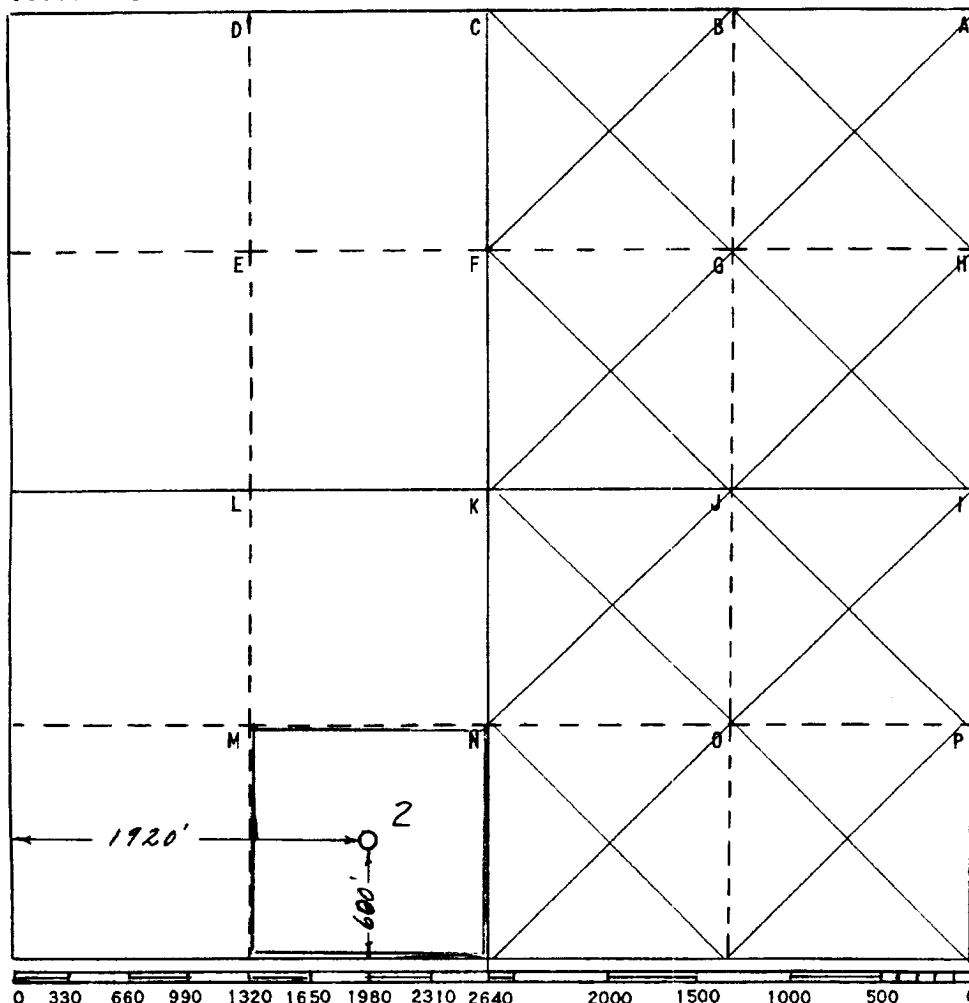

This is to certify that the information in Section A above is true and complete to the best of my knowledge and belief

HUMBLE OIL &amp; REFG. CO.

(Operator)

H. P. Hensley  
 (Representative)

Box 1600 Midland, Texas  
 Address

This is to certify that the well location shown on the plat in Section B was plotted from field notes of actual surveys made by me or under my supervision and that the same is true and correct to the best of my knowledge and belief.

Date Surveyed 9/20/63

H. S. Hesterfield  
 Registered Professional  
 Engineer and/or Land Surveyor

Certificate No. 1382

FILE NO. W-A-2078

## OIL CONSERVATION DIVISION

STATE OF NEW MEXICO  
ENERGY AND MINERALS DEPARTMENTP. O. BOX 2088  
SANTA FE, NEW MEXICO 87501Form C-102  
Revised 10-1-78

All distances must be from the outer boundaries of the Section.

|   |                                   |                                      |   |                       |
|---|-----------------------------------|--------------------------------------|---|-----------------------|
| Operator<br><b>Lynx Petroleum Consultants, INC.</b> |                                   | Lease<br><b>Humble "AO" State</b>    |   | Well No.<br><b>#2</b> |
| Unit Letter<br><b>N</b>                             | Section<br><b>11</b>              | Township<br><b>T-19S</b>             | Range<br><b>R-36E</b>                     | County<br><b>Lea</b>  |
| Actual Footage Location of Well:                    |                                   |                                      |   |                       |
| 660' feet from the <b>South</b> line and            |                                   | 1920' feet from the <b>West</b> line |   |                       |
| Ground Level Elev.<br><b>3748' GL</b>               | Producing Formation<br><b>Abo</b> | Pool<br><b>UNDESIGNATED</b>          | Dedicated Acreage:<br><b>460 40</b> Acres |                       |

1. Outline the acreage dedicated to the subject well by colored pencil or hatchure marks on the plat below.
2. If more than one lease is dedicated to the well, outline each and identify the ownership thereof (both as to working interest and royalty).
3. If more than one lease of different ownership is dedicated to the well, have the interests of all owners been consolidated by communitization, unitization, force-pooling, etc?

☐ Yes ☒ No If answer is "yes," type of consolidation \_\_\_\_\_

If answer is "no," list the owners and tract descriptions which have actually been consolidated. (Use reverse side of this form if necessary.) \_\_\_\_\_

No allowable will be assigned to the well until all interests have been consolidated (by communitization, unitization, forced-pooling, or otherwise) or until a non-standard unit, eliminating such interests, has been approved by the Division.

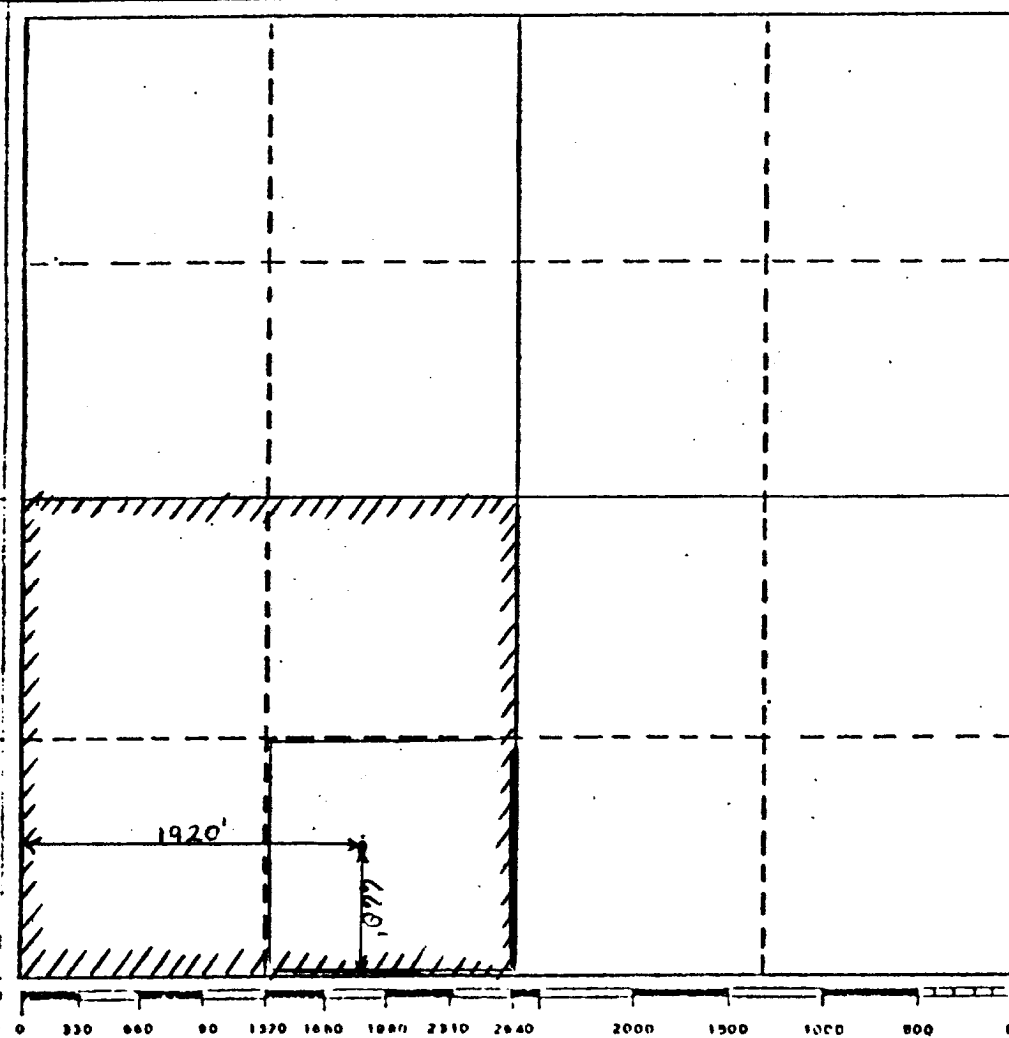

## CERTIFICATION

I hereby certify that the information contained herein is true and complete to the best of my knowledge and belief.

Name W. E. Linder  
Position Vice-President  
Company Lynx Petroleum Cons. In  
Date June 6, 1983

I hereby certify that the well location shown on this plat was plotted from field notes of actual surveys made by me or under my supervision, and that the same is true and correct to the best of my knowledge and belief.

Date Surveyed \_\_\_\_\_

Registered Professional Engineer  
and/or Land Surveyor

Certificate No. \_\_\_\_\_

### Current Completion

KB: 0.0'  
DF: 0.0'  
GL: 3748.0'  
Datum: 3748.0' above GL

### Humble "AO" State #2

John Pride 2/8/07  
API # 30-025-20460

600' FSL & 1920' FWL  
Sec 11-T19S-R36E  
Lea Co, NM  
(in Unit Letter N = SE SW)

13 3/8", 48#, 279' csg, cmt. w/ 375  
sx cmt to surf in 17 1/2" hole

8 5/8", 24# & 32#, 3,358' csg,  
cmt w/ 500 sx cmt  
TOC @ 2,160' by temp. survey  
in 11" hole

5 1/2" CIBP set @ 6,255'  
+ 4 sx cmt on top

CIBP set @ 8,415'  
+ 5 sx cmt on top

PBTD = 8,601'

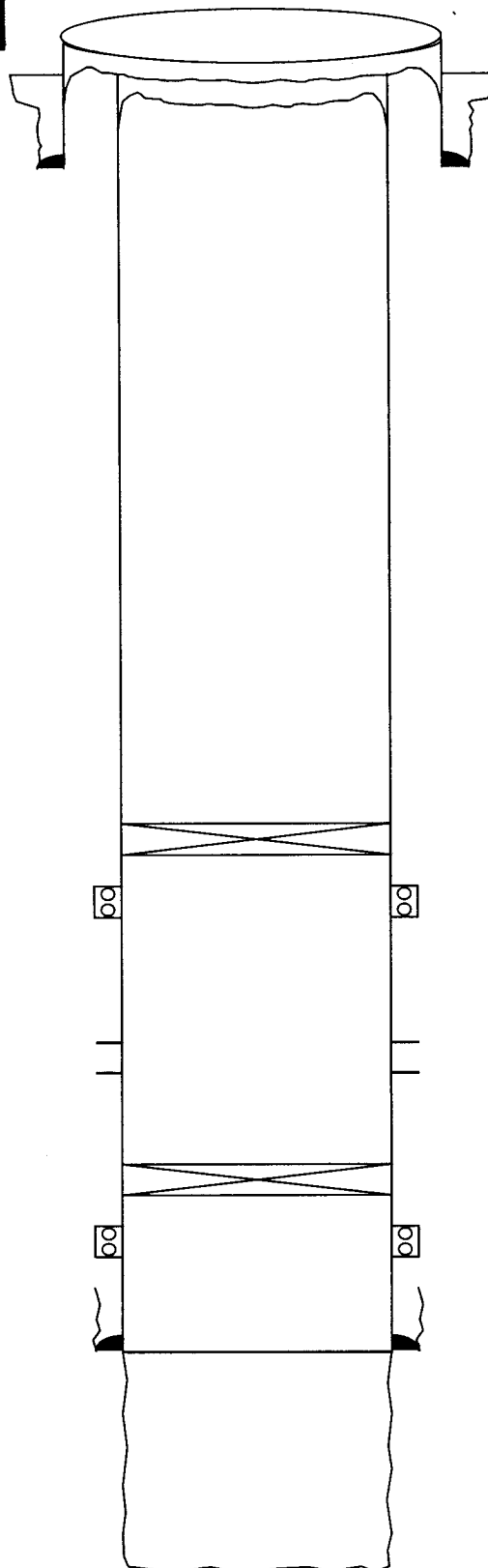

10 sx cmt plug @ surface  
w/ dry hole marker

25 sx cmt plug @ 1,500-1,700'

40 sx cmt plug @ 3,150-3,477'

35 sx cmt plug @ 3,900-4,200'

25 sx cmt plug @ 4,900-5,000'

Perf'd Bone Springs  
6,304-6,324 = 20'  
6,350-6,358 = 8'  
6,414-6,424 = 10'

DV Tool @ 6,600'

Perf'd Lower Abo  
8,465-8,476 = 11'

5 1/2", 20# & 17#, N-80 csg to  
8,601' w/ stage collar at 6,600'  
cmt'd in 2 stages:  
400 sx + 1,200 sx  
c/o to 8,520'

25 sx cmt plug 9,060-9,140'

Orig. TD = 9,141'

**Proposed Completion**

KB: 0.0'  
DF: 0.0'  
GL: 3748.0'  
Datum: 3748.0' above GL

**Humble "AO" State #2**

John Pride 2/8/07  
API # 30-025-20460

600' FSL & 1920' FWL  
Sec 11-T19S-R36E  
Lea Co, NM  
(in Unit Letter N = SE SW)

13 3/8", 48#, 279' csg, cmt. w/ 375  
sx cmt to surf in 17 1/2" hole

8 5/8", 24# & 32#, 3,358' csg,  
cmt w/ 500 sx cmt  
TOC @ 2,160' by temp. survey  
in 11" hole

2 7/8", J-55, tubing probably will  
require rods and pumping unit

Sqz Bone Springs perfs

Perf. Upper Abo, \_\_\_\_\_ spf,

CIBP set @ 8,415'  
+ 5 sx cmt on top

PBTD = 8,601'

Orig. TD = 9,141'

Perf'd Bone Springs  
6,304-6,324 = 20'  
6,350-6,358 = 8'  
6,414-6,424 = 10'

DV Tool @ 6,600'

Perf'd Lower Abo  
8,465-8,476 = 11'

5 1/2", 20# & 17#, N-80 csg to  
8,601' w/ stage collar at 6,600'  
cmt'd in 2 stages:  
400 sx + 1,200 sx  
c/o to 8,520'

25 sx cmt plug 9,060-9,140'

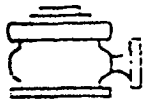

BOP-4

PRIDE ENERGY COMPANY  
Typical 5,000 psi Pressure System  
Schematic  
Annular with Double Ram Preventer Stack

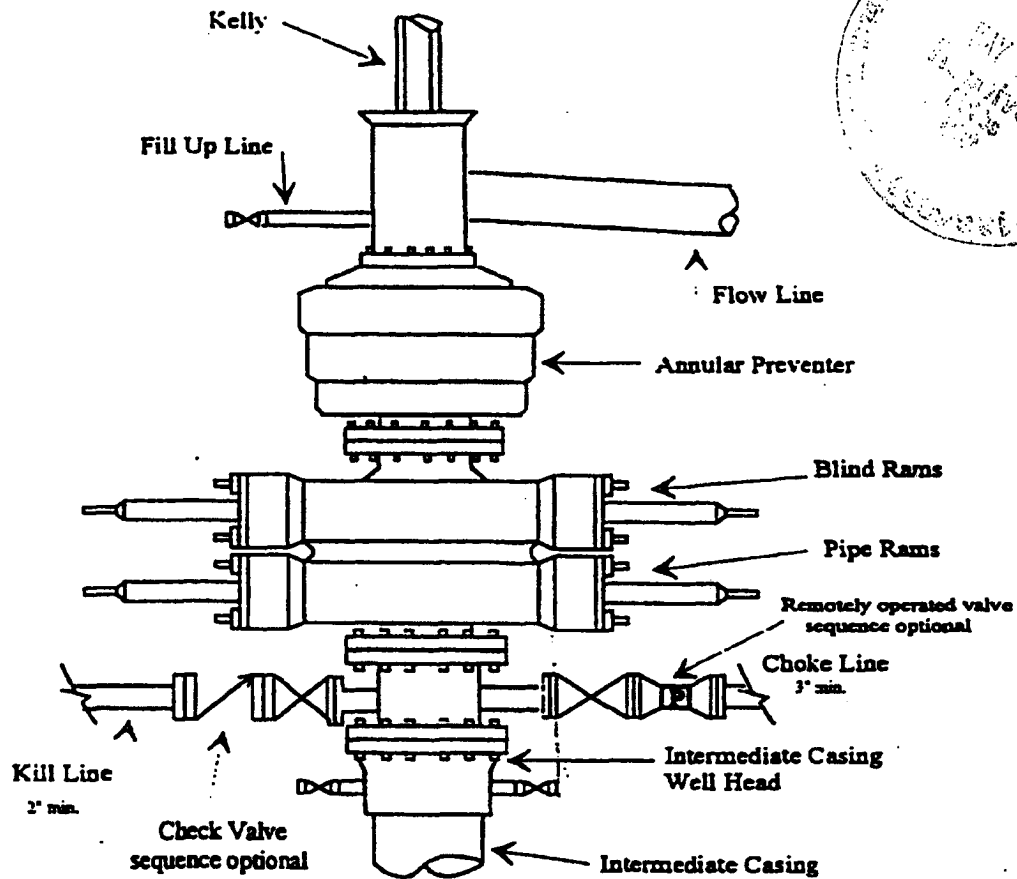

Typical 5,000 psi choke manifold assembly with at least these minimum features

