

District I
1625 N. French Dr., Hobbs, NM 88240
District II
1301 W. Grand Avenue, Artesia, NM 88210
District III
1000 Rio Brazos Road, Aztec, NM 87410
District IV
1220 S. St. Francis Dr., Santa Fe, NM 87505

State of New Mexico
Energy Minerals and Natural Resources

Form C-144
June 1, 2004

Oil Conservation Division
1220 South St. Francis Dr.
Santa Fe, NM 87505

For drilling and production facilities, submit to appropriate NMOCD District Office.
For downstream facilities, submit to Santa Fe office

Pit or Below-Grade Tank Registration or Closure

Is pit or below-grade tank covered by a "general plan"? Yes ☐ No ☒

Type of action: Registration of a pit or below-grade tank ☐ Closure of a pit or below-grade tank ☒

Operator: **COG Operating LLC** Telephone: **432-685-4372** e-mail address: **dkuykendall@conchoresources.com**
Address: **Fasken Center Tower II, 550 W. Texas Ave., Suite 1300, Midland, TX 79701**
Facility or well name: **Prohibition "12" Federal #10** API #: **30-025-37819** U/L or Qtr/Qtr: **K** Sec: **12** T: **22S** R: **32E**
County: **Lea** Latitude: **N 32° 24' 16"** Longitude: **W 103° 37' 48"** NAD: 1927 ☐ 1983 ☐
Surface Owner: Federal ☒ State ☐ Private ☐ Indian ☐

Pit **Below-grade tank**

Type: Drilling ☒ Production ☐ Disposal ☐

Workover ☐ Emergency ☐

Lined ☒ Unlined ☐

Liner type: Synthetic ☒ Thickness: **12 mil** Clay ☐

Pit Volume: **15,000 bbl**

Volume: _____ bbl Type of fluid: _____

Construction material: _____

Double-walled, with leak detection? Yes ☐ If not, explain why not.

Depth to ground water (vertical distance from bottom of pit to seasonal high water elevation of ground water.) **greater than 100'**

Less than 50 feet

(20 points)

50 feet or more, but less than 100 feet

(10 points)

100 feet or more - **X**

(0 points) 0

Wellhead protection area: (Less than 200 feet from a private domestic water source, or less than 1000 feet from all other water sources.)

Yes

(20 points)

No - **X**

(0 points) 0

Distance to surface water: (horizontal distance to all wetlands, playas, irrigation canals, ditches, and perennial and ephemeral watercourses.)

Less than 200 feet

(20 points)

200 feet or more, but less than 1000 feet

(10 points)

1000 feet or more - **X**

(0 points) 0

Ranking Score (Total Points)

0 points

If this is a pit closure: (1) Attach a diagram of the facility showing the pit's relationship to other equipment and tanks. (2) Indicate disposal location: (check the onsite box if you are burying in place) onsite ☒ offsite ☐ If offsite, name of facility _____. (3) Attach a general description of remedial action taken including remediation start date and end date. (4) Groundwater encountered: No ☐ Yes ☐ If yes, show depth below ground surface _____ ft and attach sample results. (5) Attach soil sample results and a diagram of sample locations and excavations.

Additional Comments: **Pit Closure Plan attached**

I hereby certify that the information above is true and complete to the best of my knowledge and belief. I further certify that the above-described pit or below-grade tank has been/will be constructed or closed according to NMOCD guidelines ☒, a general permit ☐, or an (attached) alternative OCD-approved plan ☐.

Date: **3-6-07**

Printed Name/Title **Phyllis A. Edwards - Regulatory Analyst**

Signature *Phyllis A. Edwards*

Your certification and NMOCD approval of this application/closure does not relieve the operator of liability should the contents of the pit or tank contaminate ground water or otherwise endanger public health or the environment. Nor does it relieve the operator of its responsibility for compliance with any other federal, state, or local laws and/or regulations.

Approval:

Printed Name/Title **GARY W. WINK / STAFF MGR**

Signature *Gary W. Wink*

Date: **3/16/07**

Pit Closure Plan – Drilling Pit

Operator: COG Operating LLC

Well Name: Prohibition "12" Federal #10

Location: Unit K, Section 12, Township 22 S, Range 32 E, Lea County, NM

The drilling pit associated with this well will be closed as per New Mexico OCD "Pit and Below-Grade Tank Guidelines" dated November 1, 2004. The visual inspection of the pit indicated that the pit liner has maintained its integrity.

1. Any remaining liquids will be removed from the pit.
2. Remaining solid wastes (i.e. buckets, cans, miscellaneous trash, debris, contaminated solids, etc.) will be removed from the pit, except for dried mud and cuttings, cement, and frac materials in drilling and reserve pits which have been approved by the OCD for encapsulation.
3. **This well did penetrate a salt section, and 9.5 lb/gal brine or greater was used during drilling. Therefore, the pit will be closed by capping and encapsulation:**

Capping and encapsulation will be accomplished by mixing earthen materials with the pit contents, as necessary to stiffen the pit contents sufficiently to provide physical stability and support for the pit cover; folding the edges of the liner over the stiffened mud and cuttings; capping with a 20 mil minimum thickness impervious, reinforced, synthetic or fabricated liner meeting ASTM standards that is designed to be resistant to the material encapsulated; the liner will overlap the underlying pit by at least 3 feet on all directions; and covering the liner cap with minimum of 3 feet of clean soil that is capable of supporting native plant growth.

4. Upon closure of the pit, the surface where the pit was located will be contoured to prevent erosion and ponding of rainwater over the site.
5. Since this is a federal well, the Bureau of Land Management (BLM) will be contacted for site reclamation requirements.

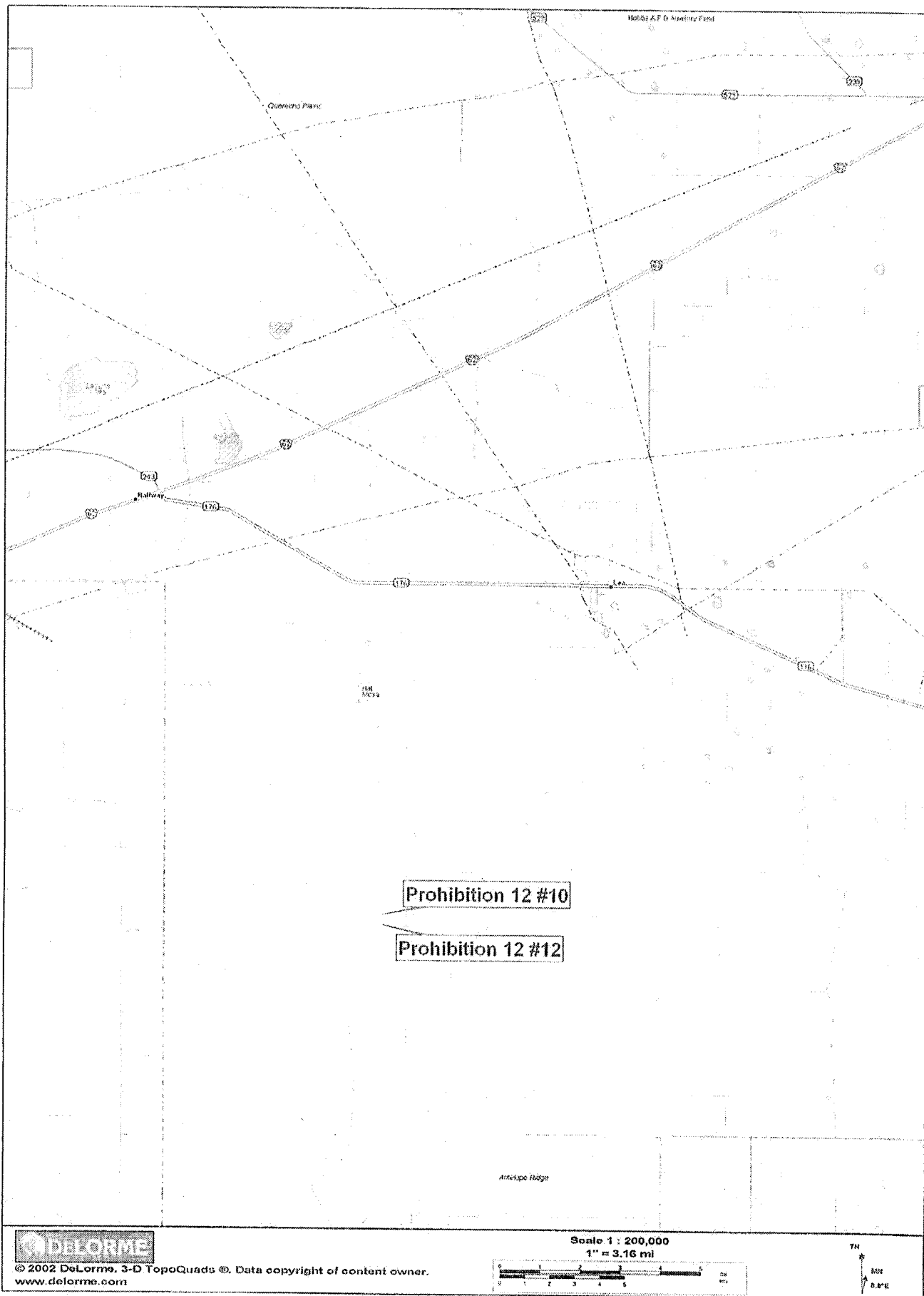

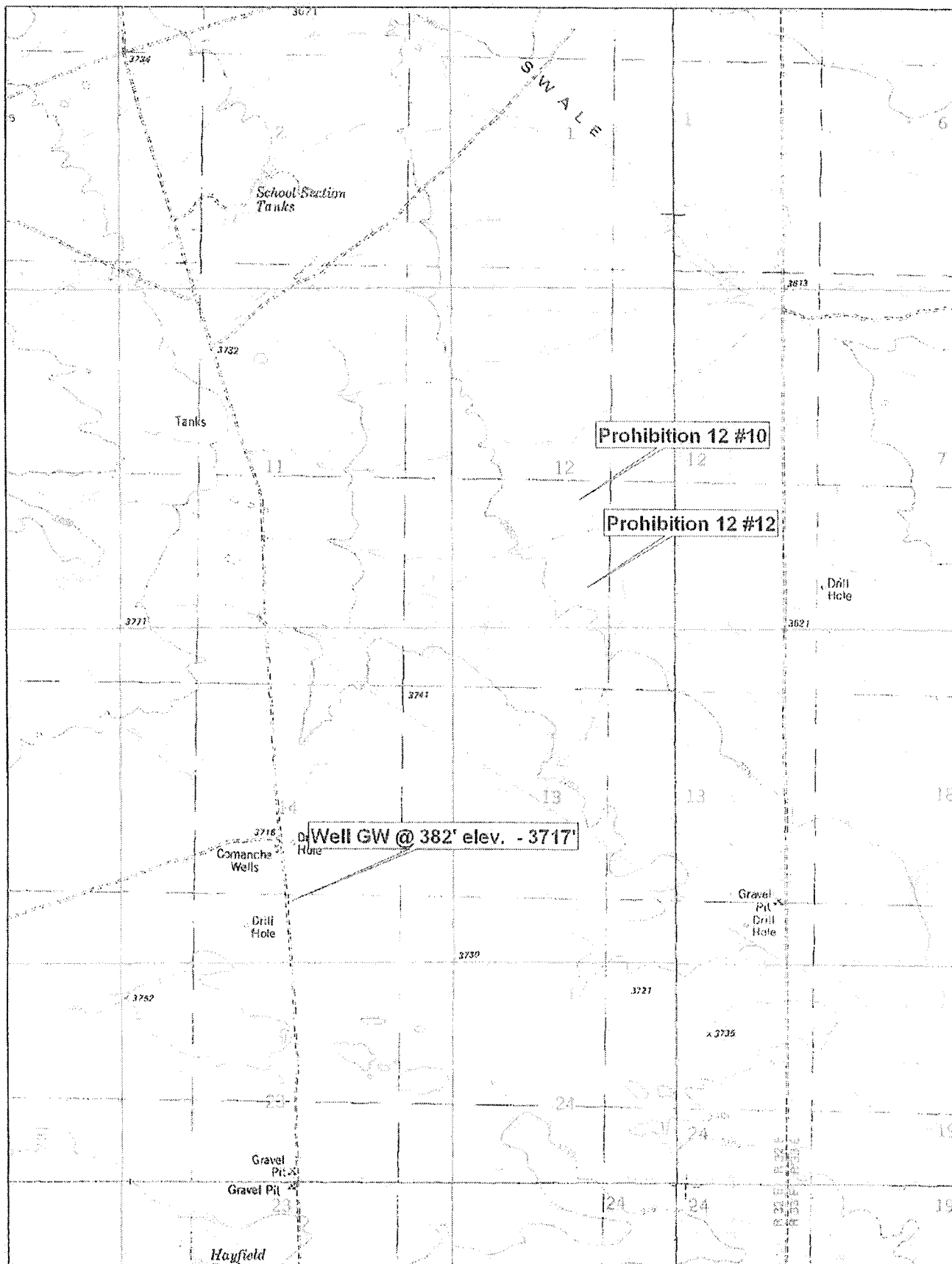

© 2002 DeLorme. 3-D TopoQuads®. Data copyright of content owner.
www.delorme.com

Scale 1 : 25,000
1" = 2080 ft

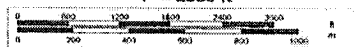

Water Well Data
Average Depth to Groundwater (ft)
COG - Prohibition 12 Federal #12 and #10, Lea County, New Mexico

21 South			31 East		
6	5	4	3	2	1
7	8	9	10	11	12
18	17	16	15	14	13
19	20	21	22	23	24
30	29	28	27	26	25
31	32	33	34	35	36

21 South			32 East		
6	5	4	3	2	1
7	8	9	10	11	12
18	17	16	15	14	13
19	20	21	22	23	24
30	29	28	27	26	25
31	32	33	34	35	36

21 South			33 East		
6	5	4	3	2	1
7	8	9	10	11	12
18	17	16	15	14	13
19	20	21	22	23	24
30	29	28	27	26	25
31	32	33	34	35	36

22 South			31 East		
6	5	4	3	2	1
7	8	9	10	11	12
18	17	16	15	14	13
19	20	21	22	23	24
30	29	28	27	26	25
31	32	33	34	35	36

22 South			32 East		
6	5	4	3	2	1
7	8	9	10	11	12
18	17	16	15	14	13
19	20	21	22	23	24
30	29	28	27	26	25
31	32	33	34	35	36

22 South			33 East		
6	5	4	3	2	1
7	8	9	10	11	12
18	17	16	15	14	13
19	20	21	22	23	24
30	29	28	27	26	25
31	32	33	34	35	36

23 South			31 East		
6	5	4	3	2	1
7	8	9	10	11	12
18	17	16	15	14	13
19	20	21	22	23	24
30	29	28	27	26	25
31	32	33	34	35	36

23 South			32 East		
6	5	4	3	2	1
7	8	9	10	11	12
18	17	16	15	14	13
19	20	21	22	23	24
30	29	28	27	26	25
31	32	33	34	35	36

23 South			33 East		
6	5	4	3	2	1
7	8	9	10	11	12
18	17	16	15	14	13
19	20	21	22	23	24
30	29	28	27	26	25
31	32	33	34	35	36

- 88 New Mexico State Engineers Well Reports
- 105 USGS Well Reports
- 90 Geology and Groundwater Conditions in Southern Lea, County, NM (Report 6)
- Geology and Groundwater Resources of Eddy County, NM (Report 3)
- 34 NMOCD - Groundwater Data

New Mexico Office of the State Engineer
POD Reports and Downloads

Township: 22S Range: 32E Sections:

NAD27 X: Y: Zone: Search Radius:

County: Basin: Number: Suffix:

Owner Name: (First) (Last) ☐ Non-Domestic ☐ Domestic
☒ All

POD / Surface Data Report

Avg Depth to Water Report

Water Column Report

Clear Form

iWATERS Menu

Help

AVERAGE DEPTH OF WATER REPORT 12/20/2006

Bsn	Tws	Rng	Sec	Zone	X	Y	Wells	(Depth Water in Feet)		
								Min	Max	Avg
C	22S	32E	14				2	340	360	350
C	22S	32E	19				1	280	280	280

Record Count: 3

Water
ResourcesNational Water Information
System: Web InterfaceData Category:
Ground WaterGeographic Area:
New Mexico

GO

Ground-water levels for New Mexico

Search Results -- 1 sites found

Search Criteria

site_no list = • 322314103384301

Save file of selected sites to local disk for future upload

USGS 322314103384301 22S.32E.14.32322

Available data for this site

Ground-water: Field measurements

GO

Lea County, New Mexico

Hydrologic Unit Code

Latitude 32°23'14", Longitude 103°38'43" NAD27

Land-surface elevation 3,717.00 feet above sea level NGVD29

The depth of the well is 435 feet below land surface.

This well is completed in the SANTA ROSA SANDSTONE (231SNRS) local aquifer.

Output formats

Table of data

Tab-separated data

Graph of data

Reselect period

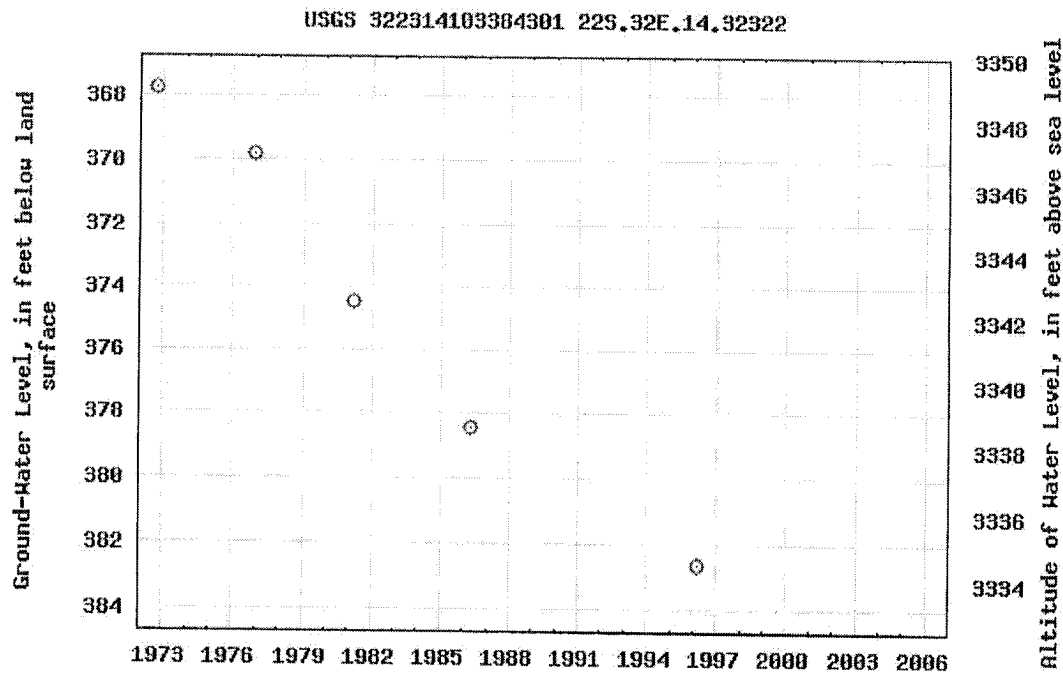

Provisional Data Subject to Revision

41336

Water
ResourcesNational Water Information
System: Web InterfaceData Category:
Ground WaterGeographic Area:
New Mexico

GO

Ground-water levels for New Mexico

Search Results -- 1 sites found

Search Criteria

site_no list = • 322702103344001

Save file of selected sites to local disk for future upload

USGS 322702103344001 21S.33E.28.12443

Available data for this site Ground-water: Field measurements

GO

Lea County, New Mexico

Hydrologic Unit Code 13070007

Latitude 32°27'02", Longitude 103°34'40" NAD27

Land-surface elevation 3,688.00 feet above sea level NGVD29

The depth of the well is 224 feet below land surface.

This well is completed in the CHINLE FORMATION (231CHNL) local
aquifer.

Output formats

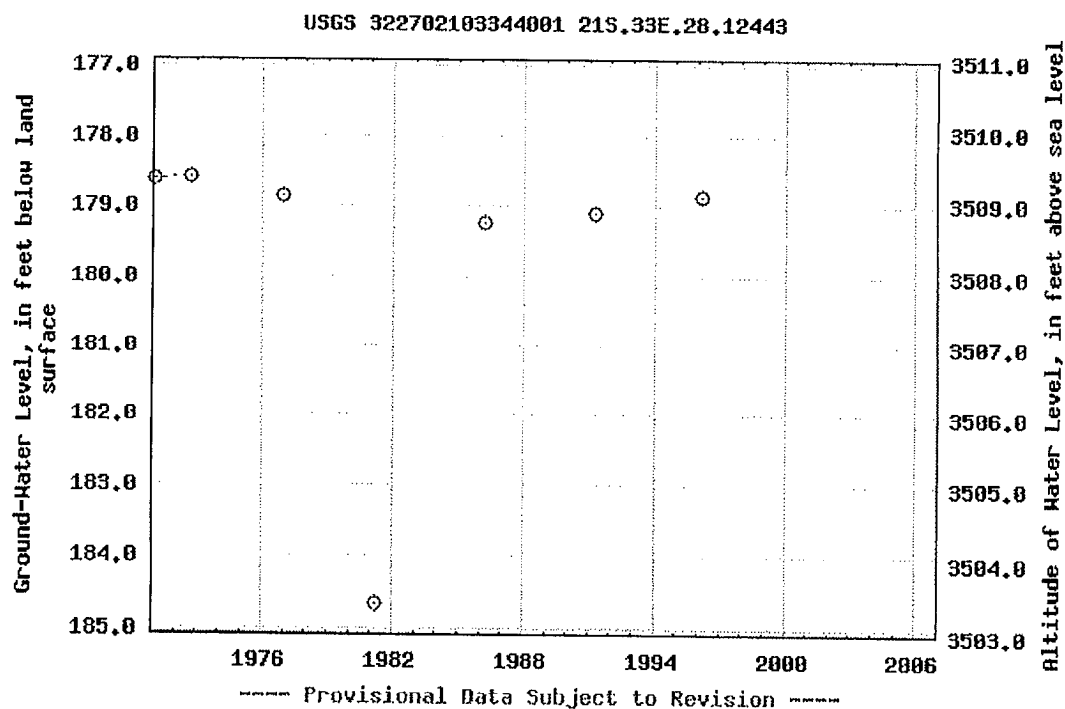
[Table of data](#)[Tab-separated data](#)[Graph of data](#)[Reselect period](#)

12/20/06

Water
ResourcesNational Water Information
System: Web InterfaceData Category:
Ground WaterGeographic Area:
New Mexico

GO

Ground-water levels for New Mexico

Search Results -- 1 sites found

Search Criteria

site_no list = • 322325103313301

Save file of selected sites to local disk for future upload

USGS 322325103313301 22S.33E.13.23131

Available data for this site

Ground-water: Field measurements

GO

Lea County, New Mexico

Hydrologic Unit Code 13070007

Latitude 32°23'25", Longitude 103°31'33" NAD27

Land-surface elevation 3,514.00 feet above sea level NGVD29

The depth of the well is 508 feet below land surface.

This well is completed in the CHINLE FORMATION (231CHNL) local
aquifer.

Output formats

Table of data

Tab-separated data

Graph of data

Reselect period

