

District I
1625 N. French Dr., Hobbs, NM 88240
District II
1301 W. Grand Avenue, Artesia, NM 88210
District III
1000 Rio Brazos Road, Aztec, NM 87410
District IV
1220 S. St. Francis Dr., Santa Fe, NM 87505

State of New Mexico
Energy Minerals and Natural Resources

Form C-144
June 1, 2004

Oil Conservation Division
1220 South St. Francis Dr.
Santa Fe, NM 87505

For drilling and production facilities, submit to appropriate NMOCD District Office.
For downstream facilities, submit to Santa Fe office

Pit or Below-Grade Tank Registration or Closure

Is pit or below-grade tank covered by a "general plan"? Yes ☒ No ☐

Type of action: Registration of a pit or below-grade tank ☐ Closure of a pit or below-grade tank ☒

Operator: Yates Petroleum Corporation Telephone: 505-748-4500 e-mail address: mikes@ypcnm.com

Address: 105 South 4th Street, Artesia, N.M. 88210

Facility or well name: Cleary AKC Federal #1 API #: 30-025-24823 U/L or Qtr/Qtr J Sec 17 T 22S R 32E

County: LEA Latitude 32.38975 Longitude 103.69408 NAD: 1927 ☒ 1983 ☐

Surface Owner: Federal ☒ State ☐ Private ☐ Indian ☐

Pit

Type: Drilling ☒ Production ☐ Disposal ☐

Work over ☐ Emergency ☐

Lined ☒ Unlined ☐

Liner type: Synthetic ☒ Thickness 12 mil Clay ☐

Pit Volume _____ bbl

Below-grade tank

Volume: _____ bbl Type of fluid: _____

Construction material: _____

Double-walled, with leak detection? Yes ☐ If not, explain why not. _____

Depth to ground water (vertical distance from bottom of pit to seasonal high water elevation of ground water.)

Less than 50 feet

(20 points)

50 feet or more, but less than 100 feet

(10 points)

100 feet or more

(0 points) XXXX

Wellhead protection area: (Less than 200 feet from a private domestic water source, or less than 1000 feet from all other water sources.)

Yes

(20 points)

No

(0 points) XXXX

Distance to surface water: (horizontal distance to all wetlands, playas, irrigation canals, ditches, and perennial and ephemeral watercourses.)

Less than 200 feet

(20 points)

200 feet or more, but less than 1000 feet

(10 points)

1000 feet or more

(0 points) XXXX

Ranking Score (Total Points)

0 POINTS

If this is a pit closure: (1) Attach a diagram of the facility showing the pit's relationship to other equipment and tanks. (2) Indicate disposal location: (check the onsite box if you are burying in place) onsite ☒ offsite ☐ If offsite, name of facility NA. (3) Attach a general description of remedial action taken including remediation start date and end date.

(4) Groundwater encountered: No ☐ Yes ☐ If yes, show depth below ground surface _____ ft. and attach sample results.

(5) Attach soil sample results and a diagram of sample locations and excavations.

Additional Comments: Closure work plan for encapsulation trench. The drilling pit material will be excavated & stockpiled. An encapsulation trench will be excavated and lined with a 12 mil. synthetic liner on former drilling pit site. Drilling pit contents will then be emplaced into the encapsulation trench. A 20 mil synthetic liner will then be placed over the pit contents with a minimum of a 3' over lap of the underlying trench areas. The encapsulation trench will then be backfilled to grade using a minimum of 3' of clean soil and like material. A one call and 48 hour notice will be provided to the Oil Conservation Division before pit closure actions begin.

Pit Closure actions to begin by NA. Ending date NA

Pit will be reopened and closed per OCD requirements

I hereby certify that the information above is true and complete to the best of my knowledge and belief. I further certify that the above-described pit or below-grade tank has been/will be constructed or closed according to NMOCD guidelines ☐, a general permit ☒, or an (attached) alternative OCD-approved plan ☐.

Date: 03/19/2007

Printed Name/Title Mike Stubblefield / Environmental Regulatory Agent

Signature Mike Stubblefield

Your certification and NMOCD approval of this application/closure does not relieve the operator of liability should the contents of the pit or tank contaminate ground water or otherwise endanger public health or the environment. Nor does it relieve the operator of its responsibility for compliance with any other federal, state, or local laws and/or regulations.

Approval:

Printed Name/Title GARY W. WINK / STAFF MGR

Signature Gary W. Wink

Date: 3/23/07

New Mexico Office of the State Engineer

POD Reports and Downloads

CLEARLY AKC FEDERAL #1

30-025-24823

Township: 22S Range: 32E Sections:

NAD27 X: Y: Zone: Search Radius:

County: Basin: Number: Suffix:

Owner Name: (First) (Last) ☐ Non-Domestic ☐ Domestic ☒ All

POD / Surface Data Report

Avg Depth to Water Report

Water Column Report

Clear Form

iWATERS Menu

Help

AVERAGE DEPTH OF WATER REPORT 02/16/2007

Bsn	Tws	Rng	Sec	Zone	X	Y	Wells	(Depth Water in Feet)		
								Min	Max	Avg
C	22S	32E	14				2	340	360	350
<div></div>										

Record Count: 3



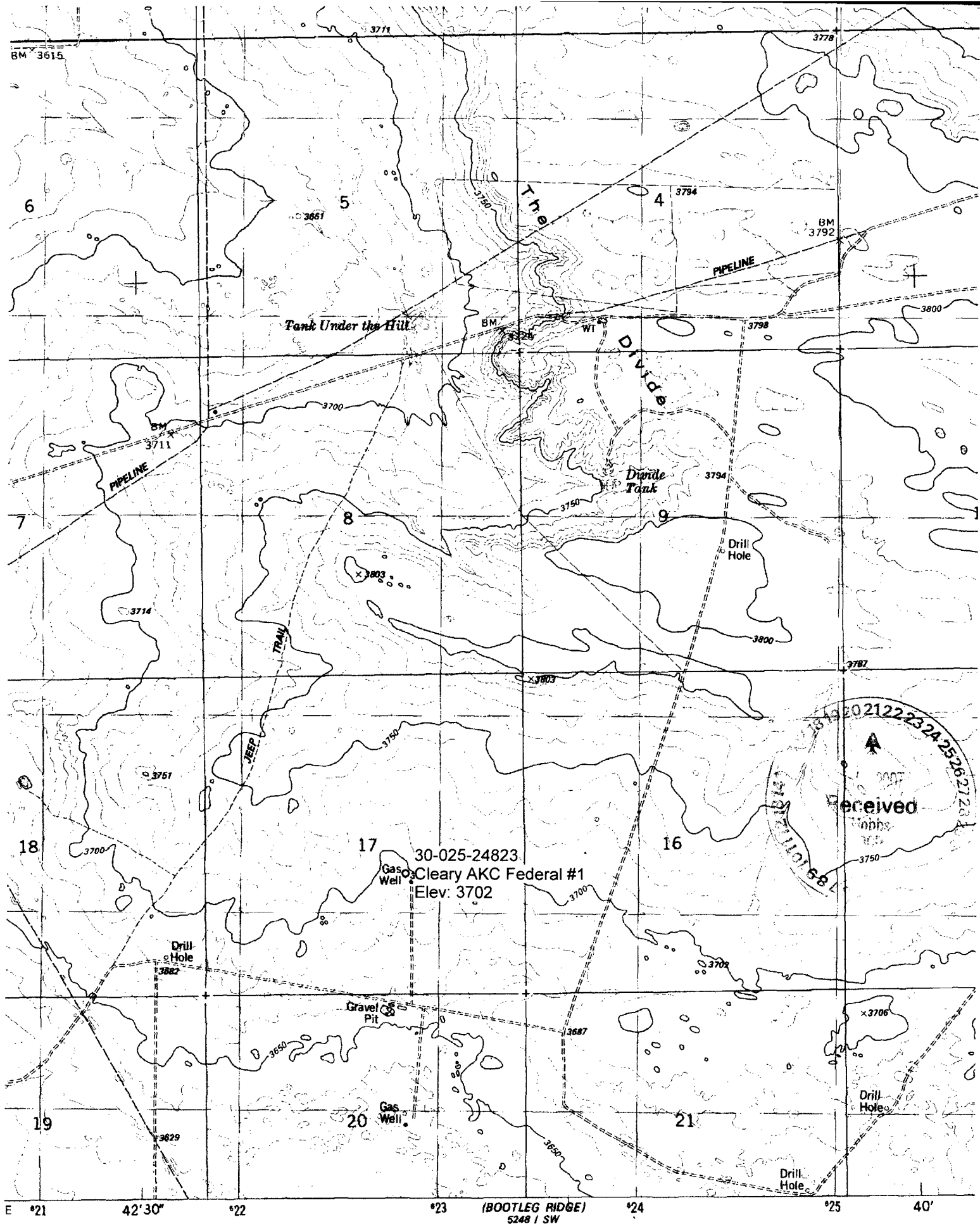

18 19 20 21 22 23 24 25
 10110158
 Received
 10/1/58

E °21 42'30" °22 (BOOTLEG RIDGE) °24 °25 40'
 5248 / SW
 SCALE 1:24 000
 "The Divide; NM" Scale: 1" = 0.379Mi 610Mt 2,000Ft, 1 Mi = 2.640" , 1 cm = 240Mt 0 1 MILE