

District I
1625 N. French Dr., Hobbs, NM 88240
District II
1301 W. Grand Avenue, Artesia, NM 88210
District III
1000 Rio Brazos Road, Aztec, NM 87410
District IV
1220 S. St. Francis Dr., Santa Fe, NM 87505

State of New Mexico
Energy Minerals and Natural Resources

Oil Conservation Division
1220 South St. Francis Dr.
Santa Fe, NM 87505

Form C-144
June 1, 2004

For drilling and production facilities, submit to
appropriate NMOCD District Office.
For downstream facilities, submit to Santa Fe
office

Pit or Below-Grade Tank Registration or Closure

Is pit or below-grade tank covered by a "general plan"? Yes ☒ No ☐

Type of action: Registration of a pit or below-grade tank ☐ Closure of a pit or below-grade tank ☐

Operator: Apache Corp. Telephone: 918.491.4900 e-mail address: seay ot @ leaco . net
Address: 6120 S. Yale Tulsa OK 74136
Facility or well name: Gulf Hill #8 API #: 30.025.37983 U/L or Qtr/Qtr J Sec 4 T 21 R 37
County: Lea Latitude 32° 30' 28" Longitude 103° 09' 59" NAD: 1927 ☒ 1983 ☐
Surface Owner: Federal ☐ State ☐ Private ☒ Indian ☐

Pit
Type: Drilling ☒ Production ☐ Disposal ☐
Workover ☐ Emergency ☐
Lined ☒ Unlined ☐
Liner type: Synthetic ☒ Thickness 12 mil Clay ☐
Pit Volume 7000 bbl

Below-grade tank
Volume: _____ bbl Type of fluid: _____
Construction material: _____
Double-walled, with leak detection? Yes ☐ If not, explain why not: _____

Depth to ground water (vertical distance from bottom of pit to seasonal
high water elevation of ground water.) 62 ft

| | |
|---|-------------|
| Less than 50 feet | (20 points) |
| 50 feet or more, but less than 100 feet | (10 points) |
| 100 feet or more | (0 points) |

Wellhead protection area: (Less than 200 feet from a private domestic
water source, or less than 1000 feet from all other water sources.)

| | |
|-----|-------------|
| Yes | (20 points) |
| No | (0 points) |

Distance to surface water: (horizontal distance to all wetlands, plays,
irrigation canals, ditches, and perennial and ephemeral watercourses.)

| | |
|---|-------------|
| Less than 200 feet | (20 points) |
| 200 feet or more, but less than 1000 feet | (10 points) |
| 1000 feet or more | (0 points) |

Ranking Score (Total Points)

10

If this is a pit closure: (1) Attach a diagram of the facility showing the pit's relationship to other equipment and tanks. (2) Indicate disposal location: (check the onsite box if
our are burying in place) onsite ☒ offsite ☐ If offsite, name of facility: _____ (3) Attach a general description of remedial action taken including
emediation start date and end date. (4) Groundwater encountered: No ☐ Yes ☐ If yes, show depth below ground surface _____ ft. and attach sample results.
5) Attach soil sample results and a diagram of sample locations and excavations.

Additional Comments: Revised Closure: Apache would like to deep bury on location due
to new water data. One plan is to excavate a trench adjacent to the drilling
pit line trench with 12 mil plastic, put contents of drilling pit in trench, cover
trench with 20 mil plastic and 3 ft. of clean soil. contents & level
Notify O&D when starting project and file survey notice after closing
will begin soon after approval.

I hereby certify that the information above is true and complete to the best of my knowledge and belief. I further certify that the above-described pit or below-grade tank
has been/will be constructed or closed according to NMOCD guidelines ☐, a general permit ☒, or an (attached) alternative O&D-approved plan ☐.

Date: 2/27/07

Printed Name/Title Eddie W Seay Agent

Signature Eddie W Seay

Your certification and NMOCD approval of this application/closure does not relieve the operator of liability should the contents of the pit or tank contaminate ground water or
otherwise endanger public health or the environment. Nor does it relieve the operator of its responsibility for compliance with any other federal, state, or local laws and/or
regulations.

Approval:

Printed Name/Title L. JOHNSON - ENSURE ENGR

Signature L. Johnson

Date: 2.27.07

ARGON LABORATORIES

Analysis Report Sheet

Instrument: dx-100

Analyst: hc

Client: Safety & Environmental Solutions, Inc.

Project Name: GULF HILL #8

Project No.: PSS-07-006

300.0 - Anions

B703004

Matrix: Water

Units: MG/Kg

Analysis Date:

03-19-07

Sample ID Lab # Chloride

#1.6 -01

39

#2.6 -02

59

#3.6 -03

55

#4.6 04

48

#5.6 05

44

#6.6 06

40

CHLORIDE BLANK

<10

Method

Lab No.

Lab ID

Analyte

MS / MSD

RPD

LCSID

Analyte

LCS/LCSD

RPD

APACHE GULF HILL #8

→ N

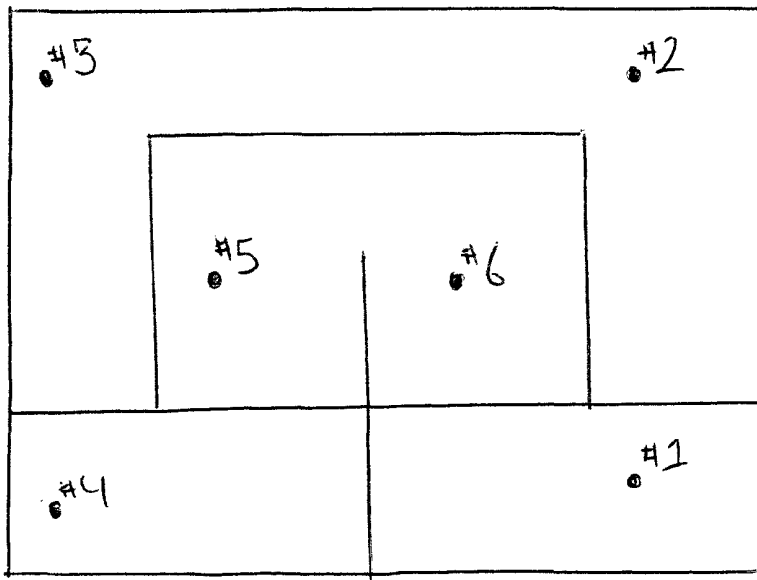

FIELD CHLORIDES

#1.6' - 272

#2.6' - <120

#3.6' - <120

#4.6' - <120

#5.6' - <120

#6.6' - <120

CLOSURE
FINAL APPROVAL
3.21.07 → JG