

UNITED STATES
DEPARTMENT OF THE INTERIOR **OCD-HOBBS**
BUREAU OF LAND MANAGEMENTFORM APPROVED
OMB No. 1004-0137
Expires: March 31, 2007**SUNDRY NOTICES AND REPORTS ON WELLS**

Do not use this form for proposals to drill or to re-enter an abandoned well. Use Form 3160-3 (APD) for such proposals.

SUBMIT IN TRIPLICATE- Other instructions on reverse side.1. Type of Well
☒ Oil Well ☐ Gas Well ☐ Other

2. Name of Operator Mar Oil and Gas Corp

3a. Address
PO Box 5156 Santa Fe, New Mexico 875023b. Phone No. (include area code)
505-989-19774. Location of Well (Footage, Sec., T., R., M., or Survey Description)
660 FNL X 1980 FWL
Unit Letter C, Section 4, T10S, R37E
Lea County, New Mexico5. Lease Serial No.
NM-0100236A

6. If Indian, Allottee or Tribe Name

7. If Unit or CA/Agreement, Name and/or No.

8. Well Name and No.
Federal 4 # 29. API Well No.
30-025-2591410. Field and Pool, or Exploratory Area
Sawyer San Andres; West11. County or Parish, State
Lea County, New Mexico**12. CHECK APPROPRIATE BOX(ES) TO INDICATE NATURE OF NOTICE, REPORT, OR OTHER DATA**

TYPE OF SUBMISSION	TYPE OF ACTION			
<input checked="" type="checkbox"/> Notice of Intent	<input type="checkbox"/> Acidize	<input type="checkbox"/> Deepen	<input type="checkbox"/> Production (Start/Resume)	<input type="checkbox"/> Water Shut-Off
<input type="checkbox"/> Subsequent Report	<input type="checkbox"/> Alter Casing	<input type="checkbox"/> Fracture Treat	<input type="checkbox"/> Reclamation	<input type="checkbox"/> Well Integrity
<input type="checkbox"/> Final Abandonment Notice	<input type="checkbox"/> Casing Repair	<input type="checkbox"/> New Construction	<input type="checkbox"/> Recomplete	<input type="checkbox"/> Other
	<input type="checkbox"/> Change Plans	<input type="checkbox"/> Plug and Abandon	<input type="checkbox"/> Temporarily Abandon	
	<input type="checkbox"/> Convert to Injection	<input type="checkbox"/> Plug Back	<input checked="" type="checkbox"/> Water Disposal	

13. Describe Proposed or Completed Operation (clearly state all pertinent details, including estimated starting date of any proposed work and approximate duration thereof. If the proposal is to deepen directionally or recompleat horizontally, give subsurface locations and measured and true vertical depths of all pertinent markers and zones. Attach the Bond under which the work will be performed or provide the Bond No. on file with BLM/BIA. Required subsequent reports shall be filed within 30 days following completion of the involved operations. If the operation results in a multiple completion or recompleat in a new interval, a Form 3160-4 shall be filed once testing has been completed. Final Abandonment Notices shall be filed only after all requirements, including reclamation, have been completed, and the operator has determined that the site is ready for final inspection.)

Mar Oil and Gas Corp is requesting approval to dispose of water produced at this well in the Mar Oil and Gas Corp. Pearl Marr # 1 SWD (API # 30-025-23247) located 660 FSL X 660 FEL, Unit Letter P, Section 33, T9S, R37E Lea County, New Mexico..The Pearl Marr #1 is permitted with the NMOCD (SWD-372) .
Please see Attachment

14. I hereby certify that the foregoing is true and correct
Name (Printed/Typed)

Billy E. Prichard

Title Foreman

Signature



Date

5/10/07

THIS SPACE FOR FEDERAL OR STATE OFFICE USE

Approved by

Conditions of approval, if any, are attached. Approval of this notice does not warrant or certify that the applicant holds legal or equitable title to those rights in the subject lease which would entitle the applicant to conduct operations thereon.

Title

Office

Title 18 U.S.C. Section 1001 and Title 43 U.S.C. Section 1212, make it a crime for any person knowingly and willfully to make to any department or agency of the United States any false, fictitious or fraudulent statements or representations as to any matter within its jurisdiction.

(Instructions on page 2)

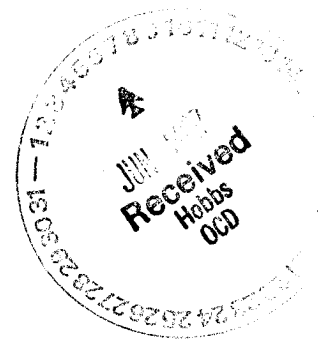

WATER PRODUCTION & DISPOSAL INFORMATION

In order to process your disposal request, the following information must be completed:

1. Names(s) of all formation(s) producing water on the lease.
West Sawyer San Andres
2. Amount of water produced from all formations in barrels per day.
10-12 BWPD
3. A Current water analysis of produced water from all zones showing at least the total dissolved solids, ph, and the concentrations of chlorides and sulfates.
Please see attached water analysis
4. How water is stored on the lease.
Water is not stored on the lease, it is moved directly to Pearl Marr disposal storage
5. How water is moved to the disposal facility.
Seperator pressure is used to move the water to the Pearl Marr disposal
6. Identify the Disposal Facility by:
 - A. Facility Operator Name Mar Oil and Gas Corp
 - B. Name of facility of well name & number Pearl Marr SWD # 1
 - C. Type of facility of well (WDW)(WIW), etc. WDW
 - D. Location by $\frac{1}{4}$, $\frac{1}{4}$, Section, Township and Range SE,SE Section 33, T9S,R37E Lea County, New Mexico
7. Attach a copy of the State issued permit for the Disposal Facility.
See copy of NMOCD SWD-372

Submit all of the above required information to this office, 414 West Taylor, Hobbs, NM 88240, on a Sundry Notice Form 3160-5, 1 Original and 5 copies, within the required time frame. (This form may be used as an attachment to the Sundry Notice.) Call (505) 393-3612 if you need to further discuss this matter.

Federal 4 # 2
Facility Diagram
Located in SE NW Section 4, T10S, R37E
Lea County, New Mexico
NM-0100236A

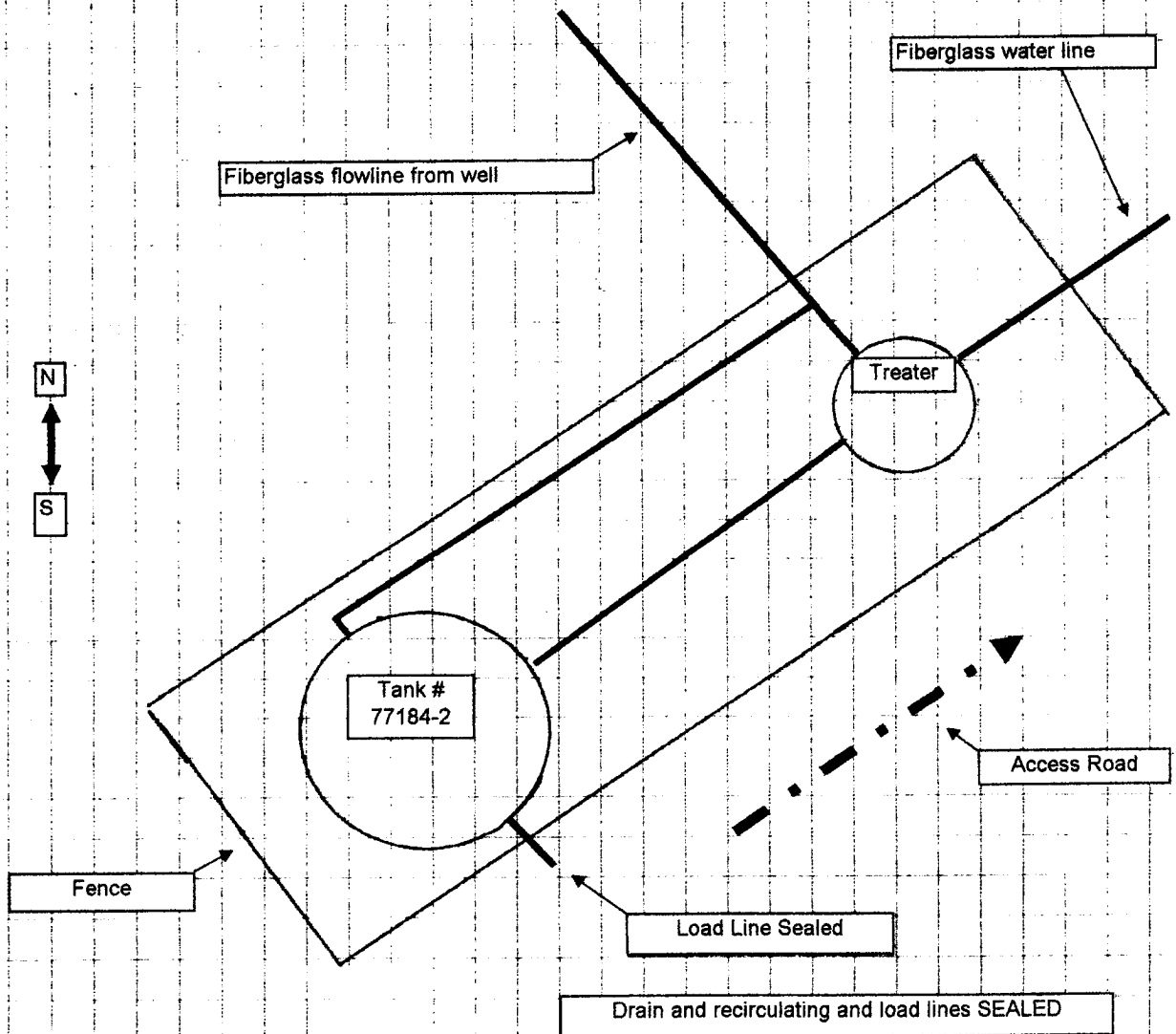

Mar Oil and Gas Corp
Federal 4 # 2
Off Lease Salt Water Disposal

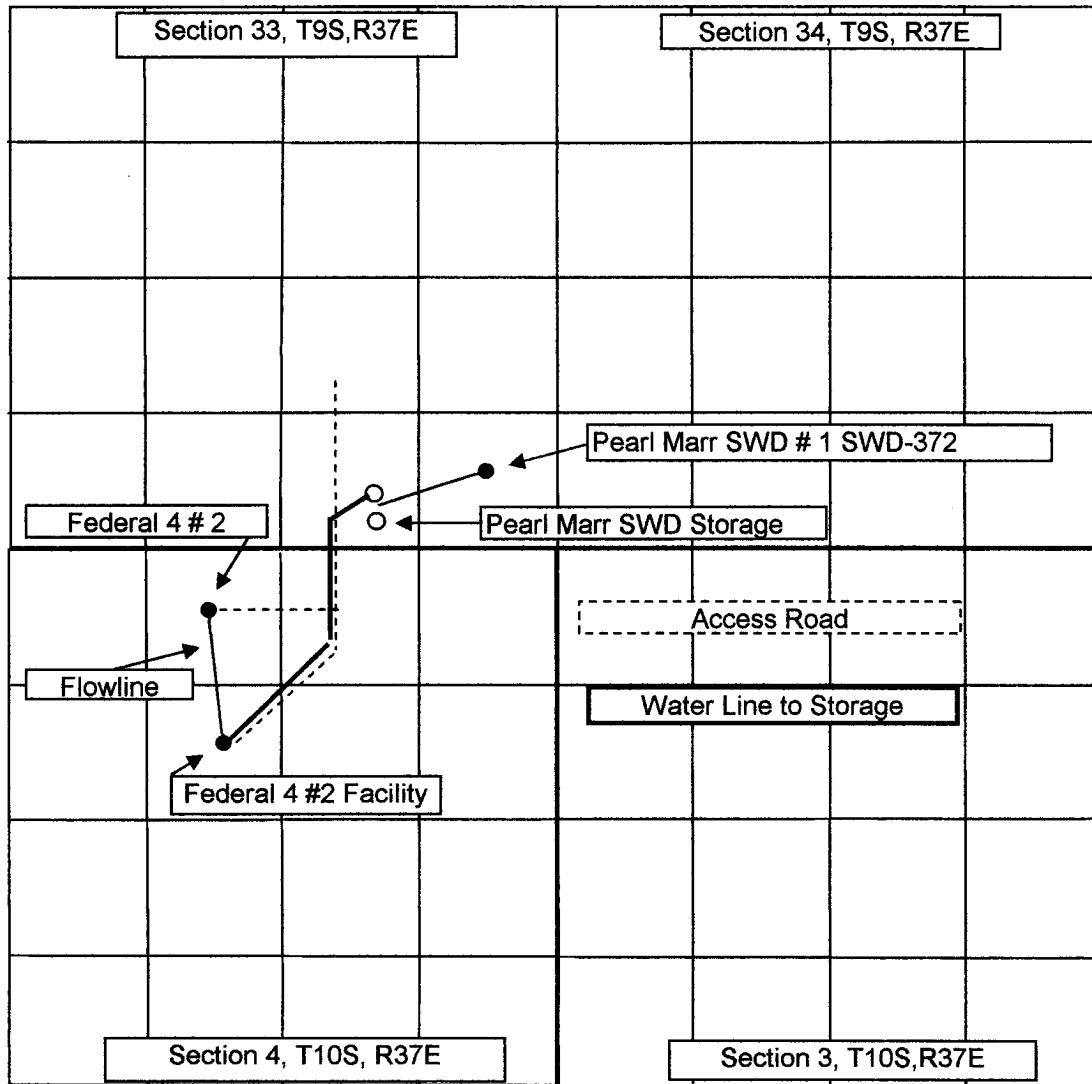

InterChem

3803 Mankins Ave. - Odessa, TX

WATER ANALYSIS REPORT

SAMPLE

Oil Co. : MAR Oil & Gas
 Lease : Fed4
 Well No.: 2
 Location:
 Attention:

Date Sampled : 10-May-2007
 Date Analyzed: 14-May-2007
 Lab ID Number: May1407.001- 1
 Salesperson :
 Requested By : Permian Treating Chemicals, Inc.
 File Name : May1407.001

ANALYSIS

1. Ph 5.880
2. Specific Gravity 60/60 F. 1.163
3. CACO3 Saturation Index @ 80F 0.824 Moderate
 @140F 2.324 Severe

Dissolved Gasses

4. Hydrogen Sulfide
5. Carbon Dioxide
6. Dissolved Oxygen

MG/L. EQ. WT. *MEQ/L

Present
 Not Determined
 Not Determined

Cations

- | | | | | | | |
|-----|-----------|--------|--------------|----------------|----------|----------|
| 7. | Calcium | (Ca++) | | 10,317 | / 20.1 = | 513.28 |
| 8. | Magnesium | (Mg++) | | 4,172 | / 12.2 = | 341.97 |
| 9. | Sodium | (Na+) | (Calculated) | 67,614 | / 23.0 = | 2,939.74 |
| 10. | Barium | (Ba++) | | Not Determined | | |

Anions

- | | | | | | | |
|-----|----------------------------------|---------|--|----------------|----------|--------------------|
| 11. | Hydroxyl | (OH-) | | 0 | / 17.0 = | 0.00 |
| 12. | Carbonate | (CO3=) | | 0 | / 30.0 = | 0.00 |
| 13. | Bicarbonate | (HCO3-) | | 537 | / 61.1 = | 8.79 |
| 14. | Sulfate | (SO4=) | | 550 | / 48.8 = | 11.27 |
| 15. | Chloride | (Cl-) | | 133,970 | / 35.5 = | 3,773.80 |
| 16. | Total Dissolved Solids | | | 217,160 | | |
| 17. | Total Iron | (Fe) | | 2.00 | / 18.2 = | 0.11 |
| 18. | Manganese | (Mn++) | | Not Determined | | |
| 19. | Total Hardness as CaCO3 | | | 42,938 | | |
| 20. | Resistivity @ 75 F. (Calculated) | | | | | 0.001 Ohm · meters |

LOGARITHMIC WATER PATTERN

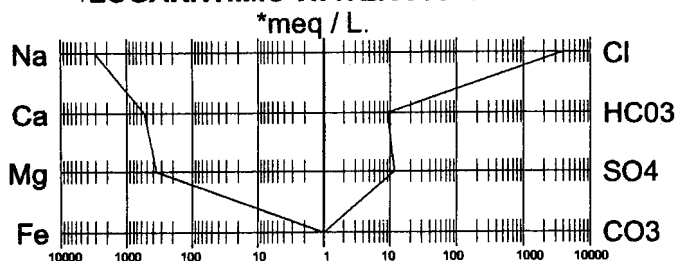

Calcium Sulfate Solubility Profile

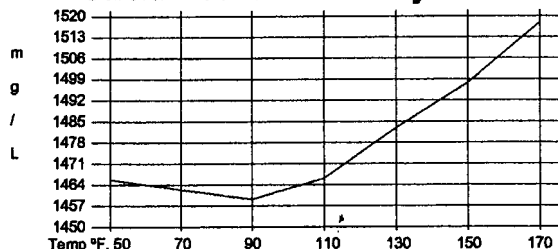

PROBABLE MINERAL COMPOSITION

COMPOUND	*meq/L	X	EQ. WT.	=	mg/L.
Ca(HCO3)2	8.79		81.04		712
CaSO4	11.27		68.07		767
CaCl2	493.22		55.50		27,374
Mg(HCO3)2	0.00		73.17		0
MgSO4	0.00		60.19		0
MgCl2	341.97		47.62		16,284
NaHCO3	0.00		84.00		0
NaSO4	0.00		71.03		0
NaCl	2,938.61		58.46		171,791

* milliequivalents per Liter

Kevin Byrne, Analyst