

District I  
1625 N. French Dr., Hobbs, NM 88240  
District II  
1301 W. Grand Avenue, Artesia, NM 88210  
District III  
1000 Rio Brazos Road, Aztec, NM 87410  
District IV  
1220 S. St. Francis Dr., Santa Fe, NM 87505

State of New Mexico  
Energy Minerals and Natural Resources

Oil Conservation Division  
1220 South St. Francis Dr.  
Santa Fe, NM 87505

Form C-101  
Revised June 10, 2003

Submit to appropriate District Office  
State Lease - 6 Copies  
Fee Lease - 5 Copies

☐ AMENDED REPORT

**APPLICATION FOR PERMIT TO DRILL, RE-ENTER, DEEPEN, PLUGBACK, OR ADD A ZONE**

<sup>1</sup> Operator Name and Address L.E. Jones Operating, Inc. P.O. Box 1185 Duncan, OK 73534		<sup>2</sup> OGRID Number 180930
<sup>3</sup> Property Code 32985		<sup>4</sup> Property Name McNeill "B"
		<sup>5</sup> API Number 30-025-36426
		<sup>6</sup> Well No. 1

**<sup>7</sup> Surface Location**

UL or lot no.	Section	Township	Range	Lot Idn	Feet from the	North/South line	Feet from the	East/West line	County
J	33	19S	38E		1655	South	1732	East	Lea

**<sup>8</sup> Proposed Bottom Hole Location If Different From Surface**

UL or lot no.	Section	Township	Range	Lot Idn	Feet from the	North/South line	Feet from the	East/West line	County

<sup>9</sup> Proposed Pool 1 Nadine; Drinkard-Abo	<sup>10</sup> Proposed Pool 2
--	-------------------------------

<sup>11</sup> Work Type Code N	<sup>12</sup> Well Type Code D	<sup>13</sup> Cable/Rotary R	<sup>14</sup> Lease Type Code P	<sup>15</sup> Ground Level Elevation 3588'
<sup>16</sup> Multiple N	<sup>17</sup> Proposed Depth 8000'	<sup>18</sup> Formation Drinkard/Abo	<sup>19</sup> Contractor Star Drilling	<sup>20</sup> Spud Date 9-31-03

**<sup>21</sup> Proposed Casing and Cement Program**

Hole Size	Casing Size	Casing weight/foot	Setting Depth	Sacks of Cement	Estimated TOC
11"	8-5/8"	32.00	1625'	850	Surface
7-7/8"	5-1/2"	15.50	7700'	1600	Surface

<sup>22</sup> Describe the proposed program. If this application is to DEEPEN or PLUG BACK, give the data on the present productive zone and proposed new productive zone.

Describe the blowout prevention program, if any. Use additional sheets if necessary.

Drill well to a sufficient depth to evaluate Drinkard Formation. After reaching total depth, run open hole logs. Run 5-1/2" casing set to total depth. Perforate, test & stimulate as necessary to establish production.

Permit Expires 1 Year From Approval  
Date Unless Drilling Underway

<sup>23</sup> I hereby certify that the information given above is true and complete to the best of my knowledge and belief.		OIL CONSERVATION DIVISION	
Signature: <i>Dan W. Hammond</i>		Approved by: ORIGINAL SIGNED BY	
Printed name: Dan W. Hammond		PAUL F. KAUTZ	
Title: Production Engineer		Title: PETROLEUM ENGINEER	
E-mail Address: dhammond@texhoma.net		Approval Date: SEP 30 2003	
Date: 9-26-03		Expiration Date:	
Phone: 580-255-1191		Conditions of Approval:	
		Attached <input type="checkbox"/>	

District I  
PO Box 1980, Hobbs, NM 88241-1980

District II  
PO Drawer DD, Artesia, NM 88211-0719

District III  
1000 Rio Brasas Rd., Aztec, NM 87410

District IV  
PO Box 2088, Santa Fe, NM 87504-2088

State of New Mexico  
Energy, Minerals & Natural Resources Department

OIL CONSERVATION DIVISION  
PO Box 2088  
Santa Fe, NM 87504-2088

Form C-102  
Revised February 10, 1994  
Submit to Appropriate District Office  
State Lease - 4 Copies  
Fee Lease - 3 Copies

☐ AMENDED REPORT

WELL LOCATION AND ACREAGE DEDICATION PLAT

1 API Number 30-025-3642.6	2 Pool Code 47510	3 Pool Name Nadine; Drinkard/Abo
4 Property Code 32985	5 Property Name McNeill "B"	6 Well Number No.1
7 OGRID No. 180930	8 Operator Name L.E. Jones Operating Inc.	9 Elevation 3588'

<sup>10</sup>Surface Location

UL or lot no.	Section	Township	Range	Lot Idn	Feet from the	North/South line	Feet from the	East/West line	County
J	33	19 S	38 E		1655	South	1732	East	Lea

<sup>11</sup>Bottom Hole Location If Different From Surface

UL or lot no.	Section	Township	Range	Lot Idn	Feet from the	North/South line	Feet from the	East/West line	County

12 Dedicated Acres 4.7	13 Joint or Infill	14 Consolidation Code	15 Order No.
------------------------------	-----------------------	--------------------------	-----------------

NO ALLOWABLE WILL BE ASSIGNED TO THIS COMPLETION UNIT. ALL INTERESTS HAVE BEEN CONSOLIDATED  
OR A NON-STANDARD UNIT HAS BEEN APPROVED BY THE DIVISION

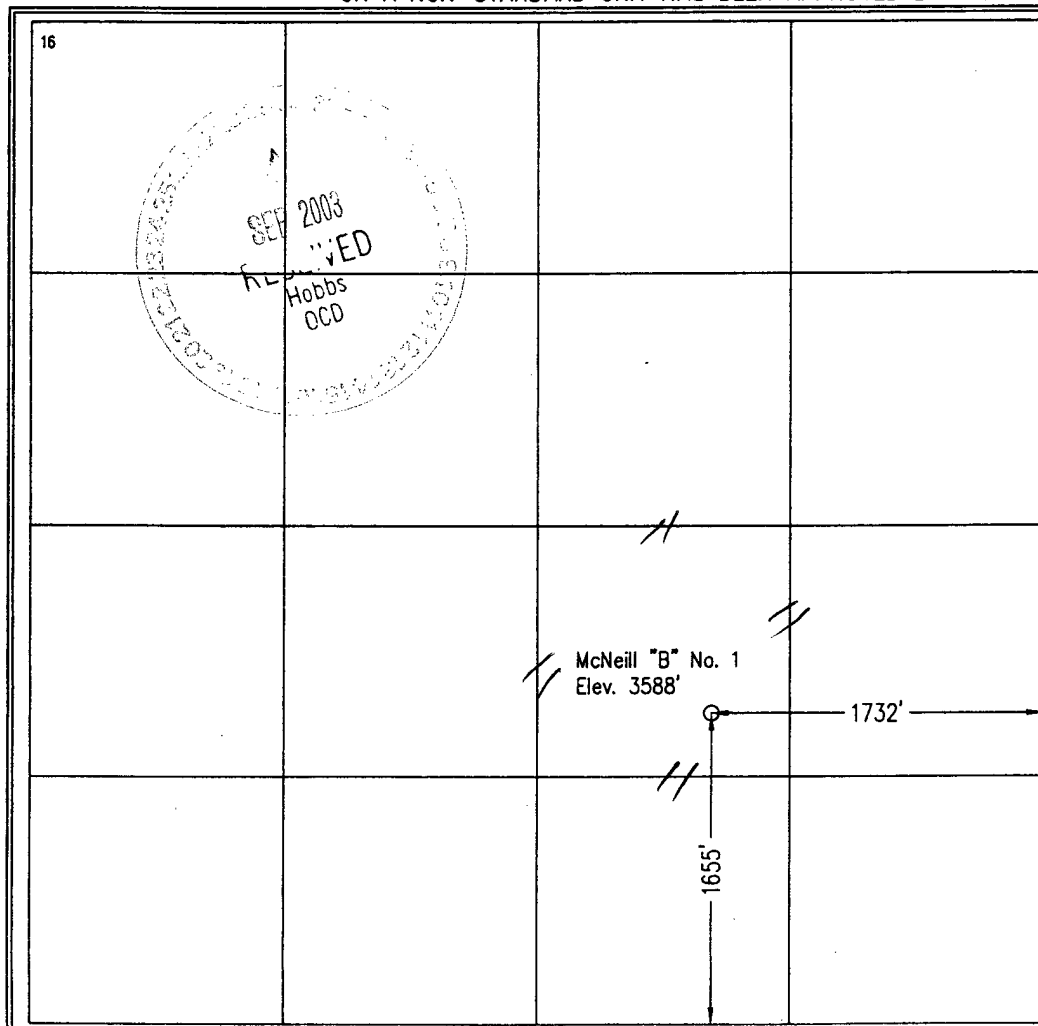

17 OPERATOR CERTIFICATION

I hereby certify that the information contained herein is true and complete to the best of my knowledge and belief.

*[Signature]*  
Signature  
Dan W. Hammond  
Printed Name  
Prod. Eng.  
Title  
9-26-03  
Date

18 SURVEYOR CERTIFICATION

I hereby certify that the well location shown on this plat was plotted from field notes of actual surveys made by me or under my supervision, and that the same is true and correct to the best of my belief.

August 28, 2003  
Date of Survey  
Signature and Seal of Professional Surveyor.  
*[Signature]*  
Certificate Number 10324