



## **Occidental Permian Limited Partnership**

---

June 26, 2007

New Mexico Oil Conservation Division  
District I  
1625 N. French Drive  
Hobbs, New Mexico 88240

Attn: Environmental Engineering

RE: Drilling Pit Closure Plan  
North Hobbs Unit 18-517 Drilling Pit  
API#30-025-38087  
UL 'M', Sec. 18, T-18-S, R-38-E

This letter is being sent as final notification of pit closure for the drilling pit at the above mentioned location. This pit will be closed as follows:

1. All drill cuttings and liner were removed from pit area.
2. All cuttings were disposed of at Sundance Services, Parabo Facility near Eunice, New Mexico.
3. A five spot composite sample was taken in the area below the pit liner.
4. A 2' clay liner will be placed in the bottom of the pit before back filling.
5. Native soils, stored on site, will be used for final backfill of the area.
6. Work should be completed by the end of July 2007.

If you have any questions, or if I can be of further assistance, please contact me at (505) 397-8251.

A handwritten signature in black ink, reading "Steven M. Bishop". The signature is fluid and cursive, with the first name "Steven" being the most prominent.

Steven M. Bishop  
HES Technician/WSAH RMT  
Steven\_Bishop@oxy.com  
(505) 397-8251

Attachments: Final Form C-144  
Diagram of pit and well location  
Cardinal Lab analysis dated 05/09/07 showing initial chloride and TPH non-detect  
Cardinal Lab analysis dated 05/10/07 showing BTEX non-detect  
Cardinal Lab analysis dated 06/18/07 showing final chloride

District I  
1625 N French Dr , Hobbs, NM 88240  
District II  
1301 W. Grand Avenue, Artesia, NM 88210  
District III  
1000 Rio Brazos Road, Aztec, NM 87410  
District IV  
1220 S. St. Francis Dr , Santa Fe, NM 87505

State of New Mexico  
Energy Minerals and Natural Resources

Form C-144  
March 12, 2004

Oil Conservation Division  
1220 South St. Francis Dr.  
Santa Fe, NM 87505

For drilling and production facilities, submit to appropriate NMOCD District Office.  
For downstream facilities, submit to Santa Fe office

**Pit or Below-Grade Tank Registration or Closure**

Is pit or below-grade tank covered by a "general plan"? Yes ☐ No ☒

Type of action Registration of a pit or below-grade tank ☐ Closure of a pit or below-grade tank ☒

Operator: Occidental Permian LTD Telephone: 505.397.8251 e-mail address Steven\_Bishop@oxy.com

Address: 1017 W. Stanolind Road Hobbs, NM 88240

Facility or well name NHU 18-517 API #: 30-025-38087 U/L or Qtr/Qtr Lot 4 Sec 18 T 18 S R 38 E

County: Lea Latitude 32°44'30.67" N Longitude 103°11'36.99" W NAD. 1927 ☒ 1983 ☐ Surface Owner Federal ☐ State ☐ Private ☒ Indian ☐

**Pit**

Type: Drilling ☒ Production ☐ Disposal ☐

Workover ☐ Emergency ☐

Lined ☒ Unlined ☐

Liner type: Synthetic ☒ Thickness 12 mil Clay ☐

8000 bbl

**Below-grade tank**

Volume bbl Type of fluid

Construction material

Double-walled, with leak detection? Yes ☐ If not, explain why not.

Depth to ground water (vertical distance from bottom of pit to seasonal high water elevation of ground water )

Less than 50 feet

(20 points) 20

50 feet or more, but less than 100 feet

(10 points)

100 feet or more

( 0 points)

Wellhead protection area. (Less than 200 feet from a private domestic water source, or less than 1000 feet from all other water sources.)

Yes

(20 points)

No

( 0 points) 0

Distance to surface water (horizontal distance to all wetlands, playas, irrigation canals, ditches, and perennial and ephemeral watercourses.)

Less than 200 feet

(20 points)

200 feet or more, but less than 1000 feet

(10 points)

1000 feet or more

( 0 points) 0

**Ranking Score (Total Points)**

20

**If this is a pit closure:** (1) attach a diagram of the facility showing the pit's relationship to other equipment and tanks (2) Indicate disposal location:

onsite ☐ offsite ☒ If offsite, name of facility Sundance Service, Parabo Facility. (3) Attach a general description of remedial action taken including remediation start date and end date (4) Groundwater encountered. No ☒ Yes ☐ If yes, show depth below ground surface ft. and attach sample results. (5) Attach soil sample results and a diagram of sample locations and excavations

I hereby certify that the information above is true and complete to the best of my knowledge and belief. I further certify that the above-described pit or below-grade tank has been/will be constructed or closed according to NMOCD guidelines ☒, a general permit ☐, or an (attached) alternative OCD-approved plan ☐.

Date: June 26, 2007

Printed Name/Title Steven M Bishop / HES Tech

Signature

*Steven M Bishop*

Your certification and NMOCD approval of this application/closure does not relieve the operator of liability should the contents of the pit or tank contaminate ground water or otherwise endanger public health or the environment Nor does it relieve the operator of its responsibility for compliance with any other federal, state, or local laws and/or regulations

Approval:

Date:

*6/28/07*

Printed Name/Title *CHRIS WILLIAMS / DIST. SUPV.*

Signature

*Chris Williams*

North Hobbs Unit #18-517

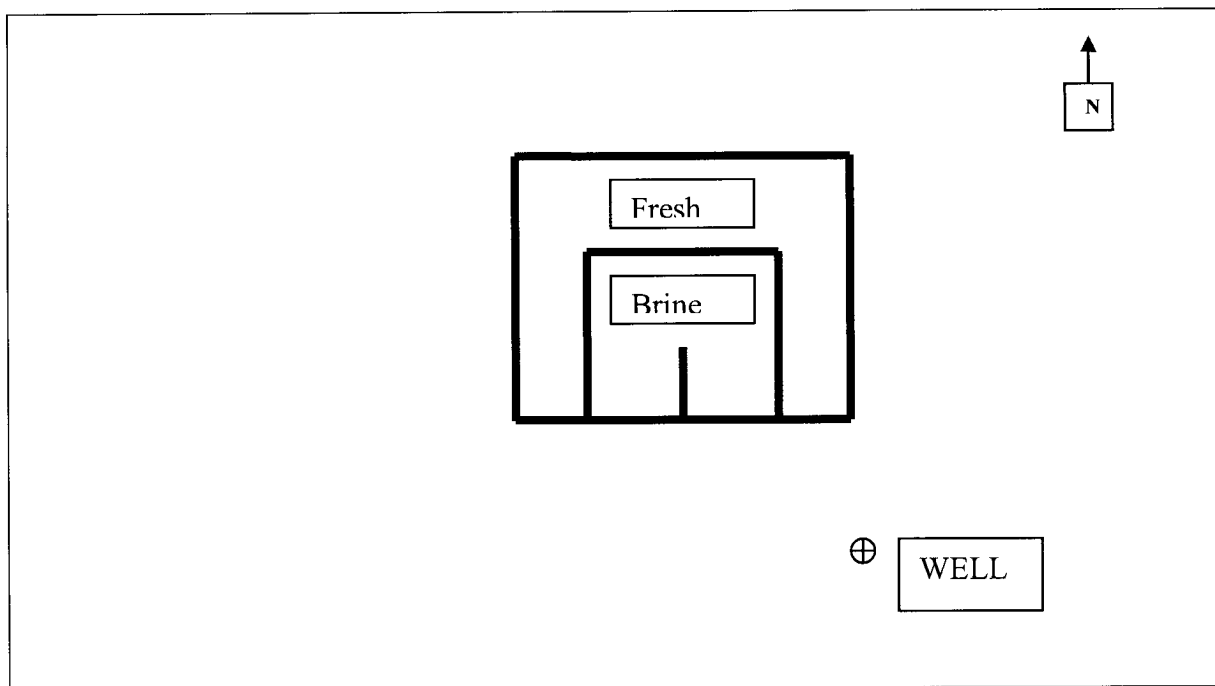

Occidental Permian Ltd.

North Hobbs Unit #18-517

API # 30-025-38087

Unit Letter M, Section 18, T-18-S, R-38-E

N 32°44'30.67", W103°11'36.99"

100' X 100' Pit approximately 50' north of wellhead



# ARDINAL LABORATORIES

PHONE (325) 673-7001 • 2111 BEECHWOOD • ABILENE, TX 79603

PHONE (505) 393-2326 • 101 E MARLAND • HOBBS, NM 88240

ANALYTICAL RESULTS FOR  
OCCIDENTAL PERMIAN LTD. PARTNERSHIP  
ATTN: STEVE BISHOP  
1017 W. STANOLIND ROAD  
HOBBS, NM 88240  
FAX TO: (505) 397-8204

Receiving Date: 05/07/07  
Reporting Date: 05/09/07  
Project Number: NOT GIVEN  
Project Name: NHU 18-517  
Project Location: DRILLING PIT

Sampling Date: 05/07/07  
Sample Type: SOIL  
Sample Condition: COOL & INTACT  
Sample Received By: AB  
Analyzed By: BC/AB

LAB NUMBER	SAMPLE ID	GRO (C <sub>6</sub> -C <sub>10</sub> ) (mg/Kg)	DRO (>C <sub>10</sub> -C <sub>28</sub> ) (mg/Kg)	CI* (mg/Kg)
ANALYSIS DATE		05/08/07	05/08/07	05/08/07
H12563-1	NHU 18-517 PIT	<10.0	<10.0	7840
Quality Control		779	791	500
True Value QC		800	800	500
% Recovery		98.8	97.4	100
Relative Percent Difference		0.9	1.8	1.0

METHODS: TPH GRO & DRO: EPA SW-846 8015 M; CI: Std. Methods 4500-CI-B

\*Analysis performed on a 1:4 w:v aqueous extract.

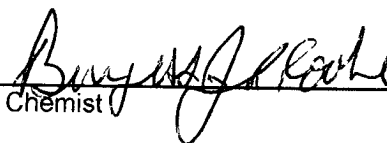
  
Chemist

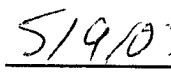
  
Date

H12563A OXY

PLEASE NOTE **Liability and Damages** Cardinal's liability and client's exclusive remedy for any claim arising, whether based in contract or tort, shall be limited to the amount paid by client for analyses. All claims, including those for negligence and any other cause whatsoever shall be deemed waived unless made in writing and received by Cardinal within thirty (30) days after completion of the applicable service. In no event shall Cardinal be liable for incidental or consequential damages, including, without limitation, business interruptions, loss of use, or loss of profits incurred by client, its subsidiaries, affiliates or successors arising out of or related to the performance of services hereunder by Cardinal, regardless of whether such claim is based upon any of the above-stated reasons or otherwise.



PHONE (325) 673-7001 • 2111 BEECHWOOD • ABILENE, TX 79603

PHONE (505) 393-2326 • 101 E MARLAND • HOBBS, NM 88240

ANALYTICAL RESULTS FOR  
OCCIDENTAL PERMIAN LTD. PARTNERSHIP  
ATTN: STEVE BISHOP  
1017 W. STANOLIND ROAD  
HOBBS, NM 88240  
FAX TO: (505) 397-8204

Receiving Date: 05/07/07  
Reporting Date: 05/10/07  
Project Number: NOT GIVEN  
Project Name: NHU 18-517  
Project Location: DRILLING PIT

Sampling Date: 05/07/07  
Sample Type: SOIL  
Sample Condition: COOL & INTACT  
Sample Received By: AB  
Analyzed By: AB

LAB NUMBER	SAMPLE ID	BENZENE (mg/Kg)	TOLUENE (mg/Kg)	ETHYL BENZENE (mg/Kg)	TOTAL XYLENES (mg/Kg)
ANALYSIS DATE		05/09/07	05/09/07	05/09/07	05/09/07
H12563-1	NHU 18-517 PIT	<0.002	<0.002	<0.002	<0.006
Quality Control		0.096	0.095	0.091	0.274
True Value QC		0.100	0.100	0.100	0.300
% Recovery		95.6	95.1	90.7	91.3
Relative Percent Difference		2.5	2.8	2.9	2.9

METHOD: EPA SW-846 8021 B

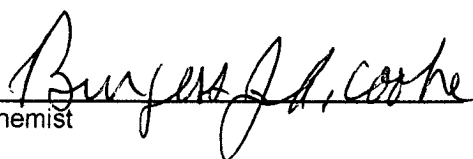
  
Chemist

  
Date

PLEASE NOTE **Liability and Damages** Cardinal's liability and client's exclusive remedy for any claim arising, whether based in contract or tort, shall be limited to the amount paid by client for analyses. All claims, including those for negligence and any other cause whatsoever shall be deemed waived unless made in writing and received by Cardinal within thirty (30) days after completion of the applicable service. In no event shall Cardinal be liable for incidental or consequential damages, including, without limitation, business interruptions, loss of use, or loss of profits incurred by client or its subsidiaries, affiliates or successors arising out of or related to the performance of services hereunder by Cardinal, regardless of whether such claim is based upon any of the above-stated reasons or otherwise.



PHONE (505) 393-2326 • 101 E MARLAND • HOBBS, NM 88240

Receiving Date: 06/18/07  
Reporting Date: 06/18/07  
Project Owner: OXY  
Project Name: NHU 18-517  
Project Location: DRILLING PIT

Analysis Date: 06/18/07  
Sampling Date: 06/18/07  
Sample Type: SOIL  
Sample Condition: COOL & INTACT  
Sample Received By: HM  
Analyzed By: AB

<b>LAB NUMBER</b>	<b>SAMPLE ID</b>	<b>C<sub>T</sub> (mg/Kg)</b>
H12754-1	NHU DRILLING PIT 18-517	3040
Quality Control		500
True Value QC		500
% Recovery		100
Relative Percent Difference		1.0

METHOD: Standard Methods	4500-CrB
--------------------------	----------

Note: Analysis performed on a 1:4 w:v aqueous extract.

Chemist

Date \_\_\_\_\_

H12754 OCC

PLEASE NOTE: Liability and Damages. Cardinal's liability and client's exclusive remedy for any claim arising, whether based in contract or tort, shall be limited to the amount paid by client for analysis. All claims, including those for negligence and any other cause whatsoever shall be deemed waived unless made in writing and received by Cardinal within thirty (30) days after completion of the applicable service. In no event shall Cardinal be liable for incidental or consequential damages, including, without limitation, business interruptions, loss of use, or loss of profits incurred by client, its subsidiaries, affiliates or successors arising out of or related to the performance of services hereunder by Cardinal, regardless of whether such claim is based upon any of the above-stated reasons or otherwise.