

Submit 3 Copies To Appropriate District  
Office  
District I  
1625 N. French Dr., Hobbs, NM 88240  
District II  
1301 W. Grand Ave., Artesia, NM 88210  
District III  
1000 Rio Brazos Rd., Aztec, NM 87410  
District IV  
1220 S. St. Francis Dr., Santa Fe, NM  
87505

State of New Mexico  
Energy, Minerals and Natural Resources

OIL CONSERVATION DIVISION  
1220 South St. Francis Dr.  
Santa Fe, NM 87505  
OCD

Form C-103  
May 27, 2004

<b>SUNDRY NOTICES AND REPORTS ON WELLS</b> (DO NOT USE THIS FORM FOR PROPOSALS TO DRILL OR TO DEEPEN OR PLUG BACK TO A DIFFERENT RESERVOIR. USE "APPLICATION FOR PERMIT" (FORM C-101) FOR SUCH PROPOSALS.)		WELL API NO. 30-025-37560
1. Type of Well: Oil Well <input type="checkbox"/> Gas Well <input checked="" type="checkbox"/> Other		5. Indicate Type of Lease STATE <input checked="" type="checkbox"/> FEE <input type="checkbox"/>
2. Name of Operator Mewbourne Oil Company		6. State Oil & Gas Lease No. VB756
3. Address of Operator PO Box 5270 Hobbs, NM 88240		7. Lease Name or Unit Agreement Name Osudo South 20 State Com
4. Well Location Unit Letter <u>C</u> : <u>660</u> feet from the <u>N</u> line and <u>1980</u> feet from the <u>W</u> line Section <u>20</u> Township <u>21S</u> Range <u>35E</u> NMPM Lea County		8. Well Number #1
11. Elevation (Show whether DR, RKB, RT, GR, etc.) 3649' GL		9. OGRID Number 14744
Pit or Below-grade Tank Application <input type="checkbox"/> or Closure <input type="checkbox"/>		10. Pool name or Wildcat Osudo Strawn South (97396) and Osudo Morrow (82120)
Pit type _____ Depth to Groundwater _____ Distance from nearest fresh water well _____ Distance from nearest surface water _____		
Pit Liner Thickness: _____ mil Below-Grade Tank: Volume _____ bbls; Construction Material _____		

12. Check Appropriate Box to Indicate Nature of Notice, Report or Other Data

NOTICE OF INTENTION TO:

PERFORM REMEDIAL WORK ☐ PLUG AND ABANDON ☐  
TEMPORARILY ABANDON ☐ CHANGE PLANS ☐  
PULL OR ALTER CASING ☐ MULTIPLE COMPL ☐  
OTHER: ☐

SUBSEQUENT REPORT OF:

REMEDIAL WORK ☐ ALTERING CASING ☐  
COMMENCE DRILLING OPNS. ☐ P AND A ☐  
CASING/CEMENT JOB ☐  
OTHER: Commingle Strawn & Morrow ☒

13. Describe proposed or completed operations. (Clearly state all pertinent details, and give pertinent dates, including estimated date of starting any proposed work). SEE RULE 1103. For Multiple Completions: Attach wellbore diagram of proposed completion or recompletion.

Mewbourne Oil Company was producing Strawn perfs @ 11005' to 11045'. Applied for & received DHC approval (#DHC-3890). On 06/06/07, cleaned out isolation sand plug at 12080'. RIH with tubing to 12103'. On 06/14/07, PWOL commingling Osudo Strawn South and Osudo Morrow.

I hereby certify that the information above is true and complete to the best of my knowledge and belief. I further certify that any pit or below-grade tank has been/will be constructed or closed according to NMOCD guidelines ☐, a general permit ☐ or an (attached) alternative OCD-approved plan ☐.

SIGNATURE Kristi Green TITLE Hobbs Regulatory DATE 06/20/07

Type or print name Kristi Green

E-mail address:

Telephone No. 505-393-5905

For State Use Only

APPROVED BY: Chris Williams

OCD DISTRICT SUPERVISOR/GENERAL MANAGER  
TITLE \_\_\_\_\_

DATE AUG 09 2007

Conditions of Approval (if any):



**Attachments to C-107A**

Mewbourne Oil Company  
Osudo South "20" State Com #1  
Unit Letter C, Sec 20 T21S R35E  
Osudo; Strawn South (Gas) and Osudo; Morrow (Gas) Pools  
Lea Co., NM

**C-102 for each zone to be commingled showing its spacing unit and acreage dedication**

**Production curve is attached**

**Estimated production rates and supporting data**

Test Data:

Morrow	11/6/06	200 MCFD, 1 BO, 1 BW: last recorded production
Strawn	5/6/07	100 MCFD, 3 BO, 1 BW: current production

**Data to support allocation method or formula**

Test as shown above for both zones

**Notification list of working, royalty and overriding royalty interests for uncommon interest cases**

No uncommon interests.

**Any additional statements, data or documents required to support commingling**

The well is completed with 5 1/2" OD casing. In order to dually complete the well to recover all economic reserves, the use of small diameter special clearance tubing would be required. Performing a dual completion as described could not be economically justified for a zone with limited deliverability. To produce the Strawn interval (upper zone) up the annulus (5 1/2" - 2 7/8") is not recommended due to liquid loading and insufficient velocity to lift produced fluids with the estimated gas rates listed above. The addition of the Strawn as a commingled zone will prevent waste that would not otherwise be possible due to the increased cost to produce each individual zone. Commingling will prevent early abandonment of each production zone.

DISTRICT I  
1825 N. French Dr., Hobbs, NM 88248

DISTRICT II  
811 South First, Artesia, NM 88210

DISTRICT III  
1000 Rio Brazos Rd., Aztec, NM 87410

DISTRICT IV  
2040 South Pacheco, Santa Fe, NM 87506

State of New Mexico  
Energy, Minerals and Natural Resources Department

Form C-102  
Revised March 17, 1999  
Instruction on back  
Submit to Appropriate District Office  
State Lease - 4 Copies  
Fee Lease - 3 Copies

OIL CONSERVATION DIVISION  
P.O. Box 2088  
Santa Fe, New Mexico 87504-2088

☐ AMENDED REPORT

### WELL LOCATION AND ACREAGE DEDICATION PLAT

API Number <b>30-025-3756D</b>	Pool Code <b>47580 97396</b>	Pool Name <b>OSUDO SOUTH "20" STATE COM.</b>
Property Code <b>35232</b>	Property Name <b>OSUDO SOUTH "20" STATE COM.</b>	Well Number <b>1</b>
OGRID No. <b>14744</b>	Operator Name <b>MEWBOURNE OIL COMPANY</b>	Elevation <b>3649</b>

#### Surface Location

UL or lot No.	Section	Township	Range	Lot Idn	Feet from the	North/South line	Feet from the	East/West line	County
C	20	21S	35E		660	NORTH	1980	WEST	LEA

#### Bottom Hole Location If Different From Surface

UL or lot No.	Section	Township	Range	Lot Idn	Feet from the	North/South line	Feet from the	East/West line	County

Dedicated Acres	Joint or Infill	Consolidation Code	Order No.
320			

NO ALLOWABLE WILL BE ASSIGNED TO THIS COMPLETION UNTIL ALL INTERESTS HAVE BEEN CONSOLIDATED  
OR A NON-STANDARD UNIT HAS BEEN APPROVED BY THE DIVISION

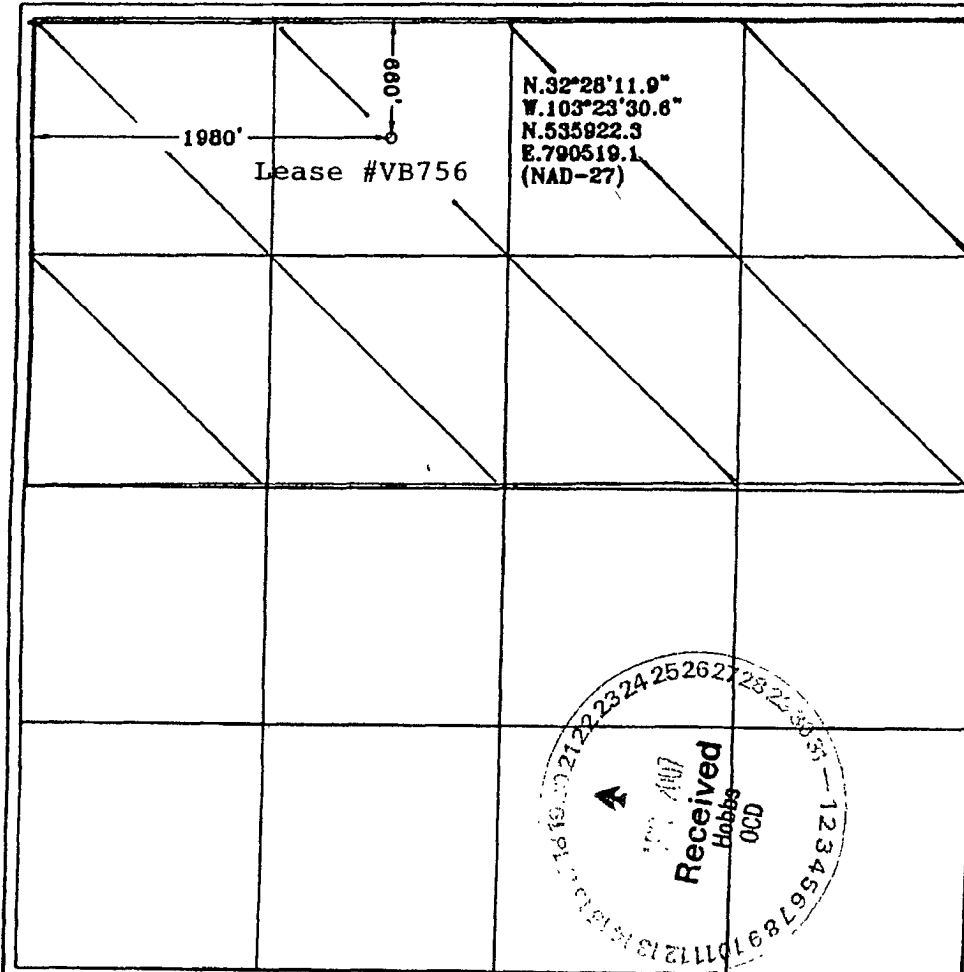

#### OPERATOR CERTIFICATION

I hereby certify the the information  
contained herein is true and complete to the  
best of my knowledge and belief.

*Kristi Green*  
Signature

Kristi Green  
Printed Name  
Hobbs Regulatory  
Title

1/15/07  
Date

#### SURVEYOR CERTIFICATION

I hereby certify that the well location shown  
on this plat was plotted from field notes of  
actual surveys made by me or under my  
supervision, and that the same is true and  
correct to the best of my belief.

8/22/2005

Date Surveyed

Signature & Seal of  
Professional Surveyor

*Herschel L. Jones*  
Herschel L. Jones  
Professional Surveyor  
Certificate No. Herschel - Jones RLS 3640  
OSUDO SOUTH "20" - 1  
GENERAL SURVEYING COMPANY  
PROFESSIONAL LAND SURVEYOR

0 330' 660' 990' 1650' 1980' 2310' 2310' 1980' 1650' 990' 660' 330' 0'

DISTRICT I  
23 N. French Dr., Hobbs, NM 88240  
DISTRICT II  
811 South First, Artesia, NM 88210

DISTRICT III  
1000 Rio Brazos Rd., Aztec, NM 87410

DISTRICT IV  
2040 South Pacheco, Santa Fe, NM 87505

State of New Mexico  
Energy, Minerals and Natural Resources Department

Form C-102  
Revised March 17, 1999  
Instruction on back  
Submit to Appropriate District Office  
State Lease - 4 Copies  
Fee Lease - 3 Copies

OIL CONSERVATION DIVISION  
P.O. Box 2088  
Santa Fe, New Mexico 87504-2088  
Hobbs  
OCD

☐ AMENDED REPORT

### WELL LOCATION AND ACREAGE DEDICATION PLAT

API Number <b>30-025-3756D</b>	Pool Code <b>8212D</b>	Pool Name <b>Osudo Morrow</b>
Property Code <b>35232</b>	Property Name <b>OSUDO SOUTH "20" STATE COM.</b>	
OGRID No. <b>14744</b>	Operator Name <b>MEWBORNE OIL COMPANY</b>	
		Well Number <b>1</b>
		Elevation <b>3649</b>

#### Surface Location

UL or lot No.	Section	Township	Range	Lot Idn	Feet from the	North/South line	Feet from the	East/West line	County
C	20	21S	35E		660	NORTH	1980	WEST	LEA

#### Bottom Hole Location If Different From Surface

UL or lot No.	Section	Township	Range	Lot Idn	Feet from the	North/South line	Feet from the	East/West line	County

Dedicated Acres	Joint or Infill	Consolidation Code	Order No.
320			

NO ALLOWABLE WILL BE ASSIGNED TO THIS COMPLETION UNTIL ALL INTERESTS HAVE BEEN CONSOLIDATED  
OR A NON-STANDARD UNIT HAS BEEN APPROVED BY THE DIVISION

	<b>OPERATOR CERTIFICATION</b>  I hereby certify the the information contained herein is true and complete to the best of my knowledge and belief.  <i>Kristi Green</i> Signature  Kristi Green Printed Name Hobbs Regulatory Title 11/15/05 Date
	<b>SURVEYOR CERTIFICATION</b>  I hereby certify that the well location shown on this plat was plotted from field notes of actual surveys made by me or under my supervision, and that the same is true and correct to the best of my belief.  8/22/2005 Date Surveyed  Signature & Seal of Professional Surveyor   Herschel L. Jones Professional Surveyor Certificate No. 3040 OSUDO SOUTH 20-1 GENERAL SURVEYING COMPANY PROFESSIONAL LAND
	0 330' 680' 990' 1650' 1980' 2310' 2310' 1980' 1650' 990' 660' 330' 0'