

UNITED STATES
DEPARTMENT OF THE INTERIOR
BUREAU OF LAND MANAGEMENT

OCD-HOBBS

FORM APPROVED
OMB No. 1004-0137
Expires March 31, 2007

SUNDRY NOTICES AND REPORTS ON WELLS
**Do not use this form for proposals to drill or to re-enter an
abandoned well. Use Form 3160-3 (APD) for such proposals.**

5. Lease Serial No.
NMLC-030133B

6. If Indian, Allottee or Tribe Name

SUBMIT IN TRIPLICATE – Other instructions on page 2.

1. Type of Well

☒ Oil Well ☐ Gas Well ☐ Other

2. Name of Operator
CHESAPEAKE OPERATING, INC.

ATTN: LINDA GOOD

7. If Unit of CA/Agreement, Name and/or No.

8. Well Name and No.
MILLARD DECK ESTATE 28 FEDERAL 1

9. API Well No.
30-025-38103

3a. Address
P. O. BOX 18496
OKLAHOMA CITY, OK 73154-0496

3b. Phone No. (include area code)
405-767-4275

10. Field and Pool or Exploratory Area
LANGLEY

4. Location of Well (Footage, Sec., T., R., M., or Survey Description)
965' FNL & 1590' FEL, NWNE, SECTION 28, T22S, R36E

11. Country or Parish, State
LEA COUNTY, NEW MEXICO

12. CHECK THE APPROPRIATE BOX(ES) TO INDICATE NATURE OF NOTICE, REPORT OR OTHER DATA

TYPE OF SUBMISSION	TYPE OF ACTION			
<input checked="" type="checkbox"/> Notice of Intent	<input type="checkbox"/> Acidize	<input type="checkbox"/> Deepen	<input type="checkbox"/> Production (Start/Resume)	<input type="checkbox"/> Water Shut-Off
<input checked="" type="checkbox"/> Subsequent Report	<input type="checkbox"/> Alter Casing	<input type="checkbox"/> Fracture Treat	<input type="checkbox"/> Reclamation	<input type="checkbox"/> Well Integrity
<input type="checkbox"/> Final Abandonment Notice	<input type="checkbox"/> Casing Repair	<input type="checkbox"/> New Construction	<input type="checkbox"/> Recomplete	<input checked="" type="checkbox"/> Other <u>Updated Production Facility</u>
	<input type="checkbox"/> Change Plans	<input type="checkbox"/> Plug and Abandon	<input type="checkbox"/> Temporarily Abandon	
	<input type="checkbox"/> Convert to Injection	<input type="checkbox"/> Plug Back	<input type="checkbox"/> Water Disposal	

13. Describe Proposed or Completed Operation: Clearly state all pertinent details, including estimated starting date of any proposed work and approximate duration thereof. If the proposal is to deepen directionally or recompleat horizontally, give subsurface locations and measured and true vertical depths of all pertinent markers and zones. Attach the Bond under which the work will be performed or provide the Bond No. on file with BLM/BIA. Required subsequent reports must be filed within 30 days following completion of the involved operations. If the operation results in a multiple completion or recompleat in a new interval, a Form 3160-4 must be filed once testing has been completed. Final Abandonment Notices must be filed only after all requirements, including reclamation, have been completed and the operator has determined that the site is ready for final inspection.)

Chesapeake has updated the Production Facility per the attached diagram.

**SEE ATTACHED FOR
CONDITIONS OF APPROVAL**

(CHK PN 611242)



14. I hereby certify that the foregoing is true and correct
Name (Printed/Typed)
LINDA GOOD

Title REGULATORY ANALYST

Signature

Linda Good

Date 08/01/2007

THIS SPACE FOR FEDERAL OR STATE OFFICE USE

Approved by

Title

Conditions of approval, if any, are attached. Approval of this notice does not warrant or certify that the applicant holds legal or equitable title to those rights in the subject lease which would entitle the applicant to conduct operations thereon.

Office

Title 18 U.S.C. Section 1001 and Title 43 U.S.C. Section 1212, make it a crime for any person knowingly and willfully to make to any department or agency of the United States any false, fictitious or fraudulent statements or representations as to any matter within its jurisdiction.

(Instructions on page 2)

GWW

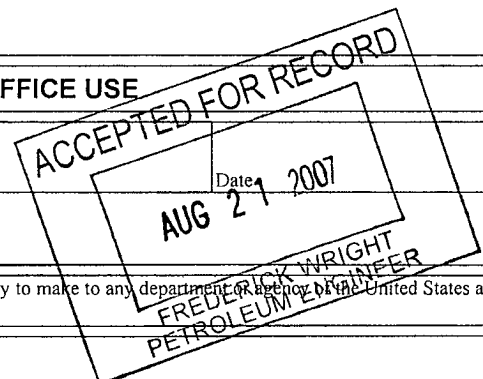

CHESAPEAKE OPERATING, INC.

MILLARD DECK ESTATE 28 FEDERAL 1
28-22S-36E
LEA CO., NM

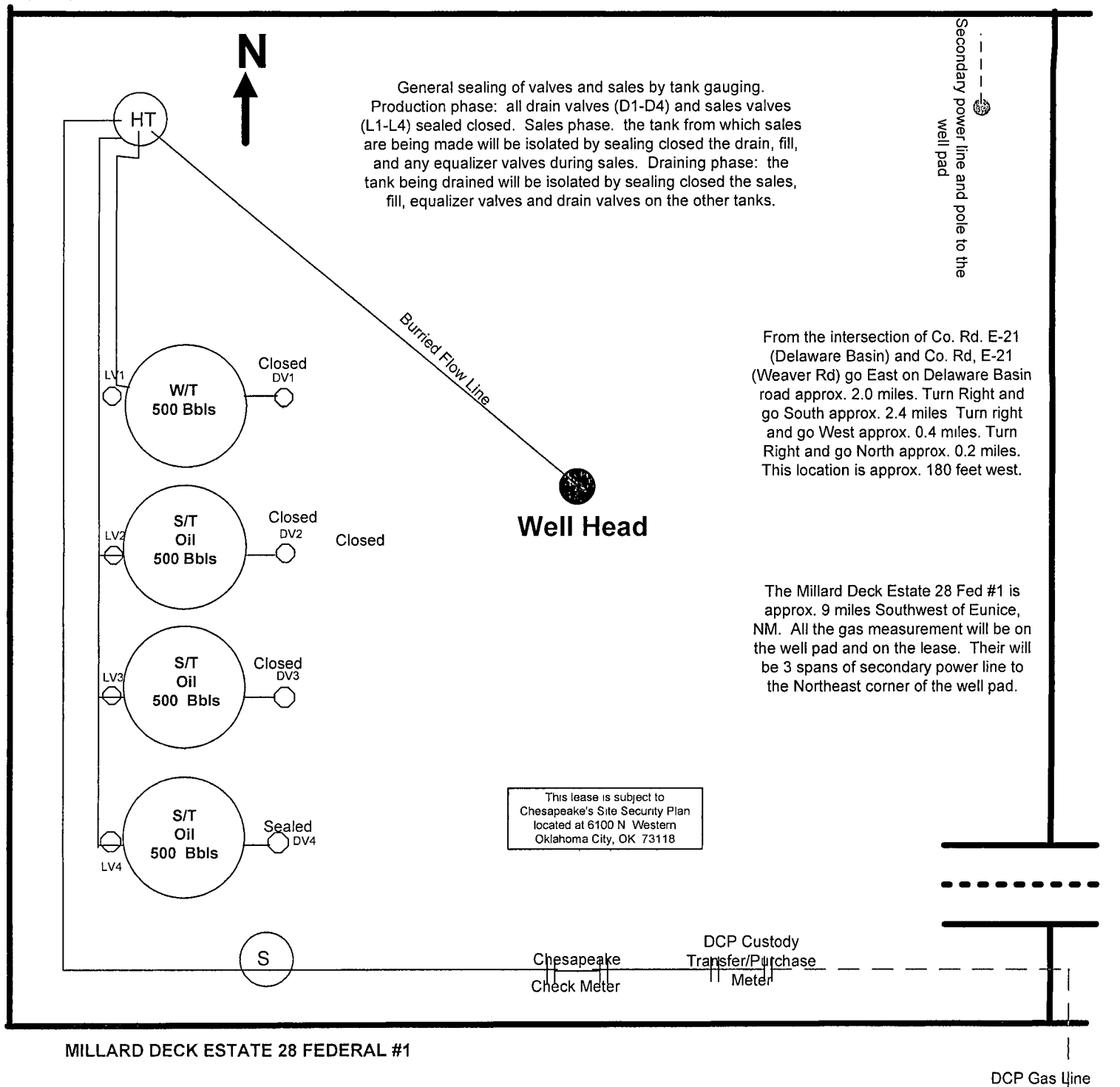



SUNDRY NOTICE SPECIAL STIPULATIONS

1. This sundry is accepted for record only. The following additional information will be needed:
2. The facility diagram must identify any separation equipment other than the heater treater.
- ~~3. The facility diagram must identify the tank equalizer valves.~~
4. The facility diagram must identify the fill line and valves for all tanks, such that they can be easily distinguished from sales lines and valves.
5. If gas is being used for beneficial use for the heater treater the fuel lines must show that the gas is being taken upstream of the point of measurement for sales.

Engineering
can be reached at 505-706-2779 for any variances that might be necessary.

F Wright 8/21/07