

Submit 3 Copies To Appropriate District Office  
District I  
1625 N. French Dr., Hobbs, NM 88240  
District II  
1301 W. Grand Ave., Artesia, NM 88210  
District III  
1000 Rio Brazos Rd., Aztec, NM 87410  
District IV  
1220 S. St. Francis Dr., Santa Fe, NM 87505

State of New Mexico  
Energy, Minerals and Natural Resources

Form C-103  
March 4, 2004

OIL CONSERVATION DIVISION  
1220 South St. Francis Dr.  
Santa Fe, NM 87505

WELL API NO. 30-025-36527
5. Indicate Type of Lease STATE <input checked="" type="checkbox"/> FEE <input type="checkbox"/>
6. State Oil & Gas Lease No. VA-1945
7. Lease Name or Unit Agreement Name Reba State Unit
8. Well Number 1
9. OGRID Number 25575
10. Pool Wildcat Mississippian

SUNDRY NOTICES AND REPORTS ON WELLS  
(DO NOT USE THIS FORM FOR PROPOSALS TO DRILL OR TO DEEPEN OR PLUG BACK TO A DIFFERENT RESERVOIR. USE "APPLICATION FOR PERMIT" (FORM C-101) FOR SUCH PROPOSALS.)

1. Type of Well:

Oil Well ☐ Gas Well ☒ Other

2. Name of Operator  
Yates Petroleum Corporation

3. Address of Operator  
105 South 4<sup>th</sup> Street, Artesia, New Mexico, 88210

4. Well Location

Unit Letter C; 1200 feet from the North line and 1500 feet from the West line

Section 29

Township 11S

Range 35E

NMPM

County Lea

11. Elevation (Show whether DR, RKB, RT, GR, etc.)  
4180' GR

Pit or Below-grade Tank Application (For pit or below-grade tank closures, a form C-144 must be attached)

Pit Location: UL    Sect    Twp    S    Rng    E    Pit type    Depth to Groundwater less than 50' Distance from nearest fresh water well   

Distance from nearest surface water    Below-grade Tank Location UL    Sect    Twp    Rng    ;  
   feet from the    line and    feet from the    line

12. Check Appropriate Box to Indicate Nature of Notice, Report or Other Data

NOTICE OF INTENTION TO:

PERFORM REMEDIAL WORK ☐ PLUG AND ABANDON ☐

TEMPORARILY ABANDON ☐ CHANGE PLANS ☐

PULL OR ALTER CASING ☐ MULTIPLE COMPLETION ☐

OTHER Change Acreage Dedication

SUBSEQUENT REPORT OF:

REMEDIAL WORK ☐ ALTERING CASING ☐

COMMENCE DRILLING OPNS. ☐ PLUG AND ABANDONMENT ☐

CASING TEST AND CEMENT JOB ☐  
OTHER: ☐

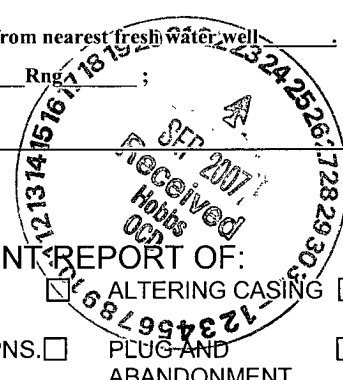

13. Describe proposed or completed operations. (Clearly state all pertinent details, and give pertinent dates, including estimated date of starting any proposed work). SEE RULE 1103. For Multiple Completions: Attach wellbore diagram of proposed completion or recompletion.

Yates Petroleum Corporation wishes to change the dedicated acreage from the West Half to the North Half of the section.

I hereby certify that the information above is true and complete to the best of my knowledge and belief. I further certify that any pit or below-grade tank has been/will be constructed or closed according to NMOCD guidelines ☐, a general permit ☒ or an (attached) alternative OCD-approved plan ☐.

SIGNATURE Clifton R. May TITLE Regulatory Agent/Land Department DATE 9/21/2007

Type or print name: Clifton R. May E-mail address: cliff@ypcnm.com Telephone No. (505) 748-4347

(This space for State use)

APPROVED BY Chris Williams TITLE DISTRICT SUPERVISOR/GENERAL MANAGER DATE OCT 01 2007

Conditions of approval, if any:

**DISTRICT I**  
1625 N. French Dr., Hobbs, NM 88240

**DISTRICT II**  
811 South First, Artesia, NM 88210

**DISTRICT III**  
1000 Rio Brazos Rd., Aztec, NM 87410

**DISTRICT IV**  
2040 South Pacheco, Santa Fe, NM 87505

State of New Mexico  
Energy, Minerals and Natural Resources Department

Form C-102  
Revised March 17, 1999  
Instruction on back  
Submit to Appropriate District Office  
State Lease - 4 Copies  
Fee Lease - 3 Copies

**OIL CONSERVATION DIVISION**  
P.O. Box 2088  
Santa Fe, New Mexico 87504-2088

☐ AMENDED REPORT

**WELL LOCATION AND ACREAGE DEDICATION PLAT**

API Number <b>30-025-36527</b>	Pool Code <b>97053</b>	Pool Name <b>Four Lakes MISSISSIPPIAN</b>
Property Code <b>33254</b>	Property Name <b>REBA STATE UNIT</b>	
OGRID No. <b>025575</b>	Operator Name <b>YATES PETROLEUM CORPORATION</b>	
		Well Number <b>1</b>
		Elevation <b>4143</b>

**Surface Location**

UL or lot No.	Section	Township	Range	Lot Idn	Feet from the	North/South line	Feet from the	East/West line	County
<b>C</b>	<b>29</b>	<b>11S</b>	<b>35E</b>		<b>1200</b>	<b>NORTH</b>	<b>1500</b>	<b>WEST</b>	<b>LEA</b>

**Bottom Hole Location If Different From Surface**

UL or lot No.	Section	Township	Range	Lot Idn	Feet from the	North/South line	Feet from the	East/West line	County
Dedicated Acres <b>320 N/2</b>		Joint or Infill	Consolidation Code	Order No.					

**NO ALLOWABLE WILL BE ASSIGNED TO THIS COMPLETION UNTIL ALL INTERESTS HAVE BEEN CONSOLIDATED OR A NON-STANDARD UNIT HAS BEEN APPROVED BY THE DIVISION**

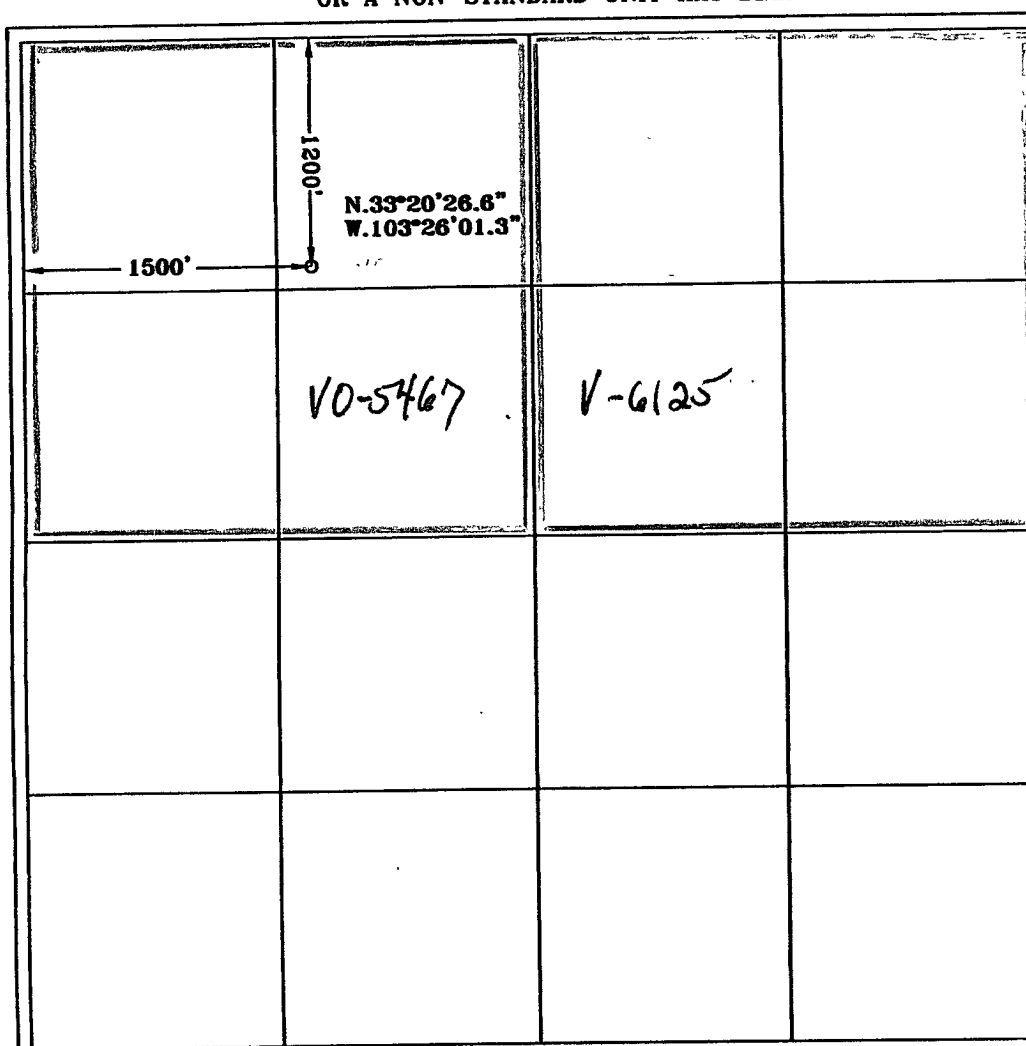

<b>OPERATOR CERTIFICATION</b>	
I hereby certify that the information contained herein is true and complete to the best of my knowledge and belief.	
<b>Clifton R. May</b>	
Signature	<b>CLIFTON R. MAY</b>
Printed Name	<b>REGULATORY AGENT</b>
Title	<b>9-21-2007</b>
Date	
<b>SURVEYOR CERTIFICATION</b>	
I hereby certify that the well location shown on this plat was plotted from field notes of actual surveys made by me or under my supervision, and that the same is true and correct to the best of my belief.	
<b>1/05/2004</b>	
Date Surveyed	
Signature and Seal of Professional Surveyor	<b>HERSHELL JONES</b>
Certificate No. <b>3640</b>	
<b>REBA STATE UNIT</b>	
<b>GENERAL SURVEYING COMPANY</b>	

0 330' 660' 990' 1650' 1980' 2310' 2310' 1980' 1650' 990' 660' 330' 0'

DISTRICT I  
1625 N. French Dr., Hobbs, NM 88240  
DISTRICT II  
811 South First, Artesia, NM 88210  
DISTRICT III  
1000 Rio Brazos Rd., Aztec, NM 87410  
DISTRICT IV  
2040 South Pacheco, Santa Fe, NM 87505

State of New Mexico  
Energy, Minerals and Natural Resources Department

Revised March 17, 1999  
Instruction on back  
Submit to Appropriate District Office  
State Lease - 4 Copies  
Fee Lease - 3 Copies

OIL CONSERVATION DIVISION  
P.O. Box 2088  
Santa Fe, New Mexico 87504-2088

☐ AMENDED REPORT

WELL LOCATION AND ACREAGE DEDICATION PLAT

API Number 30-025-36527	Pool Code 97082	Pool Name FOUR LAKES MORROW
Property Code 33254	Property Name REBA STATE UNIT	Well Number 1
OGRID No. 025575	Operator Name YATES PETROLEUM CORPORATION	Elevation 4143

Surface Location

UL or lot No.	Section	Township	Range	Lot Idn	Feet from the	North/South line	Feet from the	East/West line	County
C	29	11S	35E		1200	NORTH	1500	WEST	LEA

Bottom Hole Location If Different From Surface

UL or lot No.	Section	Township	Range	Lot Idn	Feet from the	North/South line	Feet from the	East/West line	County

Dedicated Acres 320	Joint or Infill	Consolidation Code	Order No.
------------------------	-----------------	--------------------	-----------

NO ALLOWABLE WILL BE ASSIGNED TO THIS COMPLETION UNTIL ALL INTERESTS HAVE BEEN CONSOLIDATED  
OR A NON-STANDARD UNIT HAS BEEN APPROVED BY THE DIVISION

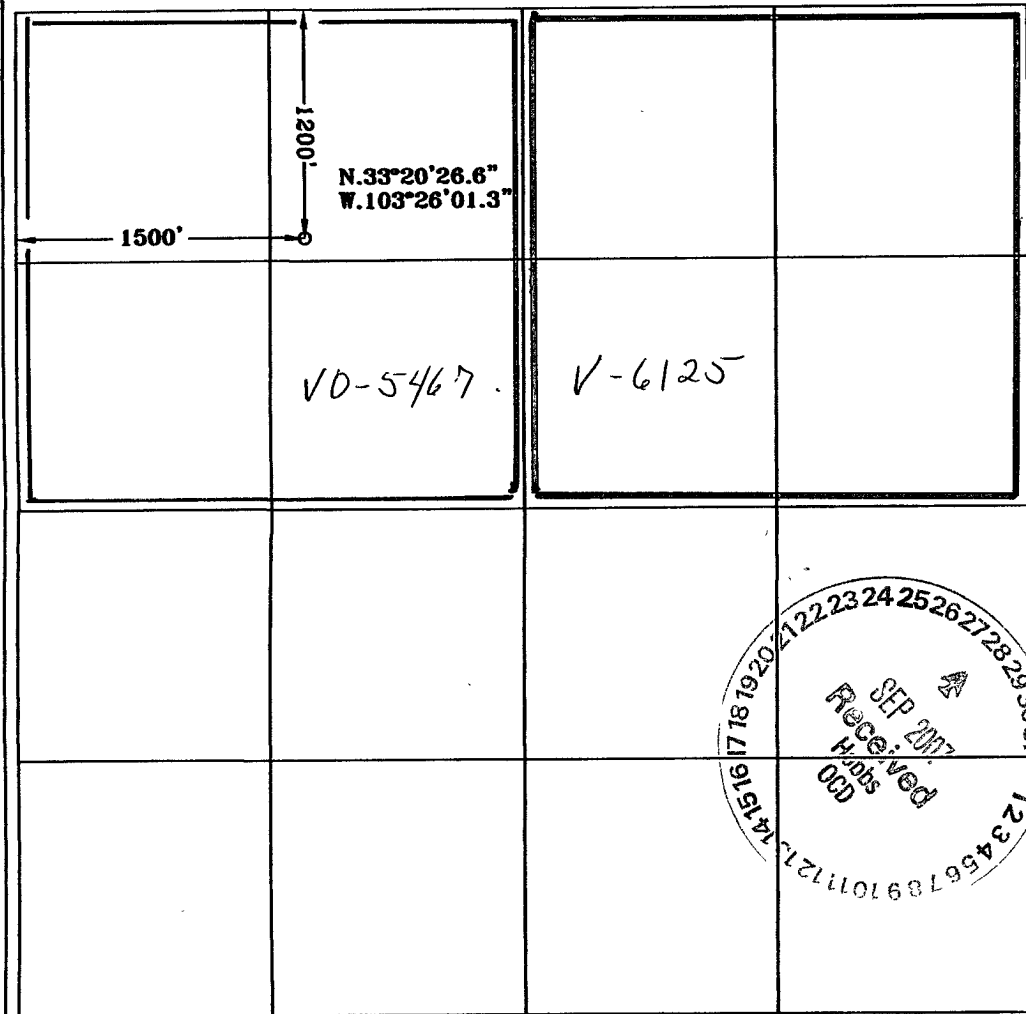
	<b>OPERATOR CERTIFICATION</b> <i>I hereby certify that the information contained herein is true and complete to the best of my knowledge and belief.</i> Signature: <u>Clifton R. May</u> Printed Name: <u>CLIFTON R. MAY</u> Title: <u>REGULATORY AGENT</u> Date: <u>9/27/2007</u>
	<b>SURVEYOR CERTIFICATION</b> <i>I hereby certify that the well location shown on this plat was plotted from field notes of actual surveys made by me or under my supervision, and that the same is true and correct to the best of my belief.</i> Date Surveyed: <u>1/05/2004</u> Signature and Seal of Professional Surveyor: <u>[Signature]</u> Certificate No. <u>3640</u> Herschel L. Jones GENERAL SURVEYING COMPANY

0 330' 660' 990' 1650' 1980' 2310' 2310' 1980' 1650' 990' 660' 330' 0'