

District I  
1625 N. French Dr., Hobbs, NM 88240  
District II  
1301 W. Grand Avenue, Artesia, NM 88210  
District III  
1000 Rio Brazos Road, Aztec, NM 87410  
District IV  
1220 S. St. Francis Dr., Santa Fe, NM 87505

State of New Mexico  
Energy Minerals and Natural Resources  
Oil Conservation Division  
1220 South St. Francis Dr.  
Santa Fe, NM 87505

Form C-141  
Revised October 10, 2003

Submit 2 Copies to appropriate  
District Office in accordance  
with Rule 116 on back  
side of form

### Release Notification and Corrective Action

#### OPERATOR

☒ Initial Report ☐ Final Report

Name of Company	Southern Union Gas Services, Ltd.	Contact	Tony Savoie
Address	P.O. Box 1226 Jal, N.M. 88252	Telephone No.	575-395-2116
Facility Name	Lea County Field Dept.	Facility Type	Natural Gas Gathering

Surface Owner: Jimmie T. Cooper	Mineral Owner: Federal	Lease No.
---------------------------------	------------------------	-----------

#### LOCATION OF RELEASE

Unit Letter D	Section 18	Township 20S	Range 37E	Feet from the	North/South Line	Feet from the	East/West Line	County Lea
------------------	---------------	-----------------	--------------	---------------	------------------	---------------	----------------	---------------

Latitude N32 34.725 Longitude W103 17.832

#### NATURE OF RELEASE

Type of Release : Natural Gas and Iron Sulfide Sludge	Volume of Release: 600 MCF	Volume Recovered None
Source of Release : 6" Natural Gas Pipeline	Date and Hour of Occurrence 10/16/07 3:45 p.m.	Date and Hour of Discovery 10/16/07 Time: 3:45 p.m.
Was Immediate Notice Given? <input type="checkbox"/> Yes <input checked="" type="checkbox"/> No <input type="checkbox"/> Not Required	If YES, To Whom? Reported to Chris Williams	
By Whom? Tony Savoie	Date and Hour: 10/17/07 11:38 a.m.	
Was a Watercourse Reached? <input type="checkbox"/> Yes <input checked="" type="checkbox"/> No	If YES, Volume Impacting the Watercourse.	

If a Watercourse was Impacted, Describe Fully.*
---

Describe Cause of Problem and Remedial Action Taken.* A 6" Natural Gas gathering line operating at approximately 30 p.s.i. was struck by a bull-dozer that was excavating and area around a plugged well location. The line was blocked in and allowed to blow down. On 10/23/07 the damaged area of pipe was cut-out and approximately 400 ft. of 4" poly was inserted into the 6" line. <input type="checkbox"/>
--

Describe Area Affected and Cleanup Action Taken. An area measuring approximately 3750 sq. ft., consisting mostly of a caliche based well location was affected by the iron sulfide sludge, most of the sludge was contained within the excavation made by the bull-dozer. An area covering approximately 10,500 sq.ft. north-west of the impact area had a slight mist covering due to the gas release and wind direction. Final remediation will follow the NMOCD recommended guidelines for leaks and spills.
---

I hereby certify that the information given above is true and complete to the best of my knowledge and understand that pursuant to NMOCD rules and regulations all operators are required to report and/or file certain release notifications and perform corrective actions for releases which may endanger public health or the environment. The acceptance of a C-141 report by the NMOCD marked as "Final Report" does not relieve the operator of liability should their operations have failed to adequately investigate and remediate contamination that pose a threat to ground water, surface water, human health or the environment. In addition, NMOCD acceptance of a C-141 report does not relieve the operator of responsibility for compliance with any other federal, state, or local laws and/or regulations.
--

Signature: <i>J. A. Savoie</i>	OIL CONSERVATION DIVISION	
Printed Name: John A. Savoie	Approved by District Supervisor <i>J. Johnson</i>	
Title: Remediation Supervisor	Approval Date:	Expiration Date: 12/31/07
E-mail Address: tony.savoie@sug.com	Conditions of Approval:	
Date: 10/25/07 Phone: 575-395-2116	Attached <input type="checkbox"/>	

\* Attach Additional Sheets If Necessary

RP#1646

37 E

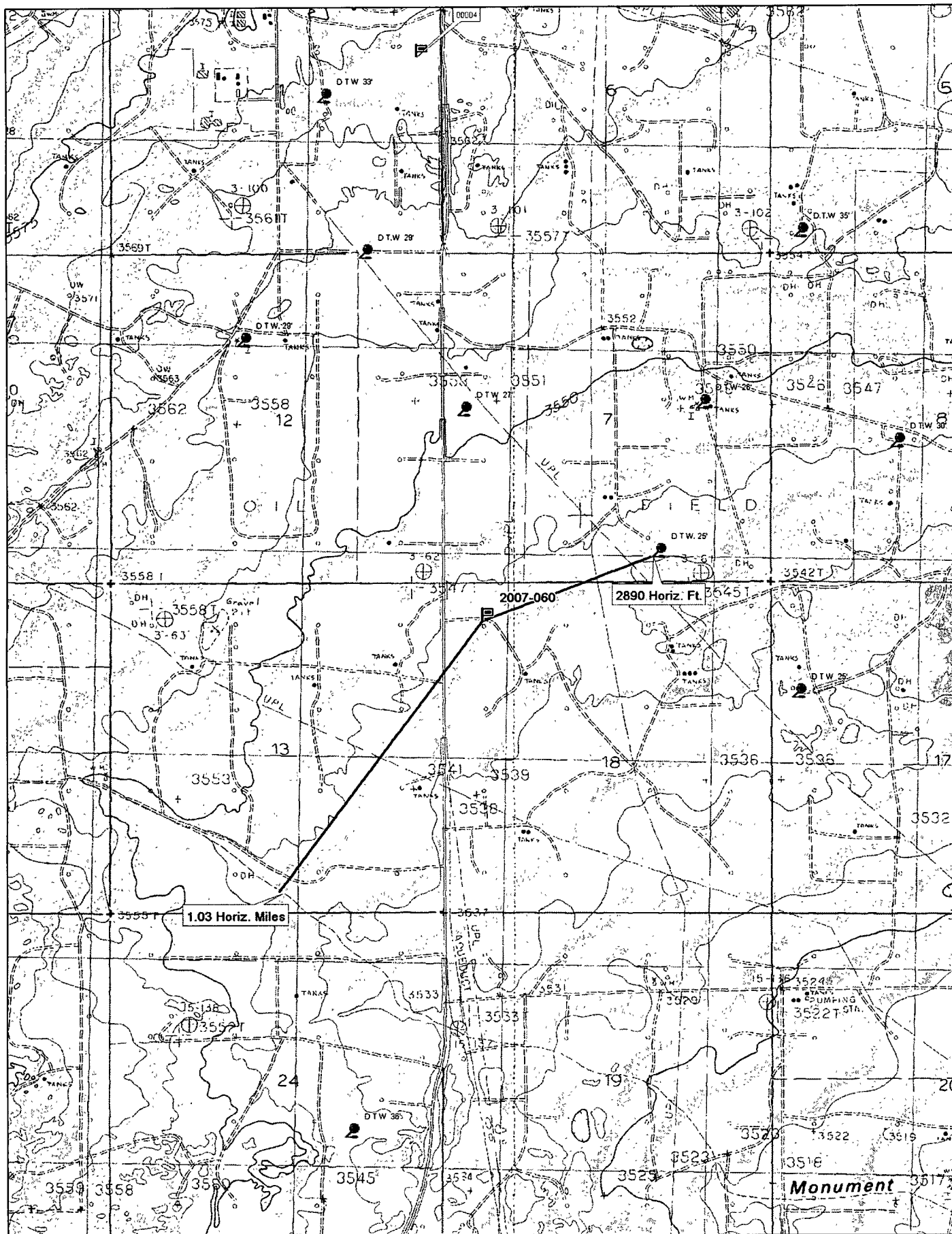

20 S

# Cooper 6"

## Job # 2007-060

### Ranking Analysis

NMOCD Standards			Points
Depth to Ground Water	Greater than 100 ft.		0
Depth to Ground Water	Less than 100 ft. but greater than 50 ft.		10
Depth to Ground Water	Less than 50 ft.		20
Well Head Protection	Less than 1000 ft. from a water source, or;	Yes	20
	Less than 200 ft. from private domestic water source	No	0
Distance to Surface water body	Less than 200 Horizontal. ft.		20
Distance to Surface water body	200 to 1000 Horizontal ft.		10
Distance to Surface water body	Greater than 1000 Horizontal ft.		0
<b>Action levels</b>	<b>&gt;19</b>	<b>10-19</b>	<b>0-9</b>
Benzene (mg/kg)	10	10	10
BTEX (mg/kg)	50	50	50
TPH (mg/kg)	100	1000	5000

Site Ranking			Points
Depth to Ground Water "Avg."	27 ft.Average		20
Well Head Protection	2890 Horiz. Ft.		0
Surface Water Body	1.03 Horiz. Miles		0
<b>Total Ranking Score</b>			<b>20</b>

Site Closure Objective	
Benzene (mg/kg)	10
BTEX (mg/kg)	50
TPH (mg/kg) "Surface"	100

Remediation Plan:
All affected soil will be excavated and sampled for the presence of Hydrocarbons EPA method (8015M)
Soil with TPH values greater than 100 mg/kg will be transported to the S.U.G.S. Landfarm
Soil samples will be collected from the excavation and analyzed for Hydrocarbons EPA method (8015M)
All samples will be field screened with a "PID" The soil sample with the highest PID reading will be analyzed separately and tested for BTEX.