

District I
1625 N French Dr, Hobbs, NM 88240
District II
1301 W Grand Avenue, Artesia, NM 88210
District III
1000 Rio Brazos Road, Aztec, NM 87410
District IV
1220 S St Francis Dr, Santa Fe, NM 87505

State of New Mexico
Energy Minerals and Natural Resources

Form C-144
June 1, 2004

Oil Conservation Division
1220 South St. Francis Dr.
Santa Fe, NM 87505

For drilling and production facilities, submit to appropriate NMOCD District Office.
For downstream facilities, submit to Santa Fe office

Pit or Below-Grade Tank Registration or Closure

Is pit or below-grade tank covered by a "general plan"? Yes ☐ No ☒

Type of action: Registration of a pit or below-grade tank ☒ Closure of a pit or below-grade tank ☐

Operator	COG Operating, LLC	Telephone	(432) 685-4340	e-mail address	PEdwards@conchoresources.com
Address	550 West Texas Ave, Suite 1300, Midland, Texas 79701				
Facility or well name:	JC Federal #12	API #:	30-025-38696	U/L or Qtr/Qtr	A Sec 22 T-17-S R-32-E
County	Lea	Latitude	32.824502N	Longitude	103.748396W NAD 1927 X 1983 <input type="checkbox"/>
Surface Owner:	Federal <input checked="" type="checkbox"/> State <input type="checkbox"/> Private <input type="checkbox"/> Indian <input type="checkbox"/>				
Pit Type: Drilling <input checked="" type="checkbox"/> Production <input type="checkbox"/> Disposal <input type="checkbox"/> Workover <input type="checkbox"/> Emergency <input type="checkbox"/> Lined <input checked="" type="checkbox"/> Unlined <input type="checkbox"/> Liner type: Synthetic <input checked="" type="checkbox"/> Thickness 12 mil Clay <input type="checkbox"/> Pit Volume 25,000 bbl		Below-grade tank Volume ____ bbl Type of fluid: ____ Construction material: ____ Double-walled, with leak detection? Yes <input type="checkbox"/> If not, explain why not: ____			
Depth to ground water (vertical distance from bottom of pit to seasonal high water elevation of ground water) 150' 08'		Less than 50 feet 50 feet or more, but less than 100 feet 100 feet or more		(20 points) (10 points) 0 10 (0 points)	
Wellhead protection area (Less than 200 feet from a private domestic water source, or less than 1000 feet from all other water sources)		Yes No		(20 points) (0 points) 0	
Distance to surface water. (horizontal distance to all wetlands, playas, irrigation canals, ditches, and perennial and ephemeral watercourses)		Less than 200 feet 200 feet or more, but less than 1000 feet 1000 feet or more		(20 points) (10 points) (0 points) 0	
		Ranking Score (Total Points)		0 10	

If this is a pit closure: (1) Attach a diagram of the facility showing the pit's relationship to other equipment and tanks (2) Indicate disposal location: (check the onsite box if you are burying in place) onsite ☐ offsite ☐ If offsite, name of facility _____ (3) Attach a general description of remedial action taken including remediation start date and end date (4) Groundwater encountered No ☐ Yes ☐ If yes, show depth below ground surface _____ ft. and attach sample results. (5) Attach soil sample results and a diagram of sample locations and excavations

Additional Comments

I hereby certify that the information above is true and complete to the best of my knowledge and belief. I further certify that the above-described pit or below-grade tank has been/will be constructed or closed according to NMOCD guidelines X, a general permit ☐, or an (attached) alternative OCD-approved plan ☐.

Date: 11-12-07

Printed Name/Title Gary Miller, Agent

Signature

Your certification and NMOCD approval of this application/closure does not relieve the operator of liability should the contents of the pit or tank contaminate ground water or otherwise endanger public health or the environment. Nor does it relieve the operator of its responsibility for compliance with any other federal, state, or local laws and/or regulations.

Approval

Printed Name/Title CHRIS WILLIAMS / DIST. SUPV

Signature Chris Williams

Date: 1/16/08

DRILLING LOCATION H₂S SAFETY EQUIPMENT Exhibit # 8

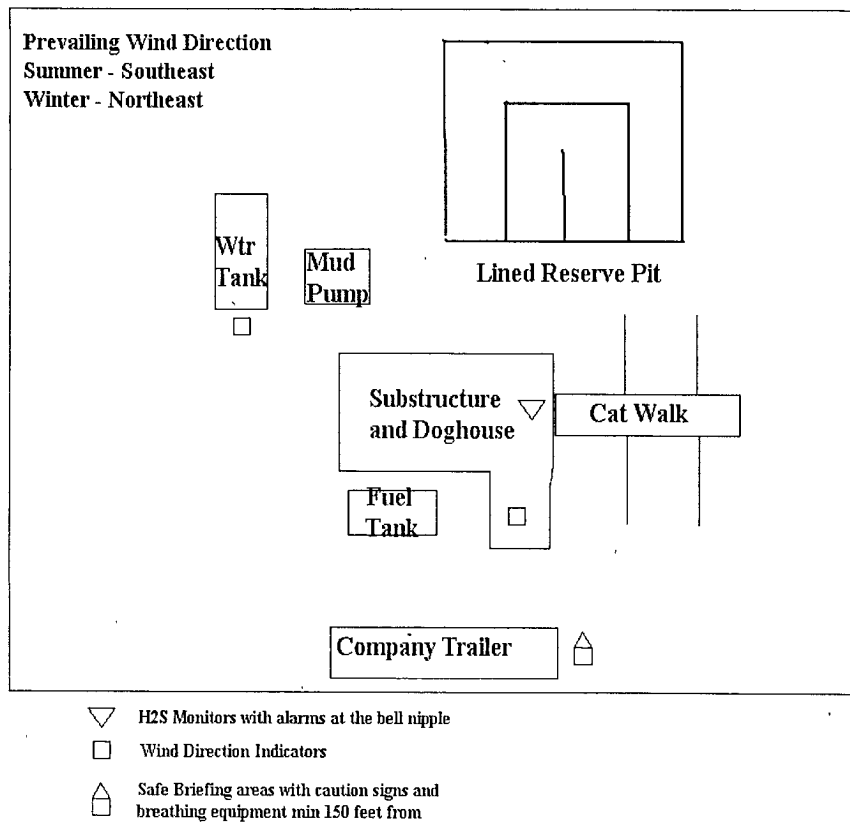

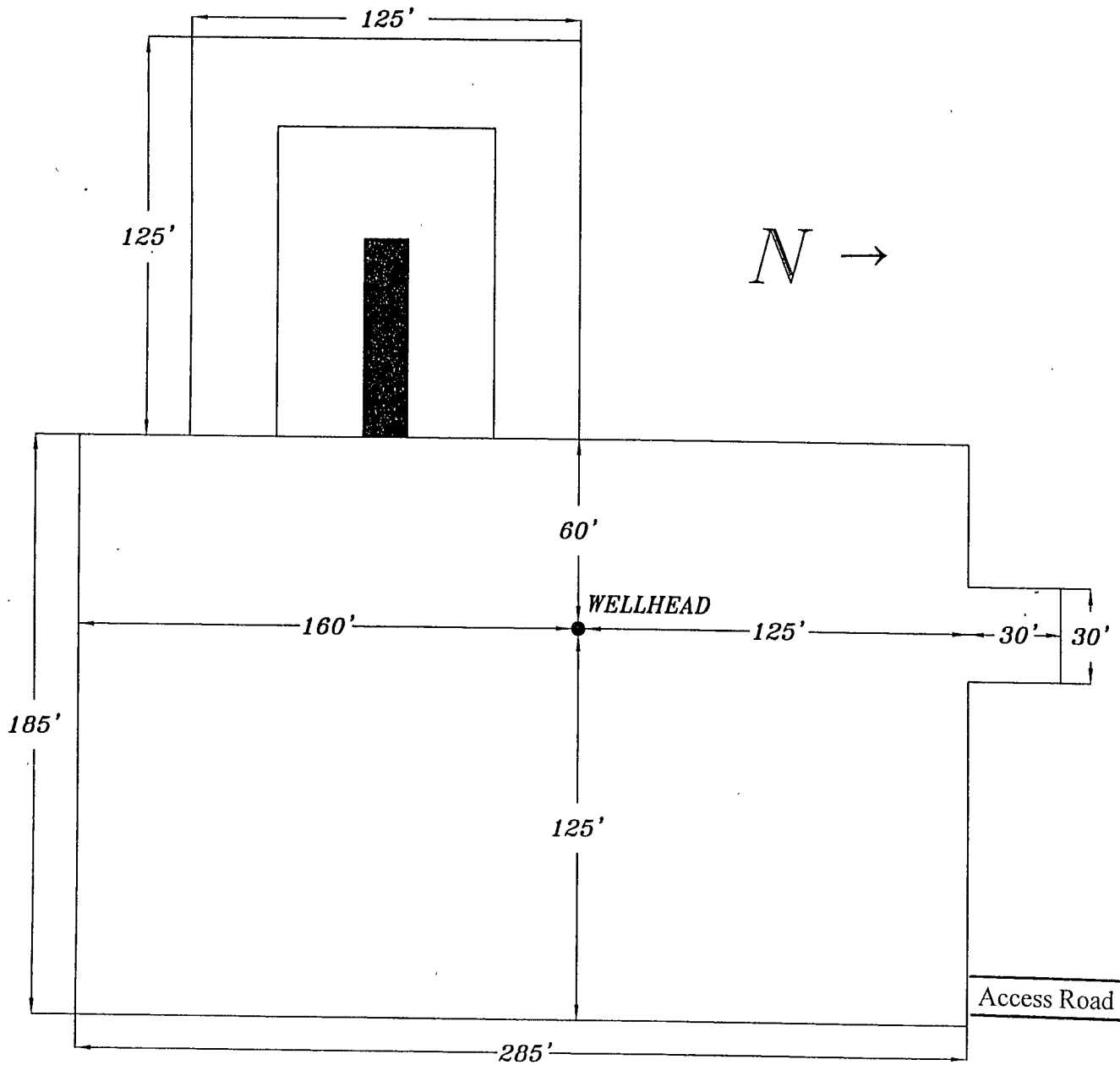

See COA

EXHIBIT #6

DATE:
9/14/07
OWN. BY:
JJ
FILE:
CADDON
RIG LAYOUT

COG OPERATING, LLC
RIG LAYOUT

HIGHLANDER ENVIRONMENTAL CORP.
MIDLAND, TEXAS

NOT TO SCALE