

District III  
1000 Rio Brazos Road, Aztec, NM 87410  
District IV  
1220 S. St. Francis Dr., Santa Fe, NM 87505

Oil Conservation Division  
1220 South St. Francis Dr.  
Santa Fe, NM 87505

For drilling and production facilities, submit to appropriate NMOCD District Office.  
For downstream facilities, submit to Santa Fe office

**Pit or Below-Grade Tank Registration or Closure**

Is pit or below-grade tank covered by a "general plan"? Yes ☐ No ☐

Type of action Registration of a pit or below-grade tank ☐ Closure of a pit or below-grade tank ☐

Operator **EnerVest Operating, Ltd** Telephone **(713)-495-6530** e-mail address **ryoung@enervest.net**  
Address **1001 Fannin Street, Suite 800, Houston, Texas 77002-6707**  
Facility or well name **Stevens A-35 #5** API # **30-025-38765** U/L or Qtr/Qtr K Sec **35** T-23-S R-36-E  
County **LEA** Latitude **32.259174N** Longitude **103.238159 W** NAD 1927 ☒ 1983 ☐  
Surface Owner Federal ☐ State ☐ Private ☒ Indian ☐

<b>Pit</b>	<b>Below-grade tank</b>	
Type Drilling <input checked="" type="checkbox"/> Production <input type="checkbox"/> Disposal <input type="checkbox"/> Workover <input type="checkbox"/> Emergency <input type="checkbox"/> Lined <input type="checkbox"/> Unlined <input type="checkbox"/> Liner type Synthetic <input type="checkbox"/> Thickness mil Clay <input type="checkbox"/> Pit Volume	Volume ___ bbl Type of fluid _____ Construction material. _____ Double-walled, with leak detection? Yes <input type="checkbox"/> If not, explain why not _____	
Depth to ground water (vertical distance from bottom of pit to seasonal high water elevation of ground water) <b>NA ~ 130'</b>	Less than 50 feet	(20 points)
	50 feet or more, but less than 100 feet	(10 points)
	100 feet or more	( 0 points)
Wellhead protection area (Less than 200 feet from a private domestic water source, or less than 1000 feet from all other water sources )	Yes	(20 points)
	No	( 0 points)
Distance to surface water (horizontal distance to all wetlands, playas, irrigation canals, ditches, and perennial and ephemeral watercourses )	Less than 200 feet	(20 points)
	200 feet or more, but less than 1000 feet	(10 points)
	1000 feet or more	( 0 points)
<b>Ranking Score (Total Points)</b>		<b>0</b>

**If this is a pit closure:** (1) Attach a diagram of the facility showing the pit's relationship to other equipment and tanks (2) Indicate disposal location (check the onsite box if you are burying in place) onsite ☐ offsite ☐ If offsite, name of facility \_\_\_\_\_ (3) Attach a general description of remedial action taken including remediation start date and end date (4) Groundwater encountered No ☐ Yes ☐ If yes, show depth below ground surface \_\_\_\_\_ ft and attach sample results (5) Attach soil sample results and a diagram of sample locations and excavations

Additional Comments
<b>This well will utilize a closed mud system</b>

I hereby certify that the information above is true and complete to the best of my knowledge and belief. I further certify that the above-described pit or below-grade tank has been/will be constructed or closed according to NMOCD guidelines ☐, a general permit ☐, or an (attached) alternative OCD-approved plan ☐.

Date 1-14-08

Printed Name/Title **Gary Miller, Agent**

Signature 

Your certification and NMOCD approval of this application/closure does not relieve the operator of liability should the contents of the pit or tank contaminate ground water or otherwise endanger public health or the environment. Nor does it relieve the operator of its responsibility for compliance with any other federal, state, or local laws and/or regulations.

Approval

Printed Name/Title **CHRIS WILLIAMS / DIST. SURV** Signature **Chris Williams** Date **2/15/08**

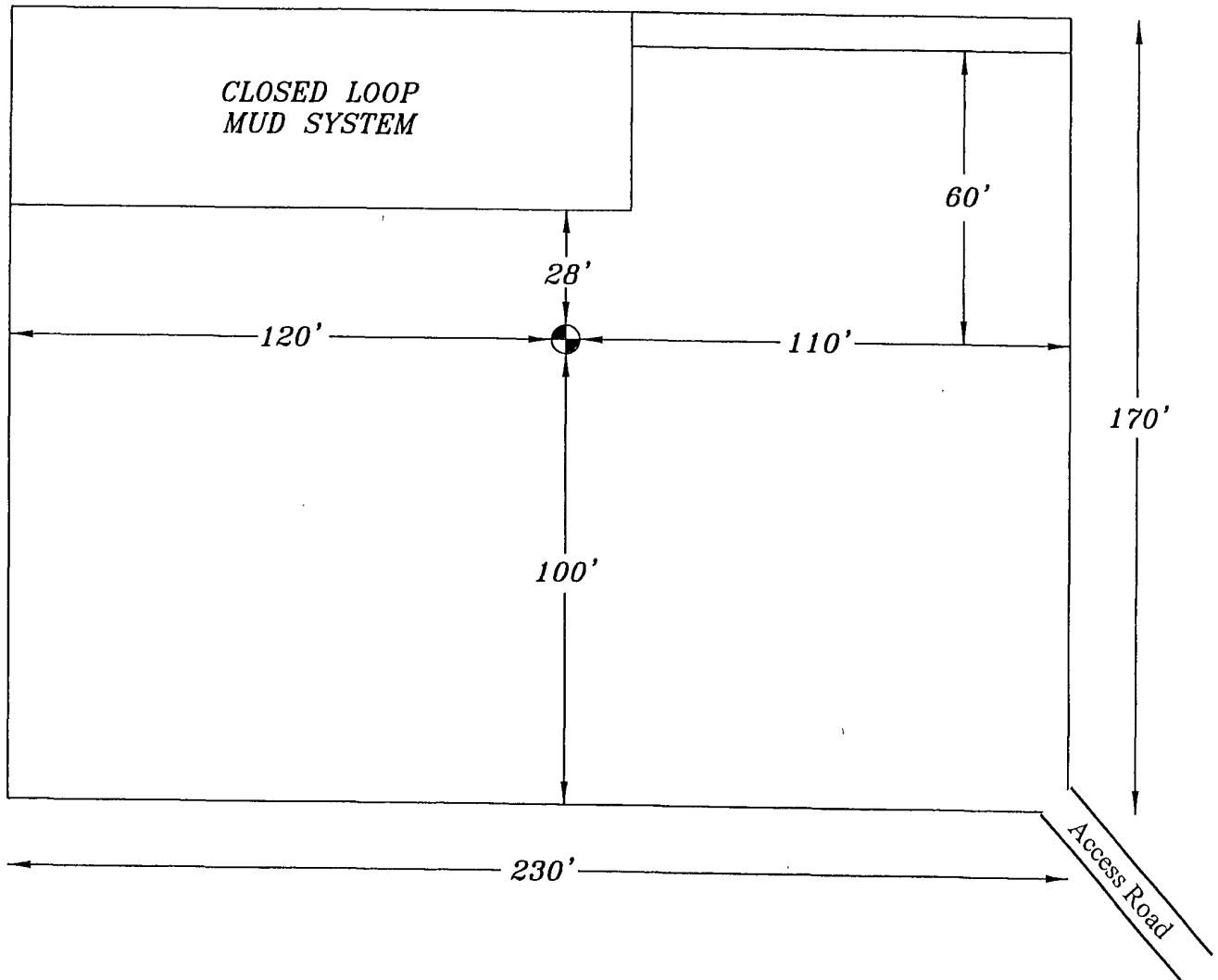

SEE ATTACHED FOR  
CONDITIONS OF APPROVAL

NOT TO SCALE

DATE:  
1/7/08  
DWN. BY:  
RC  
FILE:  
C:\ENERVEST\3334  
RIG LAYOUT

EXHIBIT #6

ENERVEST OPERATING, LTD.  
RIG LAYOUT