

District I

1625 N. French Dr , Hobbs, NM 88240

District II

1301 W. Grand Avenue, Artesia, NM 88210

District III

1000 Rio Brazos Road, Aztec, NM 87410

District IV

1220 S. St. Francis Dr , Santa Fe, NM 87505

State of New Mexico
Energy Minerals and Natural Resources

RECEIVED

Form C-101

May 27, 2004

Oil Conservation Division APR 22 2008

Submit to appropriate District Office

1220 South St. Francis Dr

Santa Fe, NM 87505

HOBBS OCD

AMENDED REPORT

APPLICATION FOR PERMIT TO DRILL, RE-ENTER, DEEPEN, PLUGBACK, OR ADD A ZONE

Operator Name and Address Yates Petroleum Corporation 105 S 4 th Street Artesia, NM 88210		OGRID Number 025575
		API Number 30-025-34898
Property Code 34507	Property Name East Sand Springs BFZ State	Well No. 3
Proposed Pool 1 Sand Springs; Abo		Proposed Pool 2

Surface Location

UL or lot no N	Section 6	Township 11S	Range 35E	Lot Idn	Feet from the 1000	North/South line South	Feet from the 1400	East/West line West	County Lea
-------------------	--------------	-----------------	--------------	---------	-----------------------	---------------------------	-----------------------	------------------------	---------------

Proposed Bottom Hole Location If Different From Surface

UL or lot no	Section	Township	Range	Lot Idn	Feet from the	North/South line	Feet from the	East/West line	County
--------------	---------	----------	-------	---------	---------------	------------------	---------------	----------------	--------

Additional Well Information

Work Type Code P	Well Type Code O	Cable/Rotary N/A	Lease Type Code S	Ground Level Elevation 4182'GR
Multiple N	Proposed Depth N/A	Formation Devonian	Contractor N/A	Spud Date ASAP
Depth to Groundwater		Distance from nearest fresh water well		Distance from nearest surface water
Pit: Liner: Synthetic <input type="checkbox"/> mils thick Clay <input type="checkbox"/> Pit Volume: bbls Drilling Method: Closed-Loop System <input checked="" type="checkbox"/> Fresh Water <input type="checkbox"/> Brine <input type="checkbox"/> Diesel/Oil-based <input type="checkbox"/> Gas/Air <input type="checkbox"/>				

Proposed Casing and Cement Program

Hole Size	Casing Size	Casing weight/foot	Setting Depth	Sacks of Cement	Estimated TOC
		IN PLACE			

Describe the proposed program. If this application is to DEEPEN or PLUG BACK, give the data on the present productive zone and proposed new productive zone. Describe the blowout prevention program, if any. Use additional sheets if necessary.

Yates Petroleum Corporation plans to plugback and recompleate this well as follows: Set a CIBP at 12,350' with 35' cement on top. Set a 2nd CIBP at 12,050' with 35' cement on top. Perforate Abo 9174'-9212' (76). Stimulate as needed. Run appropriate production string and turn well to production.

Permit Expires 2 Years From Approval
Date Unless Drilling Underway
Plugback

I hereby certify that the information given above is true and complete to the best of my knowledge and belief. I further certify that the drilling pit will be constructed according to NMOC guidelines ☐, a general permit ☐, or an (attached) alternative OCD-approved plan ☐.

Signature

Printed name. Tina Huerta

Title Regulatory Compliance Supervisor

E-mail Address: tnah@ypcnm.com

Date April 21, 2008

Phone 575-748-4168

OIL CONSERVATION DIVISION

Approved by

Title PETROLEUM ENGINEER

Approval Date. APR 30 2008

Expiration Date.

CONDITIONS OF APPROVAL Intent to drill ONLY -- CANNOT produce until the Non-Standard Location has been approved by OCD Santa Fe office

Yates Petroleum Corporation

Typical 3,000 psi Pressure System Schematic

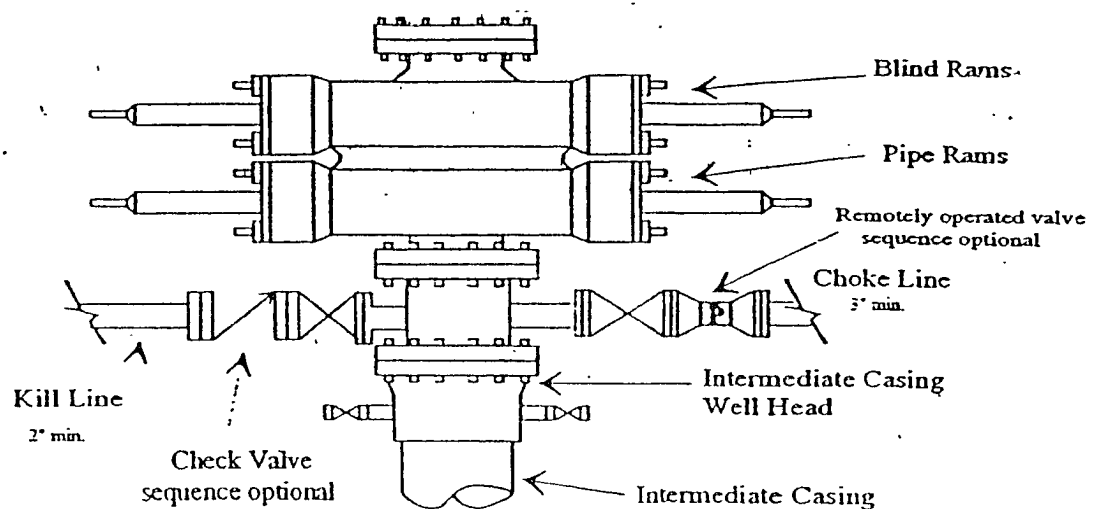

Typical 3,000 psi choke manifold assembly with at least these minimum features

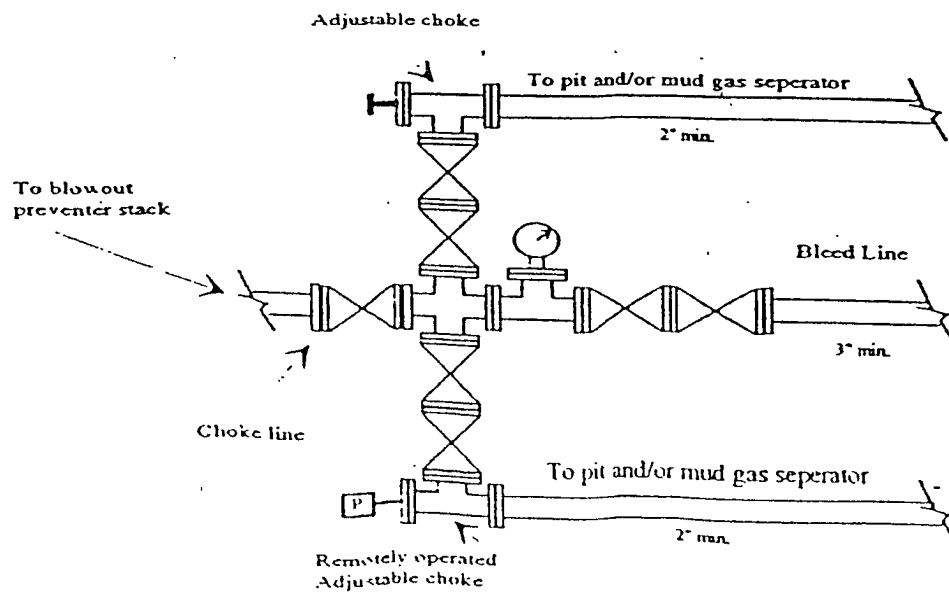

Well Name: East Sand Springs Unit No. 3 Field:

Location: 1000' FSL & 1400' FWL Sec. 6-11S-35E Lea Co, NM

GL: 4182' Zero: AGL: KB: 4200'

Spud Date: Completion Date:

Comments:

Casing Program	
Size/Wt/Grade/Conn	Depth Set
11 3/4" 42# H40	387'
8 5/8" 32# J55	4142'
5 1/2" 17 & 20# L80, N80, M95	13458'

PROPOSED CONFIGURATION

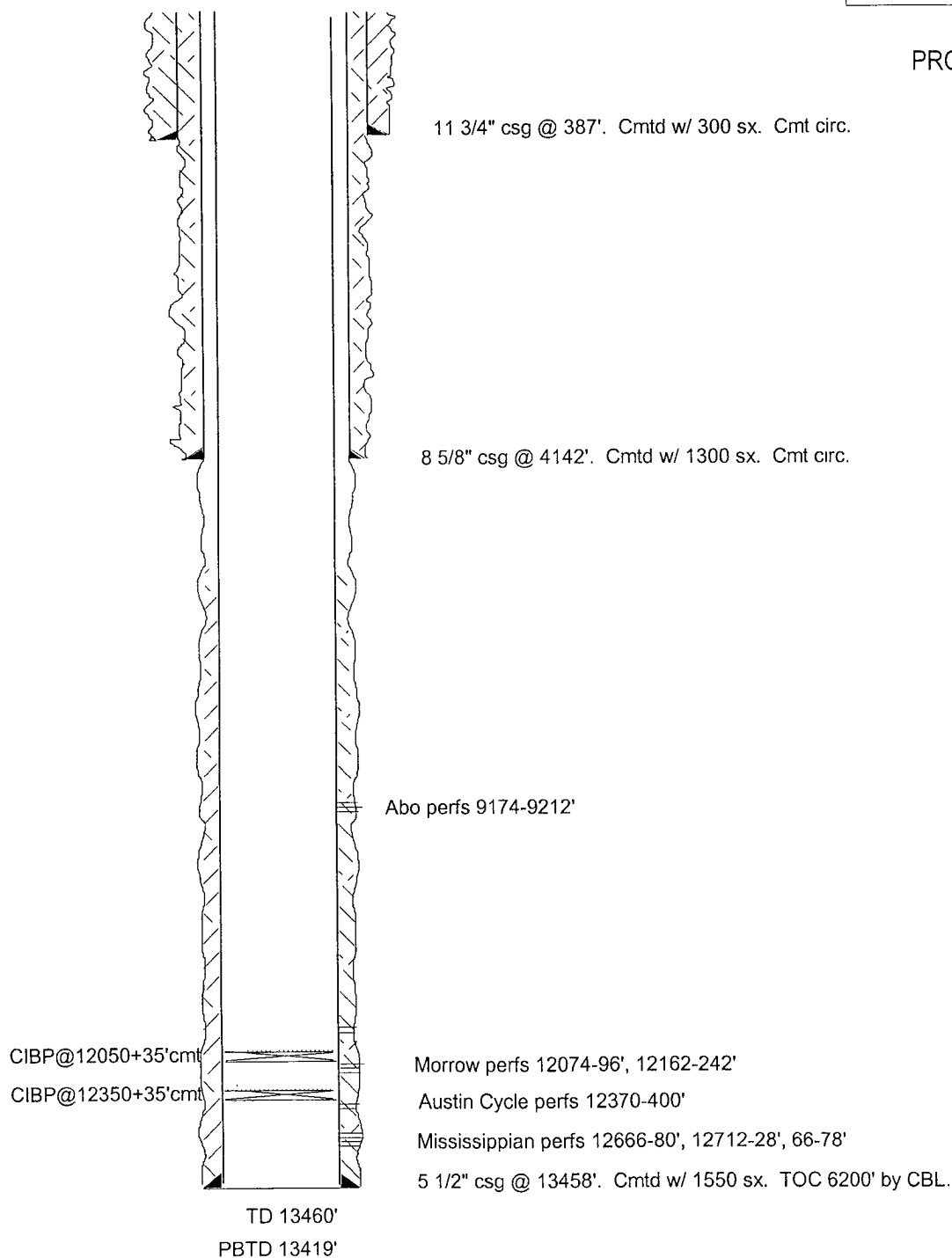

SKETCH NOT TO SCALE

DATE: 1/14/08 ESSU3B

District I
1625 N. French Dr., Hobbs, NM 88240
District II
1301 W. Grand Avenue, Artesia, NM 88210
District III
1000 Rio Brazos Rd., Aztec, NM 87410
District IV
1220 S. St. Francis Dr., Santa Fe, NM 87505

State of New Mexico
Energy, Minerals & Natural Resources Department
OIL CONSERVATION DIVISION
1220 South St. Francis Dr.
Santa Fe, NM 87505

Form C-102
Revised October 12, 2005
Submit to Appropriate District Office
State Lease - 4 Copies
Fee Lease - 3 Copies
☐ AMENDED REPORT

WELL LOCATION AND ACREAGE DEDICATION PLAT

¹ API Number 30-025-34898	² Pool Code 96803	³ Pool Name Sand Springs; Abo
⁴ Property Code 34507	⁵ Property Name East Sand Springs BFZ State	
⁷ OGRID No. 025575	⁸ Operator Name Yates Petroleum Corporation	⁶ Well Number 3
		⁹ Elevation 4182'GR

¹⁰ Surface Location

UL or lot no. N	Section 6	Township 11S	Range 35E	Lot Idn	Feet from the 1000	North/South line South	Feet from the 1400	East/West line West	County Lea
---------------------------	---------------------	------------------------	---------------------	---------	------------------------------	----------------------------------	------------------------------	-------------------------------	----------------------

¹¹ Bottom Hole Location If Different From Surface

UL or lot no.	Section	Township	Range	Lot Idn	Feet from the	North/South line	Feet from the	East/West line	County
---------------	---------	----------	-------	---------	---------------	------------------	---------------	----------------	--------

¹² Dedicated Acres 40	¹³ Joint or Infill	¹⁴ Consolidation Code	¹⁵ Order No.
--	-------------------------------	----------------------------------	-------------------------

No allowable will be assigned to this completion until all interests have been consolidated or a non-standard unit has been approved by the division.

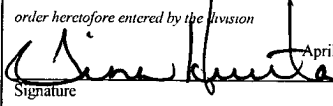
¹⁶				¹⁷ OPERATOR CERTIFICATION <i>I hereby certify that the information contained herein is true and complete to the best of my knowledge and belief, and that this organization either owns a working interest or unleased mineral interest in the land including the proposed bottom hole location or has a right to drill this well at this location pursuant to a contract with an owner of such a mineral or working interest, or to a voluntary pooling agreement or a compulsory pooling order heretofore entered by the Division</i>  Signature April 21, 2008 Date Tina Huerta Printed Name
Lot 4	Lot 3	Lot 2	Lot 1	
				¹⁸ SURVEYOR CERTIFICATION <i>I hereby certify that the well location shown on this plat was plotted from field notes of actual surveys made by me or under my supervision, and that the same is true and correct to the best of my belief</i>
				Date of Survey
				Signature and Seal of Professional Surveyor
				Certificate Number