

District I
1625 N French Dr., Hobbs, NM 88240
District II
1301 W Grand Avenue, Artesia, NM 88210
District III
1000 Rio Brazos Road, Aztec, NM 87410
District IV
1220 S St Francis Dr, Santa Fe, NM 87505

State of New Mexico
Energy Minerals and Natural Resources

Form C-144
June 1, 2004

Oil Conservation Division
1220 South St. Francis Dr.
Santa Fe, NM 87505

For drilling and production facilities, submit to appropriate NMOCD District Office.
For downstream facilities, submit to Santa Fe office

Pit or Below-Grade Tank Registration or Closure

Is pit or below-grade tank covered by a "general plan"? Yes ☐ No ☒

Type of action Registration of a pit or below-grade tank ☐ Closure of a pit or below-grade tank ☒

Operator: COG Operating LLC Telephone: 432-685-4332 e-mail address: kcarrillo@conchoresources.com
Address: Fasken Center Tower II, 550 W Texas Ave., Suite 1300, Midland, TX 79701
Facility or well name: B C Federal #33 API #: 30-025-38714 U/L or Qtr/Qtr: H Sec 20 T 17S R 32E
County: Lea Latitude: 32.822758 deg N Longitude: 103.790121 deg W NAD 1927 ☒ 1983 ☐
Surface Owner: Federal ☒ State ☐ Private ☐ Indian ☐

Pit

Type: Drilling ☒ Production ☐ Disposal ☐

Workover ☐ Emergency ☐

Lined ☒ Unlined ☐

Liner type: Synthetic ☒ Thickness: 12 mil Clay ☐

Pit Volume: 25,000 bbl

Below-grade tank

Volume: _____ bbl Type of fluid: _____

Construction material: _____

Double-walled, with leak detection? Yes ☐ If not, explain: MAY 16 2008

Depth to ground water (vertical distance from bottom of pit to seasonal high water elevation of ground water): 150'

Less than 50 feet

(20 points)

50 feet or more, but less than 100 feet

(10 points)

100 feet or more - X

(0 points) 0

Wellhead protection area (Less than 200 feet from a private domestic water source, or less than 1000 feet from all other water sources)

Yes

(20 points)

No - X

(0 points) 0

Distance to surface water (horizontal distance to all wetlands, playas, irrigation canals, ditches, and perennial and ephemeral watercourses.)

Less than 200 feet

(20 points)

200 feet or more, but less than 1000 feet

(10 points)

1000 feet or more - X

(0 points) 0

Ranking Score (Total Points)

0 points

If this is a pit closure: (1) Attach a diagram of the facility showing the pit's relationship to other equipment and tanks (2) Indicate disposal location (check the onsite box if you are burying in place) onsite ☒ offsite ☐ If offsite, name of facility: _____ (3) Attach a general description of remedial action taken including remediation start date and end date (4) Groundwater encountered: No ☐ Yes ☐ If yes, show depth below ground surface: _____ ft and attach sample results (5) Attach soil sample results and a diagram of sample locations and excavations

Closed by trench burial, procedure attached and on verbal approval by Larry Johnson on 4-30-08

Lined burial trench is located on the N side of the reserve pit area Pit contents were placed inside lined trench Site had several P&A well sites on location Due to elevated

Chlorides that were left in the reserve pit the entire pit bottom was bedded with sand and capped Trench was capped with 20 mil liner with excess of 3' on all sides and

covered with 3' of native soil Lab and field samples results are attached

I hereby certify that the information above is true and complete to the best of my knowledge and belief I further certify that the above-described pit or below-grade tank has been/will be constructed or closed according to NMOCD guidelines ☒, a general permit ☐, or an (attached) alternative OCD-approved plan ☐.

Date: 5-5-2008

Printed Name/Title: Gary Miller- Agent

Signature: _____

Your certification and NMOCD approval of this application/closure does not relieve the operator of liability should the contents of the pit or tank contaminate ground water or otherwise endanger public health or the environment Nor does it relieve the operator of its responsibility for compliance with any other federal, state, or local laws and/or regulations.

Approval

Printed Name/Title: _____

Signature: _____

Date: 5.7.08

ENVIRONMENTAL ENGINEER

Summary Report

Gary Miller
Highlander Environmental Services
1910 N. Big Spring Street
Midland, TX, 79705

Report Date: April 30, 2008

Work Order: 8042923



Project Location: Lea County, NM
Project Name: COG-BC Federal #33
Project Number: 3257

Sample	Description	Matrix	Date Taken	Time Taken	Date Received
158243	NE-20	soil	2008-04-28	00:00	2008-04-29
158244	NW-20	soil	2008-04-28	00:00	2008-04-29
158245	SE-20	soil	2008-04-28	00:00	2008-04-29
158246	SW-5	soil	2008-04-28	00:00	2008-04-29
158247	C-10	soil	2008-04-28	00:00	2008-04-29

Sample: 158243 - NE-20

Param	Flag	Result	Units	RL
Chloride		1770	mg/Kg	2.00

Sample: 158244 - NW-20

Param	Flag	Result	Units	RL
Chloride		1520	mg/Kg	2.00

Sample: 158245 - SE-20

Param	Flag	Result	Units	RL
Chloride		1050	mg/Kg	2.00

Sample: 158246 - SW-5

Param	Flag	Result	Units	RL
Chloride		234	mg/Kg	2.00

Sample: 158247 - C-10

TraceAnalysis, Inc. • 6701 Aberdeen Ave., Suite 9 • Lubbock, TX 79424-1515 • (806) 794-1296
This is only a summary. Please, refer to the complete report package for quality control data.

Report Date: April 30, 2008
3257

Work Order: 8042923
COG-BC Federal #33

Page Number: 2 of 2
Lea County, NM

Param	Flag	Result	Units	RL
Chloride		2900	mg/Kg	2.00

Highlander Environmental Corp.

Pit Closure Sampling Report

Job Number: 3257

Date: 4-28-08

Client: COG

Well Name: B.C. Fed #33

API#: 3002538714

Depth of Pit: 8'

Depth to Groundwater: 150'

Orientation of pit N S (E) W

Burial trench location from reserve pit (N) S E W

All pit sample depths are below pit bottom (BPB)

Sample Location	Depth (BPB)	Field Chloride Results (mg/Kg)	Lab Chloride Results (mg/Kg)	Soil to be excavated	Soil to be left in-situ
NE	2	2100			X
	5	2250			X
	10	2450			X
	15	2200			X
	20	1350	1770		X
NW	2	1600			X
	5	850			X
	10	500			X
	15	750			X
	20	1550	1520		X
SE	2	750			X
	5	1050			X
	10	1200			X
	15	1100			X
	20	750	1050		X
SW	2	350			X
	5	250	234		
Center	2	3300			X
	5	4100			X
	10	2600	2900		X

BGS- Below Ground Surface

BPB- Below Pit Bottom

Pit Bottom leveled, bedded w/ Sand & capped w/ 20 mil plastic liner, Pit contents placed in lined burial trench & capped - Approved by Larry Johnson 4-30-08

Highlander Environmental Corp.
Pit Sample Location Plat

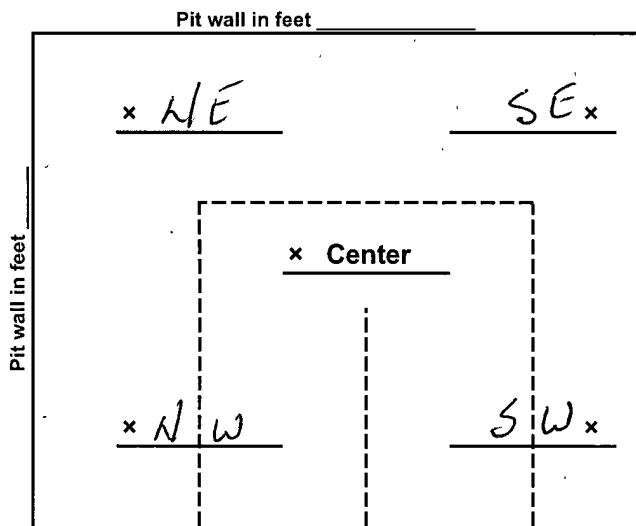

x _____ Indicates Sample Location
(Name by quarter i.e. NW, NE etc)



Draw in North Arrow

Depth of pit in feet 8

9 P&A well location

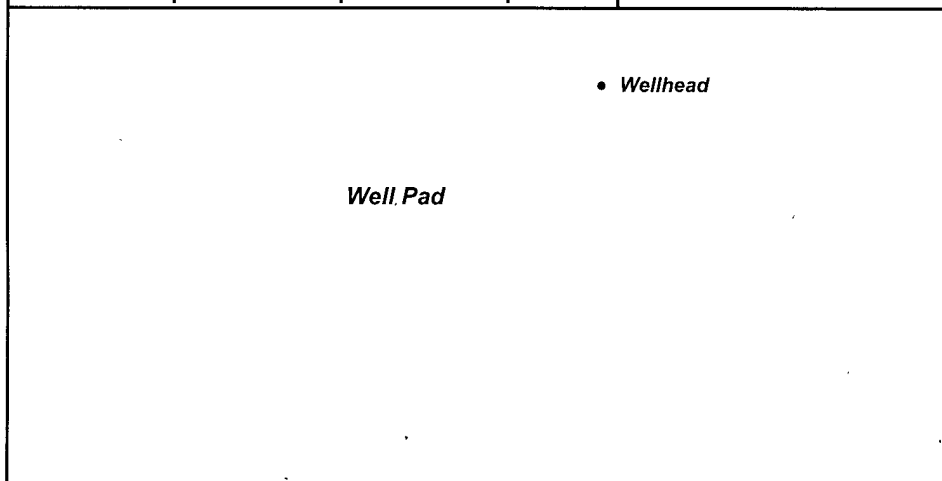

Client: COG Oper.

Well Name: BC Fed #33

API# 3002538714

There is a P&A well location just south of
The Res. Pit - Burial Trench is located N. of
Res. P.T.

District I
1625 N French Dr, Hobbs, NM 88240
District II
1301 W. Grand Avenue, Artesia, NM 88210
District III
1000 Rio Brazos Road, Aztec, NM 87410
District IV
1220 S St Francis Dr, Santa Fe, NM 87505

State of New Mexico
Energy Minerals and Natural Resources

Form C-144
June 1, 2004

Oil Conservation Division
1220 South St. Francis Dr.
Santa Fe, NM 87505

For drilling and production facilities, submit to appropriate NMOCD District Office.
For downstream facilities, submit to Santa Fe office

Pit or Below-Grade Tank Registration or Closure

Is pit or below-grade tank covered by a "general plan"? Yes ☐ No ☒

Type of action Registration of a pit or below-grade tank ☐ Closure of a pit or below-grade tank ☒

Operator **COG Operating LLC** Telephone **432-685-4332** e-mail address **kcarrillo@conchoresources.com**

Address **550 W. Texas, Suite 1300 Midland, TX 79701**

Facility or well name **BC Federal #33** API # **30-025-38714** U/L or Qtr/Qtr **H** Sec **20** T **17S** R **32E**

County **Lea** Latitude **32.820938° N** Longitude **103.71088° W** NAD. 1927 ☒ 1983 ☐

Surface Owner. Federal ☒ State ☐ Private ☐ Indian ☐

Pit

Type Drilling ☒ Production ☐ Disposal ☐

Workover ☐ Emergency ☐

Lined ☒ Unlined ☐

Liner type: Synthetic ☒ Thickness **12** mil Clay ☐

Pit Volume **25,000** bbl

Below-grade tank

Volume: _____ bbl Type of fluid _____

Construction material _____

Double-walled, with leak detection? Yes ☐ If not, explain why not _____

Depth to ground water (vertical distance from bottom of pit to seasonal high water elevation of ground water) **150'**

Less than 50 feet

50 feet or more, but less than 100 feet

100 feet or more

(20 points)

(10 points)

(0 points)

Wellhead protection area (Less than 200 feet from a private domestic water source, or less than 1000 feet from all other water sources.)

Yes

No

(20 points)

(0 points)

Distance to surface water (horizontal distance to all wetlands, playas, irrigation canals, ditches, and perennial and ephemeral watercourses)

Less than 200 feet

200 feet or more, but less than 1000 feet

1000 feet or more

(20 points)

(10 points)

(0 points)

Ranking Score (Total Points)

0 points

If this is a pit closure: (1) Attach a diagram of the facility showing the pit's relationship to other equipment and tanks. (2) Indicate disposal location: (check the onsite box if you are burying in place) onsite ☒ offsite ☐ If offsite, name of facility _____. (3) Attach a general description of remedial action taken including remediation start date and end date (4) Groundwater encountered No ☒ Yes ☐ If yes, show depth below ground surface _____ ft and attach sample results (5) Attach soil sample results and a diagram of sample locations and excavations.

Additional Comments **COG Operating LLC proposes to close the drilling pit as follows:**

1. Remove fluids from pit.
2. A deep trench pit will be constructed next to the existing reserve pit and lined with a 12 mil liner. The contents will be encapsulated in this pit and the liner will be folded over the mud & cuttings.
3. Cover liner w/20 mil liner w/ excess of 3' on all sides as per option IV.B.3.(b) of Pit and Below-Grade Tank Guidelines.
4. Cover w/ a minimum of 3' of native soil.
5. Contour pit to prevent erosion & ponding of rainwater.

I hereby certify that the information above is true and complete to the best of my knowledge and belief. I further certify that the above-described pit or below-grade tank has been/will be constructed or closed according to NMOCD guidelines ☒, a general permit ☐, or an (attached) alternative OCD-approved plan ☐.

Date **03/26/08**

Printed Name/Title **Kanicia Carrillo, Regulatory Analyst**

Signature 

Your certification and NMOCD approval of this application/closure does not relieve the operator of liability should the contents of the pit or tank contaminate ground water or otherwise endanger public health or the environment. Nor does it relieve the operator of its responsibility for compliance with any other federal, state, or local laws and/or regulations.

Approval.

Printed Name/Title _____

Signature 

ENVIRONMENTAL ENGINEER

Date **4.4.08**