

District I

1625 N. French Dr., Hobbs, NM 88240

District II

1301 W. Grand Avenue, Artesia, NM 88210

District III

1000 Rio Brazos Road, Aztec, NM 87410

District IV

1220 S. St. Francis Dr., Santa Fe, NM 87505

State of New Mexico
Energy Minerals and Natural Resources

RECEIVED

Form C-101
May 27, 2004

Oil Conservation Division

1220 South St. Francis Dr.

Santa Fe, NM 87505

Submit to appropriate District Office

MAY 27 2008

☐ AMENDED REPORT

HOBBS, OCD

APPLICATION FOR PERMIT TO DRILL, RE-ENTER, DEEPEN, PLUG BACK, OR ADD A ZONE

¹ Operator Name and Address Yates Petroleum Corporation 105 S. 4 th Street Artesia, NM 88210		² OGRID Number 025575
		³ API Number 30 -025-20698
³ Property Code 25152	³ Property Name Comet AUC State	⁶ Well No. 1
⁹ Proposed Pool 1 Undesignated Four Lakes; Atoka, North		¹⁰ Proposed Pool 2

⁷ Surface Location

UL or lot no	Section	Township	Range	Lot Idn	Feet from the	North/South line	Feet from the	East/West line	County
O	23	11S	34E		660	South	1980	East	Lea

⁸ Proposed Bottom Hole Location If Different From Surface

UL or lot no	Section	Township	Range	Lot Idn	Feet from the	North/South line	Feet from the	East/West line	County

Additional Well Information

¹¹ Work Type Code P	¹² Well Type Code G	¹³ Cable/Rotary N/A	¹⁴ Lease Type Code S	¹⁵ Ground Level Elevation 4156'
¹⁶ Multiple N	¹⁷ Proposed Depth N/A	¹⁸ Formation Mississippian	¹⁹ Contractor N/A	²⁰ Spud Date ASAP
Depth to Groundwater		Distance from nearest fresh water well		Distance from nearest surface water
Pit: Liner: Synthetic <input type="checkbox"/> _____ mls thick Clay <input type="checkbox"/> Pit Volume: _____ bbls Drilling Method: _____ Closed-Loop System <input checked="" type="checkbox"/> Fresh Water <input type="checkbox"/> Brine <input type="checkbox"/> Diesel/Oil-based <input type="checkbox"/> Gas/Air <input type="checkbox"/>				

²¹ Proposed Casing and Cement Program

Hole Size	Casing Size	Casing weight/foot	Setting Depth	Sacks of Cement	Estimated TOC

IN PLACE

²² Describe the proposed program. If this application is to DEEPEN or PLUG BACK, give the data on the present productive zone and proposed new productive zone. Describe the blowout prevention program, if any Use additional sheets if necessary.

Yates Petroleum Corporation plans to recompleate this well in the Atoka as follows:

Set composite flow through plug @ 12,145'. Perforate Atoka 12,095-12,101' (36 holes). Stimulate as needed.
Set RBP @ 12,080'. Perforate 11,952-11,955' (18 holes); 11,994-11,998' (24 holes); 12,009-12,016' (42 holes)
& 12,048-12,054' (36 holes). Stimulate as needed.

**Permit Expires 2 Years From Approval
Date Unless Drilling Underway**

Plugback

²³ I hereby certify that the information given above is true and complete to the best of my knowledge and belief. I further certify that the drilling pit will be constructed according to NMOCD guidelines <input type="checkbox"/> , a general permit <input type="checkbox"/> , or an (attached) alternative OCD-approved plan <input type="checkbox"/> .		OIL CONSERVATION DIVISION	
Signature: <i>Allison Barton</i>		Approved by: <i>Chris Williams</i>	
Printed name: Allison Barton		Title: OC DISTRICT SUPERVISOR/GENERAL MANAGER	
Title: Regulatory Compliance Technician		Approval Date: MAY 28 2008	
E-mail Address: abarton@ypcnm.com		Expiration Date	
Date: 5/23/08	Phone: (575) 748-1471	Conditions of Approval Attached <input type="checkbox"/>	

Well Name: Comet AUC State No. 1 Field: _____
 Location: 660' FSL & 1980' FEL Sec. 23-11S-34E Lea Co, NM
 GL: 4145' Zero: _____ AGL: _____ KB: 4152'
 Spud Date: _____ Completion Date: _____
 Comments: Re-entry of J.M Huber Gulf State No. 1-A

Casing Program	
Size/Wt/Grade/Conn	Depth Set
13 3/8" 48 & 54#	356'
8 5/8" 24 & 32#	4116'
4 1/2" 11.6# HCP110	12460'

PROPOSED CONFIGURATION

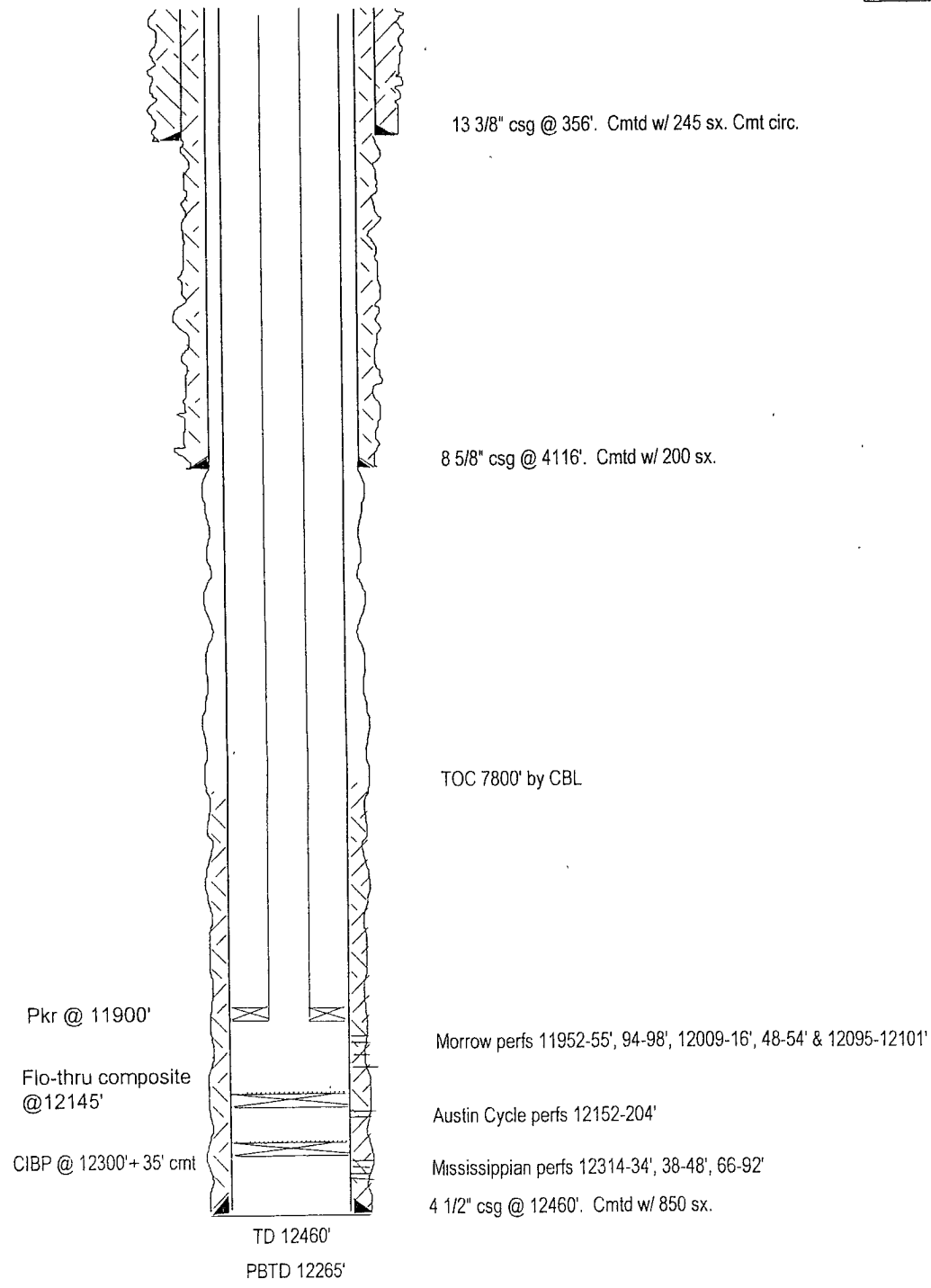

SKETCH NOT TO SCALE

DATE: 11/9/07 COMET1A

Yates Petroleum Corporation

Typical 3,000 psi Pressure System Schematic

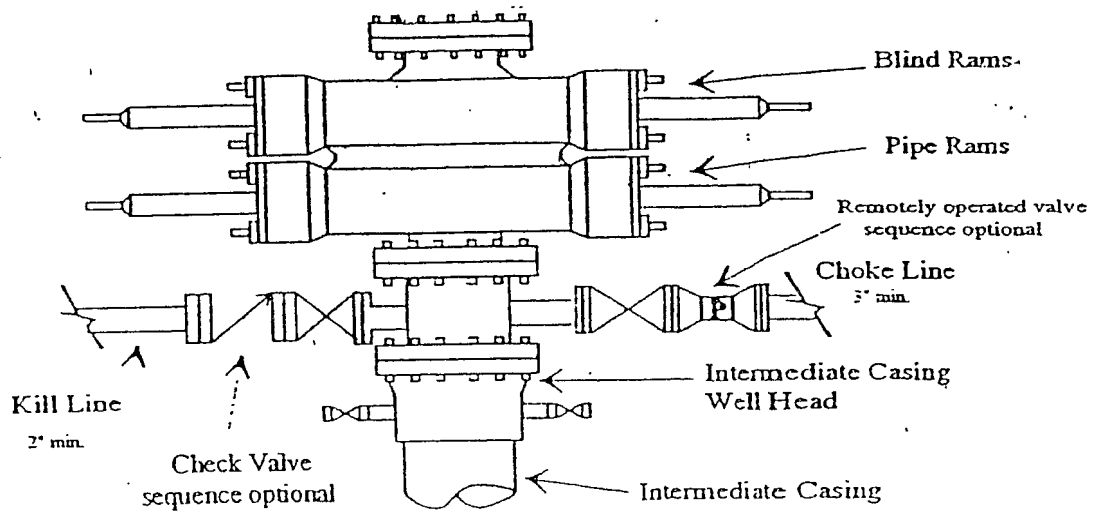

Typical 3,000 psi choke manifold assembly with at least these minimum features

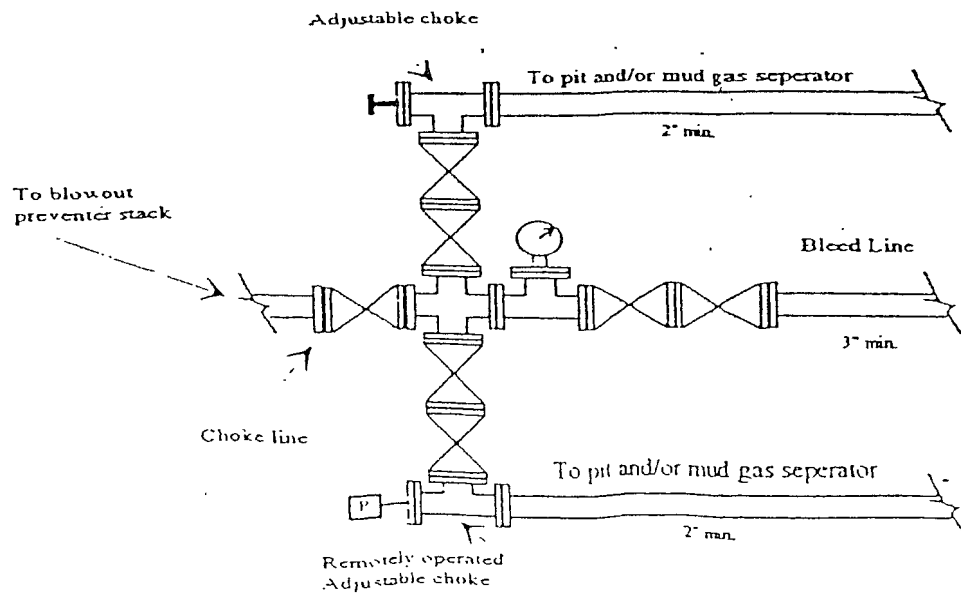

District I
1625 N. French Dr., Hobbs, NM 88240

District II
1301 W. Grand Avenue, Artesia, NM 88210

District III
1000 Rio Brazos Rd., Aztec, NM 87410

District IV
1220 S. St. Francis Dr., Santa Fe, NM 87505

State of New Mexico
Energy, Minerals & Natural Resources Department
OIL CONSERVATION DIVISION
1220 South St. Francis Dr.
Santa Fe, NM 87505

Form C-102
Revised October 12, 2005
Submit to Appropriate District Office
State Lease - 4 Copies
Fee Lease - 3 Copies

☐ AMENDED REPORT

WELL LOCATION AND ACREAGE DEDICATION PLAT

¹ API Number 30-025-20698	² Pool Code 76880	³ Pool Name Undesignated Four Lakes; Atoka, North
⁴ Property Code 25152	⁵ Property Name Comet AUC State	⁶ Well Number 1
⁷ OGRID No. 025575	⁸ Operator Name Yates Petroleum Corporation	⁹ Elevation 4156'

¹⁰ Surface Location

UL or lot no O	Section 23	Township 11S	Range 34E	Lot Idn	Feet from the 660	North/South line South	Feet from the 1980	East/West line East	County Lea
--------------------------	----------------------	------------------------	---------------------	---------	-----------------------------	----------------------------------	------------------------------	-------------------------------	----------------------

¹¹ Bottom Hole Location If Different From Surface

UL or lot no	Section	Township	Range	Lot Idn	Feet from the	North/South line	Feet from the	East/West line	County
¹² Dedicated Acres 320	¹³ Joint or Infill	¹⁴ Consolidation Code	¹⁵ Order No.						

No allowable will be assigned to this completion until all interests have been consolidated or a non-standard unit has been approved by the division.

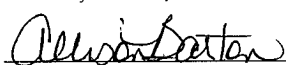
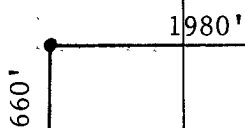
16				¹⁷ OPERATOR CERTIFICATION <i>I hereby certify that the information contained herein is true and complete to the best of my knowledge and belief, and that this organization either owns a working interest or unleased mineral interest in the land including the proposed bottom hole location or has a right to drill this well at this location pursuant to a contract with an owner of such a mineral or working interest, or to a voluntary pooling agreement or a compulsory pooling order heretofore entered by the division</i>  Signature 5/23/08 Date Allison Barton Printed Name
				¹⁸ SURVEYOR CERTIFICATION <i>I hereby certify that the well location shown on this plat was plotted from field notes of actual surveys made by me or under my supervision, and that the same is true and correct to the best of my belief.</i> Date of Survey Signature and Seal of Professional Surveyor Certificate Number