

District I  
1625 N. French Dr., Hobbs, NM 88240  
District II  
1301 W. Grand Avenue, Artesia, NM 88210  
District III  
1000 Rio Brazos Road, Aztec, NM 87410  
District IV  
1220 S. St. Francis Dr., Santa Fe, NM 87505

State of New Mexico  
Energy Minerals and Natural Resources

Form C-101  
May 27, 2004

Oil Conservation Division  
1220 South St. Francis Dr.  
Santa Fe, NM 87505

Submit to appropriate District Office

☐ AMENDED REPORT

APPLICATION FOR PERMIT TO DRILL, RE-ENTER, DEEPEN, PLUGBACK, OR ADD A ZONE

Operator Name and Address VANGUARD PERMIAN, LLC. 1209 SOUTH MAIN LOVINGTON, NEW MEXICO 88260		2 OGRID Number 258350
Property Code 305160	Property Name STATE SECTION I-LA	Well No. 22
Proposed Pool 1 LOVINGTON-DRINKARD (40490)		Proposed Pool 2

7 Surface Location

UL or lot no.	Section	Township	Range	Lot Idn	Feet from the	North/South line	Feet from the	East/West line	County
G	1	17S	36E		2310'	NORTH	1650'	EAST	LEA

8 Proposed Bottom Hole Location If Different From Surface

UL or lot no.	Section	Township	Range	Lot Idn	Feet from the	North/South line	Feet from the	East/West line	County

Additional Well Information

11 Work Type Code N	12 Well Type Code O	13 Cable/Rotary ROTARY	14 Lease Type Code S	15 Ground Level Elevation 3823'
16 Multiple NO	17 Proposed Depth 8400'	18 Formation DRINKARD	19 Contractor WHEN APPROVED	20 Spud Date
Depth to Groundwater 55' +		Distance from nearest fresh water well .5 Miles		Distance from nearest surface water None
Pit: Liner: Synthetic <input checked="" type="checkbox"/> 12 mils thick Clay <input type="checkbox"/> Pit Volume: 15M bbls Drilling Method:				
Closed-Loop System <input type="checkbox"/> Fresh Water <input checked="" type="checkbox"/> Brine <input checked="" type="checkbox"/> Diesel/Oil-based <input type="checkbox"/> Gas/Air <input type="checkbox"/>				

21 Proposed Casing and Cement Program

Hole Size	Casing Size	Casing weight/foot	Setting Depth	Sacks of Cement	Estimated TOC
17 1/2"	13 3/8"	48#	500'	350 Sx.	SURFACE
11"	8 5/8"	32#	4500'	1015 Sx.	SURFACE
7 7/8"	4 1/2"	11.6#	8400'	1140 Sx.	SURFACE

22 Describe the proposed program. If this application is to DEEPEN or PLUG BACK, give the data on the present productive zone and proposed new productive zone. Describe the blowout prevention program, if any. Use additional sheets if necessary.

*Pit liner & contents must be removed to approved OCD facility and pit tested for chlorides, TPH, BTEX if liner compromised. All*

SEE ATTACHED SHEET FOR DETAIL

Permit Expires 2 Years From Approval  
Date Unless Drilling Underway

RECEIVED

JUN 05 2008

HOBBS OCD

I hereby certify that the information given above is true and complete to the best of my knowledge and belief. I further certify that the drilling pit will be constructed according to NMOCD guidelines <input checked="" type="checkbox"/> a general permit <input type="checkbox"/> or an (attached) alternative OCD-approved plan <input type="checkbox"/> .		OIL CONSERVATION DIVISION	
Printed name: Joe T. Janica		Approved by: <i>Chris Williams</i>	
Title: Permit Engineer		Title: OC DISTRICT SUPERVISOR/GENERAL MANAGER	
E-mail Address: joejanica@valornet.com		Approval Date: JUN 05 2008 Expiration Date:	
Date: 06/05/08	Phone: 575-391-8503	Conditions of Approval Attached <input type="checkbox"/> <i>Please see comments above.</i>	

1. Drill 26" hole to 40'. Set 40' of 20" conductor and cement to surface with Redi-mix.
2. Drill 17½" hole to 500'. Run and set 500' of 13 3/8" 48# H-40 ST&C casing. Cement with 150 Sx. of 35/65 CLASS "C" POZ + 6% Bentonite + 3% CaCl, + 4#/Sx. Gilsonite, + .125# polyflakes/Sx. Yield 1.94, tail in with 200 Sx. of Class "C" cement + 2% CaCl, Yield 1.34, circulate cement to surface.
3. Drill 11" hole to 4500'. Run and set 4500' of 8 5/8" 32# J-55 ST&C casing. Cement with 15 Sx. of 50/50 Class "C" POZ + 5% Salt, + 10% Bentonite, 5#/Sx. Gilsonite, + .125# polyflakes; + .2% Antifoamer, Yield 2.47. Tail in with 200 Sx. Sx. of Class "C" cement + .1% Retarder, Yield 1.32. Circulate cement to surface.
4. Drill 7 7/8" hole to 8400'. Run and set 8400' of 4½" 11.6# J-55 LT&C casing. Cement with 525 Sx. of 50/50 Class "H" POZ cement + 5% Salt, + 10% Bentonite, + .2% Dispersant, + .2% Uniflac, + .25% Retarder, +.2% Antifoamer, Yield 2.47. Tail in with 615 Sx. of TXI Light weight cement + 1% Salt, + .3% Uniflac, + .1% Dispersant, + .3% Retarder, Yield 1.4, circulate cement to surface.

# State of New Mexico

## DISTRICT I

1625 N. FRENCH DR., HOBBS, NM 88240

Energy, Minerals and Natural Resources Department

Form C-102

## DISTRICT II

1301 W. GRAND AVENUE, ARTESIA, NM 88210

## OIL CONSERVATION DIVISION

1220 SOUTH ST. FRANCIS DR.  
Santa Fe, New Mexico 87505

Revised October 12, 2005  
Submit to Appropriate District Office  
State Lease - 4 Copies  
Fee Lease - 3 Copies

## DISTRICT III

1000 Rio Brazos Rd., Aztec, NM 87410

## DISTRICT IV

1220 S. ST. FRANCIS DR., SANTA FE, NM 87505

## WELL LOCATION AND ACREAGE DEDICATION PLAT

☐ AMENDED REPORT

API Number <b>30-025-38962</b>	Pool Code 40490 -	Pool Name LOVINGTON-DRINKARD
Property Code <b>305160</b>	Property Name STATE SECTION 11A	Well Number 22
GRID No. 258350	Operator Name VANGUARD PERMIAN, LLC	Elevation 3823'

### Surface Location

UL or lot No.	Section	Township	Range	Lot Idn	Feet from the	North/South line	Feet from the	East/West line	County
G	1	17-S	36-E		2310	NORTH	1650	EAST	LEA

### Bottom Hole Location If Different From Surface

UL or lot No.	Section	Township	Range	Lot Idn	Feet from the	North/South line	Feet from the	East/West line	County
Dedicated Acres 40	Joint or Infill	Consolidation Code	Order No.						

NO ALLOWABLE WILL BE ASSIGNED TO THIS COMPLETION UNTIL ALL INTERESTS HAVE BEEN CONSOLIDATED  
OR A NON-STANDARD UNIT HAS BEEN APPROVED BY THE DIVISION

<p>LOT 4</p> <p>39.63 AC</p> <p>LOT 3</p> <p>39.73 AC</p> <p>LOT 2</p> <p>39.83 AC</p> <p>LOT 1</p> <p>39.93 AC</p> <p>2310'</p> <p>1650'</p> <p>GEODETTIC COORDINATES NAD 27 NME Y=679908.7 N X=816017.5 E LAT.=32.864917° N LONG =103.304149° W</p>	<p><b>OPERATOR CERTIFICATION</b></p> <p>I hereby certify that the information herein is true and complete to the best of my knowledge and belief, and that this organization either owns a working interest or unleased mineral interest in the land including the proposed bottom hole location or has a right to drill this well at this location pursuant to a contract with an owner of such mineral or working interest, or to a voluntary pooling agreement or a compulsory pooling order heretofore entered by the division.</p> <p><i>Joe T. Janica</i> Signature Date Joe T. Janica 06/05/08 Printed Name</p> <p><b>SURVEYOR CERTIFICATION</b></p> <p>I hereby certify that the well location shown on this plat was plotted from field notes of actual surveys made by me or under my supervision, and that the same is true and correct to the best of my belief.</p> <p>RONALD J. EIDSON Date Surveyed: 6/29/08 AR Signature: &amp; Seal of Professional Surveyor Certificate No GARY EIDSON 12641 RONALD J. EIDSON 3239</p>
---	--

SECTION 1, TOWNSHIP 17 SOUTH, RANGE 36 EAST, N.M.P.M.,  
LEA COUNTY, NEW MEXICO

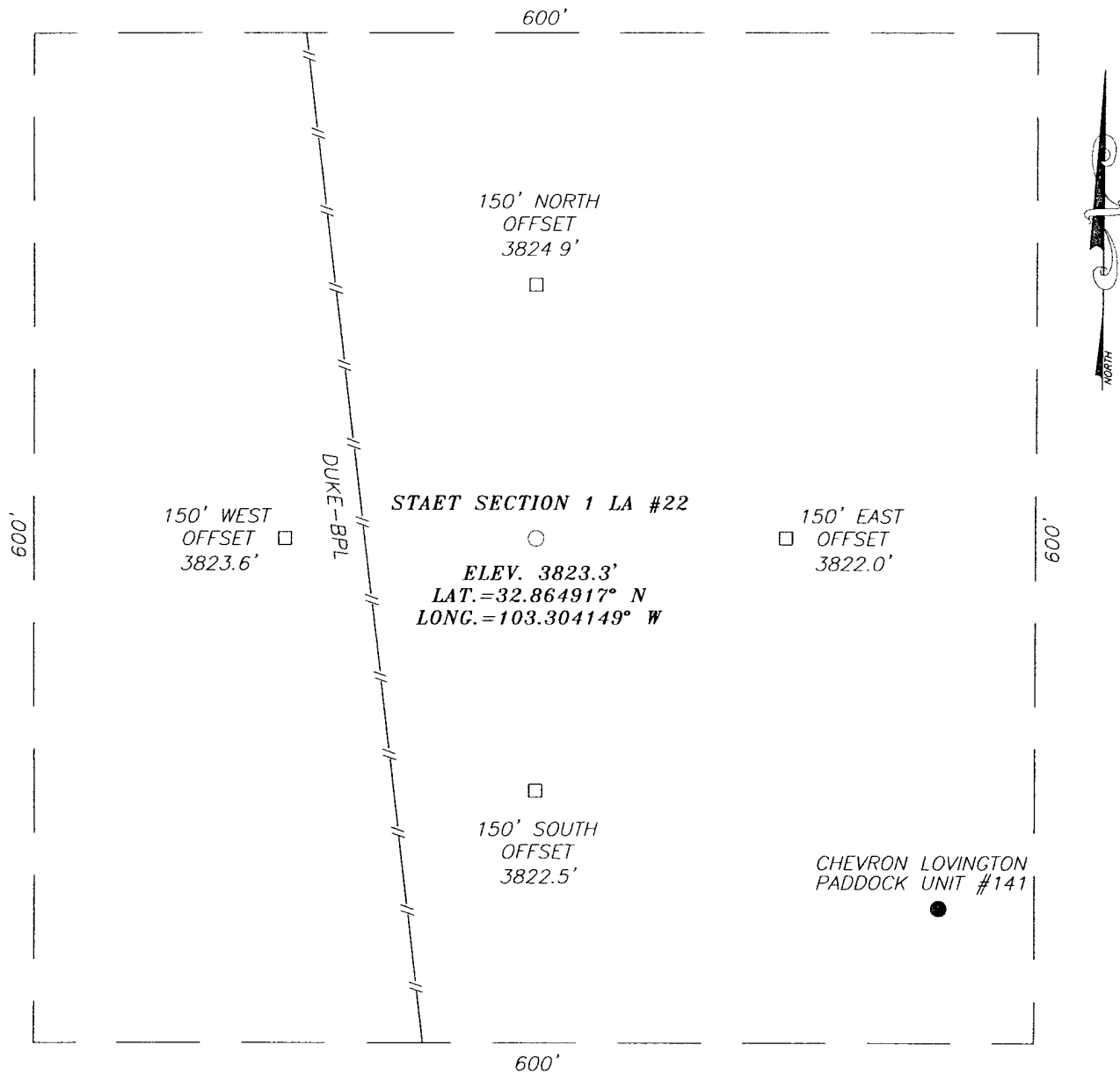

DIRECTIONS TO LOCATION

FROM THE INTERSECTION OF U.S. HWY. #18 AND WEST STILES ROAD, GO NORTH ON U.S. HWY. #18 FOR APPROX. 1.6 MILES. TURN LEFT AND GO WEST APPROX. 0.9 MILES. TURN LEFT AND GO SOUTH APPROX. 0.5 MILES. THIS LOCATION IS EAST OF LEASE ROAD APPROX. 500 FEET.

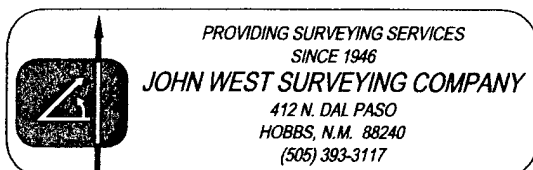
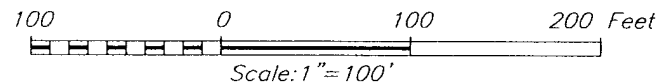

VANGUARD PERMIAN, LLC

STATE SECTION 1 LA #22 WELL  
LOCATED 2310 FEET FROM THE NORTH LINE  
AND 1650 FEET FROM THE EAST LINE OF SECTION 1,  
TOWNSHIP 17 SOUTH, RANGE 36 EAST, N.M.P.M.,  
LEA COUNTY, NEW MEXICO

Survey Date: 5/23/08		Sheet 1 of 1 Sheets	
W.O. Number. 08.11.0789		Dr By AR	Rev 1-N/A
Date: 5/29/08	Disk:	08110789	Scale: 1"=100'

# VICINITY MAP

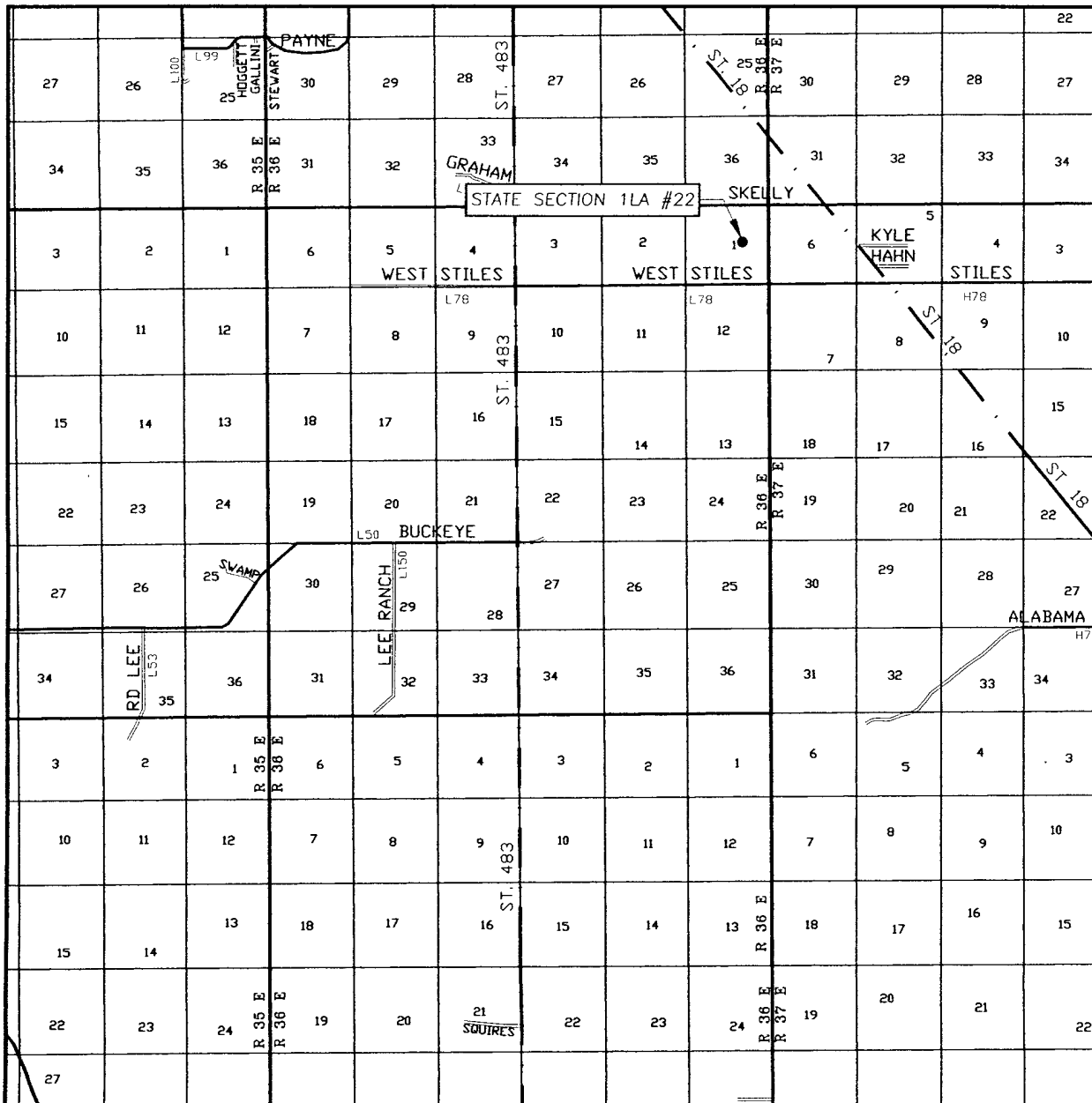

SCALE: 1" = 2 MILES

SEC. 1 TWP. 17-S RGE. 36-E

SURVEY N.M.P.M.

COUNTY LEA STATE NEW MEXICO

DESCRIPTION 2310' FNL & 1650' FEL

ELEVATION 3823'

OPERATOR VANGUARD PERMIAN, LLC

LEASE STATE SECTION 1LA



**PROVIDING SURVEYING SERVICES**  
**SINCE 1946**  
**JOHN WEST SURVEYING COMPANY**  
 412 N. DAL PASO  
 HOBBS, N.M. 88240  
 (505) 393-3117

# LOCATION VERIFICATION MAP

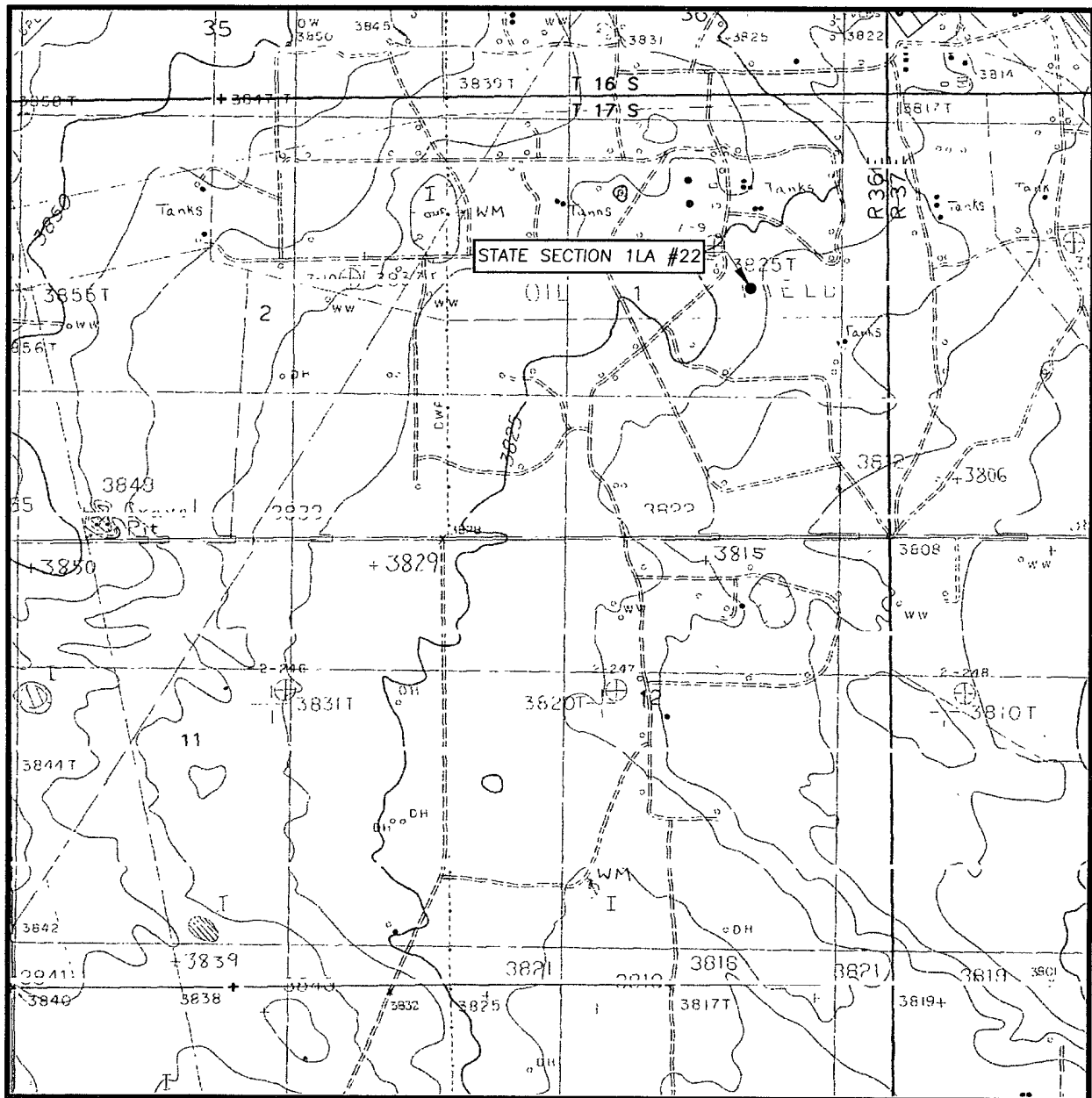

SCALE: 1" = 2000'

CONTOUR INTERVAL:  
LOVINGTON SE, N.M. - 10'

SEC. 1 TWP. 17-S RGE. 36-E

SURVEY \_\_\_\_\_ N.M.P.M.

COUNTY LEA STATE NEW MEXICO

DESCRIPTION 2310' FNL & 1650' FEL

ELEVATION 3823'

OPERATOR VANGUARD PERMIAN, LLC

LEASE STATE SECTION 1LA #22

U.S.G.S. TOPOGRAPHIC MAP  
LOVINGTON SE, N.M.

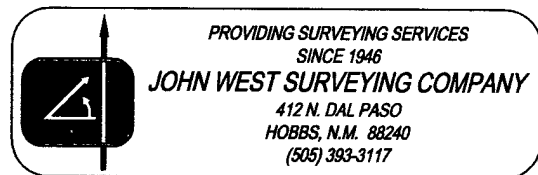

# BLOWOUT PREVENTER SYSTEM

3000 PSI

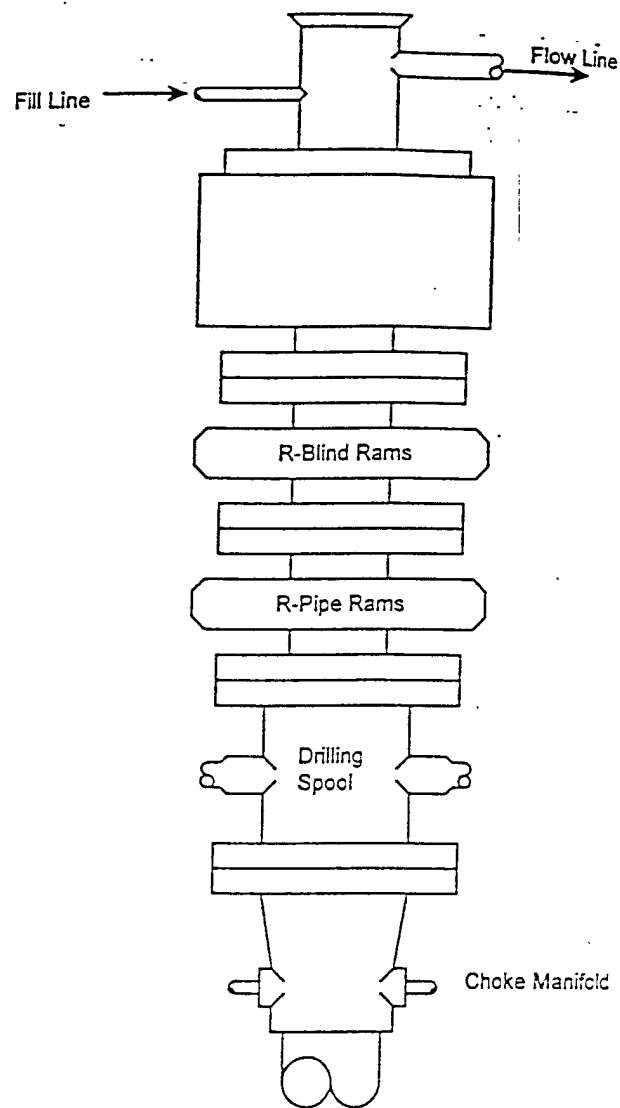

Type 900 SERIES  
3000 PSI WP

## Choke Manifold Assembly for 5M WP System

