

District I
1625 N French Drive, Hobbs, NM 88240

District II
1301 W Grand Avenue, Artesia NM 88210

District III
1000 Rio Brazos Road, Aztec, NM 87410

District IV
1220 S St Francis Dr Santa Fe, NM 87505

State of New Mexico
Energy, Minerals and Natural Resources Department

Form C-107A
Revised June 10, 2003

Oil Conservation Division
1220 South St. Francis Dr.
Santa Fe, New Mexico 87505

APPLICATION TYPE
 X Single Well
 X Establish Pre-Approved Pools
EXISTING WELLBORE
 Yes X No

APPLICATION FOR DOWNHOLE COMMINGLING

CHEVRON U.S.A. INC. 15 SMITH ROAD, MIDLAND, TX 79705

Operator Address

C.H. Weir B #14 B-11-20S-37E LEA

Lease Well No Unit Letter-Section-Township-Range County

OGRID No. 4323 Property Code 29920 API No. 30-025-38966 Lease Type: Federal State X Fee

DATA ELEMENT	UPPER ZONE	INTERMEDIATE ZONE	LOWER ZONE
Pool Name	WEIR, BLINEBRY, EAST	MONUMENT, TUBB	SKAGGS, DRINKARD
Pool Code	63800	47090	57000
Top and Bottom of Pay Section (Perforated or Open-Hole Interval)	5700'-6300' PERFORATED	6300'-6600' PERFORATED	6600'-7000' PERFORATED
Method of Production (Flowing or Artificial Lift)	ARTIFICIAL LIFT	ARTIFICIAL LIFT	ARTIFICIAL LIFT
Bottomhole Pressure (Note: Pressure data will not be required if the bottom perforation in the lower zone is within 150% of the depth of the top perforation in the upper zone)	-	-	-
Oil Gravity or Gas BTU (Degree API or Gas BTU)	36	36	36
Producing, Shut-In or New Zone	NEW ZONE	NEW ZONE	NEW ZONE
Date and Oil/Gas/Water Rates of Last Production. (Note: For new zones with no production history, applicant shall be required to attach production estimates and supporting data.)	L.R. KERSHAW #16 – Offset Date: 12/3/2007 Rates: Oil Gas 45 BOPD 174 MCFPD	L.R. KERSHAW #16 – Offset Date: 12/3/2007 Rates: Oil Gas 54 BOPD 252 MCFPD	L.R. KERSHAW #16 – Offset Date: 12/3/2007 Rates: Oil Gas 59 BOPD 136 MCFPD
Fixed Allocation Percentage (Note: If allocation is based upon something other than current or past production, supporting data or explanation will be required.)	Oil Gas 28.26% 30.98% 31%	Oil Gas 34.10% 44.82% 45%	Oil Gas 37.64% 24.20% 38%

ADDITIONAL DATA

Are all working, royalty and overriding royalty interests identical in all commingled zones? Yes X No

If not, have all working, royalty and overriding royalty interest owners been notified by certified mail? Yes No

Are all produced fluids from all commingled zones compatible with each other? Yes X No

Will commingling decrease the value of production? Yes No X

If this well is on, or communitized with, state or federal lands, has either the Commissioner of Public Lands or the United States Bureau of Land Management been notified in writing of this application? Yes No

NMOCD Reference Case No. applicable to this well:

Attachments:

C-102 for each zone to be commingled showing its spacing unit and acreage dedication.

Production curve for each zone for at least one year. (If not available, attach explanation.)

For zones with no production history, estimated production rates and supporting data.

Data to support allocation method or formula.

Notification list of working, royalty and overriding royalty interests for uncommon interest cases.

Any additional statements, data or documents required to support commingling

PRE-APPROVED POOLS

If application is to establish Pre-Approved Pools, the following additional information will be required:

List of other orders approving downhole commingling within the proposed Pre-Approved Pools

List of all operators within the proposed Pre-Approved Pools

Proof that all operators within the proposed Pre-Approved Pools were provided notice of this application

Bottomhole pressure data.

I hereby certify that the information above is true and complete to the best of my knowledge and belief.

SIGNATURE TITLE Petroleum Engineer DATE 6/12/2008

TYPE OR PRINT NAME Richard A. Jenkins TELEPHONE NO. (432)687-7120

E-MAIL ADDRESS rjdg@chevron.com

District I
1625 N. French Dr., Hobbs, NM 88240

District II
811 South First, Artesia, NM 88210

District III
1000 Rio Brazos Rd., Aztec, NM 87410

District IV
2040 South Pacheco, Santa Fe, NM 87505

State of New Mexico
Energy, Minerals & Natural Resources Department

Form C-102
Revised March 17, 1999

OIL CONSERVATION DIVISION

2040 South Pacheco
Santa Fe, NM 87505

Submit to Appropriate District Office
State Lease - 4 Copies
Fee Lease - 3 Copies

☐ **AMENDED REPORT**

WELL LOCATION AND ACREAGE DEDICATION PLAT

¹ API Number 30-025-38966	² Pool Code 63800	³ Pool Name Weir; Blinbry, East
⁴ Property Code 29920	⁵ Property Name C.H. Weir B	⁶ Well Number 14
⁷ OGRID No 4323	⁸ Operator Name Chevron U.S.A., Inc.	⁹ Elevation 3604'



¹⁰ **Surface Location**

UL or Lot No B	Section 11	Township 20S	Range 37E	Lot Idn	Feet from the 660'	North/South line North	Feet from the 1980'	East/West line East	County Lea
-------------------	---------------	-----------------	--------------	---------	-----------------------	---------------------------	------------------------	------------------------	---------------

¹¹ **Bottom Hole Location If Different From Surface**

UL or Lot No	Section	Township	Range	Lot Idn	Feet from the	North/South line	Feet from the	East/West line	County
¹² Dedicated Acres 40	¹³ Joint or Infill	¹⁴ Consolidation Code	¹⁵ Order No.						

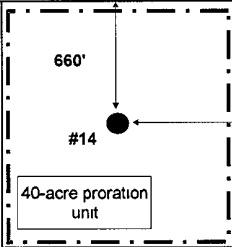
**NO ALLOWABLE WILL BE ASSIGNED TO THIS COMPLETION UNTIL ALL INTERESTS HAVE BEEN CONSOLIDATED OR A
NON-STANDARD UNIT HAS BEEN APPROVED BY THE DIVISION**

16		1 OPERATOR CERTIFICATION <i>I hereby certify that the information contained herein is true and complete to the best of my knowledge and belief</i>  Signature Richard A. Jenkins Printed Name NM Petroleum Engineer Date 6/12/08
		1 SURVEYOR CERTIFICATION <i>I hereby certify that the well location shown on this plat was plotted from field notes of actual surveys made by me or under my supervision, and that the same is true and correct to the best of my belief.</i> Signature and Seal of Professional Surveyor Certificate Number

District I
1625 N. French Dr., Hobbs, NM 88240

District II
811 South First, Artesia, NM 88210

District III
1000 Rio Brazos Rd., Aztec, NM 87410

District IV
2040 South Pacheco, Santa Fe, NM 87505

State of New Mexico
Energy, Minerals & Natural Resources Department

Form C-102
Revised March 17, 1999

OIL CONSERVATION DIVISION

2040 South Pacheco
Santa Fe, NM 87505

Submit to Appropriate District Office
State Lease - 4 Copies
Fee Lease - 3 Copies

☐ AMENDED REPORT

WELL LOCATION AND ACREAGE DEDICATION PLAT

¹ API Number 30-025-38966	² Pool Code 40790	³ Pool Name Monument; Tubb
⁴ Property Code 29920	⁵ Property Name C.H. Weir B	⁶ Well Number 14
⁷ OGRID No 4323	⁸ Operator Name Chevron U.S.A., Inc.	⁹ Elevation 3604'

¹⁰ Surface Location

UL or Lot No B	Section 11	Township 20S	Range 37E	Lot Idn	Feet from the 660'	North/South line North	Feet from the 1980'	East/West line East	County Lea
-------------------	---------------	-----------------	--------------	---------	-----------------------	---------------------------	------------------------	------------------------	---------------

¹¹ Bottom Hole Location If Different From Surface

UL or Lot No	Section	Township	Range	Lot Idn	Feet from the	North/South line	Feet from the	East/West line	County
¹² Dedicated Acres 80	¹³ Joint or Infill	¹⁴ Consolidation Code	¹⁵ Order No						

NO ALLOWABLE WILL BE ASSIGNED TO THIS COMPLETION UNTIL ALL INTERESTS HAVE BEEN CONSOLIDATED OR A NON-STANDARD UNIT HAS BEEN APPROVED BY THE DIVISION

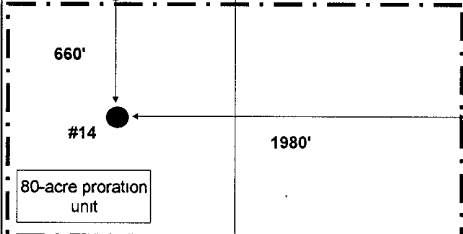
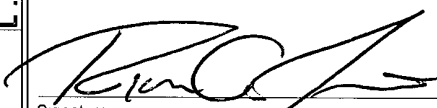
16		<p>1</p> <p>OPERATOR CERTIFICATION</p> <p><i>I hereby certify that the information contained herein is true and complete to the best of my knowledge and belief</i></p> <p></p> <p>Signature Richard A. Jenkins</p> <p>Printed Name NM Petroleum Engineer</p> <p>Date 6/12/08</p>
		<p>1</p> <p>SURVEYOR CERTIFICATION</p> <p><i>I hereby certify that the well location shown on this plat was plotted from field notes of actual surveys made by me or under my supervision, and that the same is true and correct to the best of my belief</i></p> <p>Signature and Seal of Professional Surveyor</p>
		Certificate Number

District I
1625 N. French Dr., Hobbs, NM 88240

District II
811 South First, Artesia, NM 88210

District III
1000 Rio Brazos Rd., Aztec, NM 87410

District IV
2040 South Pacheco, Santa Fe, NM 87505

State of New Mexico
Energy, Minerals & Natural Resources Department

Form C-102
Revised March 17, 1999

OIL CONSERVATION DIVISION

2040 South Pacheco
Santa Fe, NM 87505

Submit to Appropriate District Office
State Lease - 4 Copies
Fee Lease - 3 Copies

☐ AMENDED REPORT

WELL LOCATION AND ACREAGE DEDICATION PLAT

¹ API Number 30-025-38966	² Pool Code 57000	³ Pool Name Skaggs, Drinkard
⁴ Property Code 29920	⁵ Property Name C.H. Weir B	⁶ Well Number 14
⁷ OGRID No 4323	⁸ Operator Name Chevron U.S.A., Inc.	⁹ Elevation 3604'

¹⁰ Surface Location

UL or Lot No	Section	Township	Range	Lot Idn	Feet from the	North/South line	Feet from the	East/West line	County
B	11	20S	37E		660'	North	1980'	East	Lea

¹¹ Bottom Hole Location If Different From Surface

UL or Lot No.	Section	Township	Range	Lot Idn	Feet from the	North/South line	Feet from the	East/West line	County
¹² Dedicated Acres 40	¹³ Joint or Infill	¹⁴ Consolidation Code	¹⁵ Order No						

NO ALLOWABLE WILL BE ASSIGNED TO THIS COMPLETION UNTIL ALL INTERESTS HAVE BEEN CONSOLIDATED OR A
NON-STANDARD UNIT HAS BEEN APPROVED BY THE DIVISION

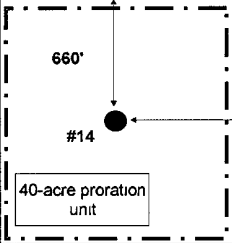
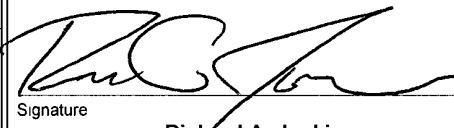
16			¹ OPERATOR CERTIFICATION <i>I hereby certify that the information contained herein is true and complete to the best of my knowledge and belief</i>  Signature Richard A. Jenkins Printed Name NM Petroleum Engineer Date 6/12/08
			¹ SURVEYOR CERTIFICATION <i>I hereby certify that the well location shown on this plat was plotted from field notes of actual surveys made by me or under my supervision, and that the same is true and correct to the best of my belief.</i> Signature and Seal of Professional Surveyor
			Certificate Number

C.H. Weir B #14

Location:

660' FNL & 1980' FEL; T20S R37E Section 11

Unit Letter: B

Field: Weir East/Monument/Skaggs

County: Lea

State: NM

Well Info:

Spud Date:

API: 30-025-38966

Cost Center:

WBS#:

RefNO:

Lease:

Proposed Wellbore Diagram

Elevations:

DF: 16'

KB: 17'

GL: 3604'

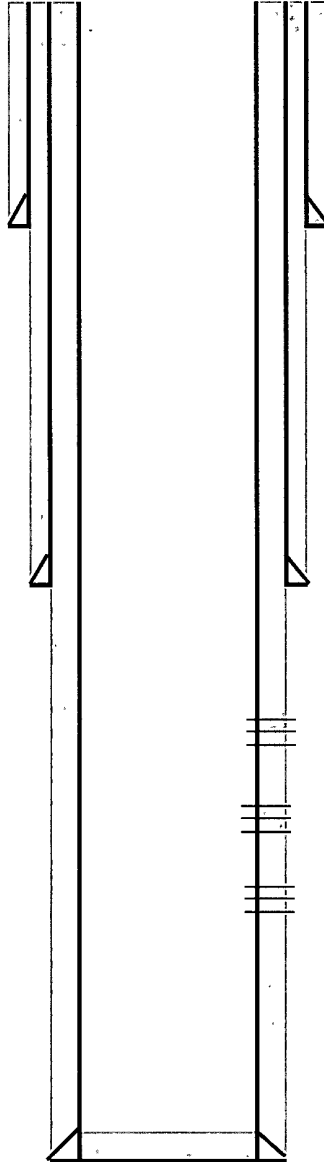

Surface Casing

Size: 11 3/4", 42#, H-40 ST&C

Set @: 520'

With: 360 sx

Hole Size: 14 3/4"

TOC @: Surface

By: Circulation

Intermediate Casing

Size: 8 5/8", 24#, K-55 ST&C

Set @: 2750'

With: 775sx

Hole Size: 11"

TOC: Surface

By: Circulation

Blinbry 5700'-6300'

Tubb 6300'-6600'

Drinkard 6600'-7000'

Production Casing

Size: 5 1/2", 17#, L-80 LTC

Set @: 7000'

With: 1080 sx

Hole Size: 7 7/8"

TOC: Surface

By: Circulation

Updated: 29-May-08

By: rjdg

PBTD:

TD: 7000'

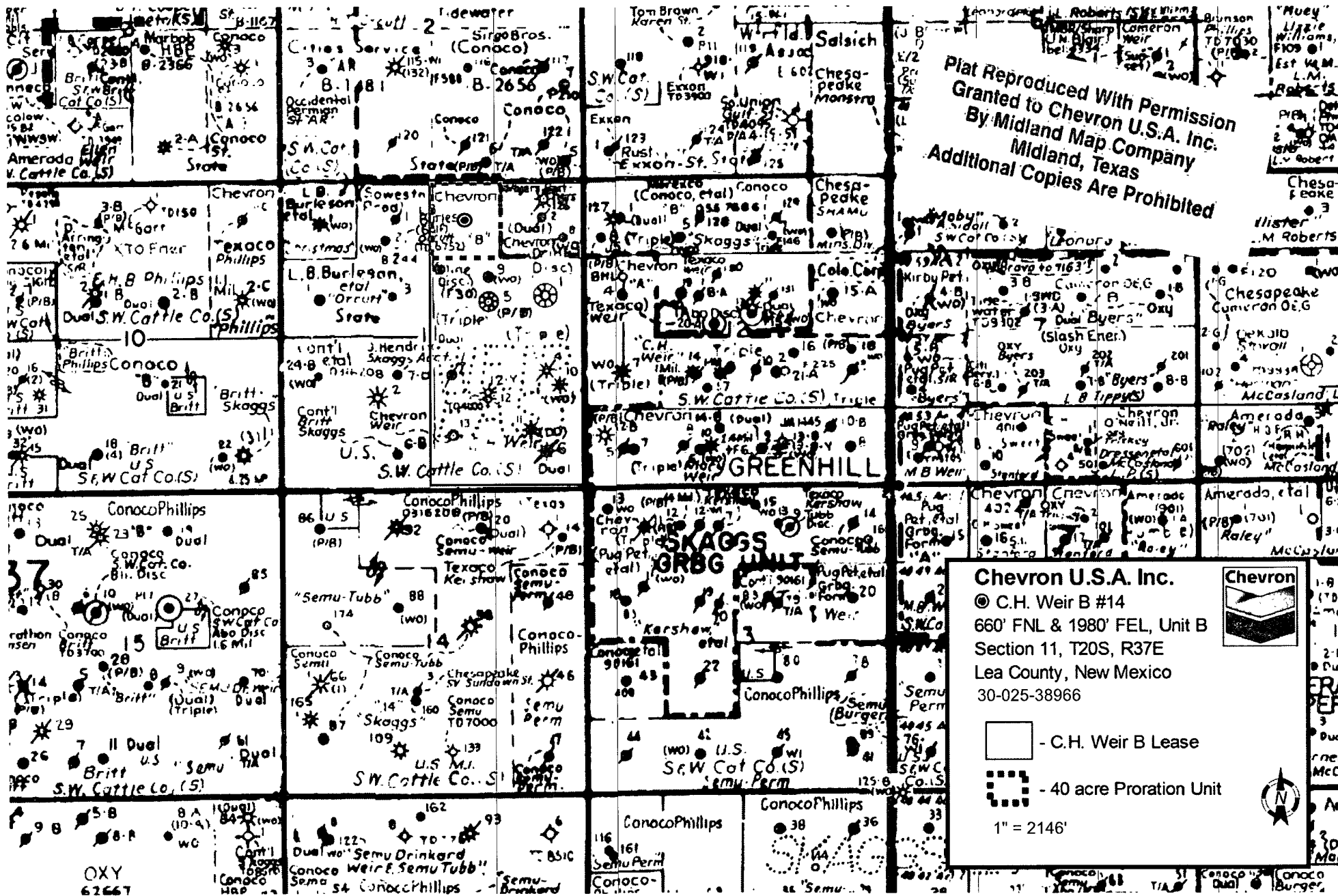

Plat Reproduced With Permission
Granted to Chevron U.S.A. Inc.
By Midland Map Company
Midland, Texas
Additional Copies Are Prohibited

Chevron U.S.A. Inc.
© C.H. Weir B #14
660' FNL & 1980' FEL, Unit B
Section 11, T20S, R37E
Lea County, New Mexico
30-025-38966

