

District I
1625 N. French Dr., Hobbs, NM 88240

District II
811 South First, Artesia, NM 88210

District III
1000 Rio Brazos Rd., Aztec, NM 87410

District IV
2040 South Pacheco, Santa Fe, NM 87505

State of New Mexico
Energy, Minerals & Natural Resources Department

Form C-102
Revised March 17, 1999

OIL CONSERVATION DIVISION Submit to Appropriate District Office
State Lease - 4 Copies
Fee Lease - 3 Copies
2040 South Pacheco
Santa Fe, NM 87505

☐ AMENDED REPORT

WELL LOCATION AND ACREAGE DEDICATION PLAT

¹ API Number 30-025-38967	² Pool Code 63800	³ Pool Name Weir; Blinebry, East
⁴ Property Code 29920	⁵ Property Name C.H. Weir B	⁶ Well Number 15
⁷ OGRID No 4323	⁸ Operator Name Chevron U.S.A., Inc.	⁹ Elevation 3574'

¹⁰ Surface Location

UL or Lot No	Section	Township	Range	Lot Idn	Feet from the	North/South line	Feet from the	East/West line	County
I	11	20S	37E		1333'	South	1308'	East	Lea

¹¹ Bottom Hole Location If Different From Surface

UL or Lot No	Section	Township	Range	Lot Idn	Feet from the	North/South line	Feet from the	East/West line	County
¹² Dedicated Acres 40	¹³ Joint or Infill	¹⁴ Consolidation Code	¹⁵ Order No						

NO ALLOWABLE WILL BE ASSIGNED TO THIS COMPLETION UNTIL ALL INTERESTS HAVE BEEN CONSOLIDATED OR A
NON-STANDARD UNIT HAS BEEN APPROVED BY THE DIVISION

16				<div><p>¹</p><p>40-acre proration unit</p><p>#15</p><p>1308'</p><p>1333'</p></div>	<p>1</p> <p>OPERATOR CERTIFICATION</p> <p><i>I hereby certify that the information contained herein is true and complete to the best of my knowledge and belief</i></p> <p></p> <p>Signature Richard A. Jenkins</p> <p>Printed Name NM Petroleum Engineer</p> <p>Date 6/12/08</p>
					<p>1</p> <p>SURVEYOR CERTIFICATION</p> <p><i>I hereby certify that the well location shown on this plat was plotted from field notes of actual surveys made by me or under my supervision, and that the same is true and correct to the best of my belief</i></p> <p>Signature and Seal of Professional Surveyor</p> <p>Certificate Number</p>

District II
811 South First, Artesia, NM 88210

District III
1000 Rio Brazos Rd., Aztec, NM 87410

District IV
2040 South Pacheco, Santa Fe, NM 87505

OIL CONSERVATION DIVISION

**2040 South Pacheco
Santa Fe, NM 87505**

Submit to Appropriate District Office
State Lease - 4 Copies
Fee Lease - 3 Copies

☐ **AMENDED REPORT**

WELL LOCATION AND ACREAGE DEDICATION PLAT

¹ API Number 30-025-38967	² Pool Code 40790	³ Pool Name Monument; Tubb
⁴ Property Code 29920	⁵ Property Name C.H. Weir B	⁶ Well Number 15
⁷ OGRID No 4323	⁸ Operator Name Chevron U.S.A., Inc.	⁹ Elevation 3574'



¹⁰ Surface Location

UL or Lot No	Section	Township	Range	Lot Idn	Feet from the	North/South line	Feet from the	East/West line	County
I	11	20S	37E		1333'	South	1308'	East	Lea

¹¹ Bottom Hole Location If Different From Surface

UL or Lot No	Section	Township	Range	Lot Idn	Feet from the	North/South line	Feet from the	East/West line	County
12 Dedicated Acres 80		13 Joint or Infill		14 Consolidation Code		15 Order No			

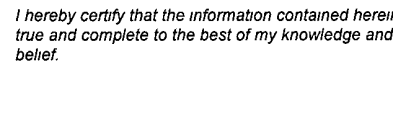
NO ALLOWABLE WILL BE ASSIGNED TO THIS COMPLETION UNTIL ALL INTERESTS HAVE BEEN CONSOLIDATED OR A NON-STANDARD UNIT HAS BEEN APPROVED BY THE DIVISION

16				<div data-bbox="1058 1017 1490 1095"><div>1</div><div>OPERATOR CERTIFICATION</div><div>I hereby certify that the information contained herein is true and complete to the best of my knowledge and belief.</div><div></div><div>Signature</div><div>Richard A. Jenkins</div><div>Printed Name</div><div>NM Petroleum Engineer</div><div>Date</div><div>6/12/08</div></div>
		<div data-bbox="583 1464 618 1542">1</div>	<div data-bbox="583 1464 1037 1970"><div data-bbox="888 1517 1029 1568">80-acre proration unit</div><div data-bbox="591 1672 625 1691">#15</div><div data-bbox="724 1681 774 1702">1308'</div><div data-bbox="591 1706 618 1725"></div><div data-bbox="612 1866 660 1885">1333'</div></div>	<div data-bbox="1058 1502 1490 1970"><div>1</div><div>SURVEYOR CERTIFICATION</div><div>I hereby certify that the well location shown on this plat was plotted from field notes of actual surveys made by me or under my supervision, and that the same is true and correct to the best of my belief</div><div>Signature and Seal of Professional Surveyor</div><div>Certificate Number</div></div>

District I
1625 N. French Dr., Hobbs, NM 88240

District II
811 South First, Artesia, NM 88210

District III
1000 Rio Brazos Rd., Aztec, NM 87410

District IV
2040 South Pacheco, Santa Fe, NM 87505

State of New Mexico
Energy, Minerals & Natural Resources Department

Form C-102
Revised March 17, 1999

OIL CONSERVATION DIVISION Submit to Appropriate District Office
2040 South Pacheco
Santa Fe, NM 87505
State Lease - 4 Copies
Fee Lease - 3 Copies

☐ AMENDED REPORT

WELL LOCATION AND ACREAGE DEDICATION PLAT

¹ API Number 30-025-38967	² Pool Code 57000	³ Pool Name Skaggs; Drinkard
⁴ Property Code 29920	⁵ Property Name C.H. Weir B	⁶ Well Number 15
⁷ OGRID No 4323	⁸ Operator Name Chevron U.S.A., Inc.	⁹ Elevation 3574'

¹⁰ Surface Location

UL or Lot No	Section	Township	Range	Lot Idn	Feet from the	North/South line	Feet from the	East/West line	County
I	11	20S	37E		1333'	South	1308'	East	Lea

¹¹ Bottom Hole Location If Different From Surface

UL or Lot No	Section	Township	Range	Lot Idn	Feet from the	North/South line	Feet from the	East/West line	County
¹² Dedicated Acres 40	¹³ Joint or Infill	¹⁴ Consolidation Code	¹⁵ Order No						

NO ALLOWABLE WILL BE ASSIGNED TO THIS COMPLETION UNTIL ALL INTERESTS HAVE BEEN CONSOLIDATED OR A
NON-STANDARD UNIT HAS BEEN APPROVED BY THE DIVISION

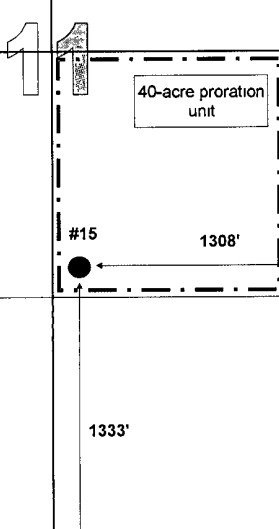
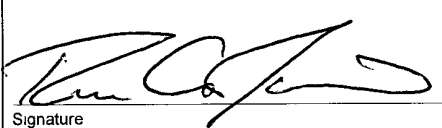
<div>16</div> 	<div>¹ OPERATOR CERTIFICATION</div> <p><i>I hereby certify that the information contained herein is true and complete to the best of my knowledge and belief</i></p> <div> Signature</div> <div>Richard A. Jenkins</div> <div>Printed Name</div> <div>NM Petroleum Engineer</div> <div>Date</div> <div>6/12/08</div>
	<div>¹ SURVEYOR CERTIFICATION</div> <p><i>I hereby certify that the well location shown on this plat was plotted from field notes of actual surveys made by me or under my supervision, and that the same is true and correct to the best of my belief</i></p> <div>Signature and Seal of Professional Surveyor</div>
	Certificate Number

C.H. Weir B #15

Location:

1333' FSL & 1308' FEL; T20S R37E Section 11
Unit Letter: I
Field: Weir East/Monument/Skaggs
County: Lea
State: NM

Well Info:

Spud Date:
API: 30-025-38967
Cost Center:
WBS#:
RefNO:
Lease:

Proposed Wellbore Diagram

Elevations:

DF: 16'
KB: 17'
GL: 3561'

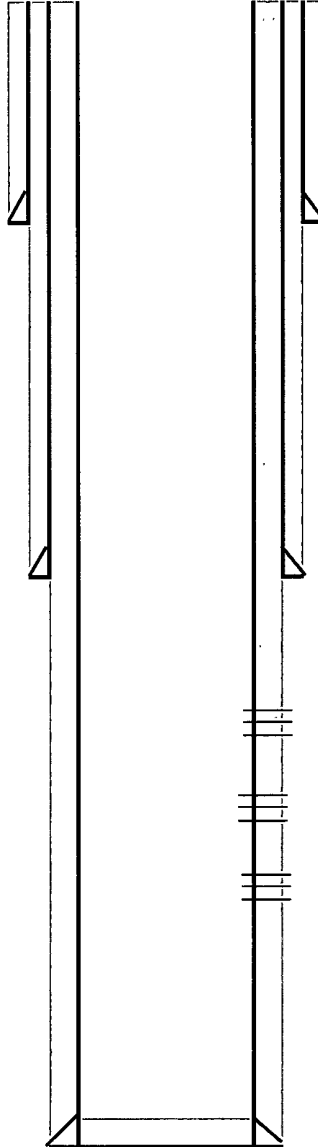

Surface Casing

Size: 11 3/4", 42#, H-40 ST&C
Set @: 520'
With: 360 sx
Hole Size: 14 3/4"
TOC @ Surface
By: Circulation

Intermediate Casing

Size: 8 5/8", 24#, K-55 ST&C
Set @: 2750'
With: 775sx
Hole Size: 11"
TOC: Surface
By: Circulation

Blinbry 5690'-6290'

Tubb 6290'-6630'

Drinkard 6630'-6934'

Production Casing

Size: 5 1/2", 17#, L-80 LTC
Set @: 7000'
With: 1080 sx
Hole Size: 7 7/8"
TOC: Surface
By: Circulation

Updated: 12-Jun-08

By: rjdg

PBTD:

TD: 7000'

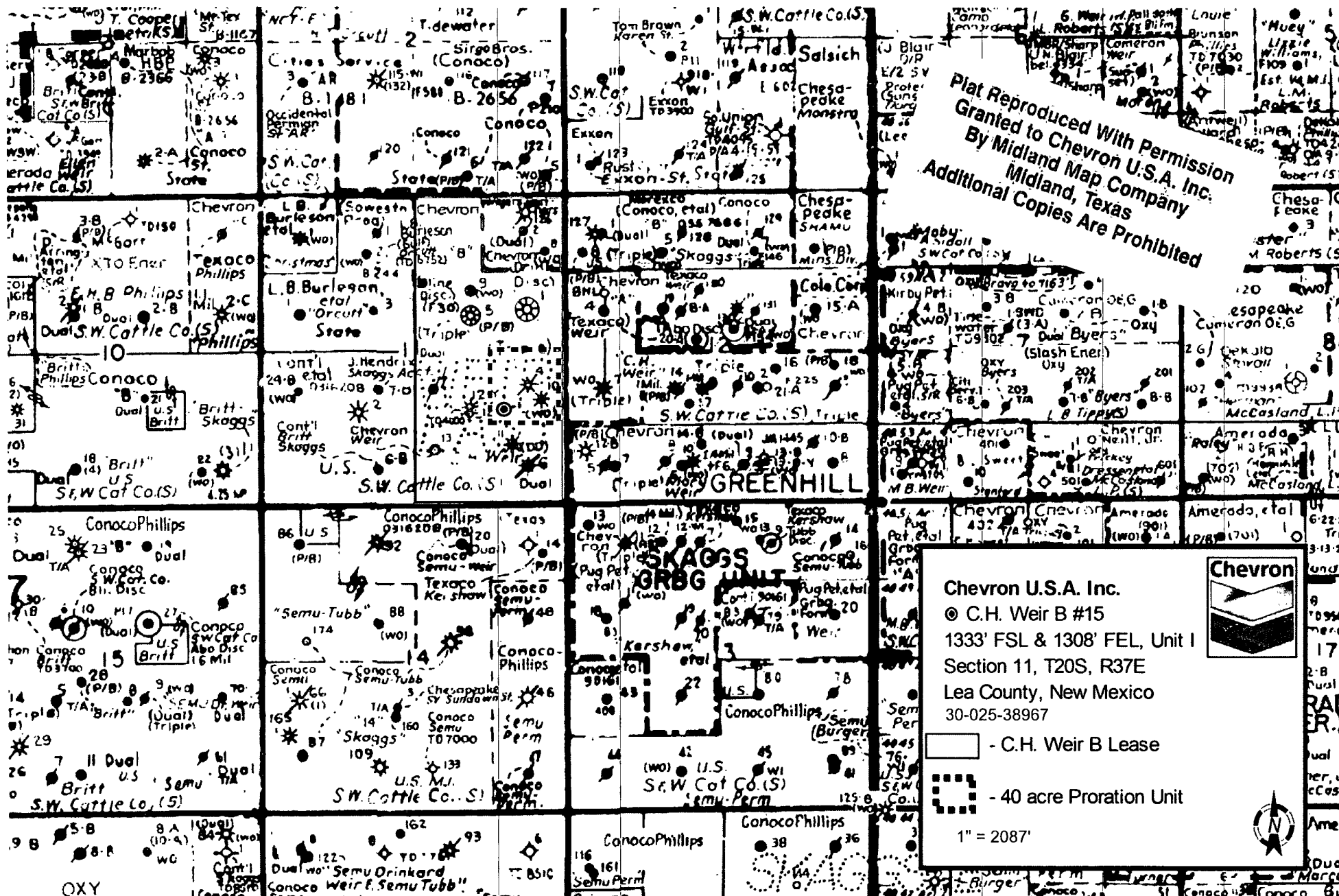

Chevron U.S.A. Inc.
 © C.H. Weir B #15
 1333' FSL & 1308' FEL, Unit I
 Section 11, T20S, R37E
 Lea County, New Mexico
 30-025-38967

- C.H. Weir B Lease
- 40 acre Proration Unit

1" = 2087'

