

District I
1625 N French Dr., Hobbs, NM 88240
District II
1701 W Grand Avenue, Artesia, NM 88210
District III
1000 Rio Brazos Road, Aztec, NM 87410
District IV
1220 S St Francis Dr., Santa Fe, NM 87505

State of New Mexico
Energy Minerals and Natural Resources

Oil Conservation Division
1220 South St. Francis Dr.
Santa Fe, NM 87505

Form C-144
June 1, 2004

For drilling and production facilities, submit to appropriate NMOCD District Office.
For downstream facilities, submit to Santa Fe office

Pit or Below-Grade Tank Registration or Closure

Is pit or below-grade tank covered by a "general plan"? Yes ☒ No ☐

Type of action Registration of a pit or below-grade tank ☐ Closure of a pit or below-grade tank ☒

Operator Yates Petroleum Corporation Telephone 505-748-4500 e-mail address mikes@ypcnm.com
Address 105 South 4th Street, Artesia, NM 88210
Facility or well name Merle State Unit #14 API # 30-025-38396 U/L or Qtr/Qtr L Sec 13 T 10S R 34E
County Lea Latitude 33.44525 Longitude 103.42347 NAD 1927 ☒ 1983 ☐
Surface Owner Federal ☐ State ☒ Private ☐ Indian ☐

RECEIVED

7/2/08
HOBBS OCD

Pit Type Drilling <input checked="" type="checkbox"/> Production <input type="checkbox"/> Disposal <input type="checkbox"/> Work over <input type="checkbox"/> Emergency <input type="checkbox"/> Lined <input checked="" type="checkbox"/> Unlined <input type="checkbox"/> Liner type Synthetic <input checked="" type="checkbox"/> Thickness <u>12</u> mil Clay <input type="checkbox"/> Pit Volume <u>24,000</u> bbl	Below-grade tank Volume _____ bbl Type of fluid _____ Construction material _____ Double-walled, with leak detection? Yes <input type="checkbox"/> If not, explain why not _____
Depth to ground water (vertical distance from bottom of pit to seasonal high water elevation of ground water.)	Less than 50 feet (20 points) XXXX 50 feet or more, but less than 100 feet (10 points) 100 feet or more (0 points)
Wellhead protection area (Less than 200 feet from a private domestic water source, or less than 1000 feet from all other water sources)	Yes (20 points) No (0 points) XXXX
Distance to surface water (horizontal distance to all wetlands, playas, irrigation canals, ditches and perennial and ephemeral watercourses)	Less than 200 feet (20 points) 200 feet or more, but less than 1000 feet (10 points) 1000 feet or more (0 points) XXXX
Ranking Score (Total Points) 20 Points	

If this is a pit closure: (1) Attach a diagram of the facility showing the pit's relationship to other equipment and tanks (2) Indicate disposal location (check the onsite box if you are burying in place) onsite ☐ offsite ☒ If offsite, name of facility N/A (3) Attach a general description of remedial action taken including remediation start date and end date (4) Groundwater encountered No ☐ Yes ☐ If yes, show depth below ground surface _____ ft and attach sample results (5) Attach soil sample results and a diagram of sample locations and excavations

Additional Comments Closure work plan for drilling pit The drilling pit contents will be excavated and hauled to an OCD approved soil waste facility
The excavated area will be backfilled to grade using a minimum of 3' of clean soil and like material A one call and a 48 hour notice will be provided to the Oil Conservation Division
Pit Closure start date N/A Final closure date N/A

I hereby certify that the information above is true and complete to the best of my knowledge and belief I further certify that the above-described pit or below-grade tank has been/will be constructed or closed according to NMOCD guidelines ☐, a general permit ☒, or an (attached) alternative OCD-approved plan ☐.

Date 06/13/2008

Printed Name/Title Mike Stubblefield / Environmental Regulatory Agent

Signature Mike Stubblefield

Your certification and NMOCD approval of this application/closure does not relieve the operator of liability should the contents of the pit or tank contaminate ground water or otherwise endanger public health or the environment Nor does it relieve the operator of its responsibility for compliance with any other federal, state, or local laws and/or regulations

Approval

Printed Name/Title CHRIS WILLIAMS

Signature Chris Williams

Date 7/2/08

MERLE STATE UNIT #14
30-025-38396

USGS SEO TWN 09S-15S CHAVES LEA GW

	F	G	H	I	J	K	L
3	COUNTY	SOURCE	USGS SITE NUM	QTY	SITE LOCATION	DATE	LEVEL
193	LEA	SEO		1	10S.34E.20.43311	1981-02-25	34.11
194	LEA	SEO		1	10S.34E.27.14210	1976-05-04	54.92
195	LEA	SEO		1	10S.34E.27.14222	1991-01-25	50.78
196	LEA	SEO		1	10S.34E.32.13144	1954-05-06	6.85
197	LEA	SEO		1	10S.34E.36.412134	1981-04-10	43.29 ✓

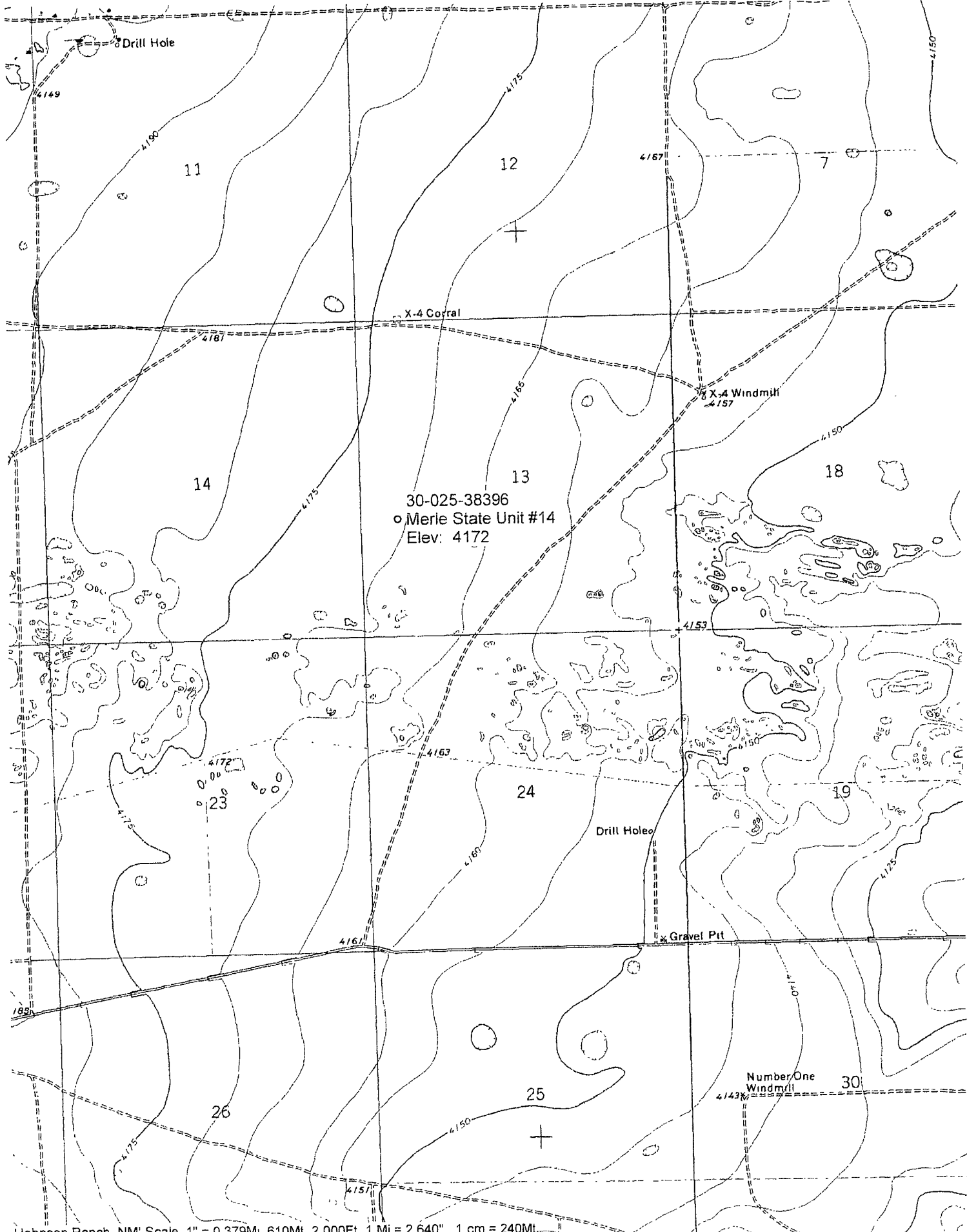

Johnson Ranch, NM Scale 1" = 0.379Mi 610Mt 2,000Ft, 1 Mi = 2.640" , 1 cm = 240Mt.