

Submit 3 Copies To Appropriate District  
Office  
District I  
1625 N. French Dr., Hobbs, NM 88240  
District II  
1301 W. Grand Ave., Artesia, NM 88210  
District III  
1000 Rio Brazos Rd., Aztec, NM 87410  
District IV  
1220 S. St. Francis Dr., Santa Fe, NM  
87505

State of New Mexico  
Energy, Minerals and Natural Resources

Form C-103  
May 27, 2004

OIL CONSERVATION DIVISION  
1220 South St. Francis Dr. 2008  
Santa Fe, NM 87505

RECEIVED

HOBBS OGD

WELL API NO.

30-025-29731

5. Indicate Type of Lease

STATE ☐ FEE ☒

6. State Oil & Gas Lease No.

7. Lease Name or Unit Agreement Name

WEIR, C.H. -B-

8. Well Number 8

9. OGRID Number

4323

10. Pool name or Wildcat

Monument Tubb/Skaggs Drinkard

SUNDRY NOTICES AND REPORTS ON WELLS  
(DO NOT USE THIS FORM FOR PROPOSALS TO DRILL OR TO DEEPEN OR PLUG BACK TO A  
DIFFERENT RESERVOIR USE "APPLICATION FOR PERMIT" (FORM C-101) FOR SUCH  
PROPOSALS.)

1. Type of Well: ☒ Oil Well ☐ Gas Well ☐ Other

2. Name of Operator

Chevron U.S.A. Inc.

3. Address of Operator

15 Smith Road Midland, TX 79705

4. Well Location

Unit Letter A : 990 feet from the North line and 330 feet from the East line

Section 11 Township 20S Range 37E NMPM County LEA

11. Elevation (Show whether DR, RKB, RT, GR, etc)

3600' KB

Pit or Below-grade Tank Application ☐ or Closure ☐

Pit type \_\_\_\_\_ Depth to Groundwater \_\_\_\_\_ Distance from nearest fresh water well \_\_\_\_\_ Distance from nearest surface water \_\_\_\_\_

Pit Liner Thickness: \_\_\_\_\_ mil Below-Grade Tank: Volume \_\_\_\_\_ bbls; Construction Material \_\_\_\_\_

12. Check Appropriate Box to Indicate Nature of Notice, Report or Other Data

NOTICE OF INTENTION TO:

PERFORM REMEDIAL WORK ☐ PLUG AND ABANDON ☐

TEMPORARILY ABANDON ☐ CHANGE PLANS ☐

PULL OR ALTER CASING ☐ MULTIPLE COMPL ☐

OTHER: DHC Monument Tubb/Skaggs Drinkard ☒

SUBSEQUENT REPORT OF:

REMEDIAL WORK ☐ ALTERING CASING ☐

COMMENCE DRILLING OPNS. ☐ P AND A ☐

CASING/CEMENT JOB ☐

OTHER: ☐

13. Describe proposed or completed operations. (Clearly state all pertinent details, and give pertinent dates, including estimated date of starting any proposed work). SEE RULE 1103. For Multiple Completions: Attach wellbore diagram of proposed completion or recompletion.

IT IS PROPOSED TO DOWNHOLE COMMINGLE POOLS, MONUMENT TUBB (PERFS 6444'-6502') AND SKAGGS DRINKARD (PERFS 6643'-6904') IN THE CAPTIONED WELL. THIS WELL WAS FORMERLY DHC'D IN THESE POOLS UNDER ADMINISTRATIVE ORDER DHC-1401. PRODUCTION WILL BE ALLOCATED BACK TO THE TWO POOLS BASED ON THE PERCENTAGES SHOWN IN THE ATTACHED SUPPORT DATA.

DHC Order No. HOB-0255

I hereby certify that the information above is true and complete to the best of my knowledge and belief. I further certify that any pit or below-grade tank has been/will be constructed or closed according to ☒ OGD guidelines ☐ a general permit ☐ or an (attached) alternative OCD-approved plan ☐.

SIGNATURE

TITLE Petroleum Engineer DATE 06/01/2008

Type or print name  
For State Use Only

E-mail address:

Telephone No.

APPROVED BY:

TITLE PETROLEUM ENGINEER

DATE

JUL 24 2008

Conditions of Approval (if any):

**REQUEST FOR DHC OF PRE-APPROVED POOLS**  
**DIVISION ORDER NO. R-11363**

**Operator**

Chevron U.S.A., Inc.  
P. O. Box 1150  
Midland, TX 79702

**Lease Name and Well Number**

C.H. Weir B #8  
990' FNL & 330' FEL, Unit Letter A  
Section 11, T20S, R37E  
Lea County, New Mexico

**Division Order**

Pre-approved pools or area established by Division Order No. R-11363.

**Pools To Be Commingled In C.H. Weir B #8**

(47090) Monument Tubb (Oil)  
(57000) Skaggs Drinkard (Oil)

**Perforated Intervals**

Monument Tubb (6444'-6502')  
Skaggs Drinkard (6643'-6904')

**Location Plat**

Attached

**Well Test Report & Production Plots**

Attached.

**Product Characteristics And Value**

Previous commingling of these zones by Chevron and other operators in the area have shown that the produced fluids are compatible and commingling will not cause formation damage or producing problems. Also, the price received by Chevron for products from these zones is very similar, so value will not be adversely affected.

**Production Allocation**

<u>Pool</u>	<u>BOPD</u>	<u>BWPD</u>	<u>MCFPD</u>	<u>Remarks</u>
Tubb	1	5	80	Calculated Using Allocation Percentages
Drinkard	3	11	69	Calculated Using Allocation Percentages
<b>Totals</b>	<b>4</b>	<b>15</b>	<b>149</b>	C.H Weir B #8 Well Test Report 11/17/2006

<u>Allocated %</u>	<u>Oil %</u>	<u>Water %</u>	<u>Gas %</u>	<u>Remarks</u>
Tubb	27	30	54	Approved Under DHC-1401 - using actual well t
Drinkard	73	70	46	Approved Under DHC-1401 - using actual well t
<b>Totals</b>	<b>100</b>	<b>100</b>	<b>100</b>	

**Ownership**

Ownership of all zones is identical so correlative rights will not be compromised.

**State / Federal Land Notification**

FEE

District I  
1625 N. French Dr., Hobbs, NM 88240

District II  
811 South First, Artesia, NM 88210

District III  
1000 Rio Brazos Rd., Aztec, NM 87410

District IV  
2040 South Pacheco, Santa Fe, NM 87505

State of New Mexico  
Energy, Minerals & Natural Resources Department

Form C-102  
Revised March 17, 1999

OIL CONSERVATION DIVISION

2040 South Pacheco  
Santa Fe, NM 87505

Submit to Appropriate District Office  
State Lease - 4 Copies  
Fee Lease - 3 Copies

☐ AMENDED REPORT

WELL LOCATION AND ACREAGE DEDICATION PLAT

<sup>1</sup> API Number 30-025-29731	<sup>2</sup> Pool Code 47090	<sup>3</sup> Pool Name Monument Tubb
<sup>4</sup> Property Code 29920	<sup>5</sup> Property Name WEIR, C.H. -B-	<sup>6</sup> Well Number 8
<sup>7</sup> OGRID No 4323	<sup>8</sup> Operator Name Chevron U.S.A., Inc.	<sup>9</sup> Elevation 3600' KB



<sup>10</sup> Surface Location

UL or Lot No	Section	Township	Range	Lot Idn	Feet from the	North/South line	Feet from the	East/West line	County
A	11	20S	37E		990	North	330	East	Lea

<sup>11</sup> Bottom Hole Location If Different From Surface

UL or Lot No	Section	Township	Range	Lot Idn	Feet from the	North/South line	Feet from the	East/West line	County
<sup>12</sup> Dedicated Acres 80	<sup>13</sup> Joint or Infill	<sup>14</sup> Consolidation Code	<sup>15</sup> Order No DHC - 1401						

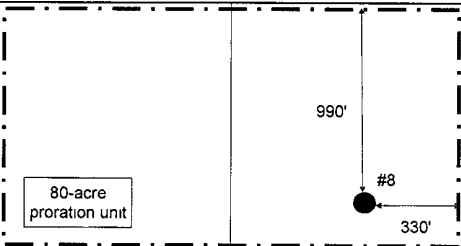
NO ALLOWABLE WILL BE ASSIGNED TO THIS COMPLETION UNTIL ALL INTERESTS HAVE BEEN CONSOLIDATED OR A  
NON-STANDARD UNIT HAS BEEN APPROVED BY THE DIVISION

16			<p><sup>1</sup> OPERATOR CERTIFICATION</p> <p>I hereby certify that the information contained herein is true and complete to the best of my knowledge and belief</p> <p></p> <p>Signature Richard A. Jenkins</p> <p>Printed Name Petr. Engineer</p> <p>Title 06/01/2008</p>
			<p><sup>1</sup> SURVEYOR CERTIFICATION</p> <p>I hereby certify that the well location shown on this plat was plotted from field notes of actual surveys made by me or under my supervision, and that the same is true and correct to the best of my belief</p> <p>Signature and Seal of Professional Surveyor</p> <p>Certificate Number</p>

☐ **AMENDED REPORT**

# WELL LOCATION AND ACREAGE DEDICATION PLAT

<sup>1</sup> API Number 30-025-29731	<sup>2</sup> Pool Code 57000	<sup>3</sup> Pool Name Skaggs Drinkard
<sup>4</sup> Property Code 29920	<sup>5</sup> Property Name WEIR, C.H. -B-	<sup>6</sup> Well Number 8
<sup>7</sup> OGRID No. 4323	<sup>8</sup> Operator Name Chevron U.S.A., Inc.	<sup>9</sup> Elevation 3600' KB

<sup>10</sup> Surface Location

UL or Lot No	Section	Township	Range	Lot Idn	Feet from the	North/South line	Feet from the	East/West line	County
A	11	20S	37E		990	North	330	East	Lea

<sup>11</sup> Bottom Hole Location If Different From Surface

UL or Lot No	Section	Township	Range	Lot Idn	Feet from the	North/South line	Feet from the	East/West line	County
<sup>12</sup> Dedicated Acres 40	<sup>13</sup> Joint or Infill	<sup>14</sup> Consolidation Code	<sup>15</sup> Order No DHC - 1401						

**NO ALLOWABLE WILL BE ASSIGNED TO THIS COMPLETION UNTIL ALL INTERESTS HAVE BEEN CONSOLIDATED OR A NON-STANDARD UNIT HAS BEEN APPROVED BY THE DIVISION**

16			<div style="border: 1px dashed black; padding: 5px; margin: 0 auto; width: 80%;"><div style="text-align: center; margin-bottom: 10px;">990'</div><div style="display: flex; align-items: center; justify-content: center;"><div style="border: 1px solid black; padding: 2px; font-size: 0.8em;">40-acre proration</div><div style="margin: 0 10px; text-align: center;">●</div><div style="text-align: center;">#8</div></div><div style="text-align: right; margin-top: -20px;">330'</div></div>	<div style="text-align: center;">1</div> <h2 style="margin: 0;">OPERATOR CERTIFICATION</h2> <p style="font-size: 0.8em; margin: 5px 0;"><i>I hereby certify that the information contained herein is true and complete to the best of my knowledge and belief</i></p> <div style="border-top: 1px solid black; margin: 5px 0; height: 40px; text-align: center;"></div> <div style="display: flex; justify-content: space-between; font-size: 0.8em; margin: 0;"><div>Signature</div><div><b>Richard A. Jenkins</b></div></div> <div style="display: flex; justify-content: space-between; font-size: 0.8em; margin: 5px 0;"><div>Printed Name</div><div><b>Petr. Engineer</b></div></div> <div style="display: flex; justify-content: space-between; font-size: 0.8em; margin: 0;"><div>Title</div><div><b>06/01/2008</b></div></div>
			<div style="text-align: center;">1</div> <h2 style="margin: 0;">SURVEYOR CERTIFICATION</h2> <p style="font-size: 0.8em; margin: 5px 0;"><i>I hereby certify that the well location shown on this plat was plotted from field notes of actual surveys made by me or under my supervision, and that the same is true and correct to the best of my belief</i></p> <div style="border-top: 1px solid black; margin: 5px 0; height: 40px;"></div> <div style="font-size: 0.8em; margin: 0;">Signature and Seal of Professional Surveyor</div>	
			<div style="border-top: 1px solid black; margin: 5px 0; height: 40px;"></div> <div style="font-size: 0.8em; margin: 0;">Certificate Number</div>	

District I  
1625 N French Drive Hobbs NM 88240  
District II  
1301 W Grand Avenue Artesia NM 88210  
District III  
1000 Rio Brazos Road Arice NM 87410  
District IV  
1220 S St Francis Dr Santa Fe NM 87505

State of New Mexico  
Energy, Minerals and Natural Resources Department

Form C-107A  
Revised June 10, 2003

Oil Conservation Division  
1220 South St. Francis Dr.  
Santa Fe, New Mexico 87505

APPLICATION TYPE  
☒ Single Well  
☒ Establish Pre-Approved Pools  
EXISTING WELLBORE  
☒ Yes ☐ No

APPLICATION FOR DOWNHOLE COMMINGLING

Chevron Corporation 15 Smith Road, Midland TX 79705  
Operator Address

C.H. Weir "B" #8 A-11-20S-37E Lea  
Lease Well No. Unit Letter-Section-Township-Range County

OGRID No. 4323 Property Code 29920 API No. 30-025-29731 Lease Type: State X Fee

DATA ELEMENT	UPPER ZONE	INTERMEDIATE ZONE	LOWER ZONE
Pool Name	Monument Tubb	-	Skaggs Drinkard
Pool Code	47090	-	57000
Top and Bottom of Pay Section (Perforated or Open-Hole Interval)	6444'-6502'	-	6643'-6904'
Method of Production (Flowing or Artificial Lift)	Artificial Lift	-	Artificial Lift
Bottomhole Pressure (Note Pressure data will not be required if the bottom perforation in the lower zone is within 150% of the depth of the top perforation in the upper zone)	-	-	-
Oil Gravity or Gas BTU (Degree API or Gas BTU)	36 API	-	36 API
Producing, Shut-In or New Zone	Producing	-	Producing
Date and Oil/Gas/Water Rates of Last Production. (Note For new zones with no production history, applicant shall be required to attach production estimates and supporting data )	Date 11/17/2006 Oil Gas 1 BOPD 81 MCFPD	-	Date 11/17/2006 Oil Gas 3 BOPD 69 MCFPD
Fixed Allocation Percentage (Note If allocation is based upon something other than current or past production, supporting data or explanation will be required )	Oil Gas 27% 54%	-	Oil Gas 73% 46%

ADDITIONAL DATA

Are all working, royalty and overriding royalty interests identical in all commingled zones? Yes ☒ No ☐  
If not, have all working, royalty and overriding royalty interest owners been notified by certified mail? Yes ☐ No ☐  
Are all produced fluids from all commingled zones compatible with each other? Yes ☒ No ☐  
Will commingling decrease the value of production? Yes ☐ No ☒  
If this well is on, or communitized with, state or federal lands, has either the Commissioner of Public Lands or the United States Bureau of Land Management been notified in writing of this application? Yes ☒ No ☐

NMOCD Reference Case No. applicable to this well:

- Attachments:
- C-102 for each zone to be commingled showing its spacing unit and acreage dedication.
  - Production curve for each zone for at least one year. (If not available, attach explanation.)
  - For zones with no production history, estimated production rates and supporting data.
  - Data to support allocation method or formula.
  - Notification list of working, royalty and overriding royalty interests for uncommon interest cases.
  - Any additional statements, data or documents required to support commingling.

PRE-APPROVED POOLS

If application is to establish Pre-Approved Pools, the following additional information will be required:

- List of other orders approving downhole commingling within the proposed Pre-Approved Pools
- List of all operators within the proposed Pre-Approved Pools
- Proof that all operators within the proposed Pre-Approved Pools were provided notice of this application.
- Bottomhole pressure data.

I hereby certify that the information above is true and complete to the best of my knowledge and belief.

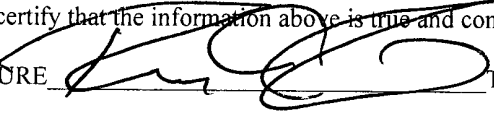
SIGNATURE  TITLE Petroleum Engineer DATE 6/01/2008  
TYPE OR PRINT NAME Richard A. Jenkins TELEPHONE NO. (432) 687-7120  
E-MAIL ADDRESS rjdgc@chevron.com

Well: **C.H. Weir B #8**

Reservoir: **Monument Tubb/Skaggs Drinkard**

**Location:**

990' FNL & 330' FEL  
Section: 11  
Township: 20S  
Range: 37E  
County: Lea, NM.

**Elevations:**

GL: 3589'  
DF:  
KB: 3600'

**Proposed**

**Well ID Info:**

Refno: IG1452  
API No: 30-025-29731  
L5/L6:  
Spud Date: 9/7/1986  
Compl. Date: 9/29/1986

**Surface Csg:** 11-3/4", 42#, H-40  
**Set: @** 1407' w/ 1000 sks  
**Hole Size:** 15"  
**Circ:** Yes  
**TOC By:** Circulation  
**TOC:** Surface

**Interm Csg:** 8-5/8", 32#, J-55  
**Set: @** 4000' w/ 1500 sks  
**Hole Size:** 11"  
**Circ:** Yes  
**TOC By:** Circulation  
**TOC:** Surface

**Perfs Status**  
6444'-6502' Monument Tubb - Open

**Perfs Status**  
6643'-6904' Skaggs Drinkard - Open

**Perfs Status**  
7077'-7144' Skaggs Abo - Open

**Prod Csg:** 5-1/2" 15 5#/17#, J-55  
**Set: @** 7194' w/ 1450 sks  
**Hole Size:** 7-7/8"  
**Circ:** Yes  
**TOC By:** Circulation  
**TOC:** Surface

This wellbore diagram is based on the most recent information regarding wellbore configuration and equipment that could be found in the Midland Office well files and computer databases as of the update date below. Verify what is in the hole with the well file in the Eunice Field Office. Discuss w/ WEO Engineer, WDO Rep OS, ALS & FS prior to rigging up on well regarding any hazards or unknown issues pertaining to the well.

CIBP @ 7050'

COTD: 7050'  
PBTd: 7050'  
TD: 7194'

Updated: 5/28/2008

By: rjdg

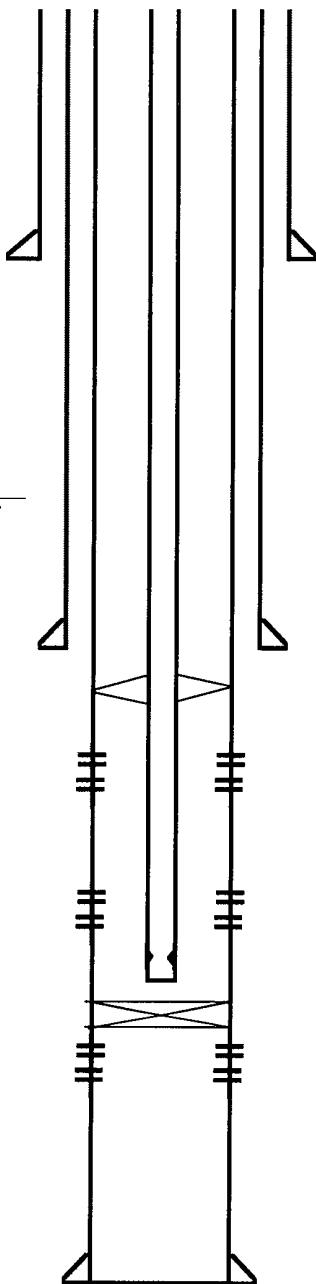

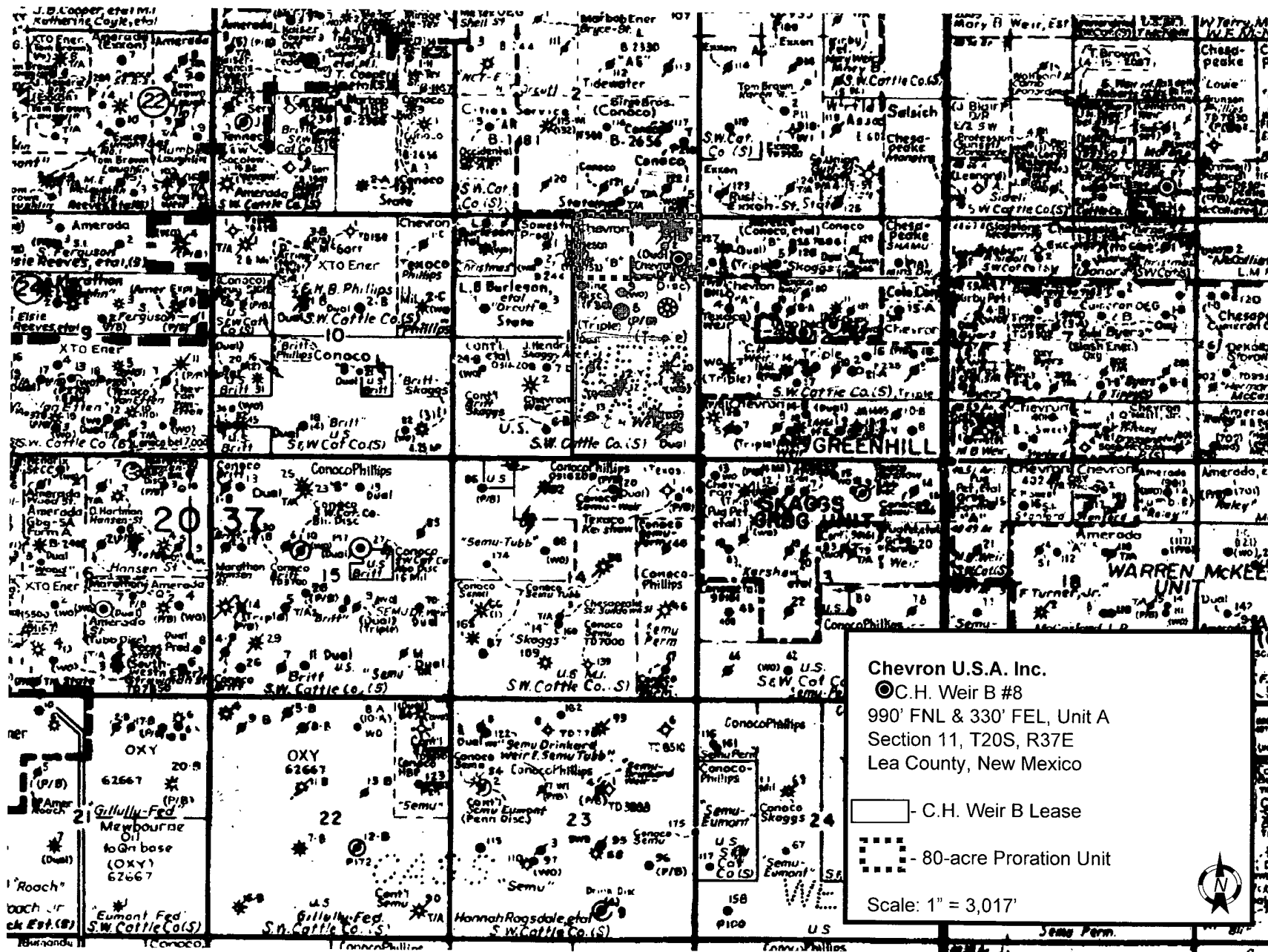



**Richard A. Jenkins**  
Petroleum Engineer  
New Mexico Team

**Permian Business Unit**  
Chevron U.S.A. Inc.  
15 Smith Road  
Midland, TX 79705  
Tel 432-631-3281  
Fax 432-687-7871  
rjdg@chevron.com

June 1, 2008

State of New Mexico  
Oil Conservation Division  
1625 N. French Drive  
Hobbs, New Mexico 88240

DHC amendment for the C.H. Weir B #8 (30-025-29731)

Attention: Oil and Gas Regulatory Department

Chevron U.S.A. Inc. respectfully requests administrative approval for an amendment to Downhole Commingle the Monument Tubb (47090) and the Skaggs Drinkard (57000) in the C.H. Weir B #8. The API number for the well is 30-025-29731. The #8 is located 990' FNL & 330' FEL, Unit A, Section 11, Township 20 South, Range 37 East, NMPM, Lea County, New Mexico.

The C.H. Weir B #8 is currently producing from the Monument; Tubb, Skaggs; Drinkard, and Skaggs; Abo formations under Administrative Order DHC-3909, after a workover to add Skaggs Abo production to the previously down hole commingled Tubb and Drinkard zones (DHC-1401). The Skaggs Abo has proven to be uneconomic to produce, and will be abandoned. The Monument Tubb and Skaggs Drinkard will continue to produce in the C.H. Weir B #8, as approved under Administrative Order DHC-1401.

Included is a proposed well schematic diagram for the C.H. Weir B #8, C107, a C102 form for each pool, and a lease plat. Chevron is the operator, with 50% working interest in the lease, and the Royalty Interest Owners are the same on each well.

If you require additional information or have any questions, please contact me by telephone at 432-687-7120, or by email at [rjdg@chevron.com](mailto:rjdg@chevron.com).

Sincerely,

A handwritten signature in black ink, appearing to read "Richard A. Jenkins", written over a horizontal line.

Richard A Jenkins  
Petroleum Engineer

Enclosure

cc: Denise Pinkerton